



# TOPTRO B1 Mini Projector with WiFi and Bluetooth User Guide

[Home](#) » [TOPTRO](#) » TOPTRO B1 Mini Projector with WiFi and Bluetooth User Guide 

## TOPTRO

B1 Mini Projector with WiFi and Bluetooth  
User Guide

### Contents

- [1 B1 Mini Projector with WiFi and Bluetooth](#)
- [2 PACKAGE CONTENTS](#)
- [3 PROJECTOR OVERVIEW](#)
- [4 OPERATION GUIDE](#)
- [5 WIRELESS CONNECTION](#)
- [6 APPS](#)
- [7 BLUETOOTH CONNECTION](#)
- [8 Documents / Resources](#)
  - [8.1 References](#)

**B1 Mini Projector with WiFi and Bluetooth**

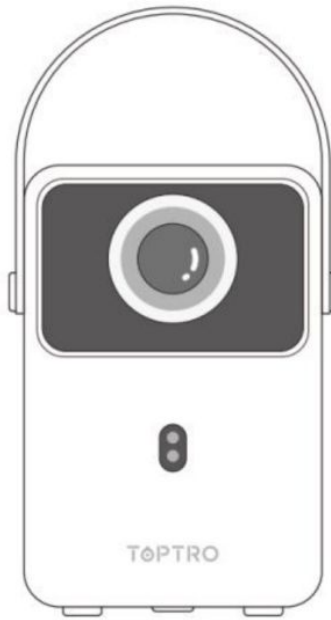

Dear valued customer,

Thank you very much for supporting TOPTRO! Before you begin using the projector, please carefully read through this QSG. The features and illustrations contained herein are provided as references and may slightly differ from the actual product due to ongoing optimizations and updates. For precise details, please refer to the physical product.

If you have any issues, please include the following details in your email: country code, order number, model, and a brief description of the problem (For example US+000-0000000-0000000+B1+No image) to [service@toptro.com](mailto:service@toptro.com). Rest assured, our team will promptly respond within 24 hours with a fast and effective solution.

It's essential to mention that many common problems can be easily resolved through simple adjustments. To ensure utmost satisfaction, we want to assure you that all our projectors undergo a rigorous 100% quality check and thorough packaging before shipping.

If you have any questions, please contact us so that the problem can be solved. And give us an opportunity to improve. We are committed to providing you with a satisfactory solution for any challenges you may encounter.

Best regards, TOPTRO Service Team



<https://www.toptro.com/pages/manuals>

Scan and download the detailed version user manual

## PACKAGE CONTENTS

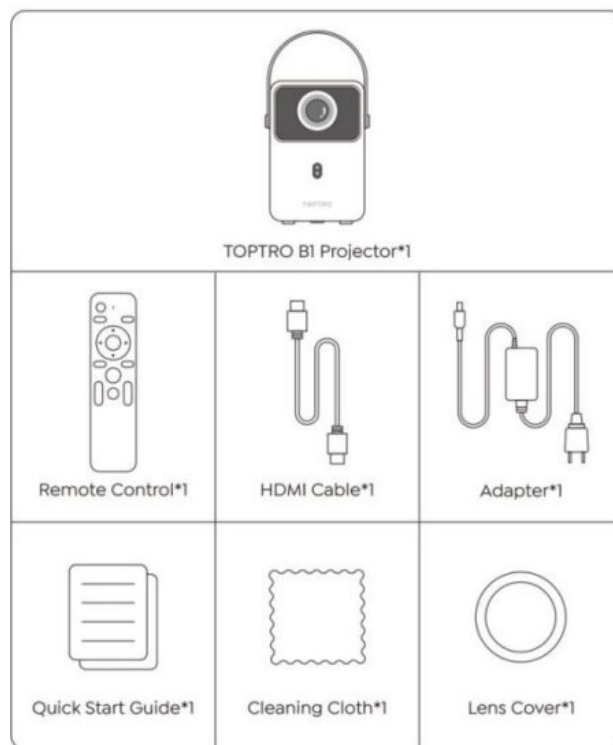

## PROJECTOR OVERVIEW

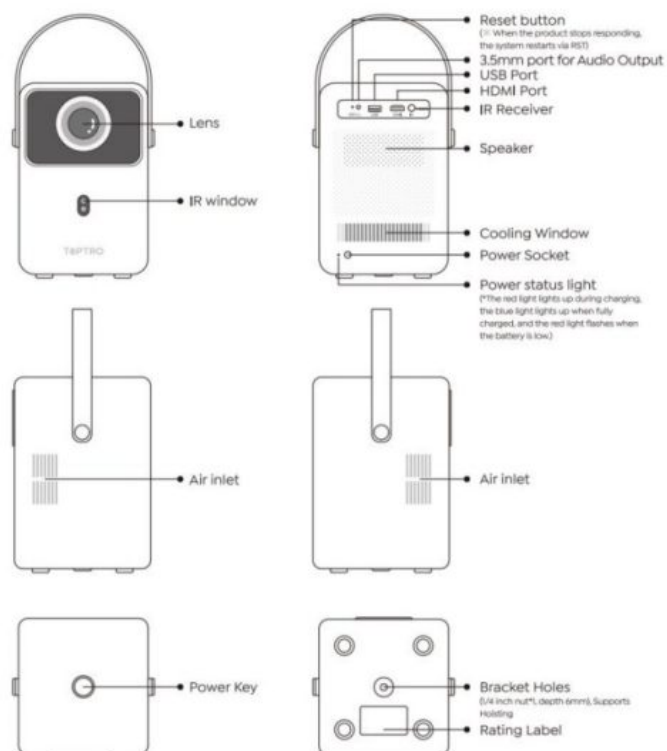

## REMOTE CONTROL

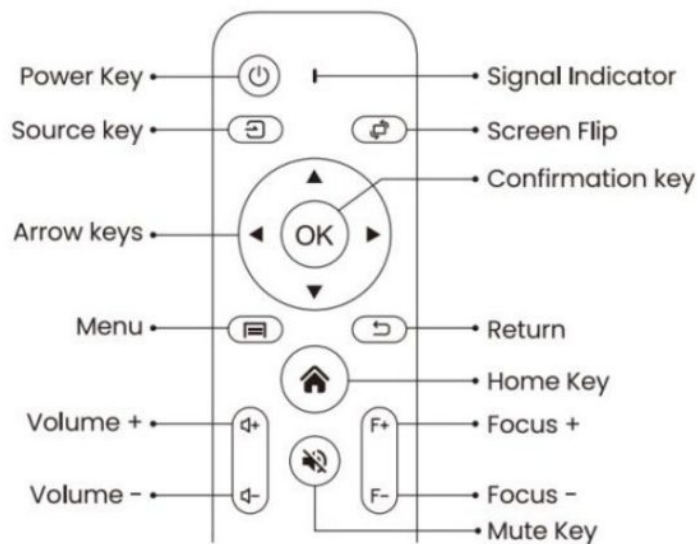

**Note:** Batteries are not included with the remote control. please install batteries before use.

### Projection Distance and Size

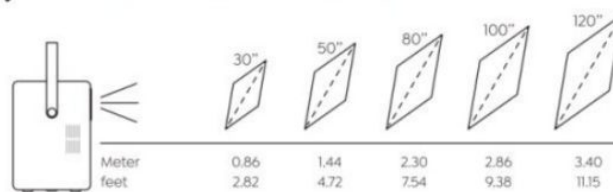

The recommended projection distance for the 81 projector is 3.7 to 7.54 feet. The image size depends on the distance and the projector's throw ratio, which is 1.3:1.

Additionally, the projector offers a 5096 zoom out feature.

## OPERATION GUIDE

### 1. Turn on BI projector

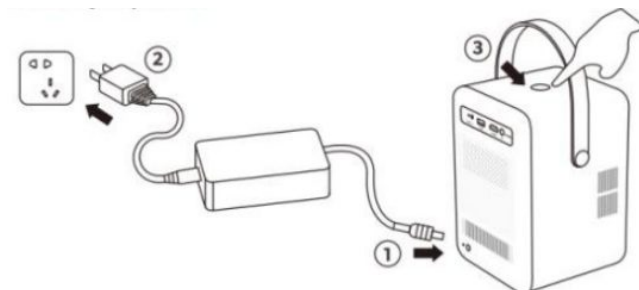

### 2. Projection Adjustment

#### 1) Focus Adjustment



#### 2) Auto Vertical Keystone

Go to home page—Select the O Button—v—Select the [Projection setting] turn on the [Auto Vertical Keystone correction]!

#### 3) 4D/4P Manual Keystone

Select the (Adv a need keystone correction!). use the left and right keys of the remote control to select 4-s,de keystone correction or 4-point keystone correction. then click (OK) to set the keystone correction

### 3. Connect device, choose the right signal source

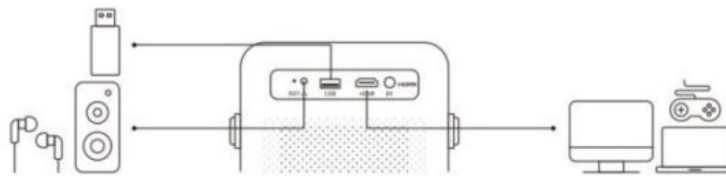

TOPTRO B1 projector has 3 Ports. HDMI Port, USB port 3.5mm headphone output port

**Note:** The projector only has HDMI signal source. If you connect an external device via USB Port. the projector will automatically recognize it. If you connect an external device via HDMI port (such as TV box, Fire TV Stick, DVD Player, PC, etc.), please select the HDMI signal source.

#### 4. Battery Mode

A. 2.5 Hours of use in battery mode. B. The brightness will be reduced to extending battery's endurance time. C. You can also adjust the brightness by adjusting the settings; However, battery's endurance time will decrease.

Battery Mode	Brightness	Play Time
HIGH BRIGHTNESS MODE	100%	1.5Hrs (fully charged)
ECO MODE	80%	2Hrs (fully charged)
LOW POWER MODE	60%	2.5Hrs (fully charged)

#### Attentions for Battery

- A. Please make sure to use the projector's power cord for charging.
- B. Due to long-time transportation, the battery may be low, and shows not fully charged when you turn on the projector for the first time, it is normal and workable.
- C. When the battery is lower than 20%, the system will prompt you to charge. The projector is still useable. However, we recommend that you turn it off and charge it to extend battery life.
- D. In battery mode, the picture brightness will be reduced to extend the usage time.
- E. The battery is not removable, please do not disassemble the machine without authorization. if you encounter any problems, please feel free to contact us
- F. When the projector completely runs out of power please turn it on again after charging for 15 minutes.
- G. The projector does not support external charging.

## WIRELESS CONNECTION

### Wi-Fi Setting

The fluency of screen mirroring with a wireless connection will be affected by the network environment. Some mobile devices may not support screen mirroring due to the compatibility.

#### 1. For iOS System (iOS Cast)

##### 1) iPhone or iPad

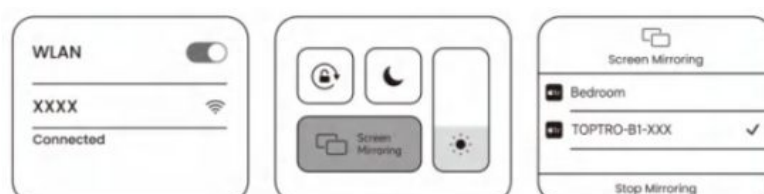

A. Go to home page—select the  button—select (Network) – select the home Wi-Fi—Connect B1 projector to your home wi-n

- B. Open your ios device to connect the same home Wi-Fi
- C. Open the [Control Center) on your iOS device—select the [Screen Mirroring) —Connect the iOS cast receiver named [TOPTRO-BHOO<J and done.

## 2) Mac laptops

- A. Make sure your Mac laptop supports Wi-Fi connection
- B. Connect the projector to the same Wi-Fi network as your Mac.
- C. Open the projector desktop MaxhubShare Apple same screen application stay on this page.
- D. Mac Projector Settings: On your Mac. go to (System Preferences] . then select [Displays] Click the [Arrangement] tab and ensure the (Mirror Displays] option is checked to enable screen mirroring.
- E. Open the iOS cast on the projector. your Mac should automatically detect the projector. The projected display should appear on the projector screen.
- F. Adjust Display Preferences: In the (Displays] settings, you can adjust the resolution and other display preferences to optimize the projection for the best visual experience.

## 2. Miracast (for Android Devices)

### 1) Android phone—MaxhubShare

- A. Make sure Tootro 81 projector and your Android device are connected in the sameWi-Fi
- 8. Go to home -Select the (MaxhubShare) app -Press the OK button to enter the [MaxhubShare) app,
- c. Scan the QR code and download the app on your Android device
- D. Open (MaxhubShare) app on your Android device -Select TV named [TOPTRO-BI-XXXJ – Your Android device screen will be displayed on the projection screen after 3 seconds.
- E. You can also use the cast function in streaming software such as YouTube to cast via the DLNA protocol.

### 2) Android phone—Kindlink

- A. Make sure Tootro 81 projector and your Android device are connected in the sameWi-Fi
- B. Go to APP page – Select the [ Kindlink I – Press the OK button to enter.
- C. Select the I Settings menu on your Android device – Select the I Screen mirroring I function – Select your Kindlink receiver named I TOPTRO-BI-XXX I – your Android device screen will be displayed on the projection screen after 3 seconds.

**Note:** 1. Different brands of Android phones have different operations for select Screen Mirroring Display, please refer to your phones manual. I Multiscreen/Wireless display/WLAN display/Screen mirroring/Wireless projection/Smart view etc.)

2. Not all Android phones support this function Please make sure it is supported before use.

### 3) Windows laptop

- A. Make sure your laptop support Wi-Fi connectivity, connect the projector to the same Wi-Fi network as your laptop.
- B. Turn on [Miracast) on the projector.
- C. Use the laptop keyboard keys to press [Win+K] to search for the projector and connect After the connection is successful. press [Win+P] to select the copy function.

## APPS

The BI projector has a large number of built-in apps, and you can also search and download the apps you need in the App Store as needed.

**Note:** When using Netflix, you need to switch to mouse mode. Press and hold the menu button on the remote control for 3 seconds to switch the remote control to mouse mode. press and hold the direction keys to move the mouse. and confirm with the OK key.

## BLUETOOTH CONNECTION

Go to home page—Select the  button—Select the [Bluetooth]—Open the Bluetooth function and your Bluetooth device—Find your Bluetooth device name and connect it.

### Attentions:

A. If the projector cannot search for Bluetooth devices. or there is a Bluetooth delay problem. please do not hesitate to contact us via [service@toptro.com](mailto:service@toptro.com)

B. Since the projector's Bluetooth only transmits audio signals. the projector can only connect to Bluetooth headsets and Bluetooth speakers. please don't connect to mobile phones and Bluetooth keyboards via Bluetooth.

### FCC Warning

This device complies with part 15 of the FCC Rules. Operation is subject to the following two conditions: (1) This device may not cause harmful interference, and (2) this device must accept any interference received, including interference that may cause undesired operation.

Any Changes or modifications not expressly approved by the party responsible for compliance could void the user's authority to operate the equipment.

**Note:** This equipment has been tested and found to comply with the limits for a Class B digital device, pursuant to part 15 of the FCC Rules. These limits are designed to provide reasonable protection against harmful interference in a residential installation. This equipment generates uses and can radiate radio frequency energy and, if not installed and used in accordance with the instructions, may cause harmful interference to radio communications. However, there is no guarantee that interference will not occur in a particular installation. If this equipment does cause harmful interference to radio or television reception, which can be determined by turning the equipment off and on, the user is encouraged to try to correct the interference by one or more of the following measures:

- Reorient or relocate the receiving antenna.
- Increase the separation between the equipment and receiver.
- Connect the equipment into an outlet on a circuit different from that to which the receiver is connected,
- Consult the dealer or an experienced radio/TV technician for help.

This equipment complies with FCC radiation exposure limits set forth for an uncontrolled environment. This equipment should be installed and operated with minimum distance 20cm between the radiator & your body.

### IC Warning

This device complies with Industry Canada's licence-exempt RSS standard(s), Operation is subject to the following two conditions:

(1) this device may not cause interference, and

(2) this device must accept any interference, including interference that may cause undesired operation of the device,

This Class B digital apparatus complies with Canadian ICES-003.

### IC RF Statement:

When using the product, maintain a distance of 20cm from the body to ensure compliance with RF exposure requirements,

UNII Band 1&2 for indoor use only

# TOPTRO

Poss'bly hazardous optical radiation emitted  
from this product.

Do not stare at operating lamp.

Maybe harmful to the eyes.



[service@toptro.com](mailto:service@toptro.com)

## Documents / Resources



**[TOPTRO B1 Mini Projector with WiFi and Bluetooth](#)** [pdf] User Guide  
2A4K9-B1, 2A4K9B1, B1 Mini Projector with WiFi and Bluetooth, B1, Mini Projector with WiFi and Bluetooth, with WiFi and Bluetooth, and Bluetooth

References

- [User Manual](#)

**[Manuals+](#)**, [Privacy Policy](#)

This website is an independent publication and is neither affiliated with nor endorsed by any of the trademark owners. The "Bluetooth®" word mark and logos are registered trademarks owned by Bluetooth SIG, Inc. The "Wi-Fi®" word mark and logos are registered trademarks owned by the Wi-Fi Alliance. Any use of these marks on this website does not imply any affiliation with or endorsement.