



TOPPING M50 Digital Network Player File Reader User Guide

[Home](#) » [TOPPING](#) » TOPPING M50 Digital Network Player File Reader User Guide 

Contents

- [1 TOPPING M50 Digital Network Player File Reader](#)
- [2 Contents list](#)
- [3 Front panel](#)
- [4 Remote control](#)
- [5 Support range](#)
- [6 Playback](#)
- [7 Output](#)
- [8 Operation](#)
- [9 Bluetooth Input](#)
- [10 Connect to PC and use as USB Bridge](#)
- [11 Documents / Resources](#)

TOPPING

TOPPING M50 Digital Network Player File Reader



Thank you for purchasing Lossless music player M50! M50 is a lossless music player that supports a wide range of music formats. It can access SD card / U disk / hard disk, can be connected wirelessly via Bluetooth, Airplay, DINA, and can also be connected to a computer as a USB bridge. We hope it could bring you more fun at enjoying music. Now we recommend you read this manual so that you can use all the features of M50 correctly.

Contents list

- M50 × 1
- Remote control × 1
- USB cable × 1
- DC cable × 1
- Bluetooth antenna × 1
- User manual × 1
- Warrantv card × 1

Note: You can download the drivers and user manual on <http://www.topping.audio/>.

Attribute

Measured		11.9cm x 11cm x 3.8cm
Weight		440g
Power input		DC5V/1A (DCbase 5.5*2.1)
Signal input		USB-OTG • 2, USB OAC- TF card slot, Bluetooth, WiFi
Signal output		Bluetooth, USB-OTG. Optical. Coaxial. IIS
Standby power consumption		<0.5W
Power consumption		<1.5W
TF card capacity		up to 256 GB
USB	Hard disk driver	up to 4 TB
	Filesystem	Support FAT/FAT32/NTFS
Bluetooth	Input preference	LDAC > AAC > SBC
	Output : preference order	LDAC > APTX > AAC > SBC

Front panel

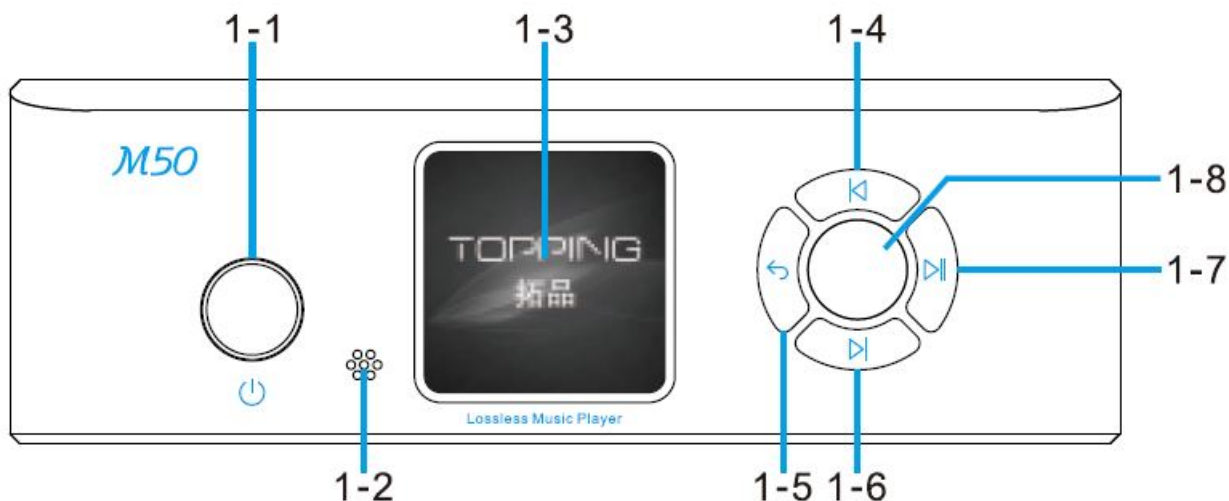

1. Power button

Press and hold to power on/off. In the on state, a short press turns the screen off.

You can press any button on the front panel to light up the screen.

2. Remote control receiver

Please point the top of the remote control at it when using the remote control

3. Display

4. Previous*

- In playback interface, short press to play previous track, press and hold to rewind
- In other interfaces, short press to move to previous item, press and hold to move quickly.

5. Back

Short press to move to the previous menu, press and hold to go back to the main menu.

6. Next*

- In playback interface, short press to play next track, press and hold to fast forward
- In other interfaces, short press to move to next item, press and hold to move quickly.

7. OK/Play/Pause*

In playback interface, short press to play/pause

- In other interfaces, short press to make a selection

8. Playback menu*

Press to enter the playback menu when in playback interface

*Depending on the input, some buttons may be disabled under the playing interface.

Rear panel

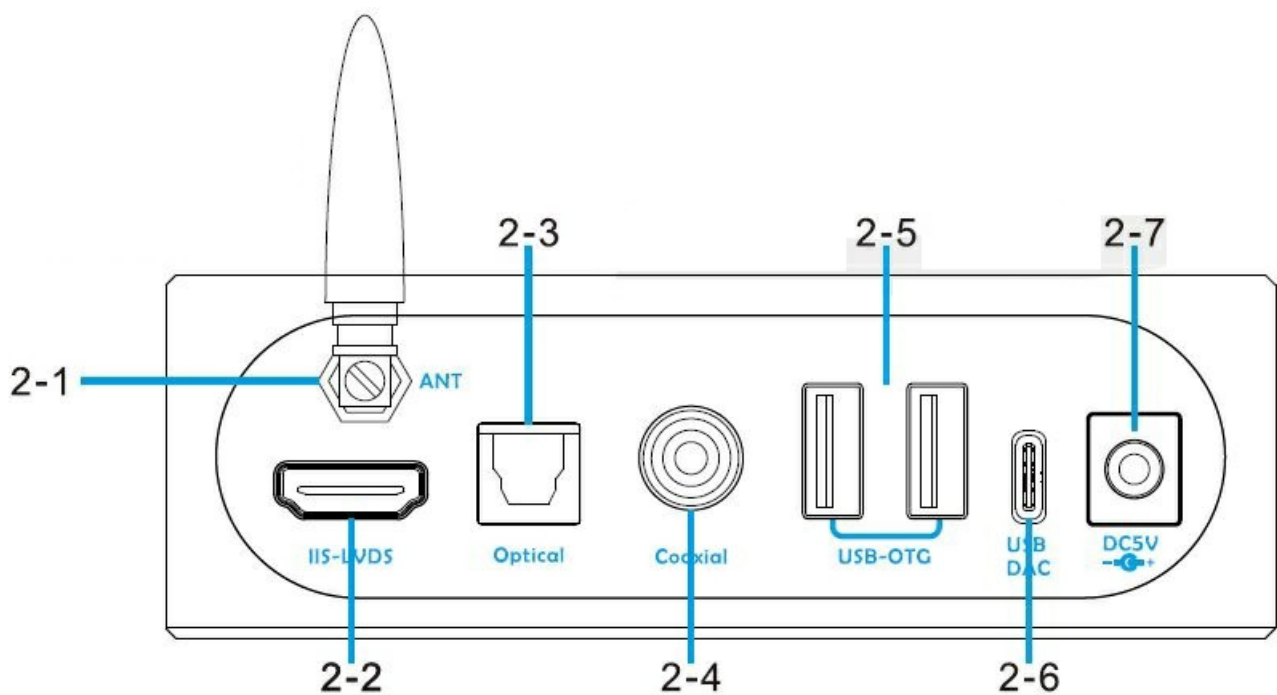

1. Bluetooth input/output
2. IIS output
3. Optical SPDIF output
4. Coaxial SPDIF output
5. USB-OTG port
 - Can connect a USB storage device or HDD (hard disk driver) to play music files.
 - Can output to the USB DAC. Note that only one USB DAC can be connected at the same time.
6. USB DAC port
 - In DAC mode, the M50 can be connected to a computer and used as a USB Bridge.
 - In USB mode, you can access the TF card inserted in the M50 on your computer.

Set it here: [Main Interface – System Settings – USB Mode]
7. Power input (DC5V)

Side panel

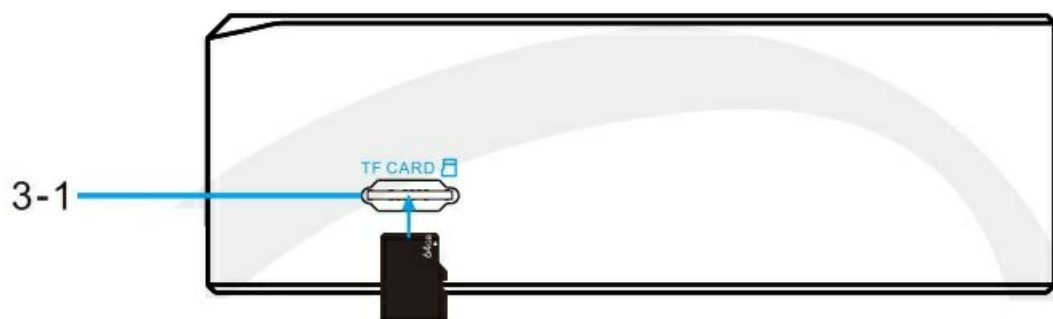

TF card slot

- This slot is only for the standard TF card(Micro SD) and support a capacity up to 256GB.
- Insert: insert a TF card until it clicks into place. Make sure to insert the TF card in the correct direction.
- Remove: push the TF card into the TF card slot. The TF card will pop out.

Remote control

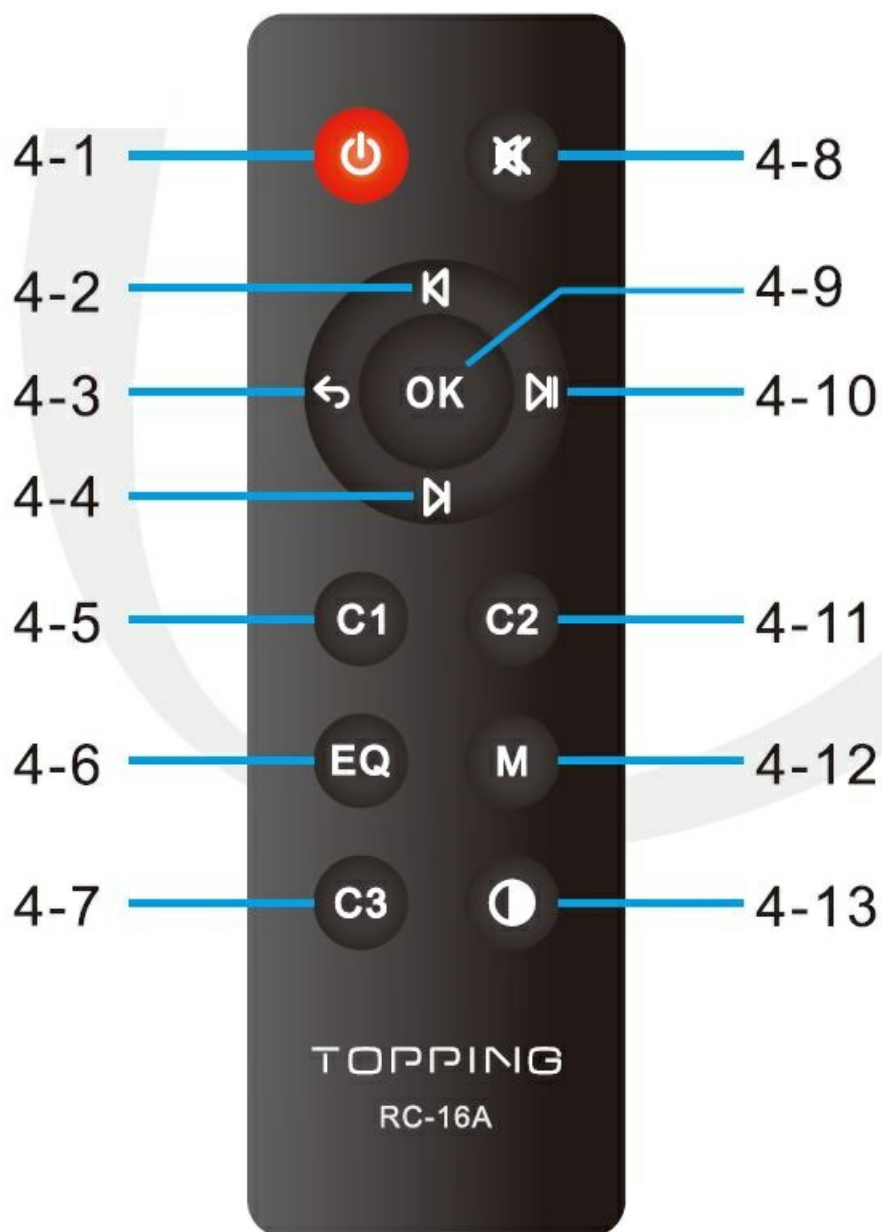

1. Standby
2. Previous*
3. Back
4. Next*
5. Invalid button
6. Equalizer setup
7. Invalid button
8. Invalid button
9. OK
10. Play/Pause
11. Invalid button
12. Playback menu*
13. Brightness

Depending on the input, some buttons may be disabled under the playing interface.

Support range

Supported Audio Formats	APE	Fast	8kHz-384 kHz / 16 bit-24 bit (CUE supported)
		Normal	8kHz-384 kHz / 16 bit-24bit (CUE supported)
		High	8kHz-384kHz/16bit-24bit
		Extra high	8kHz-96kHz/16bit-24bit
	WAV		6kHz-384kHz/16bit-32bit(CUEsupport,ed□TSnot supported)
	FLAG		8kHz-384 kHz/16b i t-24bit (CUE supported)
	AIFF		8kHz -38 4kHz / 16b it-32bil
	M4A		8kH z-384 kHz/ 16b it- 24bi t
	WMA		8kHz -96kHz / 16bi t-24bit
	WMA Lossless		8kHz -96kHz / 16bi t-24bit
	Mp2		8kHz- 48kH z/16bi t
	Mp3		8kHz- 48kH z/16bit (CUE suppo rted)
	AAC		8kHz-48k Hz/ 16bit
	OGG		8kHz- 48kH z l 16bit
	DSF		DSD64-DSD256
	DFF		DSD64-DSD256
	*Above all 64k files do not support		
USB DAC IN			PCM 44.1kHz-384kHz/16bit-32bit
			□So OS064-0SD256 (Native) , DSD64-DS0126 (Dop)
USB-OTG OUT			PCM 44 .1kHz – 384kHz /16b it- 32 bit
			DSD OSD64-DSD256 (Native) . DSD64-DSD256 (Dop)
BT IN			SBC/AAC/LDAC
BT OUT			SBC/AAC/APTX/LDAC
OPT /COAX OUT			PCM 44 .1kHz-192kHz/16b it-24b it
			DSD DS D64 (Dop)
IIS OUT			PCM 44.1kHz-384kHz/16bit-32bit
			DSD DSD64-DSD256 (NaHve)

Playback

Bluetooth

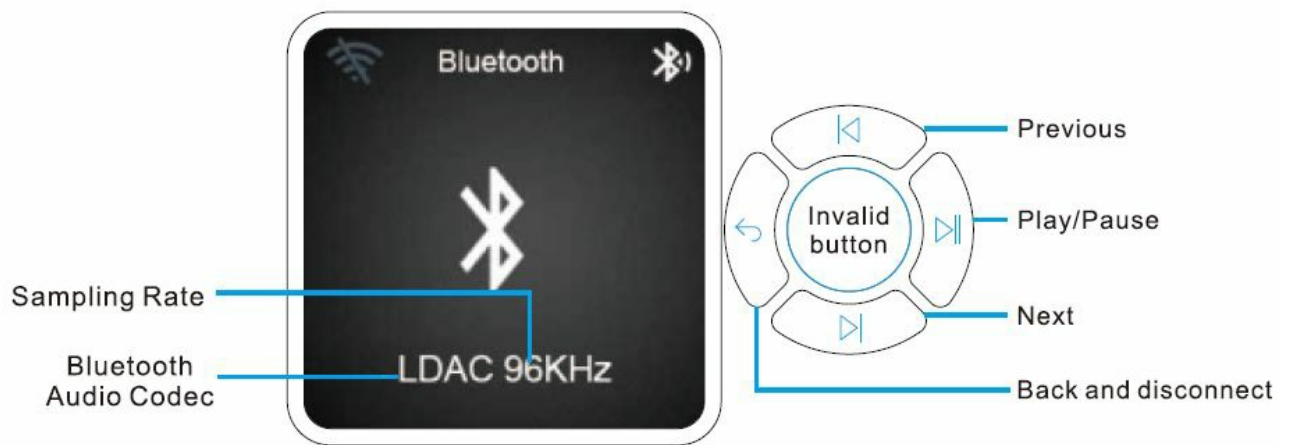

- In [Main Interface – NET settings – Bluetooth setting], turn on and connect the Bluetooth
- **Note** the Hiby link function in [Bluetooth setting] needs to be turned off first, because using Hiby link function needs to occupy Bluetooth.
- The picture above shows the playback interface when the M50 is used as a Bluetooth receiver. the M50 can also be used as a Bluetooth transmitter to connect to a Bluetooth DAC or Bluetooth headphone.





USB Storage Device/HDD/TF card

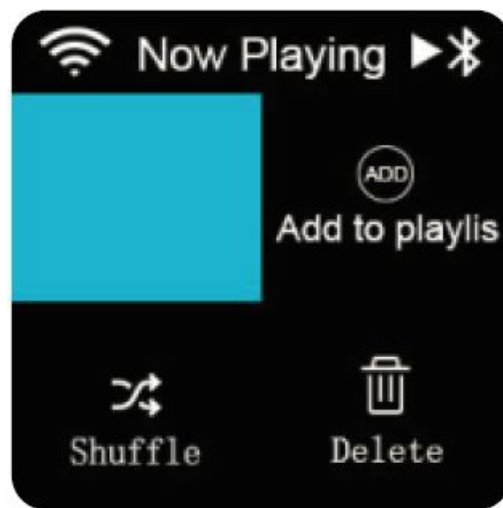

- Plug your USB storage device/HDD into the USB-OTG port or insert the TF card into the TF card slot. Folders and music files are displayed on [Main Interface – Music Browser] when loading is complete. Then you could select songs to play.
- Playback menu
- You can add this song to My Favorite/Playlist, or delete it, and you can also set the Playback Mode.



Playback Mode

-  List loop
-  Order
-  Single cycle
-  Shuffle

Connect to PC and use as USB Bridge

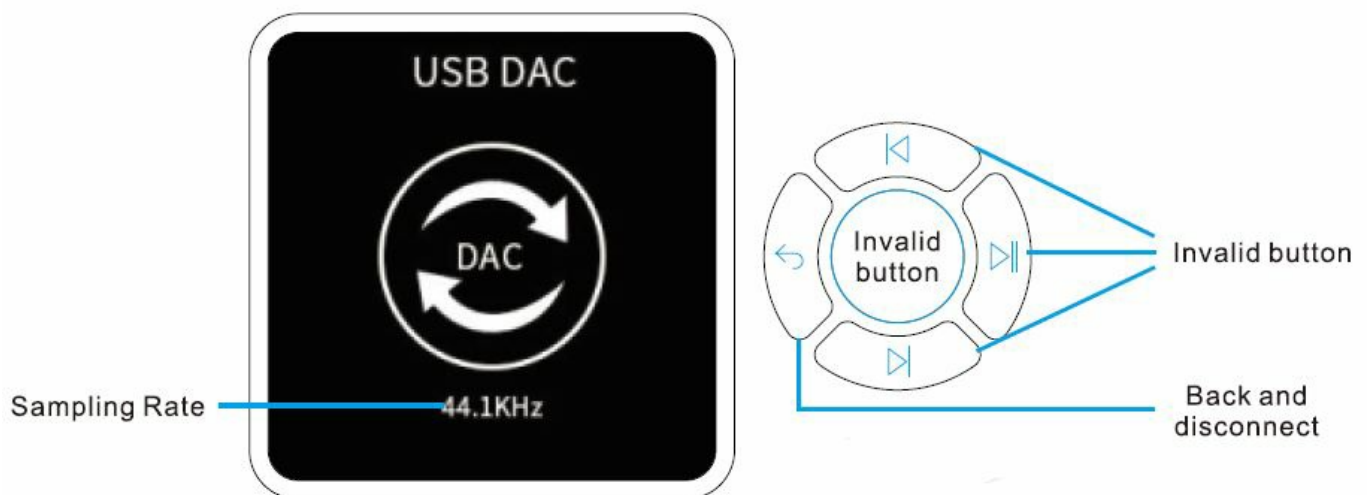

- In [Main Interface – System Settings – USB Mode], set the USB mode of the M50 to “DAC” and connect to the computer via the USB DAC port.
- Only able to control previous/next/play/pause on the computer.

Airplay/DLNA

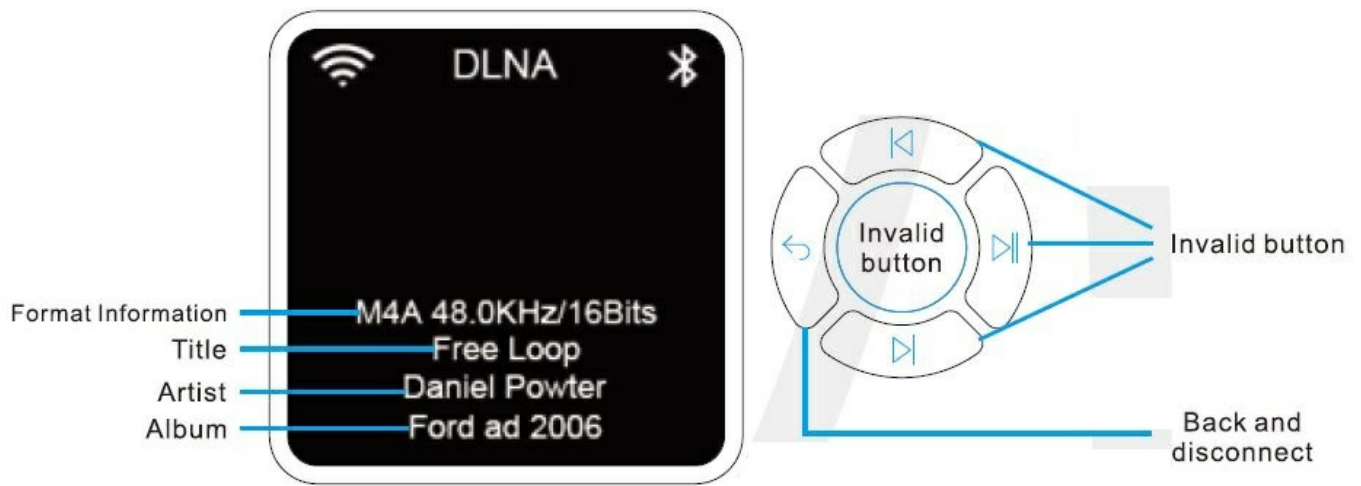

1. In [Main Interface – NET Settings – WiFi Setting], turn WiFi on and connect.
2. Turn on the Airplay or DNA function in [WiFi Setting] according to your usage needs.
3. Connect the Mobile Phone/Tablet to the same network as M50.
4. Tap the AirPlay icon on the iOS device, and select M50 from the displayed devices. For Android devices, open the app that supports DNA playback and select M50 as the receiving device.
5. Play the music file on the Mobile Phone/Tablet.

Note: Only able to control previous/next/play/pause on mobile phone.

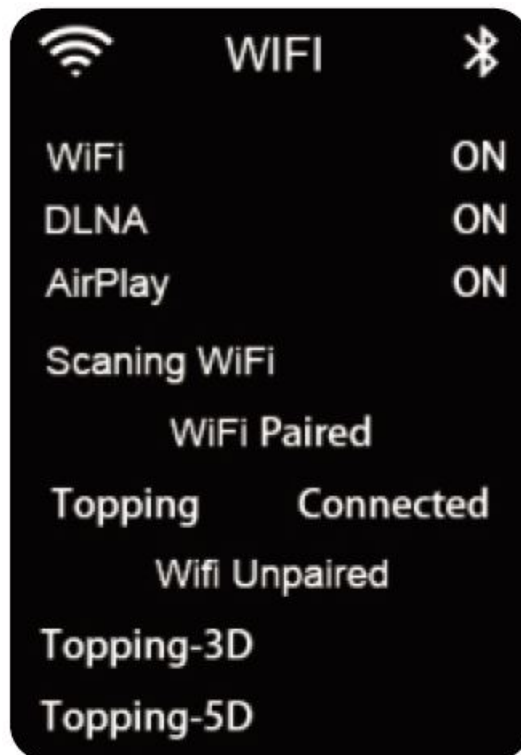

Output

	BT OUT	USB-O TG OUT	SP DIF/IIS OUT
BT IN	✗	✓	✓
USB Storage Device/HDD/TF card I N	✓	✓	✓
USB DAC	✓	✗	✓
Airplay /DLNA	✓	✓	✓

- Output priority: Bluetooth > IIS > USB-OTG > SPDIF
- SPDIF output or IIS output can be selected through [Main Interface – Play Settings – Output Mode]. If you need to use USB-OTG output, please do not set it to IIS output.

Operation

- Hiby Link [Main Interface – NET Settings – Bluetooth Setting – Hiby Link]
- Install the HiByMusic app on your Android or iOS smartphone and you can control the M50 from afar using Bluetooth, for browsing, playing, skipping tracks, etc.
- EQ Setting [Main Interface – Play Settings – EQ]
- Press the “Previous” or “Next” button to switch the EQ mode:
- Off/Custom/Heavy/metal/Blues/Vocal/Dance/Pop/Jazz/Classic/Rock
- If chose the custom mode, press the OK button to enter the custom setting, then
- press the “Back” or “Play Menu” button to switch the frequency, press the “Previous” or “Next” button to change the boost. Finally, press the OK button to save the settings.
- Firmware Update [Main Interface – System Settings – Firmware Update] Download the firmware to the TF card, and then select this option to upgrade the firmware.
- IIS Settings [Main Interface – Play Settings – IIS Phase/IIS DSDR/DSD Flag] IIS Phase: STD / REV

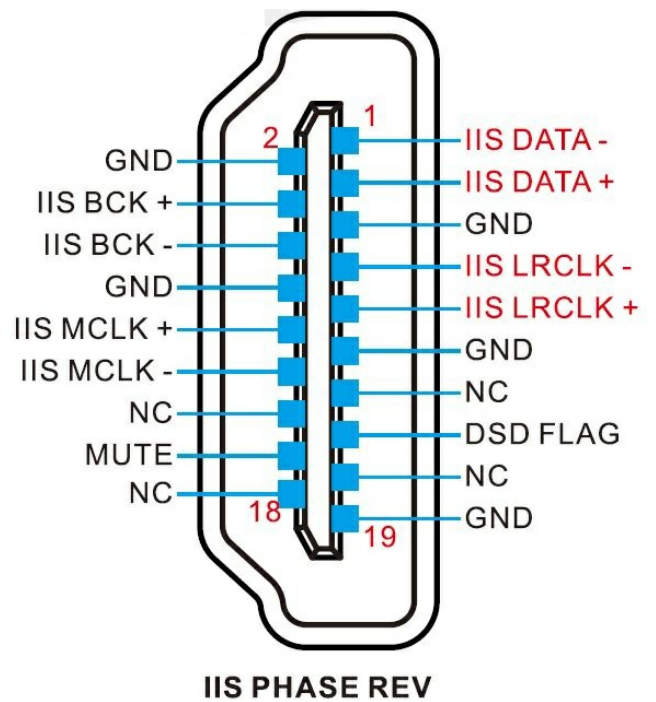
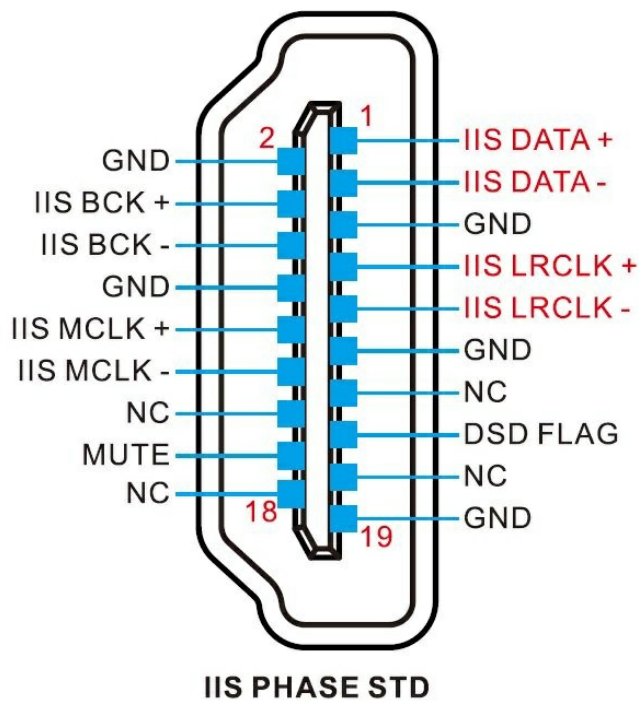

IIS DSDR: LRCLK/ DATA

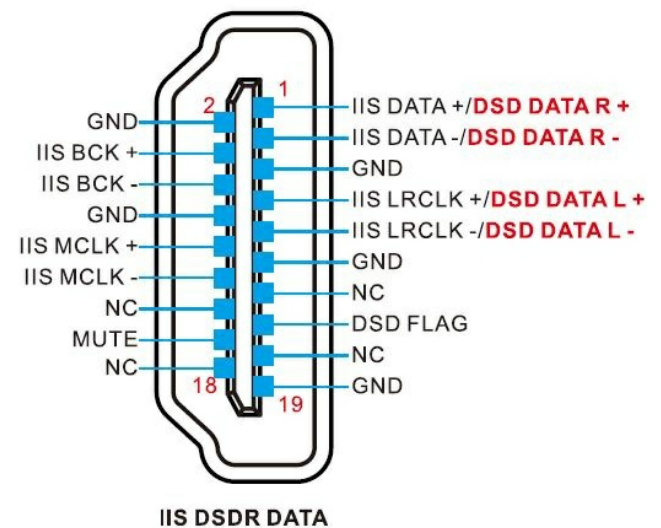
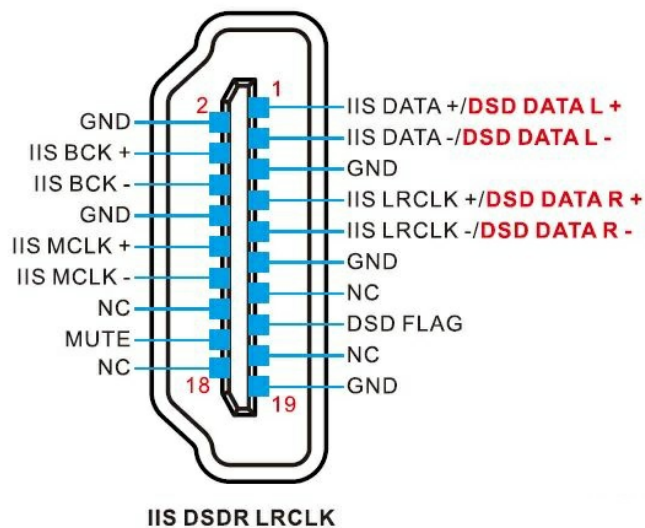

DSD Flag: Pin15 / Pin14

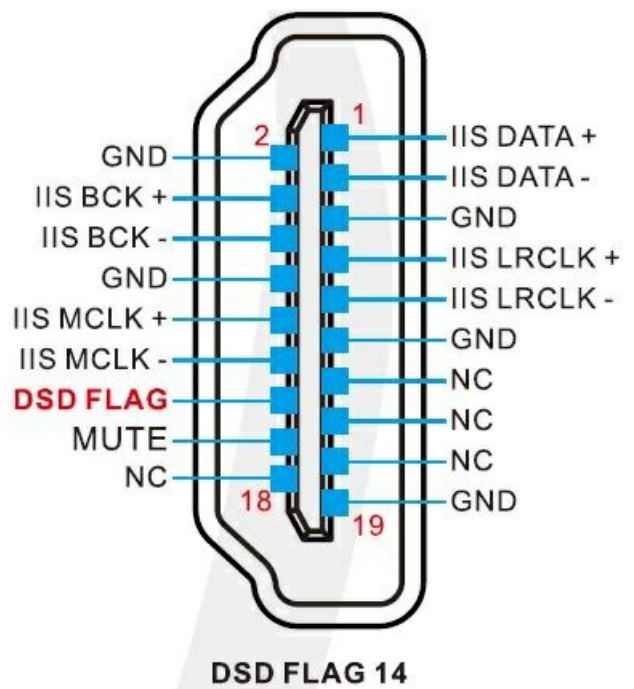
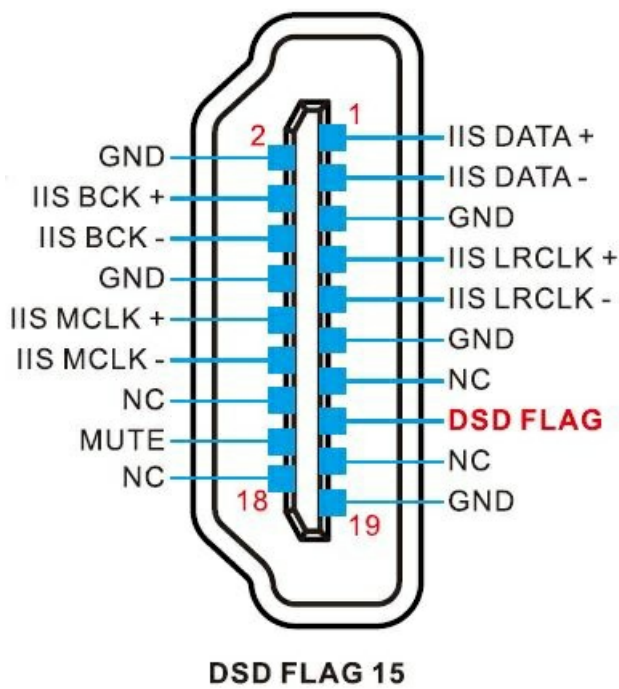

Bluetooth Input

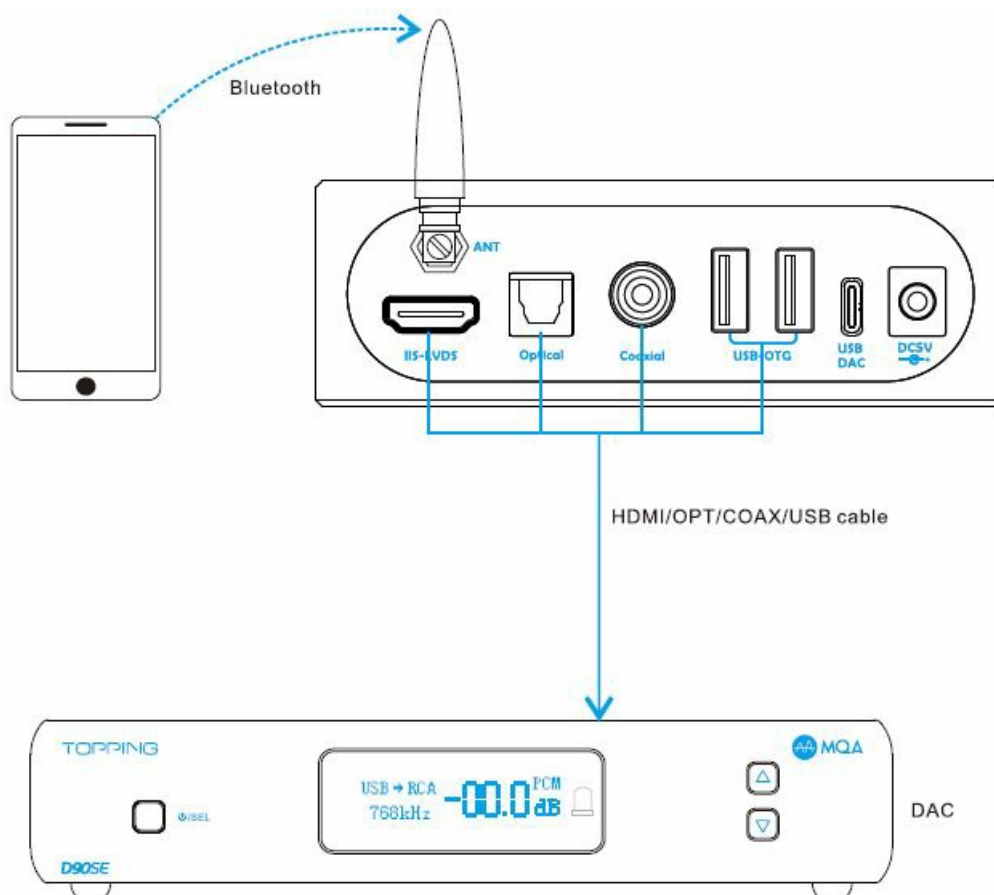

USB Storage Device/HDD/TF card

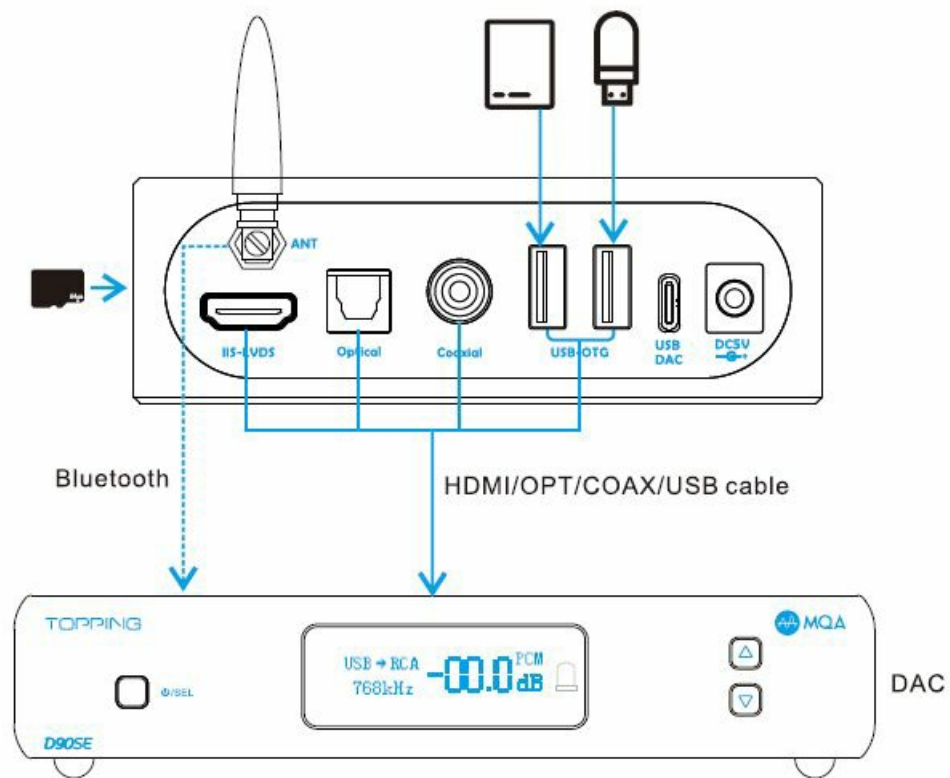

Connect to PC and use as USB Bridge

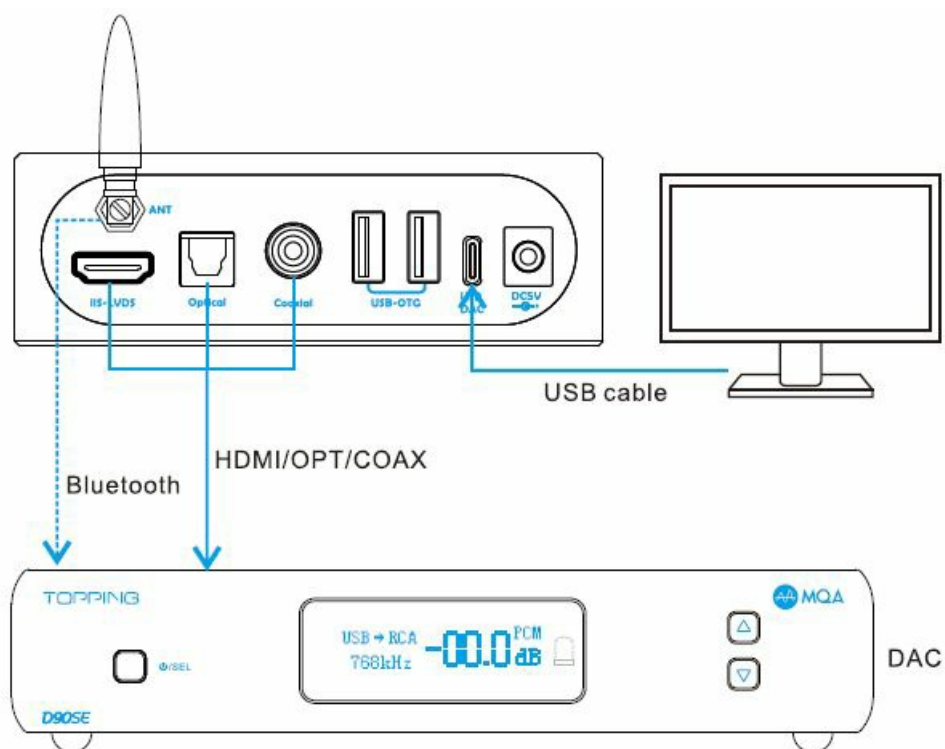

Airplay/DLNA

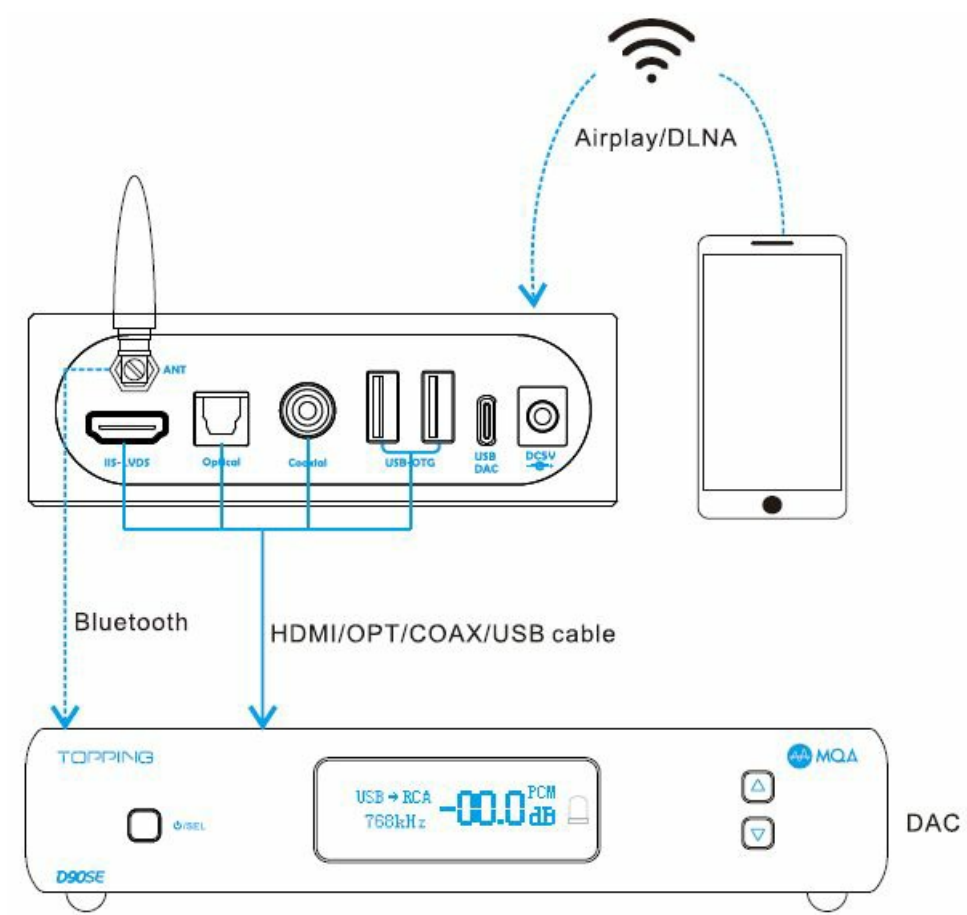

Bluetooth Output

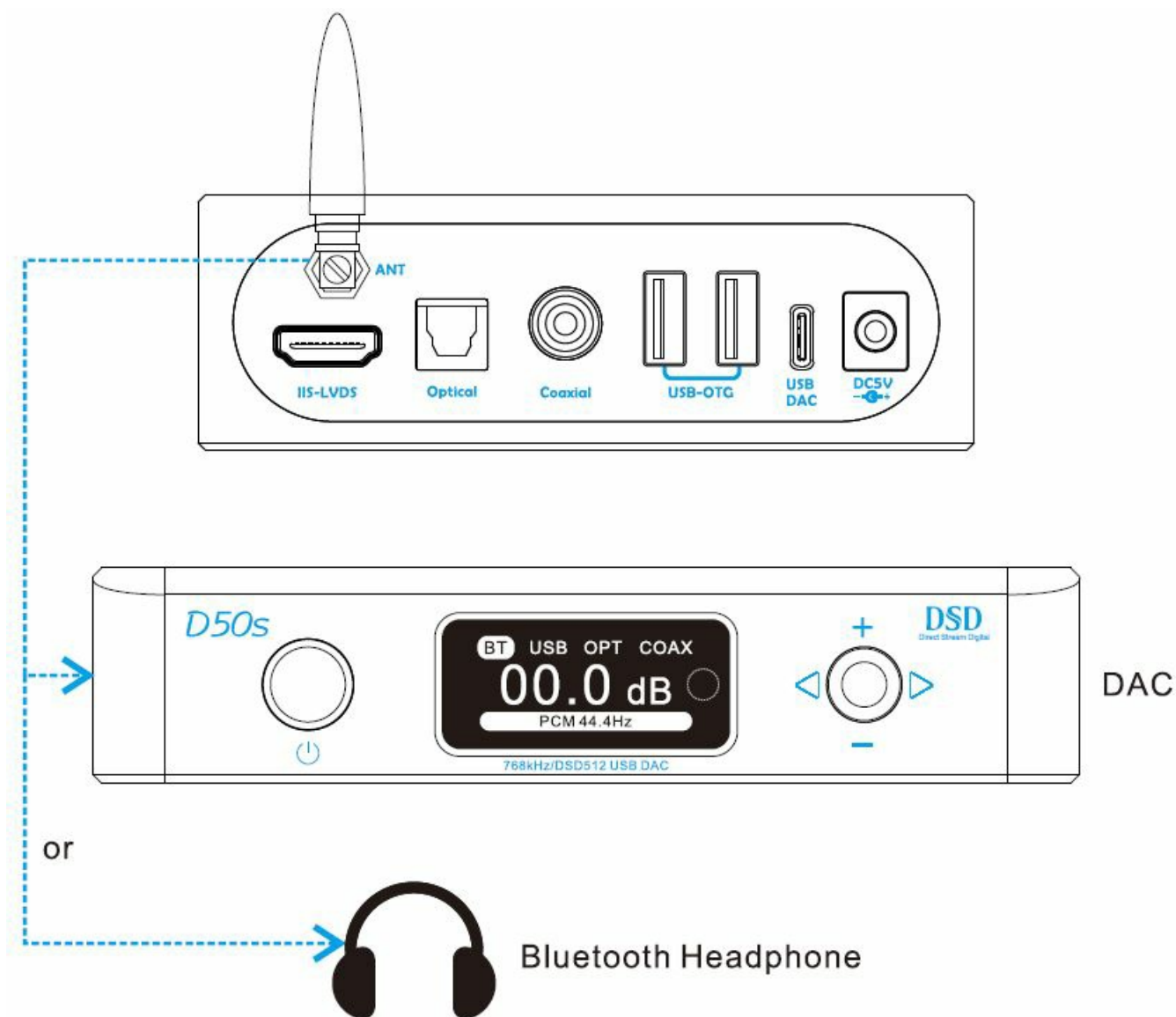

USB-OTG Output

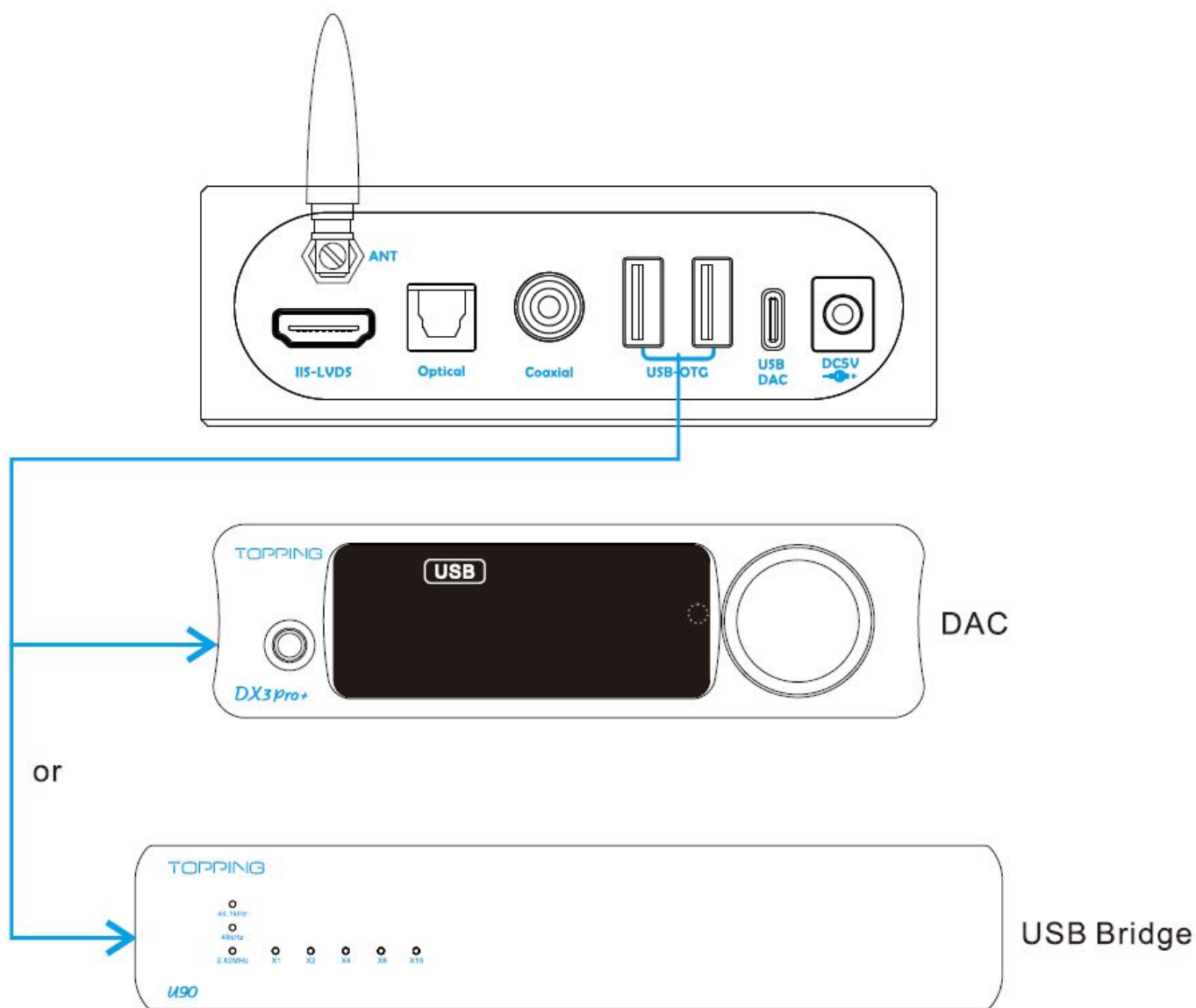

SPDIF/IIS Output

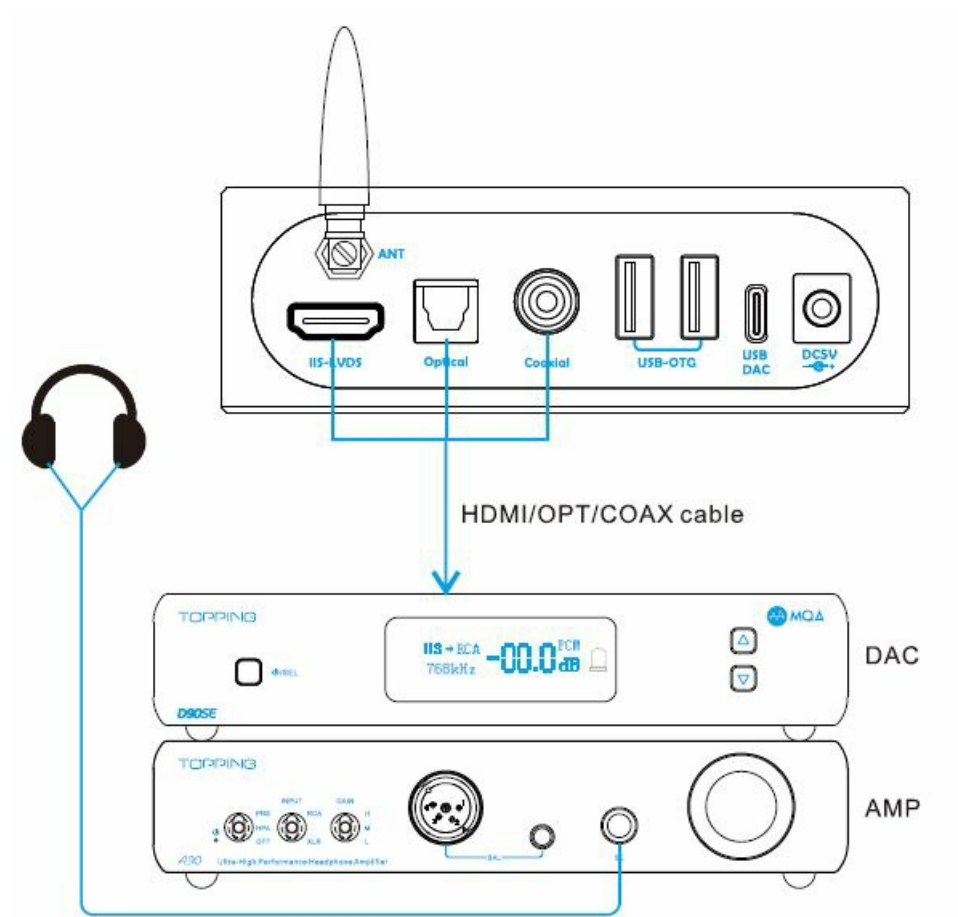

Documents / Resources

	<p>TOPPING M50 Digital Network Player File Reader [pdf] User Guide M50 Digital Network Player File Reader, M50, Digital Network Player File Reader, Network Player File Reader, Player File Reader, File Reader</p>
---	--