



TOPDON AL500B Scanner Battery Tester 2 in 1 Code Reader User Guide

[Home](#) » [TOPDON](#) » TOPDON AL500B Scanner Battery Tester 2 in 1 Code Reader User Guide 

Contents

- [1 TOPDON AL500B Scanner Battery Tester 2 in 1 Code Reader](#)
- [2 Product Description](#)
- [3 SET UP THE SCAN TOOL FOR OBD-11 TEST](#)
- [4 SET UP THE SCAN TOOL FOR BATTERY TEST](#)
- [5 Documents / Resources](#)
 - [5.1 References](#)
- [6 Related Posts](#)

TOPDON®

TOPDON AL500B Scanner Battery Tester 2 in 1 Code Reader



Thanks for purchasing the TOPDON ALSOOB. This quick user guide will walk you through the basic set up and

operation of ALSOOB, so please carefully read all the instructions and warnings.



For multilingual user manuals, please scan the QR code.

TOPDON is always committed to be environmental friendly, so the user manual comes along with the tool is only in English.

FOR OTHER 6 Languages, PLEASE CLICK THE LINK www.topdon.com/products/artilink500b, WHICH WILL DIRECTLY LEAD YOU TO THE DOWNLOADING PAGE, OR YOU CAN SCAN THE QR CODE ABOVE TO DOWNLOAD THE USER MANUAL. We apologize for the inconvenience.

Product Description

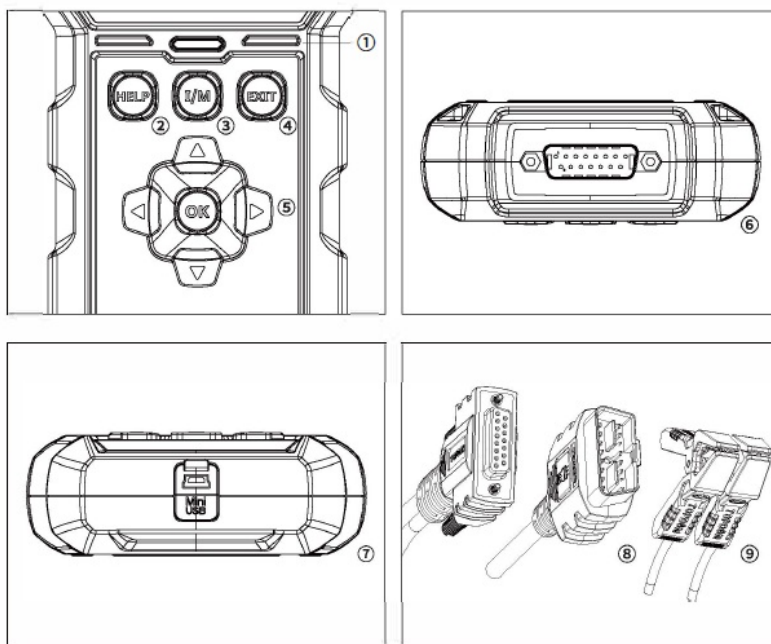

1. 3-Color Indicator
2. Help Shortcut Button
3. I/M Readiness Shortcut Button
4. Exit Button
5. Arrow Keys & OK Button
6. DBIS Male Connector
7. Mini-USB Port
8. Diagnostic Cable with DBIS Female Connector & 16-pin OBD-II Port
9. Diagnostic Cable with DBIS Female Connector & 16-pin OBD-II Port

9. Battery Clamps

SET UP THE SCAN TOOL FOR OBD-11 TEST

1. Turn the ignition off or to the position of LOCK (0).

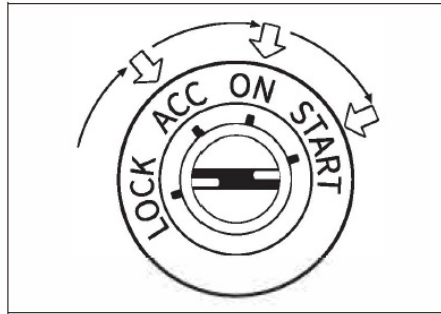

2. Locate the vehicle's DLC.

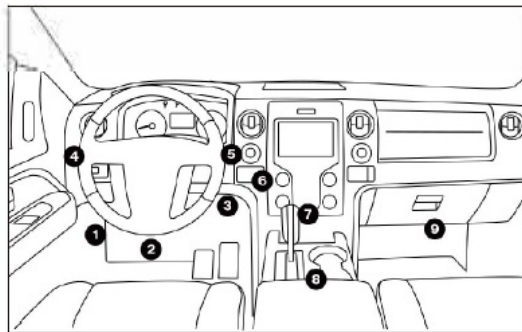

3. Connect the scan tool to the DLC.
4. Turn the ignition to the position of ON (II).
5. When the scan tool is properly connected to the DLC, the units will start initializing and present you with the main menu interface.

SET UP THE SCAN TOOL FOR BATTERY TEST

1. Locate the battery on your vehicle.

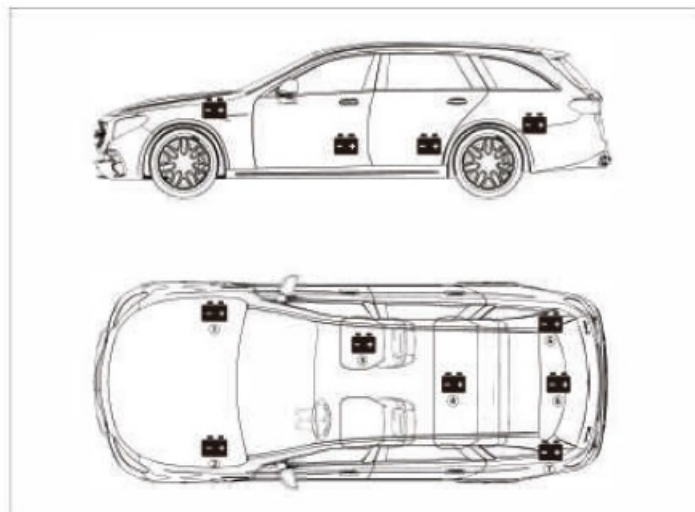

2. Turn the ignition off to the position of LOCK (0).
3. Attach the battery clamps to the battery terminals, red to +, black to -.
4. Turn the ignition to the position of ON (II).
5. Confirm the battery type, CCA, standards and other key values for testing.
6. Once the info is confirmed, you can conduct the test.

Documents / Resources



[TOPDON AL500B Scanner Battery Tester 2 in 1 Code Reader](#) [pdf] User Guide
AL500B Scanner Battery Tester 2 in 1 Code Reader, AL500B, Scanner Battery Tester 2 in 1 Code Reader, Battery Tester 2 in 1 Code Reader, Code Reader, Reader

References

- [User Manual](#)