



# TOP ICON MDT765 Mobile Data Terminal User Guide

[Home](#) » [TOP ICON](#) » TOP ICON MDT765 Mobile Data Terminal User Guide 



**Mobile Data Terminal  
MDT765**

## Contents

- [1 Interface](#)
- [2 Parameters](#)
- [3 TF/SIM card](#)
- [4 Notices & Warnings](#)
- [5 Documents / Resources](#)
  - [5.1 References](#)

## Interface

There are RS232 interfaces and OTG from cradle.

Highlight: OTG port from device (10pin usb connector) and cradle are sharing same pins. Only 1 OTG interface can be used.

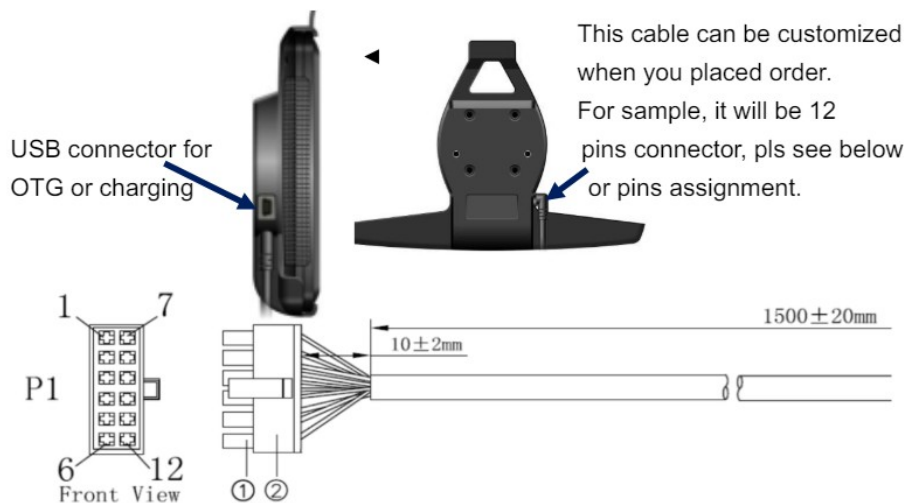

Pin 1 – NOT connected –

Pin 2 — GND (black) –

Pin 3 — RXD (White) .

Pin 4 — CTS in MDT720, NC in MDT750/MDT740 (yellow) –

Pin 5 — RTS in MDT720, NC in MDT750/MDT740 (Orange) .

Pin 6 — Ignition (Green), it can wake up device in sleep mode. See the software section for more details.

Pin 7 =Don't connect pls –

Pin 8 = NOT connected –

Pin 9 = cable shielding –

Pin 10 = TXD (purple) –

Pin 11 = car battery input (12-28V) (Red) –

Pin 12 — NOT connected.

To learn more about installations & start guides or more services, pls contact us: [sales@topicon.hk](mailto:sales@topicon.hk) or follow us on YouTube channel "Topicon HK Ltd".

## Parameters



Processor	Quad-core 2GHz	
Storage	ROM (SLC/MLC) 32G NAND flash RAM (DDR) 4GB DDR4 Extend Slot.: microSD (TF), do 128G	
Camera	Rear: 16Mpixel autofocus camera	
Screen	1280×800; capacitive touch	
Network	2G/3G/4G	
WIFI	802.11 b/g/n	
Bluetooth	V2.1 & V4.0	
Lora	Optional	
NFC	Supported	
GPS	GNSS/ Glonass/ Galileo	•
Power	USB: MiniUSB / Pogo Pins with adapter: 12 – 24V	•
Camera Input	1 x analog, 1 x 720P, 1 x AHD camera	•
Battery	4300mAh	•
OS	Android (12)	

## TF/SIM card

- Insert the SIM card with the gold contacts facing up.
- Insert the Micro SD card with gold contacts facing up.
- Push the card in the direction of the arrow as shown
- in the figure.
- SIM card/SD card cover can be locked by screws in preventing from loss or steal.



## Notices & Warnings

PLEASE CHARGE AND DISCHARGE THE DEVICE AS ONE CYCLE AT ROOM TEMPERATATURE WHEN DEVICES ARE STORED FOR HALF YEAR OR ABOVE.

## Customization Services

Topicon's device management server is developed to allow customer to update different firmware and make kiosk mode function:

- BOOT ANIMATION
- INSTALL APK
- ADD APN
- **DEFAULT SETTING**

## **EU Declaration of Conformity for RED Directive and RoHS Directive**

We,  
TOPICON HK LIMITED

---

hereby, declare that the essential requirements set out in the RED Directive 2014/53/EU, RoHS Directive 2011/65/EU and its amendment (EU) No 2015/863. have been fully fulfilled on our product with indication below:

Product Name: Tablet

Brand Name: /

Model No.: MDT765,MDT760, MDT761, OBC760, OBC765, MDT785, M710A, M710B, M720A, M720B, MDT714D, MDT715D, MDT716D, M725A, M725B, 100861, LAR-1192, LARDIS\_H4L

The following standards have been applied for the investigation of compliance:

ETSI EN 301 511 V12.5.1 (2017-03)

ETSI EN 301 908-1 V15.2.1 (2023-01)

ETSI EN 301 908-2 V13.1.1 (2020-06)

ETSI EN 301 908-13 V13.2.1 (2022-02)

ETSI EN 300 328 V2.2.2 (2019-07)

ETSI EN 300 220-1 V3.1.1 (2017-02)

ETSI EN 300 220-2 V3.2.1 (2018-06)

ETSI EN 300 330 V2.1.1 (2017-02)

ETSI EN 303 413 V1.2.1 (2021-04)

ETSI EN 301 489-1 V2.2.3 (2019-11)

ETSI EN 301 489-3 V2.3.2 (2023-01)

ETSI EN 301 489-17 V3.2.4 (2020-09)

ETSI EN 301 489-19 V2.2.1 (2022-09)

ETSI EN 301 489-52 V1.2.1 (2021-11)

EN 50663:2017

EN 62209-2:2010+AMD1:2019

EN 50566:2017

EN IEC 62368-1:2020+A11:2020

Furthermore, the ISO requirement for the in-process quality control procedure as

### **Attention**

The tablet and battery should not be thrown into a fire and should not be used in places where the temperature exceeds the specified values. It may cause a fire or explosion of the battery. In addition, it will cause a leakage and will greatly reduce the functionality or the tablet cannot be used anymore. If you are charging the battery or using a tablet and you realize that the case temperature is unusually high because the battery has overheated, close applications. Do not charge the battery continuously for more than 24 hours. Ignoring these precautions could void your warranty.

Please charge and discharge the device in one cycle at room temperature if the device is stored for half a year or more.

Do not try to repair, adapt or disassemble the device without proper knowledge and precautions, as this may lead to dangerous situations with possible damage to the product.

Do not use in extreme conditions such as high and low temperatures, high humidity or humid environments and near magnetic fields.

Avoid prolonged exposure to sunlight. Use only accessories authorized by the manufacturer to avoid damage to the product and possible loss of warranty.

well as the manufacturing process has been reached. The technical document as well as the test reports will be kept for a period at least 10 years after the last product has been manufactured at the disposal of the relevant national authorities of any Member State for inspection.

Detail contact information for this declaration has been listed below as the window of any issues relevant for this declaration.

Manufacturer Contact

Company: TOPICON HK LIMITED

Address: Room 2314-2316, Tower C, Huangdu Plaza, Yitian Road, Futian District, Shenzhen, China

Name & Title: Keller Sin/Sales Director

Tel No.: (86) 755-82549331

Fax No.: (86) 755-82549331

E-mail: [keller.sin@topicon.hk](mailto:keller.sin@topicon.hk)

For and on behalf of  
Topicon (HK) Limited  
Authorized Signature(s)

Signature

Date 2024/5/9

IEC 62321-3-1:2013, IEC 62321-4:2017, IEC 62321-5:2013, IEC 62321-7-1:2015, IEC 62321-7-2:2017, IEC 62321-6:2015, IEC 62321-8:2017

And apply notified body assessment:

Notified Body number 1177

Timco Engineering, Inc.

13146 NW 86th Drive Suite 400 Alachua, FL 32615, America

Software Version:	mdt765_ngms_2.0.4
Hardware Version:	MDT765_V20
System Components	
Component 1	Lithium-ion Polymer battery Model: 954108; 3.7V, 4300mAh Shenzhen Guangwei Electronic Technology Co., Ltd.
Optional Components	
Optional 1	Adapter MODEL:GS-0500200 Input: AC100-240V 50/60Hz 0.3A max Output:DC5V,2A Shenzhen GOOD-SHE technology Co., Ltd
Optional 2	DC Cable (1.0m, Shielded, With Ferrite) TOPICON HK LIMITED
Optional 3	Type-C Cable(1.5m, Unshielded, Without Ferrite) TOPICON HK LIMITED
Optional 4	Camera Model: 700SN-RV1A Input: 12VDC 200mA Zhongshan YiHongDa Technology Co.,LTD
Optional 5	Cradle Model: CRD760, CRD860 Input: 12V-24V, 2A Output: 5V, 2A Topicon HK Limited
Optional 6	Camera Hub Model: HH420 Input: 12V-24V Topicon HK Limited

Frequency Range:	FDD-LTE Band 1: Tx: 1920-1980MHz, Rx: 2110-2170MHz
	FDD-LTE Band 3: Tx: 1710-1785MHz, Rx: 1805-1880MHz
	FDD-LTE Band 7: Tx: 2500-2570MHz, Rx: 2620-2690MHz
	FDD-LTE Band 8: Tx: 880-915MHz, Rx: 925-960MHz
	FDD-LTE Band 20: Tx: 832-862MHz, Rx: 791-821MHz
	FDD-LTE Band 28: Tx: 703-748MHz, Rx: 758-803MHz
	TDD-LTE Band 38: Tx: 2570-2620MHz, Rx: 2570-2620MHz
	TDD-LTE Band 40: Tx: 2300-2400MHz, Rx: 2300-2400MHz
Max.RF Output Power:	FDD-LTE Band 1: 23.14dBm, FDD-LTE Band 3: 24.40dBm, FDD-LTE Band 7: 22.77dBm, FDD-LTE Band 8: 23.81dBm, FDD-LTE Band 20: 23.83dBm, FDD-LTE B and 28: 24.10dBm, TDD-LTE Band 38: 23.28dBm, TDD-LTE Band 40: 23.40dBm
Modulation Type:	QPSK, 16QAM
Antenna Type:	FPC Antenna
Antenna Gain:	FDD-LTE Band 1: 0.6dBi, FDD-LTE Band 3: 0.3dBi, FDD-LTE Band 7: 1.3dBi, FDD-LTE Band 8: -2.2dBi, FDD-LTE Band 20: -1.8dBi, FDD-LTE Band 28: -3.4dBi, TDD-LTE Band 38: 1.3dBi, TDD-LTE Band 40: 1.1dBi,
<b>NFC</b>	
Frequency Range:	13.56MHz
Radiated H-Field:	12.67dBuA/m(@3m)
Modulation:	ASK
Type of Antenna:	FPC Antenna
Antenna Gain:	0dBi
<b>GPS</b>	
Frequency Range:	1575.42MHz

<b>Model No:</b> MDT765	
<b>Technical Characteristics of EUT</b>	
<b>2G</b>	
Support Networks:	GSM, GPRS, EDGE
Support Bands:	GSM900, DCS1800
Frequency Range:	GSM900: Tx: 880-915MHz, Rx: 925-960MHz
	DCS1800: Tx: 1710-1785MHz, Rx: 1805-1880MHz
RF Output Power:	GSM900: 32.58dBm, GSM1800: 30.10dBm EDGE900: 27.57dBm, EDGE1800: 24.96dBm
Modulation Type:	GMSK, 8PSK
Type of Antenna:	FPC Antenna
Antenna Gain:	GSM900: -1.8dBi, DCS1800:0.3dBi
GPRS/EDGE Class:	Class 12
<b>3G</b>	
Support Networks:	WCDMA, HSDPA, HSUPA
Support Bands:	WCDMA Band 1, WCDMA Band 8
Frequency Range:	WCDMA Band 1: Tx: 1920-1980MHz, Rx: 2110-2170MHz
	WCDMA Band 8: Tx: 880-915MHz, Rx: 925-960MHz
RF Output Power:	WCDMA Band 1: 22.59dBm, WCDMA Band 8: 23.26dBm
Modulation Type:	BPSK, QPSK, 16QAM
Antenna Type:	FPC Antenna
Antenna Gain:	WCDMA Band 1: 0.6dBi, WCDMA Band 8: -2.2dBi
<b>4G</b>	
Support Bands:	FDD-LTE Band1, 3, 7, 8, 20, 28, TDD-LTE Band 38, 40

### FCC RF Exposure Information and Statement

This device meets the government's requirements for exposure to radio waves. The guidelines are based on standards that were developed by independent scientific organizations through periodic and thorough evaluation of scientific studies. The standards include a substantial safety margin designed to assure the safety of all persons regardless of age or health. The SAR limit of USA (FCC) is 1.6 W/kg averaged.

Device types: portable device has also been tested against this SAR limit. SAR information on this and other pad can be viewed on-line at <http://www.fcc.gov/oet/ea/fccid/>.

Please use the device FCC ID number for search.

This device was tested simulation typical 0mm to body.

To maintain compliance with FCC RF exposure requirements, use accessories should maintain a separation distance between the user's bodies mentioned above.

### FCC Warning

This device complies with Part 15 of the FCC Rules.

Operation is subject to the following two conditions:

- (1) This device may not cause harmful interference
- (2) This device must accept any interference received, including interference that may cause undesired operation.

**NOTE 1:** This equipment has been tested and found to comply with the limits for a Class B digital device, pursuant to part 15 of the FCC Rules. These limits are designed to provide reasonable protection against harmful interference in a residential installation. This equipment generates uses and can radiate radio frequency energy and, if not installed and used in accordance with the instructions, may cause harmful interference to radio communications. However, there is no guarantee that interference will not occur in a particular installation. If this equipment does cause harmful interference to radio or television reception, which can be determined by turning the equipment off and on, the user is encouraged to try to correct the interference by one or more of the following measures:

<b>Bluetooth</b>	
Bluetooth Version:	Bluetooth V5.0
Frequency Range:	2402-2480MHz
Max.RF Output Power:	7.15dBm (EIRP)
Type of Modulation:	GFSK, $\pi/4$ DQPSK, 8DPSK
Data Rate:	1Mbps, 2Mbps, 3Mbps
Quantity of Channels	79/40
Channel Separation:	1MHz/2MHz
Type of Antenna:	Chip Antenna
Antenna Gain:	3dBi
<b>Wi-Fi (2.4GHz)</b>	
Support Standards:	802.11b, 802.11g, 802.11n-HT20/40
Frequency Range:	2412-2472MHz for 802.11b/g/n(HT20) 2422-2462MHz for 802.11n(HT40)
Max.RF Output Power:	17.68dBm (EIRP)
Type of Modulation:	CCK, OFDM, QPSK, BPSK, 16QAM, 64QAM
Quantity of Channels	13 for 802.11b/g/n(HT20), 9 for 802.11n(HT40)
Channel Separation:	5MHz
Type of Antenna:	Chip Antenna
Antenna Gain:	3dBi
<b>Lora</b>	
Frequency Range:	868.00MHz-868.6MHz 869.4MHz-869.650MHz
RF Output Power:	13.73dBm(ERP)
Type of Modulation:	/
Type of Antenna:	FPC Antenna
Antenna Gain:	2dBi
Receiver Categories:	2



## RF Exposure Statement

For body worn operation, this device has been tested and meets the IC RF exposure guidelines when used with an accessory designated for this product or when used with an accessory that contains no metal and that positions the handset a minimum of 0mm from the body. Noncompliance with the above restrictions may result in violation of RF exposure guidelines.

## IC WARNING

This device contains licence-exempt transmitter(s) that comply with Innovation, Science and Economic Development Canada's licence-exempt RSS(s).

Operation is subject to the following two conditions:

1. This device may not cause interference.
  2. This device must accept any interference, including interference that may cause undesired operation of the device.
- Reorient or relocate the receiving antenna.
  - Increase the separation between the equipment and receiver.
  - Connect the equipment into an outlet on a circuit different from that to which the receiver is connected.
  - Consult the dealer or an experienced radio/TV technician for help.

**NOTE 2:** Any changes or modifications to this unit not expressly approved by the party responsible for compliance could void the user's authority to operate the equipment.

**CE** The product shall only be connected to a USB interface of version USB2.0 and that the connection to a power USB is allowed.

Use careful with the earphone maybe possible excessive sound pressure from earphones and headphones can cause hearing loss.



## CAUTION

RISK OF EXPLOSION IF BATTERY IS REPLACED BY AN INCORRECT TYPE.

DISPOSE OF USED BATTERIES ACCORDING TO THE INSTRUCTIONS

This Class B digital apparatus complies with Canadian ICES-003.

Topicon HK Ltd

Rm 2314, Tower C HuangDu Plaza, Yitian Road, Futian District, Shenzhen 518048, CN [www.topicon.hk](http://www.topicon.hk)



## Documents / Resources



[TOP ICON MDT765 Mobile Data Terminal](#) [pdf] User Guide

MDT765 Mobile Data Terminal, MDT765, Mobile Data Terminal, Data Terminal, Terminal

## References

-  [Leading MDT Hardware Solution Provider - TOPICON](#)
-  [Leading MDT Hardware Solution Provider - TOPICON](#)
- [User Manual](#)

## **Manuals+. Privacy Policy**

This website is an independent publication and is neither affiliated with nor endorsed by any of the trademark owners. The "Bluetooth®" word mark and logos are registered trademarks owned by Bluetooth SIG, Inc. The "Wi-Fi®" word mark and logos are registered trademarks owned by the Wi-Fi Alliance. Any use of these marks on this website does not imply any affiliation with or endorsement.