



TOOLCRAFT 2368387 Low-Voltage Float Switch Instruction Manual

[Home](#) » [Toolcraft](#) » TOOLCRAFT 2368387 Low-Voltage Float Switch Instruction Manual 



TOOLCRAFT

**Operating Instructions
Low-Voltage Float Switch
12/24/32 V
Item No. 2368387**

Contents

- [1 Intended use](#)
- [2 Delivery content](#)
- [3 Explanation of symbols](#)
- [4 Safety instructions](#)
- [5 Technical data](#)
- [6 Dimensions](#)
- [7 Wiring](#)
- [8 Installation](#)
- [9 Documents / Resources](#)
 - [9.1 References](#)
- [10 Related Posts](#)

Intended use

The product is a float switch. It switches the pump on when water level reaches 51 mm. Only for use with fresh water or salt water.



NOTE

- The product has an IPX8 ingress protection rating and is suitable for outdoor use.
- The product is sealed and submersible.

For safety and approval purposes, you must not rebuild and/or modify this product. If you use the product for purposes other than those described above, the product may be damaged. In addition, improper use can result in short circuits, fires, or other hazards. Read the instructions carefully and store them in a safe place. Make this product available to third parties only together with its operating instructions. This product complies with the statutory national and European requirements. All company names and product names are trademarks of their respective owners. All rights reserved.

Delivery content

- Product
- Operating instructions

Explanation of symbols



The symbol with the exclamation mark in the triangle is used to indicate important information in these operating instructions. Always read this information carefully.



This product is constructed according to protection class III.

Safety instructions





Read the operating instructions carefully and especially observe the safety information. If you do not follow the safety instructions and information on proper handling in this manual, we assume no liability for any resulting personal injury or damage to property. Such cases will invalidate the warranty/guarantee.

a) General information

- The device is not a toy. Keep it out of the reach of children and pets.
- Do not leave packaging material lying around carelessly. This may become dangerous playing material for children.
- Protect the appliance from extreme temperatures, strong jolts, flammable gases, steam and solvents.
- Do not place the product under any mechanical stress.
- If it is no longer possible to operate the product safely, take it out of operation and protect it from any accidental use. Safe operation can no longer be guaranteed if the product:
 - is visibly damaged,
 - is no longer working properly,
 - has been stored for extended periods in poor ambient conditions or
 - has been subjected to any serious transportrelated stresses.
- Please handle the product carefully. Jolts, impacts or a fall even from a low height can damage the product.
- Consult an expert when in doubt about the operation, safety or connection of the appliance.
- Maintenance, modifications and repairs must only be completed by a technician or an authorised repair centre.
- If you have questions which remain unanswered by these operating instructions, contact our technical support service or other technical personnel.

Technical data

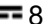
Operating voltages / current 12 V  14 A, 24 V  10 A , 32 V  8 A
Protection class III
Ingress protection IPX8
Fluid medium fresh water, salt water
Water level switch activation..... 51 mm (2.0")
Wire lead 1 m, \varnothing 1.29 mm (16 AWG)
Operating / Storage temp. 0 to +40 °C
Dimensions (W x H X D) 130 x 54 x 44 mm
Weight 100 g

This is a publication by Conrad Electronic SE, Klaus-Conrad-Str. 1, D-92240 Hirschau (www.conrad.com). All rights including translation reserved. Reproduction by any method, e.g. photocopy, microfilming, or the capture in electronic data processing systems require the prior written approval by the editor. Reprinting, also in part, is prohibited. This publication represent the technical status at the time of printing. Copyright 2022 by Conrad Electronic SE. *2386387_v2_1221_02_dh_mh_en

Dimensions

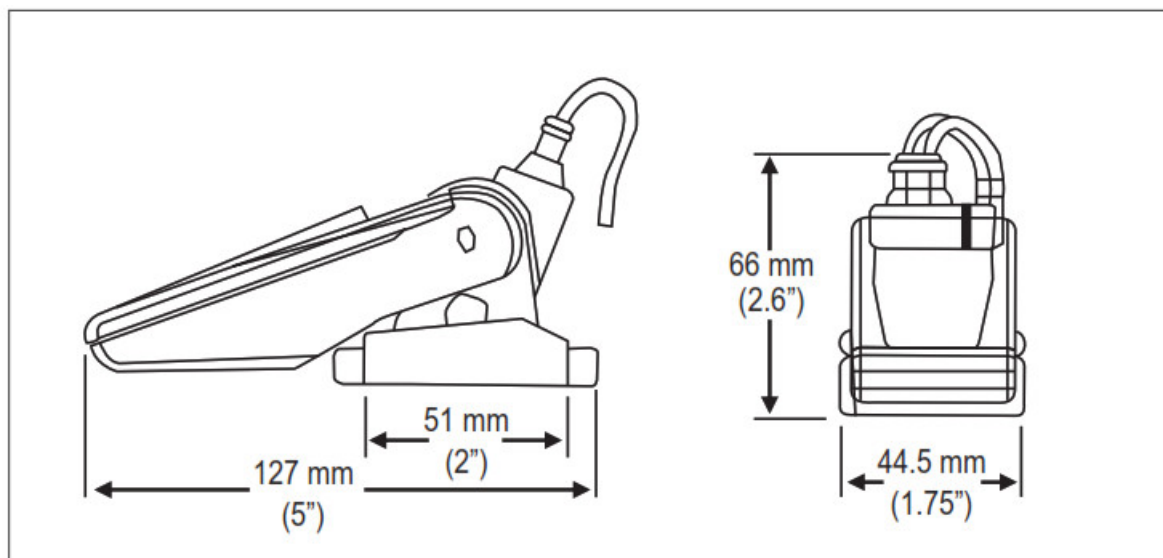

Wiring

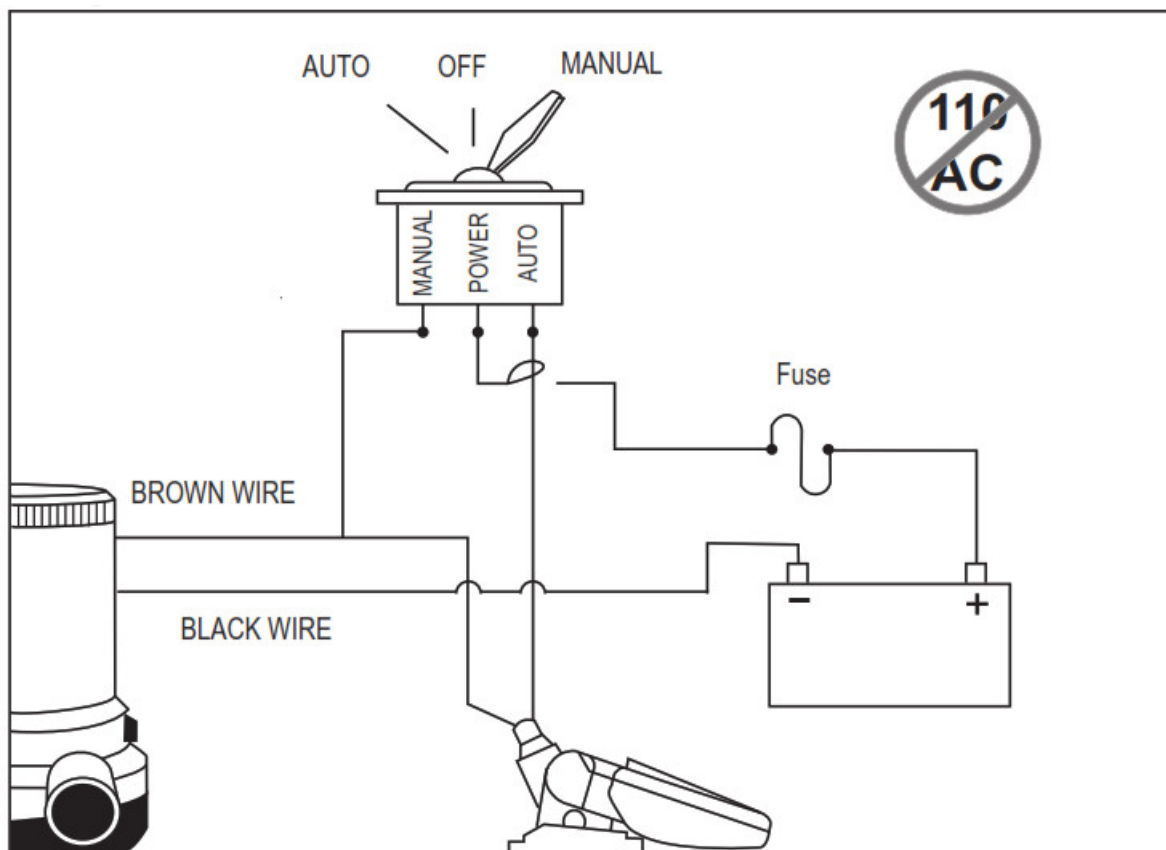

⚠ IMPORTANT

- Switch must be mounted equal to or above the pump base for positive shut-off.
- Keep all wire connections above the highest water level.
- Wires must be joined with connectors.
- Always disconnect the power supply when installing or servicing electrical parts.

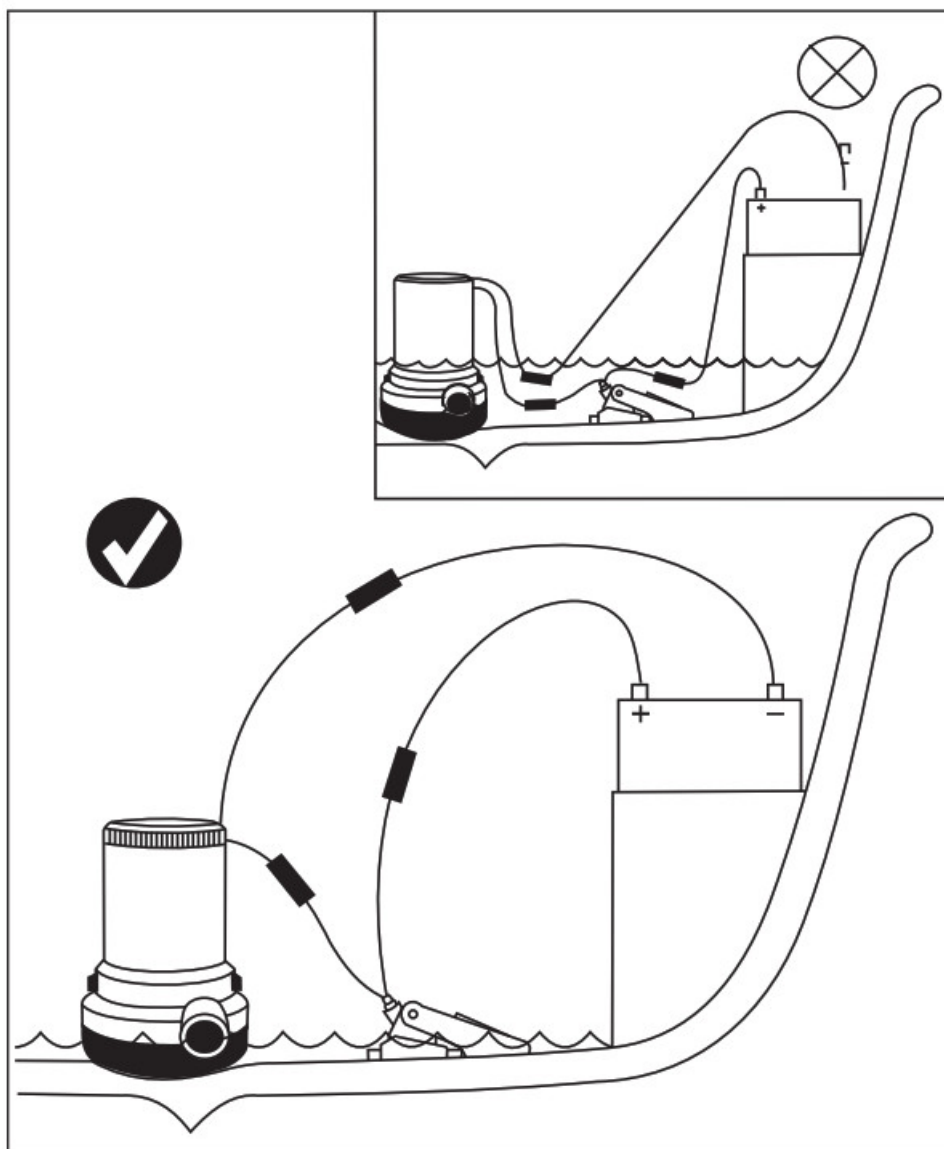

Installation

IMPORTANT

- All mounting holes must be sealed to prevent water intrusion.

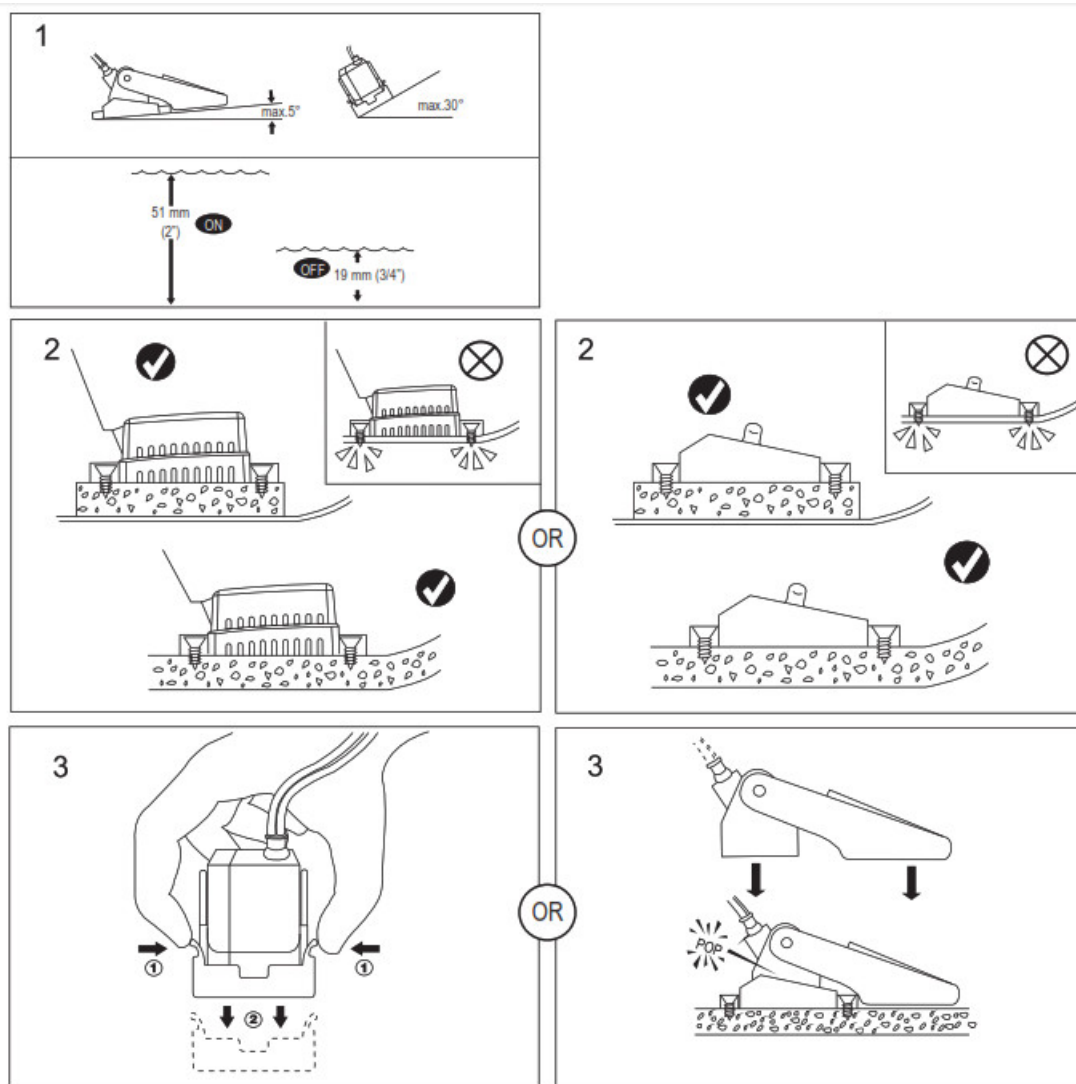

Test the float switch

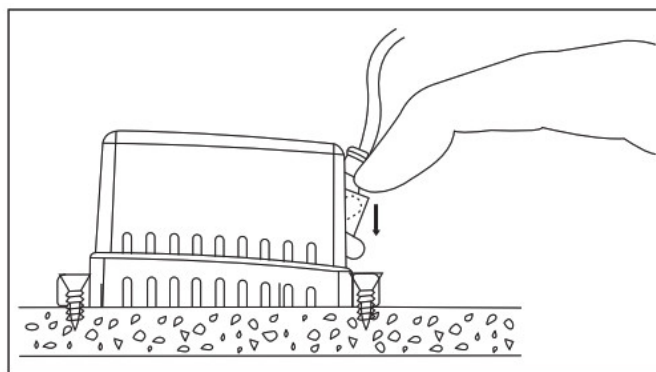
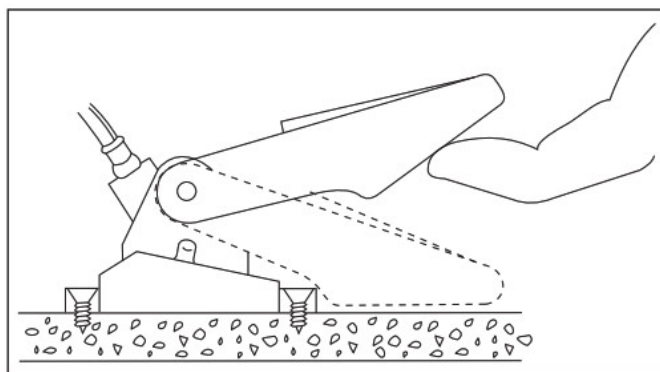

⚠ IMPORTANT! Only use with fresh water or salt water. DO NOT use with gasoline, diesel, oil, hazardous, caustic, corrosive, or other flammable liquids.

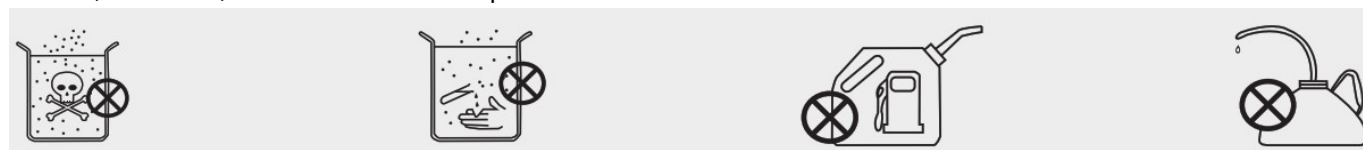

Up-to-date operating instructions Download the latest operating instructions at www.conrad.com/downloads or scan the QR code shown. Follow the instructions on the website.



www.conrad.com/downloads

Documents / Resources

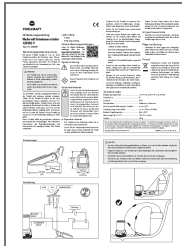

[TOOLCRAFT 2368387 Low-Voltage Float Switch](#) [pdf] Instruction Manual
2368387 Low-Voltage Float Switch, 2368387, Low-Voltage Float Switch, Voltage Float Switch, Float Switch, Switch

References

- [Conrad Electronic » Your Sourcing Platform](#)
- [Conrad Electronic » Your Sourcing Platform](#)
- [Document](#)