

Contents [[hide](#)]

- [1 TONTRU T101 Mechanical Keyboard](#)
- [2 Specifications](#)
- [3 Basic parameters](#)
- [4 2.4G connection](#)
- [5 Bluetooth connectivity](#)
- [6 Wired connection](#)
- [7 Product indicator light](#)
- [8 FCC Caution](#)
- [9 Frequently Asked Questions](#)
- [10 Documents / Resources](#)
 - [10.1 References](#)

TONTRU

TONTRU T101 Mechanical Keyboard



Specifications

- Model: XYZ-1000
- Power: 1200W
- Capacity: 10 liters
- Material: Stainless steel
- Dimensions: 12" x 14" x 10"

Initial Setup

Before using the XYZ-1000, make sure to read the user manual carefully. Place the appliance on a flat, stable surface near a power outlet.

Filling the Tank

Open the top lid of the unit and fill the tank with water up to the maximum level indicator. Do not exceed the maximum capacity to avoid spillage.

Power On

Plug in the power cord and switch on the device using the power button located on the control panel. The indicator light will illuminate once the unit is powered on.

Selecting Settings

Use the control panel to select your desired settings, such as temperature and timer. The XYZ-1000 offers multiple cooking modes for different recipes.

Cooking Process

Once you have set the desired parameters, close the lid securely and allow the XYZ-1000 to cook your food. Monitor the cooking progress through the transparent window.

Cleaning and Maintenance

After each use, ensure the unit has cooled down before cleaning. Wipe the interior and exterior surfaces with a damp cloth and mild detergent. Regular maintenance will prolong the lifespan of your XYZ-1000.

Basic parameters

- Product model: T101
- Bluetooth name: TONTRU Keyboard 3.0/TONT

- RU Keyboard 5.0
- Battery parameters: 3.7V 8000mAh (does not support fast charging! Please connect to a computer for charging)
- Input: DC 5V— 1A
- Connection modes: wired connection Bluetooth connection (5.0), 2.4G connection
- Wireless version: 2,4G BLE 5.0
- Wireless connection distance: 10 meters (in unobstructed open environments)
- Charging port: Type-C
- Support system: Windows, macOS
- Product size: 410mm * 144mm * 42mm
- Manual measurement of relevant parameters.
- In case of any discrepancies, the actual product shall prevail!

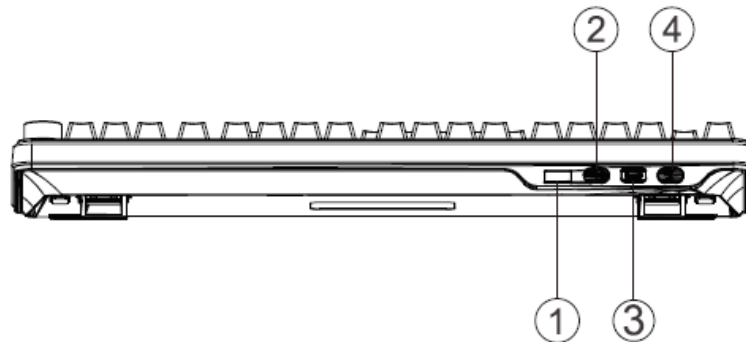

1. 2.4G receiver placement hole
2. 2.4G/USB/BT
3. Type-C interface
4. WIN/MAC

2.4G connection

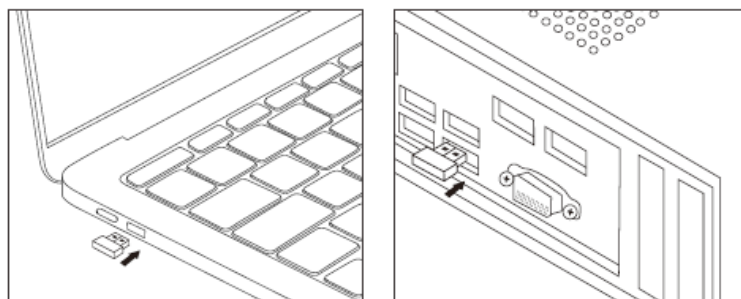

After switching to 2.4G mode, long-press FN+R and hold the combination key for 3 seconds to enter 2.4G pairing mode. After successful pairing, the modelight will turn off.

After 2 minutes of inactivity, the pairing device will not be found, the keyboard will enter sleep mode. Press any key to wake up (for after-sales secondary pairing)

Bluetooth connectivity



After switching to Bluetooth mode, long-press FN+Q/W/E to enter Bluetooth pairing mode, corresponding to Bluetooth channels 1/2/3 with blue/yellow/white indicator lights. Shortpress to switch channels. If the connection is not successful, there will be no operation for 2 minutes before the keyboard enters sleep mode. Press any key to wake up.

Wired connection

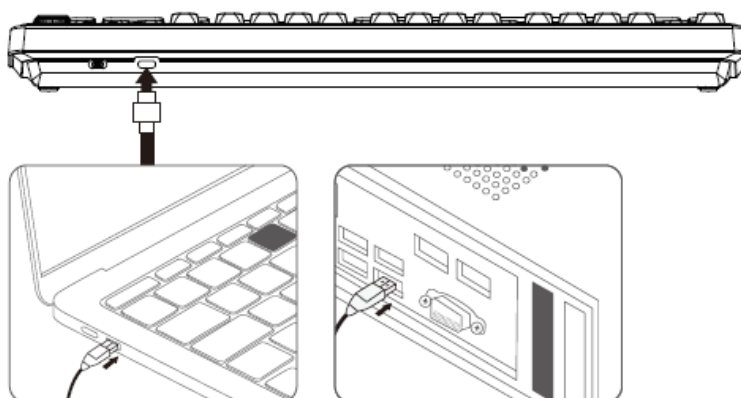

- Turn the switch to the wired mode and in the USB data cable to establish a wired connection.
- Power-saving sleep state
 - After 2 minutes of inactivity on the keyboard, the backlight will turn off
 - Press any key to wake up (the driver can adjust the sleep time)
- Deep sleep state
 - Keyboard inactivity for 30 minutes.
 - The keyboard enters deep sleep mode, Bluetooth is disconnected, press any key to wake up the back and Bluetooth is reconnected.

Product indicator light

1. NUM indicator light

Press the NUM key indicator light to turn on the numeric keypad area function, then
Press the NUM key indicator light to turn off the numeric keypad function.

2. Caps lock indicator light

Press the Caps lock key to turn on the uppercase indicator light, then press the
Capslock key to turn off the indicator light and return to lowercase.

3. WIN key indicator light

Press the FN+WIN button and the indicator light will remain on, indicating that the win
is locked. Press the unlock button again to restore normal operation. (With memory
function, the MAC system does not support the WIN lock key function)

4. Charging indicator light

The red light flashes slowly at low voltage, stays on during charging, and turns off
when fully charged. Power indicator: Display in primary key area 1-0

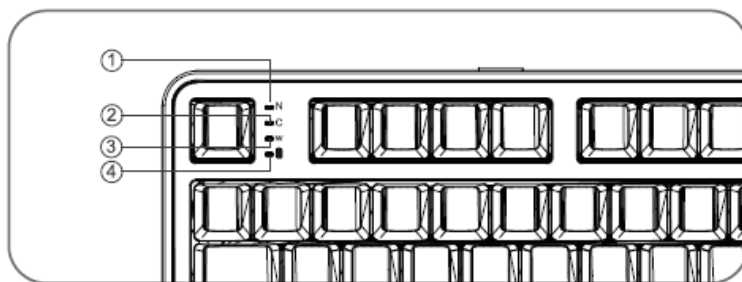

Multimedia combination key (WIN)

Combination button	function
Fn+Esc	Long press for 3 seconds to restore factory settings
Fn+F1	Screen brightness-
Fn+F2	Screen brightness+
FN+F3	Task View
FN+F4	Application switching
FN+F5	Emoji
FN+F6	Screenshot
FN+F7	Previous song
FN+F8	Play/Pause
FN+F9	Next song
FN+F10	Search
FN+F11	Input method switching
FN+F12	Return to desktop

Multimedia combination key (MAC)

Combination button	function
Fn+Esc	Long press for 3 seconds to restore factory settings
F1	Screen brightness-
F2	Screen brightness+
F3	Task Center
F4	Application switching
F5	Emoji
F6	Screenshot
F7	Previous song
F8	Play/Pause
F9	Next song
F10	Search
F11	Input method switching
F12	Return to desktop

Multimedia combination key (WIN/MAC)

Combination button	function
Fn+BackSpace	Check battery level
Fn+\\	Main backlight effect switching
Fn+Enter	Main backlight color switching
Fn+X	Keyboard light switch
Fn+↑	Main backlight brightness+
Fn+↓	Main backlight brightness-
Fn+ ←	Main backlight speed-
Fn+ →	Main backlight speed+
FN+1!	Enter custom game mode

List of Items

- A. Type-C connection cable
- B. 2.4G receive
- C. Instruction manual
- D. Three axes
- E. Dust cover
- F. Pulling shaft and key puller

FCC Caution

This device complies with part 15 of the FCC Rules. Operation is subject to the following

two conditions:

1. This device may not cause harmful interference, and
2. This device must accept any interference received, including interference that may cause undesired operation.

Any changes or modifications not expressly approved by the party responsible for compliance could void the user's authority to operate the equipment.

NOTE: This equipment has been tested and found to comply with the limits for a Class B digital device, pursuant to Part 15 of the FCC Rules. These limits are designed to provide reasonable protection against harmful interference in a residential installation. This equipment generates, uses and can radiate radio frequency energy and, if not installed and used in accordance with the instructions, may cause harmful interference to radio communications. However, there is no guarantee that interference will not occur in a particular installation

If this equipment does cause harmful interference to radio or television reception, which can be determined by turning the equipment off and on, the user is encouraged to try to correct the interference by one or more of the following measures:

- Reorient or relocate the receiving antenna.
- Increase the separation between the equipment and receiver.
- Connect the equipment into an outlet on a circuit different from that to which the receiver is connected.
- Consult the dealer or an experienced radio/TV technician for help.

The device has been evaluated to meet general RF exposure requirements. The device can be used in portable exposure conditions without restriction.

Frequently Asked Questions

Q: Can I use the XYZ-1000 without water?

A: No, it is essential to fill the tank with water before using the XYZ-1000 to prevent damage to the unit.

Q: How do I know when the cooking cycle is complete?

A: The XYZ-1000 will beep and automatically switch off once the cooking cycle is complete. You can also check the timer on the control panel.

Documents / Resources

	TONTRU T101 Mechanical Keyboard [pdf] User Manual 2BQMT-T101, 2BQMTT101, T101 Mechanical Keyboard, T101, Mechanical Keyboard, Keyboard
---	---

References

- [User Manual](#)

2BQMT-T101, 2BQMTT101, Keyboard, Mechanical keyboard, T101, T101 Mechanical Keyboard, TONTRU TONTRU

Leave a comment

Your email address will not be published. Required fields are marked *

Comment *

Name

Email

Website

☐ Save my name, email, and website in this browser for the next time I comment.

Post Comment

Search:

e.g. whirlpool wrf535swhz

Search

[Manuals+](#) | [Upload](#) | [Deep Search](#) | [Privacy Policy](#) | [@manuals.plus](#) | [YouTube](#)

This website is an independent publication and is neither affiliated with nor endorsed by any of the trademark owners. The "Bluetooth®" word mark and logos are registered trademarks owned by Bluetooth SIG, Inc. The "Wi-Fi®" word mark and logos are registered trademarks owned by the Wi-Fi Alliance. Any use of these marks on this website does not imply any affiliation with or endorsement.