

Tongxin
Tongxin F81
Magic
Keyboard



Tongxin F81 Magic Keyboard User Manual

[Home](#) » [Tongxin](#) » Tongxin F81 Magic Keyboard User Manual 

Contents

- 1 [Tongxin F81 Magic Keyboard](#)
- 2 [Product Information](#)
- 3 [Frequently Asked Questions](#)
- 4 [Set up and use a magic keyboard suitable for Galaxy Tab](#)
- 5 [Conditions to be met](#)
- 6 [Installing Galaxy Tab on Magic Keyboard](#)
- 7 [Connect the magic keyboard to the Galaxy Tab](#)
- 8 [Hibernate, Reconnect, Disconnect, or Modify Bluetooth name](#)
- 9 [Adjusting touchpad settings](#)
- 10 [Charging the Magic Keyboard](#)
- 11 [Turn on keyboard backlight and adjust backlight brightness or color](#)
- 12 [Open the magic keyboard connected to the Galaxy Tab](#)
- 13 [Magic keyboard status indicator light and other instructions](#)
- 14 [Keyboard shortcut functions](#)
- 15 [Touchpad gesture instructions](#)
- 16 [FCC](#)
- 17 [Documents / Resources](#)
 - 17.1 [References](#)
- 18 [Related Posts](#)

Tongxin

Tongxin F81 Magic Keyboard



Product Information

Specifications

- Compliance: Part 15 of FCC Rules
- RF Exposure: Meets general RF exposure requirement
- Usage: Portable exposure condition without restriction

Frequently Asked Questions

Q: Can I modify the device on my own?

A: No, any changes or modifications not approved may void your authority to operate the equipment.

Q: Is there a restriction on using the device in portable exposure conditions?

A: No, the device can be used in portable exposure conditions without restriction as it meets the RF exposure requirement.

Set up and use a magic keyboard suitable for Galaxy Tab

Learn how to set up a magic keyboard and use it with Galaxy Tab.



Conditions to be met

- Samsung Galaxy Tab S7+/S7FE/S8+/S9+/S9FE+
- Samsung One UI 2.5 or higher

Due to the slightly thicker size of some Galaxy Tabs when using screen protectors, the magic keyboard may not fully fit the device when closed.

Installing Galaxy Tab on Magic Keyboard

1. Place the magic keyboard on a flat surface with the pivot on the side away from you and the camera hole facing upwards.
2. Open the upper cover. The upper half of the cover will tilt towards the side away from you.
3. Continue tilting the top cover until it reaches the desired angle or cannot be opened further.
4. Place the Galaxy Tab on the magic keyboard. The rear camera should be located in the upper left corner to be exposed through the opening on the magic keyboard.

Connect the magic keyboard to the Galaxy Tab

1. Install the Galaxy Tab onto the magic keyboard and open the keyboard.
2. Turn the switch on the right side of the magic keyboard to "ON". The power indicator light turns red for 1 second and goes off, while the paired indicator light flashes blue.
 1. Power indicator icon: ON/OFF
 2. Case indicator icon: A
 3. Paired indicator icon: BT
3. Open the "Settings" app on the Galaxy Tab.
4. Tap "Connections".
5. Tap "Bluetooth" to set it to "ON" or blue.
6. Find your Bluetooth accessory "Wireless Keyboard" under "Available devices", then tap its name to pair it with

your Galaxy Tab. Paired successfully, the blue light remains on.

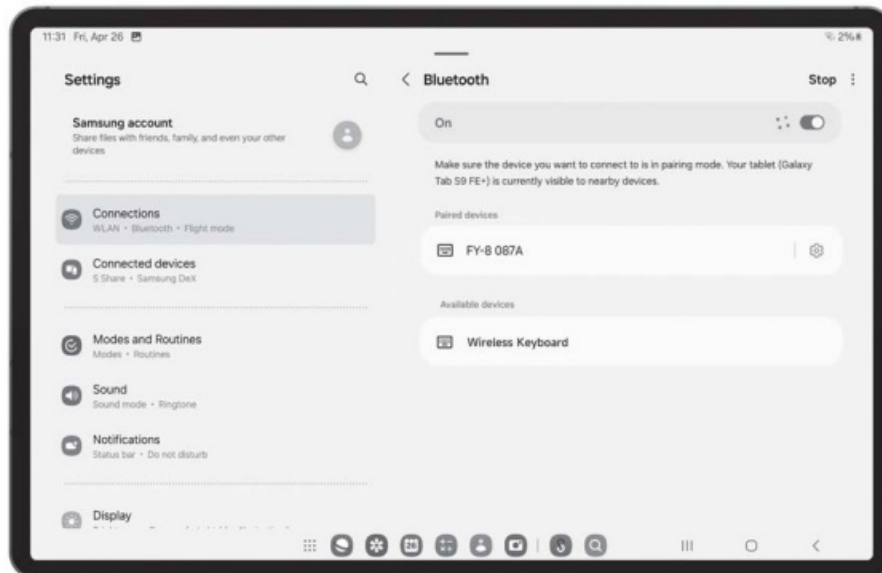

Hibernate, Reconnect, Disconnect, or Modify Bluetooth name

After pairing with the Galaxy Tab for the first time, your magic keyboard will appear under “Paired Devices” in “Settings”>“Connections”>“Bluetooth”. The magic keyboard will enter sleep mode after about 10 minutes of inactivity, and Bluetooth will disconnect. Automatically rewind by typing any key on the keyboard. When the keyboard is closed, lifting the top cover and opening the keyboard will also automatically reconnect.

The operation touchpad cannot be reconnected.

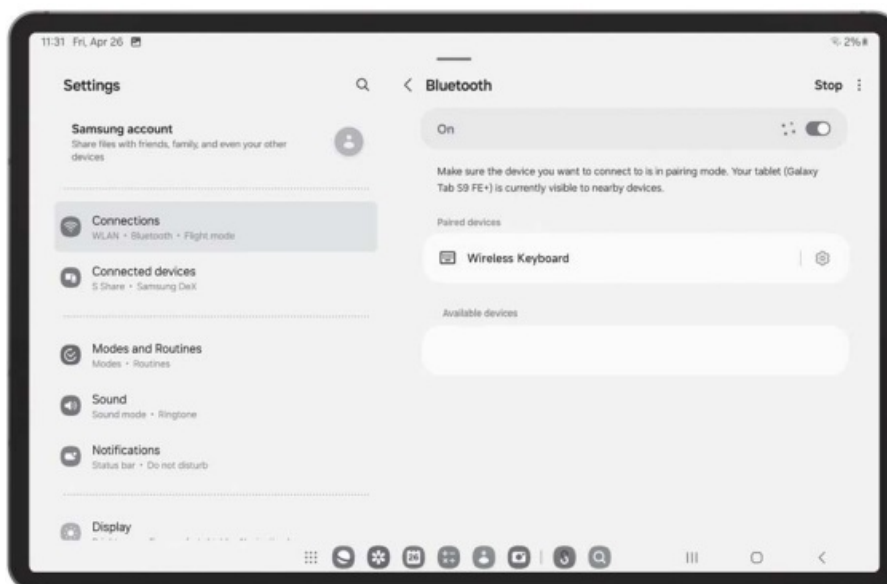

To modify the Bluetooth name, disconnect, or cancel pairing, please tap the Ⓜ button next to “Wireless Keyboard”.



Adjusting touchpad settings

To adjust the touchpad, go to Settings>General Management>Mouse and Touchpad. You can change the pointer tracking speed and set other related options.

Charging the Magic Keyboard

To charge the magic keyboard, you can connect the USB-C cable to the USB-C port on the right side of the magic keyboard. It usually takes about two hours to fully charge the magic keyboard, and the charging indicator light turns red and green to indicate that the charging is complete.

Turn on keyboard backlight and adjust backlight brightness or color

1. Turn on/off backlight and backlight brightness switch: Press the backlight button  to turn on the first level brightness backlight, then press the second level, then press the third level, and then press to turn off the backlight.
2. Backlight color switching: Press the combination keys  +  to switch the backlight color.
3. The backlight will automatically turn off if the keyboard is not tapped for six seconds. Re typing the keyboard will automatically turn on the backlight.

Open the magic keyboard connected to the Galaxy Tab



1. Place the magic keyboard on a flat surface with the pivot on the side away from you and the camera hole facing upwards.
2. Open the top cover until you reach the desired angle or can no longer open it.

Adjusting the viewing angle

You can tilt the Galaxy Tab up and down to find the ideal viewing angle.

Magic keyboard status indicator light and other instructions

1. Low battery state: The red light is flashing.
2. Charging: The red light is constantly on.
3. Fully charged: The green light remains on.
4. Request pairing: Blue light flashing.
5. In uppercase: the white light is always on, in lowercase: the white light is off.
6. Hibernation: The keyboard standby for 10 minutes enters sleep mode.
7. Hibernate and reconnect: Press any key to reconnect.

8. The vast majority of unknown usage obstacles can be resolved by restarting the keyboard or Galaxy Tab.

Understanding Magic Keyboard Shortcuts

If your Galaxy Tab is connected to a magic keyboard, you can use keyboard shortcuts to perform tasks that typically require the use of a mouse, touchpad, or other input devices.

View keyboard shortcuts

To view shortcut keys, press the combination key “[Cmd]+[?]” while displaying the main screen.

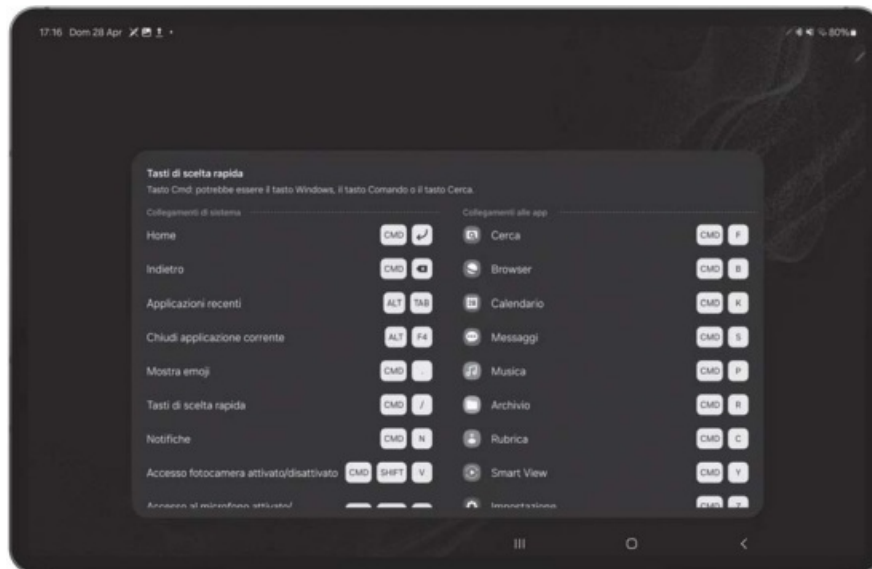

Keyboard shortcut functions

The Magic Keyboard has prepared multiple sets of shortcut function combinations for you.



Touchpad gesture instructions



FCC

FCC Caution

This device complies with part 15 of the FCC Rules. Operation is subject to the following two conditions: (1) This device may not cause harmful interference, and (2) this device must accept any interference received, including interference that may cause undesired operation.

Any Changes or modifications not expressly approved by the party responsible for compliance could void the user's authority to operate the equipment.

Note: This equipment has been tested and found to comply with the limits for a Class B digital device, pursuant to part 15 of the FCC Rules. These limits are designed to provide reasonable protection against harmful interference in a residential installation. This equipment generates uses and can radiate radio frequency energy and, if not installed and used in accordance with the instructions, may cause harmful interference to radio communications. However, there is no guarantee that interference will not occur in a particular installation. If this equipment does cause harmful interference to radio or television reception, which can be determined by turning the equipment off and on, the user is encouraged to try to correct the interference by one or more of the following measures:

- Reorient or relocate the receiving antenna.
- Increase the separation between the equipment and receiver.
- Connect the equipment into an outlet on a circuit different from that to which the receiver is connected.
- Consult the dealer or an experienced radio/TV technician for help.

The device has been evaluated to meet general RF exposure requirement. The device can be used in portable exposure condition without restriction.

Documents / Resources

 <p>F81 Magic Keyboard 无线蓝牙键盘 2A4YK-F81</p> <p><small>User Manual / 使用说明书 F81 1-1 (2020)</small></p>	<p>Tongxin F81 Magic Keyboard [pdf] User Manual</p> <p>2A4YK-F81, 2A4YKF81, F81 Magic Keyboard, F81, Magic Keyboard, Keyboard</p>
--	---

References

- [User Manual](#)

Manuals+, Privacy Policy

This website is an independent publication and is neither affiliated with nor endorsed by any of the trademark owners. The "Bluetooth®" word mark and logos are registered trademarks owned by Bluetooth SIG, Inc. The "Wi-Fi®" word mark and logos are registered trademarks owned by the Wi-Fi Alliance. Any use of these marks on this website does not imply any affiliation with or endorsement.