



# TOMTOP C28 Wireless Audio Receiver and Transmitter User Manual

[Home](#) » [TOMTOP](#) » TOMTOP C28 Wireless Audio Receiver and Transmitter User Manual 

## Contents

- [1 TOMTOP C28 Wireless Audio Receiver and Transmitter](#)
- [2 SPECIFICATIONS](#)
- [3 PACKAGE CONTENTS](#)
- [4 PRODUCT DIAGRAM](#)
- [5 INTERFACE DIAGRAM](#)
- [6 How to use](#)
- [7 Transmitter mode](#)
- [8 Documents / Resources](#)
  - [8.1 References](#)
- [9 Related Posts](#)

# TOMTOP

## TOMTOP C28 Wireless Audio Receiver and Transmitter



### SPECIFICATIONS

- Bluetooth version
  - V5.0
- Playtime
  - 4h
- Bluetooth Range
  - Up to 10m in an open area
- Battery capacity
  - 140mA
- Charging time
  - 1h

### PACKAGE CONTENTS

1. 1x Brightside C28 Wireless Audio Receiver & Transmitter
2. 1x USB-A to the micro-USB charging cable
3. 1x 3,5 mm jack (m) – 3,5 mm jack (m) stereo plug
4. User manual

## PRODUCT DIAGRAM



RX  $\longleftrightarrow$  TX  
ontvanger zender

### One button control

Switch easily between transmitter- (TX) & receiver (RX) mode.

## INTERFACE DIAGRAM

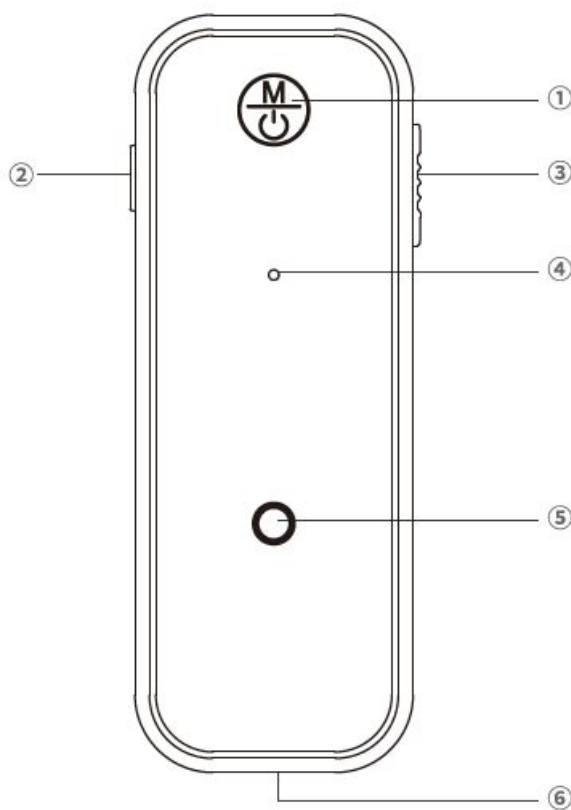

1. Multifunction button  
(power/play/pause)
2. Aux input/ output
3. Transmitter and receiver switch
4. Microphone
5. Indicator light
6. 5V/1A micro USB charging port

## How to use

## Receiver mode

1. Use the micro USB cable to charge before use. When charging the indicator light (6) will illuminate red;
2. Connect the C28 to your audio device using the AUX port (2);
3. Change the switch button (3) to the RX position;
4. Turn on the device (Long press on the multifunction button (1)) then the blue light will flash quickly indication that it is ready for pairing.
5. Find the C28 in the wireless search of your device and chose to pair. When the connection is successful the indicator light (5) will illuminate blue.

## Transmitter mode

1. Use the micro USB cable to charge before use. When charging the indicator light (6) will illuminate red;
2. Connect the C28 to your audio device using the AUX port (2);
3. Change the switch button (3) to the TX position;
4. Turn on the device (Long press on the multifunction button (1)) then the red light will flash quickly indicating that it is ready to pair;
5. Turn on the device you want to connect and the C28 will automatically connect. When the connection is successful the indicator light (5) will illuminate red.

If you encounter any problems with the installation or if

If you have any other questions, please feel free to contact us. You can do this directly via our contact page:

[www.brightsideonline.nl](http://www.brightsideonline.nl)



Get 10% off! With the code: BSO-BTA-10

## Documents / Resources

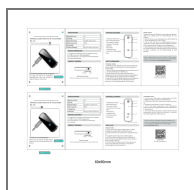

[TOMTOP C28 Wireless Audio Receiver and Transmitter](#) [pdf] User Manual  
C28, Wireless Audio Receiver and Transmitter, C28 Wireless Audio Receiver and Transmitter

## References

-  [Brightside Online - Bringing you the best with a smile!](#)

[Manuals+](#), [home](#) [privacy](#)