



# TOBENONE UDS038 Display Docking Station For Windows Instruction Manual

[Home](#) » [TOBENONE](#) » TOBENONE UDS038 Display Docking Station For Windows Instruction Manual 



Simplicity Power Elegance  
UDS038

Triple Display Docking Station for Windows

## THANK YOU!

Thank you for purchasing TobenONE USB C Docking Station UDS038! Our dock provides the ability to connect up to triple displays, power adapter, Gigabit Ethernet, audio devices, 7 USB peripherals, and SD/TF card to your laptop via one single USB C cable.

### Contents

- [1 Ports And Conncetors](#)
- [2 Plug-and-Play, NO driver needed](#)
- [3 Connection method](#)
- [4 Charging Matters](#)
- [5 Documents / Resources](#)
  - [5.1 References](#)

## Ports And Conncetors

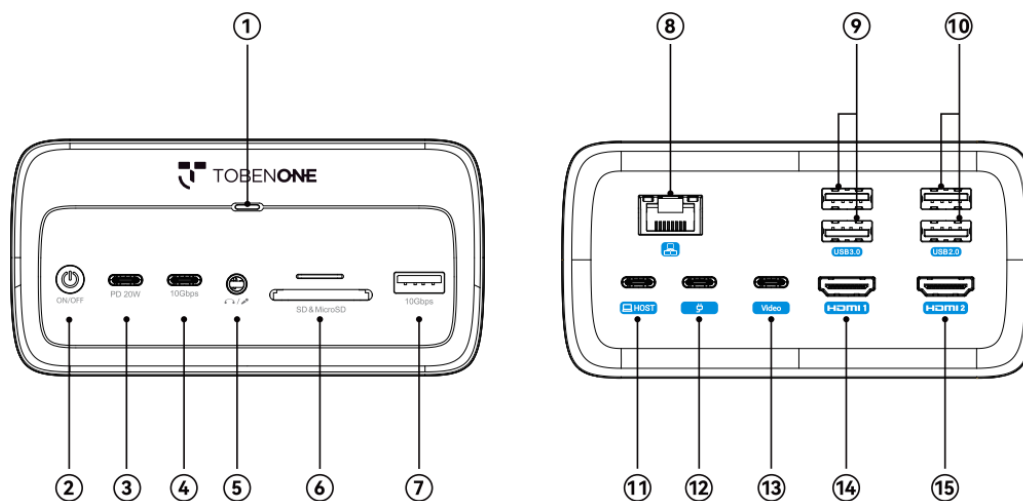

1. Green Power LED
2. Power Button: Control dock power on/off
3. USB C 3.1: PD 20W output
4. USB C 3.2: Speed up to 10Gbps
5. 3.5mm Audio: For Headphone & Microphone
6. SD/microSD Slot: Support SD&TF work simultaneously
7. USB A 3.2: Speed up to 10Gbps
8. LAN Port: Speed up to 1000Mbps

9. USB A 3.0\*2: Speed up to 5Gbps
10. USB A 2.0\*2: Special for wireless devices
11. HOST Port: Connect to the laptop
12. USB C PD 3.0: Connect the power adapter included, support 87W output
13. USB C Display Port: Resolution up to 8K/30Hz
14. HDMI 1: Resolution up to 8K/30Hz
15. HDMI 2: Resolution up to 8K/30Hz

## Plug-and-Play, NO driver needed

This USB C hub is designed for Windows laptops with a full-featured Type C or Thunderbolt 3/4 port. So please confirm your Windows laptops USB Type-C port supports Display Alt-Mode before you purchase this USB-C hub. Otherwise, the video ports cannot work.

If you're not sure, feel free to contact us with your exact laptop model, and we will check for you!

**⚠ Note:** This docking station is designed for Windows laptop, not for macOS!!!

## Connection method

**Step 1:** Connect the included power supply to the dock's USB C PD 3.0 port (12).

**Step 2:** Use the included USB C cable to connect the dock and laptop via HOST port (11).

**Step 3:** Connect the multi monitors via HDMI 1(14), HDMI 2 (15)), USB C Display port (13).

**Step 5:** Attach USB and USB-C devices(USB driver, keyboard, mouse, printer, etc.) to the USB ports ((3), (4), (7), (9)). It is recommended to connect wireless mouse and keyboard to connect the USB 2.0 port (10).

**Step 6:** Connect the speaker, headphones, or microphone to the audio port(5). And connect the ethernet cable to the RJ45 ethernet port (8).

## Charging Matters

1. If the laptop's USB C port doesn't support charging, you need to connect the original power supply to the laptop's charging port!
2. If your PC is Dell/HP/ThinkPad laptop, your PC may be warned of low charging. Those Laptop (Dell/HP/ThinkPad...) do not allow 3rd party charger to charge their laptop in other ways. So if you use a lower-power charger than the laptops included AC adapter, it will cause a low charging warning. It's the limit of the laptop, not for the dock.

USB C DP Alt Mode (DP 1.4/MST, DSC)				
Item	Mirror/Extend	HDMI 1	HDMI 2	USB-C(DP)
1	Single monitor	8K@30Hz / 4K@120Hz		
2			8K@30Hz / 4K@120Hz	
3				8K@30Hz / 4K@120Hz
4	Dual monitor	4K/60Hz	4K/60Hz	
5		4K/60Hz		4K/60Hz
6			4K/60Hz	4K/60Hz
7	Triple monitor	4K/60Hz	4K/60Hz	4K/60Hz

USB C DP Alt Mode (DP 1.2/MST)				
Item	Mirror/Extend	HDMI 1	HDMI 2	USB-C(DP)
1	Single monitor	4K/30Hz		
2			4K/30Hz	
3				4K/30Hz
4		1920X1080/60Hz	1920X1080/60Hz	
5	Dual monitor	1920X1080/60Hz		1920X1080/60Hz
6			1920X1080/60Hz	1920X1080/60Hz

#### Reminder:

1. The final resolution of video output depends on your host devices(laptop, cable, and monitor). Such as: Only when your host devices support 4K@60Hz resolution, the video output will be 4K@60Hz.
2. If your laptop only supports DP1.2, you only can mirror/extend dual monitor. If you connect 3 monitors, one of them will not work!



**Any Questions, We Are Here To Help!**

Email: [support@tobenone.com](mailto:support@tobenone.com)

**The Only Question We can't Fix Is The One We Don't Know**



[TOBENONE UDS038 Display Docking Station For Windows](#) [pdf] Instruction Manual  
UDS038, UDS038 Display Docking Station For Windows, Display Docking Station For Windows  
, Docking Station For Windows, Station For Windows, Windows

## References

- [User Manual](#)

[Manuals+.](#) [Privacy Policy](#)

This website is an independent publication and is neither affiliated with nor endorsed by any of the trademark owners. The "Bluetooth®" word mark and logos are registered trademarks owned by Bluetooth SIG, Inc. The "Wi-Fi®" word mark and logos are registered trademarks owned by the Wi-Fi Alliance. Any use of these marks on this website does not imply any affiliation with or endorsement.