



# toast TT200B Data Processing Machine User Manual

[Home](#) » [toast](#) » toast TT200B Data Processing Machine User Manual

## Contents [ [hide](#) ]

- 1 toast- TT200B- Data -Processing - Machine
- 2 Toast Flex for Kitchen
- 3 Toast Flex for Kitchen MOUNTED
- 4 Specifications: Toast Flex
- 5 Simplified Setting
- 6 Precautions
- 7 FCC Regulations
- 8 Support
- 9 Documents / Resources
  - 9.1 References
- 10 Related Posts

The word "toast" in a bold, orange, lowercase sans-serif font, set against a light gray rectangular background.

## toast- TT200B- Data -Processing -Machine



### Toast Flex for Kitchen

#### Follow these instructions if the Toast Flex for Kitchen will be on-stand

Before you get started, identify where you want your Toast Flex for Kitchen to be located. Make sure there is a power outlet and wall port in reach.



1. Unpack your Toast Flex for Kitchen terminal and place it on your counter.
2. Remove the yellow box labeled "Connect." This box contains two yellow ethernet cables. One cord is 3 ft and one is 7 ft. Choose the cord length that best suits your restaurant and connect it from the wall to the yellow port labeled "Internet IN" on the base of the terminal stand.
3. Remove the orange power box labeled "Power." Plug in the power adapter from the wall into the orange port located at the base of the Toast Flex terminal stand. Use the thumb screw to secure it.

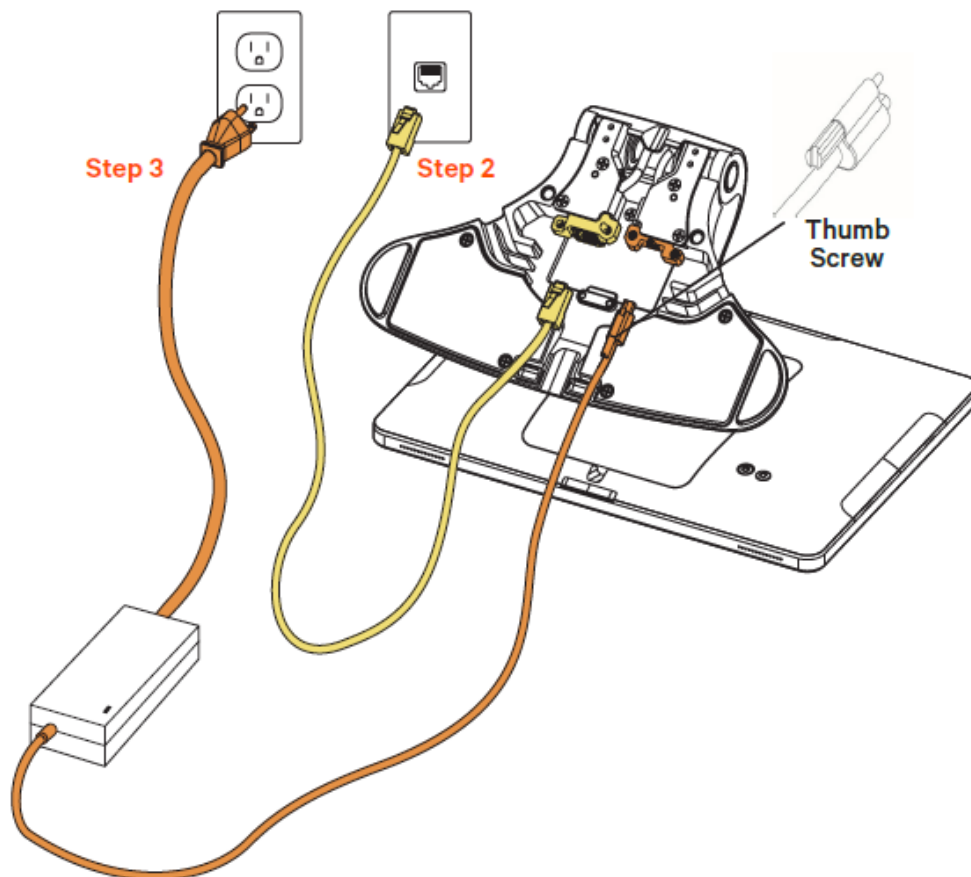

If you are using a wall mount for your Toast Flex for Kitchen, go to the next page!

## Toast Flex for Kitchen MOUNTED

**Follow these instructions if the Toast Flex for Kitchen will be mounted on the wall**

Before you get started, identify where you want your Toast Flex for Kitchen to be located. Make sure there is a power outlet and wall port in reach.



1. Unpack your Toast Flex for Kitchen and Wall Mount:
  1. It will have the swing arm for the wall mount already attached.
  2. It will also have the power cable and internet cable pre-plugged into your Toast Flex for Kitchen.
2. Plug the other end of the internet cable into the wall port.
3. Attach your wall mount to the wall. (See note below.)
4. Plug the other end of the power cable into the wall outlet.

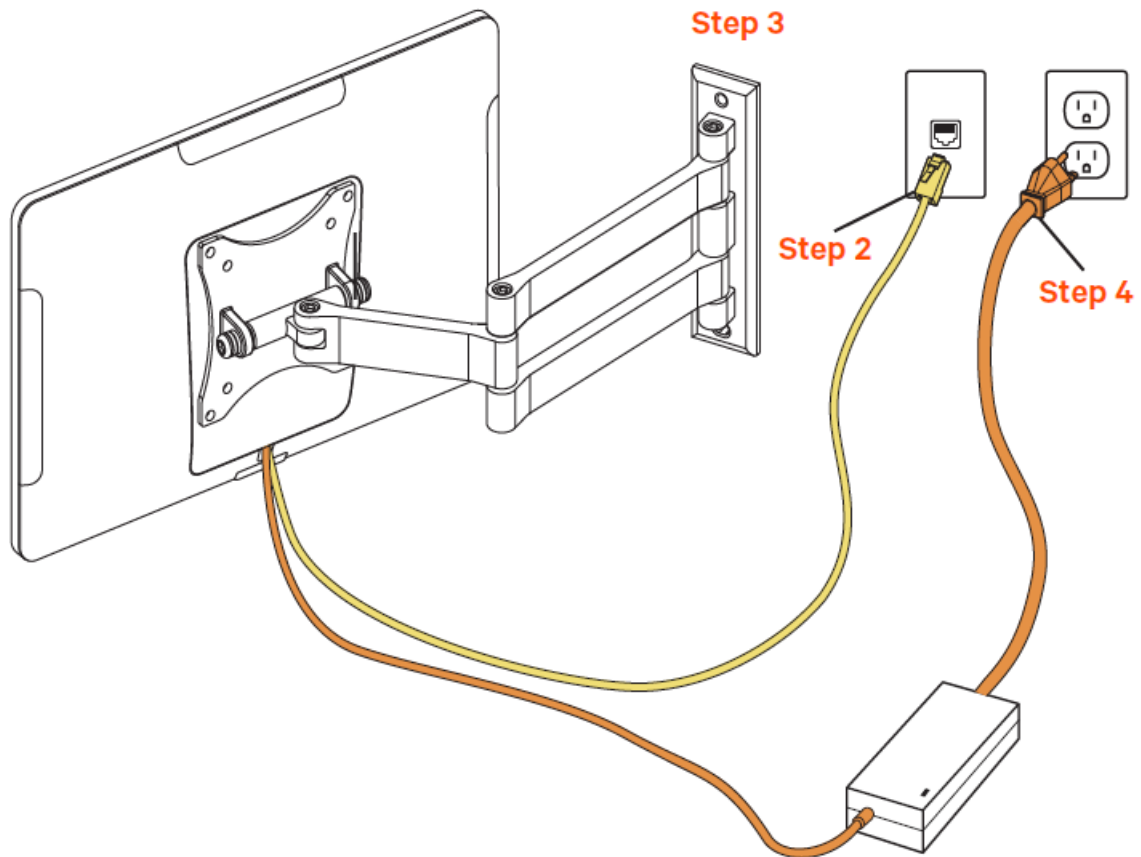

Toast does not drill holes. You will need to drill your own holes or have holes pre-drilled in the desired location.

**Product Name: Data Processing Machine**

- 14" Toast Flex – Model Name: TT200/TT200W, TT202/TT202W, TT203/TT203W
- 14" Toast Flex for Guest (Direct Attach) – Model Name: TT201/TT201W, TT204/TT204W
- 8" Toast Flex for Guest (On Counter) – Model Name: TW200/TW200W
- 14" Toast Flex for Kitchen – Model Name: TK200
- Toast Hub – Model Name: TH200

**Specifications: Toast Flex**

Operation System	Android 7.1
Processor	Rockchip ROK3399
LCD	14-inch, 1920 x 1080 resolution
Memory	16GB ROM + 4GB RAM
WIFI	Dual-band WIFI, 802.11 a/b/g/n (2.4GHz/5GHz) supported
Bluetooth	Bluetooth 4.0 BLE supported
Camera	5M FF MIPI Camera
Speaker	2W
External Ports	1 x RJ45 LAN port, 2x USB TypeC port, 1x HDMI-D port,
	1x customized TypeC port, 3x Micro-USB port
Power Adapter	Input: AC 100 240V/2.5A Output: DC 24 V/4, OA

### **Toast Flex for Guest**

LCD	8-inch, 1280 x 800 resolution
Camera	5M FF USB Camera
External Ports	1x Customized USB TypeC port, 2 x Micro-USB Port

### **Simplified Setting**

It only takes a few steps to turn on this Toast Flex. Press the power button and the screen will light up. Follow the instructions shown on the start-up screen. Two internet access modes are available for you to select.

#### **Wi-Fi Setting**

1. Press the [Setting] button and start WLAN to enter the WLAN search interface.
2. Search for the available WLAN hotspots.
3. Press the WLAN to be connected. If an encrypted network is selected,
  1. password is required for connection.

### **Precautions**

#### **Warning:**

- Please insert the AC plug into the AC outlet according to the identifying input on the power adapter.
- It is prohibited to use the device in any places with potential explosive gases.
- Nonprofessionals should not open the power adapter to avoid danger.
- Adapter should be installed near the equipment and be easily accessible.
- The operating temperature of the device is between -10°C to 40°C.

### **Recommendation**

- Do not use the device near water or in a humid environment.
- Keep liquid from falling on the Toast Flex.
- Do not use the device in extremely cold or hot environments, e.g. around fire or a lighted cigarette.
- Do not smash, throw, or bend the device.
- Use the device in a clean and dust free environment as much as possible and keep small items from falling into the Toast Flex.

## **Important Safety Instructions**

- Avoid installing or using during thunder and lightning; lightning strike may occur.
- Cut off the power immediately if there is abnormal smell, overheating, or smog.

## **Statement**

The company is not responsible for the following behaviors:

- Damage caused by using and maintaining the device without following the User Manual.
- Damage or problems caused by selection of objects of consumables (products which are not the initial ones provided or recognized by the company). In this case, the company will not undertake any responsibility. No one is entitled to modify or change the product unless permitted by the company.

## **Statement**

Discrepancies between the product and the file concerning details may occur due to product updates. The company reserves the right to interpret the file and the right to revise this manual without prior notice.

- Please make sure the temperature for adapter is between -10°C to 40°C.
- Please make sure the temperature for device is between -10°C to 40°C.

## **FCC Regulations**

This device complies with part 15 of the FCC Rules. Operation is subject to the following two conditions: (1) This device may not cause harmful interference, and (2) this device must accept any interference received, including interference that may cause undesired operation. This device has been tested and found to comply with the limits for a Class B digital device, pursuant to Part 15 of the FCC Rules. These limits are designed to provide reasonable protection against harmful interference in a residential installation. This equipment generates, uses, and can radiate radio frequency energy and, if not installed and used in accordance with the instructions, may cause harmful interference to radio communications. However, there is no guarantee that interference will not occur in a particular installation. If this equipment does cause harmful interference to radio or television reception, which can be determined by turning the equipment off and on, the user is encouraged to try to correct the interference by one or more of the following measures:

- Reorient or relocate the receiving antenna.
- Increase the separation between the equipment and receiver.
- Connect the equipment into an outlet or a circuit different from that to which the receiver is connected.
- Consult the dealer or an experienced radio/TV technician for help.

To comply with RF exposure requirements, a minimum separation distance of 20cm must be maintained between the user's body and the POS machine, including the antenna. Caution: Changes or modifications not expressly approved by the party responsible for compliance could void the user's authority to operate the equipment. **FCC ID: 2AMNG-TT200B**

## **IC Regulations**

This device complies with Industry Canada licence-exempt RSS standard(s). Operation is subject to the following two conditions:

1. this device may not cause harmful interference, and
2. this device must accept any interference received, including interference that may cause undesired operation

## **CAUTION**

1. the device for operation in the band 5150-5250 MHz is only for indoor use to reduce the potential for harmful interference to co-channel mobile satellite systems;
2. high-power radars are allocated as primary users (i.e. priority users) of the bands 5650-5850 MHz and that these radars could cause interference and/or damage to LE-LAN devices.

## **AVERTISSEMENT**

Radiofrequency (RF) Exposure Information The radiated output power of the Wireless Device is below the Industry Canada(IC) radio frequency exposure limits. The Wireless Device should be used in such a manner such that the potential for human contact during normal operation is minimized. The device has also been evaluated and shown compliant with the IC RF Exposure limits under mobile exposure conditions. ( antennas at least 20cm from a person's body)

## **Need Help With Troubleshooting?**

Contact Toast Support for any issues that may arise.

## **Meet Your Success Team**

We have teams of experts to support your restaurant and ensure you and your staff can focus on delighting your guests.

## **Support**

Support is your first line of defense for all Toast questions. Our Support team is available 24/7/365 and is trained to either help or route your request to the correct team at Toast.

- Call (617) 682-0225
- Chat with an agent online on Toast Central
- Submit a ticket on Toast Central

## **Restaurant Success**

The goal of Restaurant Success is to make sure you see the value of your new POS. Whether it's making sure that you're using all that Toast has to offer, to answering questions about new Toast updates, to helping you optimize your technology.

- Restaurant Success will contact you directly once you're live with Toast!

## **Check Out Your Resources**

Whether you're looking to master Toast or you're just getting started, we've got you covered!

## University

Toast University is a free virtual training tool available to all customers and their employees. The guided courses will help you train and ensure you get the most out of your Toast POS.

- Sign in through [central.toasttab.com](https://central.toasttab.com)



## Central

Toast Central is a simple, searchable online portal to find all your resources. Use our knowledge base to get answers to your top questions and learn more about how to use Toast POS.

- Visit [central.toasttab.com](https://central.toasttab.com)

“Toast University looks great! I’d love to have all of my new hires take all of the tests and then, upon successful completion, give them a raise.” MARTIN, TASTE OF PHILLY

## Documents / Resources

	<a href="#">toast TT200B Data Processing Machine</a> [pdf] User Manual TT200B, 2AMNG-TT200B, 2AMNGTT200B, TT200B, Data Processing Machine
	<a href="#">toast TT200B Data Processing Machine</a> [pdf] Installation Guide TT200B, 2AMNG-TT200B, 2AMNGTT200B, TT200B Data Processing Machine, Data Processing Machine

## References

-  [Toast Central](#)