



## tmezon Wireless Security Camera User Manual

[Home](#) » [TMEZON](#) » tmezon Wireless Security Camera User Manual 



Wireless Security Camera  
Quick Guide

APP installation video



<https://youtu.be/fHJGhR-ayHI>

## Contents

- 1 Interface Description
- 2 Software Installation
- 3 Camera adding process description
- 4 Wired add configuration process
- 5 FAQ
- 6 Documents / Resources
  - 6.1 References

## Interface Description

This manual is suitable for various types of cameras.

(The appearance may be different due to different batches. The details are subject to the receipt. This manual is only for the installation instructions of this series of equipment.)

### 1. Wireless Pan-tilt IP camera

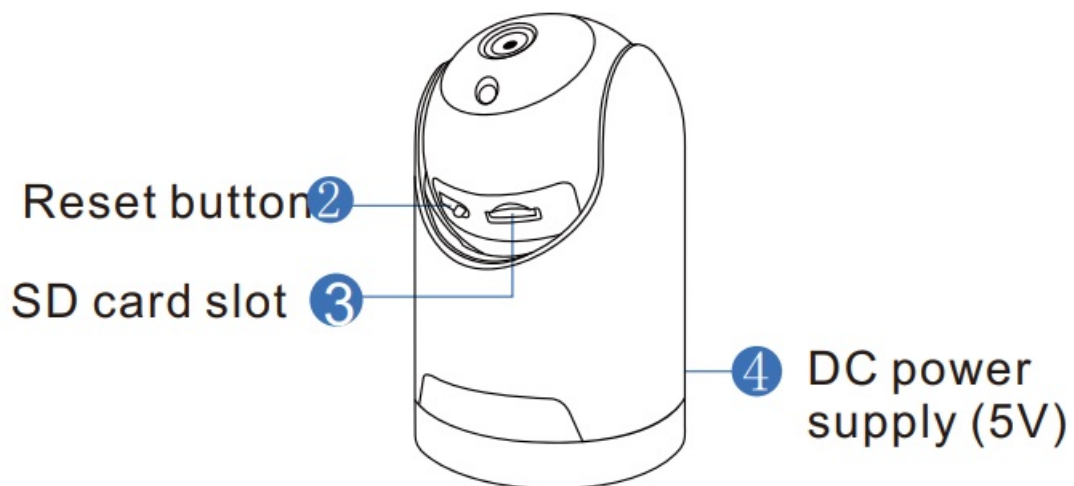

### 2. WiFi spot light camera

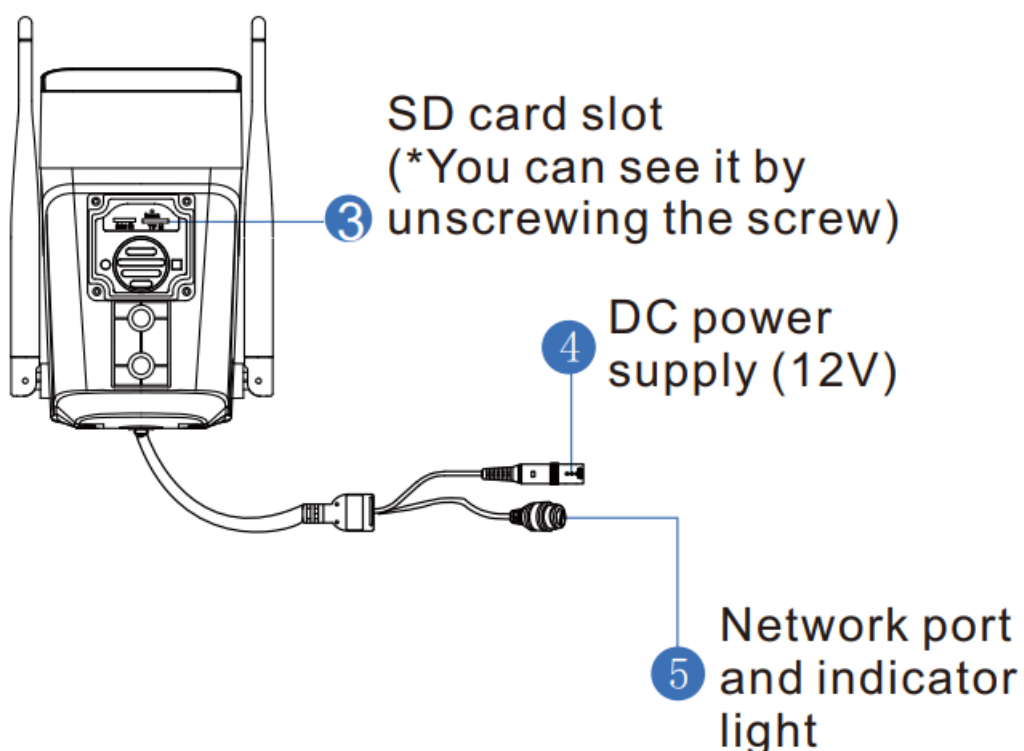

## Description

### 1. Photosensitive

Collect ambient luminosity value, turn on the infrared light when the current illuminance is less than 3Lux.

### 2. Reset button

The working state of the device, long press 3-5 seconds to restore the factory, the camera will have a voice prompt broadcast.

### 3. SD card slot

TF card, storage video and playback video.

### 4. DC power supply Power input

### 5. Network port and indicator light

Connect the LAN cable and check the current device status indicator light (flashes once/1s on hotspot mode)

## Software Installation

### APP download and Installation

Users can search “EseeCloud(IP Pro, VR Cam) ” on APP store or Google Play Store,or scan the QR code below to install the APP.



EseeCloud APP



APP Download

<http://www.dvr163.com/download/indexm.php>

**Note:** For IOS system, it requires IOS 9.0 version or above. For Android, Android 5.1 or above.

### Account login

Account login: On the login interface, enter the account/phone number/email, and the corresponding password, and click the “OK” button to log in.

Third-party login: APP supports third-party login. Click the third-party social software icon, jump to the APP to complete the authorization and log in.

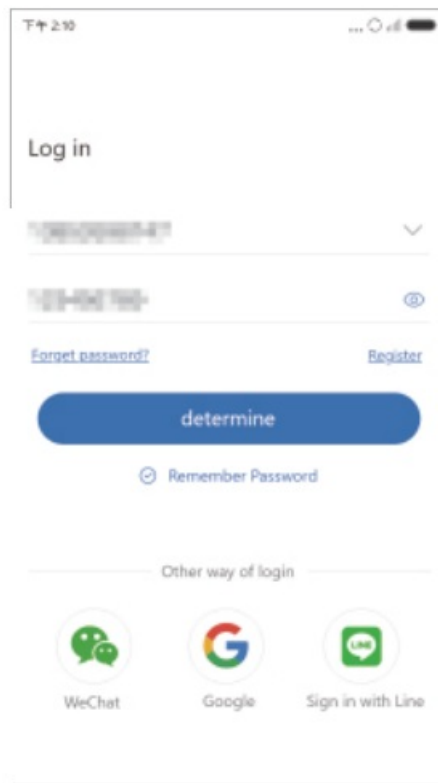

## Camera adding process description

1. Open the "EseeCloud" APP and click the "+" icon in the middle of the interface to enter the scan QR code interface;

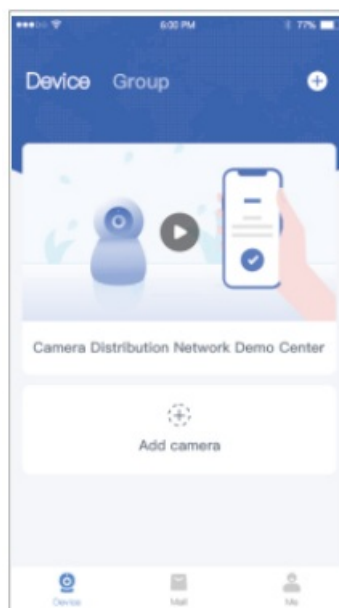

2. Scan the QR code on the device ;



3. On the Add device interface, click “Add”;



4. Reset the device and proceed to the next step; (Note: for this model, the indicator will not flash, just proceed to the next step)



5. To view and use via WiFi or other networks, please select Remote View; If there is no network, if you connect to the camera at close range, please select local Direct Connection;

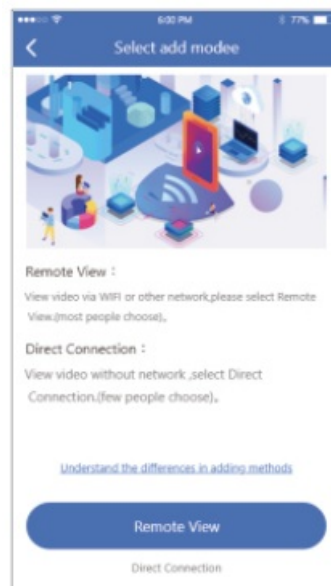

## Remote View adding process

1. Select "Remote View" to add, connect the device to WiFi, select the working WiFi that the device needs to connect to, enter the password, and click Next;



2. Use the device to scan the QR code of the mobile phone according to the operation shown in the figure, and proceed to the next step after hearing the prompt tone or the device indicator light no longer flashes;



3. After the network configuration is successful, the device name can be added successfully.

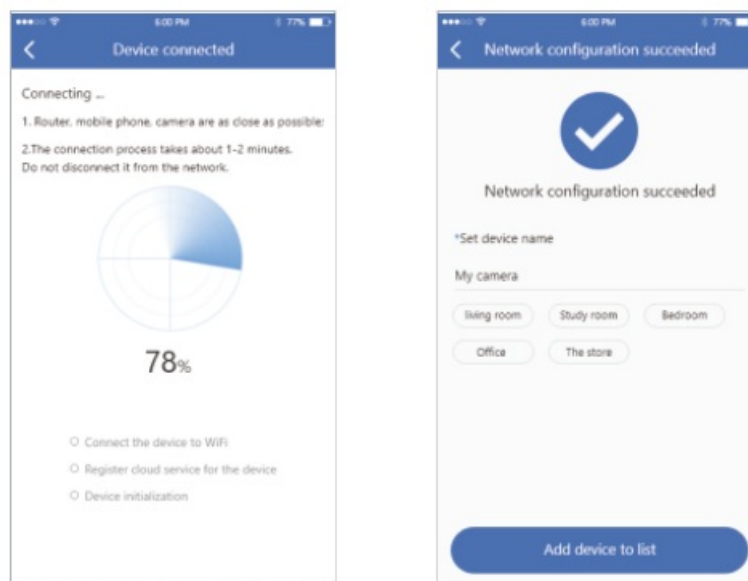

## Local direct connection add

1. Click "Direct Connection" set a password for the WiFi of the device, and enter the next step; (Direct connection can only be connected to the camera for viewing locally);

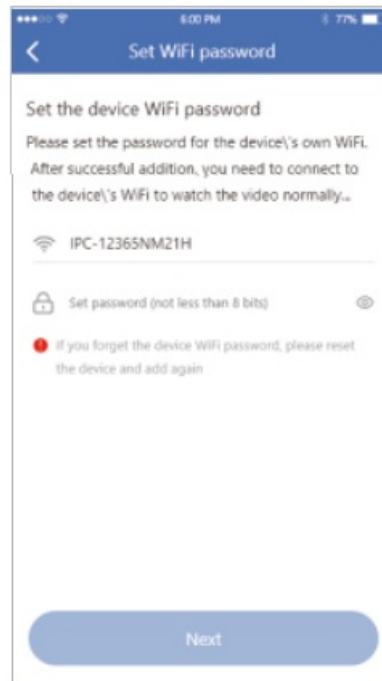

2. Use the device to scan the QR code of the mobile phone according to the operation shown in the figure, and go to the next step after hearing the prompt tone or the device indicator light no longer flashes;



3. According to the interface guide, after connecting the device with its own WiFi, return to the APP;



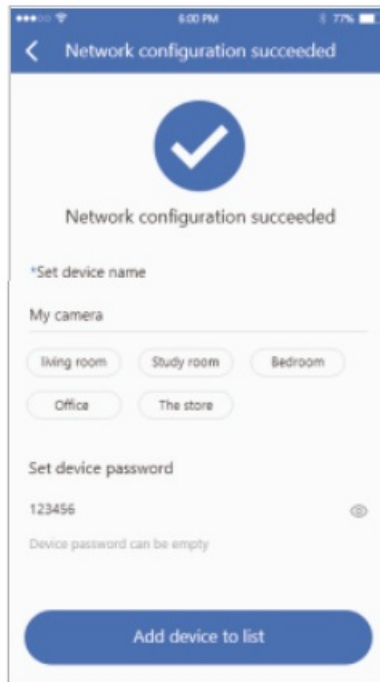

**Note:** the local direct connection needs to maintain a WiFi connection with the device to properly preview the device screen.

When the QR code of the device cannot be found (or the scan code is unsuccessful)

1. Connect to the IPCXXX hotspot in the phone settings, the password is 11111111;

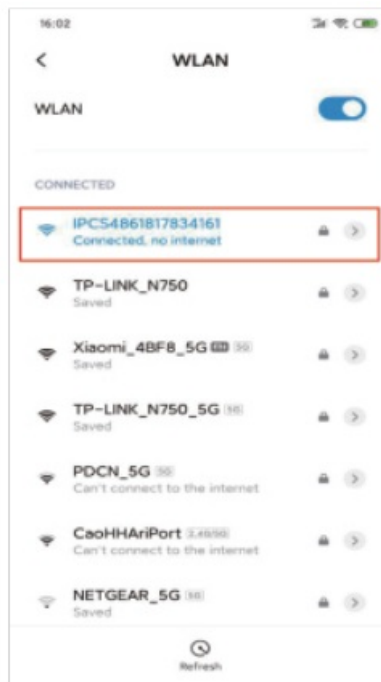

2. Click “Other ways to add” in the code scan interface, and select the “Standalone camera”.

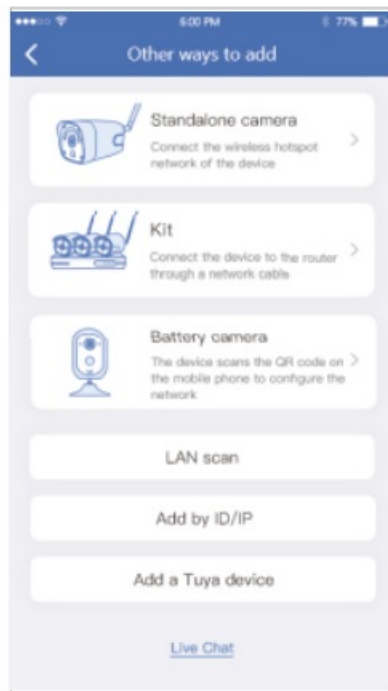

3. To view and use via WiFi or other networks, please select “Remote View “; if there is no network, to view the camera at close range, please select “Direct Connection” ;

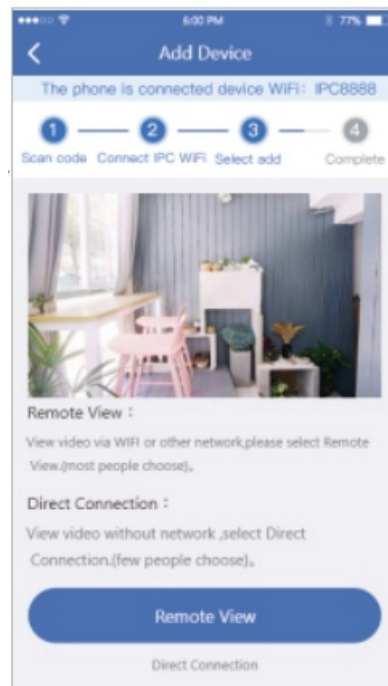

### Remote View adding process

1. Select “Remote View” to add, connect the device to WiFi, select the working WiFi that the device needs to connect to, enter the password, and click Next ;

2. Please wait patiently during the device configuration network;
3. The device is successfully added, please set a name for the device.

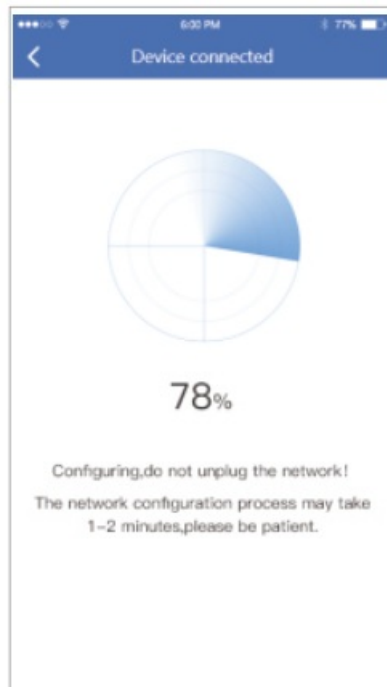

### Direct Connection adding process

Select "Direct Connection" to add, and set the name and password for the device to add successfully;

**Note:** The Direct Connection needs to be connected to the device hotspot to preview the device screen normally.

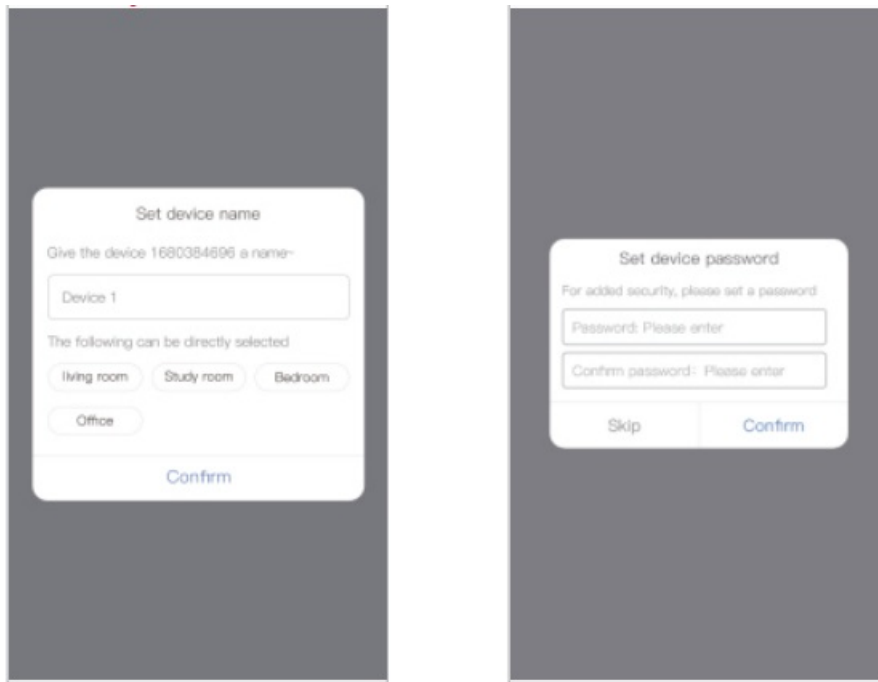

## Wired add configuration process

Power on the device, connect it to a router with internet access with a network cable.

1. Scan the QR code of the device, and click “Add”;

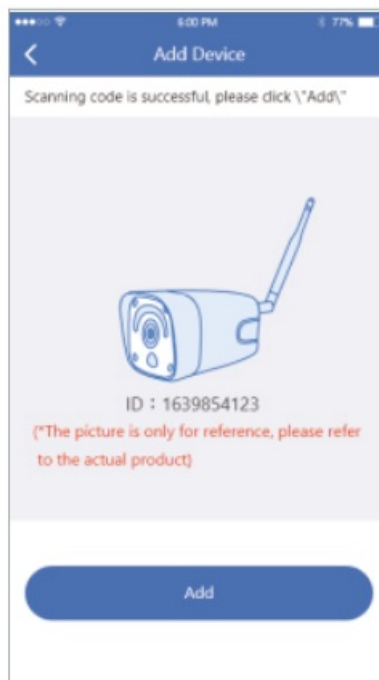

2. After setting the name for the device, it can be added successfully.

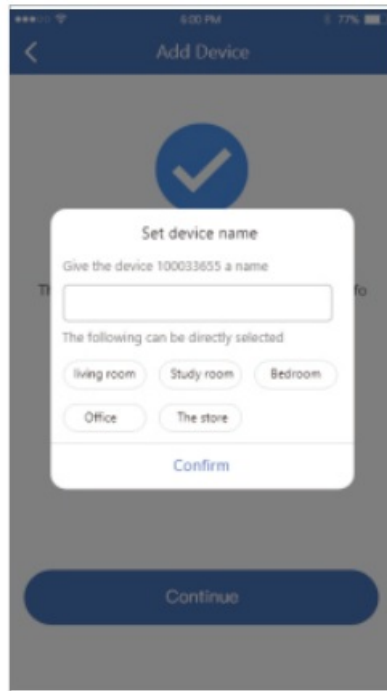

## FAQ

Questions	Answers
Why fail to add device to the app?	<ol style="list-style-type: none"> <li>1.Make sure that the WiFi is in 2.4Ghz, not 5Ghz.</li> <li>2.WiFi password should be less than 13 digits.</li> <li>3.Reset the camera and configure WiFi for the camera again.</li> </ol>
Why the video is not recorded?	<ol style="list-style-type: none"> <li>1. Make sure that SD card is recognized by the camera.</li> <li>2.If the SD card is not recognized by the camera, power off the camera, then power on the camera again, the camera will recognize the SD card. (Note: Please insert the SD card into the camera before powering on.)</li> </ol>

If you have any problem during the installation or the usage, please send email to our support team, we will help you solve the problem ASAP. Support email: [support@tmezon.com](mailto:support@tmezon.com)

Official Website: <http://www.tmezon.com>  
 Manufacturer: Zhuhai Tmezon Technology Co.,Limited  
 Address: No.6.Pingbei 2nd.Rd, NANPING  
 Technology Area, Zhuhai City,Guangdong,China

## Documents / Resources

	<a href="#">tmezon Wireless Security Camera</a> [pdf] User Manual Wireless Security Camera, Wireless, Security Camera, Camera
---	--

## References

- [📺 video intercom doorbell system wireless security system manufacturer wireless home security system secure closed circuit television camera-TMEZON](#)
- [User Manual](#)

Manuals+.