



Tizwis CL-V11 LED Fill Light User Manual

[Home](#) » [Tizwis](#) » Tizwis CL-V11 LED Fill Light User Manual 

Contents

- [1 Tizwis CL-V11 LED Fill Light](#)
- [2 Product Information](#)
- [3 Product Usage Instructions](#)
- [4 Preface](#)
- [5 Product introduction](#)
- [6 Product installation](#)
- [7 Function and display](#)
- [8 Specifications](#)
- [9 Documents / Resources](#)
 - [9.1 References](#)
- [10 Related Posts](#)

Tizwis

Tizwis CL-V11 LED Fill Light



Product Information

Specifications

- Product Name: LED Fill Light
- Models: CL-V11, CL-V11SE, CL-V11R
- Ultra-thin design
- Color temperature/brightness adjustable
- Built-in 3000mAh battery
- Approximately 2 hours of continuous lighting
- Compatibility: Mobile phones and laptops

Product Usage Instructions

Matters Needing Attention

1. This fill light does not have waterproof and dustproof functions.
2. Do not let this fill light be strongly impacted.
3. Do not look directly at the light-emitting surface of the fill lamp in use for a long time in a static distance, or it may damage your vision.
4. After charging, unplug the power cord.
5. After not using this product for a long time, the battery should be fully charged before using this product again, otherwise it may lead to no power and unable to start.
6. To extend the service life of the battery, it is recommended to charge and maintain it every three months.
7. This product has a built-in rechargeable lithium battery, which has a certain life limit. After a certain period of use, the performance will be reduced, which is a normal phenomenon.

Product Installation

Fixing Clip 1

It is fixed through the 1/4 screw hole and can be fixed by screwing the knob. (Compatible with other accessories linked by 1/4 screw)

Fixing Clip 2

1. First install the single leg of the fixing clip into the slot on the back of the fill lamp.
2. Then push the fixing clip towards the direction of both feet until the two feet of the fixing clip are also installed in the slot of the fill lamp.
3. Screw out the mobile phone mounting base of fixing clip 2.
4. Place the mobile phone in the direction as shown in the figure.

Function and Display

• CL-V11

- **ON/OFF:** Press and hold the power button for 3 seconds to turn on the fill light. Press and hold the power button again for 3 seconds to turn off the light.
- **Parameter Settings:** Briefly press the M button to toggle color temperature/brightness options. Use the +/- buttons to adjust the parameter values.
- **Charge:** When using Type-c or Micro-USB interface to charge, the battery indicator will flash in flowing water. When the indicator is no longer flashing, it means that the charging is completed.

• CL-V11SE and CL-V11R

- **ON/OFF:** Press and hold the power button for 3 seconds to turn on the fill light. Press and hold the power button again for 3 seconds to turn off the light.
- **Mode Switching:** Briefly press the power button to switch modes, CCT/HSV/special effect, and three modes are switched.
- **Parameter Adjustment:** In any mode, briefly press the M key to switch between different parameters, and use the +/- keys to adjust the parameter values.

FAQ

• Q: Does the fill light have waterproof and dustproof functions?

A: No, the fill light does not have waterproof and dustproof functions.

• Q: How long does the battery last?

A: The built-in 3000mAh battery can provide approximately 2 hours of continuous lighting.

Preface

Thank you for purchasing our products!

This is an ultra-thin fill light, which is compact and convenient to use. This product can be used for fill light in mobile phones and laptops, with a variety of color temperature/brightness adjustable, Built-in 3000mAh battery can provide about 2 hours of continuous lighting.

Please read this manual carefully before use, and keep it for future reference after reading.

Matters needing attention

1. This fill light does not have waterproof and dustproof functions.
2. Do not let this fill light be strongly impacted.
3. Do not look directly at the light-emitting surface of the fill lamp in use for a long time in a static distance, or it may damage your vision.
4. After charging, unplug the power cord.
5. After not using this product for a long time, the battery should be fully charged before using this product again, otherwise it may lead to no power and unable to start.
6. To extend the service life of the battery, it is recommended to charge and maintain it every three months.
7. This product has a built-in rechargeable lithium battery, which has a certain life limit. After a certain period of use, the performance will be reduced, which is a normal phenomenon.

Product introduction

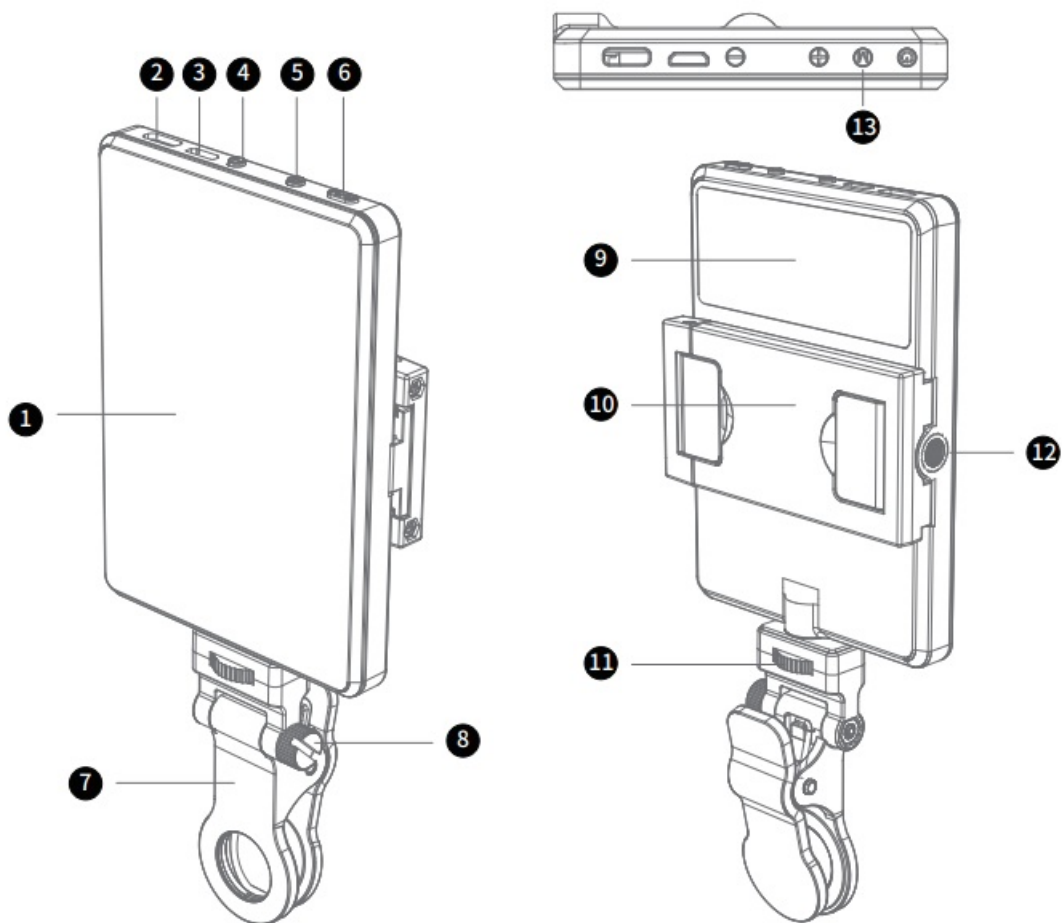

1. Luminous surface
2. Type-c charging port
3. Micro-usb charging port
4. Value decrease button
5. Value increase button
6. Power/mode switch
7. Retaining clip 1
8. Angle adjustment knob
9. Indicator/display

10. Retaining clip 2
11. Fixed knob
12. 1/4 screw hole
13. Parameter switching

Product installation

Fixing clip 1

It is fixed through 1/4 screw hole and can be fixed by screwing the knob. (Compatible with other accessories linked by 1/4 screw).

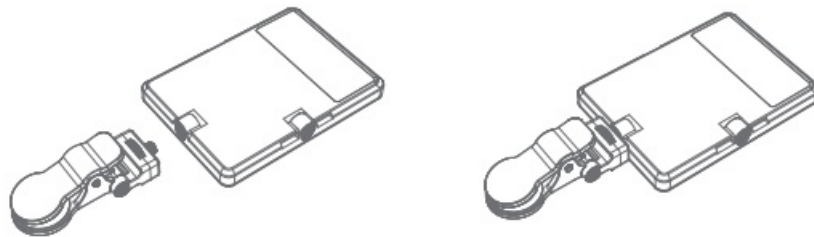

Fixing clip 2

1. First install the single leg of the fixing clip into the slot on the back of the fill lamp.
2. Then push the fixing clip towards the direction of both feet until the two feet of the fixing clip are also installed in the slot of the fill lamp.
3. Screw out the mobile phone mounting base of fixing clip 2.
4. Place the mobile phone in the direction as shown in the figure.

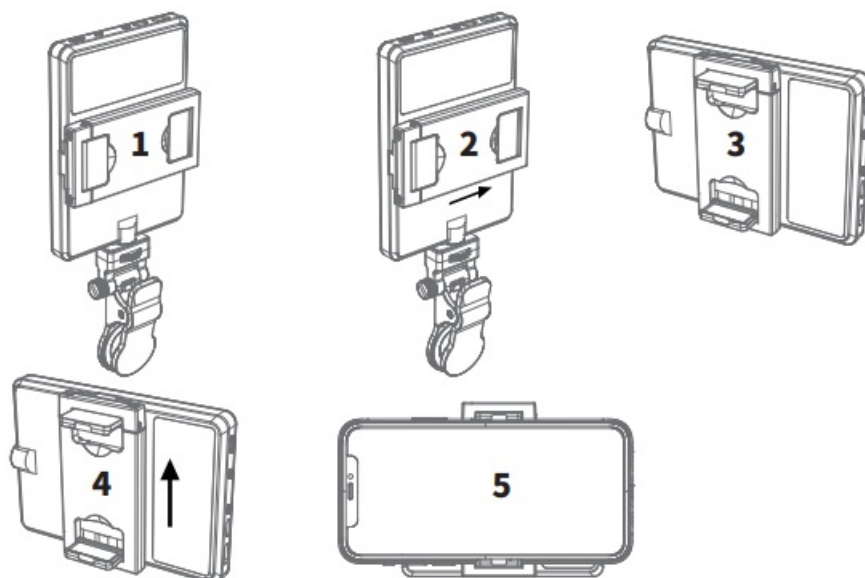

Function and display

CL-V11

• ON/OFF

Press and hold the power button for 3 seconds, and the fill light will turn on. Press and hold the power button again for 3 seconds to turn off the light.

- **Parameter settings**

Briefly press the “M” button to Toggle color temperature/brightness options. Use the “+”/“-” buttons to adjust the parameter values.

- **Charge**

When using Type-c or Micro-USB interface to charge, the battery indicator will flash in flowing water, When the indicator is no longer flashing, it means that the charging is completed.

CL-V11SE

- **ON/OFF**

Press and hold the power button for 3 seconds, and the fill light will turn on. The default is white light mode.

Press and hold the power button again for 3 seconds to turn off the light.

- **Mode switching**

Briefly press the power button to switch between warm light, cold light and white light.

- **Brightness adjustment**

In any mode, use the “+”/“-” keys to adjust the brightness, which can be adjusted by 10 levels.

- **Charge**

When using Type-c or Micro-USB interface to charge, the battery indicator will flash in flowing water, When the indicator is no longer flashing, it means that the charging is completed.

CL-V11R

- **ON/OFF ON/OFF**

Press and hold the power button for 3 seconds, and the fill light will turn on. Press and hold the power button again for 3 seconds to turn off the light.

- **Mode switching**

Briefly press the power button to switch modes, CCT/HSV/ special effect, and three modes are switched.

- **Parameter adjustment**

In any mode, briefly press the “M” key to switch between different parameters, and use the “+”/“-” keys to adjust the parameter values

- **Special effect mode**

Support 24 kinds of special effects.

- **Charge**

When using Type-c or Micro-USB interface to charge, the battery indicator will flash in flowing water, When the indicator is no longer flashing, it means that the charging is completed.

Specifications

Model		CL-V11		
Colour		2500 K-9000 K \pm 200 K		
Brightness		0-100%		
LED Qty		60pcs		
illuminanc e lux		2500 K	4500 K	9000 K
distance	0.3 m	900	1200	1000
	0.5 m	350	500	400
CRI		\geq 95		
TLCI		\geq 97		
Battery		3.7 V 3000mA h 11.1W h		
Power		5 W		
Duration		About 1.5 hours		
Input		5V/1A		
Charging port		Type- C/Micro-usb		
Fixed interface		1/4 screw hole, retaining clip 1, retaining clip 2		
Size		104*75*11.8mm		
Weight		About 140 g		
Accessories		LfiEx iDnlgi gchlTi*p11, ,Tfiyxpien-gC cclhi pa r2ging cable*1,		

Model		CL-V11SE		
Colour		2500 K/4500K/9000 K \pm 200 K		
Brightness		10 levels adjustable		
LED Qty		60pcs		
illuminance lux		2500 K	4500 K	9000 K
distance	0.3 m	900	1200	1000
	0.5 m	350	500	400
CRI		\geq 95		
TLCI		\geq 97		
Battery		3.7 V 3000mA h 11.1W h		
Power		5 W		
Duration		About 1.5 hours		
Input		5V/1A		
Charging port		Type- C/Micro-usb		
Fixed interface		1/4 screw hole, retaining clip 1, retaining clip 2		
Size		104*75*11.8mm		
Weight		About 140 g		
Accessories		LfiEx iDnlgi gchlti*p11, ,Tfiyxprien-gC cclhi pa r2ging cable*1,		

Model		CL-V11R				
CCT		2500 K-9000 K \pm 200 K				
Brightness		Brightness adjustment range 0-100 %				
LED Qty		RGB:30pcs BI 48pcs				
illuminance lux		Warm light	Cold light	Red	Green	Blue
distance	0.3 m	900	1000	200	100	400
	0.5 m	350	400	80	40	180
CRI		\geq 95				
TLCI		\geq 97				
RGB HSV		0-35 9 Full color				
Special effect		24 kinds				
Battery		3.7 V 3000mA h 11.1W h				
Power		5 W				
Duration		About 1.5 hours				
Input		5V/1A				
Charging port		Type- C/Micro-usb				
Fixed interface		1/4 screw hole, retaining clip 1, retaining clip 2				
Size		104*75*11.8mm				
Weight		About 140 g				
Accessories		fiL Ex iDnIgi gchlti*p11, ,Tfiyxpien-gC cclhi pa r2ging cable*1,				

The specifications and parameters of this product are tested by the company's laboratory samples. The finished product may have some differences ,which will not affect the normal use; if the design and specifications changed will not prior notice.

Documents / Resources

	Tizwis CL-V11 LED Fill Light [pdf] User Manual CL-V11, CL-V11SE, CL-V11R, CL-V11 LED Fill Light, LED Fill Light, Fill Light, Light
---	---

References

- [User Manual](#)