



Titus TAF-R Access Floor Diffuser Series Short Throw Instructions

[Home](#) » [Titus](#) » Titus TAF-R Access Floor Diffuser Series Short Throw Instructions 

Titus TAF-R Access Floor Diffuser Series Short Throw Instructions



Contents

- [1 Instructions](#)
- [2 General Description](#)
- [3 Documents / Resources](#)
- [4 Related Posts](#)

Instructions

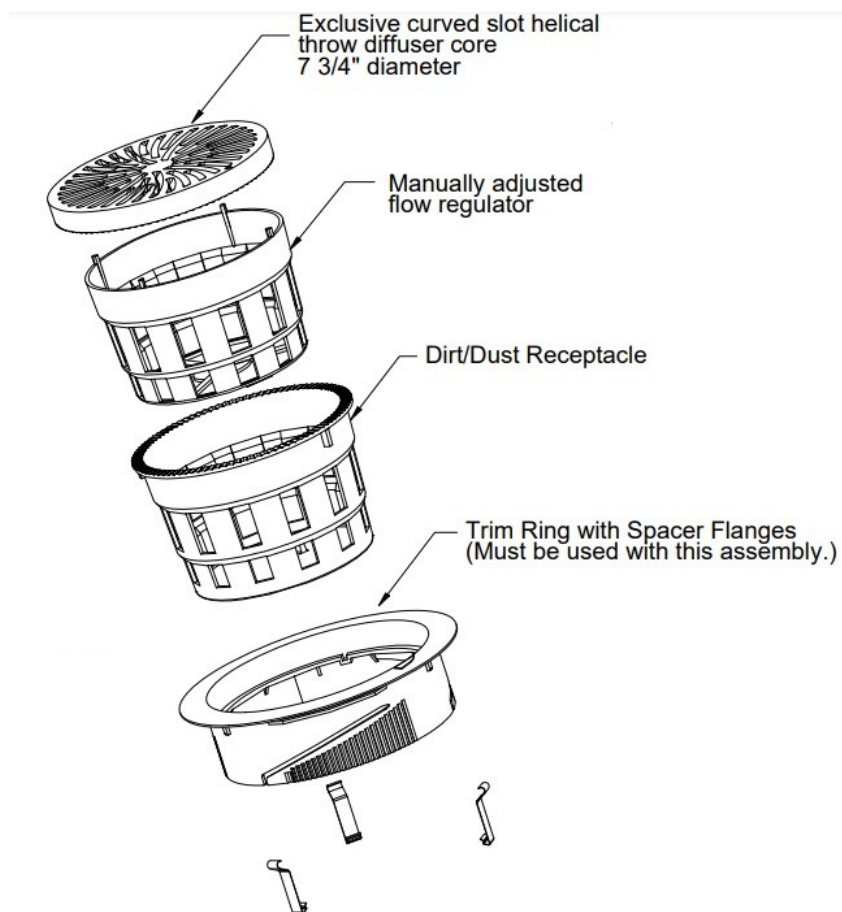

Open/Close indicator is raised from trim ring and diffuser core

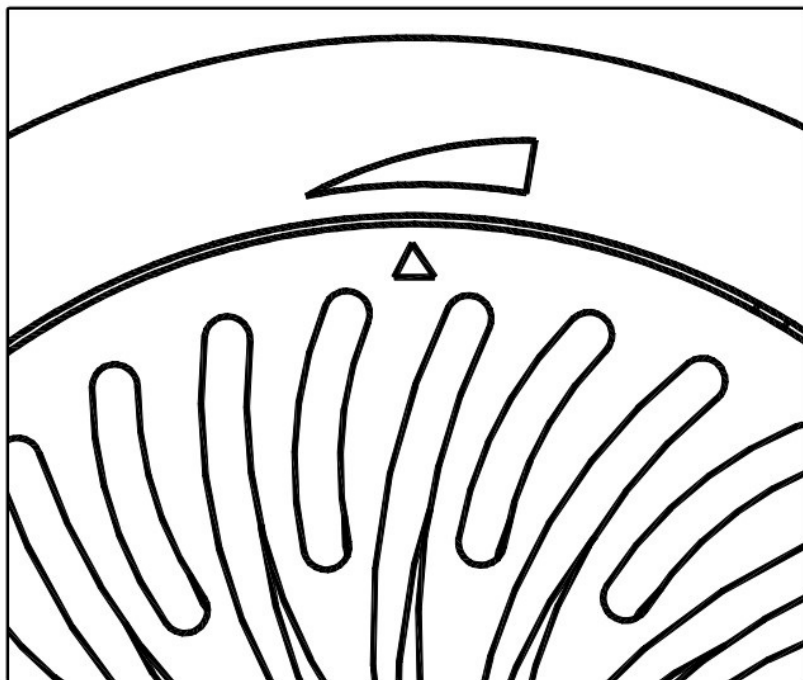

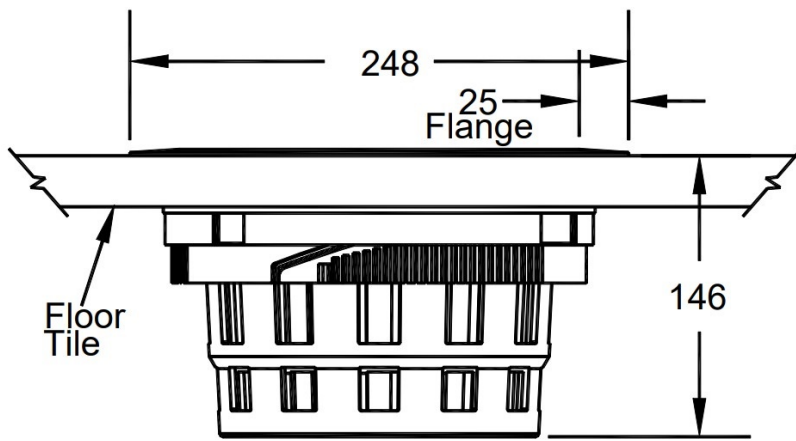

All dimensions are in millimeters.

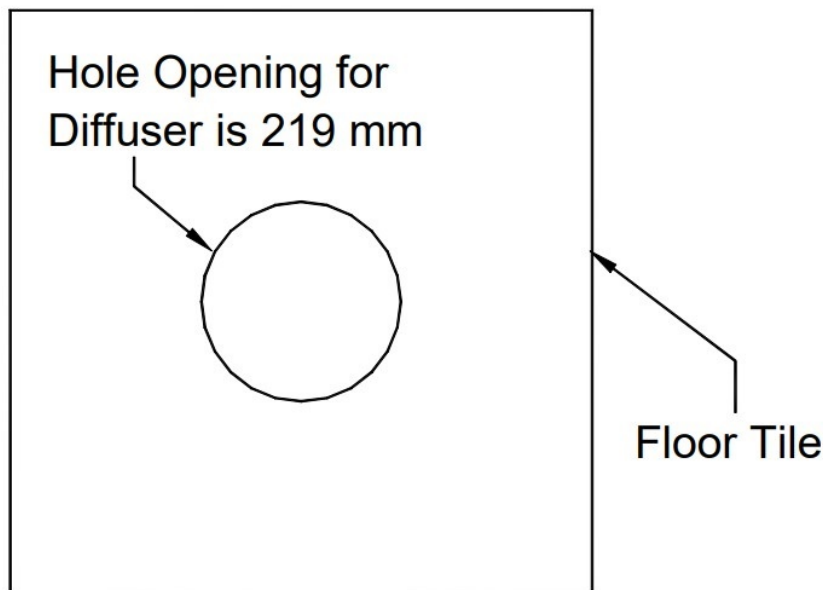

General Description

- The TITUS Model TAF-R is designed for application in access floor air distribution systems.
- All components are constructed of a highimpact polymer material, designed to resist damage from traffic.
- Complies to NPFA 90B structural requirement for floor diffusers.
- TAF-R diffuser material complies with UL-94-5V standard for flammability.
- High induction helical air pattern creates ideal circulation without excess inlet pressure requirements.
- Removable flow regulator is manually operated without removing the core.
- Optional actuated flow regulator automatically adjusts the airflow based on setpoint and zone temperature (thermostat required).
- External Open/Close indicator coupled with the internal Open/Close stop allow visual determination of damper position.
- Architecturally appealing core design is available in standard light gray or black color.

On standard gray units only the core & trim ring are available in gray. All other components (beneath the floor tile) are black.

Open/Close indicator is raised from diffuser trim ring and core to be visually appealing.

Optional colors may be specified to match any building interior's scheme.

- The trim ring's extra wide flange is designed to prevent carpet from pulling away from the diffuser.
- The spring clip attached to the trim ring is designed for rapid and secure press fit installation in raised floor panels.
- With the diffuser installed in the floor panel, relocation to another zone is simply done through relocating the floor panel.
- Dirt/dust collection receptacle can be easily removed for cleaning.
- Diffuser can be installed after flooring and carpet installation are complete.
- The minimum order quantity for custom colors is 500 units. Quantities less than 500 will be handled on a quotation basis from Titus.
- All custom colors are subject to the setup charge. The Leadtime on special colors is dependent on the matching process and may vary. A sample of the color to be matched must accompany the order on orders with special colors. When ordering a special color, we recommend ordering an additional 5% more units for replacement.

This submittal is meant to demonstrate general dimensions of this product. The drawings are not meant to detail every aspect of the product. Drawings are not to scale. Titus reserves the right to make changes without written notice.

All rights reserved. No part of this work may be reproduced or transmitted in any form or by any means, electronic or mechanical, including photocopying and recording, or by any information storage retrieval system without permission in writing from Tomkins Industries, Inc.

Documents / Resources

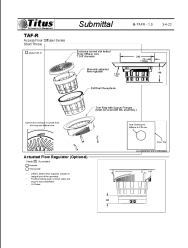
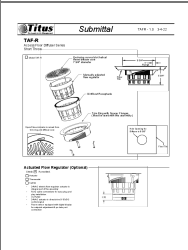
	<p>Titus TAF-R Access Floor Diffuser Series Short Throw [pdf] Instructions</p> <p>TAF-R Access Floor Diffuser Series Short Throw, TAF-R, Access Floor Diffuser Series Short Th row, Floor Diffuser Series Short Throw, Diffuser Series Short Throw, Short Throw, Throw</p>
	<p>Titus TAF-R Access Floor Diffuser Series Short Throw [pdf] User Manual</p> <p>TAF-R Access Floor Diffuser Series Short Throw, TAF-R, Access Floor Diffuser Series Short Th row, Access Floor Diffuser, Floor Diffuser, Diffuser</p>