

TITAN ARMY P24H2P 24 Inch Computer Monitor



# TITAN ARMY P24H2P 24 Inch Computer Monitor User Manual

[Home](#) » [TITAN ARMY](#) » TITAN ARMY P24H2P 24 Inch Computer Monitor User Manual 

## Contents

- [1 TITAN ARMY P24H2P 24 Inch Computer Monitor](#)
- [2 Specifications](#)
- [3 Product Usage Instructions](#)
- [4 Package Content](#)
- [5 Installation](#)
- [6 Adjustment of monitor](#)
- [7 Instructions](#)
- [8 OSD menu](#)
- [9 Basic parameters](#)
- [10 FCC](#)
- [11 FAQ](#)
- [12 Documents / Resources](#)
  - [12.1 References](#)
- [13 Related Posts](#)



**TITAN ARMY**

**TITAN ARMY P24H2P 24 Inch Computer Monitor**



## Specifications

- **Model:** P24H2P
- **Supply Voltage:** : Printed on the label on the rear casing
- **Power Adapter:** Included
- **Package Content:** Monitor, Base, Stand stem, Screws, Mount adapter, HDMI signal cable, User Manual

## Product Usage Instructions

### Precautions

- Keep the monitor away from water sources or damp places.
- Place the monitor on a flat surface to prevent falls.
- Store and use the monitor in a cool, dry, and well-ventilated place.
- Avoid covering or blocking the vent hole in the rear casing.
- Do not use the product on a bed, sofa, blanket, or similar objects.
- Determine the supply voltage from the label on the rear casing or consult the distributor or local power company.
- If the monitor will not be used for a long period, cut off the power supply to avoid electric shock and damage due to abnormal supply voltage.
- Use a reliable grounded socket and do not overload it.
- Avoid putting foreign matters into the monitor to prevent short circuits and potential fire or electric shock hazards.
- Do not disassemble or repair the product by yourself. Contact the after-sales service for assistance with faults.

- Avoid pulling or twisting the power cable forcefully.
- Do not peel off the polarizer layer on the surface of the screen to prevent damage and maintain warranty validity

## **Precautions**

- Keep the monitor away from water sources or damp places, such as bathrooms, kitchens, basements, and swimming pools.
- Make sure the monitor is placed on a flat surface. If the monitor falls, it may cause human injury or device damage.
- Store and use the monitor in a cool, dry, and well-ventilated place, and keep it away from emission and heat sources.
- Do not cover or block the vent hole in the rear casing, and do not use the product on a bed, sofa, blanket, or similar objects.
- The range of the supply voltage of the monitor is printed on the label on the rear casing. If it is impossible to determine the supply voltage, please consult the distributor or local power company.
- If the monitor will not be used for a long period, please cut off the power supply to avoid electric shock in rainy days and damage due to abnormal supply voltage.
- Please use a reliable grounded socket, Do not overload the socket, or it may cause fire or electric shock.
- Do not put foreign matters into the monitor, or it may cause short circuits resulting in or electric shock.
- Do not disassemble or repair this product by yourself to avoid electric shock. If faults occur, please contact the after-sales service directly.
- Do not pull or twist the power cable forcefully.
- There is a polarizer layer (not a protective film) on the surface of the screen. Do not peel it off, or the product may be damaged and the warranty will be invalid.

## **Package Content**

### **Packing list**

- Please check that the package of the monitor contains all the parts. If any part is lost, please contact the distributor.
- The color and shape of parts may vary with models. Figures in this User Manual are for reference only.
- Cables supplied may vary with purchased products. Figures in this User Manual are for reference only.



Monitor



Base



Stand stem



❶ Screws x5  
(KM4x10)



❷ Screws x3  
(KM4x14)

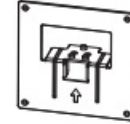

Mount adapter



Power adapter

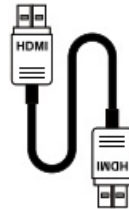

HDMI signal cable



User Manual

- Redundant screws can be used as spare screws.

## Installation

1. Open the carton package, take out the foam, and put it flat on the tabletop. Keep the foam underneath the monitor before attaching the stand.

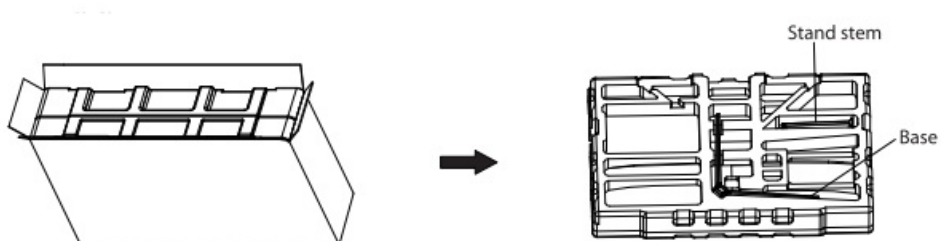

2. Take out the bracket and place it on the machine shaft and fix it with two screws.

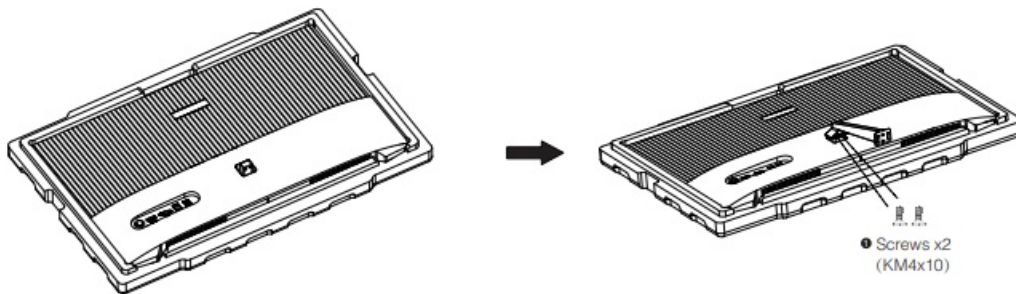

3. Take out the base, align it with the bottom of the stand, and fix it with two screws.

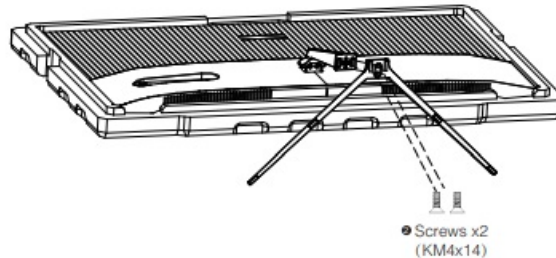

4. After assembly, simply hold the stand with your hand to stand the monitor upright.

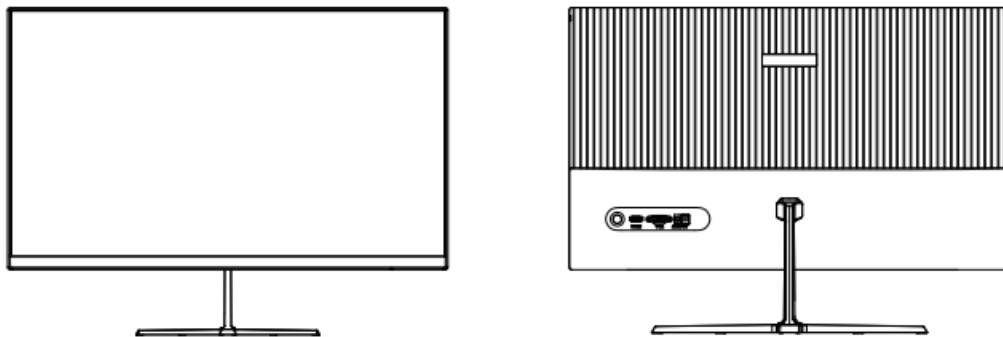

**Note:** During standing of the whole monitor, do not press the liquid crystal screen with your hand to avoid damage to the screen.

### Installation of mount

1. Open the carton, take out the product with foam still attached, and gently place it on a desktop or table. Remove the extra parts and the foam covering the back of the monitor.

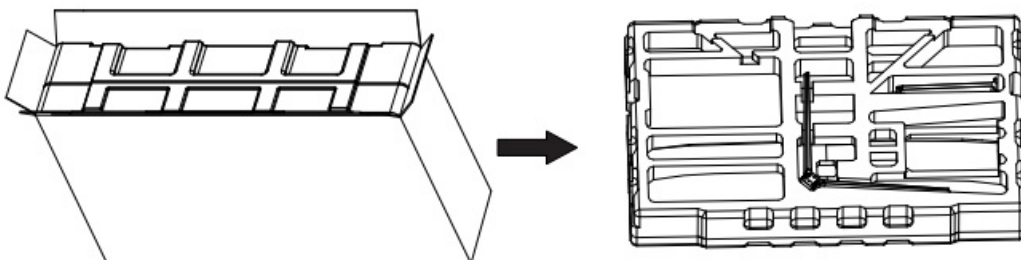

2. Put the monitor in the lower foam cover. Take out the mount adapter and 2 KM4x10 screws and tighten the mount adapter with the screws.

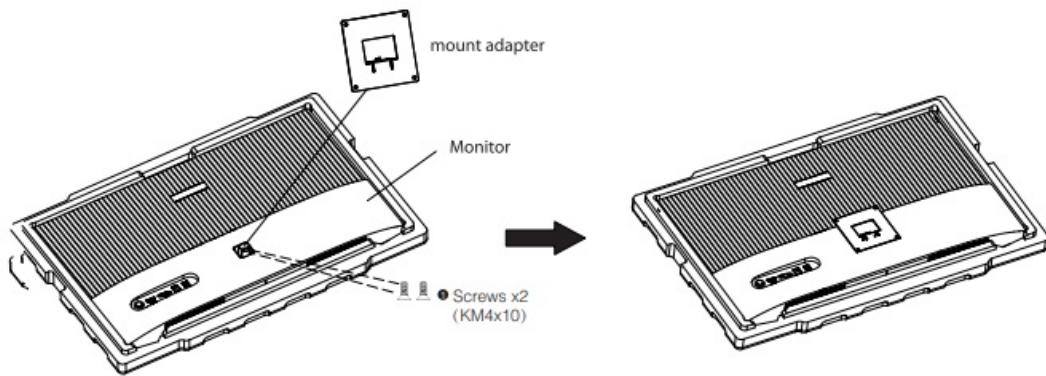

3. **Note:** Hang the assembled product on a hard wall. Do not pinch the screen with your hands during the hanging process to avoid damaging the screen.

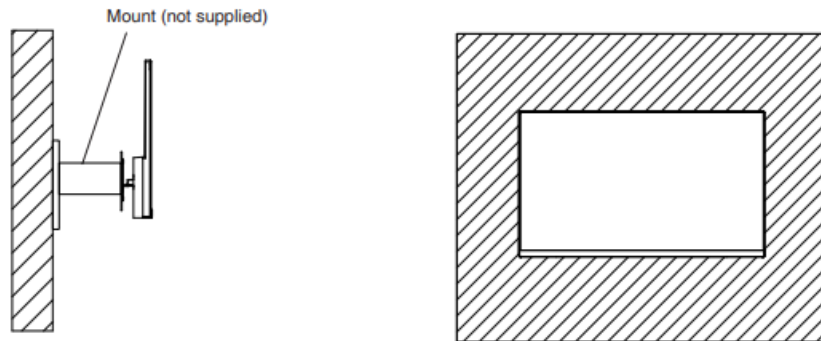

**Note:** To prevent the monitor from falling when it is used on the wall, please install it properly and do safety protection. Do not place or hang any objects on the wall bracket, and the wall height should be within 2 meters.

## Adjustment of monitor

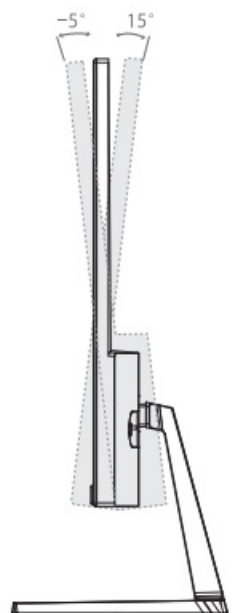

Tilting angle  
 $-5.0^{\circ}(\pm 2.0^{\circ}) - +15^{\circ}(\pm 2.0^{\circ})$

## Instructions

### Description of buttons

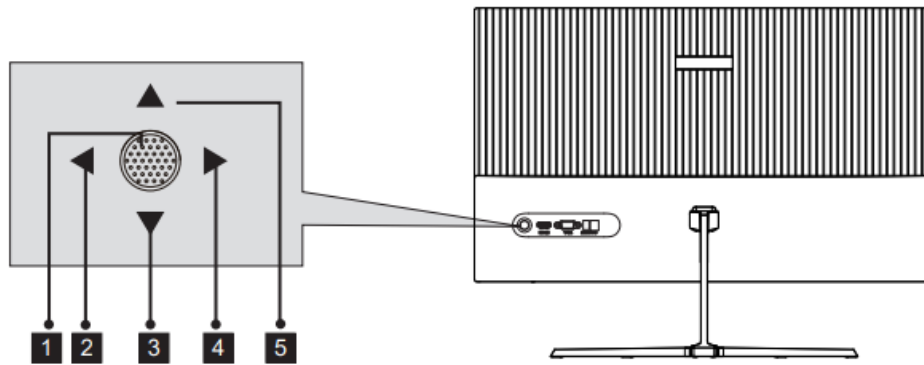

BUTT ON	FUNCTION
1	Power button: Turn on/of the monitor
2	Exit/Left button: Enter the Input select. Return to the previous menu to the left, and exit the current menu.
3	Down button: Enter the game aiming. Move down the menu option or decrease the function value.
4	Right button: Enter the OSD menu. Dial right to select a submenu and enter the next menu.
5	Up button: Enter the view mode options. Move up the menu option or increase the function value.

#### Explanation of indicators

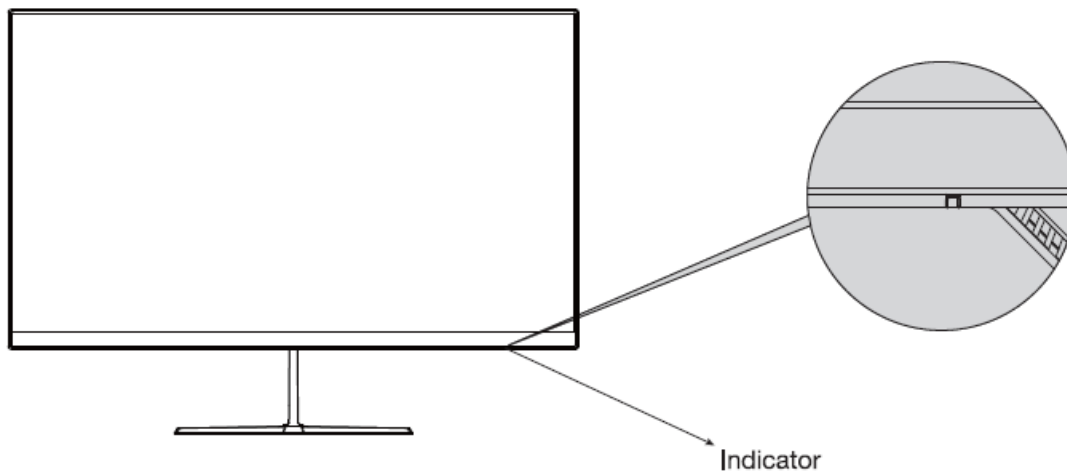

**Indicator:** A steady blue light indicates that the power is on and the monitor is operating normally. Red light indicates there is no video source and no horizontal or vertical signal or low voltage is detected, and that the monitor is in standby status. Make sure your computer is turned on and all video cables are fully plugged in and/or connected.

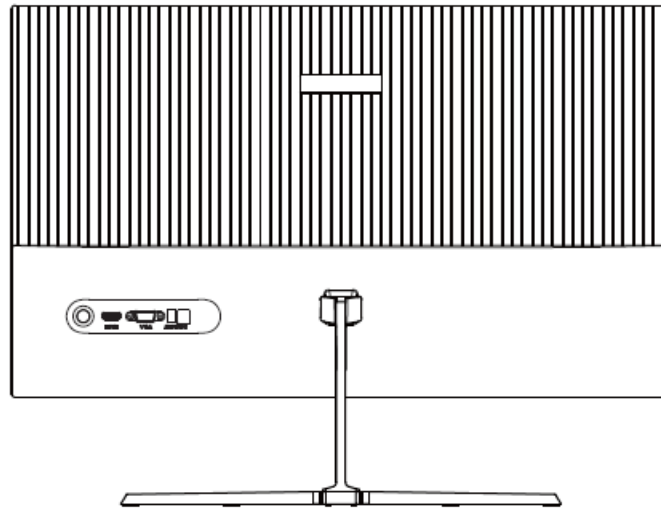

- The bottom interface configuration at the back of the monitor varies with products.
- **Note:** If the power cable or signal cable is damaged, you must replace it with special soft cables or special components purchased from the manufacture or maintenance department.

## HDMI interface

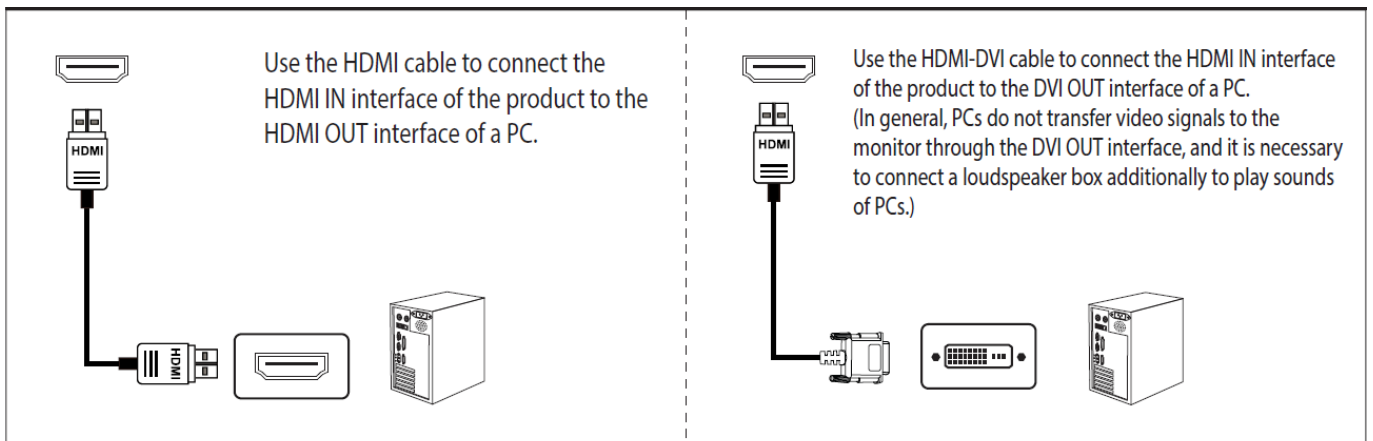

## VGA interface



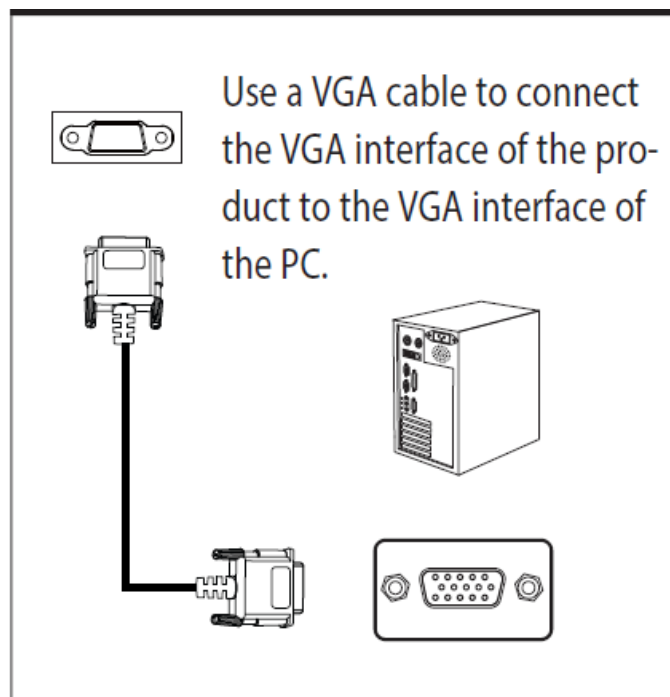

## AUDIO OUT

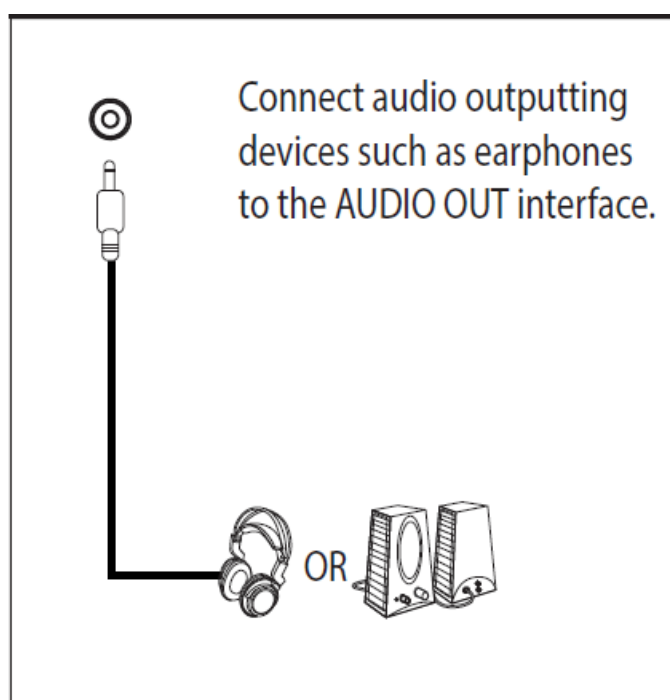

## DC IN

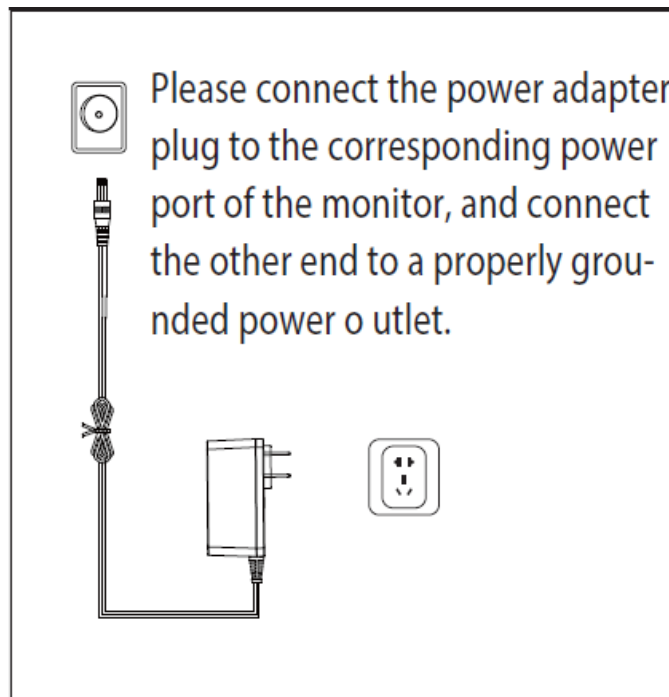

## OSD menu

### Menu description

- The color and shape of the OSD menu of the actual computer may be slightly different from them shown in the figure.
- Specifications of the OSD menu may change with improvements of functions without prior notice.

Press the menu button on the control panel to access the monitor menu. The detailed information of each menu can be found in the following sections.

1. Press  to enter the OSD menu.

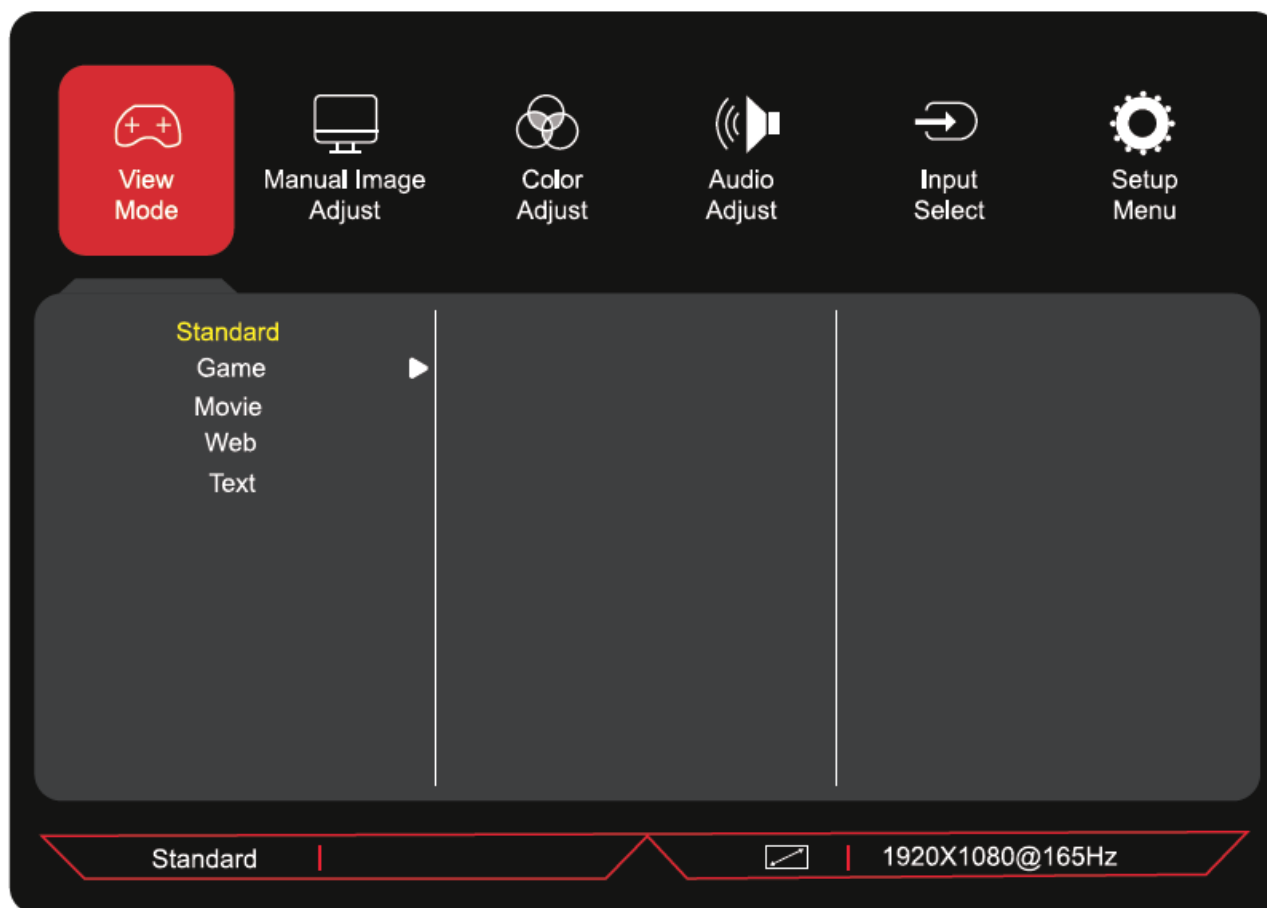

2. Press or to scroll through the functions.
  - Highlight the features you want to set, and press to open the sub-menu.
  - Press or to browse the sub-menu and press to highlight the features you want to see.
  - Press or to highlight the options and press to confirm the settings and exit the current screen.
3. Press to return to the previous menu or exit the current menu

Functions of the monitor vary with models, and the functions in this manual are for reference only.

View Mode	Standard		
	Game	FPS1	
		FPS2	
		RTS	
		Night Vision	
		GAMER1	Black Stabilization Advanced DCR Blue Light Filter Response Time Recall
		GAMER2	
		GAMER3	
	Movie		
	Web		

	Text		
Manual Image Adjust	Auto Image Adjust		
	Horizontal Size		
	H./V. Position	H. Position	
		V. Position	
	Fine Tune		
	Sharpness		
	Blue Light Fliter		
	Aspect Ratio	4:3	
		5:4	
		16:9	
		16:10	
	Adaptive-Sync	On	
		Off	
Color Adjust	Contrast/Brightness	Contrast	
		Brightness	
	Color Temperature	Bluish	
		Warm	
		Native	
		User Color	Red
			Green
			Blue
	Color Range	Auto	
		Full Range	
		Limited Range	

Audio Adjust	Volume		
	Mute	On	
		Off	
Input Select	D-Sub		
	HDMI		
Setup Menu	Language Select	/ /■■■■/ /Türkçe/ PyccK1tvi/Suomi/Italiano/Español/Deu tsch/ Français/English	
	Resolution Notice		
	Information	Resolution	
		H Frequency	
		V Frequency	
		Pixel Clock	
		Model Number	
	OSD Timeout		
	OSD Background	On	
		Off	
	Auto Power Off	On	
		Off	
	Sleep	30 Minutes	
		45 Minutes	
		60 Minutes	
		120 Minutes	
		Off	
	Memory Recall		

## Basic parameters

Product Name		Liquid Crystal Display
Product model		P24H2P
Screen Size		23.8 inches
Aspect Ratio		16:9
Viewing Angle		178°(H) / 178°(V)
Pixel pitch		0.2745(H) × 0.2745(V) mm
Contrast ratio		1000:1 (TYP)
Colors		16.7M
Resolution		1920×1080
Maximum refresh rate		100Hz
Power specifications		12V 2.0A  The standard voltage and current may vary with countries, please refer to the label at the back of the product.
Product Dimensions Normal base	With out base	542.4 × 323.1 × 38.5 mm
	With base	542.4 × 412.3 × 174.9 mm
Tilting angle		Forward titling: 5°(±2°) ; Backward tilting: 15°(±2°)
Height range		NA
Rotation angle		NA
Vertical angle		NA
Environmental conditions	Action	Temperature: 0°C~ 40°C (32°F ~ 104°F) Humidity: 10%~90% RH (non-condensing)
	Storage	Temperature: -20°~ 60° (-4°F ~ 140°F) Humidity: 5%~95% RH (non-condensing)

The terms HDMI and HDMI High-Definition Multimedia Interface, and the HDMI Logo are trademarks or registered trademarks of HDMI Licensing Administrator, Inc. in the United States and other countries.

## FCC

This device complies with Part 15 of the FCC rules. Operation is subject to the following two conditions:

1. this device may not cause harmful interference, and

2. this device must accept any interference received, including interference that may cause undesired operation.”

## FAQ

- **Q: What should I do if any part is missing from the package?**
    - A: If any part is missing, please contact the distributor for assistance.
  - **Q: Can I use the monitor in a damp environment like a bathroom or kitchen?**
    - A: No, it is recommended to keep the monitor away from water sources or damp places.
  - **Q: Can I disassemble or repair the product by myself?**
    - A: No, it is advised not to disassemble or repair the product by yourself. Contact the after-sales service for assistance with any faults.
- 

## Documents / Resources

 <p>USER MANUAL FOR MONITOR</p>	<p><a href="#">TITAN ARMY P24H2P 24 Inch Computer Monitor</a> [pdf] User Manual P24H2P 24 Inch Computer Monitor, P24H2P, 24 Inch Computer Monitor, Computer Monitor</p>
---	---

## References

- [User Manual](#)

[Manuals+](#), [Privacy Policy](#)

This website is an independent publication and is neither affiliated with nor endorsed by any of the trademark owners. The "Bluetooth®" word mark and logos are registered trademarks owned by Bluetooth SIG, Inc. The "Wi-Fi®" word mark and logos are registered trademarks owned by the Wi-Fi Alliance. Any use of these marks on this website does not imply any affiliation with or endorsement.