

 **Timekettle**[®]
W4 Pro AI
Interpreter Earbuds



Timekettle W4 Pro AI Interpreter Earbuds User Manual

[Home](#) » [Timekettle](#) » Timekettle W4 Pro AI Interpreter Earbuds User Manual 

Contents

- [1 Timekettle W4 Pro AI Interpreter Earbuds](#)
- [2 Headphone connection failed](#)
- [3 Security information](#)
- [4 Product parameters](#)
- [5 Specifications](#)
- [6 Product Usage Instructions](#)
- [7 Meeting and Translation Features](#)
- [8 Tips for Translation Accuracy](#)
- [9 Warranty Regulations](#)
- [10 FCC Caution](#)
- [11 Documents / Resources](#)
 - [11.1 References](#)



Timekettle W4 Pro AI Interpreter Earbuds



When using for the first time, put the earphones into the charging compartment, close the charging compartment, then open it, and connect the phone.



Step1



Step2

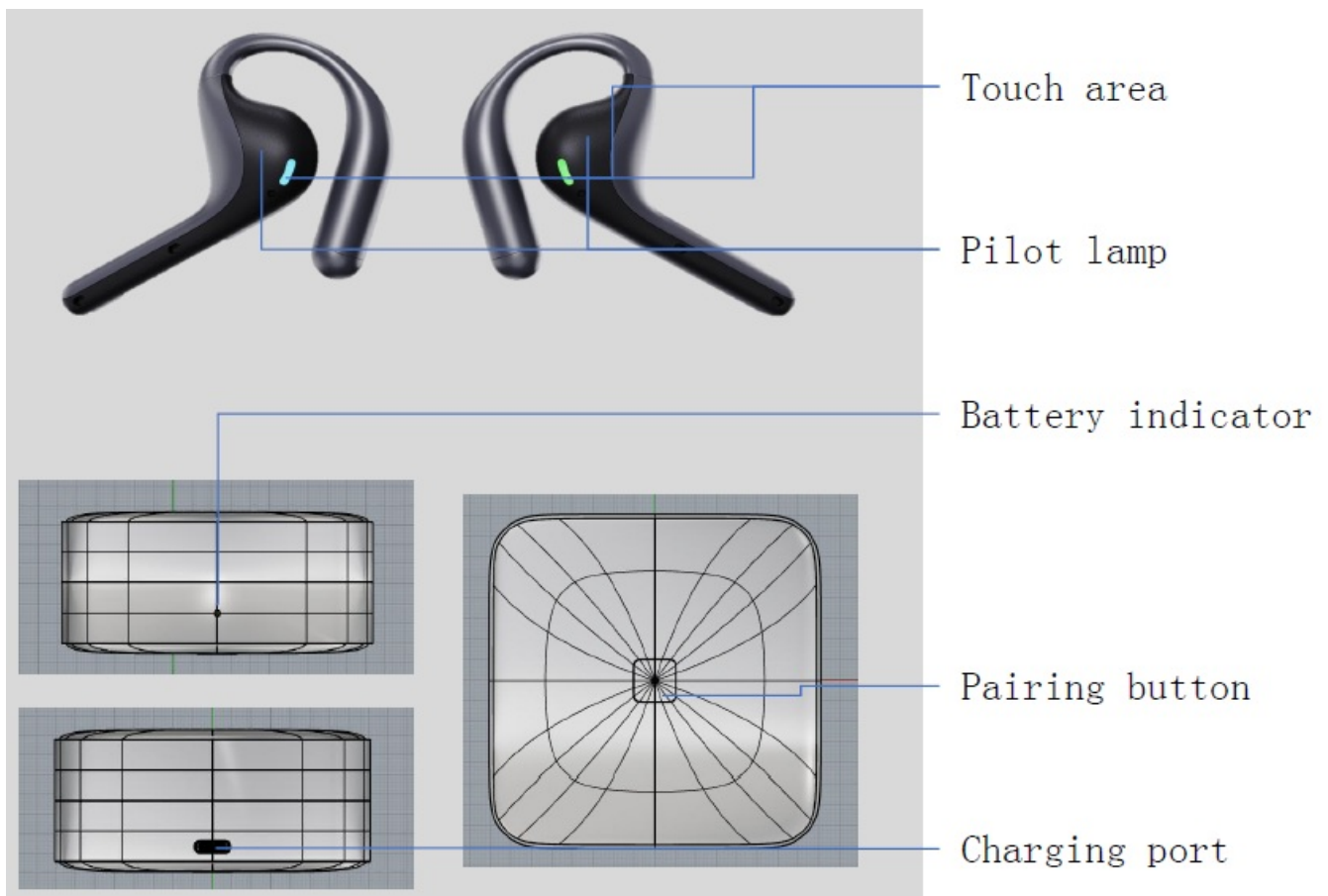

Remove the ear hook, approach the ear and rotate to the appropriate position.



Support pause/play, switch to next track, and activate voice assistant;
 Support answering and hanging up calls;
 Support switching between "listening" and "speaking" states.

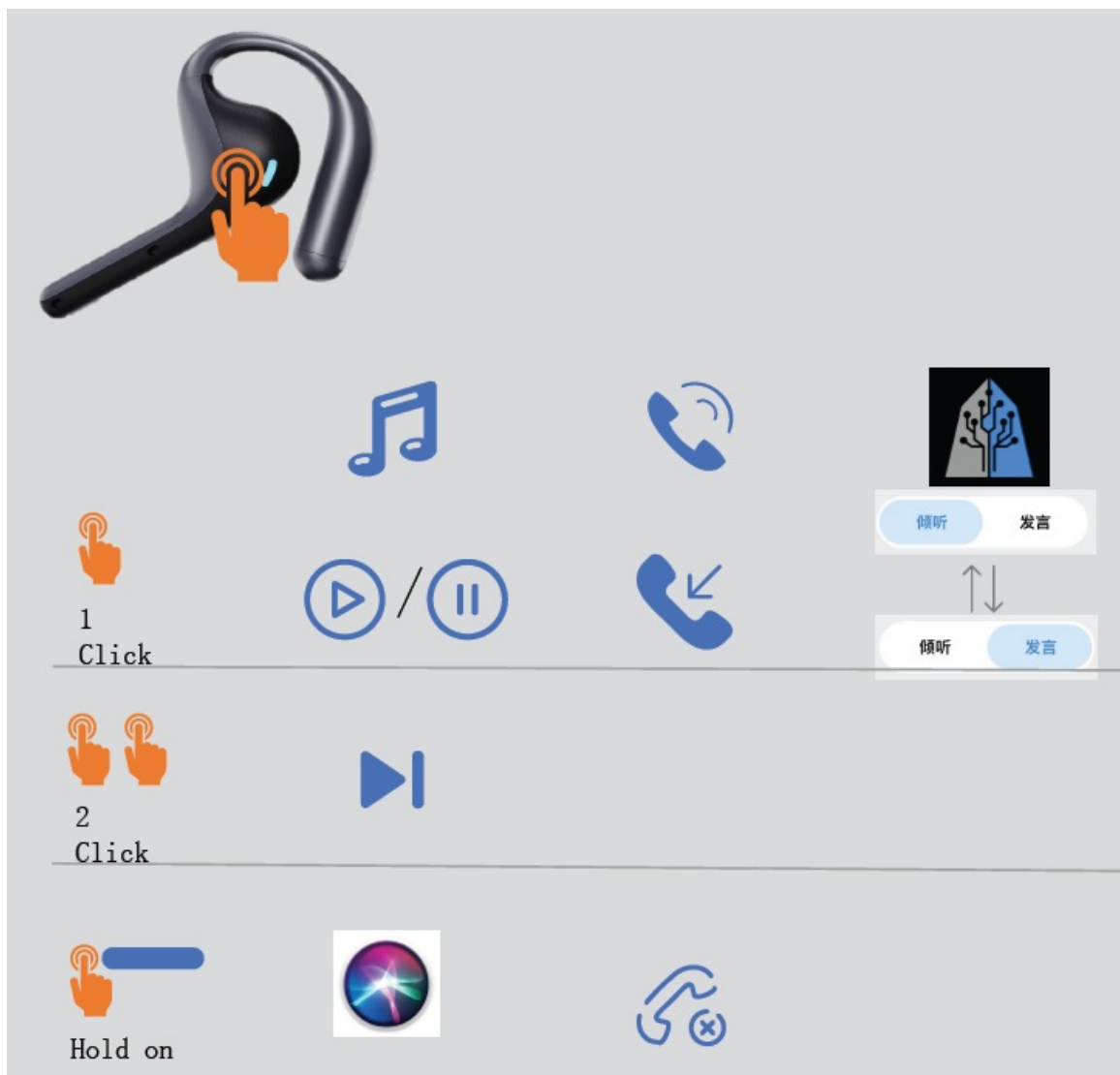

Connect a new device: Open the charging compartment and place both earphones inside. Press and hold the button on the back for at least 1 second until the earphone indicator light starts flashing.

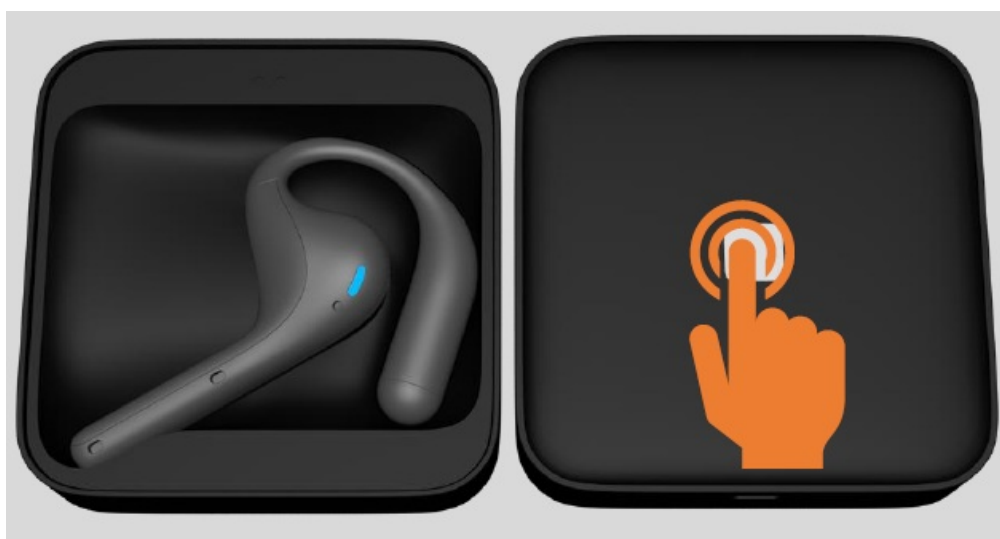

Download the Timekettle app and embark on a journey of barrier free communication!



Attend the meeting

1. Listening state: Hold the phone close to the speaker and play the translation result through the headphones;
2. Speech status: The headphones pick up your voice and the translation results are played out through the phone.



Two person conversation:

Both parties wear one earphone and speak their own language, and the earphone plays the translation result.



Audio and video translation:

Translate audio and video, video conferencing, and audio during calls.



How to improve translation accuracy?

1. In addition to choosing the correct language, please pay attention to whether the accent has been selected correctly;
2. Please check the way you wear your headphones, and the microphone of the headphones should be pointed towards your mouth;
3. When using the audit meeting mode, please note that your phone should be close to the speaker;
4. If your conversation involves a lot of special nouns, please use the "Custom Lexicon" function.

Headphone connection failed

1. Please confirm if the Bluetooth switch is turned on in the phone system settings;
2. Please check if the earphones have power. If there is no power, please charge the earphones first;
3. Please check if the current headphones are connected to other phones. If so, please disconnect them from other phones;
4. If the above methods still cannot solve the problem, you can try resetting the headphones:
 1. Put both earphones into the charging compartment;
 2. Close the charging compartment and open it again after about 10 seconds;
 3. After opening the charging case, long press the pairing button for 2 seconds until the indicator light of the earphones is flashing, then open the Bluetooth page of the phone system settings for pairing and

connection.

If you encounter any other problems during product use, please contact us

WEB www.timekettle.co

E-Mail support@timekettle.co Tel (+86) 0755 – 86725036

(Chinese)

+1 (833) 491 – 1328

(English/Espanol)

Manufacturer: Shenzhen Timekettle Technologies Co., Ltd

Address: Room 612, Building 4th, Minqi Science Park, No.65 Lishan Road, Pingshan Community, Taoyuan Street, Nanshan District, Shenzhen, Guangdong

Security information

Before using this product, please read the following safety information.

1. Do not use unofficial recommended charging methods to avoid fire, explosion, or other hazards;
2. Please avoid dropping, burning, squeezing, or immersing the product in liquids to prevent equipment damage;
3. Do not expose the product to high temperatures or around heating devices such as ovens and microwaves;
4. Please use this product within the range of 0~35 ° C and store the product within the range of -10~45 ° C.

Excessive or insufficient temperature may cause equipment malfunction;

5. Our company is not responsible for any quality issues, equipment malfunctions, or safety accidents caused by the use of non officially recognized accessories.

Product parameters

- Product Name: AI Interpreter Earbuds
- Product model: W4 Pro
- Charging compartment size: 83 * 83 * 42mm
- Earphone size: 80.13 * 57.69 * 25.44mm
- Weight of a single earphone: 16.1g
- Total weight of product: 188.1g
- Charging specification: Type C 5V 1A
- Battery capacity: Earphones alone (110mAh), charging case (800mAh)
- Charging time for charging compartment: 1.5 hours
- Earphone charging time: 1 hour
- Translation battery life: 6 hours Call endurance: 8 hours
- Music playback battery life: 12 hours
- Bluetooth version: 5.3

Specifications

- Model: W4 Pro
- Features: Touch area, Pilot lamp, Battery indicator, Pairing button, Charging port

- Functions: Pause/play, switch to next track, activate voice assistant, answer/hang up calls, switch between listening and speaking states

Product Usage Instructions

Step 1: Initial Setup

When using for the first time:

1. Place the earphones into the charging compartment.
2. Close and then open the charging compartment.
3. Connect the earphones to your phone.

Step 2: Ear Hook Adjustment

Remove the ear hook and adjust it to fit your ear comfortably.

Pairing with a New Device

To pair with a new device:

1. Open the charging compartment and place both earphones inside.
2. Press and hold the button on the back for at least 1 second until the earphone indicator light starts flashing.

Using the Timekettle App

Download the Timekettle app for seamless communication experiences.

Meeting and Translation Features

For meeting and translation purposes:

- In listening state, play translation results through headphones by holding the phone close to the speaker.
- In speech state, the headphones pick up your voice for translation results played out through the phone.
- In two-person conversation mode, each party wears one earphone for language translation.
- Translate audio and video content during video conferencing and calls.

Tips for Translation Accuracy

1. Select the correct language and accent.
2. Ensure the headphone microphone is pointed towards your mouth.
3. In meeting mode, keep your phone close to the speaker.
4. For special nouns, use the Custom Lexicon function.

Headphone Connection Issues

If you encounter headphone connection problems or other issues during product use, please contact our support team for assistance.

Warranty Regulations

1. From the date of purchase, if there are quality problems with the product or accessories within one year or six

months of normal use, customers can enjoy free repair services with the official/officially recognized purchase platform order number.

2. Normal wear and tear of the product, damage caused by failure to use according to the instructions, and damage caused by uncontrollable human factors are not covered by the warranty.
3. We will charge appropriate repair fees for faults caused by human factors, exceeding the warranty period, and uncontrollable factors.

FCC Caution

This device complies with part 15 of the FCC Rules. Operation is subject to the following two conditions:

- (1) This device may not cause harmful interference, and
- (2) this device must accept any interference received, including interference that may cause undesired operation.

Any Changes or modifications not expressly approved by the party responsible for compliance could void the user's authority to operate the equipment.

Note: This equipment has been tested and found to comply with the limits for a Class B digital device, pursuant to part 15 of the FCC Rules. These limits are designed to provide reasonable protection against harmful interference in a residential installation. This equipment generates uses and can radiate radio frequency energy and, if not installed and used in accordance with the instructions, may cause harmful interference to radio communications. However, there is no guarantee that interference will not occur in a particular installation. If this equipment does cause harmful interference to radio or television reception, which can be determined by turning the equipment off and on, the user is encouraged to try to correct the interference by one or more of the following measures:

- Reorient or relocate the receiving antenna.
- Increase the separation between the equipment and receiver.
- Connect the equipment into an outlet on a circuit different from that to which the receiver is connected.
- Consult the dealer or an experienced radio/TV technician for help.

The device has been evaluated to meet general RF exposure requirement. The device can be used in portable exposure condition without restriction. The use distance is not more than 5mm.

IC Warning

This device complies with Industry Canada licence-exempt RSS standard(s). Operation is subject to the following two conditions:

1. This device may not cause interference, and
2. This device must accept any interference, including interference that may cause undesired operation of the device.

RF warning for Portable device:

The device has been evaluated to meet general RF exposure requirement. The device can be used in portable exposure condition without restriction.

Documents / Resources

	Timekettle W4 Pro AI Interpreter Earbuds [pdf] User Manual 2AQ2G-W4PRO, 2AQ2GW4PRO, W4 Pro AI Interpreter Earbuds, W4 Pro, AI Interpreter Earbuds, Interpreter Earbuds, Earbuds
---	--

References

- [🏠 Timekettle | Voice Language Translator | NO.1 Translation Earbuds](#)
- [User Manual](#)

[Manuals+](#), [Privacy Policy](#)

This website is an independent publication and is neither affiliated with nor endorsed by any of the trademark owners. The "Bluetooth®" word mark and logos are registered trademarks owned by Bluetooth SIG, Inc. The "Wi-Fi®" word mark and logos are registered trademarks owned by the Wi-Fi Alliance. Any use of these marks on this website does not imply any affiliation with or endorsement.