



Timekettle M3 Language Translator Earbuds User Guide

[Home](#) » [Timekettle](#) » Timekettle M3 Language Translator Earbuds User Guide 

Timekettle M3 Language Translator Earbuds



Contents

- 1 M3 -Device Pairing
- 2 M3-Listen Mode
- 3 M3-Touch Mode
- 4 M3-Speaker Mode
- 5 M3- Settings
- 6 Purchasing Offline Translation Language Package
- 7 Customer Support
- 8 Documents / Resources
 - 8.1 References
- 9 Related Posts

M3 -Device Pairing

1. Select the earbuds model to pair.
2. Enable Bluetooth and location permissions.

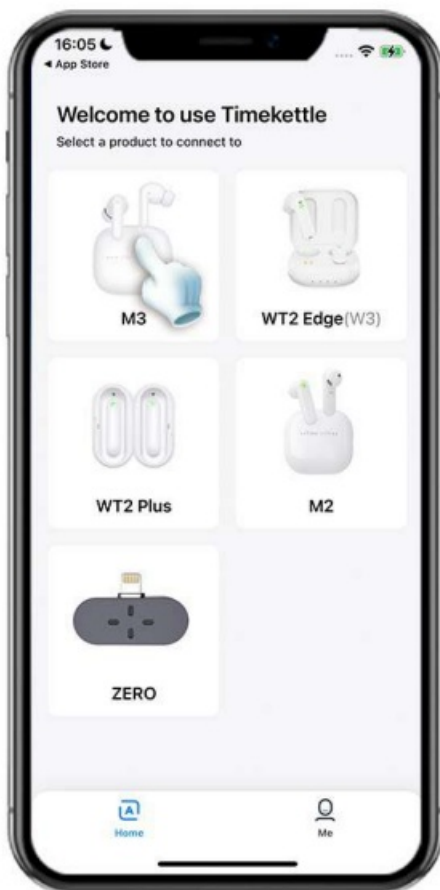

3. Tap [+], remove the earbuds from the charging case, and tap [Next] to find the earbuds you want to pair.

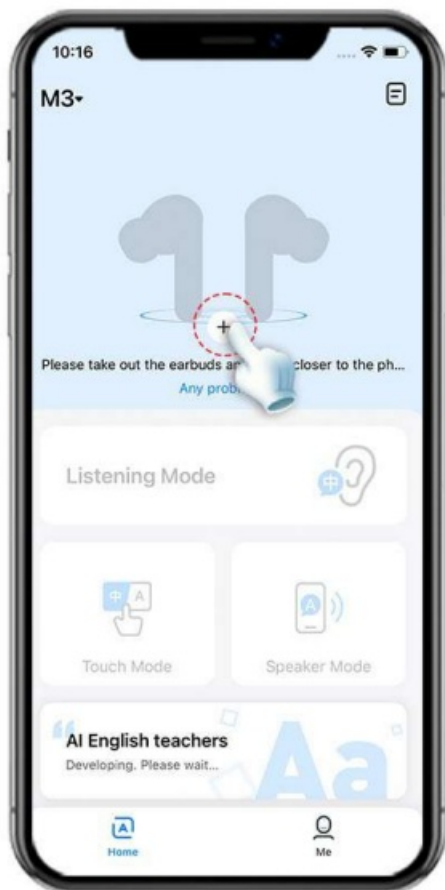

Tap [+], remove the earbuds from the charging case, and tap [Next] to find the earbuds you want to pair.



4. Tap [Connect]

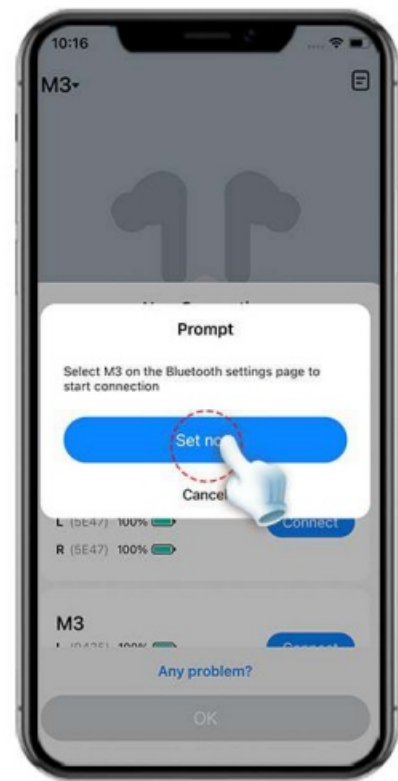

5. Tap [Set Now]
6. Connect the earbuds in Bluetooth list of your smart phone.



7. Tap [OK] to enter [Home].



M3-Listen Mode

1. In [Listen Mode], wear both earbuds. If only one earbud is worn, do not place the other earbud back into the charging case.



2. Set the source languages for both the earbud user and the smart phone user.

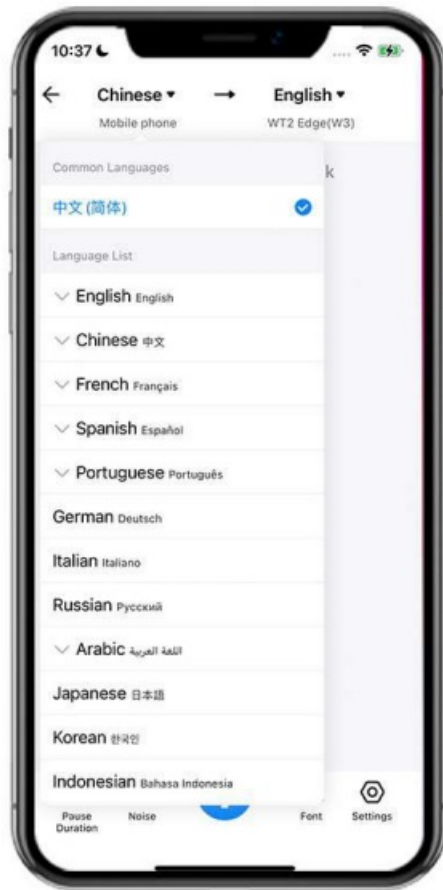

3. Tap the microphone icon to pick up voice and move the smart phone close to the sound source.



4. Tap the wavy lines to pause before returning to [Home].

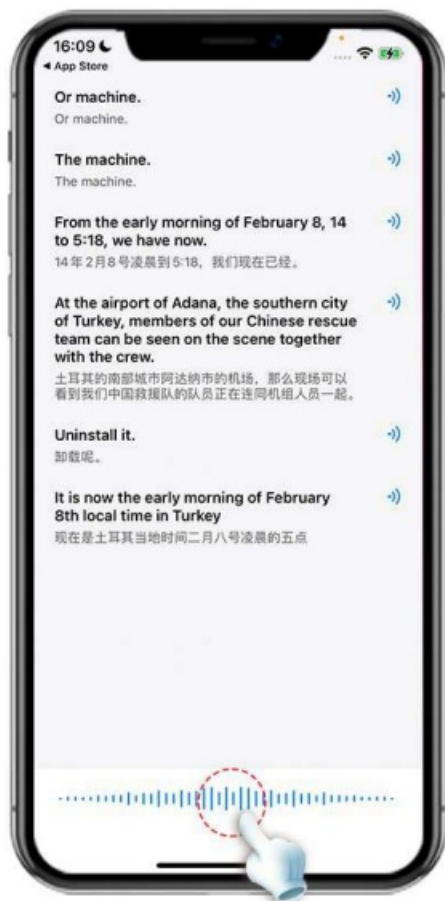

M3-Touch Mode

1. Two persons wear one earbud each, and then tap [Touch Mode].



2. Set the source language for each person's earbud.



3. Before starting a conversation, both persons should first tap the microphone icon on the screen that corresponds to the language being spoken, or tap the indicator on the earbud being worn.



4. You can switch between Face-to-Face display and Side-by-Side display by sliding the screen to the left or right. When the two persons are side by side, the Side-by-Side display is recommended. When the two persons are

facing each other, the Face-to-Face display is recommended.

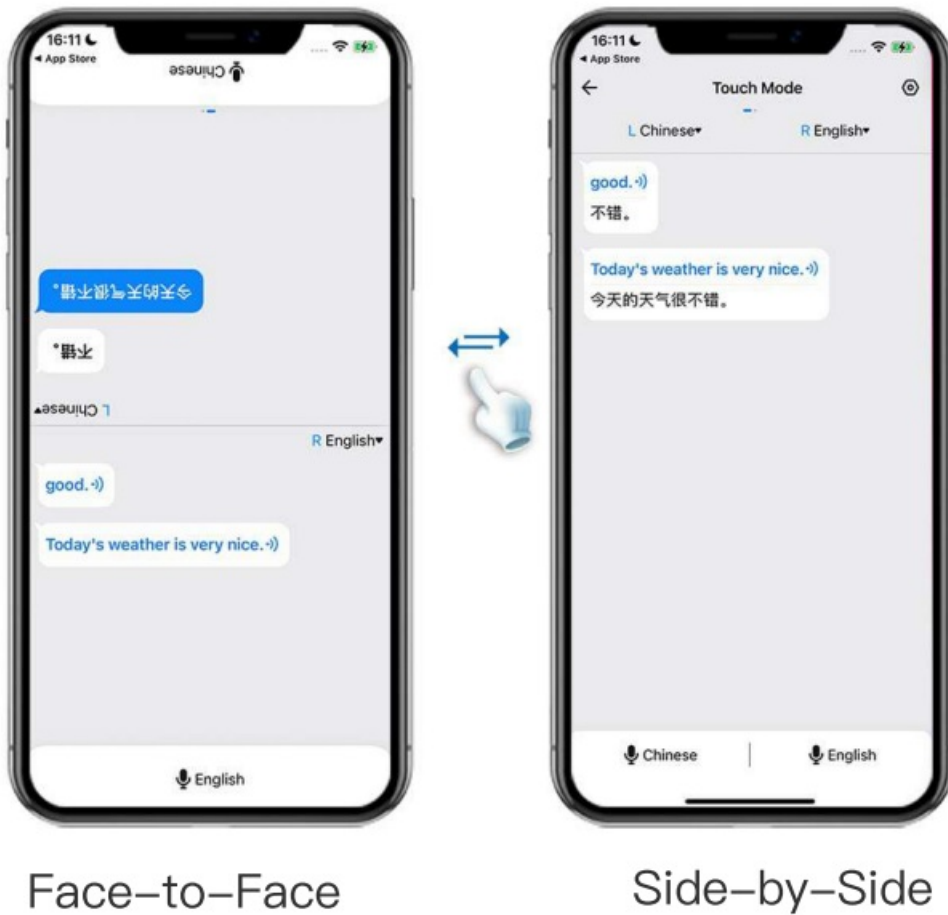

M3-Speaker Mode

1. In [Speaker Mode], one person wears two earbuds and the other uses a smartphone. If only one earbud is worn, do not place the other one back into the charging case.



2. Set the source languages for both the earbud user and the smartphone user.



3. Before starting a conversation, both persons should first tap the microphone icon on the screen that corresponds to the language being spoken (the earbud user can also tap the indicator on the earbud to start speaking).



4. You can switch between Face-to-Face display and Side-by-Side display by sliding the screen to the left or right. When the two persons are side by side, the Side-by-Side display is recommended. When the two persons are facing each other, the Face-to-Face display is recommended.



M3- Settings

Offline Translation

Select the offline language package to be used and enable [Offline Translation] in Settings.

The offline language package should be purchased and down loaded first before use.



Translate Audio Enables or disables automatically played interpreting audio.



Pause Duration

Set the pause duration between sentences according to individual speaking habits so that the sentence segmentation can be more accurately recognized. If you habitually pause long between sentences, the pause duration can be increased, otherwise it can be decreased.



Font Size

Adjust the font size of interpreting mode pages, but not the font size of other pages.



Ambient Noise

Set the ambient noise level. If it is noisy, just slide the blue button to “Noisy” , otherwise slide it to “Quiet”.

Note: In a quiet environment, people should be 1 meter away from each other for conversation.



Earbud Light

The [Earbud Light] controls the on/off of the earbud indicators. When disabled, the earbud indicators are always off.

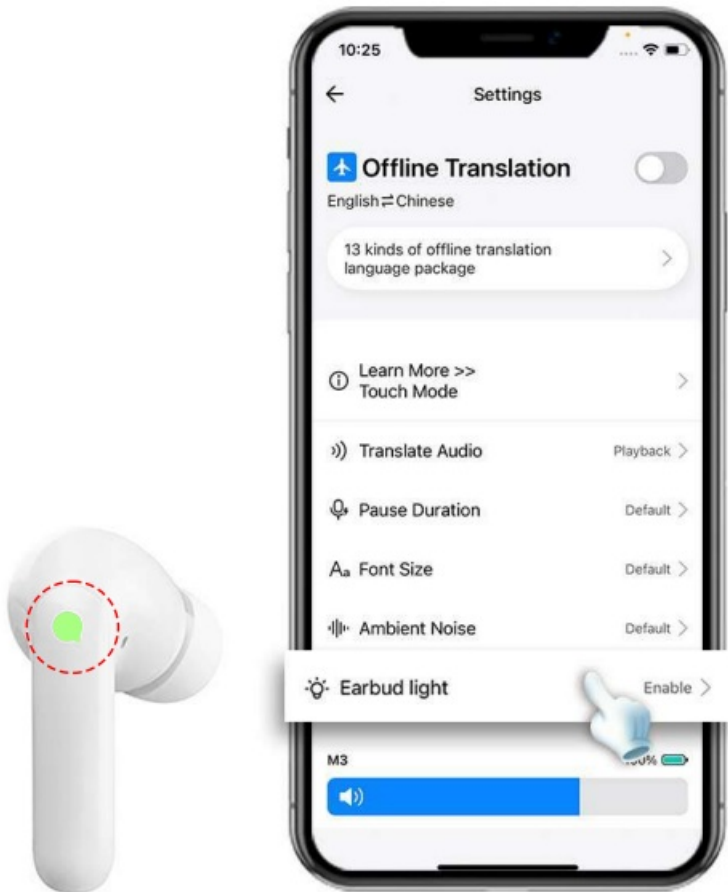

Purchasing Offline Translation Language Package

Top Up

The account should be topped up before making a purchase. You can top up the balance with a Fish card or via WeChat Pay/Google In-app Purchase /Apple In-app Purchase.

Top – up with Fish Card

1. Tap [Me] > [Redeem Fish Card] to enter the Fish Card redemption page.

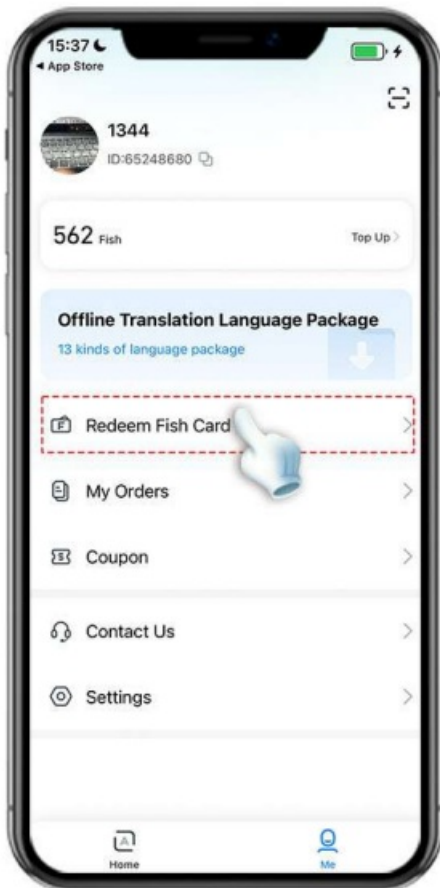

2. Scrape off the coating from the Fish card as shown in the animation. After entering the PIN code on the page, tap [Redeem]. Upon successful redemption, the Fish coin balance in your account will be updated.



Top-up via WeChat Pay/Google In-app Purchase/Apple In-app Purchase

1. Tap [Me > [Top Up] to enter the top-up page.
2. Select the amount of credit you want to add and tap [Top Up].

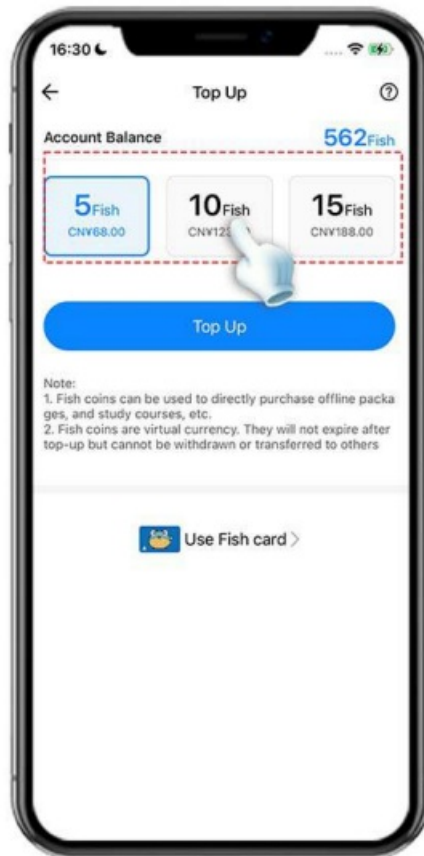
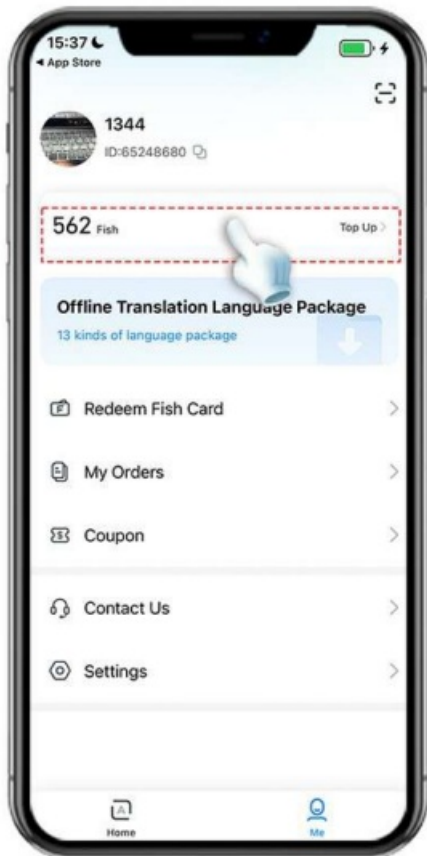

3. Tap [Purchase], enter the login password for your App Store account, and tap [Sign in].

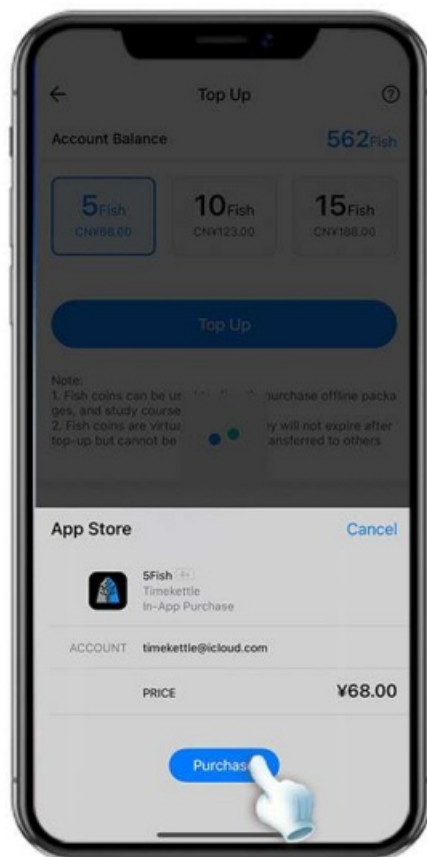

4. Upon successful redemption, a pop-up window will appear indicating that the transaction has been completed and the Fish Coin balance in your account will be updated.

Note:

1. When you enter the top-up page, the top-up amount will be loaded within a certain period of time. If the amount is not successfully loaded for a long time, please check the network connection or exit the top-up page and re-enter it.
2. If the account balance is not updated immediately after topping up, just wait a while; if it has not been updated for a long time, please reenter the balance page. If the balance cannot be updated after trying the above solutions, just contact our Customer Service.

Purchasing Offline Translation Language Package

You can use a sufficient balance to purchase an Offline Translation Language Package

1. Tap [Me] > [Offline Translation Language Package] to enter the purchase page.

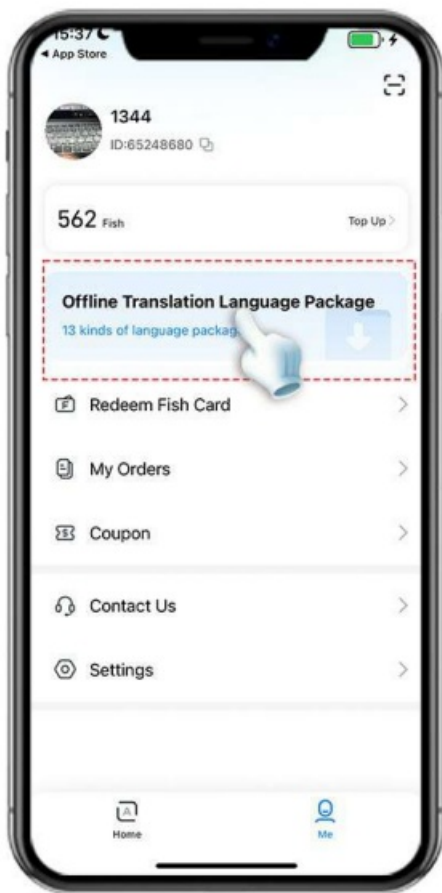

2. Check that the earbuds model shown on the page matches your earbud model. The offline package you purchased is bound to the model. If the model is changed, it Will not work.



3. Tap the shopping cart icon to purchase the Offline Translation Language Package you want.
4. Check that the earbuds model and the Offline Translation Language Package you selected are what you want. After confirming, tap [OK] to complete the purchase.

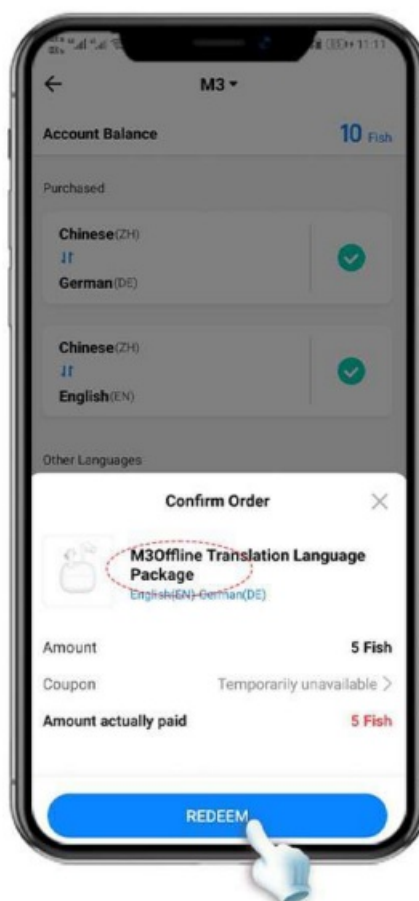

5. After a successful purchase, download the Offline Translation Language Package. Tap [Download Now].



6. When the download icon changes to a check mark, it means the download is complete.

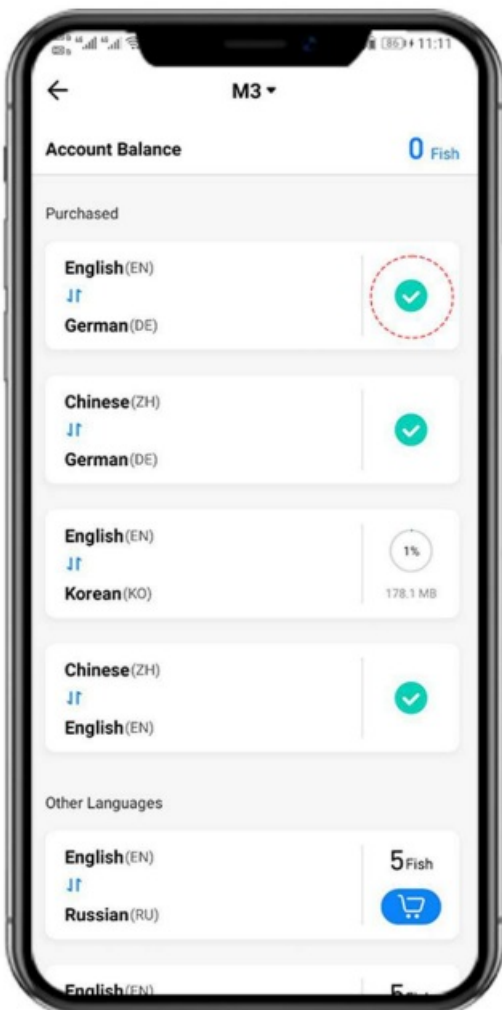

Enabling Offline Translation Language Package

After successfully purchasing and downloading the Offline Translation Language Package, enable the [Offline Translation] switch in [Settings] page of each mode.

1. Select the desired interpreting mode.

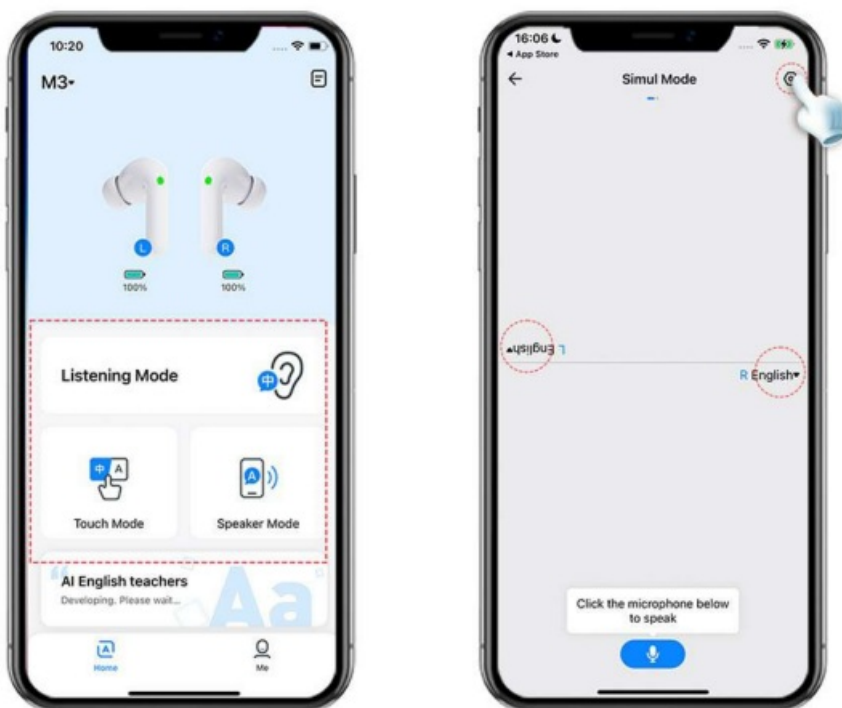

2. Enable [Offline Translation] to start offline interpreting.

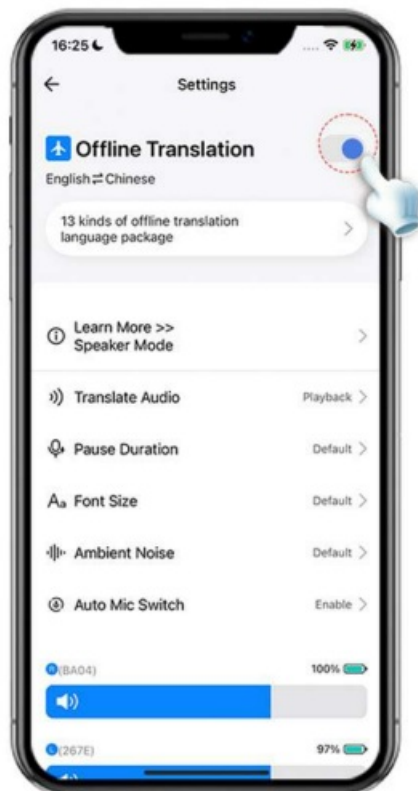

Note: Before enabling [Offline Translation], you should set the source languages for the devices in the interpreting mode you'll be using.



Customer Support

Email: support@timekettle.co
Facebook Messenger: @TimekettleTech
Website: <https://www.timekettle.co>
Tel: 1-833-491-1328



Documents / Resources

	<p>Timekettle M3 Language Translator Earbuds [pdf] User Guide A1hf3a, M3, M3 Language Translator Earbuds, Language Translator Earbuds, Translator Earbuds, Earbuds</p>
---	--

References

- [Timekettle | Voice Language Translator | NO.1 Translation Earbuds](#)
- [User Manual](#)