



time HG8145V5 Control Hub App User Guide

[Home](#) » [TIME](#) » time HG8145V5 Control Hub App User Guide 

Contents

1 time HG8145V5 Control Hub App

2 HOW TO INSTALL NEW OMNIMESH DEVICES

3 Documents / Resources

3.1 References

4 Related Posts



time HG8145V5 Control Hub App



Specifications

- Compatible Devices: Huawei HG8145V5 and WA8021V5
- Installation Distance: 2m from router
- Installation Time: Approximately 4 minutes

Product Usage Instructions

1. Open the Time Internet app on your Huawei device.
2. Tap on the Device Installation icon on the Control Hub screen.
3. Tap on the + symbol to add a new device.
4. Tap on Start Installation to begin the process.
5. Ensure your device is placed 2m from your router for detection.
6. If errors occur, follow on-screen instructions.
7. The indicator light on your device will blink once installation begins. Tap on Next to proceed.
8. The app will connect your device, taking around 4 minutes to complete.
9. Once installation is done, tap on Done to finish.
10. To delete a device, swipe left on it and tap on Delete.
11. To stop installation, tap on Stop Installation. If interrupted, tap Yes to restart.
12. If device is undetected, ensure it's powered on and close to router. Tap Retry to start again.
13. If still undetected after two attempts, reset the device:
 - Power off by unplugging.
 - Hold reset button with a needle for a few seconds.
 - Release when indicator light goes off.
 - Tap on Next to proceed.
14. Plug device back in, turn it on, and tap Next to retry the installation.

FAQ:

Q: How do I know if my device is successfully installed?

A: The indicator light on the device will stop blinking once installation is complete, and you will see a 'Done' message on the app.

HOW TO INSTALL NEW OMNIMESH DEVICES

For Huawei devices (Huawei HG8145V5 and WA8021V5) only.

1. Tap on the Device Installation icon on the Control Hub screen in your Time Internet app.

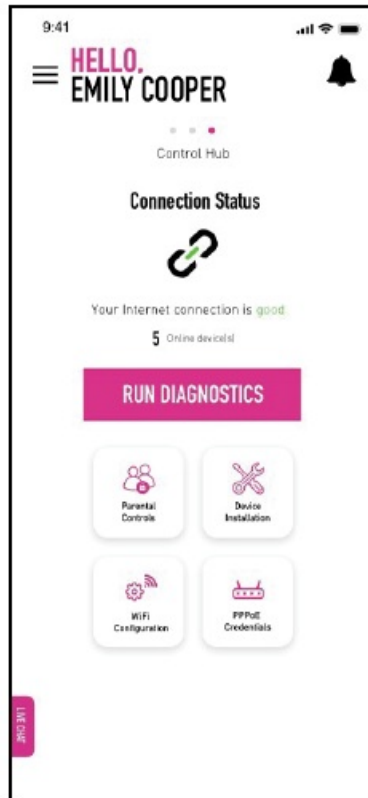

2. Tap on the + symbol to add a new device(s).



3. Tap on Start Installation to begin the process.

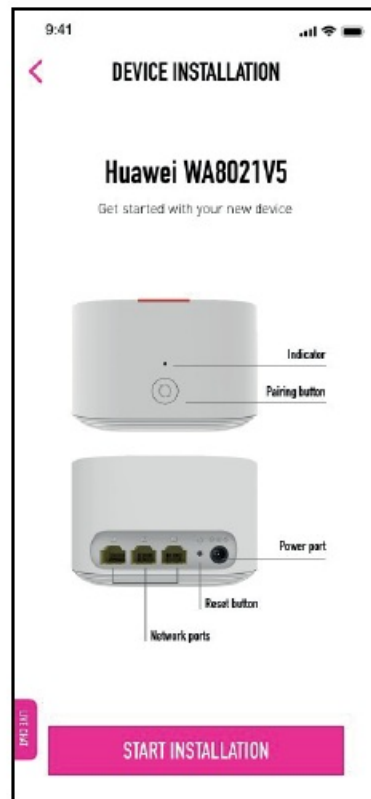

4. Ensure your device(s) is placed 2m from your router in order for it to be detected. Should you encounter any errors, simply follow the instructions on screen.

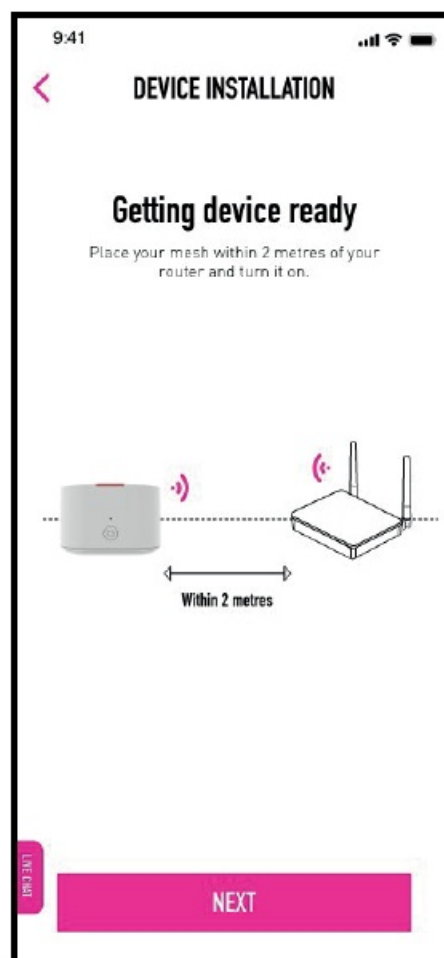

5. The indicator light on your device(s) will start to blink once the installation process begins. Tap on Next to proceed.



6. The app will start connecting your device(s). It will take approximately 4 minutes or less to complete the installation.

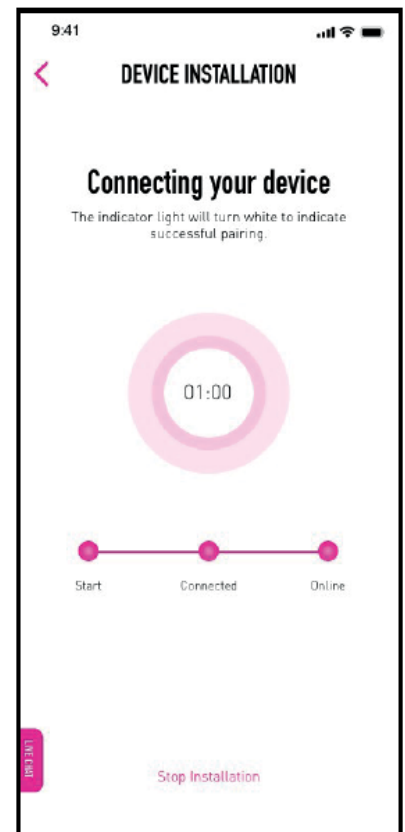
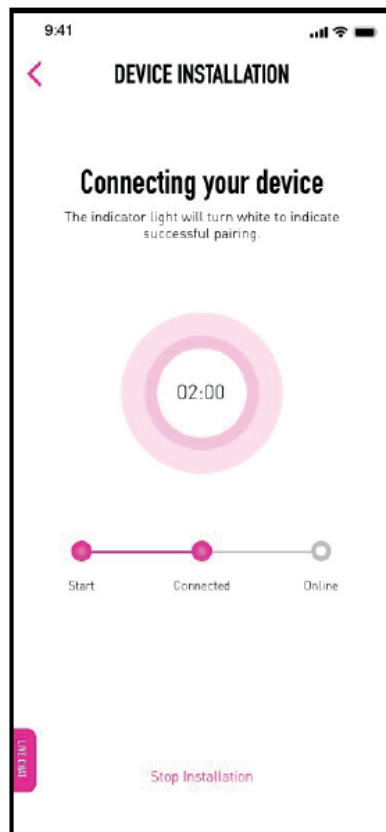
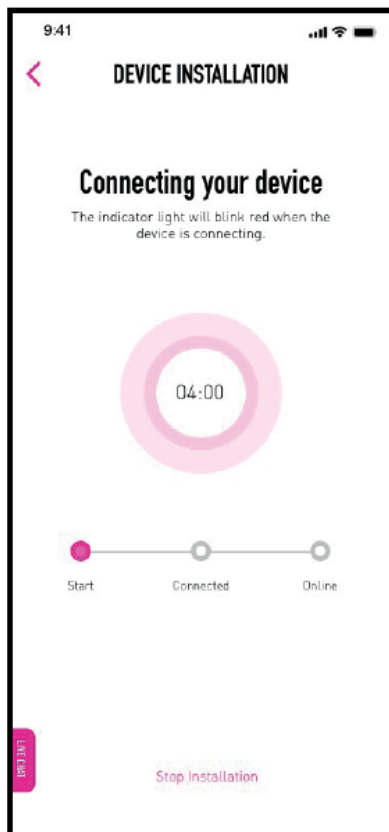

7. Once the process is complete, your device(s) will be ready for use. Tap on Done to finish.



8. If you wish to delete your installed device(s), simply swipe left on the selected device and tap on Delete.

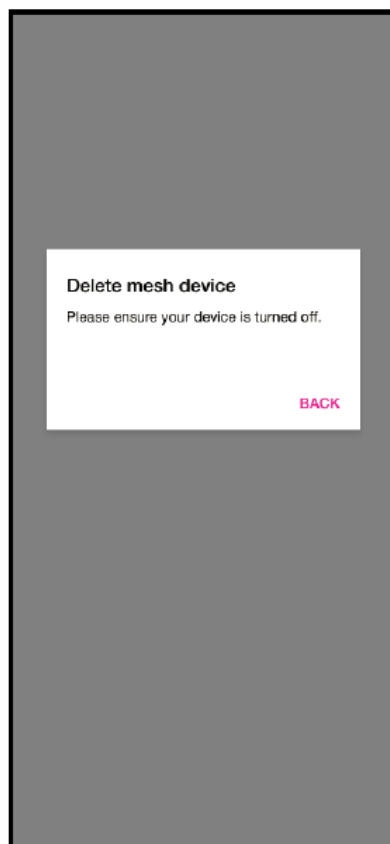
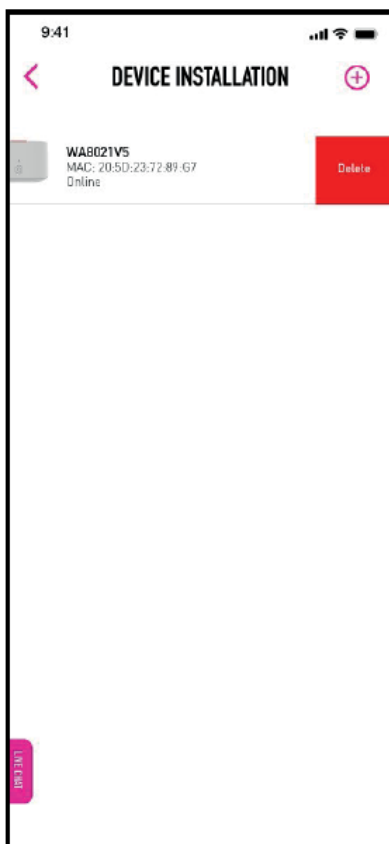

9. If you would like to stop the installation, simply tap on Stop Installation.

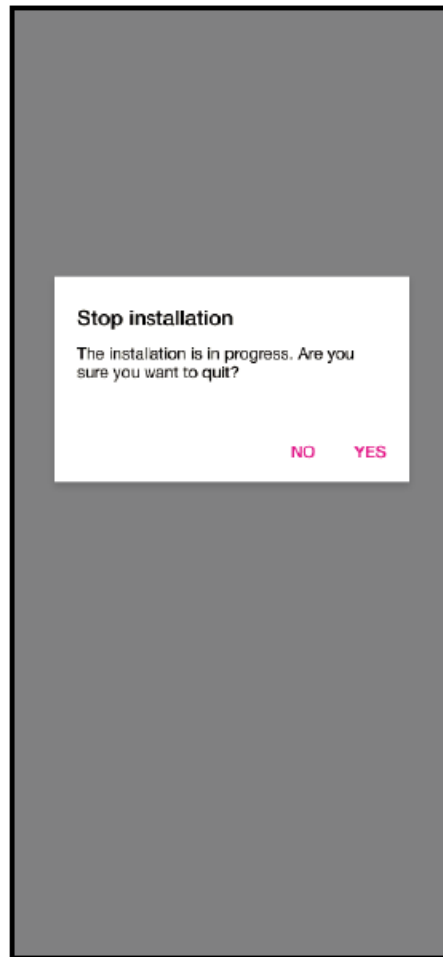

10. If the installation is interrupted midway, tap on Yes to restart the process.



11. If the app fails to detect your device(s), ensure that it is powered on and placed within 2m of your router. Tap on Retry to start again.

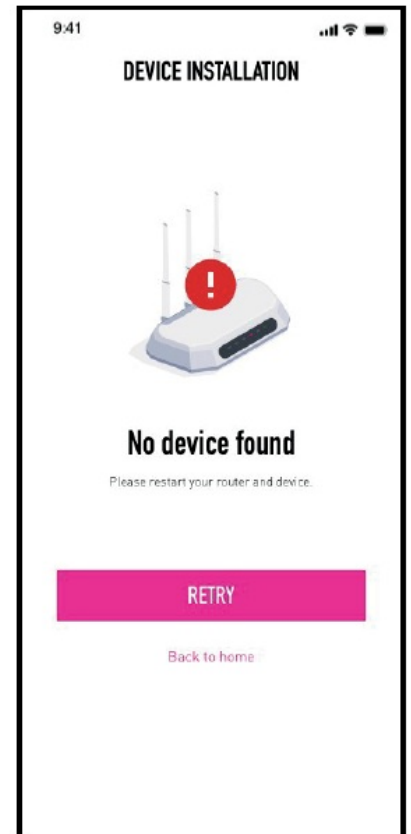
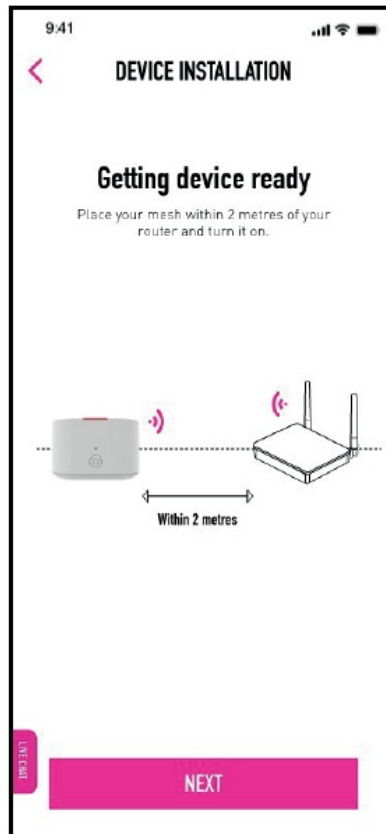
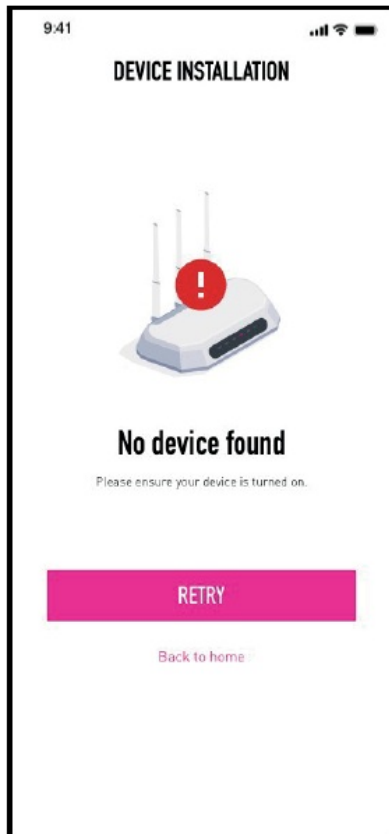

12. If the app fails to detect your device(s) after two (2) attempts, reset your device following the steps below:

- Power off your device by unplugging it from the power socket.
- Using a needle or a thin piece of metal or plastic, hold the reset button for a few seconds.
- Release the button once the indicator light goes off.
- Tap on Next to proceed.

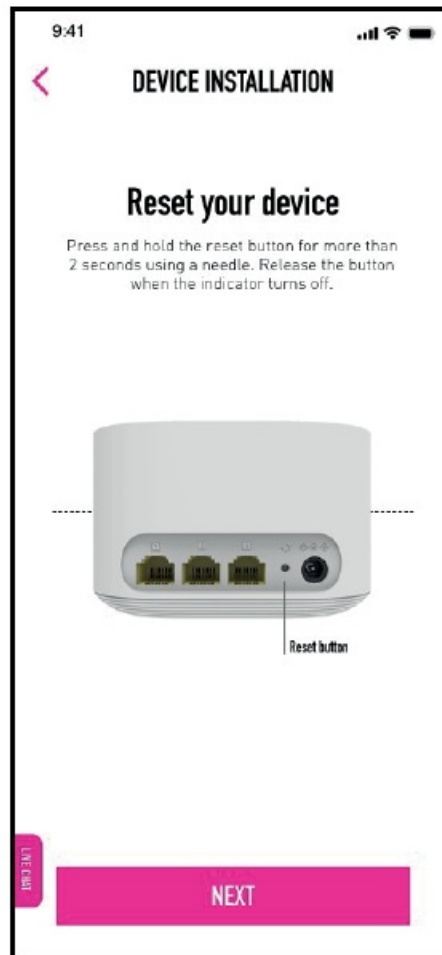

13. Plug your device back in to turn it on and tap on Next. This will take you back to the start of the installation process where you can try again.

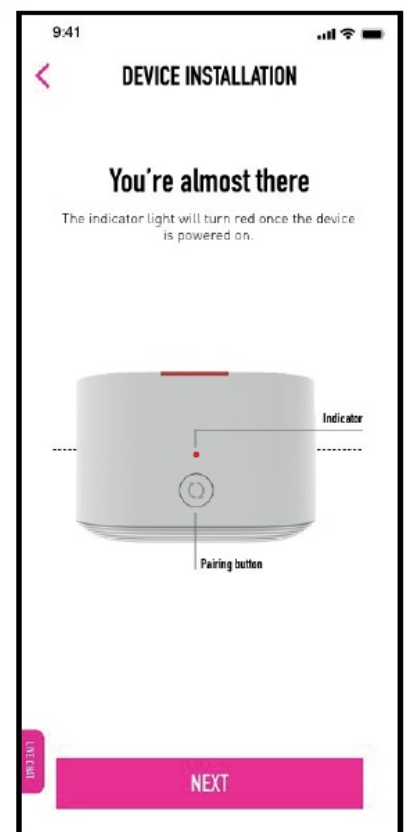
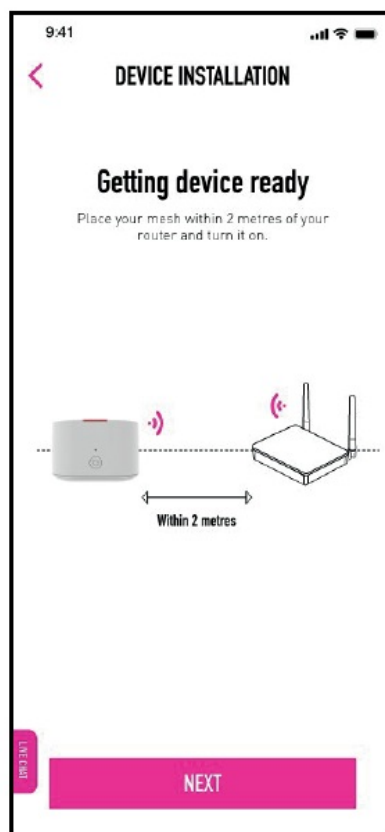



[time HG8145V5 Control Hub App](#) [pdf] User Guide
HG8145V5, HG8145V5 Control Hub App, Control Hub App, App

References

- [User Manual](#)

[Manuals+](#), [Privacy Policy](#)

This website is an independent publication and is neither affiliated with nor endorsed by any of the trademark owners. The "Bluetooth®" word mark and logos are registered trademarks owned by Bluetooth SIG, Inc. The "Wi-Fi®" word mark and logos are registered trademarks owned by the Wi-Fi Alliance. Any use of these marks on this website does not imply any affiliation with or endorsement.