



Tile RE-42001 Item Locator Instructional Manual

[Home](#) » [Tile](#) » Tile RE-42001 Item Locator Instructional Manual 

Contents

- [1 Tile RE-42001 Item Locator](#)
- [2 Introduction](#)
- [3 Specifications](#)
- [4 Setup](#)
- [5 Frequently Asked Questions](#)
- [6 Video- Product Overview](#)
- [7 Related Posts](#)

tile

Tile RE-42001 Item Locator



Introduction

The Tile RE-42001 Item Locator is a small yet highly effective tracking device designed to help you keep track of your essential items. Whether it's remotes, chargers, headphones, glasses cases, or other electronic devices, simply stick the Tile Sticker to them, and you can easily locate them using the free Tile app. Offering a Bluetooth range of up to 250 ft (76 m), the device enables you to find nearby items by ringing your Tile or using your Smart Home device. For items outside the Bluetooth range, you can view the Tile's last known location on a map. Uniquely, the Tile can also help you find your phone by pressing the button on the Tile, causing your phone to ring, even when it's on silent.

Additional features include water resistance with an IP67 rating, a non-replaceable battery that lasts up to 3 years, and compatibility with both Android and iOS devices, including Smart Home integrations with Amazon Alexa, Hey Google, and Siri. For added peace of mind, the Tile Network can even help find lost items, and you have the option to upgrade to a Premium Plan that offers proactive Smart Alert notifications and an Item Reimbursement policy. With Tile RE-42001, losing track of your essential items is a thing of the past.

Specifications

- **Brand** Tile
- **Are Batteries Included** Yes
- **Material** Plastic
- **Color** Black
- **Number of Batteries** 1 Lithium Metal battery is required. (included)
- **Product Dimensions** 1.06 x 1.1 x 0.32 inches
- **Item Weight** 0.229 ounces
- **Item model number** RE-42001
- **Connectivity technologies** Bluetooth
- **Other display features** CE
- **Human Interface** Input Buttons
- **What's in the box** 1 Tile Sticker
- **Country of Origin** China

Hey, congrats on your new Tile tracker. Let's get it set up so you can find your thing whatever and wherever it may be.

Setup

1. Attach your Tile to your thing – keys, wallet, luggage, phone, laptop, or even your pets depending on the type of Tile tracker.



2. Download the Tile app for iOS or Android.



3. Once you're in the app, tap on "Get Started" to activate your tracker. (Android users may see slightly different screens.)

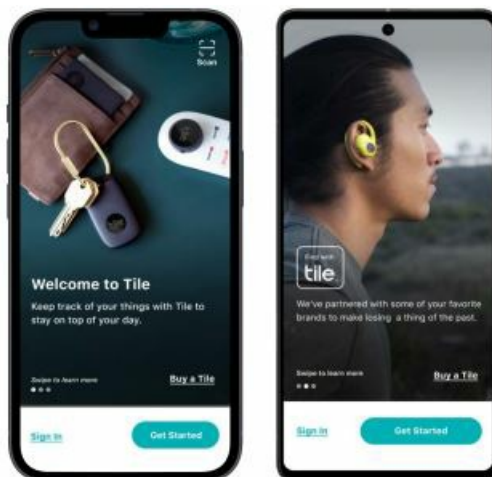

4. Next, tap on "Tile Devices." "

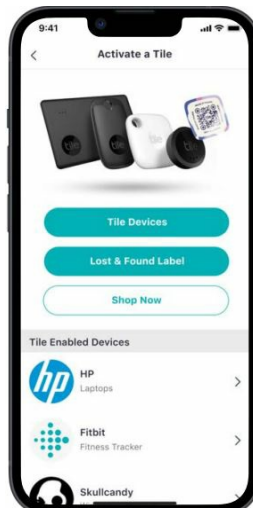

5. Create your account by filling out all your info, then verify your new account.

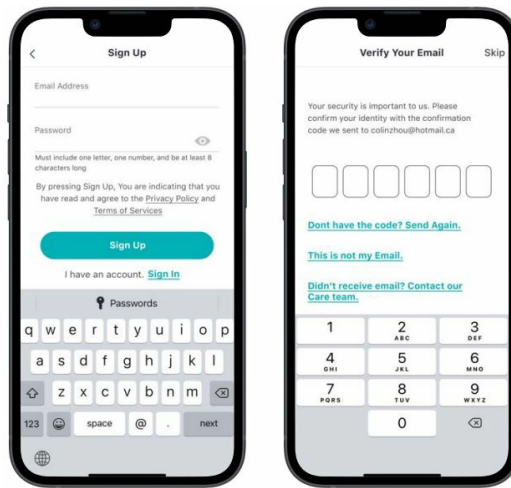

6. Tap “OK” to allow Tile to use Bluetooth. Enabling your Bluetooth Sharing Access will start the activation process for your Tile tracker, ring Tiles within range, and update the location.

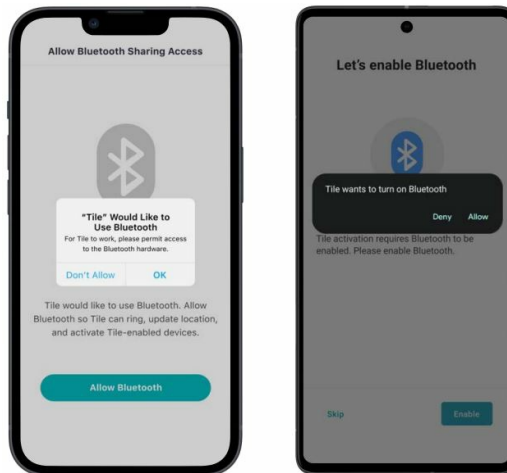

7. Now you can press the button right on your Tile tracker – this will start the activation process. Once you hear it ring, tap “Next” in the app.

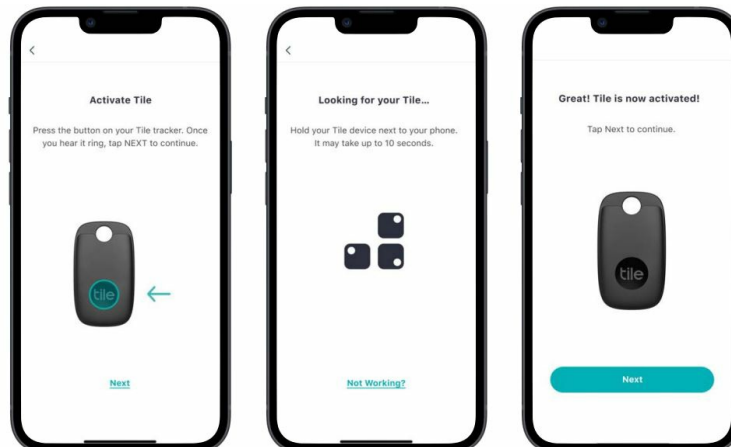

8. Choose the category for the thing you're attaching your Tile to.



9. Give it a test. Tap “Find” in the app to ring your Tile

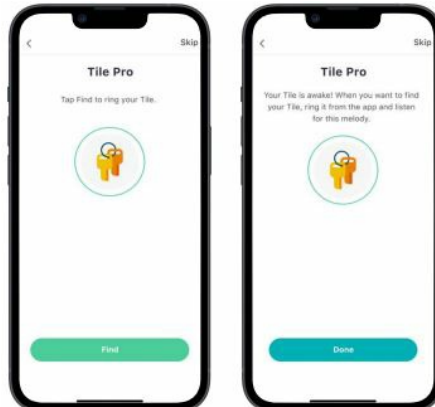

10. Here’s a helpful hint if you can’t find your phone – double press the button on your Tile to make it ring, even if your phone is on silent.

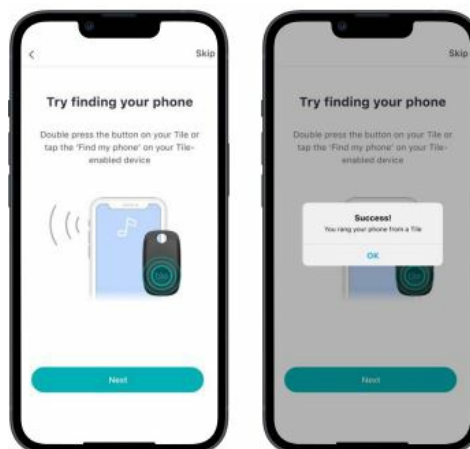

11. Make sure you say “OK” when Tile asks to send you Notifications. That way, you’ll get alerted for permission settings, when you need to change your batteries, and Notify When Found updates. Notifications are also necessary if you want to get Smart Alerts if you’ve left a Tiled item behind.

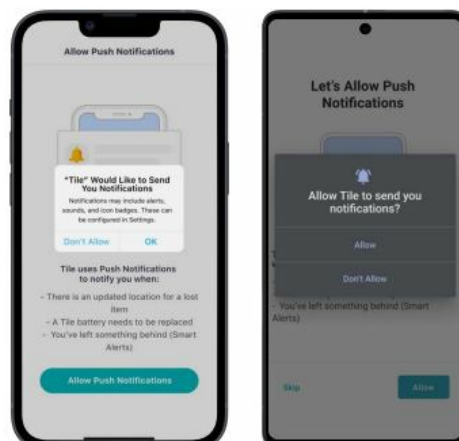

12. Allow Tile to use your location so you can always see the most up-to-date and accurate location of your Tile on the map and find your phone.

- On iOS, set your Location Permissions to “Always.”
- On Android, set your Location Preferences to “Allow all the time.”
- On Android 12 and later, set to “Allow all the time,” then “Precise.”

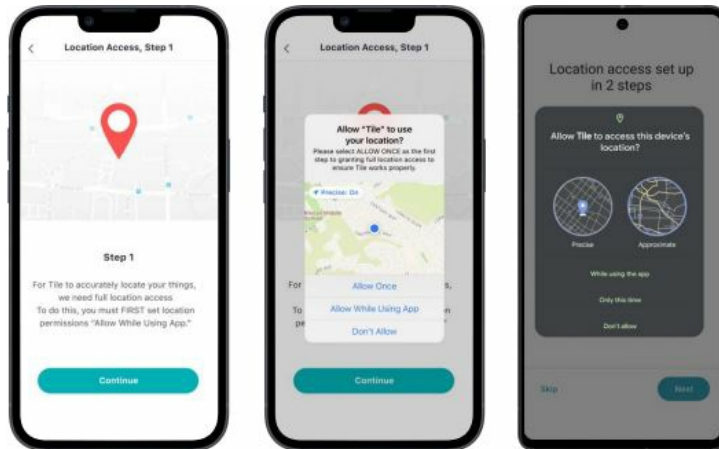

13. You're all set! Now you can see your Tiled item in the app – never lose your thing again.



Frequently Asked Questions

What is the Tile RE-42001, and what can it be used for?

Tile RE-42001 is a small tracker that helps you keep track of your things. You can stick the Tile Sticker to items like remotes, chargers, headphone cases, glasses cases, and other electronic devices, and use the free Tile app to locate them.

How does the Tile RE-42001 work to find items nearby?

You can use the Tile app to ring your Tile when it's within its Bluetooth range of up to 250 ft / 76 m, or you can ask your Smart Home device like Amazon Alexa, Hey Google, or Siri to find it for you.

What if my item with the Tile is outside the Bluetooth range?

: If the item is outside of the Bluetooth range, you can use the Tile app to view your Tile's most recent location on a map to assist in tracking it down

Can I use Tile RE-42001 to find my phone?

Yes, by double-pressing the button on your Tile, you can make your phone ring, even when it's on silent mode.

What if my Tile itself is lost?

If your Tile is lost, you can enlist the secure and anonymous help of the Tile Network. You can also add your contact information so that if someone scans the QR code on your lost Tile, they can reach you.

Is Tile RE-42001 compatible with both Android and iOS devices?

Yes, you can find your items using the free Tile app on both iOS and Android devices.

What are the technical specifications of the Tile RE-42001?

Tile RE-42001 is water-resistant with an IP67 rating, has a non-replaceable battery that lasts up to 3 years, and offers a Bluetooth range of up to 250 ft / 76 m.

Can I upgrade my Tile service for additional features?

Yes, by upgrading to a Premium Plan, you can get proactive Smart Alert notifications if you leave something behind and benefit from Item Reimbursement, where if Tile can't find your item, you will be reimbursed.

Is the Tile RE-42001 water-resistant?

Yes, the Tile RE-42001 is rated IP67 for water resistance, making it suitable for everyday use without worry about exposure to water.

What are the model numbers that work with Alexa and Ok Google?

The Tile models T1501N and T15015 are compatible with both Alexa and Ok Google, allowing you to use voice commands to locate your items.

Video- Product Overview



[Download this PDF Link: Tile RE-42001 \(2021/08\) default manual](#)
[2.mp4.480-2.mp4](#)