

Thundercomm XDV1-0001-R Hand Controller

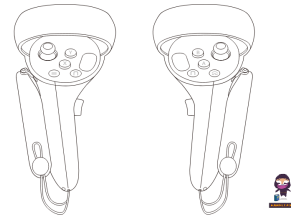

Thundercomm XDV1-0001-R Hand Controller User Guide

[Home](#) » [Thundercomm](#) » Thundercomm XDV1-0001-R Hand Controller User Guide 

Contents

- [1 Thundercomm XDV1-0001-R Hand Controller](#)
- [2 Product Usage Instructions](#)
- [3 FAQ](#)
- [4 Packing list](#)
- [5 Controllers](#)
- [6 Quick start](#)
- [7 Indicator light](#)
- [8 Product specifications](#)
- [9 Safety Information](#)
- [10 FCC Statement](#)
- [11 Documents / Resources](#)
 - [11.1 References](#)
- [12 Related Posts](#)

Thundercomm

Thundercomm XDV1-0001-R Hand Controller

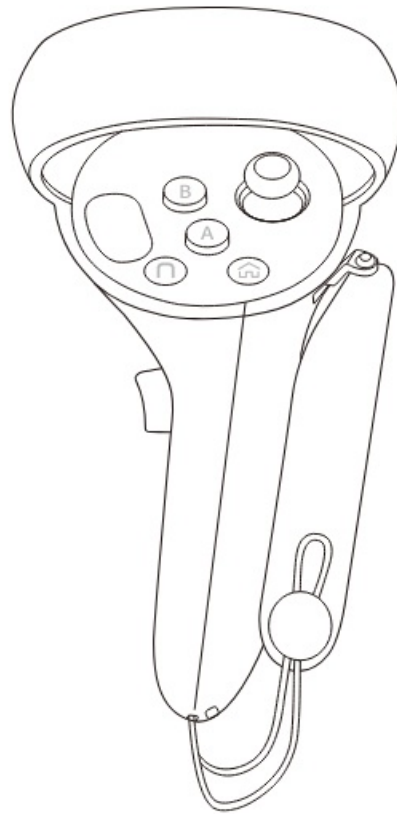
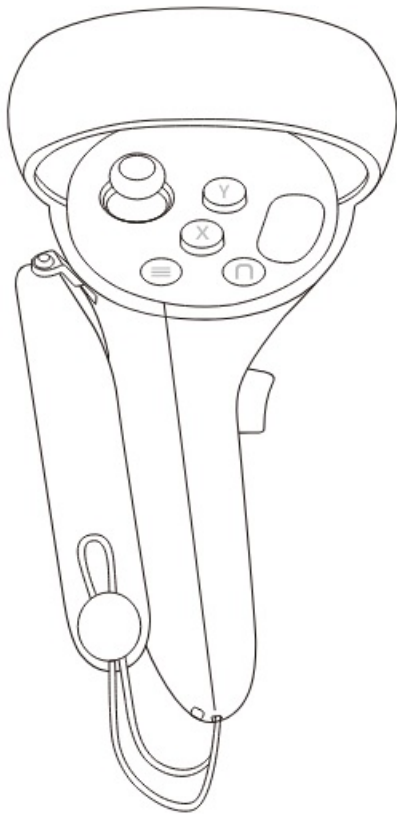

Product Specifications

- Product Name: Hand Controller
- Battery Capacity: 800mAh
- Usage Time: 22 hours
- Product Size: 15.2mm x 108.4mm x 94mm
- Product Weight: 146g

Product Usage Instructions

Preparation before use:

This product tracks the motion state of the controller in various directions to create an immersive interactive experience.

Before using, follow these steps:

1. Prepare a clean and safe space of at least 2 x 2 meters.
2. Avoid large glass, mirrors, and monochromatic walls in the room.
3. Secure the controller strap to prevent accidental removal during use.

Power On:

To power on the controller:

- Press any of the XY keys, menu keys, or Custom keys on the left and right handles to wake them up.
- Ensure wireless pairing of the controller and headset on the device before using.

Charging:

To charge the controller:

- Connect the USB cable (Type-A to Type-C) for charging.

Wireless Pairing:

To pair the controller with VR glasses:

- Left controller: Long press menu button and Y for more than 3 seconds.
- Right controller: Long press Home button and B button for more than 3 seconds.
- The controller will vibrate twice upon successful pairing.

Safety Information:

1. Use in a safe environment with awareness of surroundings.
2. Ensure enough space above and around your head while using the controller.
3. Do not disassemble or repair the equipment yourself to maintain warranty eligibility.

FAQ

Q: How long does the battery last on a full charge?

A: The battery capacity is 800mAh, providing up to 22 hours of continuous usage.

Q: How do I know if the controller is charging?

A: The indicator light will show different colors based on the status. A steady yellow light indicates charging, while a steady green light indicates a fully charged controller.

Packing list

Hand Controller L*1 Hand Controller R*1 Charging Cable*1 Reference Guide*1



Hand Controller L*1



Hand Controller R*1



Charging Cable*1

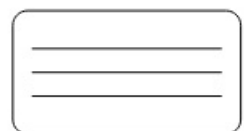

Reference Guide*1

Controllers

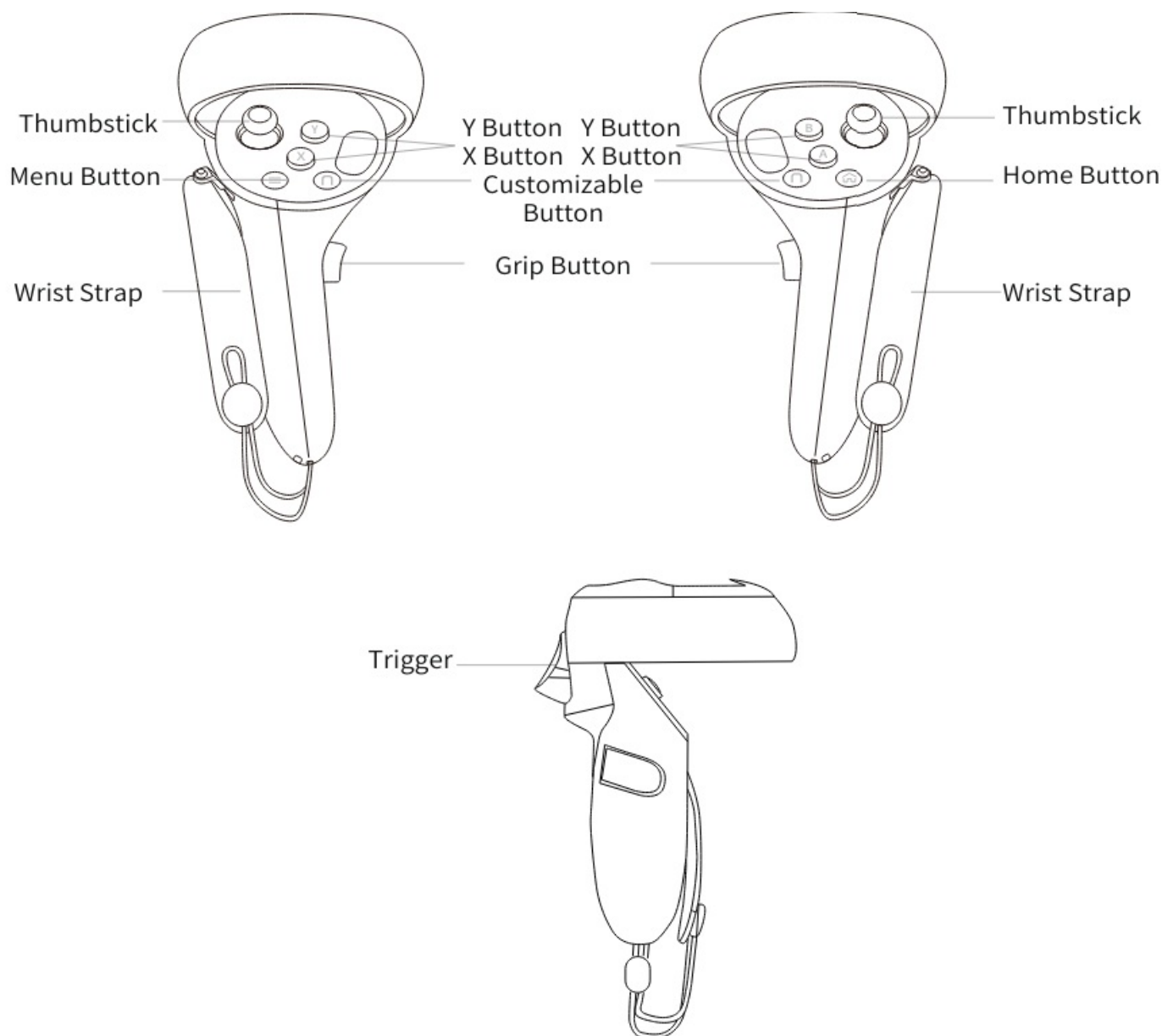

Quick start

Preparation before use

This product can track the motion state of the controller front, behind, left, right, up, down and rotation, and will map your real hand movements in the virtual world in real time to build a fully immersive interactive world. It is recommended that you:

1. Prepare a clean and safe experience space: at least 2 x 2 meters; Keep the room bright and avoid large areas of glass, mirrors, and monochromatic wall Spaces.
2. Secure the controller strap to prevent it from being removed during use.

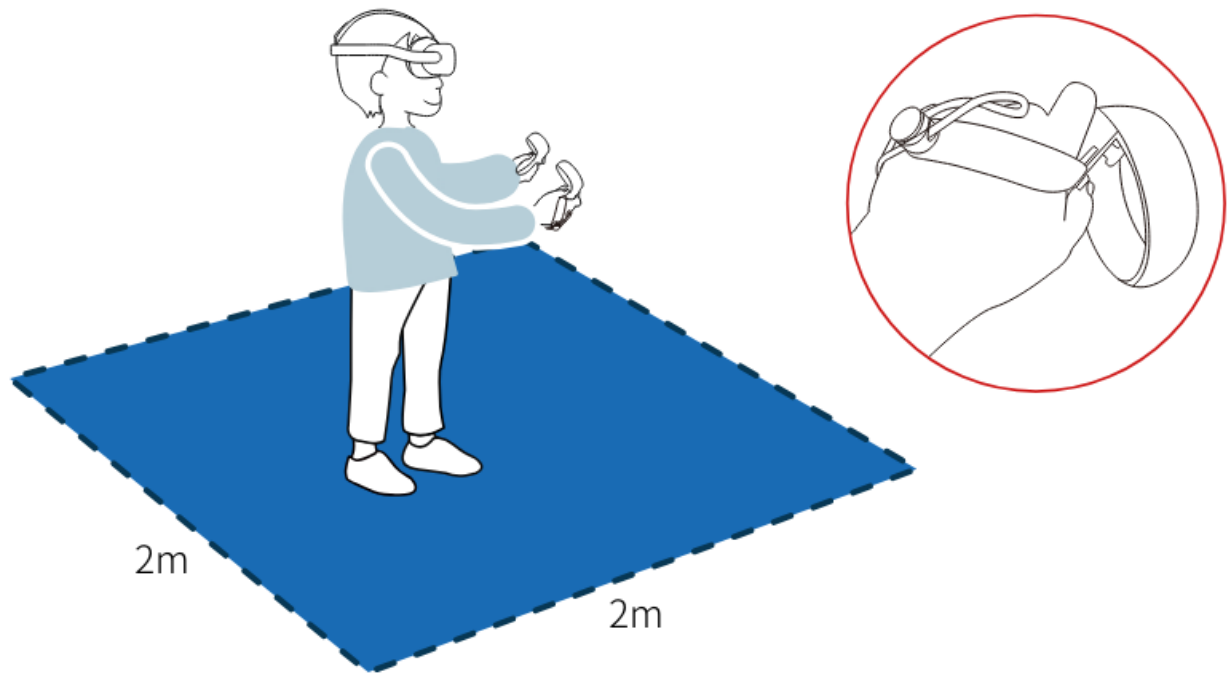

Power on

Press any of the XY keys, menu keys, and Custom keys on the left and right handles to wake up the handles automatically (Suggest wireless pairing of the controller and headset on the device before sales).

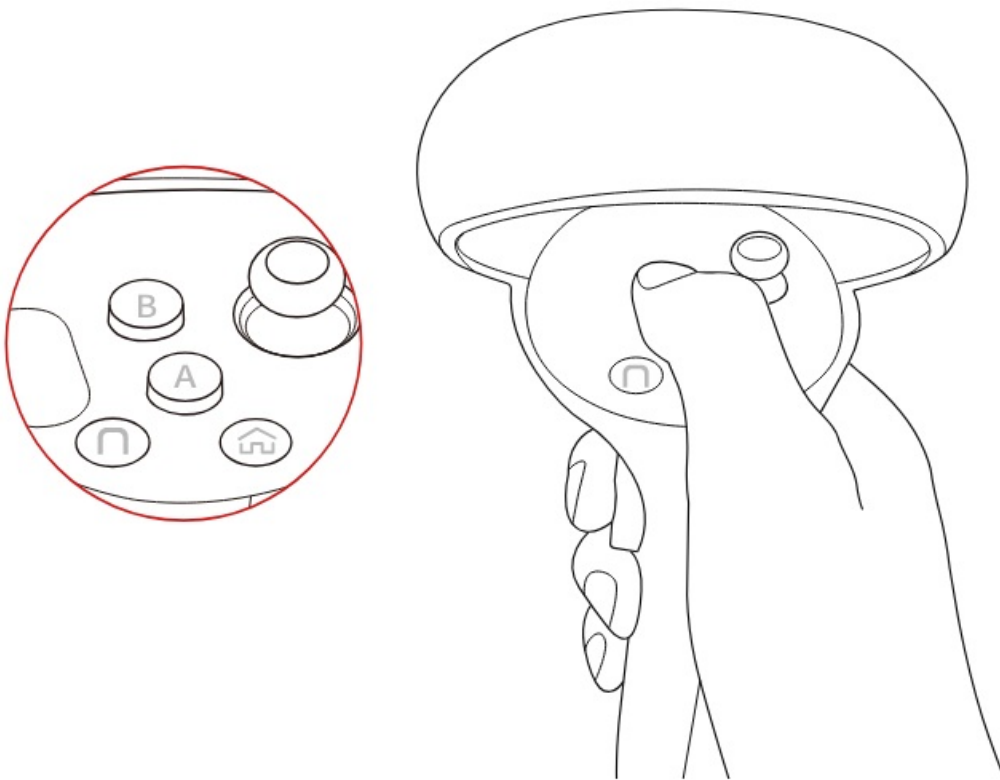

Charging

Connect the USB cable (Type-A to 2C) to charge

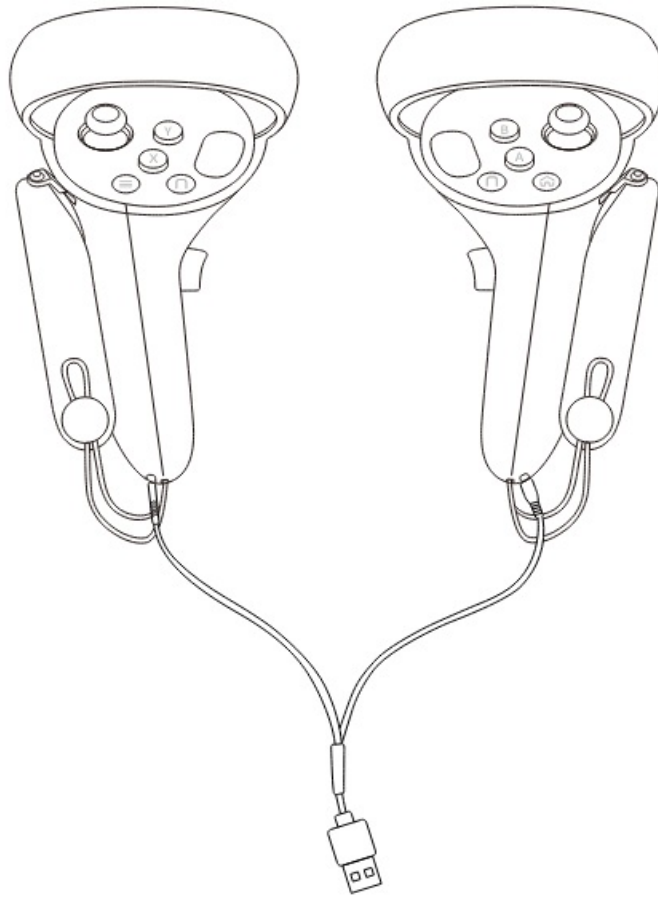

Wireless Pairing

VR glasses start pairing, the left controller long press the menu button and Y for more than 3 seconds, the right controller long-press the Home button and B button for more than 3 seconds, and the controller vibrates twice after successfully pairing.

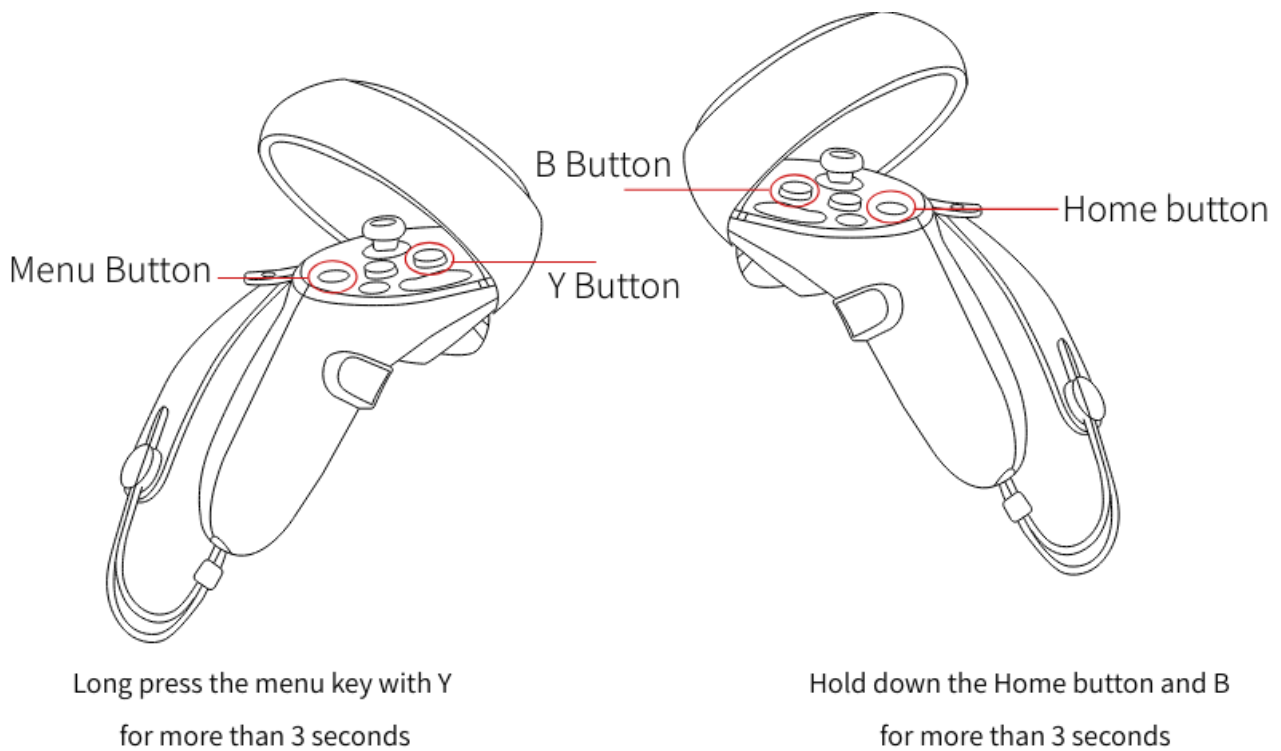

Indicator light

- Green flash 3 times:no connection to the headset
 - Green light is blinking rapidly: In pairing
 - Red light blinks three times at slow speed: the current battery power of the controller is less than 10%,please charge it in time
- Connecting the charging cable yellow indicator is steady
- on: In charging
 - Connecting the charging cable green indicator is steady
 - on: Fully charged
 - Blinking blue, steady on alternately: Firmware update in progress
 - Controller blinks red and green: Hardware failure

Product specifications

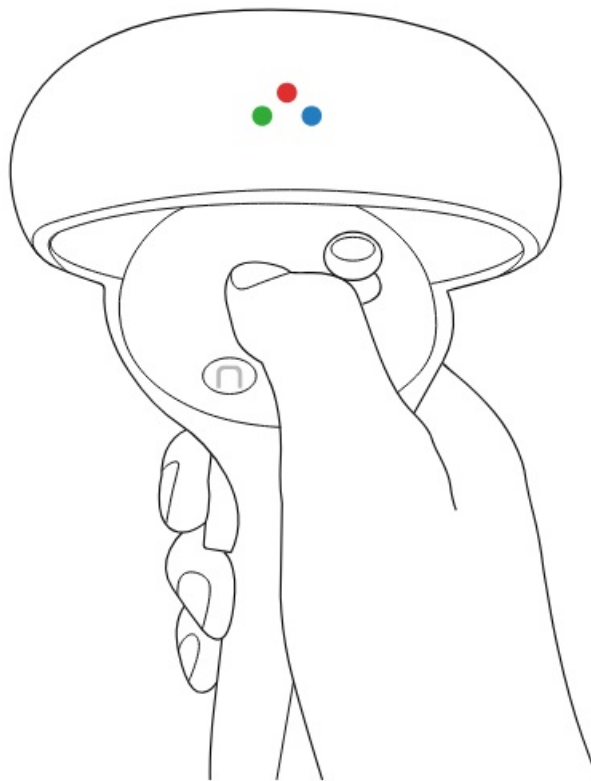

Product Name	Hand Controller
Battery capacity	800mAh
Usage time	22 hour
Product size	152mm*108.4mm * 94mm
Product weight	146g

Safety Information

1. Ensure that it is used in a safe environment. This product creates an immersive virtual reality scene for you, and you can't see around you when using it. Please move within a safe area and always be aware of your

- surroundings. Keep away from stairs, Windows, heat sources, or other dangerous areas.
2. When using the controller, make sure you have enough space above and around your head to extend your arms. Please firmly hold the controller. If you loosen or bump other people or objects during use, it may cause injury or damage to people, pets or objects around you. Before using and operating the equipment, to ensure the best performance of the equipment and to avoid dangerous or illegal situations, please review and follow all safety information.
 3. Do not disassemble, replace or repair the equipment by yourself, otherwise you will lose the warranty qualification. If you need repair service, please contact customer service or go to Sharp's authorized service provider for repair.
 4. Please use the device in the range of 0°C to -35°C, and store the device and its accessories in the range of -20°C to +45°C. When the ambient temperature is too high or too low, the device may be faulty.
 5. Do not expose equipment and batteries to high temperatures or heating devices such as sunlight, heaters, microwaves, ovens, or water heaters. Overheating of the battery may cause an explosion.
 6. When charging is complete or not charging, please disconnect the charger from the device and unplug the charger from the power socket.
 7. Please dispose of the equipment, batteries and other accessories according to local regulations, and do not dispose of them as domestic garbage. Improper battery disposal may cause battery explosion.

FCC Statement

This device complies with Part 15 of the FCC rules. Operation is subject to the following two conditions: 1) this device may not cause harmful interference, and 2) this device must accept any interference received, including interference that may cause undesired operation.

Note: This equipment has been tested and found to comply with the limits for a Class B digital device, pursuant to part 15 of the FCC Rules. These limits are designed to provide reasonable protection against harmful interference in a residential installation. This equipment generates uses and can radiate radio frequency energy and, if not installed and used in accordance with the instructions, may cause harmful interference to radio communications. However, there is no guarantee that interference will not occur in particular installation. If this equipment does cause harmful interference to radio or television reception, which can be determined by turning the equipment off and on, the user is encouraged to try to correct the interference by one or more of the following measures:

- Reorient or relocate the receiving antenna.
- Increase the separation between the equipment and receiver.
- Connect the equipment into an outlet on a circuit different from that to which the receiver is connected.
- Consult the dealer or an experienced radio/TV technician for help.

Changes or modifications not expressly approved by the party responsible for compliance could void the user's authority to operate the equipment.

FCC Radiation Exposure Statement

This device complies with FCC RF radiation exposure limits set forth for an uncontrolled environment. This transmitter must not be co-located or operating in conjunction with any other antenna or transmitter.

Documents / Resources



[Thundercomm XDV1-0001-R Hand Controller](#) [pdf] User Guide
XDV1-0001-R Hand Controller, XDV1-0001-R, Hand Controller, Controller

References

- [User Manual](#)

[Manuals+](#), [Privacy Policy](#)

This website is an independent publication and is neither affiliated with nor endorsed by any of the trademark owners. The "Bluetooth®" word mark and logos are registered trademarks owned by Bluetooth SIG, Inc. The "Wi-Fi®" word mark and logos are registered trademarks owned by the Wi-Fi Alliance. Any use of these marks on this website does not imply any affiliation with or endorsement.