



# THUNDERBIRD T40-2000 Indicator and Loadbar Set Instruction Manual

[Home](#) » [THUNDERBIRD](#) » THUNDERBIRD T40-2000 Indicator and Loadbar Set Instruction Manual 

## Contents

- 1 THUNDERBIRD T40-2000 Indicator and Loadbar Set
- 2 Product Information
- 3 Product Usage Instructions
- 4 Whats In this box
- 5 Specifications
- 6 Power + Charging
- 7 Important Information
- 8 Understanding your indicator
- 9 Setting up the T40 for the first time
- 10 Installation
- 11 Installing the Load bars
- 12 Weighing
- 13 Thunderbird Data Management
- 14 Start a weighing session
- 15 Understanding the weighing screen
- 16 Weighing small static loads
- 17 Zero Tracking
- 18 Care and Maintenance
- 19 WARRANTY
- 20 Documents / Resources



**THUNDERBIRD T40-2000 Indicator and Loadbar Set**



## Product Information

The T40 Indicator is a weighing device designed for use in agricultural settings. It comes with a pair of 2000KG Load bars, a mounting bracket, and a 240V charging adapter. The indicator has a battery that needs to be charged before first-time use.

## Specifications

- Weight unit: Kilograms (kg) or Pounds (lbs)
- Power input: External power connection
- Weigh screen: Displays weight and other information
- Weigh button: Records animal weight
- Tare/zero button: Sets the scale to zero
- Battery charge indicator: Shows the battery charge status
- Power button: Turns the T40 on/off
- Mode button: Changes weighing modes

## Product Usage Instructions

### Power + Charging

Before using the T40 for the first time, it is recommended to charge the internal battery for a minimum of 10 hours. Here's how to charge the battery:

1. Connect the power adapter to the base of the unit.
2. Plug the T40 into a power outlet.
3. The charging icon will display on the screen.
4. When the charge shows 100%, the T40 is ready to use with or without the power adapter.

**Note:** If the battery needs to be replaced, take the scale to a Thunderbird Authorised Service Centre.

## Understanding your indicator

The T40 indicator has various buttons and indicators. Here's what each component does:

- Load bar connectors: Connects the load bars to the indicator
- Power input: External power connection
- Weigh screen: Displays weight and other information
- Weigh button: Records animal weight
- Tare/zero button: Sets the scale to zero
- Battery charge indicator: Shows the battery charge status
- Weigh unit: Displays weight in kilograms (kg) or pounds (lbs)
- Power button: Turns the T40 on/off
- Mode button: Changes weighing modes

### Setting up the T40 for the first time

Follow these steps to set up the T40 indicator for the first time:

1. Turn on the T40 indicator.
2. To change the weight unit, press and hold down the MODE button for 3 seconds. A beep will sound when the weight unit changes between kilograms (kg) and pounds (lbs).
3. Press the MODE button to select a weighing mode.

### Weighing Modes

The T40 indicator offers the following weighing modes:

- **AUTO (Automatic):** In Automatic mode, the T40 will automatically start weighing the animal. When an accurate weight is determined, it will lock on to the measurement and display it on the screen. This mode is recommended for well-set-up yards where animals flow smoothly. The T40 defaults to AUTO mode when switched on.
- **MANUAL:** Manual mode allows the operator to decide when the measurement is made by pressing the Weigh button to lock the weight. This mode is recommended for yards where animals do not flow smoothly or are disruptive. The operator has greater control over the weighing session. Press the Mode button once to enable Manual mode.
- **FINE:** Fine mode is recommended for weighing small static loads such as fleeces or produce. In Fine mode, the weigh scale uses finer weight increments and zero tracking is automatically switched off. The weight is displayed when placed on the platform and displays zero when the load is removed. Press the Mode button twice until FINE briefly appears on the screen, then 0.0kg/lb displays.

### Installation

#### Installing the T40 Indicator

Follow these steps to install the T40 indicator:

*Installing on a wood surface:*

1. Mount the bracket to a flat or round wood surface using the provided screws.

*Installing on a steel surface:*

1. Use the U-bolts, bolts, and nuts supplied to mount the bracket on a vertical or horizontal pipe.

## **Installing the Load bars**

Follow these steps to install the load bars:

1. Select a location that provides a solid, level, and well-drained surface.
2. Ensure the load bars and platform are well secured and clear of any obstructions.
3. Ensure the platform does not rock or move, and use spacers if required.
4. Bolt the load bars to the concrete pad or locate them on studs set into the concrete.

## **Whats In this box**

- T40 Indicator + 2000KG Load bars (pair)
- Mounting Bracket
- 240V Charging adapter

## **Specifications**

- Operating Temperature – -20oC to +70oC
- Battery charge temperature – -0oC to +50oC
- Environmental Protection Rating – IPX4
- Weight – Indicator: 0.9kg / System weight: 20.1kg
- Estimated battery operating time – 30 Hours

## **Power + Charging**

To ensure optimum performance, it is recommended that the internal battery is charged for a minimum of 10 hours before first time use.

1. Connect the power adapter at the base of the unit and plug the T40 into a power outlet. The charging icon will display on the screen.
2. When the charge shows 100%, the T40 is ready to use with or without the power adapter.

## **Important Information**

- Charging of the T40 should be in a cool (+10oC to +30oC) place.
- If the T40 is to be stored for an extended period, this should be in a cool dry place (-20oC to 25oC, humidity 45% to 85%) with a fully charged battery. The T40 should be charged until full every 6 months.
- Always charge the battery indoors.

## **Note**

- When the T40 is in use, the battery icon will display and show remaining charge.
- When using the scale and the charge level falls below 5% the battery icon will flash. You will have about 60

minutes to complete the weighing session before the T40 must be charged.

- Charging outside the recommended temperature range will reduce charging performance. When charging above 40oC, the charging time is increased.
- If charging temperatures have been exceeded, charging will stop until the unit cools down. The charge indication will stop in this condition.
- If a battery error occurs the battery indicator will flash all the segments. Return the Weigh Scale to a Thunderbird Authorised Service Centre for battery replacement.

### Battery Charge Status



Fully Charged



25 - 50% charge



Less than 25% charge



5% or less charge remaining

When the battery level drops to 0%, three beeps will sound and shut down.

## Understanding your indicator



## Setting up the T40 for the first time

- **Set the weight unit.**

Turn on the T40 indicator. To change the weight unit, press and hold down the MODE button for 3 seconds. A beep will sound when the weight unit changes between kgs and lbs.

- **Selecting the weighing mode**

Press the Mode button to select a weighing mode.

Weighing Modes	
<b>AUTO</b> <b>(Automatic)</b>	<p>In Automatic mode the T40 will automatically start weighing the animal. When the scale has determined an accurate weight, it will lock on to the measurement and display it on the screen.</p> <p>This mode is recommended for yards that are well set up and allow the animals to flow smoothly.</p> <p>The T40 defaults to AUTO mode when switched on.</p>
<b>MANUAL</b>	<p>Manual mode allows the operator to decide when the measurement is made by pressing the <b>Weigh</b> button to lock the weight.</p> <p>Manual mode is recommended for yards that do not allow the animals to flow smoothly or where the animals are disruptive. The operator has greater control over the weighing session. Press the <b>Mode</b> button once to enable Manual mode.</p>
<b>FINE</b>	<p>Fine mode is recommended for weighing small static loads such as fleeces or produce. In Fine mode, the Weigh Scale uses finer weight increments and zero tracking is automatically switched off.</p> <p>In Fine mode, the weight is displayed when placed on the platform and displays zero when the load is removed.</p> <p>Press the <b>Mode</b> button twice until <b>FINE</b> briefly appears on the screen, then 0.0kg/lb displays.</p>

## Installation

### Installing the T40 Indicator

The T40 is supplied with a mounting bracket kit, for mounting on steel or wood. Mounting kit contains:

- Moulded bracket
- 2 x U-bolts
- 4 x Tech screws – 65mm
- 4 x M10 nuts
- 4 x M10 Bolts – 20mm for load bar

### Installing on a wood surface

The bracket can be mounted to a flat or round wood surface. Same as Gal (4 screws)



### Installing on a steel surface

To mount the bracket on either a vertical or horizontal pipe, use the U-bolts, bolts and nuts supplied.

## Installing the Load bars

1. Select a location that provides a solid, level and well drained surface.
2. Ensure the load bars and platform are well secured and clear of any obstructions.
3. Ensure the platform does not rock or move and fill with spacers if required.
4. Either bolt the load bars to the concrete pad or locate them on studs set into the concrete. It is important that the load bars and platform sit flat without any rocking or twisting.
5. Connect the load bar cables to the T40 indicator.

A beep will sound indicating a successful connection of the load bars.

**WARNING** – DO NOT WELD THE LOADBARS OR ANY STRUCTURE THAT THEY ARE ATTACHED TO. Load bars contain sensitive electronic devices which will be damaged by welding. Damaged caused from welding, will not be warranted.

## Weighing

There are 2 ways to use the T40 scale. It can be used on its own, or in conjunction with the Thunderbird Data Management mobile application. Use the application if you wish to record your session when weighing animals.

### Before Weighing

1. Check the load bars are connected to the T40 Indicator
2. Turn on the T40 Indicator using the Power Button.
3. Check the weight displayed is ZERO. If not, press the TARE button.

## Thunderbird Data Management

- The Thunderbird Data Management app is used to record live sessions and control the T40 indicator



- Use your mobile device to control your weighing sessions.
- After weighing your animals, you have the capability to sync your data and transfer the session direct to NLIS or send information to a CSV file. Where you can manage transfers, as well as monitoring your animals' weights and weight gains
- Download the app from Google Play or App Store.



Open the app and follow the prompts to sign up and create an account.

## Start a weighing session

### Thunderbird Data Management Application

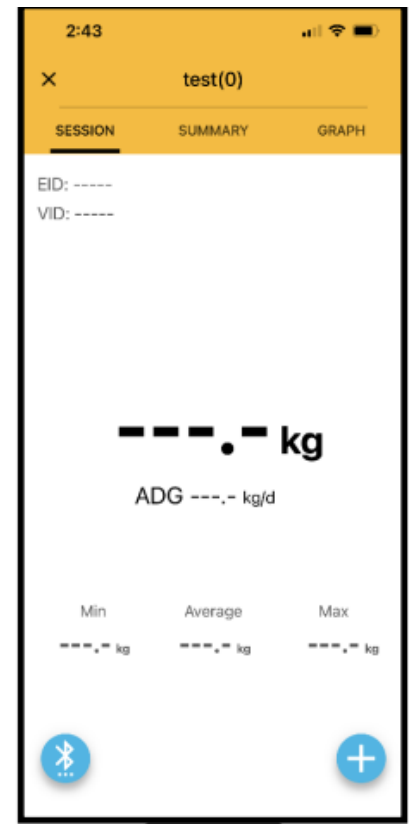
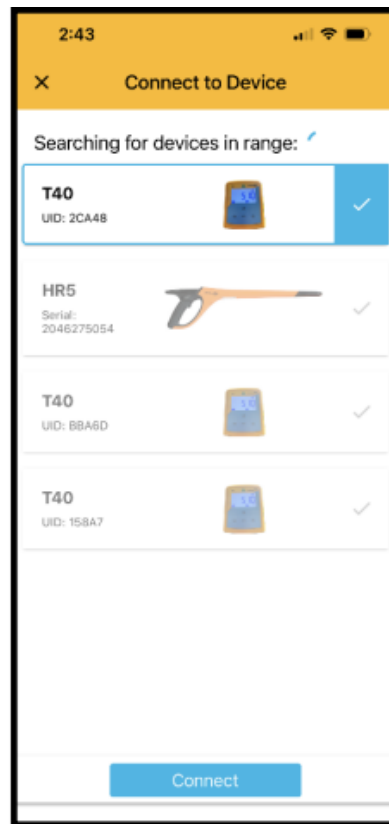
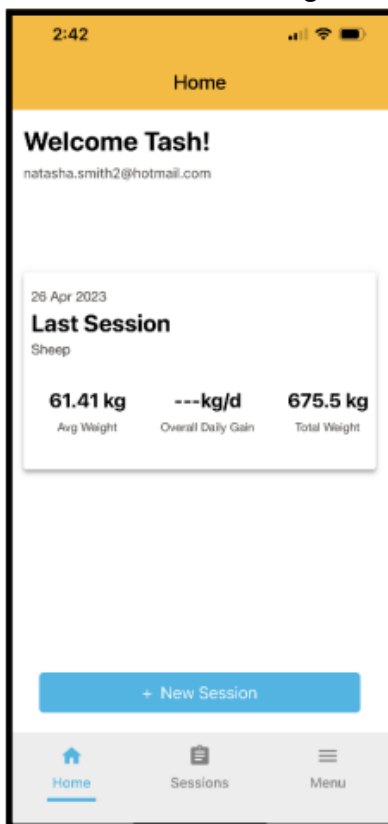

- Open App on your mobile device. From the home screen, tap new session, type the new session name and tap Done
- The app will begin to search for available devices within range. Select the T-40 and tap connect.
- The weigh screen will open. Ready for the session to commence. Refer to page 12 (how to commence weighing)

### Note

If you have previously connected to the T40 with your mobile device and come within range of the T-40, it will automatically connect.

## Understanding the weighing screen

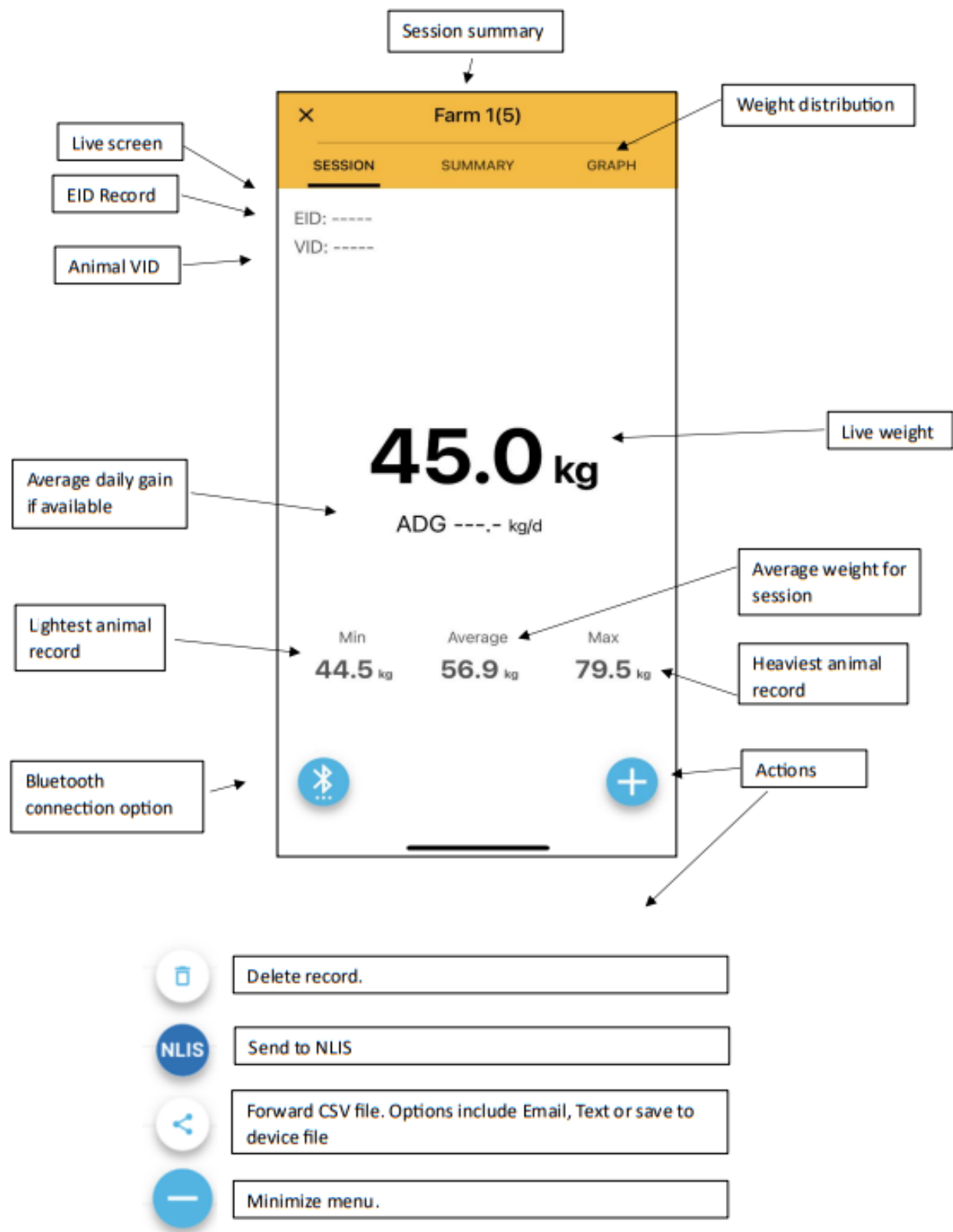

### Starting a weighing session on the T40

If you are weighing animals without the Thunderbird Data Management app, once the scale is turned on and weight displayed in zero, you can start weighing your animals. Refer to weighing animals below.

**NOTE** – If you are using the scale only, animal weights are not recorded.

### Weighing animals

Load the first animal onto the platform. Ensure the animal is entirely supported by the platform – no hooves on the ground or resting against other objects.

In AUTO mode	<ul style="list-style-type: none"> <li>the T40 will automatically start weighing.</li> <li>When the weight becomes stable it will lock and remain on screen until the next animal enters.</li> <li><b>For App users:</b> type in a VID number (if you want to record this.</li> </ul> <p>Tap the <b>Actions</b> button &gt; <b>Add VID</b>.</p>
In Manual mode	<ul style="list-style-type: none"> <li>press the <b>Weigh</b> button to start weighing. When the weight becomes stable it will lock and remain on screen until the animal leaves the platform.</li> <li><b>For App users:</b> type in a VID number, tap Actions. button &gt; <b>Add VID</b>.</li> </ul>

- When the weight locks, there will be a beep from the scale to indicate the weight has been recorded / read.
- In either weigh mode, you can re-weight an animal by pressing the weigh button to secure the new weight.

## Weighing small static loads

Press the mode button until FINE appears on the screen. FINE is displayed for 2 seconds and then the 0.0kgs displays.

- Place the load onto the platform.
- The weight displays on the scale and / or the app if using.
- The app does NOT record the weight. You will need to write this down if desired.
- Remove weight from scale.

## Completing a Weighing Session using the app

When the weighing session is complete, the recorded session on the mobile app will need to be concluded by 'finishing' the session. This data is stored on the mobile data base.

### Sending data to NLIS

- Go to the sessions screen on the app.
- Select the session you would like to transfer to the NLIS data base by selecting the tick box.

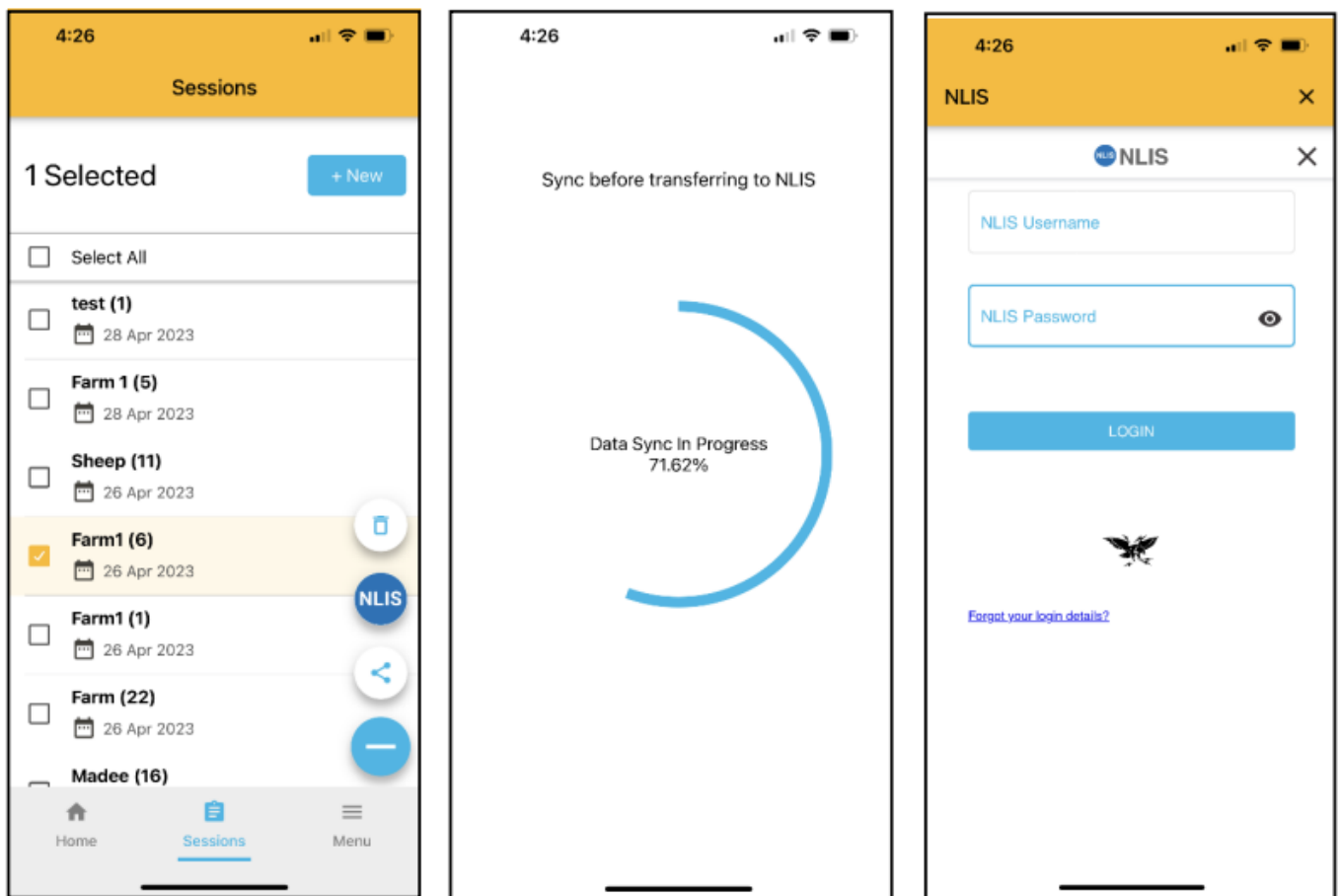

- Tick box and select the + button to display options NLIS > links direct to the NLIS database Options tab will enable you to send CSV file
- NLIS sync will take place. All of the session information will be transferred direct to the NLIS database.
- For first time transfer / sync, the user will be required to link their NLIS account, by entering credentials.

## Zero Tracking

During a weigh session, small amounts of debits such as mud can accumulate on the weighing platform. After each animal leaves the platform, the scale compensates for the small number of debris left, by automatically zeroing the weight.

## Care and Maintenance

The T40 system is robust and designed for typical livestock environments, Proper care and maintenance can extend its life.

Below recommendations to keep the T40 in good condition:

- Do not expose the T40 to excessive temperatures or fire. (Below -20oC or above +70oC).
- Do not submerge the T40 in any liquid.
- Store in a cool, dry place. Avoid storing in direct sunlight.
- After use, clean with a damp cloth. Take care not to scratch the display.
- If storing the T40 for a long time, store with the battery fully charged.
- If battery fluid comes in contact with –

**Eyes** – flush the affected area with water for at least 15 minutes. Ensure adequate flushing by separating the

eyelids with fingers. Call a physician.

**Skin** – immediately flush with water and/or soap.

- This Weigh Scale contains a Lithium battery which is not user replaceable. The lithium battery must be replaced by a trained professional using a Thunderbird approved battery. Return the unit to a Thunderbird Authorized Service Centre for battery replacement.

## WARRANTY

Thunderbird warrant all scale indicators and load cells against defective workmanship and faulty materials for 2 years from the date of purchase. We undertake, at our option, to replace or repair free of charge each product, or part thereof, on condition that it is returned to our factory, freight prepaid, and found on examination to be suffering from material or constructional defect. We cannot be held responsible for any repair other than those carried out by us or our authorized agent.

A photocopy of your proof of purchase and a request for warranty must also be returned with the item. This warranty is void if the product is subject to improper use or handling, incorrect power input voltage, load cells found to have electrical damage caused by welding, damage through contact with chemicals, flooding, fire, explosion, excessive heat, lightning strikes, insect damage, moisture damage or damage to external wiring. Any warranty on load cells will become void if they are found to have been subject to excessive weight, or failure caused by corrosion due to excessive buildup of manure and moisture.

### Thunderbird Ag Pty Ltd

ABN 75 145 262 246

11 Industrial Avenue | PO Box 391

Mudgee NSW 2850 P – 02 6372 3600

F – 02 6372 2597 E – [sales@thunderbird.net.au](mailto:sales@thunderbird.net.au)

### For your records:

Model No.: .....

Serial No.: .....

Date of Purchase: .....

Place of Purchase: .....

Receipt No.: .....

## Documents / Resources

 <p>The image shows the cover of the Thunderbird T40-2000 Instruction Manual. It features a yellow header with the Thunderbird logo and the text 'T40-2000 Instruction Manual'. Below the header is a photograph of the scale and indicator unit. At the bottom, it says 'JOIN THE SMARTER WEIGH'.</p>	<p><a href="#">THUNDERBIRD T40-2000 Indicator and Loadbar Set</a> [pdf] Instruction Manual</p> <p>T40-2000 Indicator and Loadbar Set, T40-2000, Indicator and Loadbar Set, and Loadbar Set, Loadbar Set</p>
---	---