



THUNDERX3
3 LAB-X Engine
Gaming Desk



Contents [[hide](#)]

- [1 THUNDER X3 LAB-X Engine Gaming Desk](#)
- [2 Specifications](#)
- [3 Product Information](#)
- [4 Assembly Instructions](#)
- [5 TOOLS REQUIRED](#)
- [6 Product Usage Instructions](#)
- [7 Cleaning Instructions](#)
- [8 Maintenance and Repair](#)
- [9 Disposal and Recycling](#)
- [10 Warranty](#)
- [11 FAQs](#)
- [12 Documents / Resources](#)
 - [12.1 References](#)
- [13 Related Posts](#)



THUNDER X3 LAB-X Engine Gaming Desk



Specifications

- Product Name: LAB-X Motor Gaming Desk
- Version: 1.5
- Website: thunderx3.com/tech-support/

Product Information

The LAB-X Motor Gaming Desk is a sturdy and versatile desk designed for gaming enthusiasts. It comes with various components labeled from A to K for assembly.

Warning

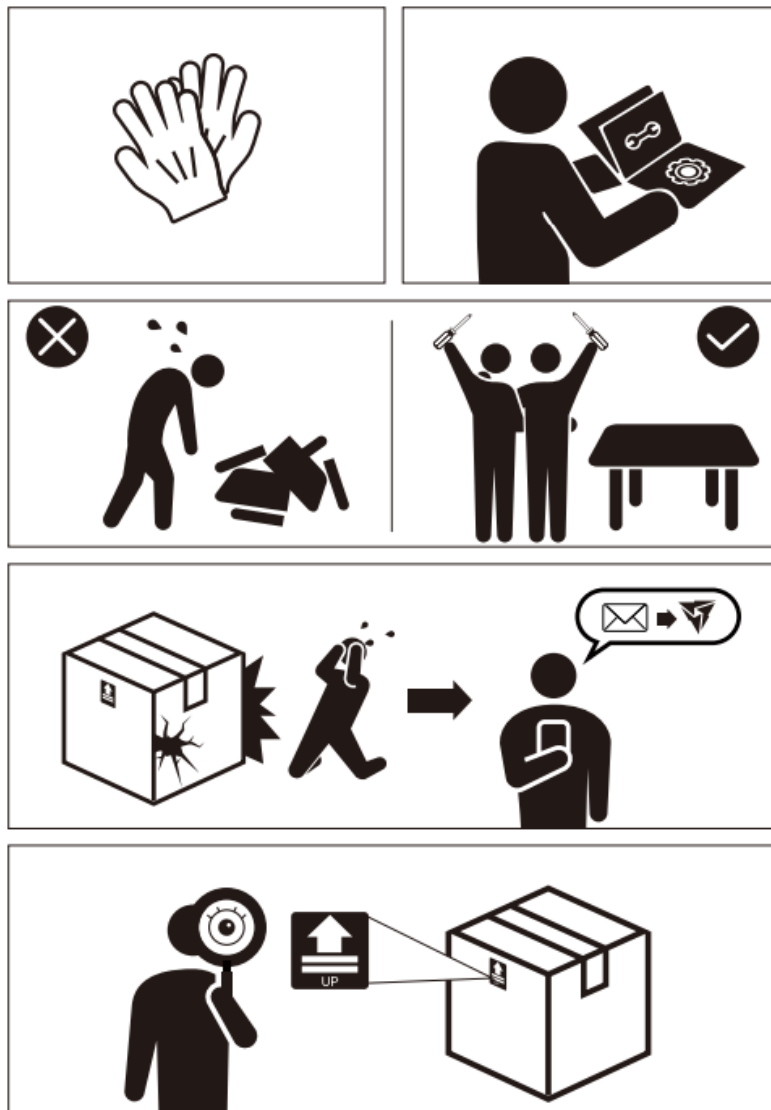

Assembly Instructions

Step 1: Preparing Components

Identify and organize all components labeled from A to K.

TOOLS REQUIRED

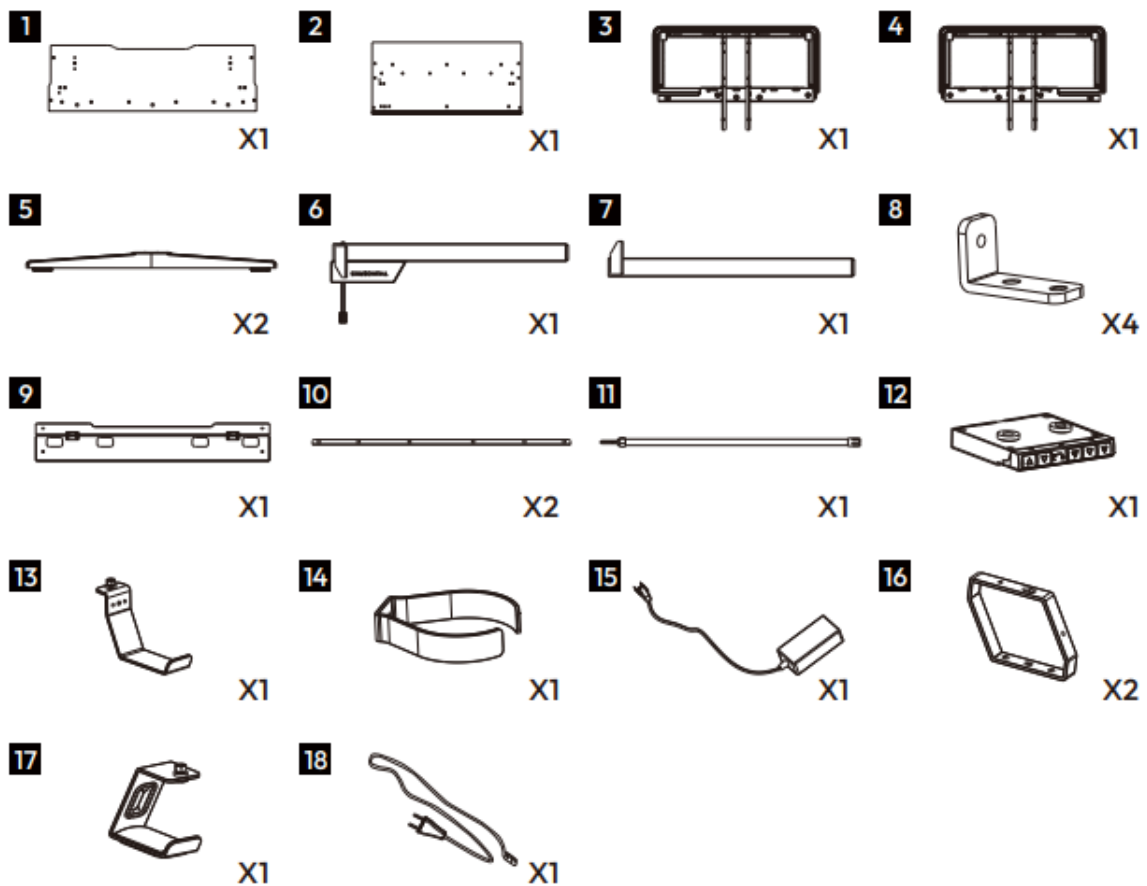
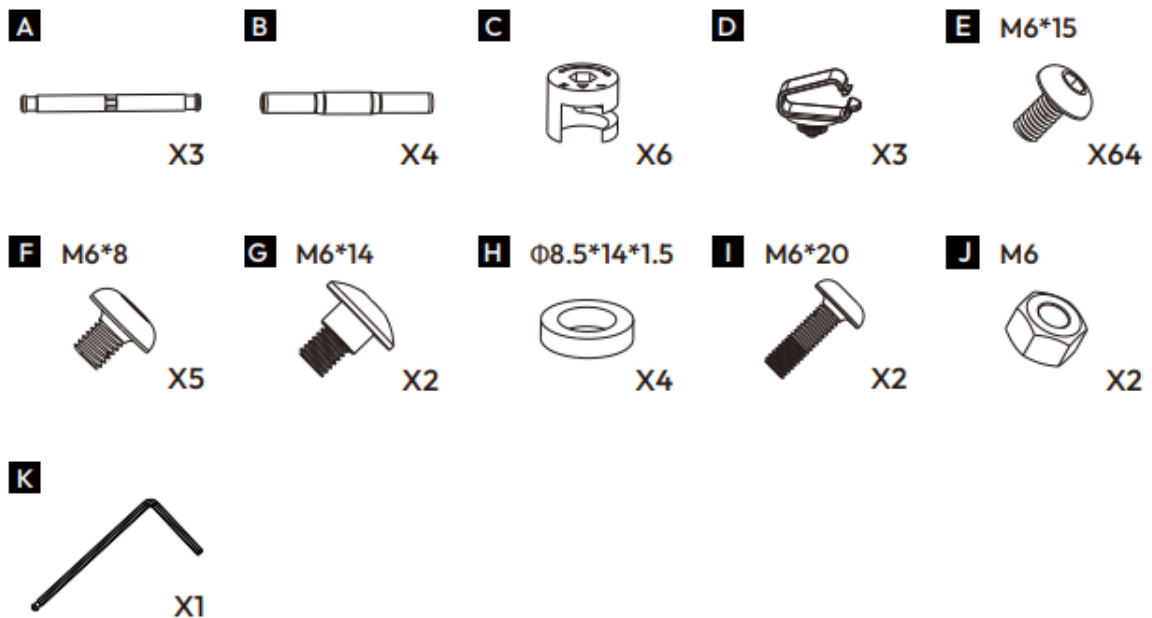

Step 2: Assembling the Frame

1. Start by connecting components X3, X4, and X6 as shown in diagram 1.

1.

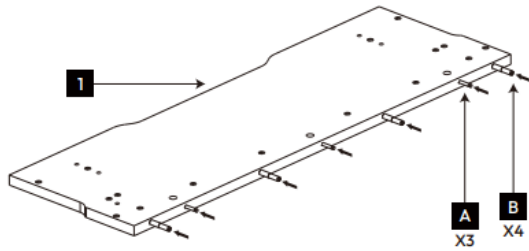

2.

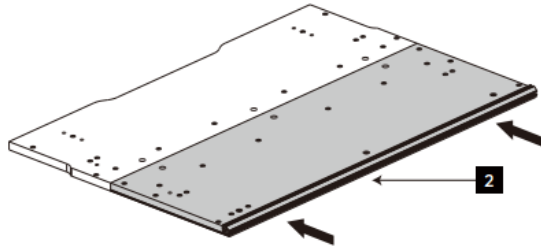

3.

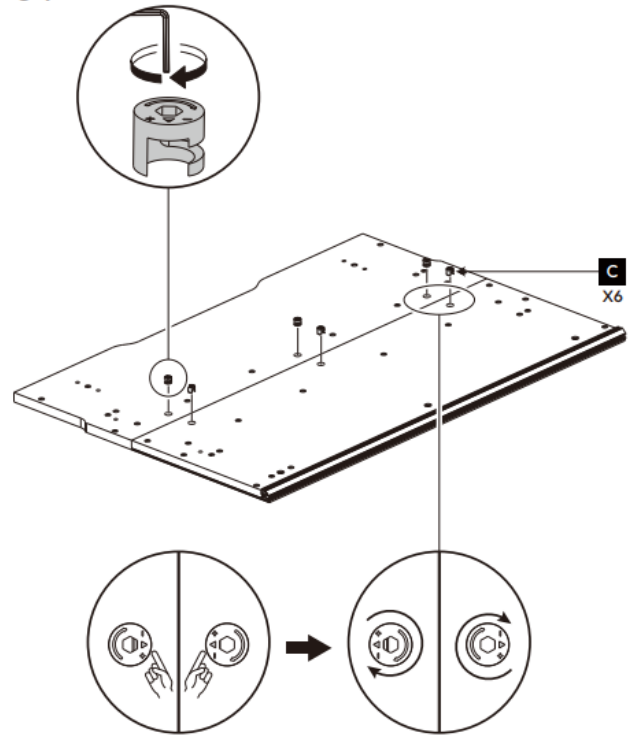

2. Continue with components X3, X64, and C for the frame assembly.

Step 3: Attaching Legs and Supports

Attach components E and X12 as legs and supports to the frame following the provided instructions.

4.

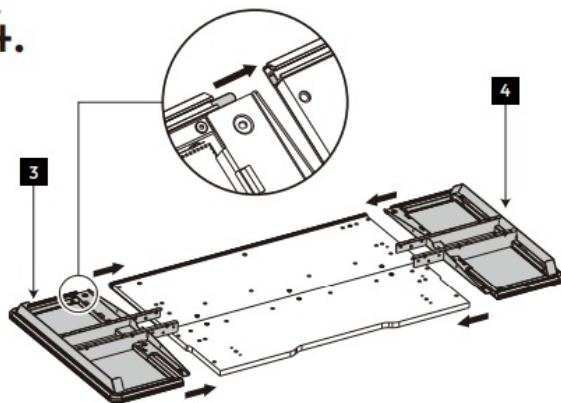

5.

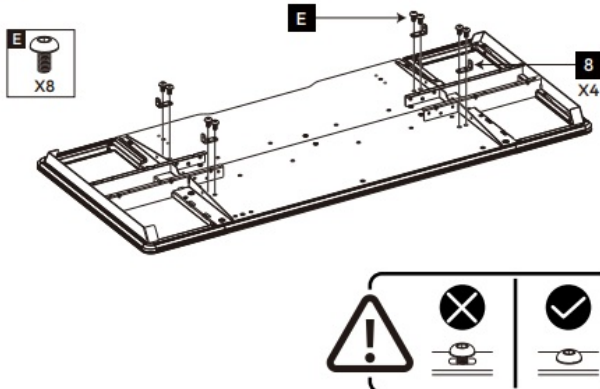

6.

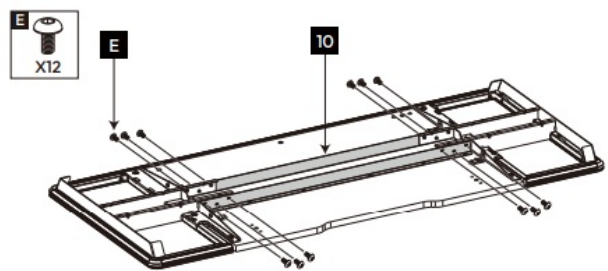

7.

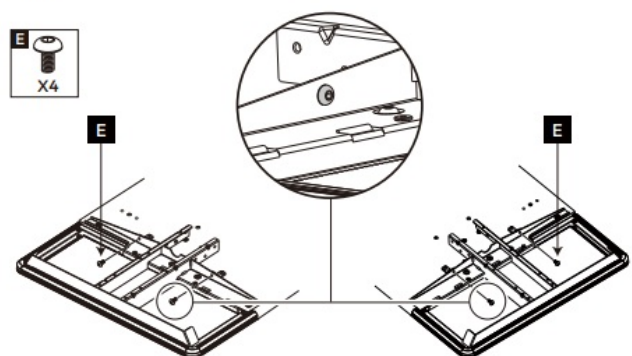

8.

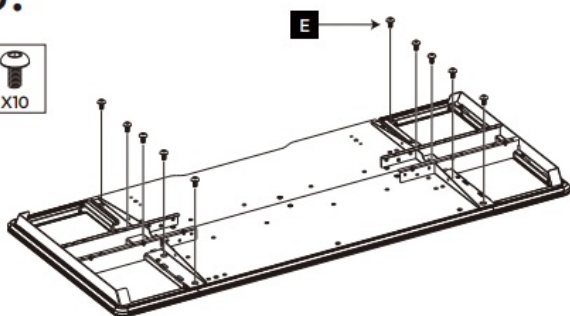

9.

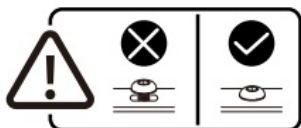
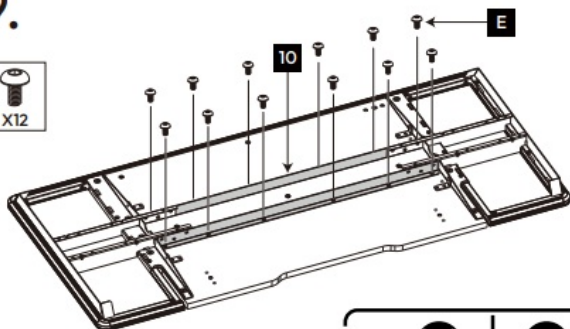

11.

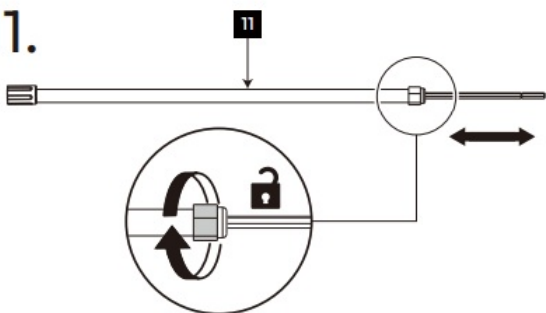

12.

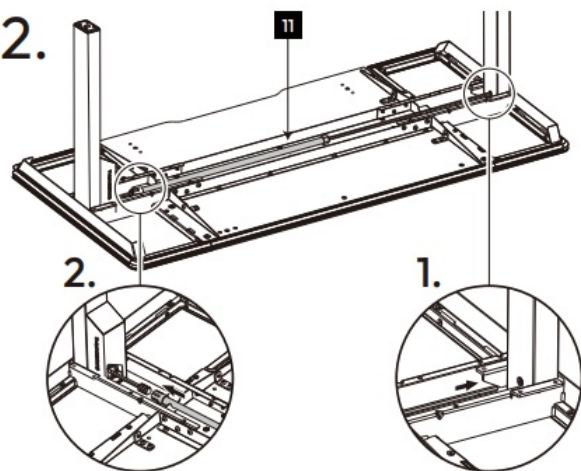

10.

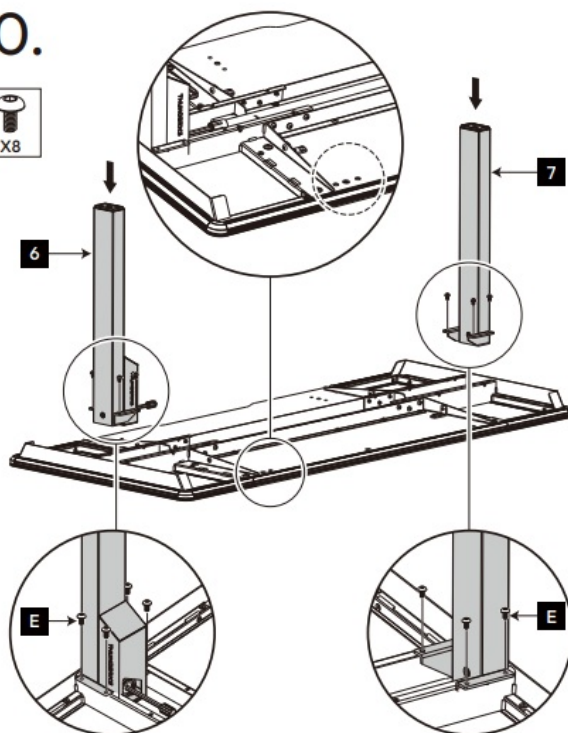

13.

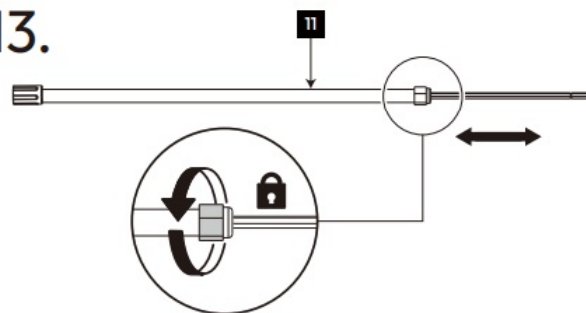

14.

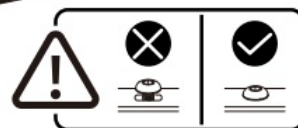
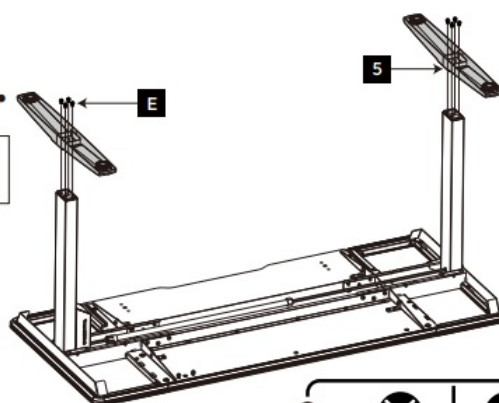

15.

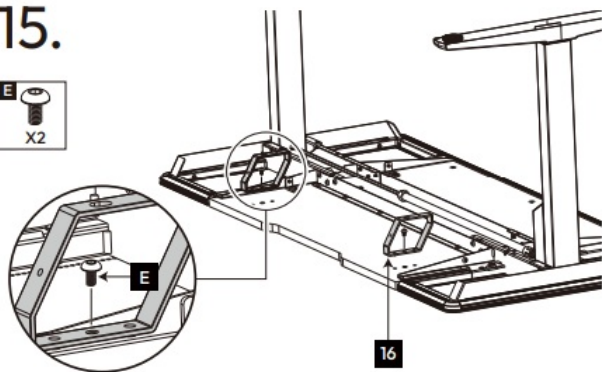

16.

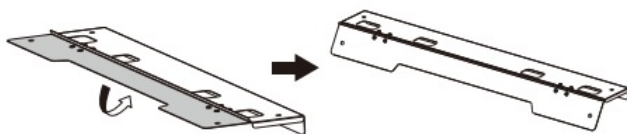

19.

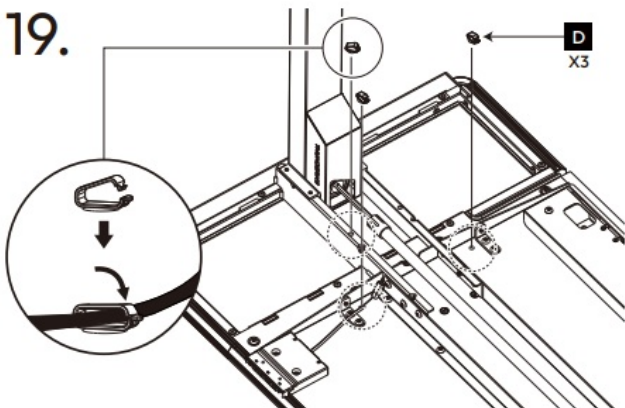

20.

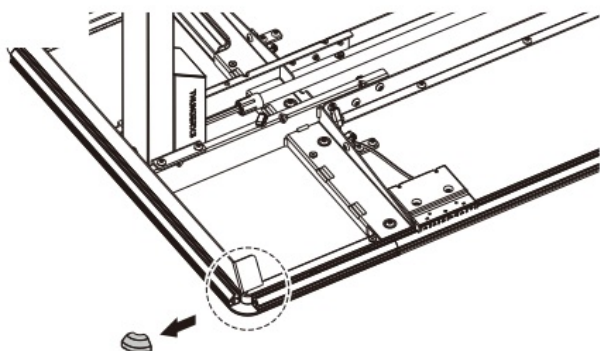

17.

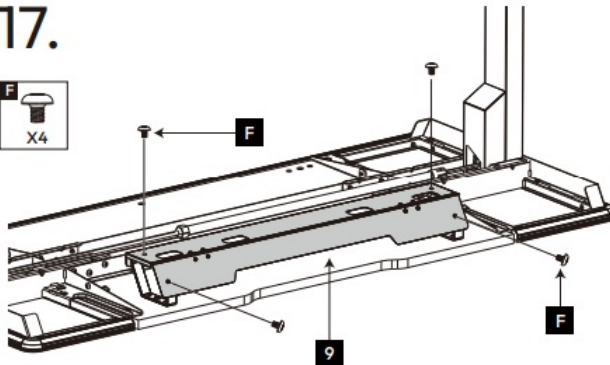

18.

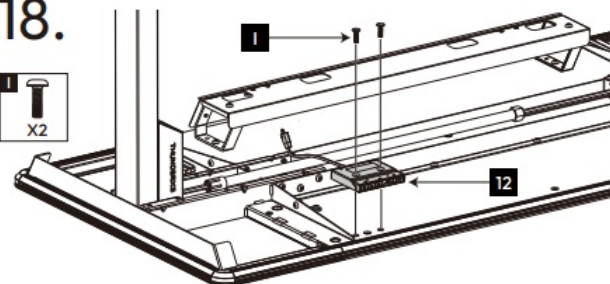

21.

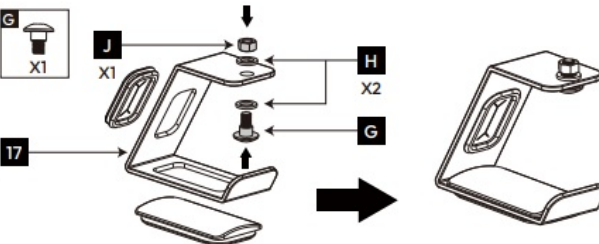

22.

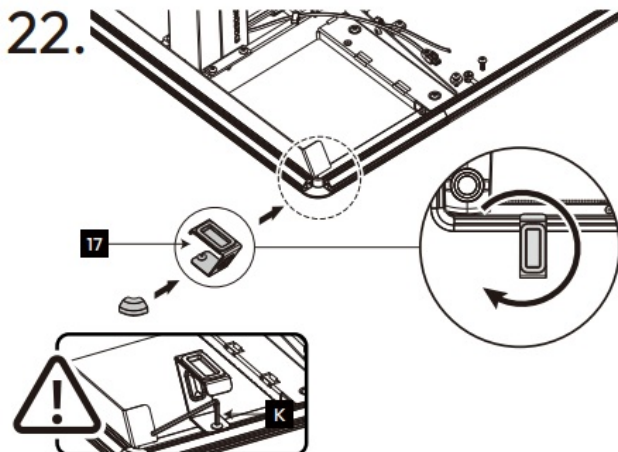

23.

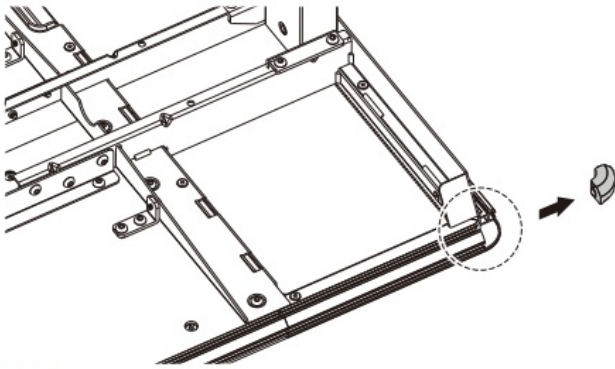

24.

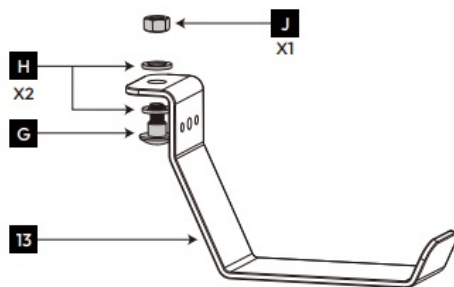

27.

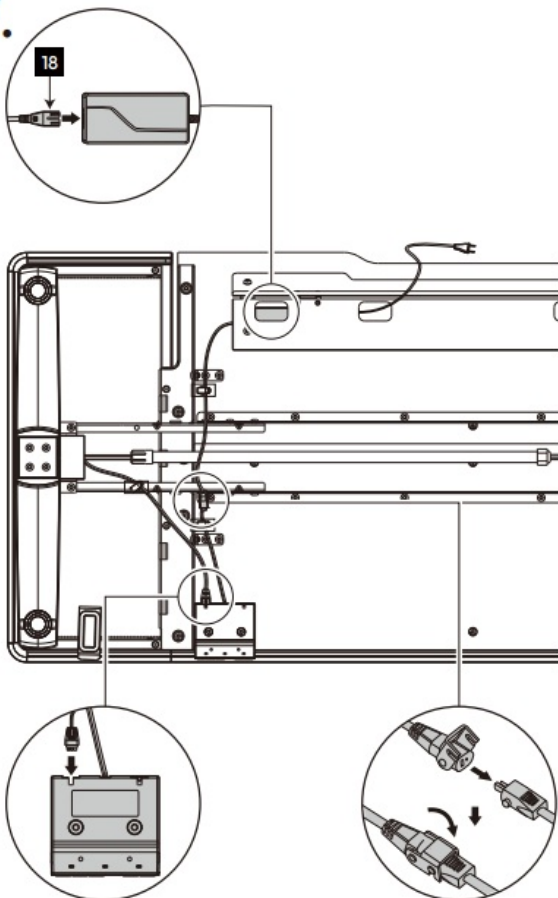

25.

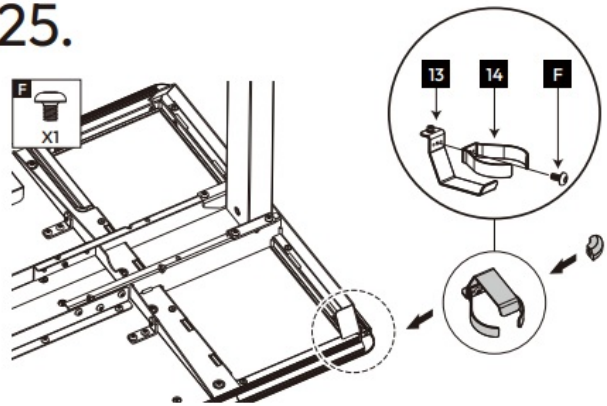

26.

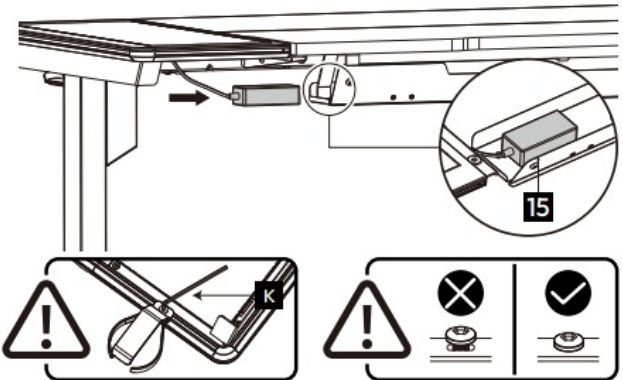

28.

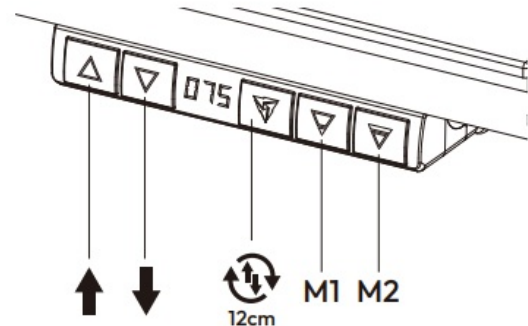

29.

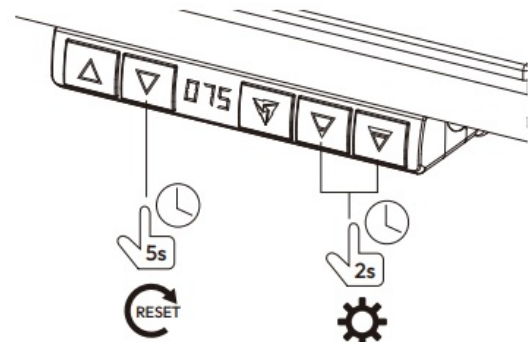

Step 4: Completing the Desk

Proceed to attach components X8, X10, and X12 to complete the desk structure.

Product Usage Instructions

- **Intended Use:** The desk is intended for adult gamers. Not suitable for children under 8 years old.
- **Maximum Weight:** Follow weight guidelines provided in the manual for safe use.

Cleaning Instructions

- Avoid using harsh cleaning chemicals such as acetone
- Avoid direct sunlight

Intended Use and User

- Not suitable for children under 8
- Maximum weight <80 kg/176 lbs.

Maintenance and Repair

- After approx. 1 week of use, check that the screws are properly tightened.
- Do not attempt to repair this product yourself.

Recommended Height: 160cm-200cm (5'3"-6'6")
Maximum Weight: <80 kg/176 lbs.
Temperature Interval at Usage: +50 up to +104 °F/+10 °C up to + 40 °C.
Temperature Interval at Storage: 0 up to 158 °F/-18 °C up to 70 °C.
Humidity: 20% up to 80% at 104 °F/40 °C.

Disposal and Recycling

The LAB-X should be disposed of separately from household waste. The LAB-X should be handed in for recycling in accordance with local environmental regulations for waste disposal. By separating the LAB-X from household waste, you will help reduce the

volume of waste sent to incinerators or landfills and minimize any potential negative impact on human health and the environment.

Warranty

Please prepare the following information before contacting the point of purchase or the local agent.

1. Invoice/receipt.
2. Photo of serial number starting with SN (can be found underneath the product).
3. Photos or videos of the product illustrating the problem/issue.
4. Photo of the complete product.

FAQs

Q: Can this desk support multiple monitors?

A: Yes, the desk is designed to support multiple monitors. Ensure you distribute the weight evenly.

Q: How do I adjust the motorized features of the desk?

A: Refer to the user manual for instructions on adjusting the motorized features of the desk.

Documents / Resources

	<p>THUNDER X3 LAB-X Motor Gaming Desk [pdf] User Manual</p> <p>170x75cm, LAB-X Motor Gaming Desk, LAB-X, Motor Gaming Desk, Gaming Desk, Desk</p>
---	---

References

- [Tech Support - ThunderX3 | Got Your Back](#)
- [User Manual](#)

Related Posts



[THUNDER X3 Essential Series Ergonomic Gaming Chair Instruction Manual](#)

THUNDER X3 Essential Series Ergonomic Gaming Chair
Instruction Manual Assembly Instruction Cleaning

Instruction: Keep chair tidy by vacuuming...



[Trust Dominus Gaming Desk Instruction Manual](#)

Trust Dominus Gaming Desk Instructions Frequently Asked Questions www.trust.com/22523/faq 02018 Trust International B.V. - All rights reserved |...



[motpk MKB0101308 Shaped Gaming Desk User Manual](#)

MKB0101308 Shaped Gaming Desk

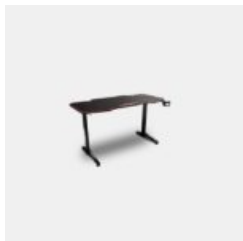

[DRIFT DZ200 Expert Gaming Desk Installation Guide](#)

DRIFT DZ200 Expert Gaming Desk Installation Guide
PRRTSLIST Read More About This Manual & Download PDF:

THUNDER
X3

170x75cm, Desk, Gaming Desk, LAB-X, LAB-X Motor Gaming Desk, Motor Gaming Desk, THUNDER
X3

—Previous Post

[THUNDER X3 FLEX Pro Ergonomic Office Chair Instruction Manual](#)

Leave a comment

Your email address will not be published. Required fields are marked *

Comment *

Name

Email

Website

☐ Save my name, email, and website in this browser for the next time I comment.

Post Comment

Manuals+, Privacy Policy | @manuals.plus | YouTube

This website is an independent publication and is neither affiliated with nor endorsed by any of the trademark owners. The "Bluetooth®" word mark and logos are registered trademarks owned by Bluetooth SIG, Inc. The "Wi-Fi®" word mark and logos are registered trademarks owned by the Wi-Fi Alliance. Any use of these marks on this website does not imply any affiliation with or endorsement.