

**THULE**  
5563165001 Yepp  
Front Adapter



## THULE 5563165001 Yepp Front Adapter Instructions

[Home](#) » [THULE](#) » THULE 5563165001 Yepp Front Adapter Instructions 

### Contents

- [1 THULE 5563165001 Yepp Front Adapter](#)
- [2 BOX CONTENT](#)
- [3 DIMENSION](#)
- [4 Installation](#)
- [5 FAQs](#)
- [6 Documents / Resources](#)
  - [6.1 References](#)

**THULE**  
SWEDEN

THULE 5563165001 Yepp Front Adapter



### Specifications

- **Model:** Thule Yepp front adapter
- **Part Number:** 12080403
- **Min Thickness:** 21 mm / 0.83 inch

### Usage:

1. Ensure the adapter is securely attached to the designated area on your bike.
2. Place the Thule Yepp Mini Windscreen (part number 12020906) onto the adapter.
3. Adjust the windscreen as needed to provide protection from wind and debris while riding.

### BOX CONTENT

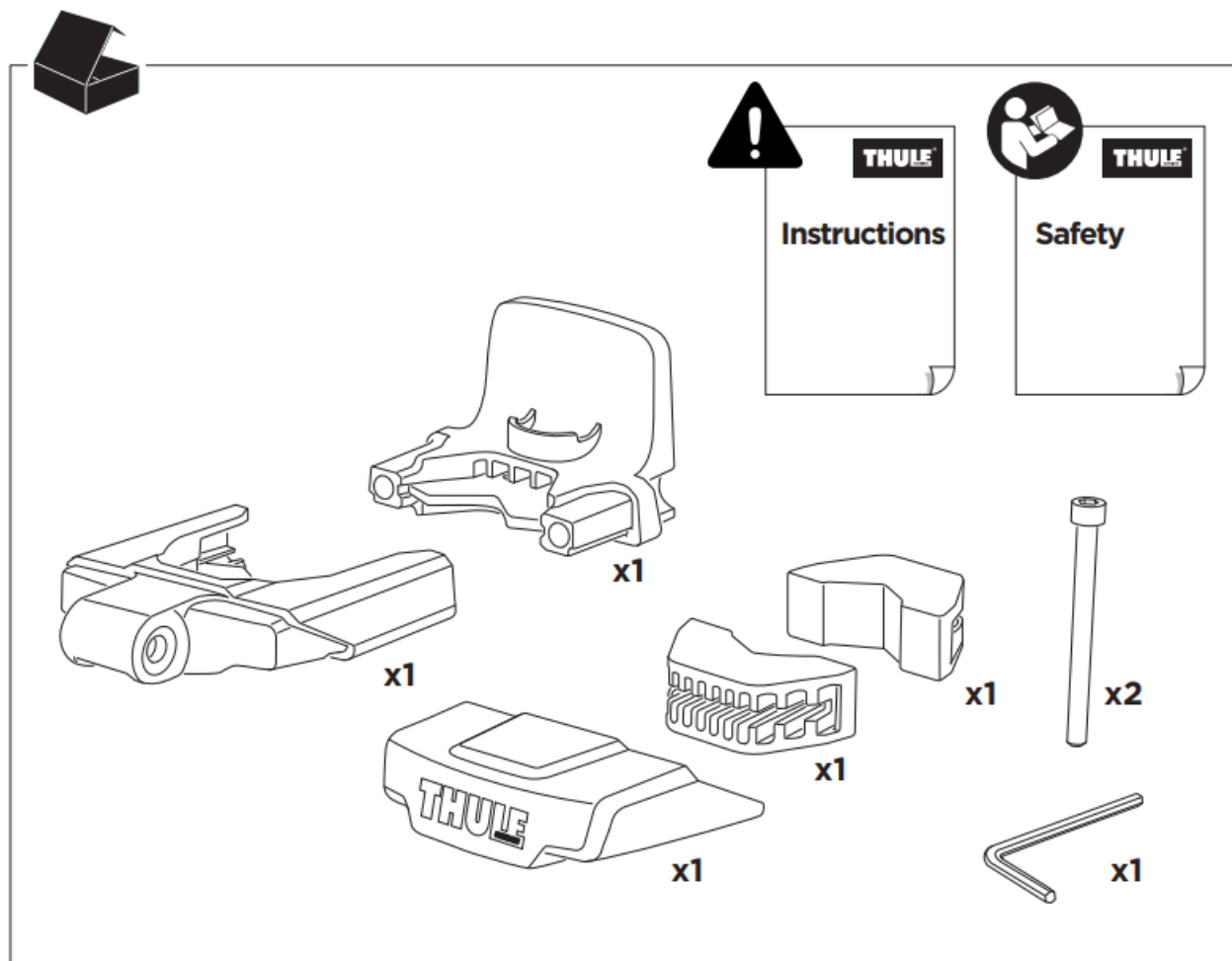

## WARNING

**IMPORTANT** – READ CAREFULLY AND KEEP FOR FUTURE REFERENCE. YOUR CHILD’S SAFETY MAY BE AFFECTED IF YOU DO NOT FOLLOW THESE INSTRUCTIONS. FAILURE TO COMPLY WITH THE MANUFACTURER’S INSTRUCTIONS CAN LEAD TO SERIOUS INJURY OR DEATH OF THE PASSENGER/RIDER!

- Never leave the child unattended in the seat.
- Always use the restraint system.
- Do not modify the product in any way.
- Do not use the seat if any part is broken.
- If in doubt, contact your local dealer or Customer Support.
- Check that all parts of the bicycle function correctly with the seat mounted.
- Ensure that all the locking devices are engaged before use.
- The movability of the handle bar could be reduced by the seat.
- For optimum comfort and safety, make sure that the seat does not slope forwards, risking the child to slide out of it. The backrest of the seat should slope backwards slightly.
- Do not use cleaning solvents. Clean only with mild soap and water.

## DIMENSION



Min:  
21 mm  
0.83" inch

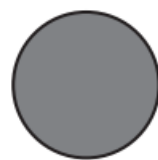
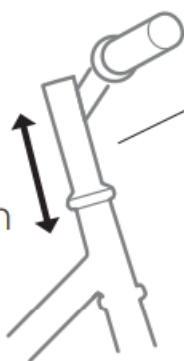

Ø 20-28,6 mm  
Ø 0.87-1.125" inch

## Installation

1. Identify parts A, B, C, D, E as per the manual.
2. Attach part A to part B using provided screws, ensuring a secure connection.
3. Attach part C to part B, aligning them correctly.
4. Secure part D and E using a torque wrench to the specified torque levels (6 Nm).

### Alt 1

 p. 16-18

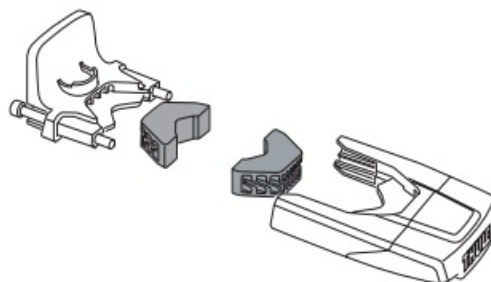
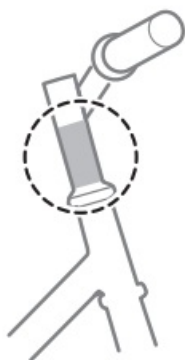

### Alt 2

 p. 19-23

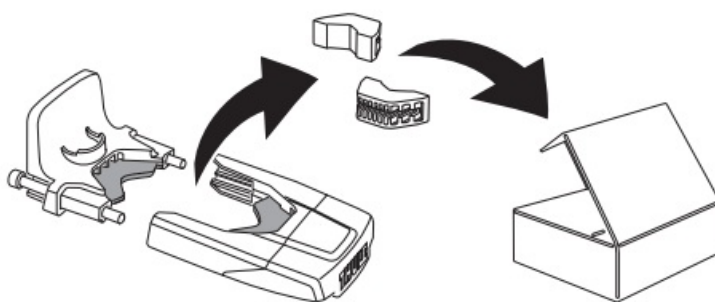

Alt 1

## Alt 1

 p. 16-18

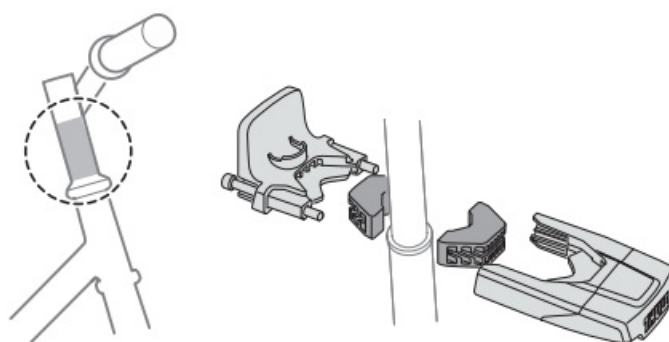

**1**

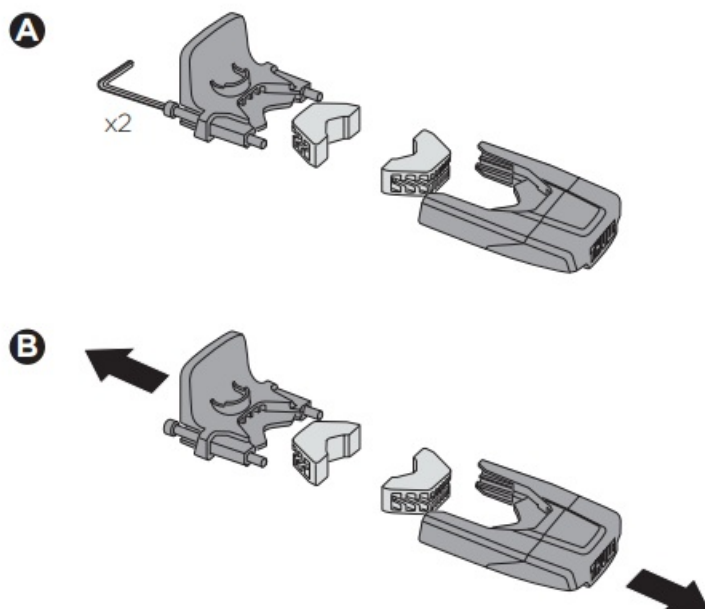

2

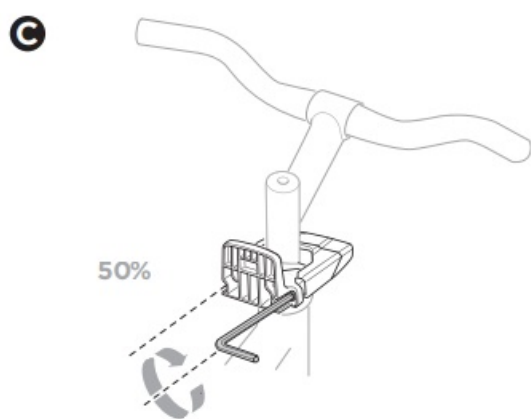
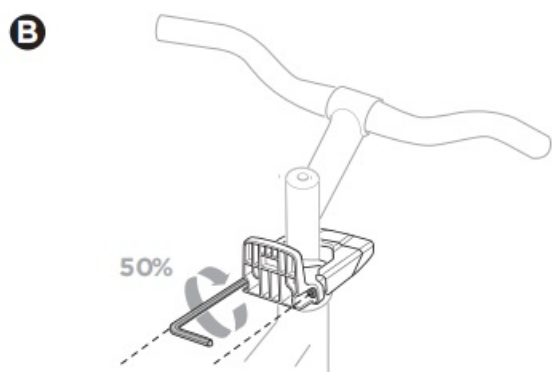
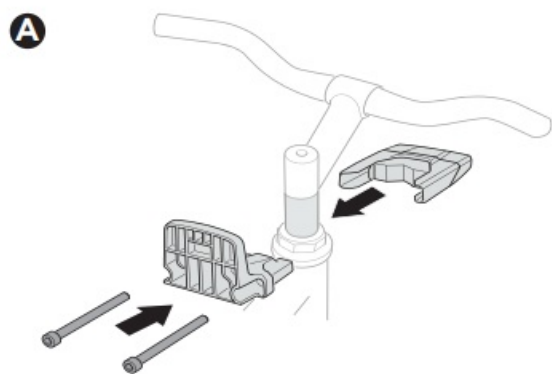

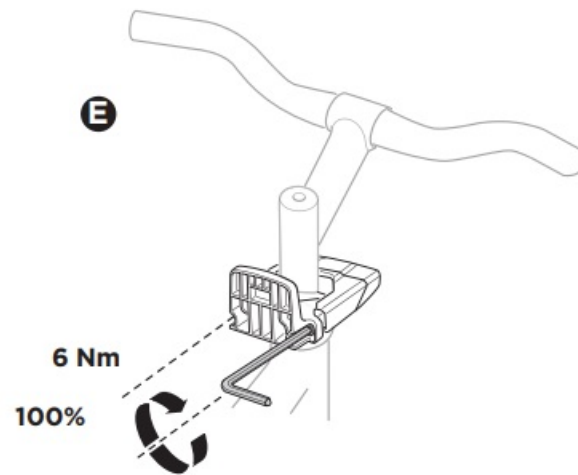
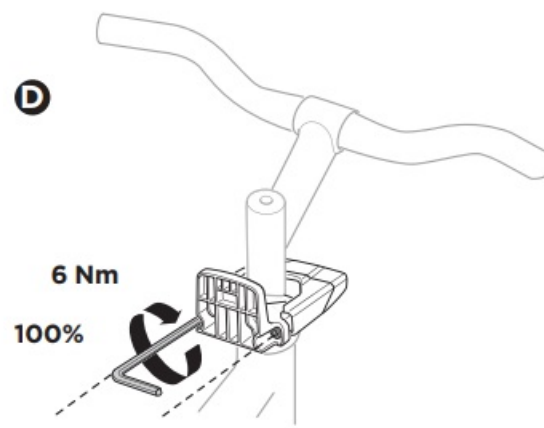

Alt 2

## Alt 2

 p. 19-23

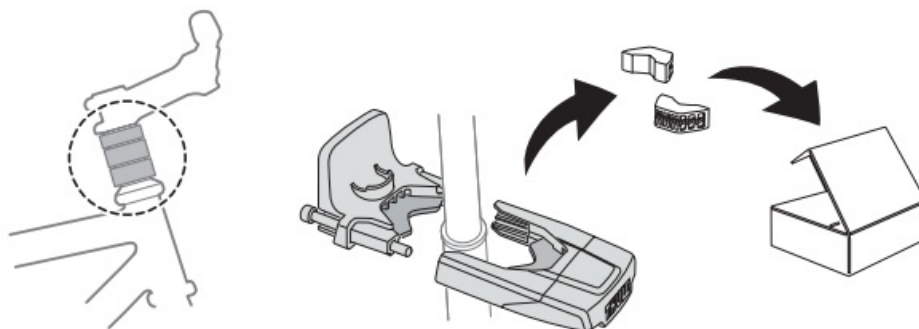

1

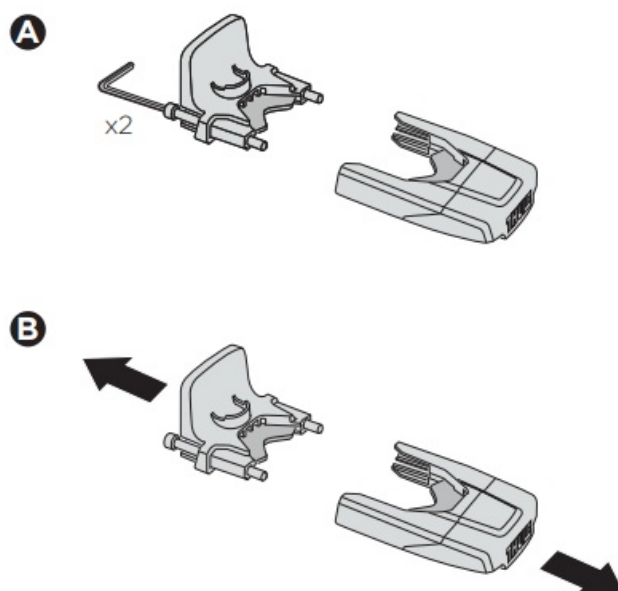

2

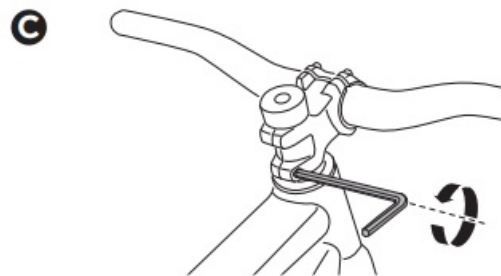
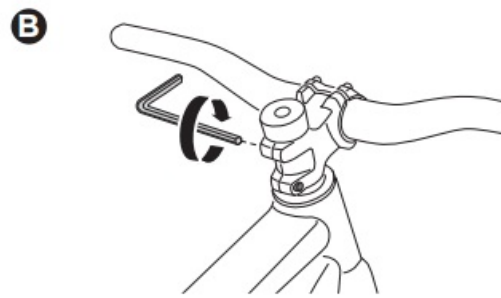
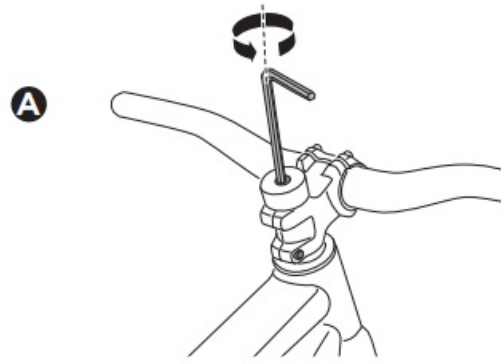

3

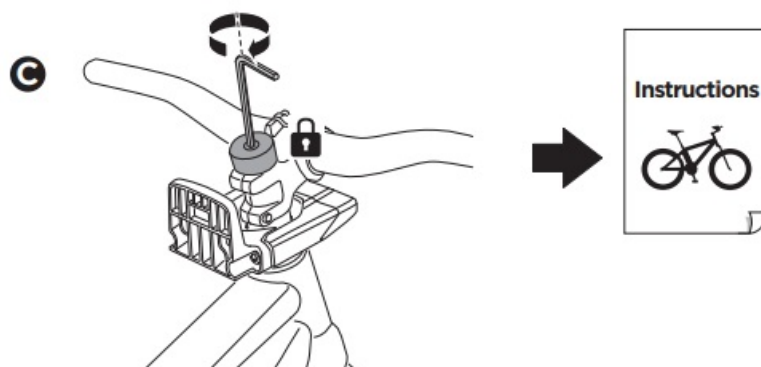
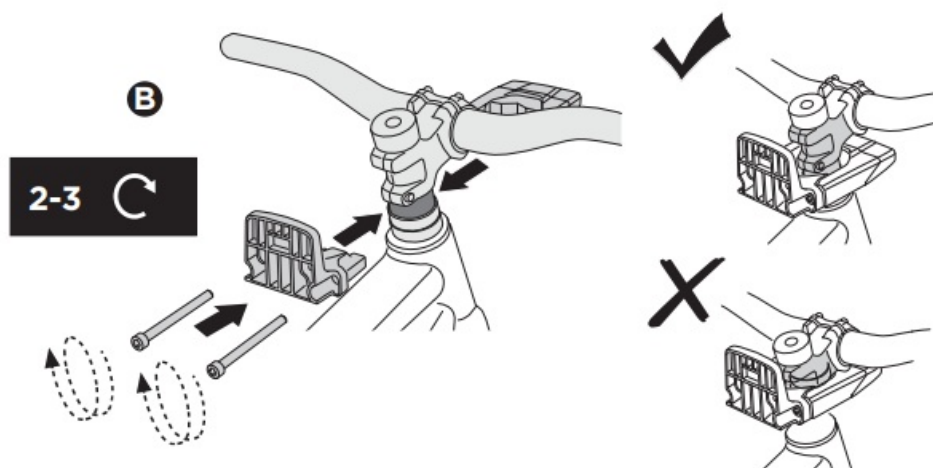
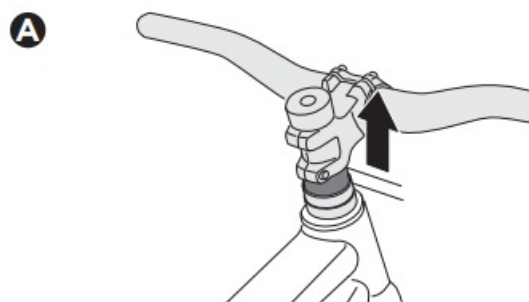

4

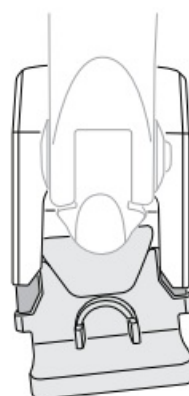
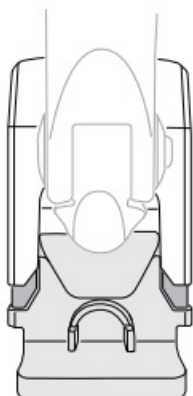
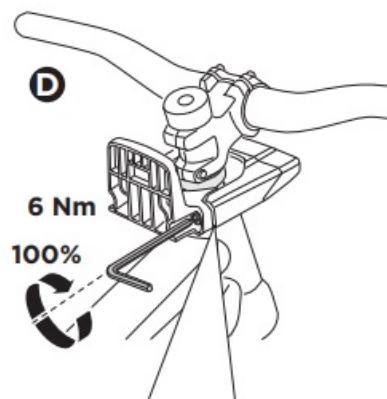
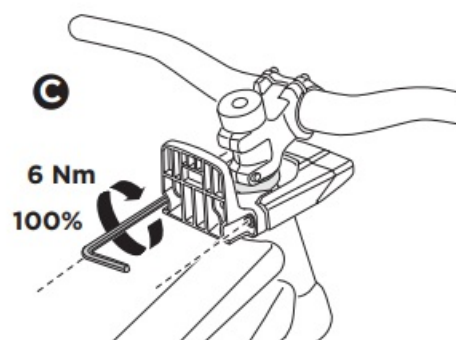
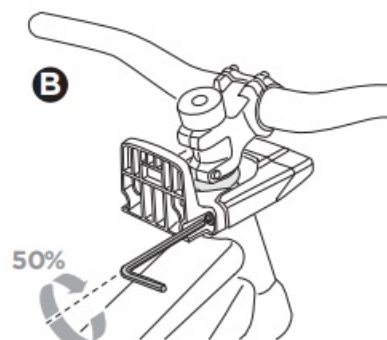
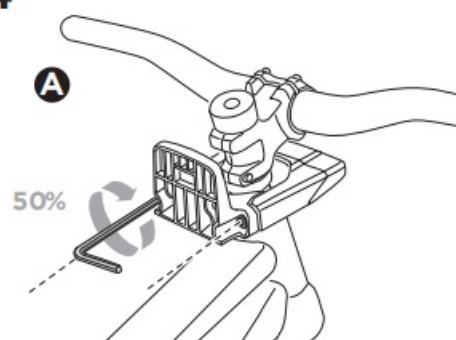

5

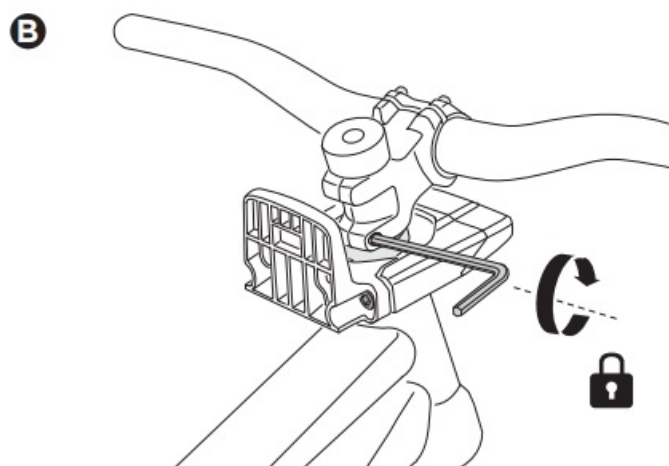
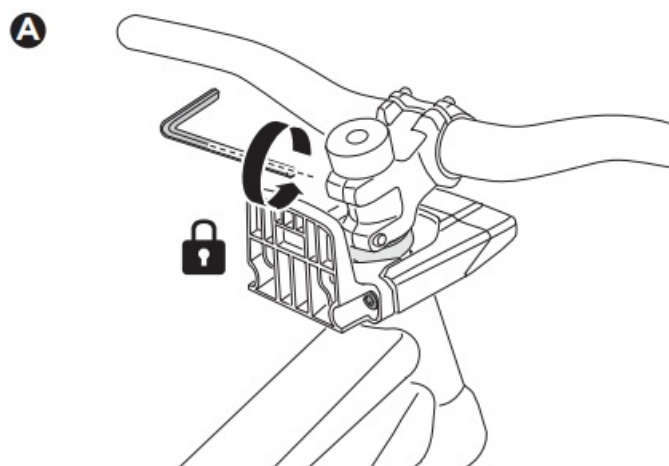

6

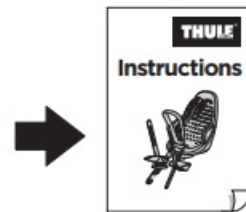
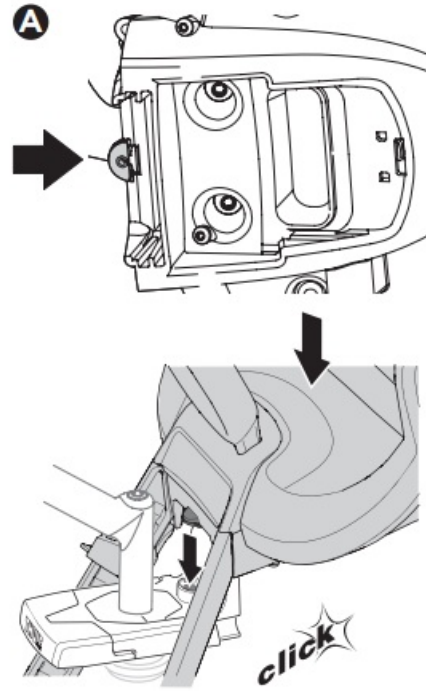
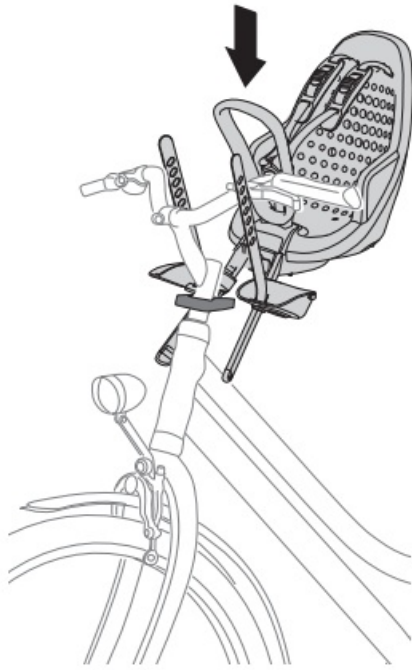

7

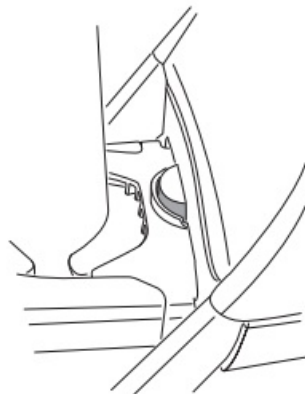
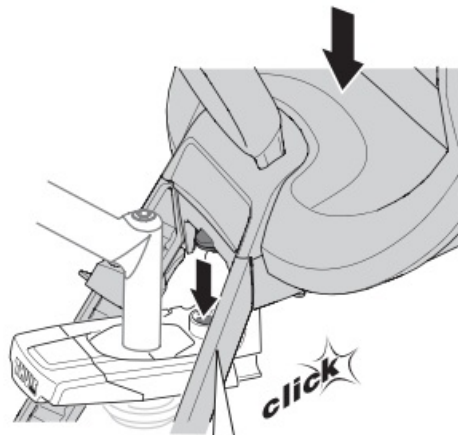

Thule Yepp Mini Windscreen  
12020906

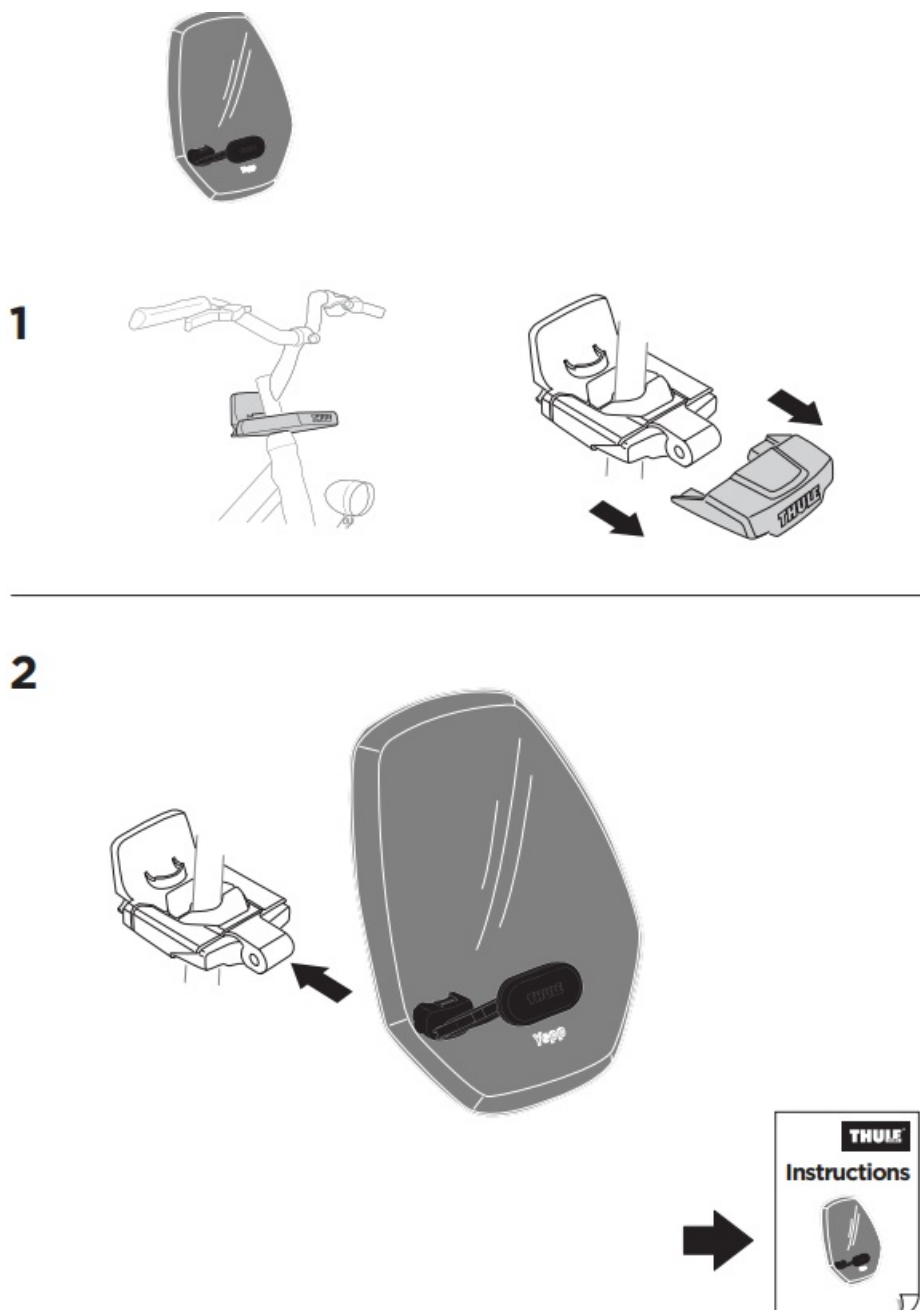

- Thule Sweden AB Borggatan 5 335 73 Hillerstorp, Sweden
- [info@thule.com](mailto:info@thule.com)
- [www.thule.com](http://www.thule.com)

© Thule Group Oct. 2024. All rights reserved.

## FAQs

### **Q: How do I know if the adapter is installed correctly?**

A: The adapter should be securely attached to the bike frame with all parts tightened to the specified torque levels.

### **Q: Can I use the Thule Yepp front adapter with other bike accessories?**

A: The adapter is designed specifically for use with the Thule Yepp Mini Windscreen and may not be compatible with other accessories.

### **Q: How do I clean the Thule Yepp Mini Windscreen?**

A: Use a mild soap and water solution with a soft cloth to gently clean the windscreen. Avoid abrasive cleaners

that may scratch the surface.

## Documents / Resources

	<p><a href="#">THULE 5563165001 Yepp Front Adapter</a> [pdf] Instructions 12080403, 5563165001, 5563165001 Yepp Front Adapter, 5563165001, Yepp Front Adapter, Front Adapter</p>
---	--

## References

- [User Manual](#)

[Manuals+.](#) [Privacy Policy](#)

This website is an independent publication and is neither affiliated with nor endorsed by any of the trademark owners. The "Bluetooth®" word mark and logos are registered trademarks owned by Bluetooth SIG, Inc. The "Wi-Fi®" word mark and logos are registered trademarks owned by the Wi-Fi Alliance. Any use of these marks on this website does not imply any affiliation with or endorsement.