

THORN
ILF AFP2
Large
Spaces
LED
Projector



THORN ILF AFP2 Large Spaces LED Projector Installation Guide

[Home](#) » [THORN](#) » THORN ILF AFP2 Large Spaces LED Projector Installation Guide 

Contents

- [1 THORN ILF AFP2 Large Spaces LED Projector](#)
- [2 Specifications](#)
- [3 Product Usage Instructions](#)
- [4 FAQs](#)
- [5 ACCESSORIES](#)
- [6 ASSEMBLING INSTRUCTION](#)
- [7 Documents / Resources](#)
 - [7.1 References](#)

THORN

THORN ILF AFP2 Large Spaces LED Projector



Specifications

Accessory Type	Frame
Compatible with	AREAFLOOD PRO2 Accessories
Available Sizes	Small, Medium, Large
Weight	See individual accessory specifications below

Product Usage Instructions

• Installation

- Ensure the power source is switched off before installing the frame accessory.
- Refer to the provided installation instructions in LV, PL, SE, and RU languages for step-by-step guidance.
- Choose the appropriate size of the frame accessory based on your requirements (S, M, L).
- Securely attach the frame to the corresponding AREAFLOOD PRO2 luminaire.

• Safety Instructions

- Replace any cracked protective shield immediately.
- For Class II luminaires, ensure no exposed metal contacts or electrical installations.
- Class I luminaires must be properly earthed for safety.
- Always switch off the mains voltage before working on the luminaire.
- Do not make any modifications to the luminaire as it may void warranty and safety certifications.

• Maintenance

- Regularly check the frame accessory for any damage or wear and tear. Clean as necessary to maintain optimal performance.

FAQs

• Can the frame accessory be used with any other type of luminaire?

- The frame accessory is specifically designed to be compatible with AREAFLOOD PRO2 luminaires and may not be suitable for use with other types of luminaires.

• How do I determine the correct size of the frame accessory to use?

- Refer to the dimensions provided in the manual to select the appropriate size (Small, Medium, Large) based on your luminaire's specifications.

• What should I do if I encounter a problem during installation?

- If you face any difficulties during installation, refer to the installation instructions in different languages provided in the manual or contact customer support for assistance.

ACCESSORIES

TYPE: AREAFLOOD PRO2 ACCESSORIES

PROTECTION GRID

S 96636420 / M 96636421
/ L 96636423

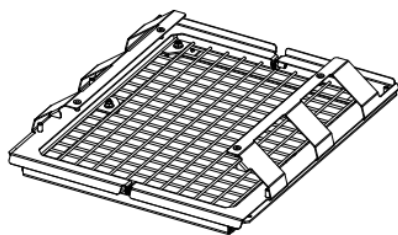

LOUVER

S 96636424 / M 96636425
/ L 96636426

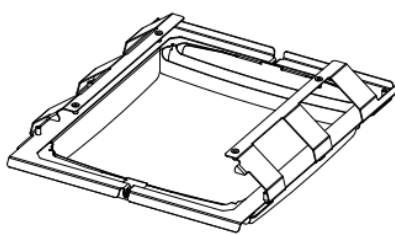

BIRD DETERRENT

S 96636416 / M 96636417
/ L 96636422

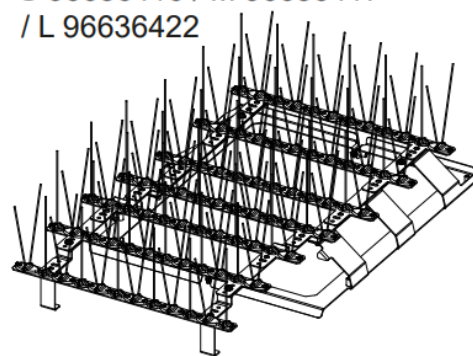

BIRD DETERRENT

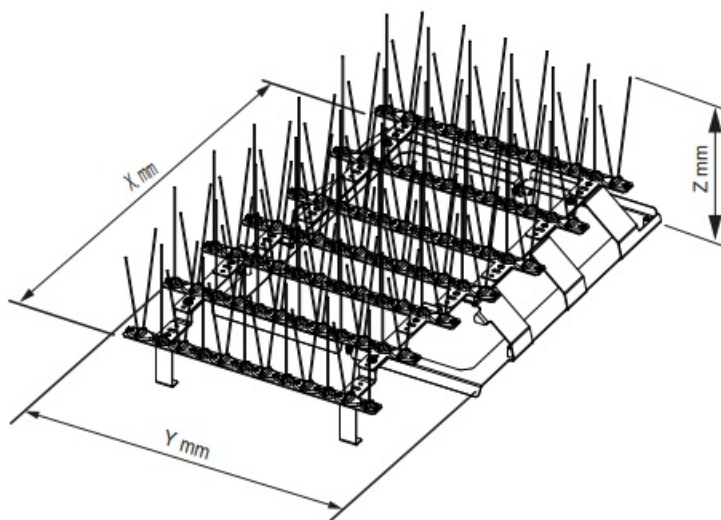

Small	X :	315 mm
	Y :	465 mm
	Z :	180 mm
Medium	X :	315 mm
	Y :	610 mm
	Z :	180 mm
Large	X :	315 mm
	Y :	761 mm
	Z :	180 mm

	Small	1.4 kg
	Medium	1.9 kg
	Large	2.1 kg

PROTECTION GRID

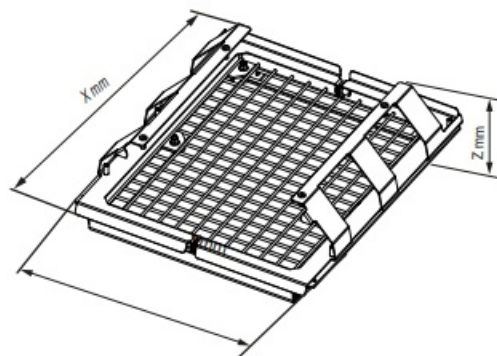

Small	X :	243 mm
	Y :	344 mm
	Z :	67 mm
Medium	X :	393 mm
	Y :	344 mm
	Z :	67 mm
Large	X :	543 mm
	Y :	344 mm
	Z :	67 mm

	Small	1.2 kg
	Medium	1.7 kg
	Large	2.17 kg

LOUVER

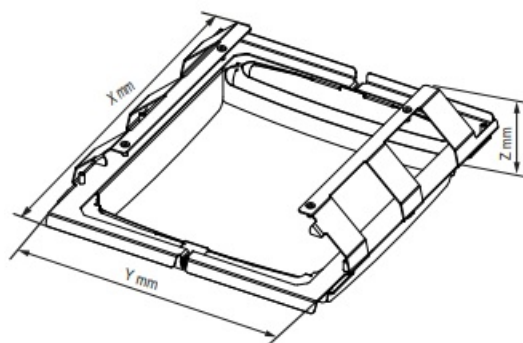

Small	X :	243 mm
	Y :	344 mm
	Z :	67 mm
Medium	X :	393 mm
	Y :	344 mm
	Z :	67 mm
Large	X :	543 mm
	Y :	344 mm
	Z :	67 mm

	Small	1.2 kg
	Medium	1.4 kg
	Large	1.7 kg

ASSEMBLING INSTRUCTION

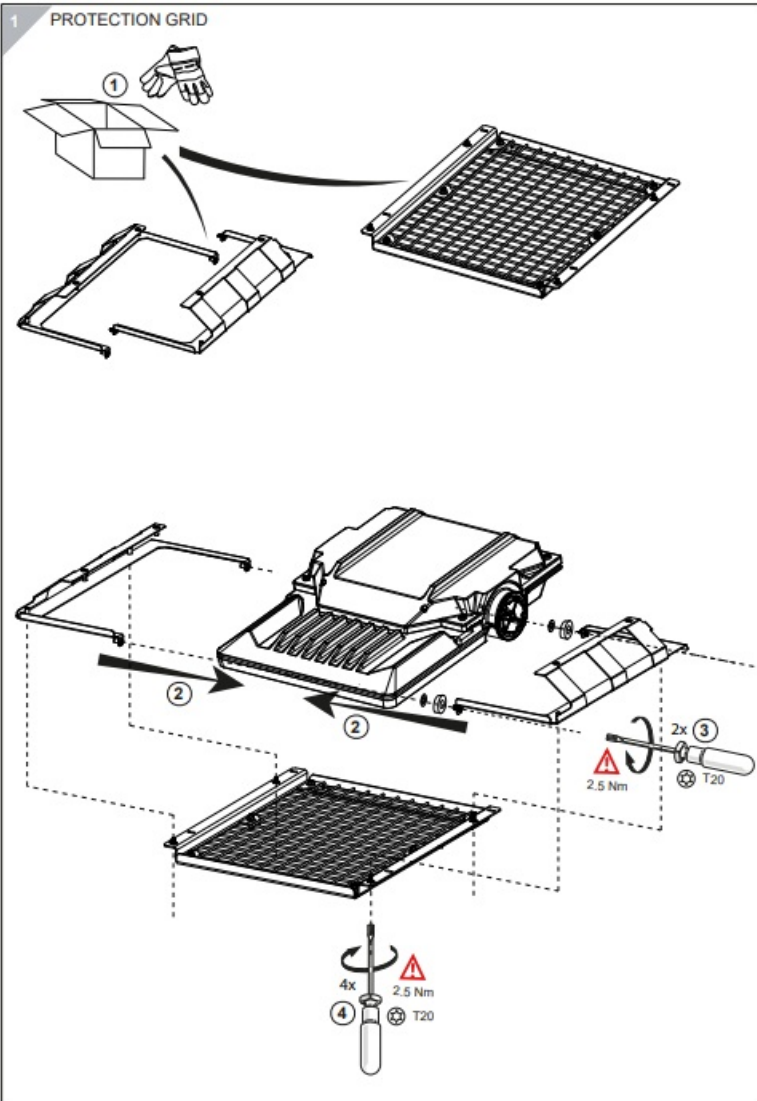

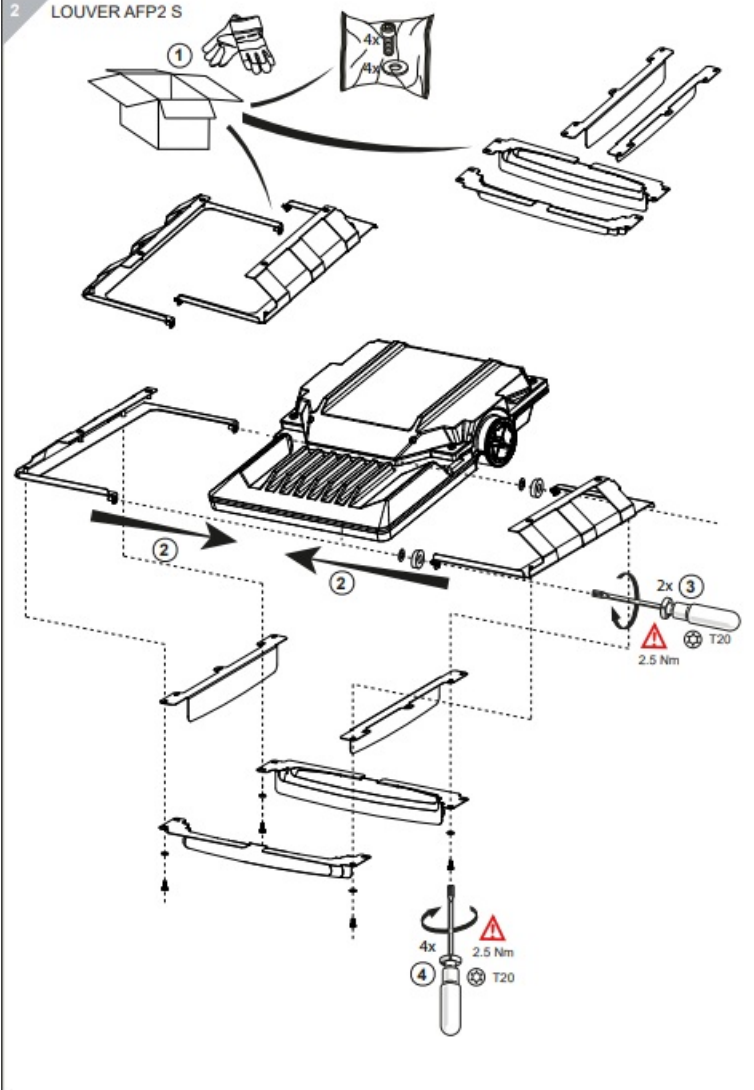

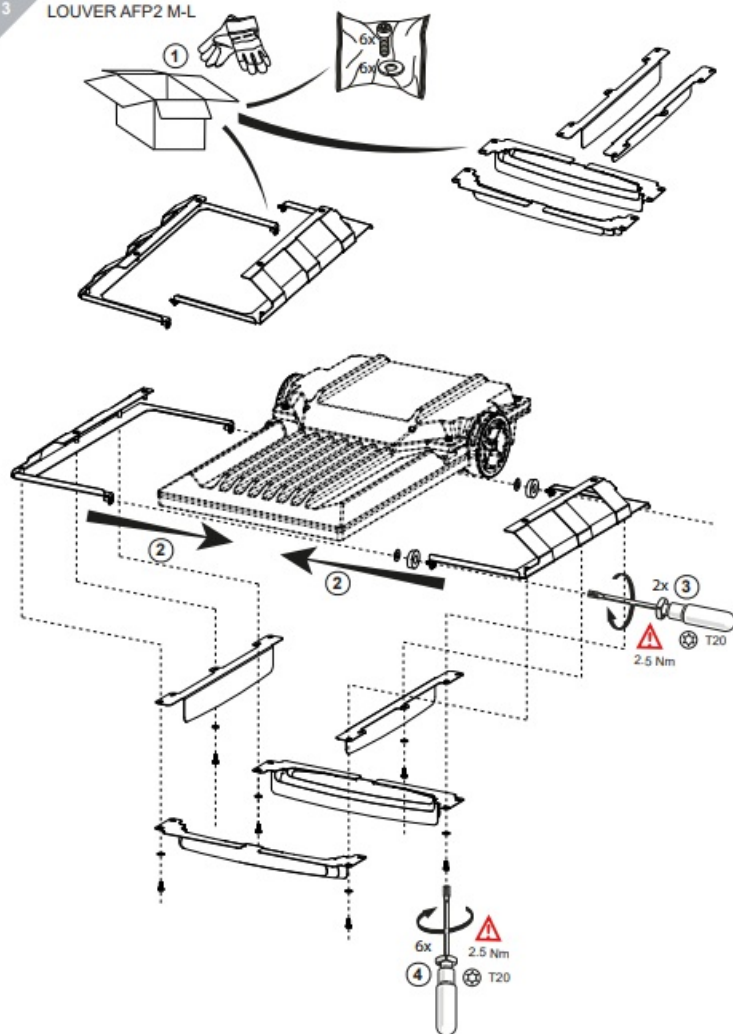

4 BIRD DETERRENT AFP2 S

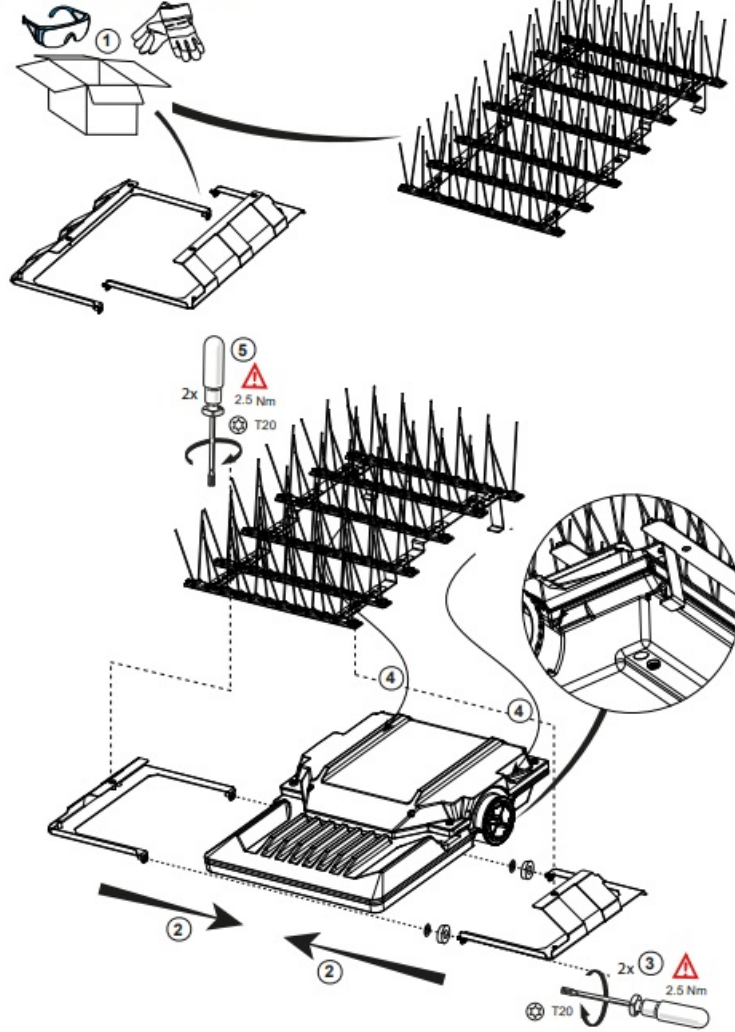

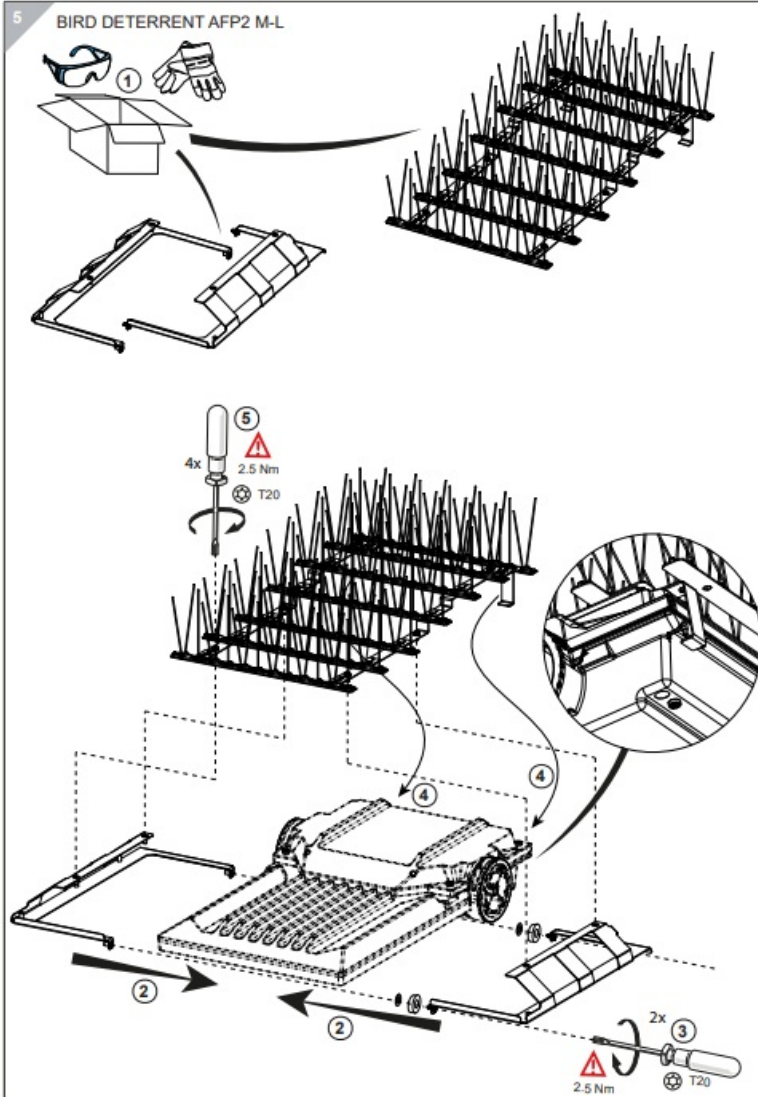

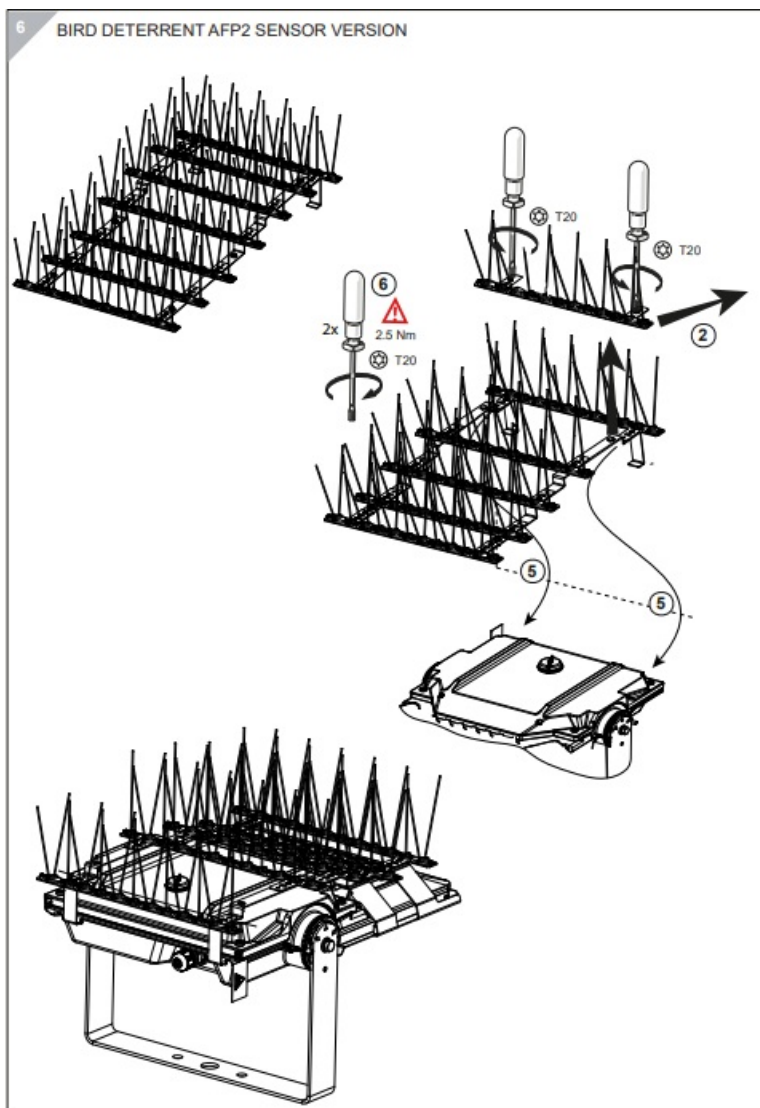

- Replace any cracked protective shield.
- Class II luminaires must be installed so that the exposed metal work of the luminaire is not in contact with any part of the electrical installation connected to a protective conductor.
- **WARNING:** Class I luminaires must be earthed.
- This luminaire operates at mains voltage which must be switched off before intervention in control gear.
- Any modification to this luminaire is forbidden.
- Lighted objects nearer than the minimal distance in the is forbidden.



Horn Lighting is constantly developing and improving its products. The right is reserved to change specifications without prior notification or public announcement © Thorn Lighting

Documents / Resources

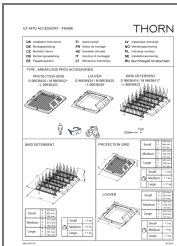

[THORN ILF AFP2 Large Spaces LED Projector](#) [pdf] Installation Guide
ILF AFP2, ILF AFP2 Large Spaces LED Projector, Large Spaces LED Projector, Spaces LED Projector, LED Projector, Projector

References

- [User Manual](#)

[Manuals+](#), [Privacy Policy](#)

This website is an independent publication and is neither affiliated with nor endorsed by any of the trademark owners. The "Bluetooth®" word mark and logos are registered trademarks owned by Bluetooth SIG, Inc. The "Wi-Fi®" word mark and logos are registered trademarks owned by the Wi-Fi Alliance. Any use of these marks on this website does not imply any affiliation with or endorsement.