



THORN EQL C PM-PRO Variable Colour Temperature Instruction Manual

[Home](#) » [THORN](#) » THORN EQL C PM-PRO Variable Colour Temperature Instruction Manual 

THORN

EQL C PM-PRO Variable Colour Temperature
Instruction Manual



Equine LED



www.thornlighting.com/EQUA



Mounting instructions

Important notices. Please, read first! Keep the instructions safe! Specifications are subject to change without notice! If you have questions, please contact the manufacturer.

SL single luminaire

WH 96632059
SR 96632061

LB continuous row

96632071
WH 96632065
SR 96632067
22169873 5x

MOUNTING OPTIONS

I

C	D	✓	C	D	✓	VCT	HO

A SURFACE

IP40

22169175

B PENDANT

IP40

22169303

C RECESSED

IP40

22169303

D WALL

IP40

22169965

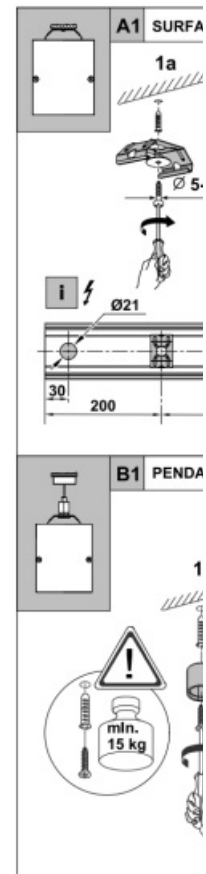
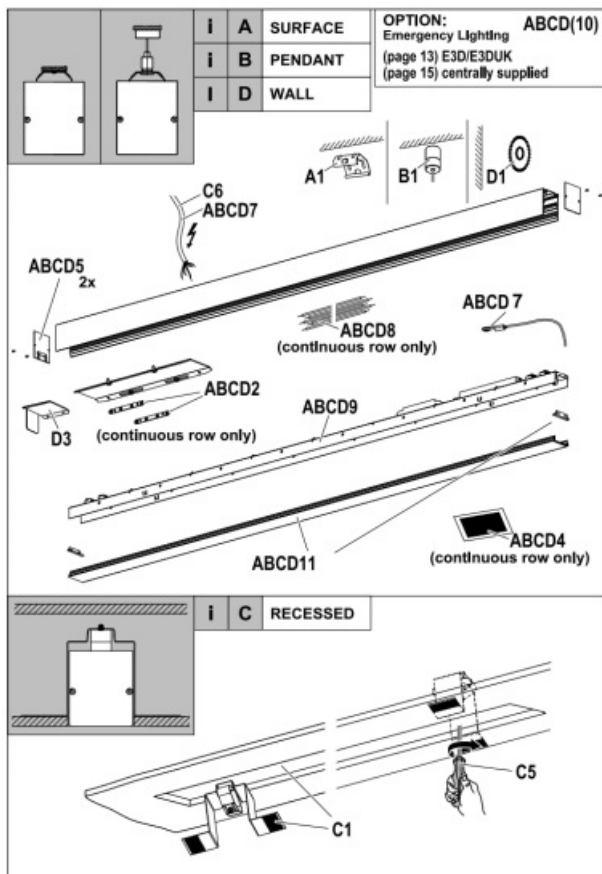

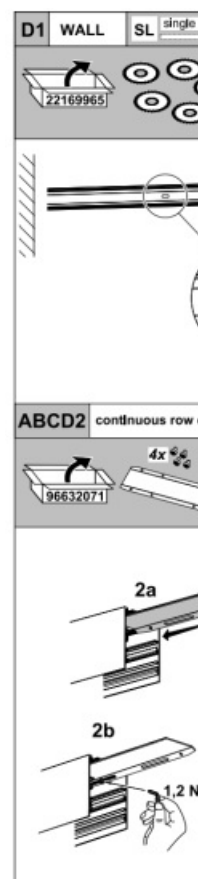
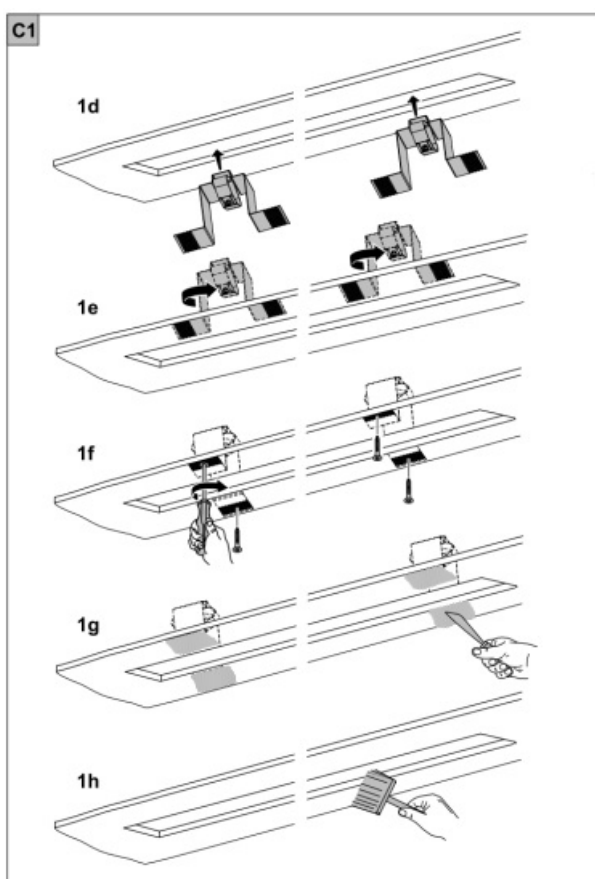
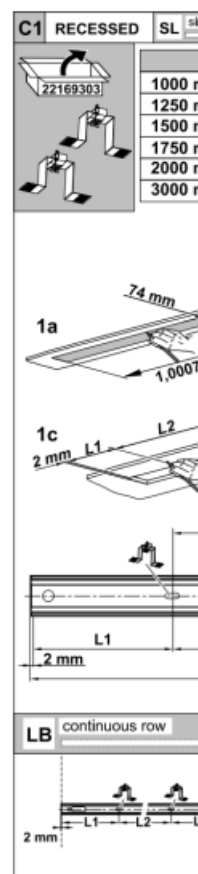
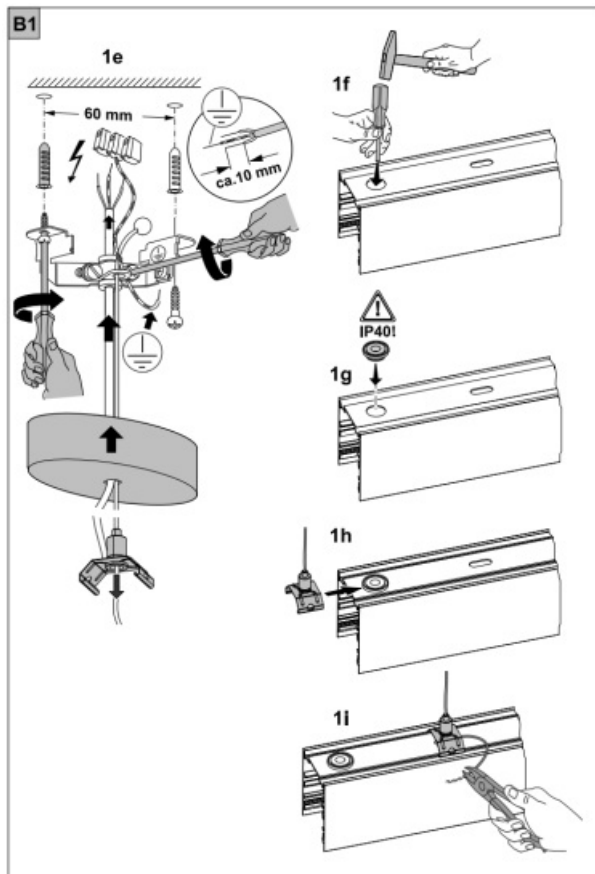

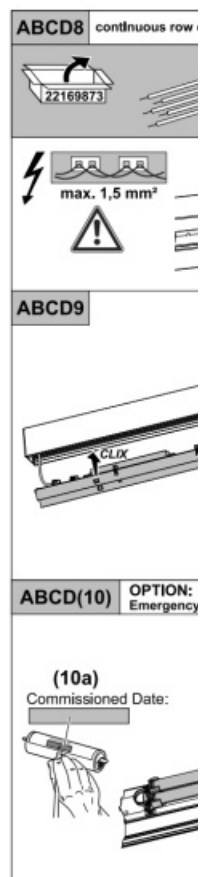
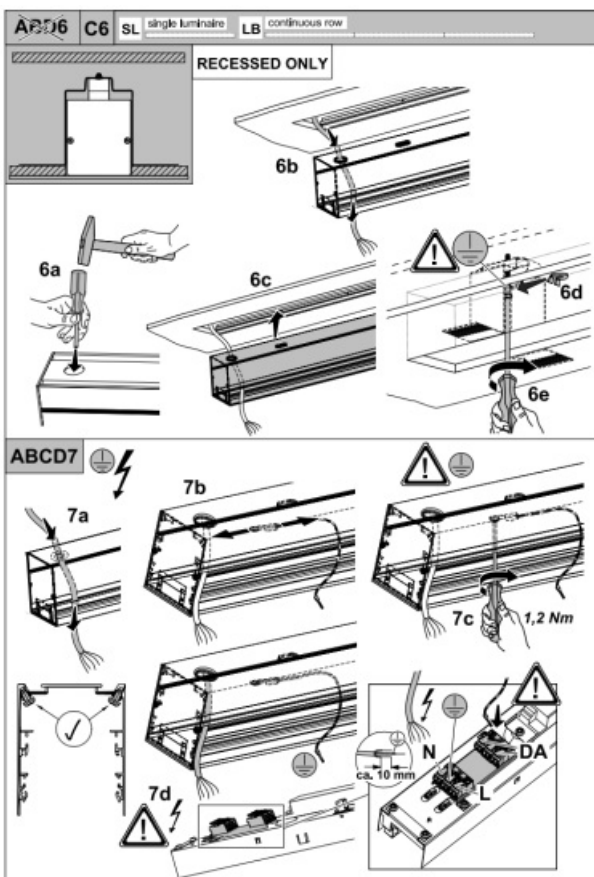
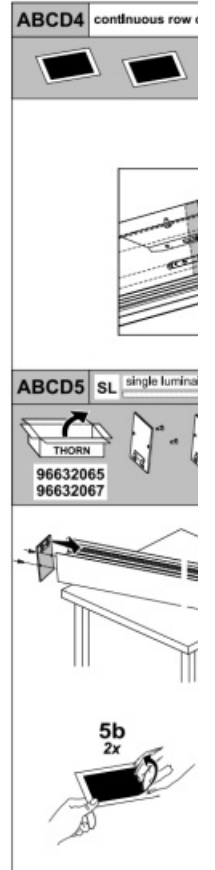
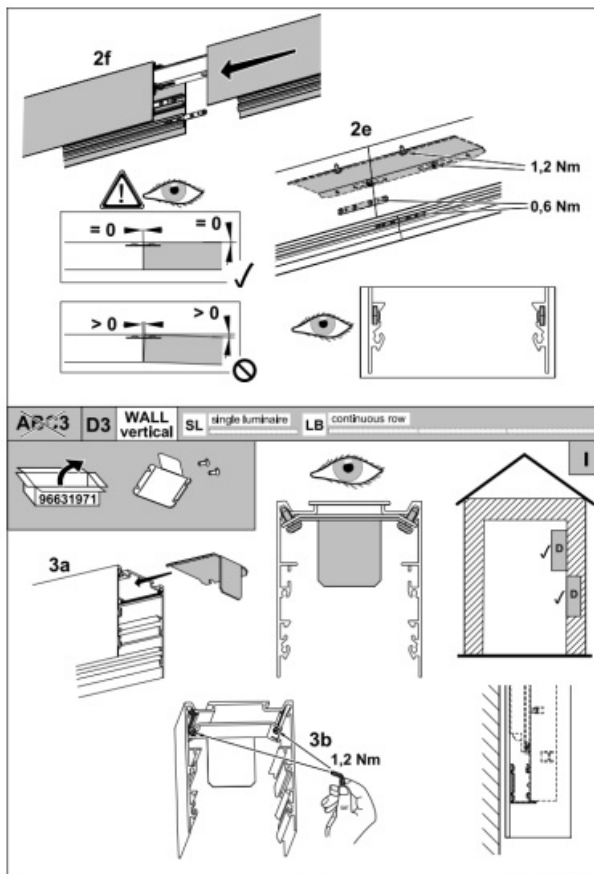

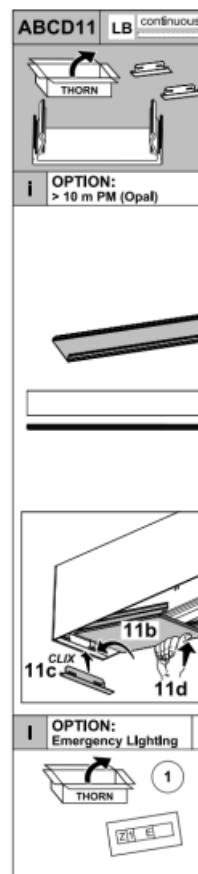
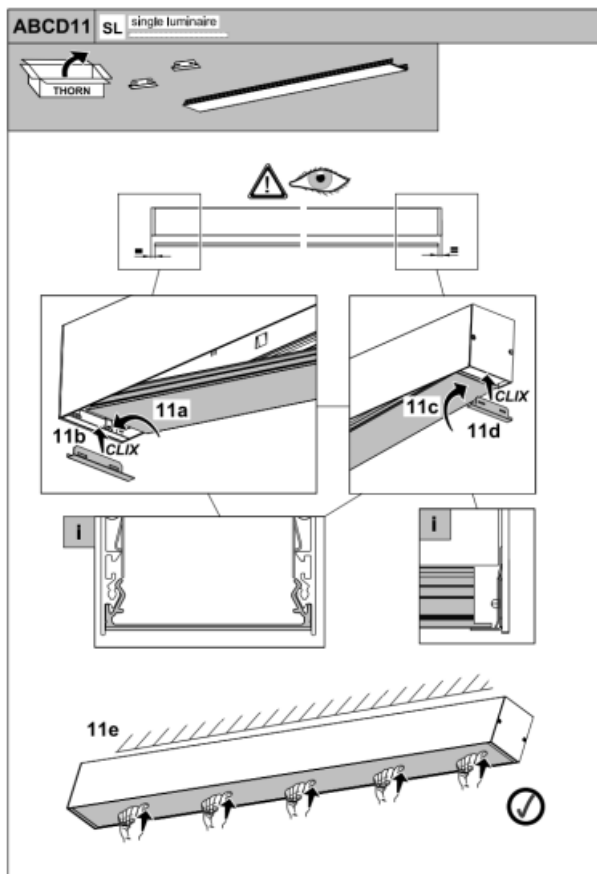

Instructions for installation and operation!

The installation and commissioning of the luminaire as well as any modification to the luminaire may only be performed by authorized personnel (qualified electricians). National installation regulations must be observed. Before any work on the appliance is done, it must be disconnected from the mains.

The hot plug-in is not an option and may cause damage to the lamp or luminaire!

The manufacturer is not liable for damages resulting from improper or faulty installation or operation or from unauthorized modifications to the luminaire.

The light source contained in this luminaire shall only be replaced by the manufacturer or his service agent or a similarly qualified person.



Caution, risk of electric shock!

Specifications are subject to change without notice! If you have questions, please contact the manufacturer.

Contents

[1 Documents / Resources](#)

[2 Related Posts](#)



[THORN EQL C PM-PRO Variable Colour Temperature](#) [pdf] Instruction Manual
EQL C PM-PRO Variable Colour Temperature, EQL C PM-PRO, Variable Colour Temperature