



# THORN AFP2 S-M-L Large Spaces LED Projector Installation Guide

[Home](#) » [THORN](#) » THORN AFP2 S-M-L Large Spaces LED Projector Installation Guide 

## THORN AFP2 S-M-L Large Spaces LED Projector Installation Guide



### Contents

- [1 K Installation instructions](#)
- [2 Documents / Resources](#)
  - [2.1 References](#)
- [3 Related Posts](#)

## K Installation instructions

TYPE : AFP2 S-M-L

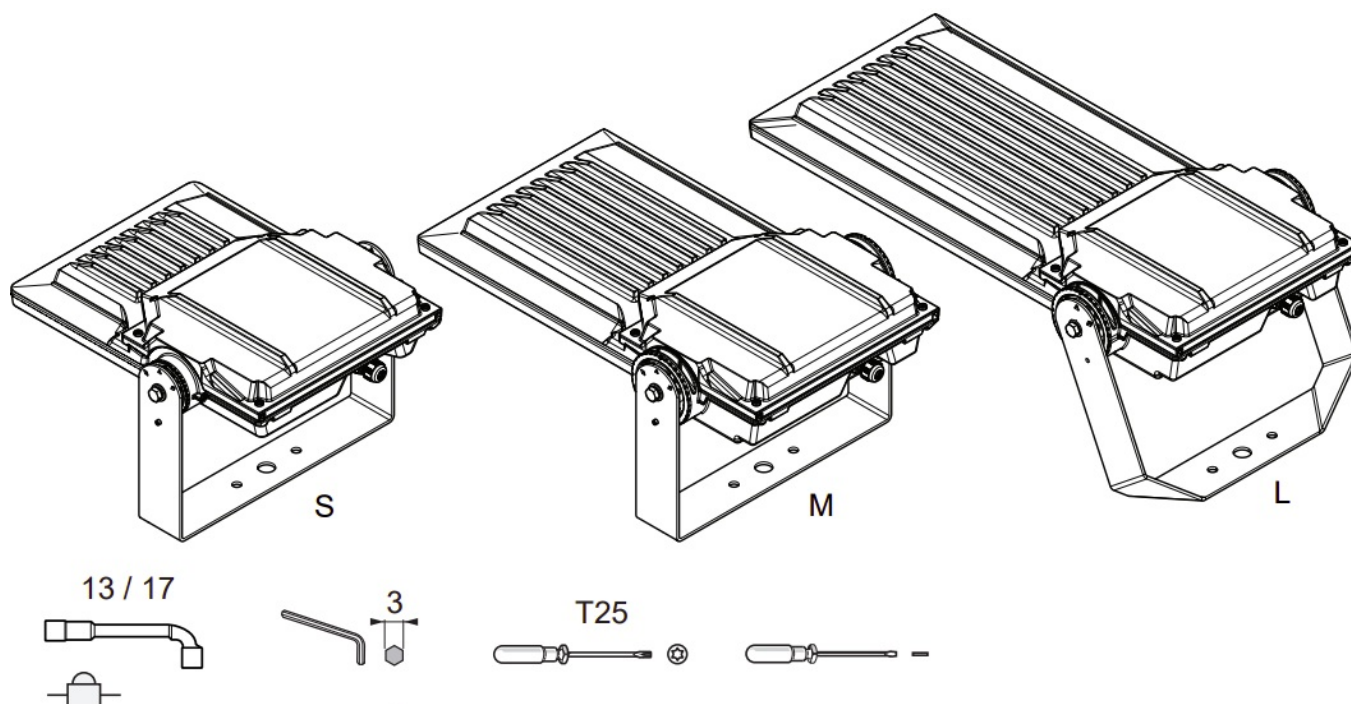

Regulations Australia / New Zealand wind speeds 250 km/h Tilting limited :



The luminaire with clear optic should be positioned so that prolonged staring into the luminaire at a distance  $< 1.5$  m is not expected

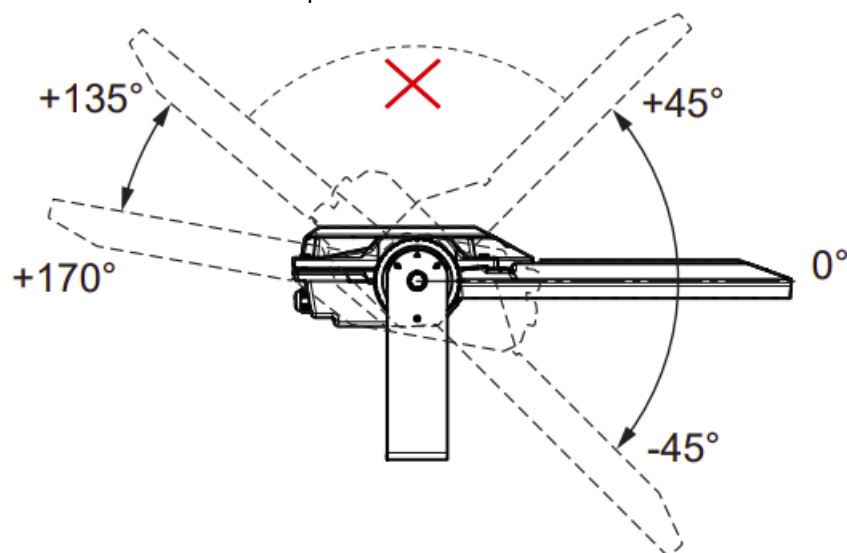

|   | AFP2                |         |          |         |     |         |                 |
|---|---------------------|---------|----------|---------|-----|---------|-----------------|
|   | QE <sup>m4</sup> -E | B<br>mm | B1<br>mm | H<br>mm | mm  | H1W(kg) | SCx<br>(at 90°) |
| S | 375                 | 285     | 145      | 62.5    | 208 | 7,6     | 0,165           |
| M | 389                 | 435     | 145      | 62.5    | 208 | 10,6    | 0,223           |
| L | 389                 | 585     | 145      | 62.5    | 232 | 14      | 0,285           |

1.

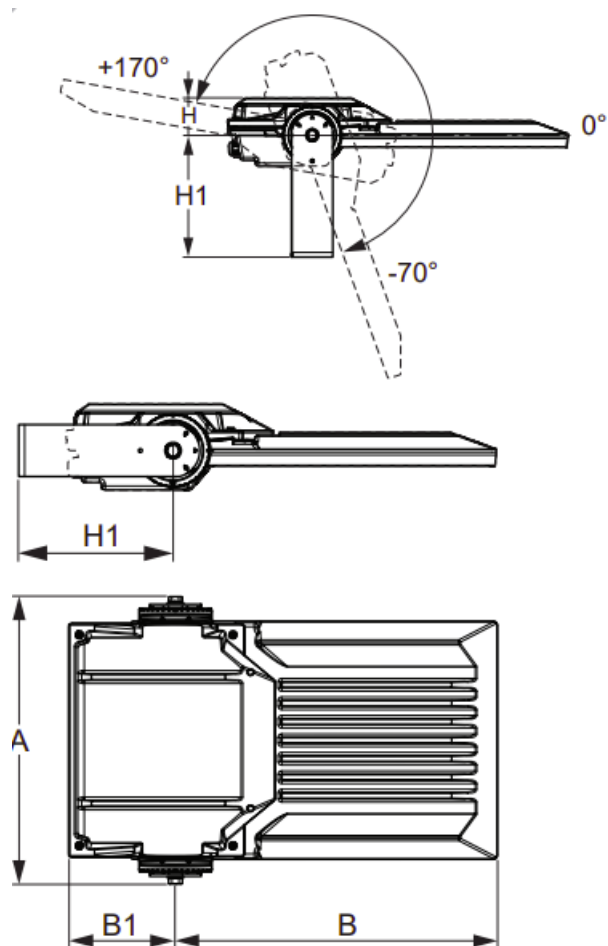

2. AFP2 S-M-L

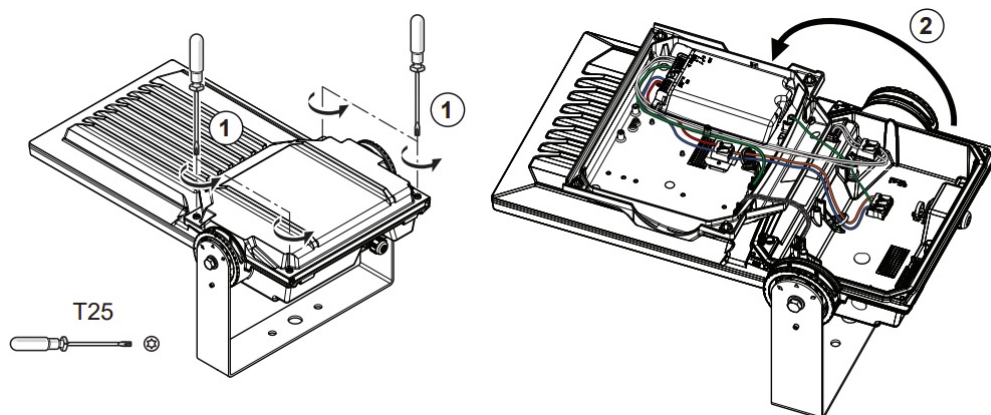

3. AFP2 S-M-L

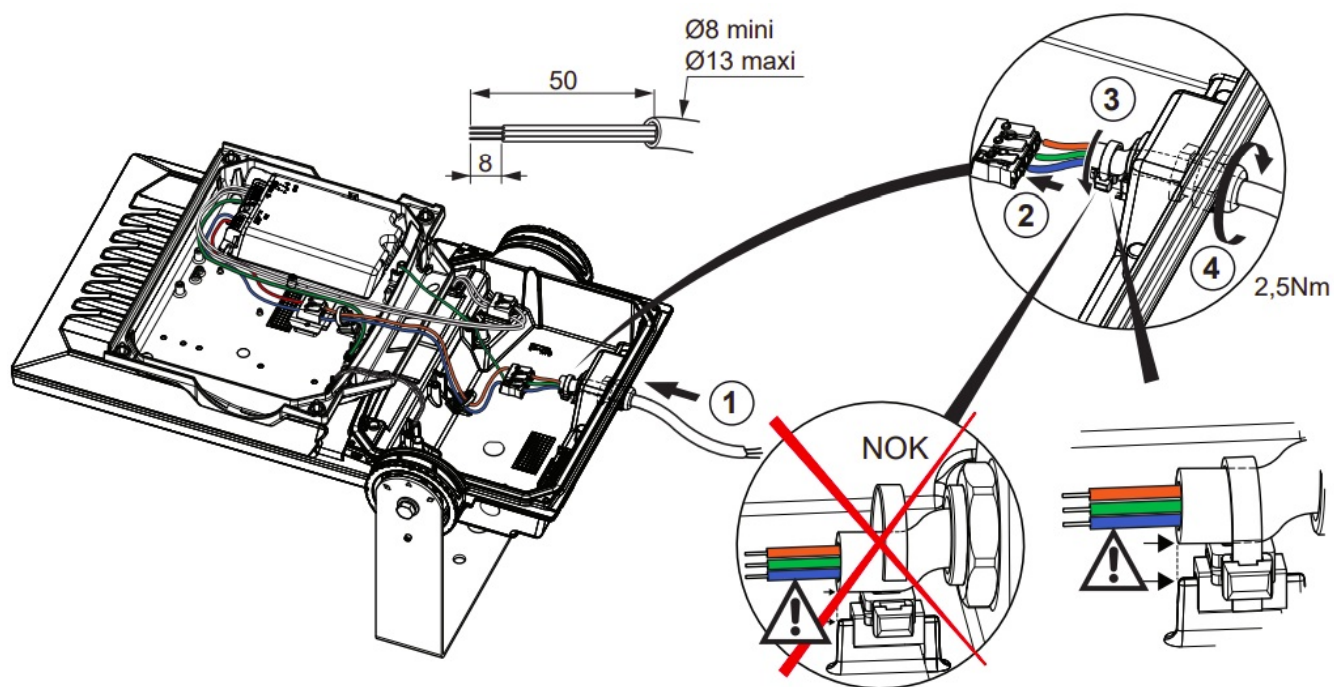

#### 4. CLASS I Standard

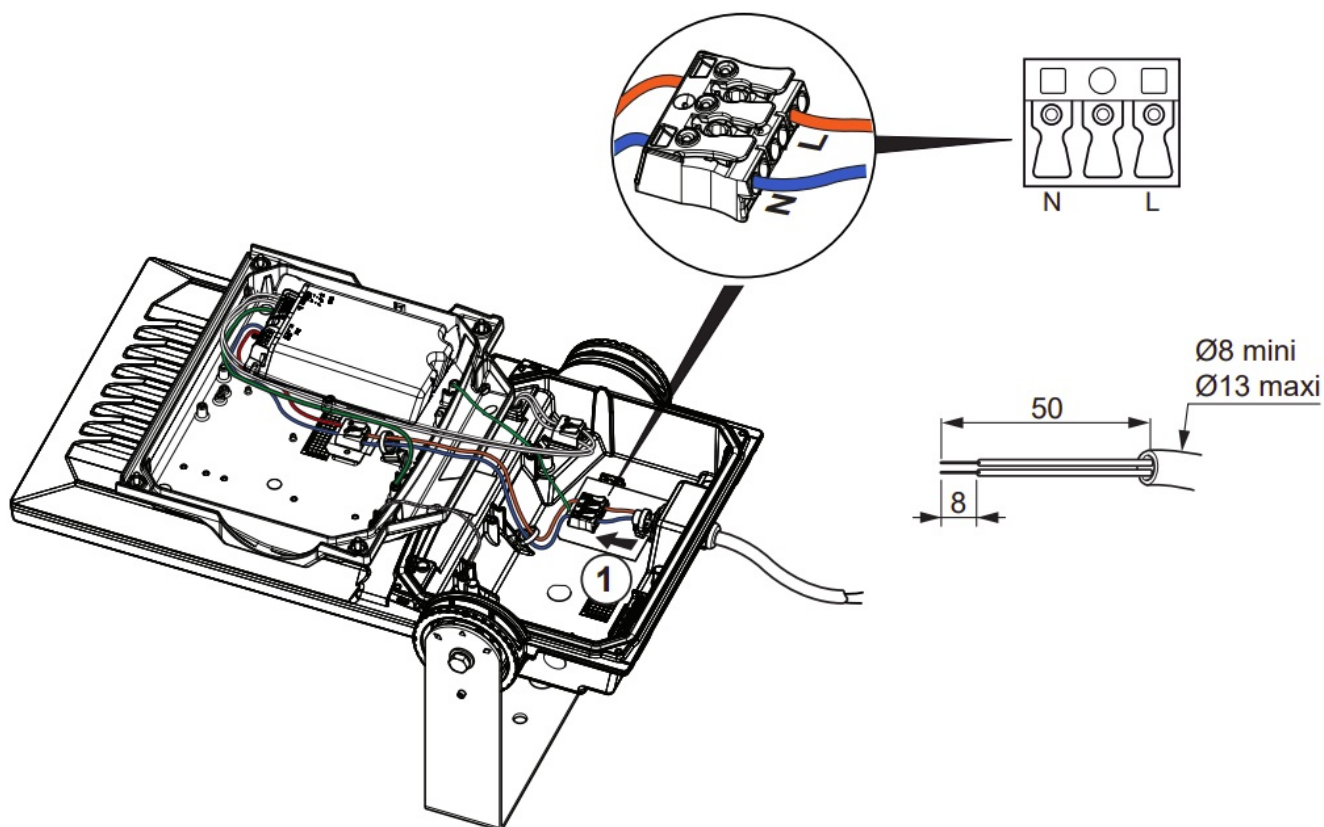

#### 5. CLASS I HFX



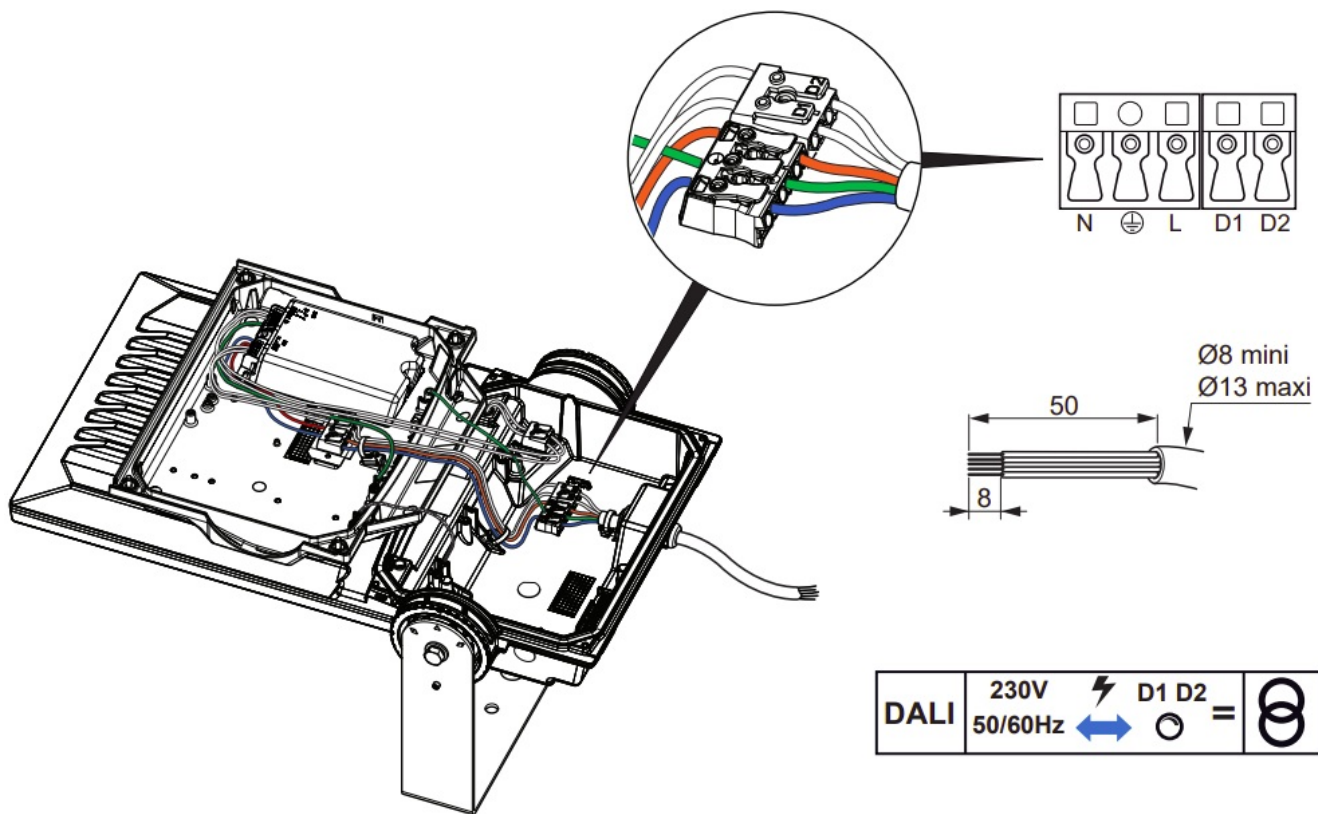

## 6. CLASS I BPL/LRT

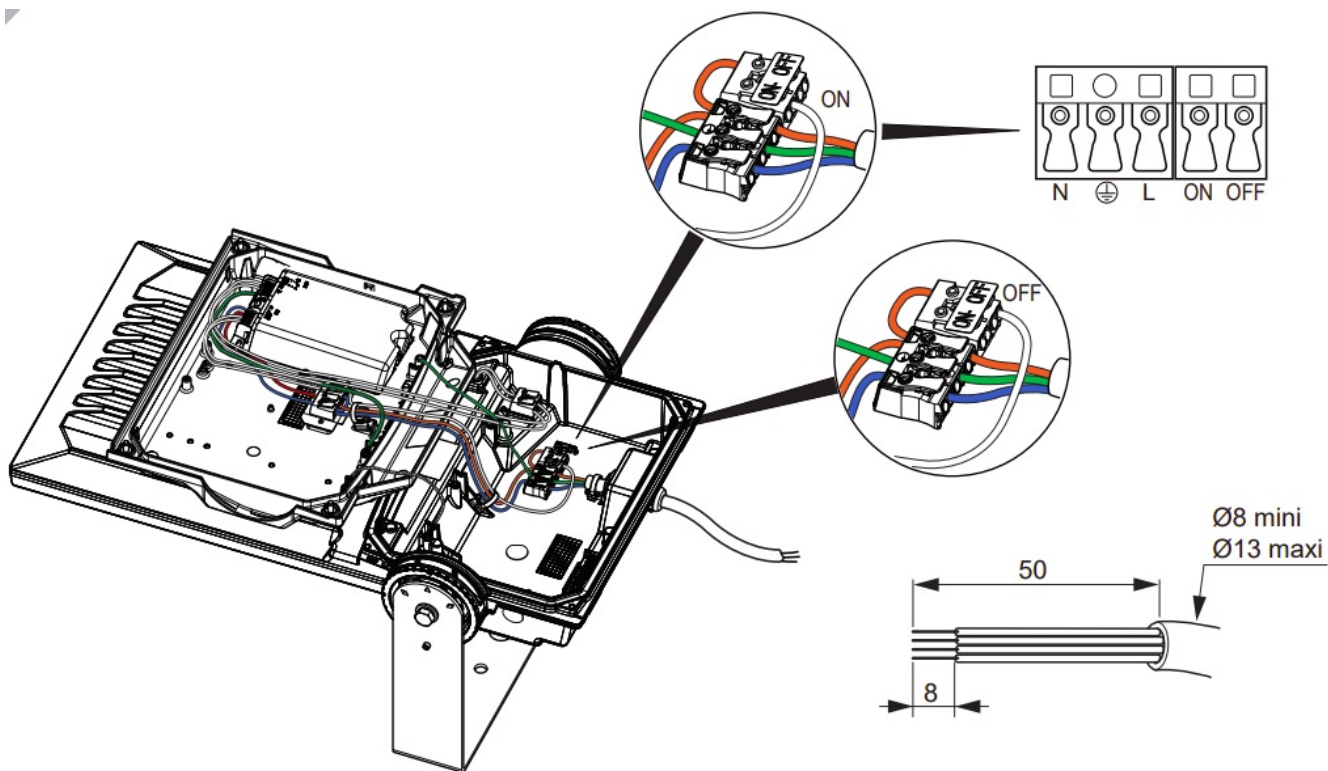

## 7. CLASS I BS

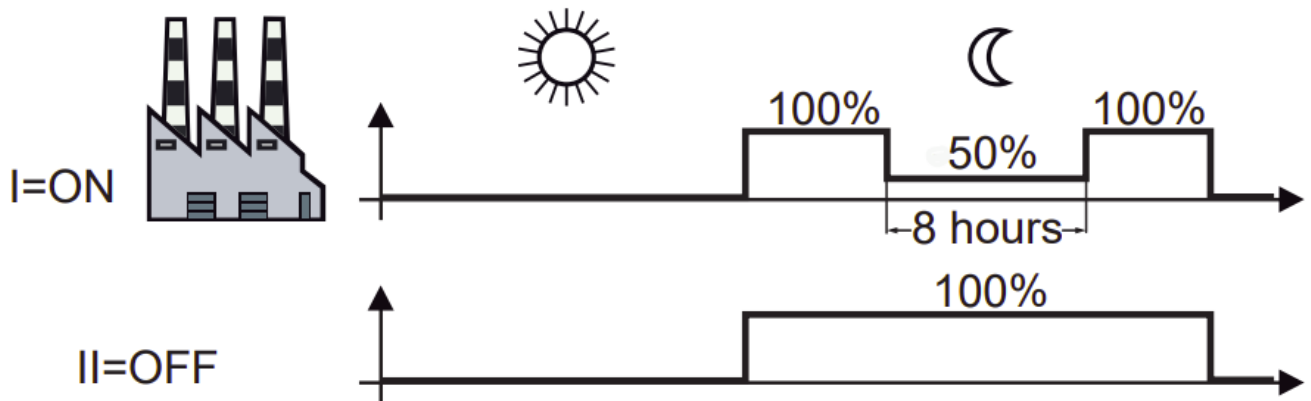
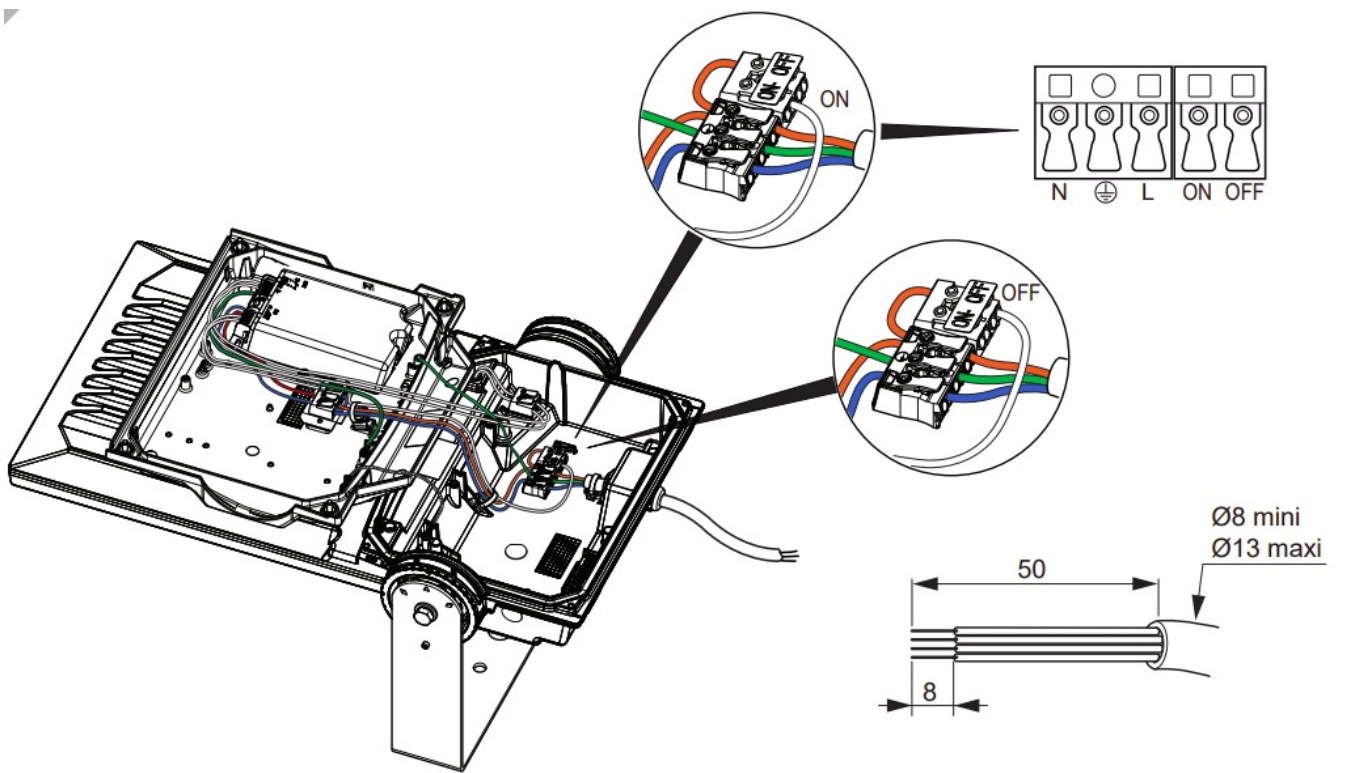

## 8. CLASS II Standard

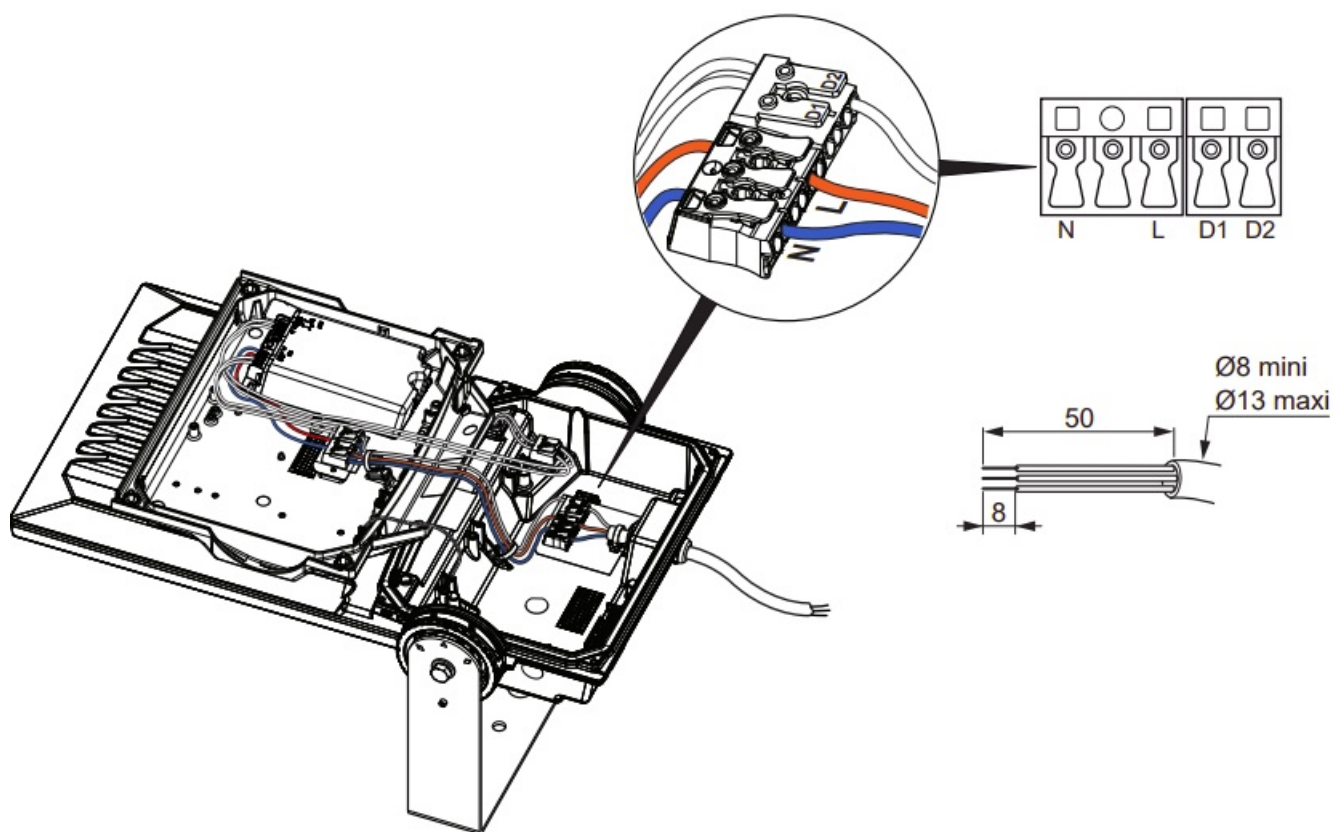

## 9. CLASS II HFX

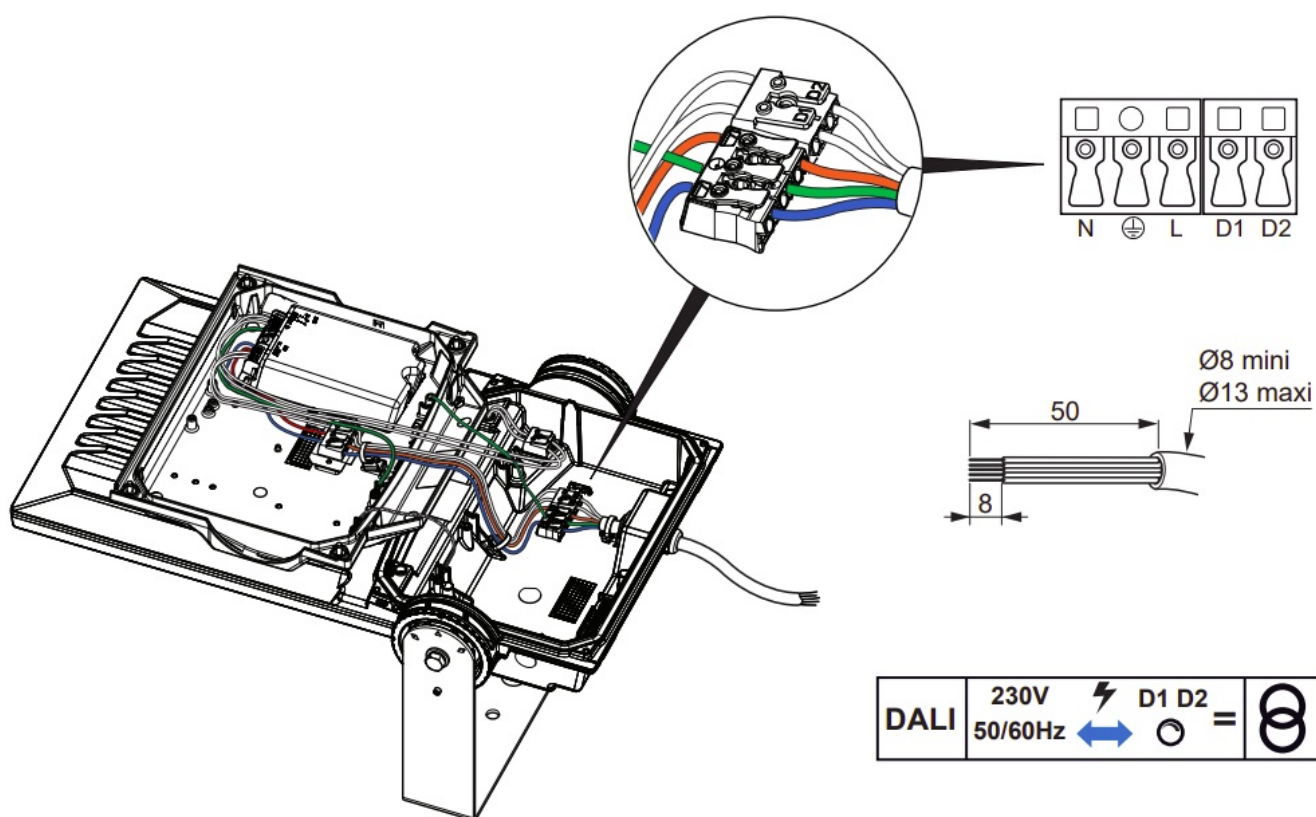

|      |         |   |       |   |   |
|------|---------|---|-------|---|---|
| DALI | 230V    | ⚡ | D1 D2 | = | ⊗ |
|      | 50/60Hz | ↔ | ⊙     |   |   |

## 10. CLASS II BPL/LRT



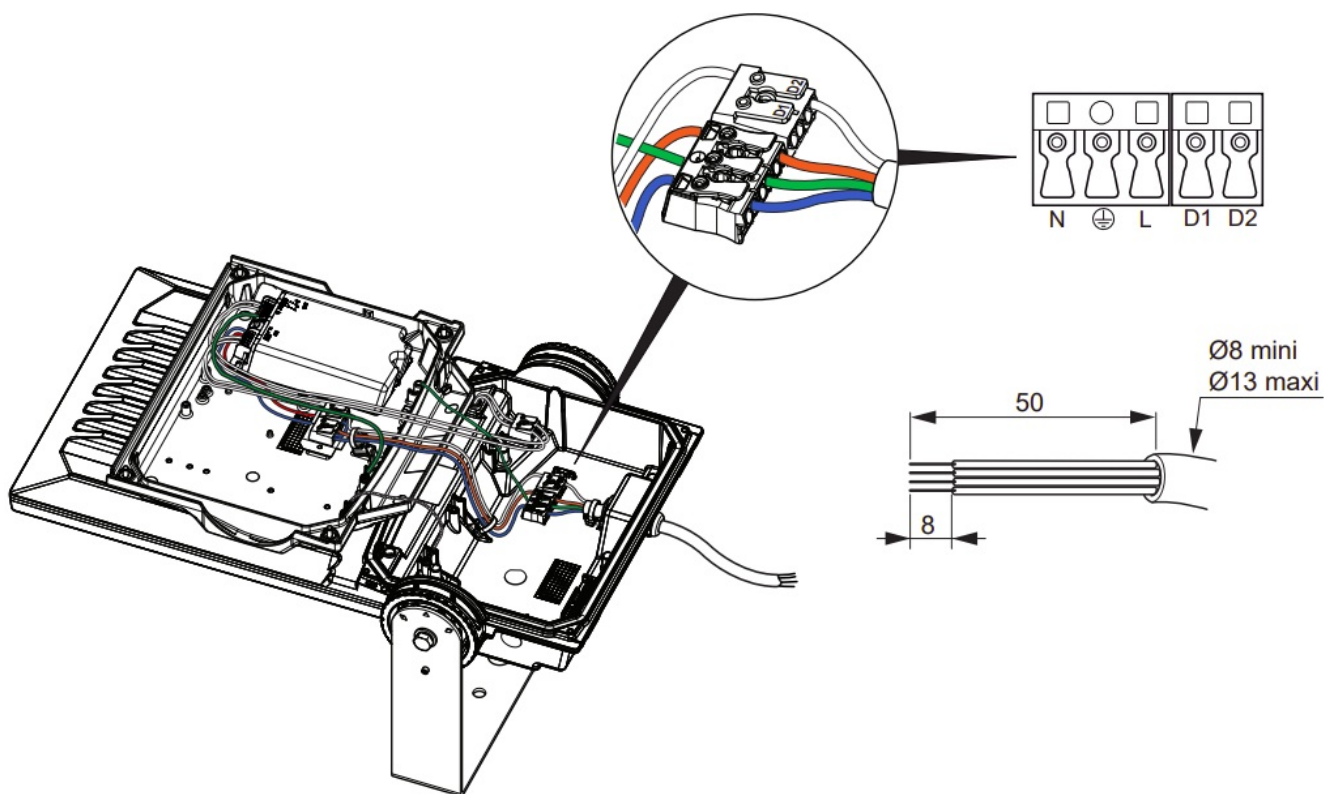

## 11. CLASS II BS

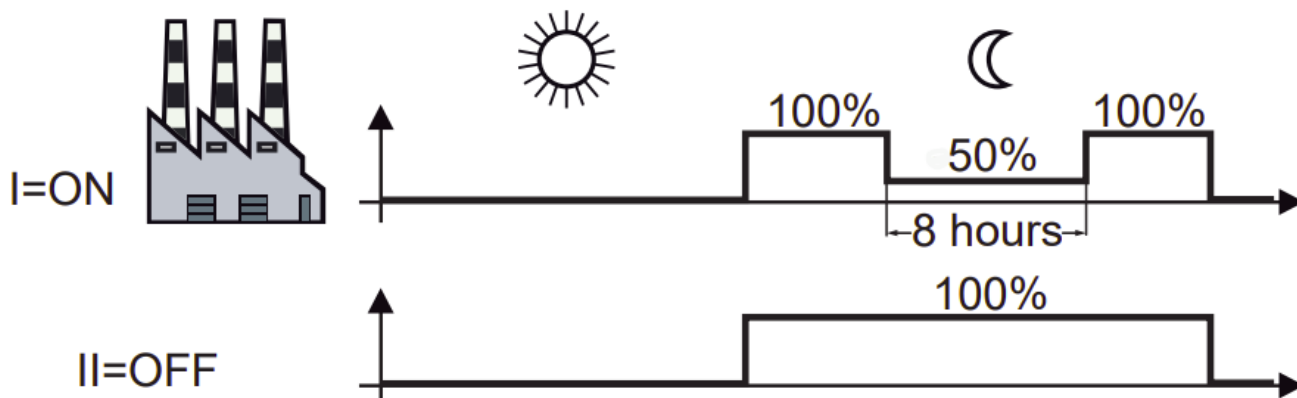
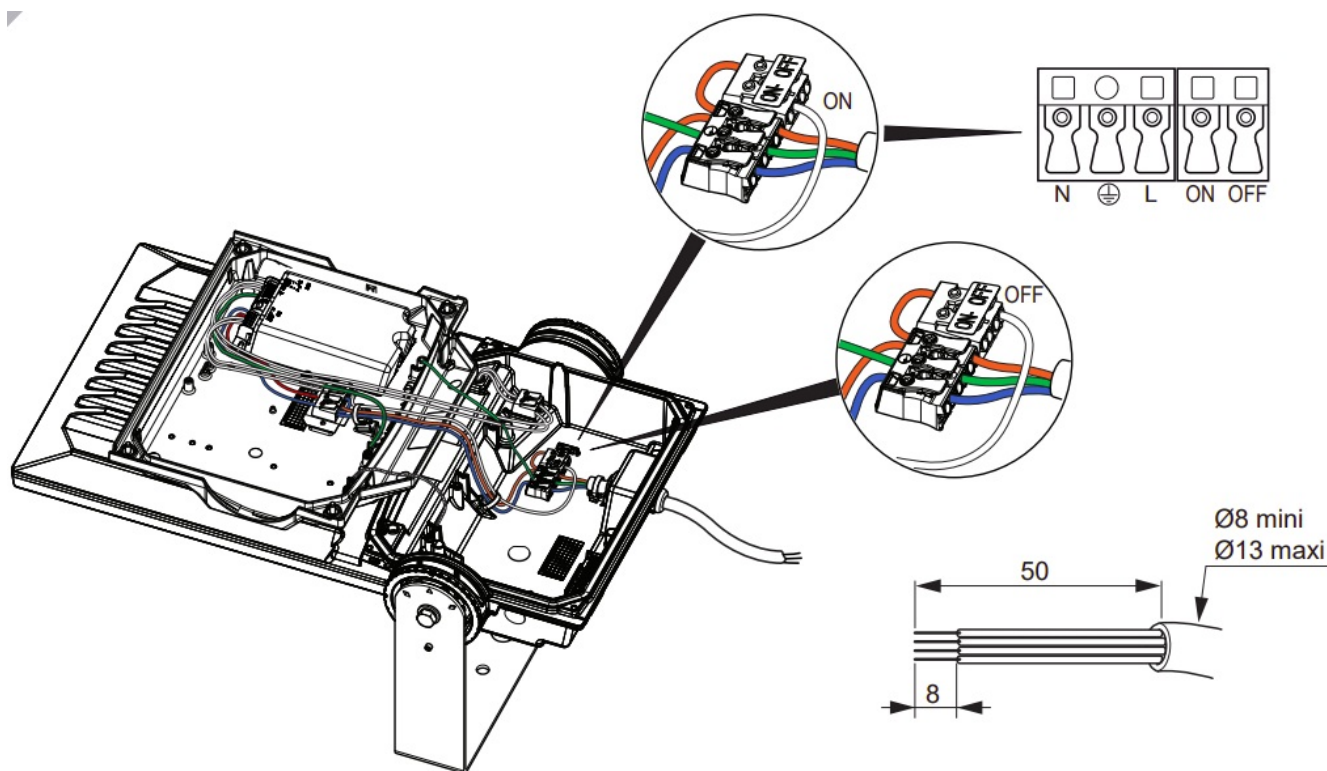



12. **AFP2 S-M-L**

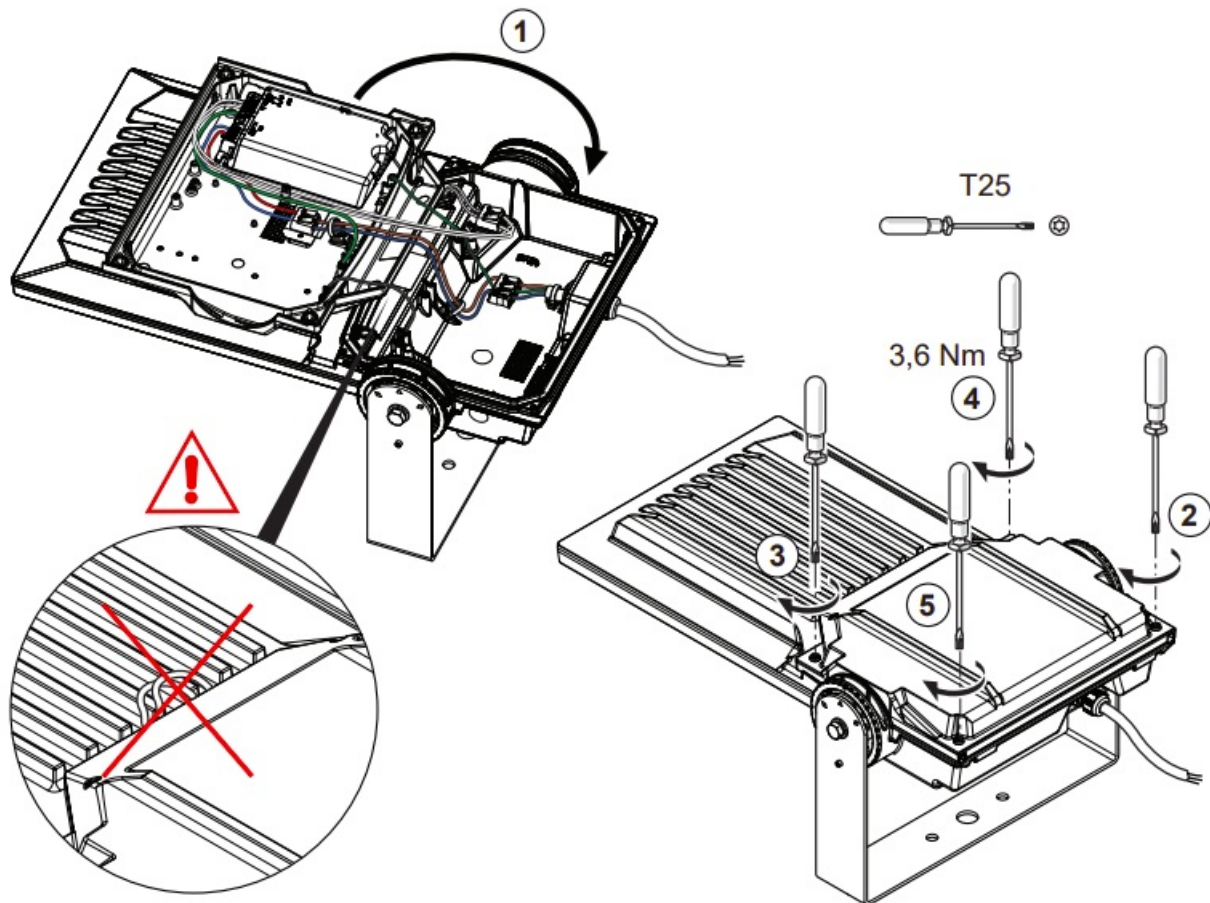

**13. AFP2 S-M-L**

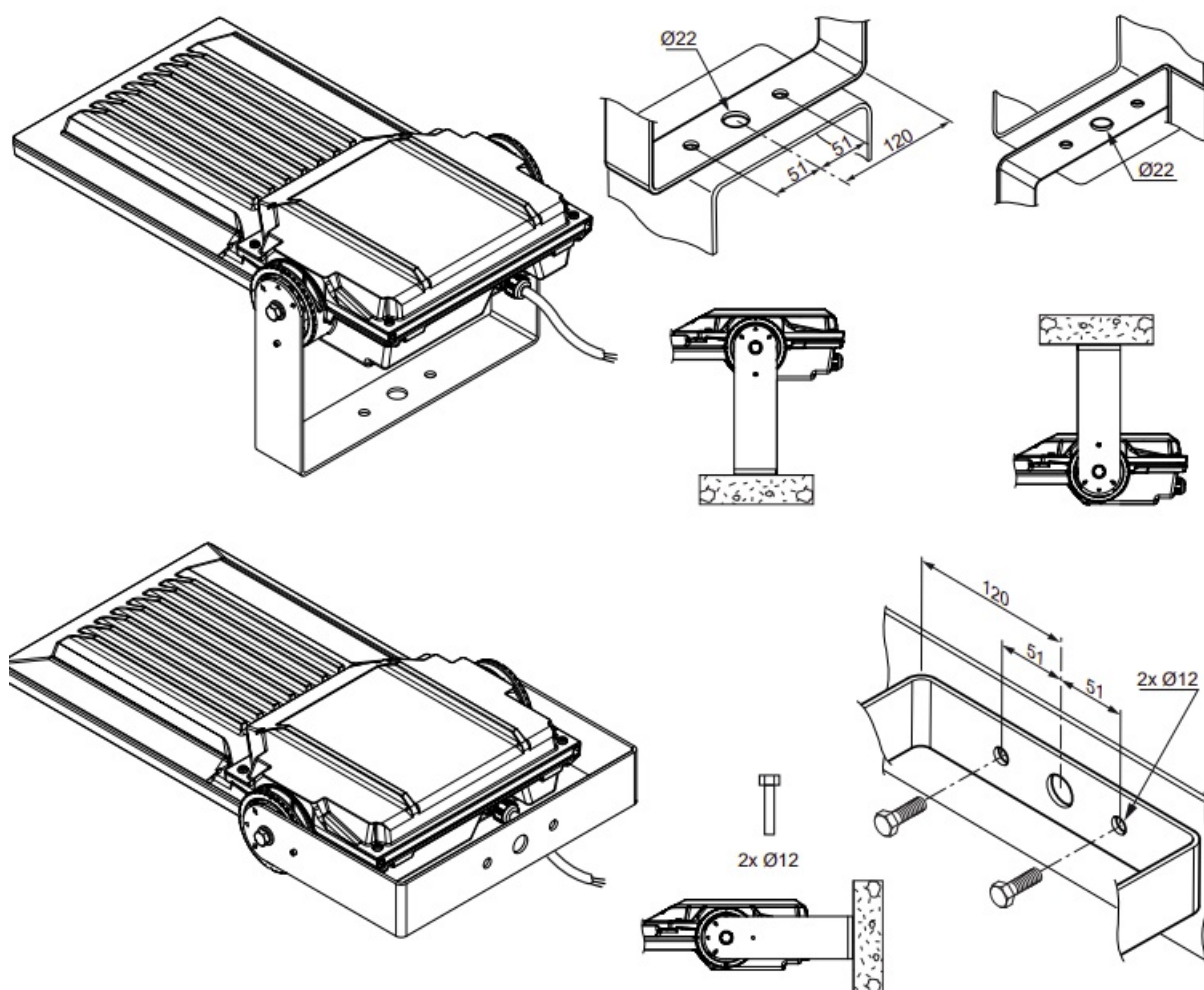

**14. AFP2 S-M-L**

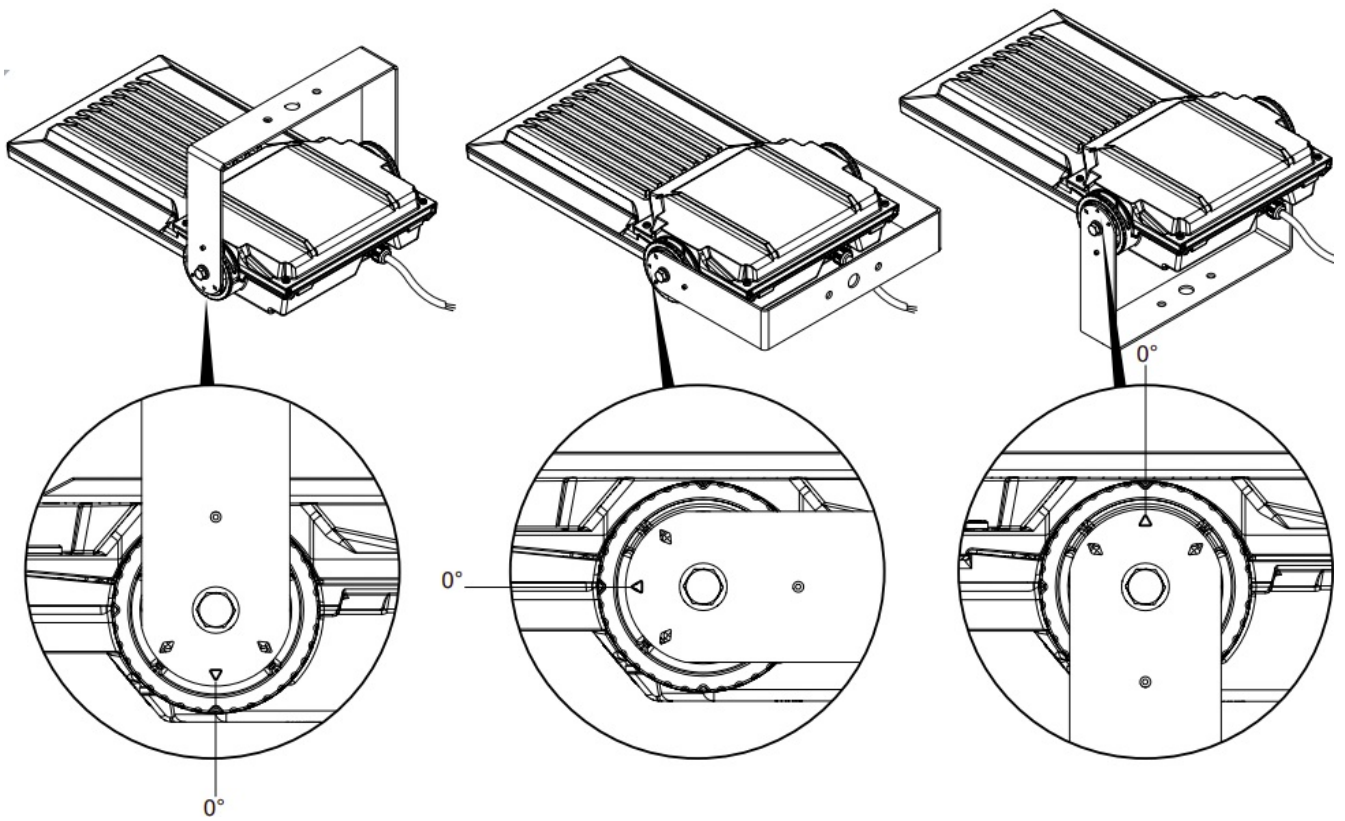

# 15. FP2 S-M-L

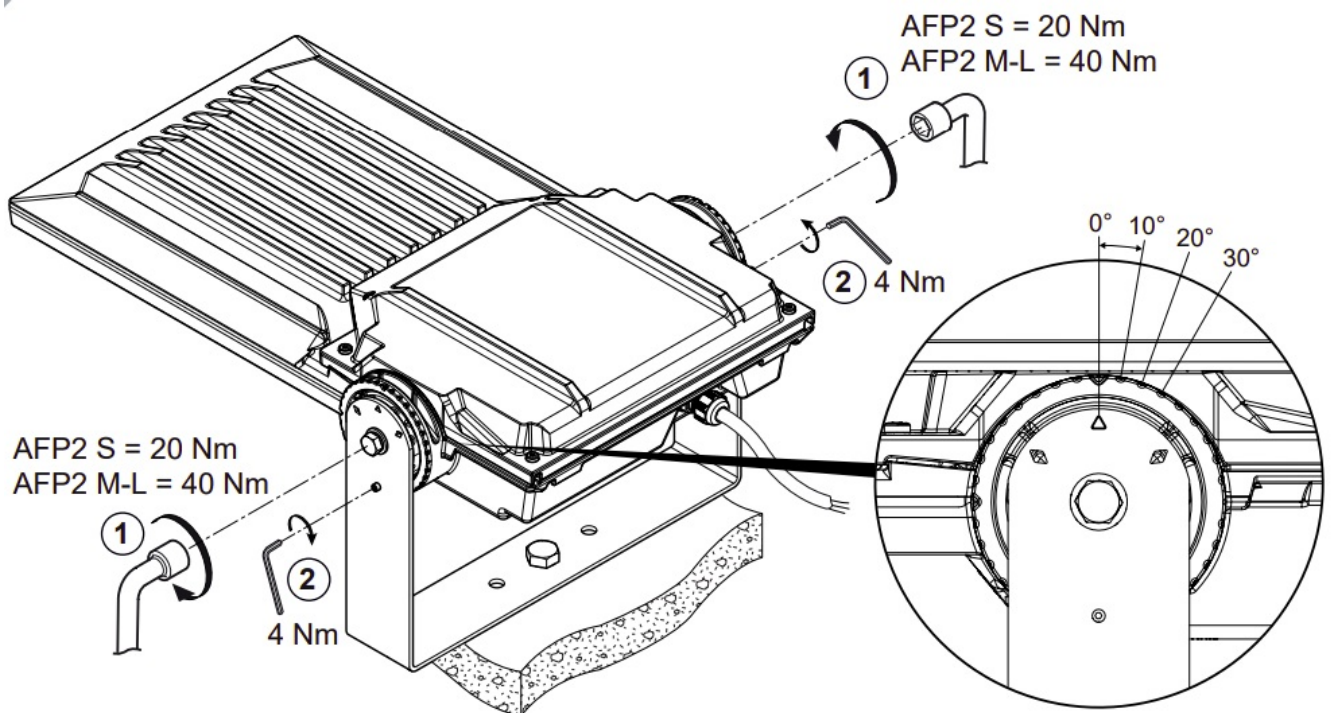

# 16. AFP2 L

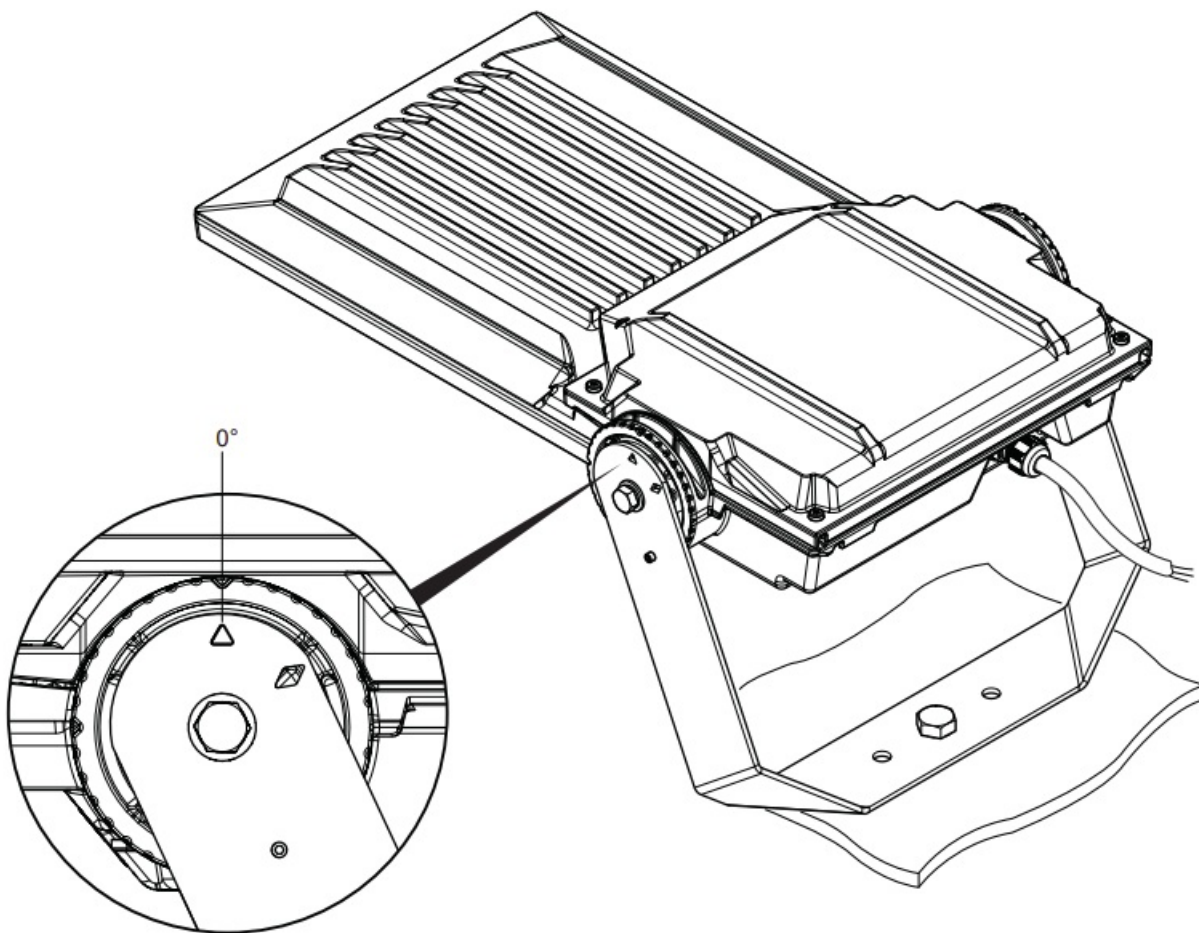

Replace any cracked protective shield. -Class II luminaires must be installed so that exposed metal work of the luminaire is not in contact with any part of the electrical installation connected to a protective conductor.

**WARNING:**

Class I luminaires must be earthed. This luminaire operates at mains voltage which must be switched off before intervention in control gear. - Any modification to this luminaire is forbidden. -Lighted objects nearer than the minimal distance in the is forbidden.

## Documents / Resources

|  |  |
|--|--|
|  | <p><a href="#">THORN AFP2 S-M-L Large Spaces LED Projector</a> [pdf] Installation Guide<br/> AFP2 M 60L70-740 A4 CL2 GY, AFP2 S-M-L, AFP2 S-M-L Large Spaces LED Projector, Large Spaces LED Projector, Spaces LED Projector, LED Projector, Projector</p> |
|--|--|

## References

- [User Manual](#)

[Manuals+](#), [Privacy Policy](#)