



THORLABS LPC01 Track Joining Kit Instructions

[Home](#) » [THORLABS](#) » THORLABS LPC01 Track Joining Kit Instructions 

Contents

- [1 THORLABS LPC01 Track Joining Kit](#)
- [2 INTRODUCTION](#)
- [3 Parts Included](#)
- [4 Joining the Curtain Rail](#)
- [5 Thorlabs Worldwide Contacts](#)
- [6 Documents / Resources](#)
 - [6.1 References](#)
- [7 Related Posts](#)



THORLABS LPC01 Track Joining Kit



INTRODUCTION

This leaflet details how to use the LPC01 track joining kit to join a custom rail arrangement of the Thorlabs Curtain system. For the continuing safety of the operators of the equipment and for the protection of the equipment itself,

the operator should take note of the Warnings, Cautions and Notes throughout this leaflet, and, where applicable, in any associated literature.

Parts Included

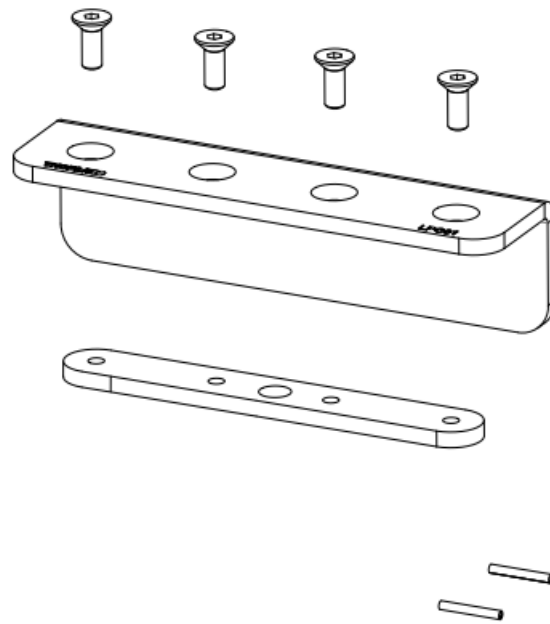

- **A.** M6 x 16 Countersunk Bolt (qty 4)
- **B.** Joint Plate Top
- **C.** Joint Plate Bottom
- **D.** Insertion Force Locating Pins (qty 2)

Joining the Curtain Rail

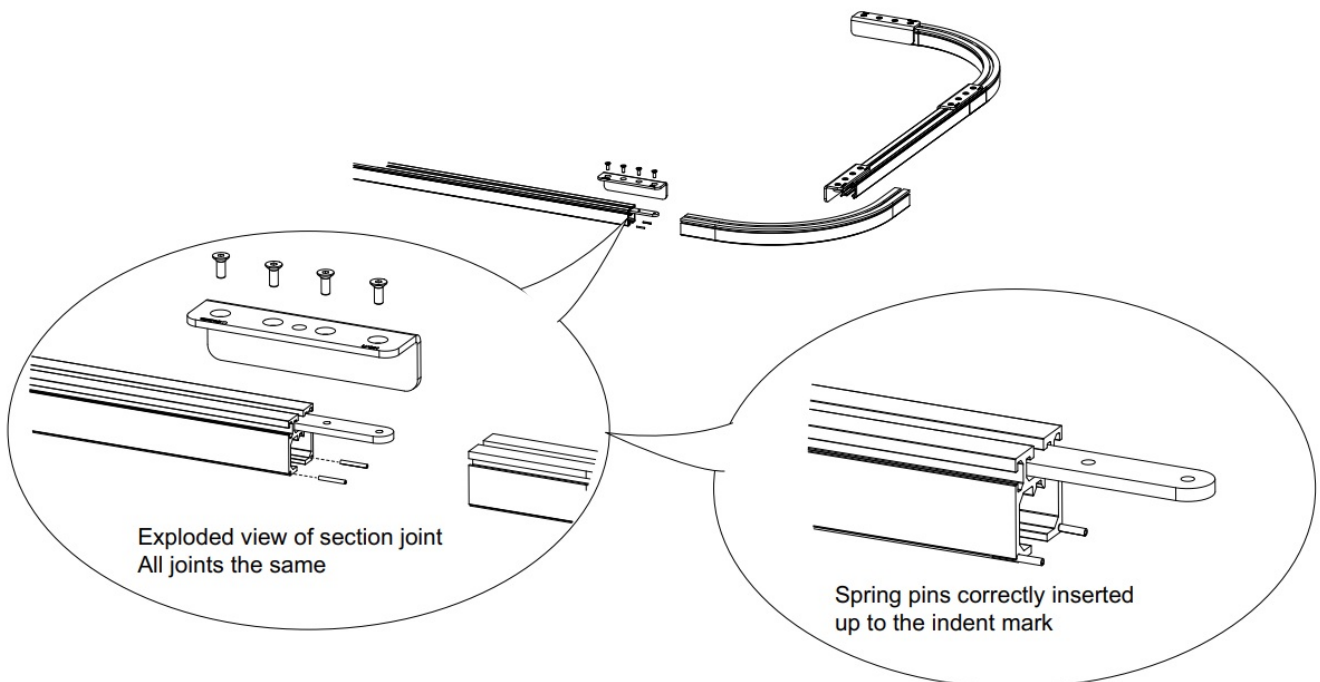

Fig. 1.2 Joining the Curtain Rail

1. Lay the parts on the floor, or other suitable large, flat surface roughly in the positions shown in Fig. 1.2.
2. Insert the two spring pins (D) into the joint as shown below. Push in each pin up to the indent mark, such that about half its length is protruding.
3. Using the M6 x 16 countersunk bolts (A) and joint plates (B and C) provided, assemble the curtain rail as shown below.

Thorlabs Worldwide Contacts

For technical support or sales inquiries, please visit us at www.thorlabs.com/contact for our most up-to-date contact information.



- **USA, Canada, and South America**

Thorlabs, Inc.

sales@thorlabs.com

techsupport@thorlabs.com

- **Europe**

Thorlabs GmbH

europe@thorlabs.com

- **France**

Thorlabs SAS

sales.fr@thorlabs.com

- **Japan**

Thorlabs Japan Inc.

sales@thorlabs.jp

- **UK and Ireland**

Thorlabs Ltd.

sales@uk.thorlabs.com

techsupport.uk@thorlabs.com

- **Scandinavia**

Thorlabs Sweden AB

scandinavia@thorlabs.com

- **Brazil**

Thorlabs Vendas de Fotônicos Ltda.

brasil@thorlabs.com

- **China**

Thorlabs China

chinasales@thorlabs.com

www.thorlabs.com

Documents / Resources

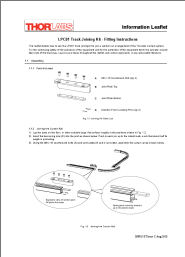
	<p>THORLABS LPC01 Track Joining Kit [pdf] Instructions LPC01 Track Joining Kit, Track Joining Kit, LPC01 Joining Kit, Joining Kit, LPC01</p>
---	--

References

- [Thorlabs, Inc. - Your Source for Fiber Optics, Laser Diodes, Optical Instrumentation and Polarization Measurement & Control](#)
- [Thorlabs, Inc. - Your Source for Fiber Optics, Laser Diodes, Optical Instrumentation and Polarization Measurement & Control](#)
- [Thorlabs, Inc. - Your Source for Fiber Optics, Laser Diodes, Optical Instrumentation and Polarization Measurement & Control](#)