

THORN
AFP2 S-M-L Large
Spaces LED Projector

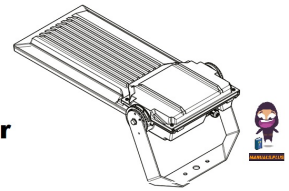

THOR AFP2 S-M-L Large Spaces LED Projector Instruction Manual

[Home](#) » [THOR](#) » THOR AFP2 S-M-L Large Spaces LED Projector Instruction Manual 

Contents

- [1 THOR AFP2 S-M-L Large Spaces LED Projector](#)
- [2 Product Information](#)
- [3 Product Usage Instructions](#)
- [4 FAQ](#)
- [5 Dimension](#)
- [6 Features](#)
- [7 INSTALLATION INSTRUCTION](#)
- [8 Important Instruction](#)
- [9 Documents / Resources](#)
 - [9.1 References](#)
- [10 Related Posts](#)

THORN

THOR AFP2 S-M-L Large Spaces LED Projector

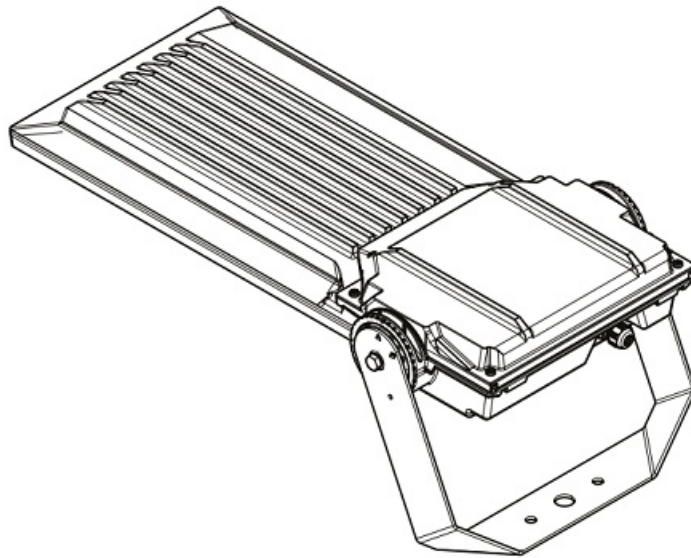

Product Information

Specifications

- **Type:** AFP2 S-M-L
- **LED Class:** I
- **Class:** II
- **Impact Protection:** IK08
- **Ingress Protection:** IP66
- **Regulations:** Australia / New Zealand
- **Wind Speed Resistance:** 250 km/h
- **Optic Type:** Asymmetric Optic

Product Usage Instructions

Installation Instructions

- Follow the installation instructions provided in the manual for proper setup and mounting of the luminaire.

Risk Reduction

- To reduce the risk of strangulation, ensure that the flexible wiring connected to the luminaire is effectively fixed to the wall if it is within arm's reach.

Positioning

- Position the luminaire with clear optics in a way that prevents prolonged staring into the light source at a close distance.

Maintenance

- Regularly inspect and clean the luminaire to ensure optimal performance and longevity.

FAQ

Is the luminaire suitable for outdoor use?

Yes, the luminaire has an IP66 rating, making it suitable for outdoor installations.

What is the recommended wind speed resistance of the luminaire?

The luminaire is designed to withstand wind speeds of up to 250 km/h.

How should I position the luminaire with clear optics to avoid glare?

Position the luminaire in a way that prevents prolonged direct staring into the light source at a close distance to avoid glare.

Dimension

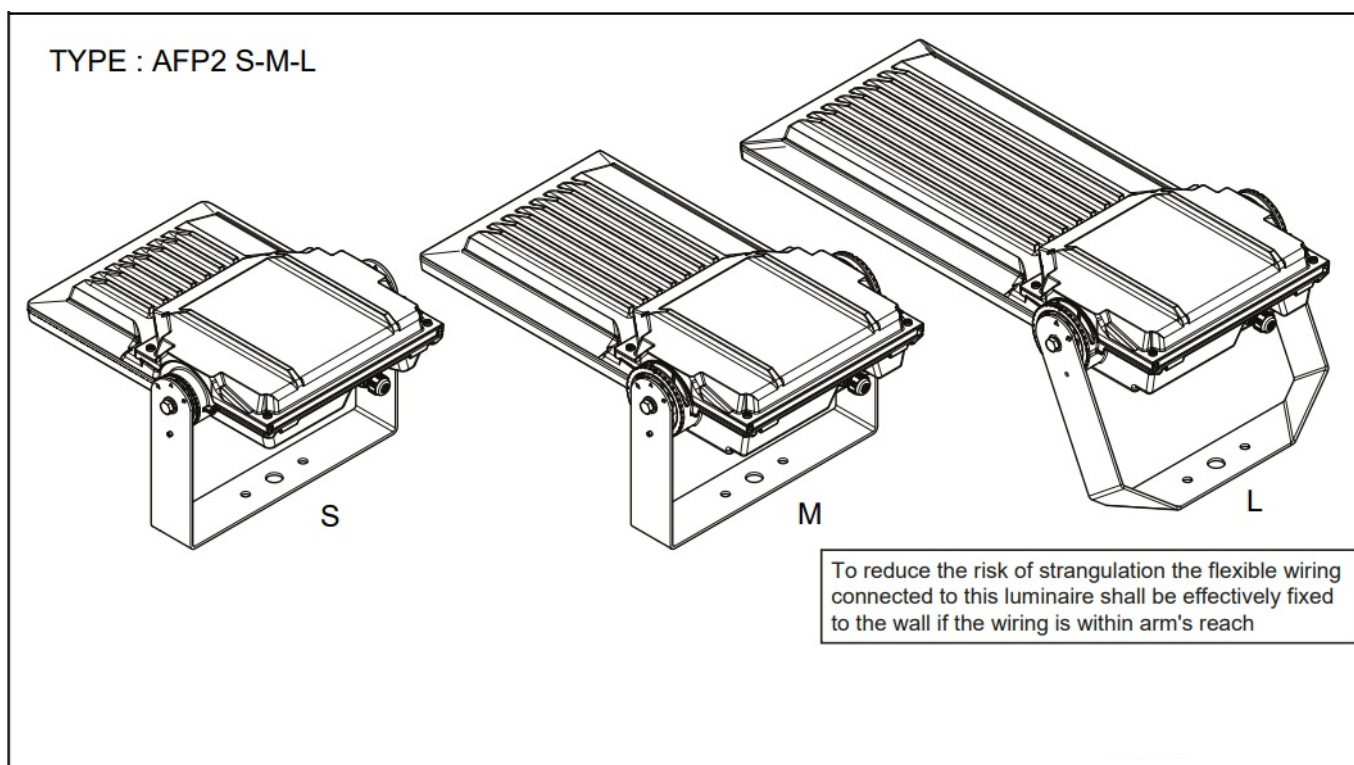

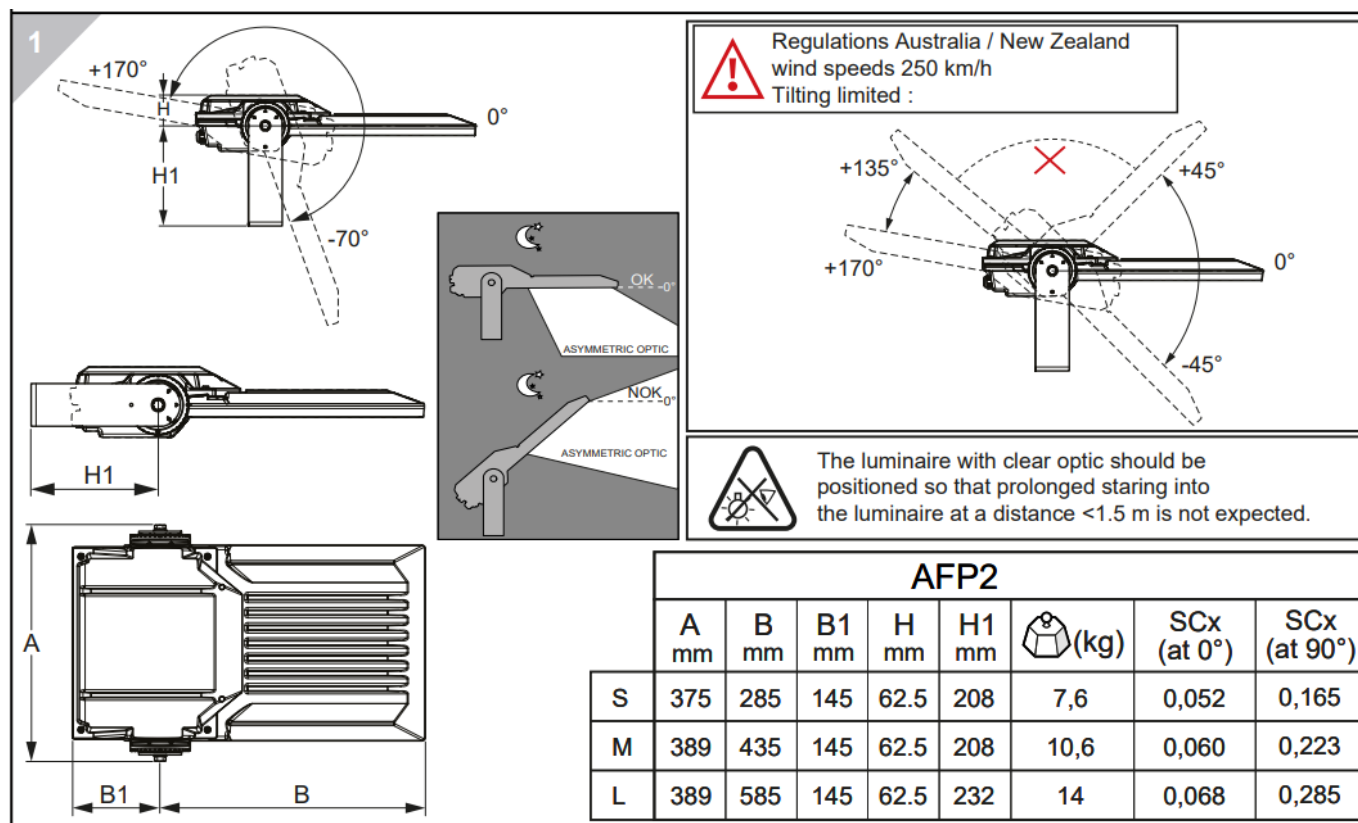

Features

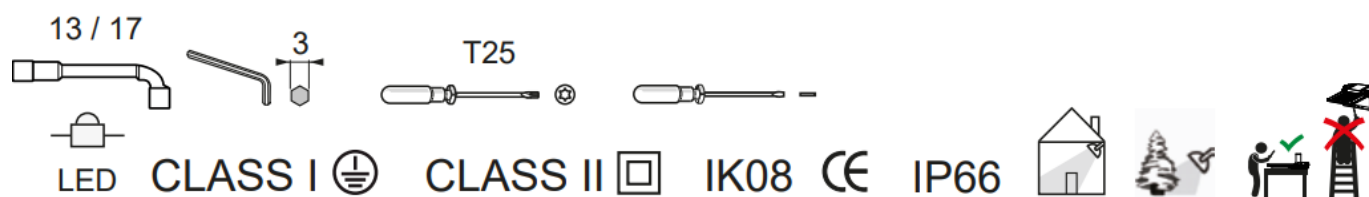

INSTALLATION INSTRUCTION

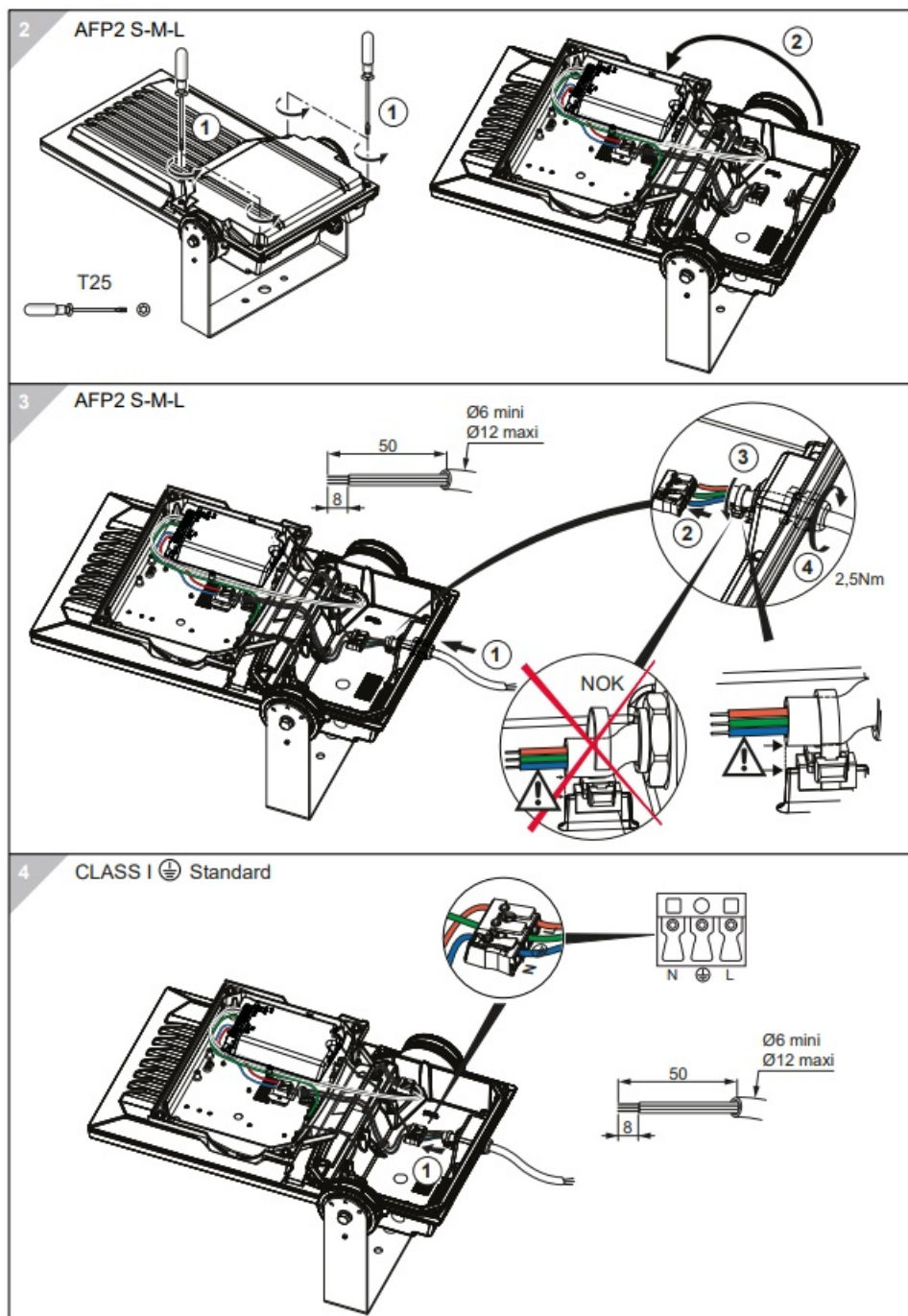

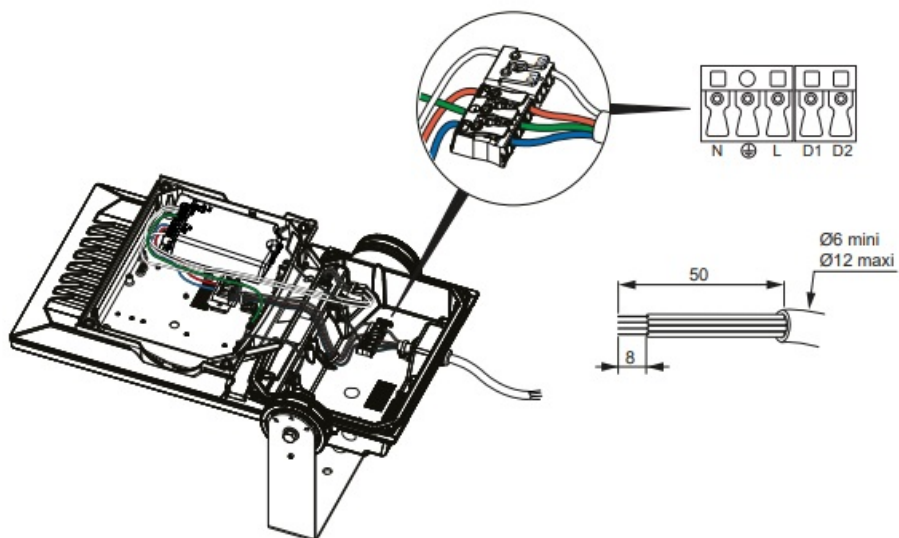
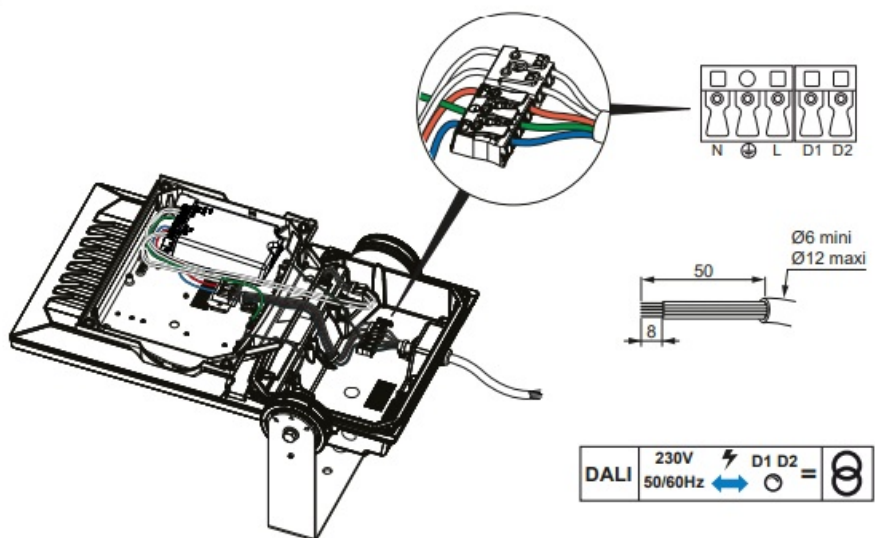

7

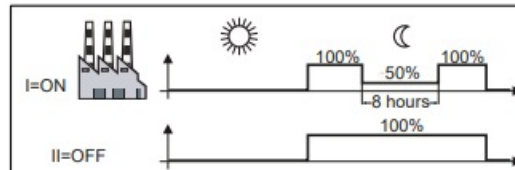
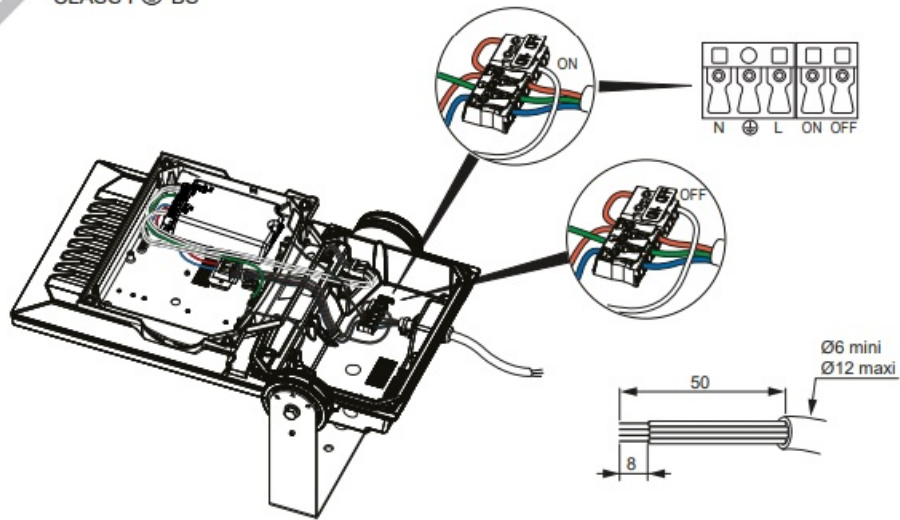
CLASS I  BS

8

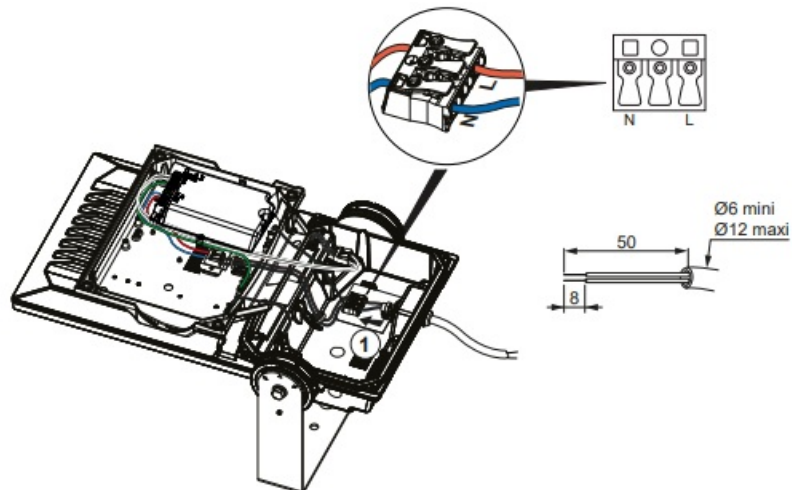
CLASS II  Standard

9

CLASS II □ HFX

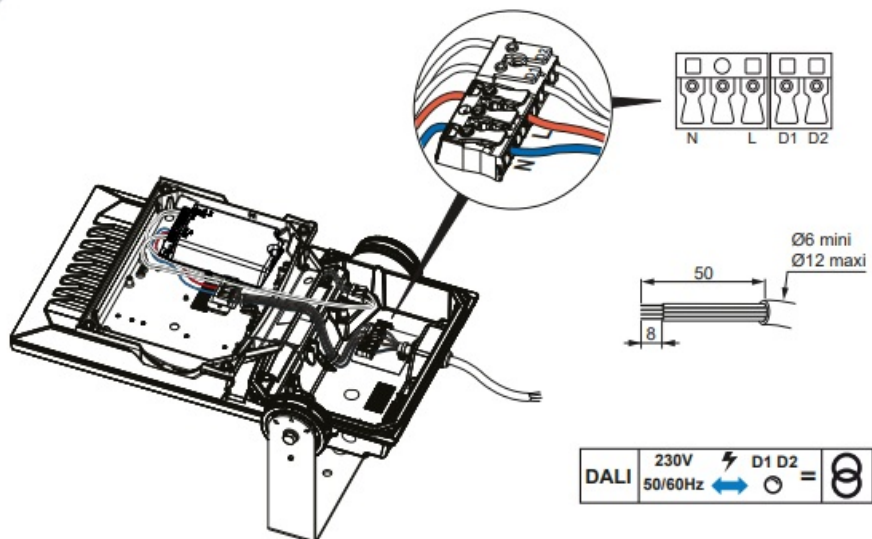

10

CLASS II □ BPL/LRT

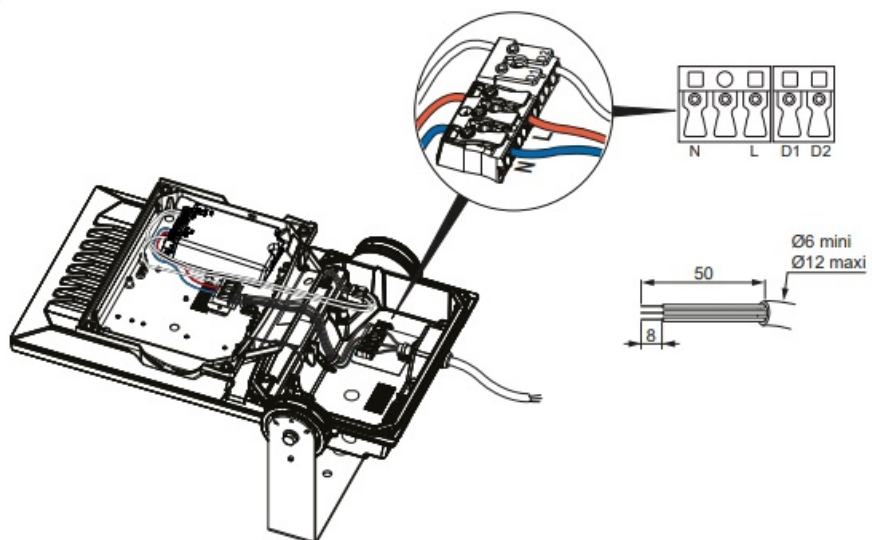

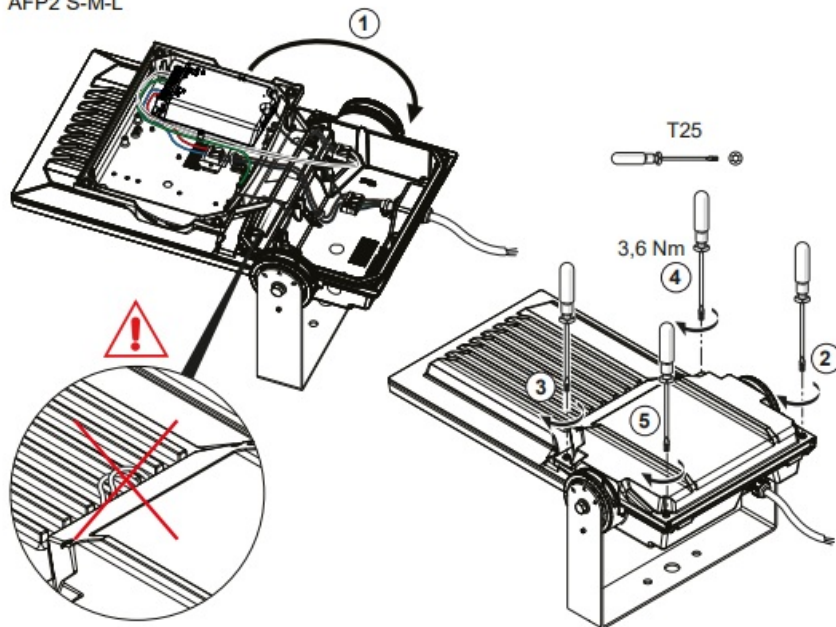
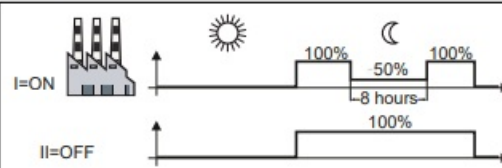
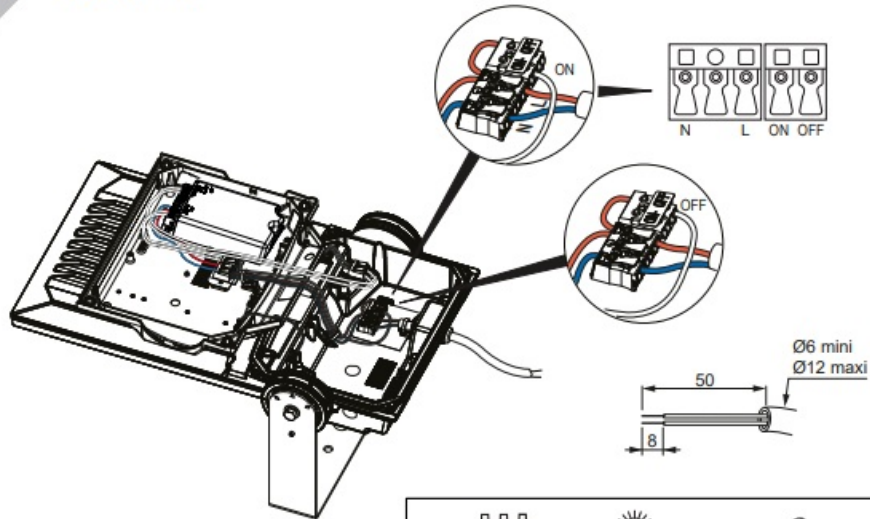

13 AFP2 S-M-L

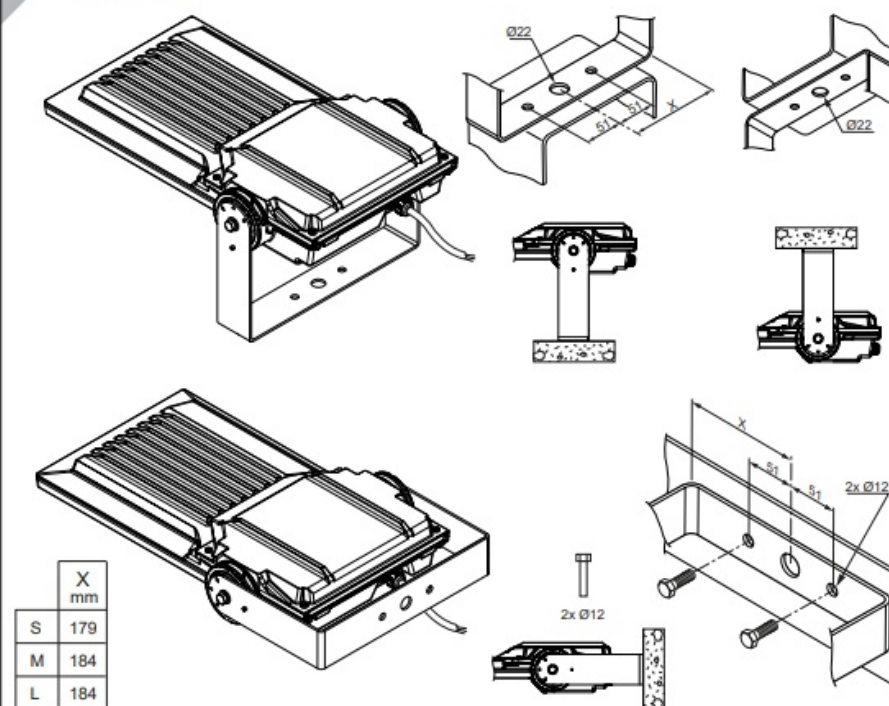

14 AFP2 S-M-L

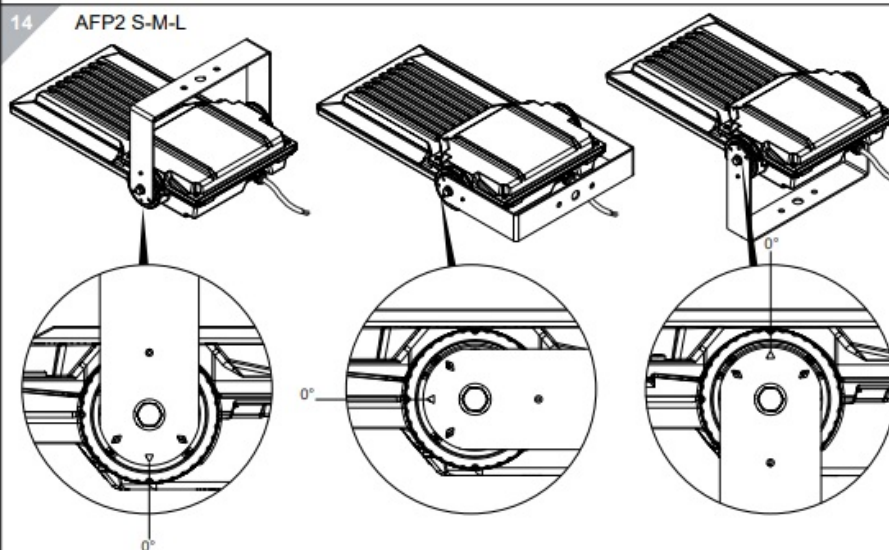

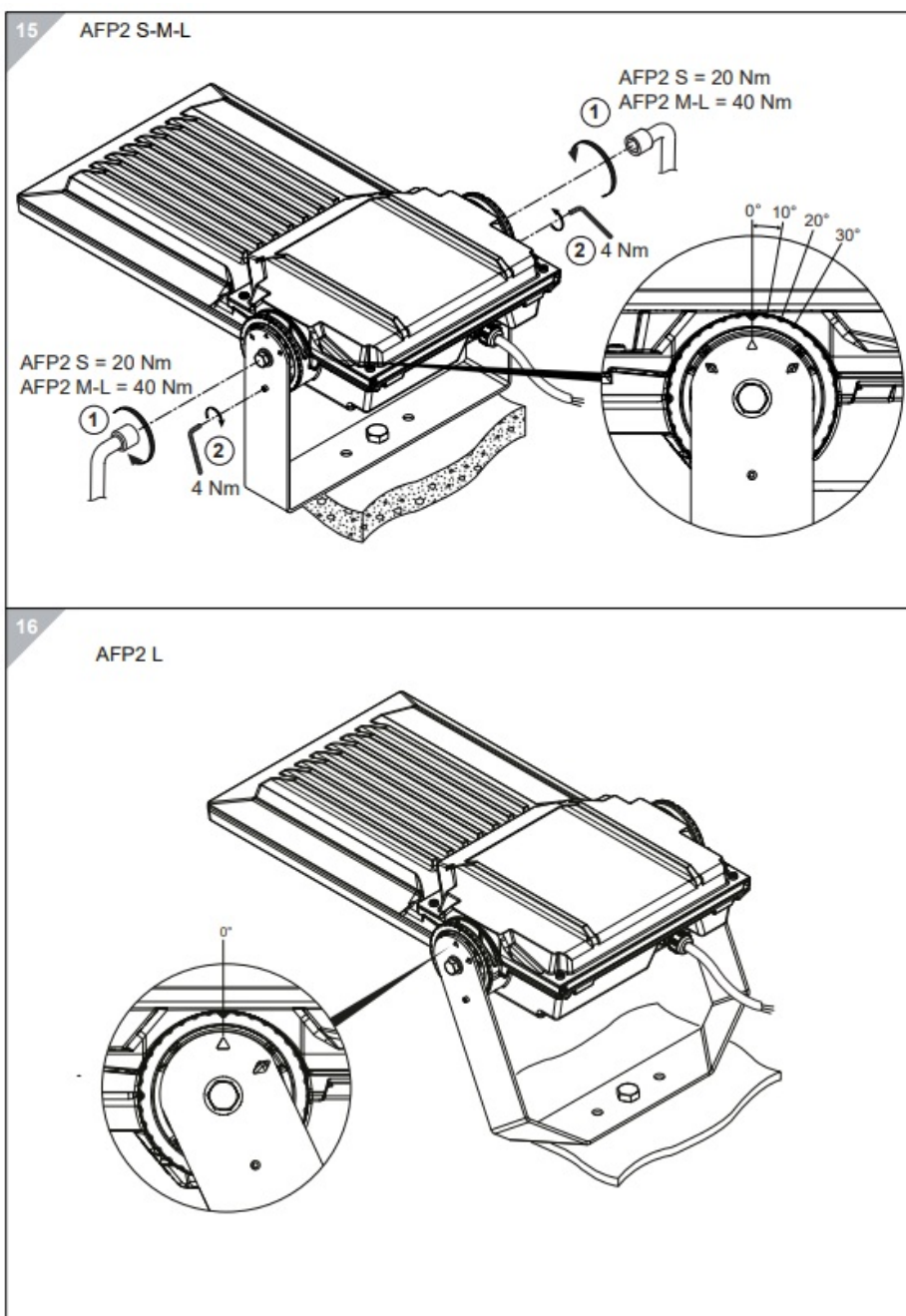

Important Instruction

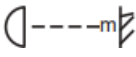
- Replace any cracked protective shield.
- Class II luminaires must be installed so that the exposed metal work of the luminaire is not in contact with any part of the electrical installation connected to a protective conductor.
- **WARNING:** Class I luminaires must be earthed.
- This luminaire operates at mains voltage which must be switched off before intervention in control gear.
- Any modification to this luminaire is forbidden.
- Lighted objects nearer than the minimal distance in the are forbidden 
- Thorn Lighting is constantly developing and improving its products.
- The right is reserved to change specifications without prior notification or public announcement.
- © Thorn Lighting

Documents / Resources



[THOR AFP2 S-M-L Large Spaces LED Projector](#) [pdf] Instruction Manual
AFP2 S, AFP2 M, AFP2 L, AFP2 S-M-L Large Spaces LED Projector, AFP2 S-M-L, Large Spaces LED Projector, Spaces LED Projector, LED Projector

References

- [User Manual](#)

[Manuals+](#), [Privacy Policy](#)

This website is an independent publication and is neither affiliated with nor endorsed by any of the trademark owners. The "Bluetooth®" word mark and logos are registered trademarks owned by Bluetooth SIG, Inc. The "Wi-Fi®" word mark and logos are registered trademarks owned by the Wi-Fi Alliance. Any use of these marks on this website does not imply any affiliation with or endorsement.