

THIRDREALITY B09ZQGSYB Smart Button Installation Guide

[Home](#) » [THIRDREALITY](#) » THIRDREALITY B09ZQGSYB Smart Button Installation Guide 

Contents

- [1 THIRDREALITY B09ZQGSYB Smart Button](#)
- [2 Product Information](#)
- [3 Product Usage Instructions](#)
- [4 Mounting Kit](#)
- [5 Setting up your Smart Button](#)
- [6 Install your Smart Button](#)
- [7 Pairing with Different Brands of Hubs](#)
- [8 Pairing with Third Reality](#)
- [9 Pairing with Amazon Echo](#)
- [10 FAQ](#)
- [11 FCC regulatory conformance](#)
- [12 Limited Warranty](#)
- [13 Documents / Resources](#)
 - [13.1 References](#)



THIRDREALITY

THIRDREALITY B09ZQGSYB Smart Button

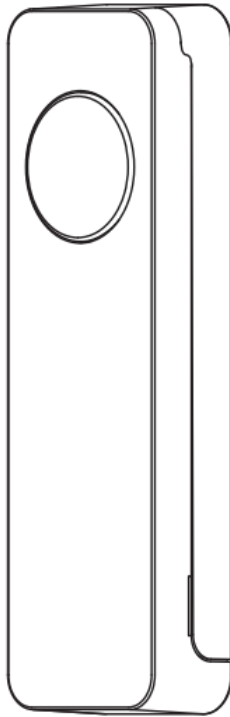

Product Information

- Product Name: Smart Button
- Included Items:
 - Mounting Kit
 - AAA Battery x 2
 - Double-sided Tape
 - Magnet Sticker x 2
 - Icon Sticker x 9
- LED Status:
 - ZigBee Pairing: fast blinking in blue
 - Echo ZigBee pairing: fast blinking in blue and red
 - Off-line: slow blinking in red
 - Low power: double blinking in red
- LED Indicator: 1
- Control Settings Supported:
 - Pressed
 - Double Pressed
 - Held
- Note: Smart Button is designed for indoor use only.

Product Usage Instructions

1. Setting up your Smart Button:
 1. Follow instructions to set up your compatible ZigBee hub.
 2. Slide the battery cover out and remove the battery insulation sheet.
 3. The LED indicator flashes rapidly in blue, indicating that the Smart Button is in pairing mode by default. If

the Smart Button is not in pairing mode, press and hold the reset button for 5 seconds until the LED indicator flashes rapidly in blue.

4. Configure the Smart Button with your ZigBee hub.
 5. Close the Smart Button's battery cover.
 6. After the pairing is completed, you can create routines in the corresponding smart home App or platform to control other connected devices.
2. Install your Smart Button: We provide two different installation methods, place your Smart Button according to your requirement:
- Using the double-sided tape that is included.
 - Using the magnet stickers that are included.
3. Pairing with Different Brands of Hubs:
1. Before pairing, check for updates to make sure the firmware of the hub is up to date.
 2. Pairing with Hubitat:
 - Remove the battery cover of the Smart Button and remove the battery insulation sheet. The LED indicator flashes quickly in blue, indicating that the Smart Button is in pairing mode.
 - Visit your Hubitat Elevation hub device page from your web browser, select the Devices menu item from the sidebar, then select Discover Devices in the upper right.
 - Click the Start ZigBee Pairing button after you select a ZigBee device type. The Start ZigBee Pairing button will put the hub into ZigBee pairing mode for 60 seconds.
 - After being paired successfully, it will be shown on the page as ThirdReality Smart Button. You can rename it if needed, then tap save.
 - Now you can see the Smart Button on the Devices page.
 3. Pairing with Home Assistant through ZHA:
 - Remove the battery cover of the Smart Button and remove the battery insulation sheet. The LED indicator flashes quickly in blue, indicating that the Smart Button is in pairing mode.
 - Make sure Home Assistant Integrations ZigBee Home Automation Setup is ready, then go to Configuration page and click integration.
 - Click the Devices on the ZigBee item, then click Add Devices.
 - After the pairing is successful, it will show as Third Reality, Inc 3RSB22BZ on the page.
 - Back to Devices page, then you can find the Smart Button added before. Click to enter the control interface to set the Smart Button.
 - Click the + belongs to Automation and then you can add different actions to Third Reality Smart Button.

Mounting Kit

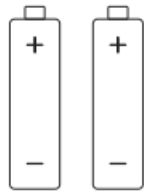

AAA Battery x 2



Double-sided Tape



Magnet Sticker x 2

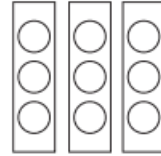

Icon Sticker x 9

LED Status

ZigBee Pairing: fast blinking in blue Echo ZigBee pairing: fast blinking in blue and red Off-line: slow blinking in red Low power: double blinking in red To switch mode between standard ZigBee mode and Echo ZigBee mode by pressing the reset button for 5 times within 5 seconds.

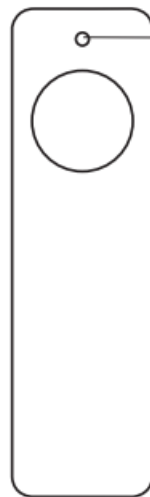

LED Indicator

Setting up your Smart Button

1. Follow instructions to set up your compatible ZigBee hub.
2. Slide the battery cover out (figure 1) and remove the battery insulation sheet.

①

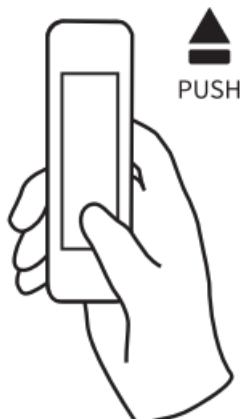

②

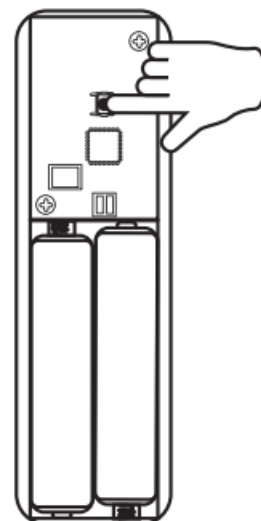

3. The LED indicator flashes rapidly in blue, indicating that the Smart Button is in pairing mode by default.

*If the Smart Button is not in pairing mode, press and hold the reset button for 5 seconds (Figure 2) until the LED indicator flashes rapidly in blue, indicating that it is in pairing mode.

4. Configure the Smart Button with your ZigBee hub.
5. Close the Smart Button's battery cover.
6. After the pairing is completed, you can create routines in the corresponding smart home App or platform to control other connected devices.

THIRDREALITY Smart Button supports three control settings: Pressed, Double Pressed and Held.

Install your Smart Button

We provide two different installation methods, place your Smart Button according to your requirement.

- Using the double-sided tape that included:

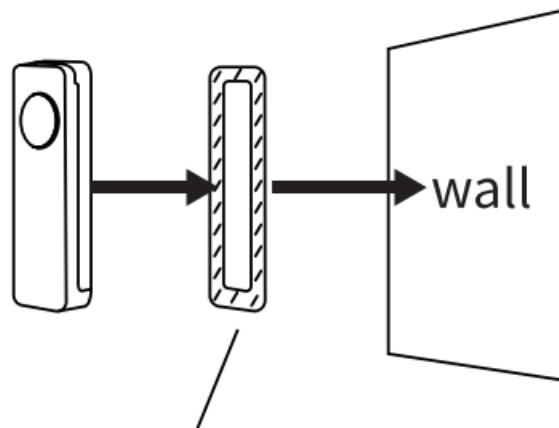

Double-sided Tape

- Using the magnet stickers that included:

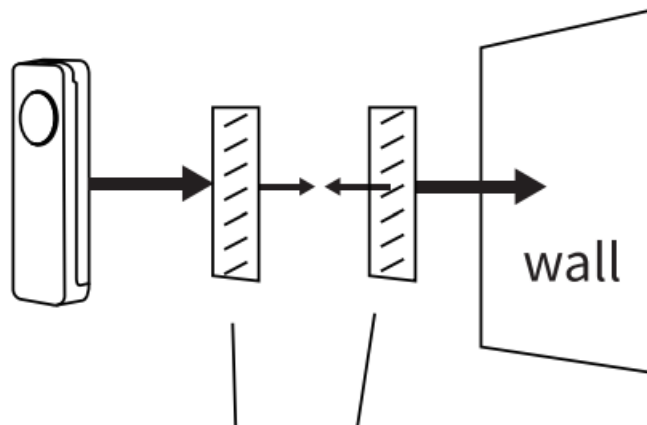

Magnet Stickers

*Note: Smart Button is designed for indoor use only.

Pairing with Different Brands of Hubs

Before pairing, check for updates to make sure the firm-ware of the hub is up to date.

1. Pairing with Hubitat

Website: <http://find.hubitat.com/>

Pairing steps:

1. Remove the battery cover of the Smart Button, remove the battery insulation sheet, the LED indicator flashes quickly in blue, indicating the Smart Button is in pairing mode.
2. Visit your Hubitat Elevation hub device page from your web browser, select the Devices menu item from the side-bar, then select Discover Devices in the upper right.

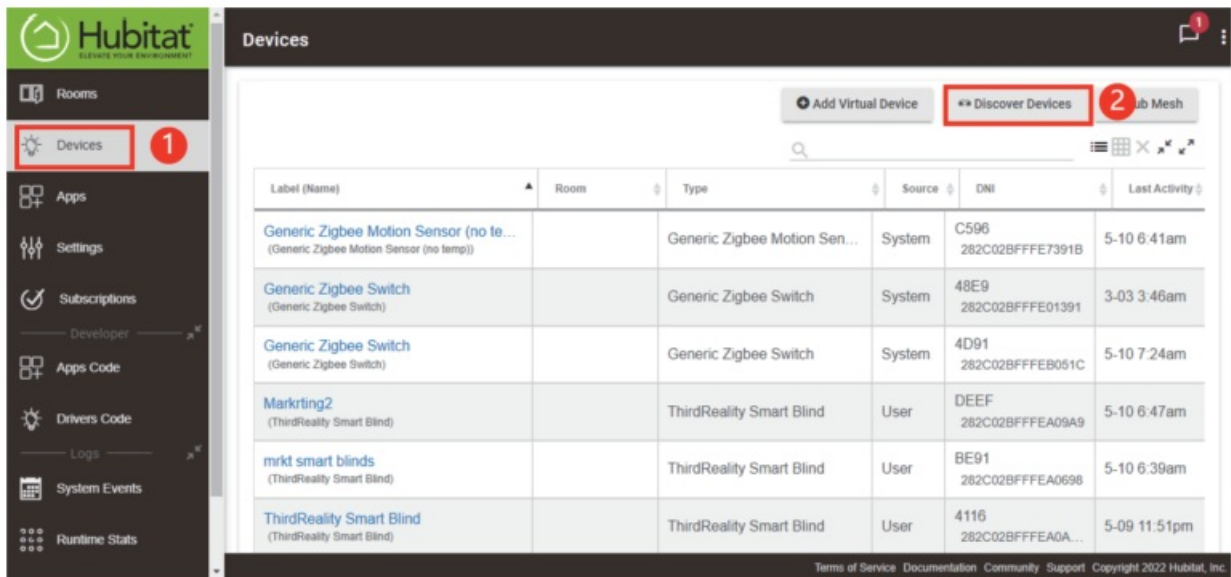

3. Click Start ZigBee Pairing button after you select a ZigBee device type, the Start ZigBee Pairing button will put the hub into ZigBee pairing mode for 60 seconds.

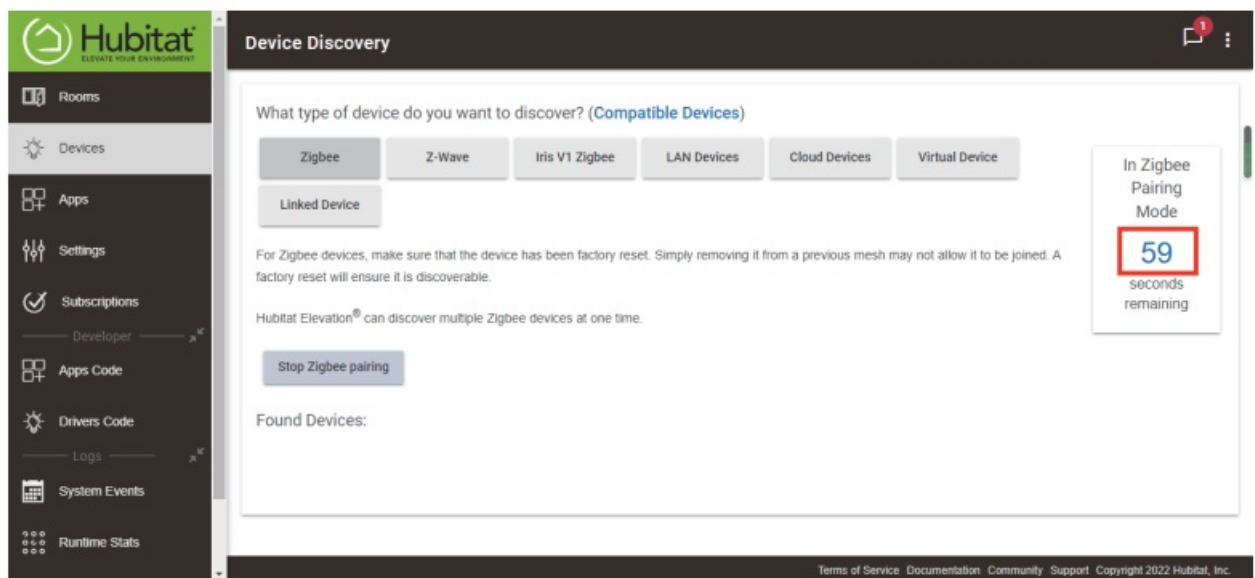
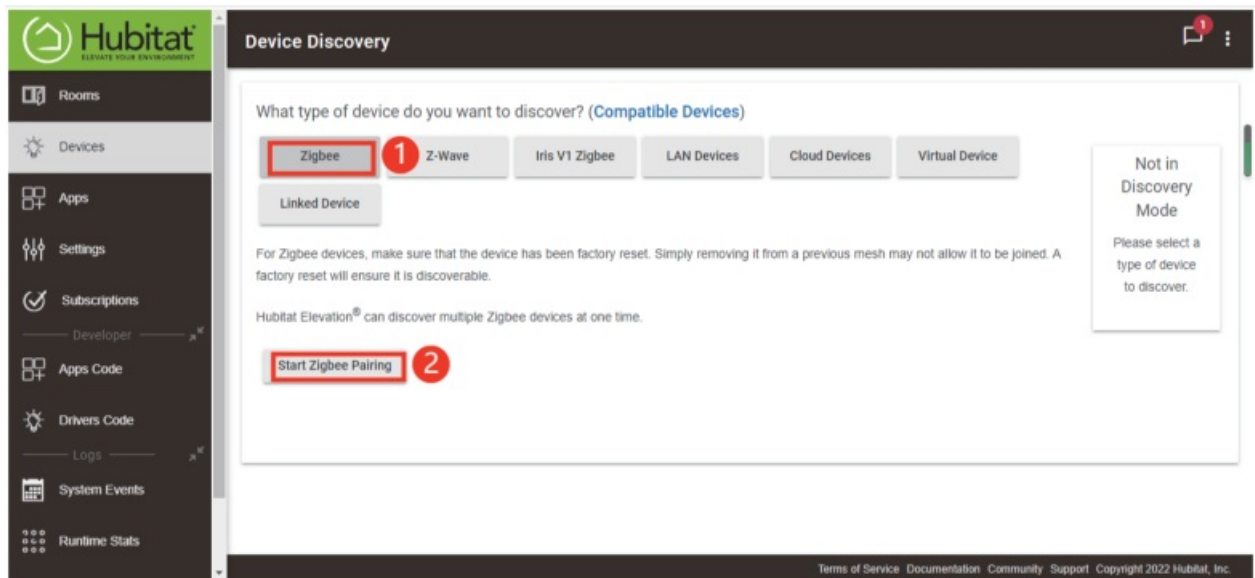

4. After being paired successfully, it will be showed on page as on page as “ThirdReality Smart Button”, you can rename it if needed, then tap “save”.

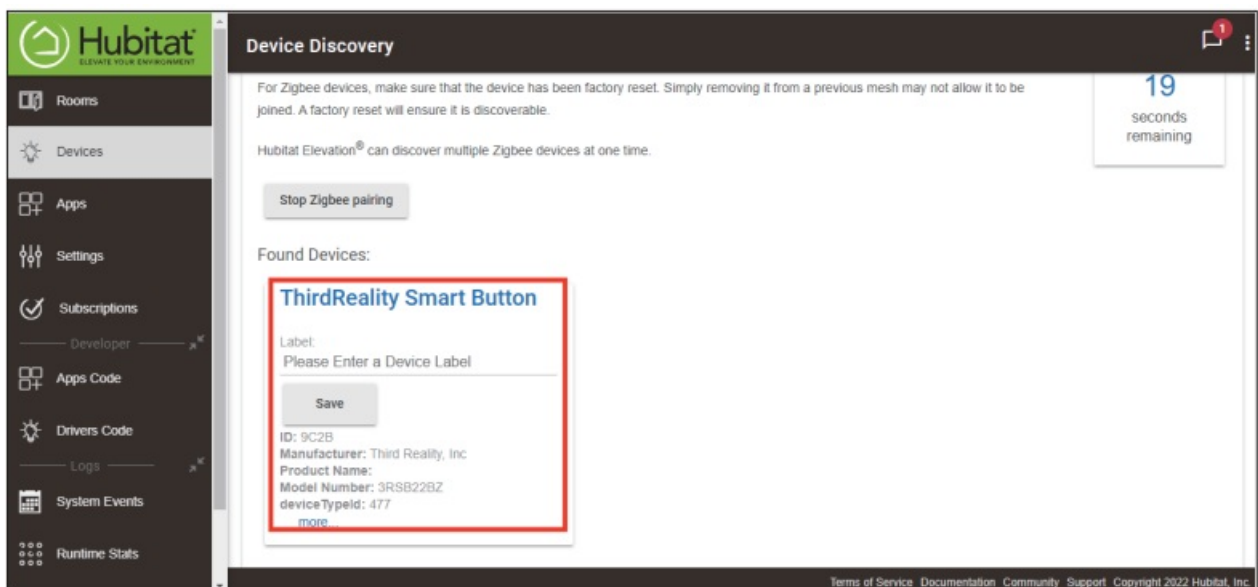

5. Now you can see the Smart Button on the Devices page.

Hubitat
ELEVATE YOUR ENVIRONMENT

Rooms

Devices

Apps

Settings

Subscriptions

Developer

Apps Code

Drivers Code

Logs

System Events

Runtime Stats

Devices

Markrtng2
(ThirdReality Smart Blind)

mrkt smart blinds
(ThirdReality Smart Blind)

ThirdReality Smart Blind
(ThirdReality Smart Blind)

ThirdReality Smart Button
(ThirdReality Smart Button)

ThirdReality Smart Button
(ThirdReality Smart Button)

ThirdReality Temp/Humidity Sensor
(ThirdReality Temp/Humidity Sensor)

Tuya Zigbee Scene Switch
(Tuya Zigbee Scene Switch)

ThirdReality Smart Blind

ThirdReality Smart Blind

ThirdReality Smart Blind

ThirdReality Smart Button

ThirdReality Smart Button

ThirdReality Temp/Humidity...

Generic Zigbee Switch

User

User

User

User

User

User

System

DEEF
282C02BFFFEA09A9

BE91
282C02BFFFEA0698

4116
282C02BFFFEA0A...

A7BA
A4C1384008C14681

9C2B
A4C13857F080A150

9B51
A4C13809CEF1D...

1904
282C02BFFFE900C0

5-10 6:47am

5-10 6:39am

5-09 11:51pm

4-24 3:40am

5-10 7:23am

3-28 1:51am

3-29 11:30pm

Showing 1 to 10 of 10 entries

Terms of Service

Documentation

Community

Support

Copyright 2022 Hubitat, Inc.

Pairing with Home Assistant through ZHA

Pairing steps:

1. Remove the battery cover of the Smart Button, remove the battery insulation sheet, the LED indicator flashes quickly in blue, indicating the Smart Button is in pairing mode.
2. Make sure Home Assistant Integrations ZigBee Home Automation Setup is ready, then go to "Configuration" page, click "integration".

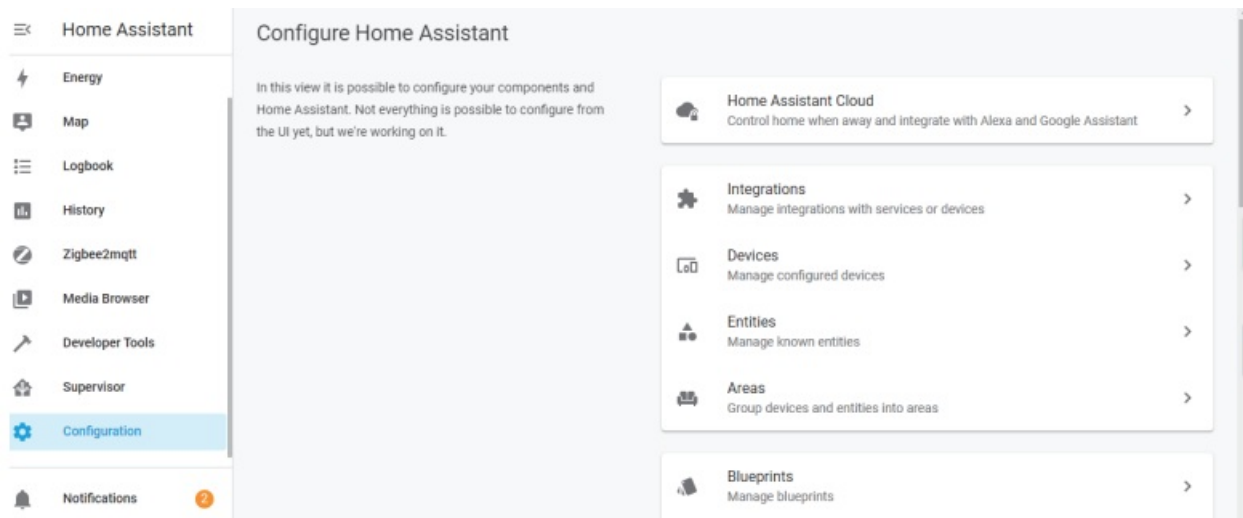

3. Then click the "Devices" on the ZigBee item, the click "Add Devices".

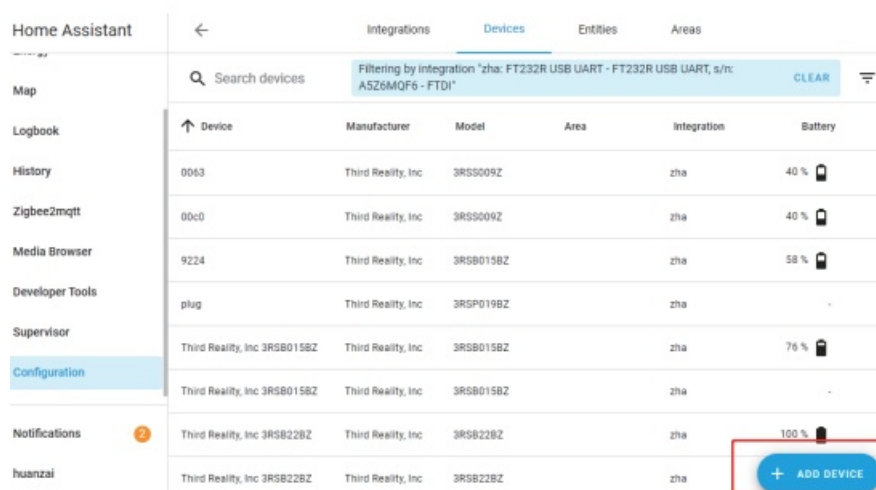
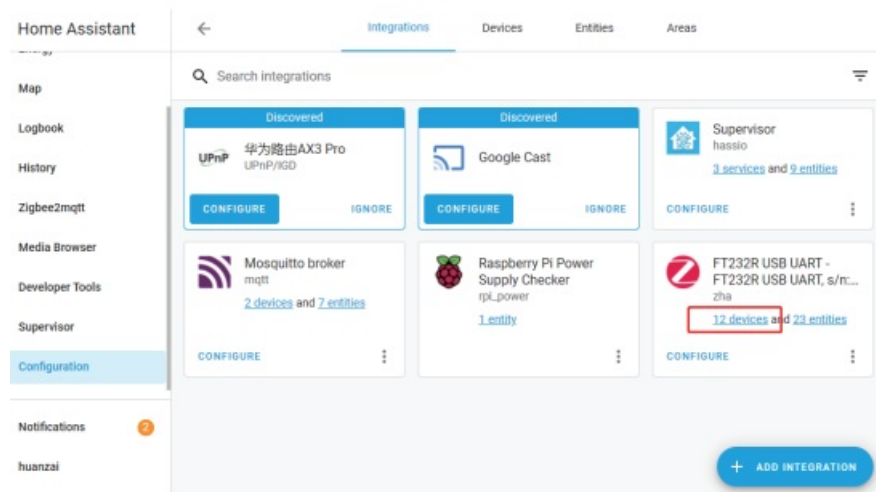

4. After the pairing is successful, it will show as “Third Reality, Inc 3RSB22BZ” on the page.

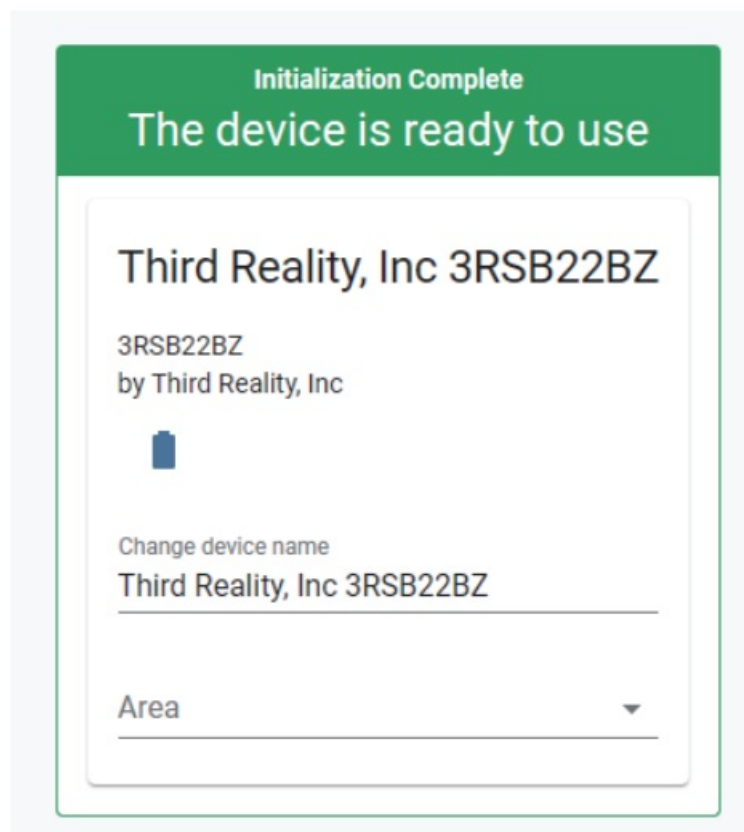

5. Back to “Devices” page, then you can find the Smart Button added before. Click to enter in the control interface to set the Smart Button.

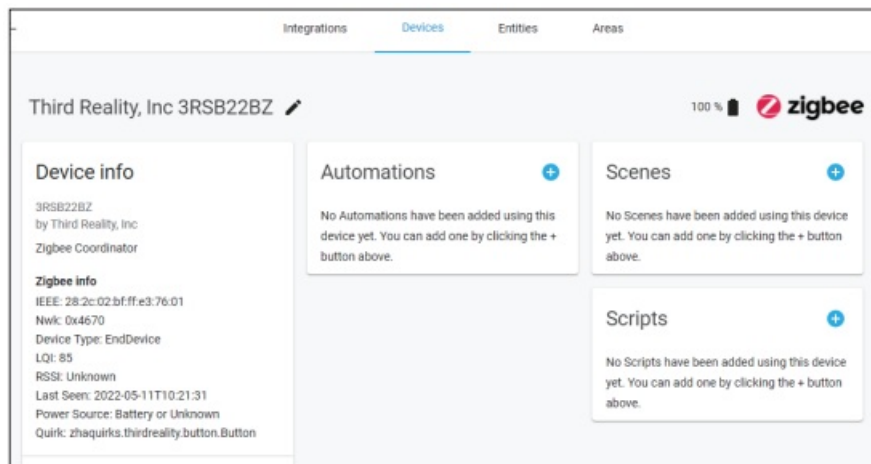

6. Click the “+” belongs to Automation and then you can add different actions to Third Reality Smart Button.

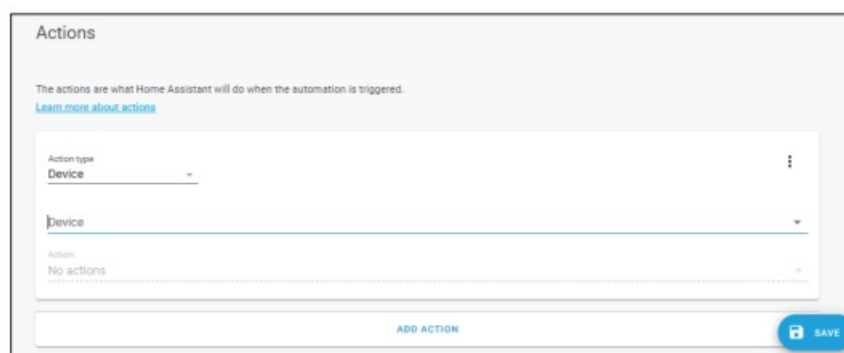
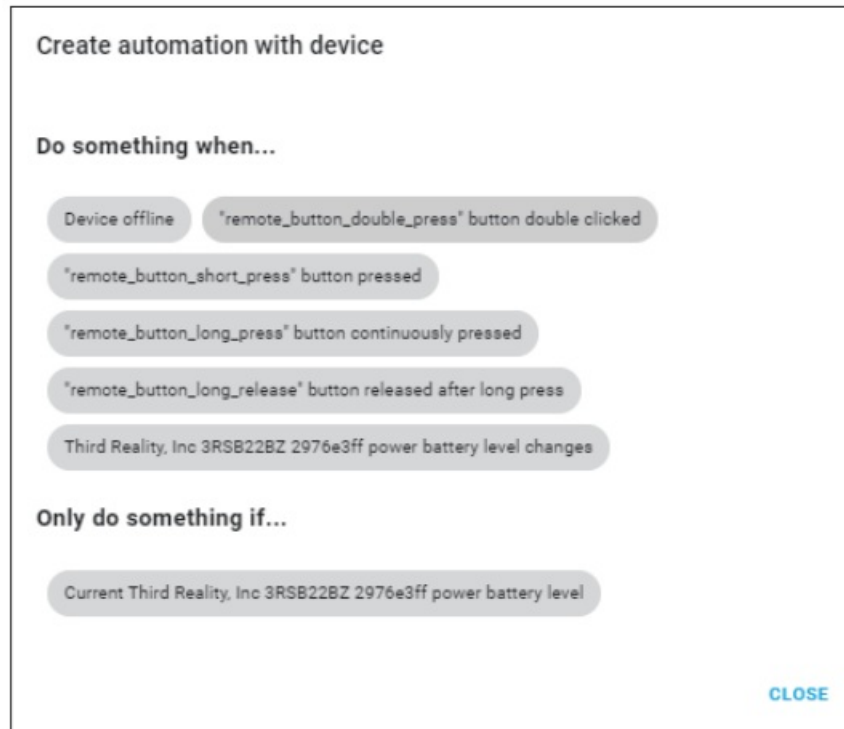

Pairing with Third Reality

ZigBee Hub Prepare: Third Reality Smart Hub App: Third Reality App



Pairing steps:

1. Remove the battery cover of the Smart Button, remove the battery insulation sheet, the LED indicator flashes quickly in blue, indicating the Smart Button is in pairing mode.
2. Open Third Reality App, go to device page, tap “+” belongs to the Hub, choose “Smart Button”, then click “Pair”.

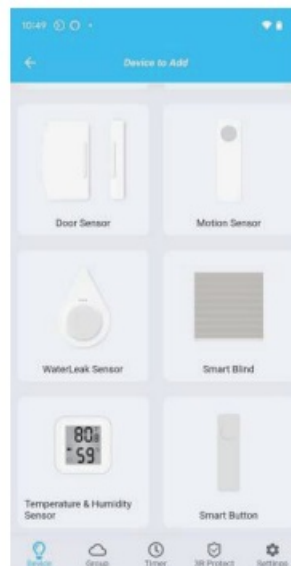

3. After the pairing is completed, tap “Complete”, then back to main interface

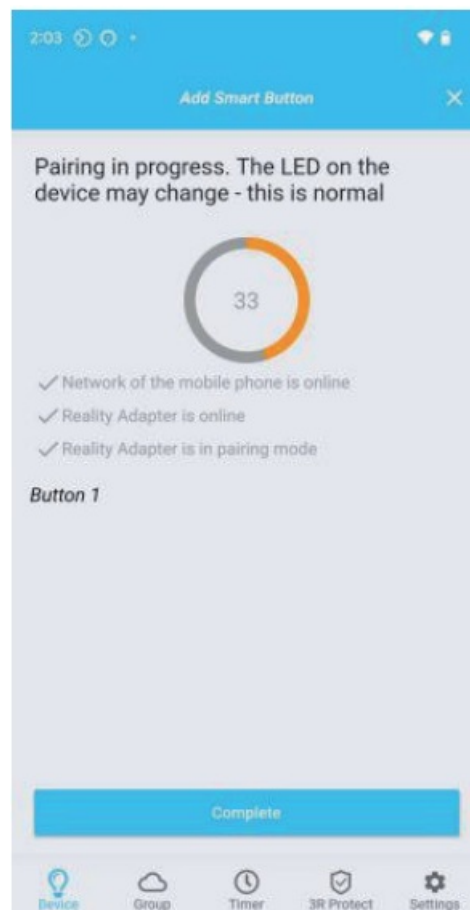

4. Tap “Smart Button” icon on device page, you can see the details, such as Battery, History Records etc. Then click Pressed / Double Pressed / Held, you can create different scenes.

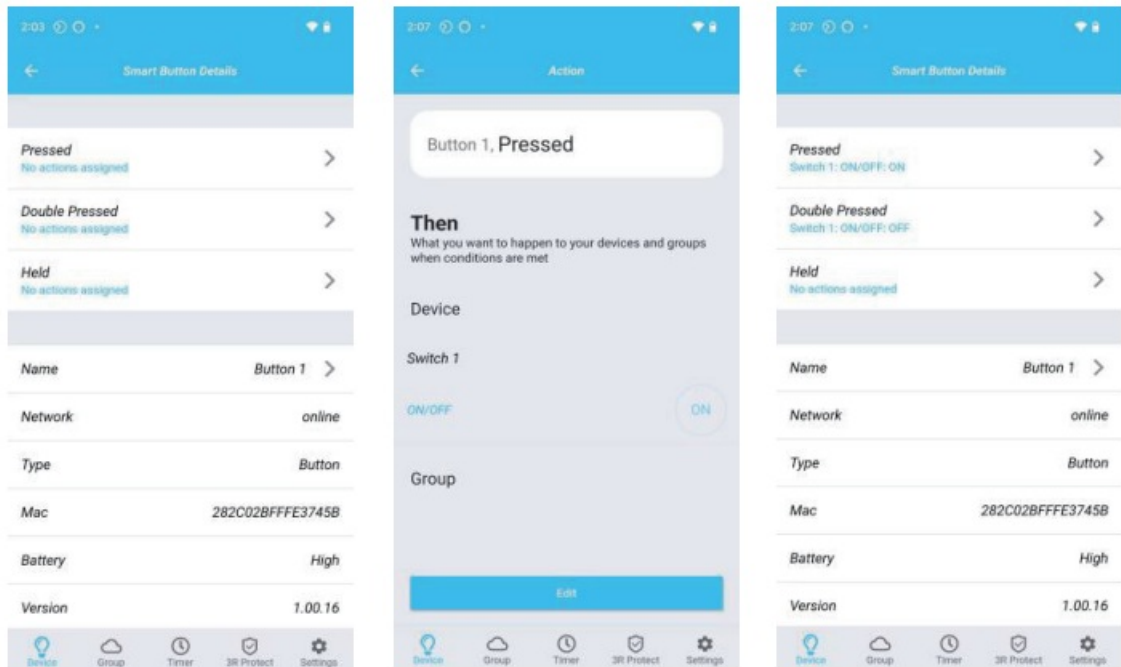

5. Or you can enable Third Reality SkillX to Alexa, follow the prompts and tap “DISCOVER DEVICES” in Alexa app, it will be recognized as 3 motion sensors as “Button 1 Click”, “Button 1 Double Click” and “Button 1 Long Click”, then you can create routines to control other devices with the Smart Button.

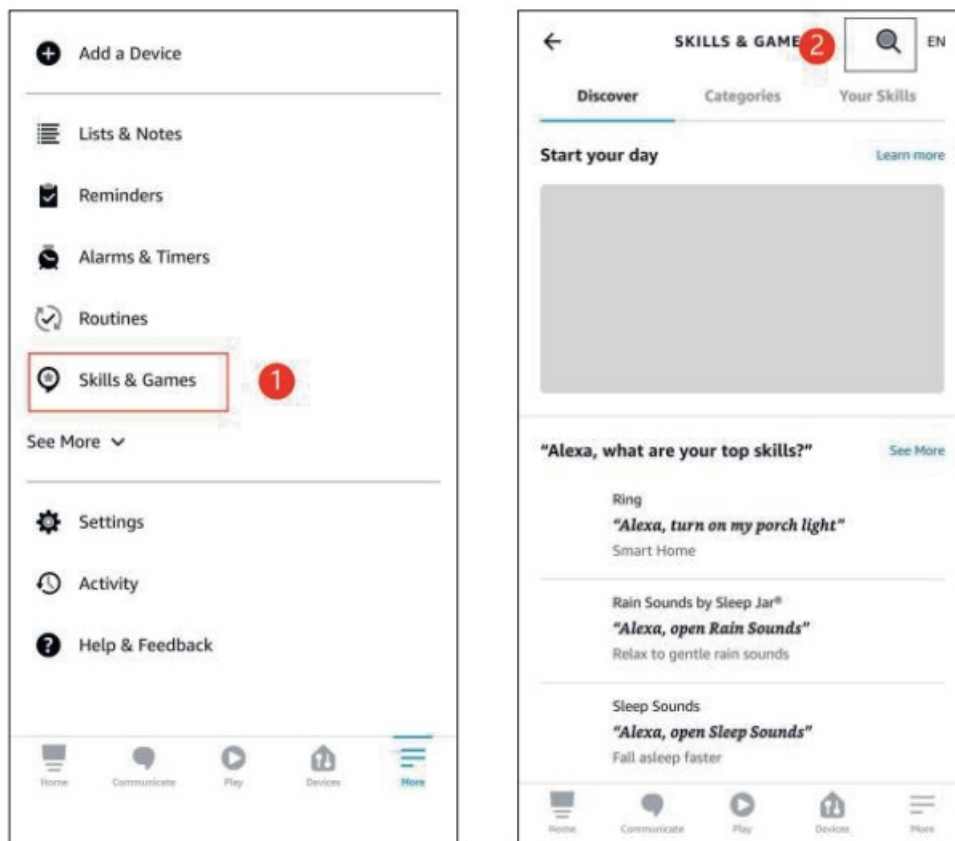

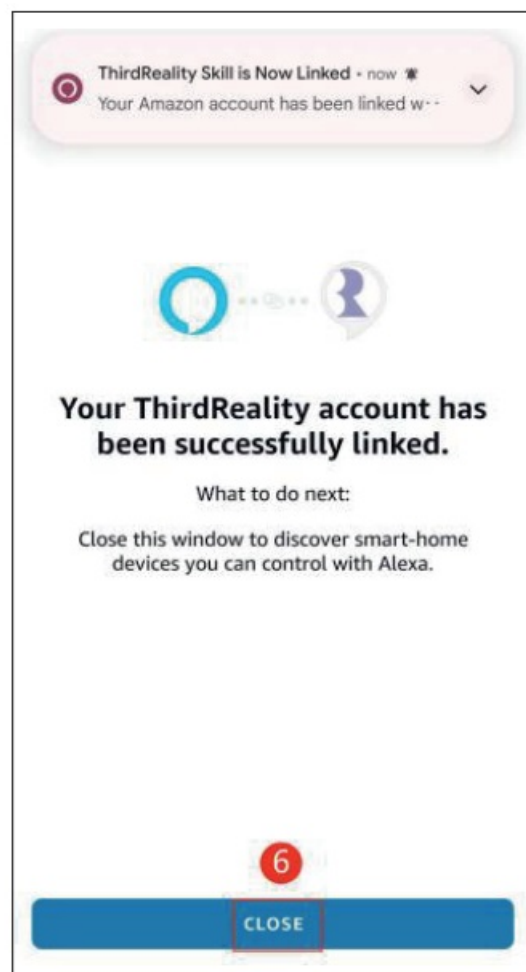
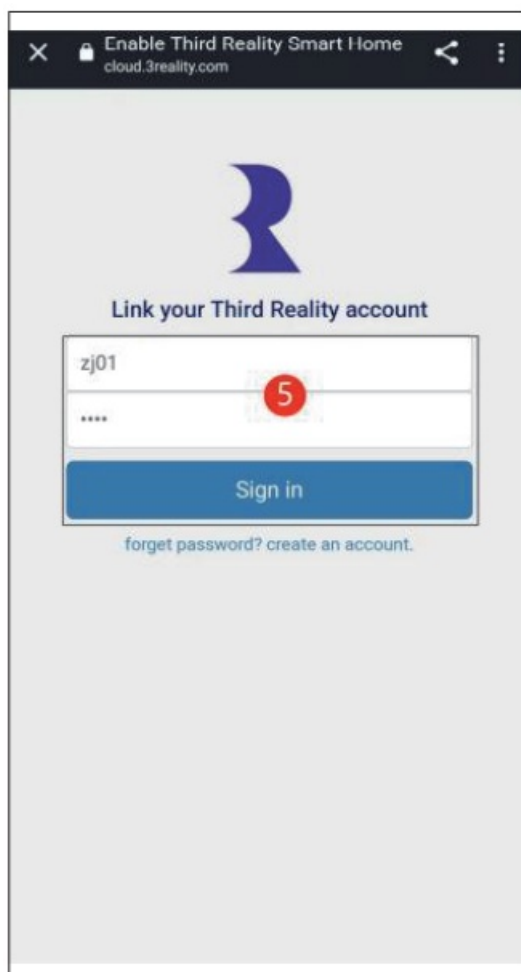
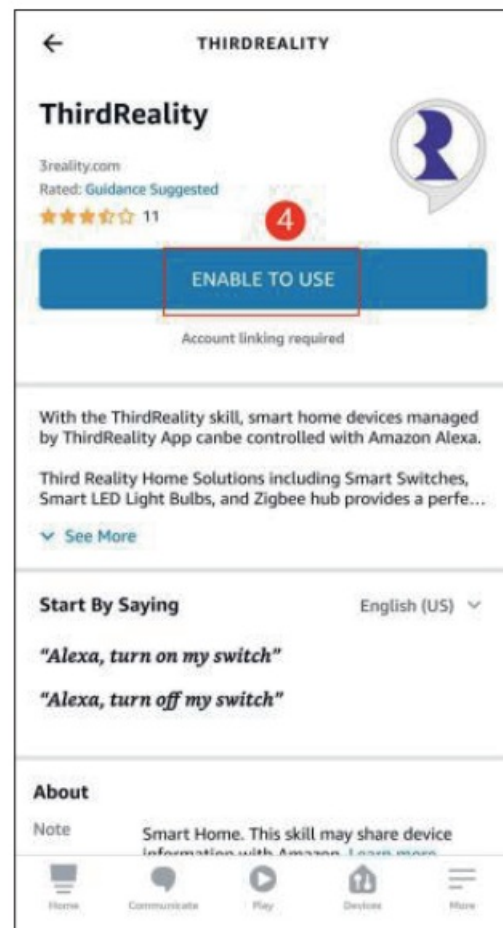
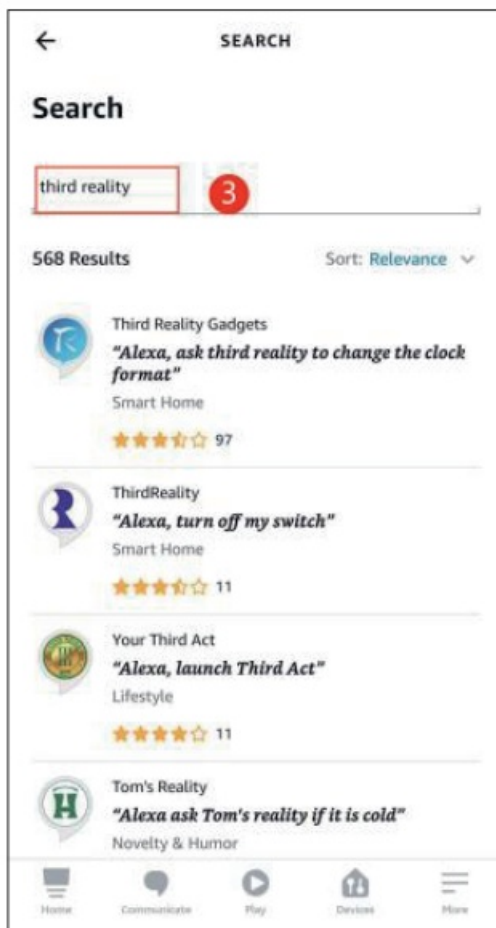

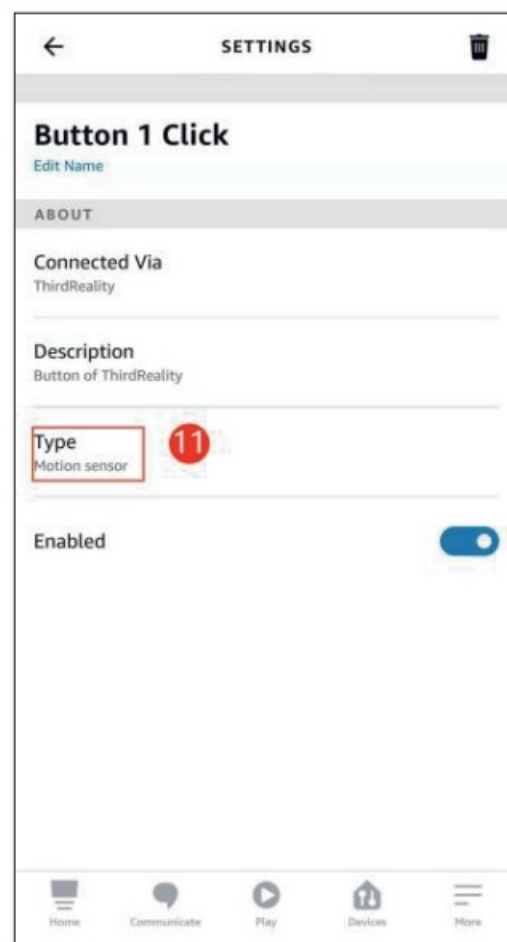
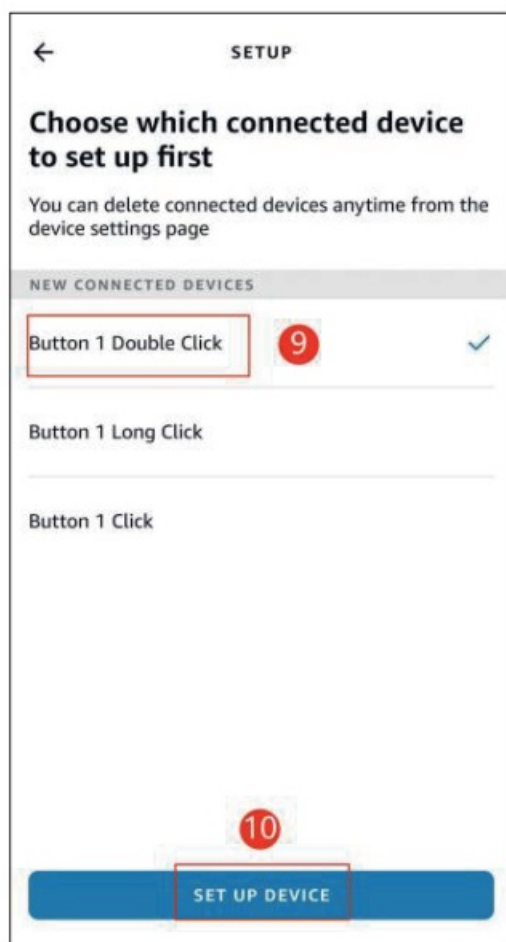
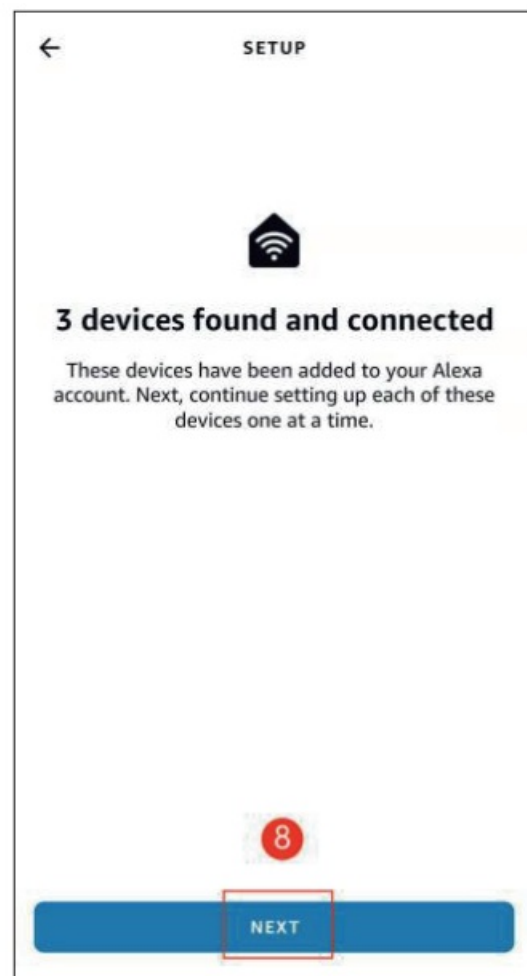
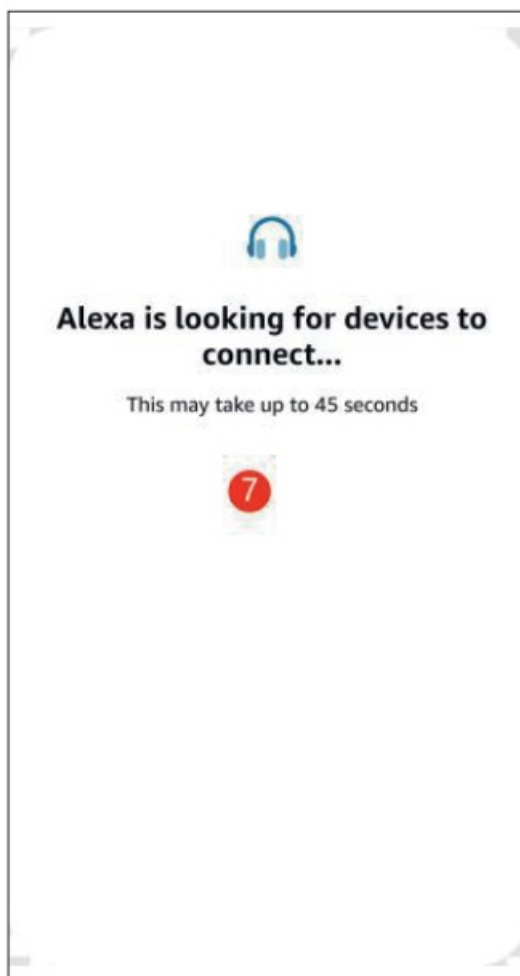

Pairing with Amazon Echo

App: Amazon Alexa App



Pairing with Echo devices with built-in ZigBee hubs such As Echo V4, Echo Plus V1 & V2, Echo Studio, Echo Show 10 Gen2 & Gen3 , and Eero 6 & 6 pro.

1. Ask Alexa to check for updates before pairing.
2. Remove the battery cover of the Smart Button, remove the battery insulation sheet and install the batteries, the LED indicator blinks quickly in blue. The Smart Button is in standard ZigBee pairing mode.
3. To switch mode between standard ZigBee mode and Echo ZigBee mode by pressing the reset button for 5 times within 5 seconds.
4. Ask Alexa to discover devices, or open Alexa App, go to device page, tap “+” on top right, choose “Add Device”, scroll down to the bottom and tap “other”, tap “DISCOVER DEVICES”, the Smart Button will be paired with your Echo device in a few seconds, it is recognized as a motion sensor.

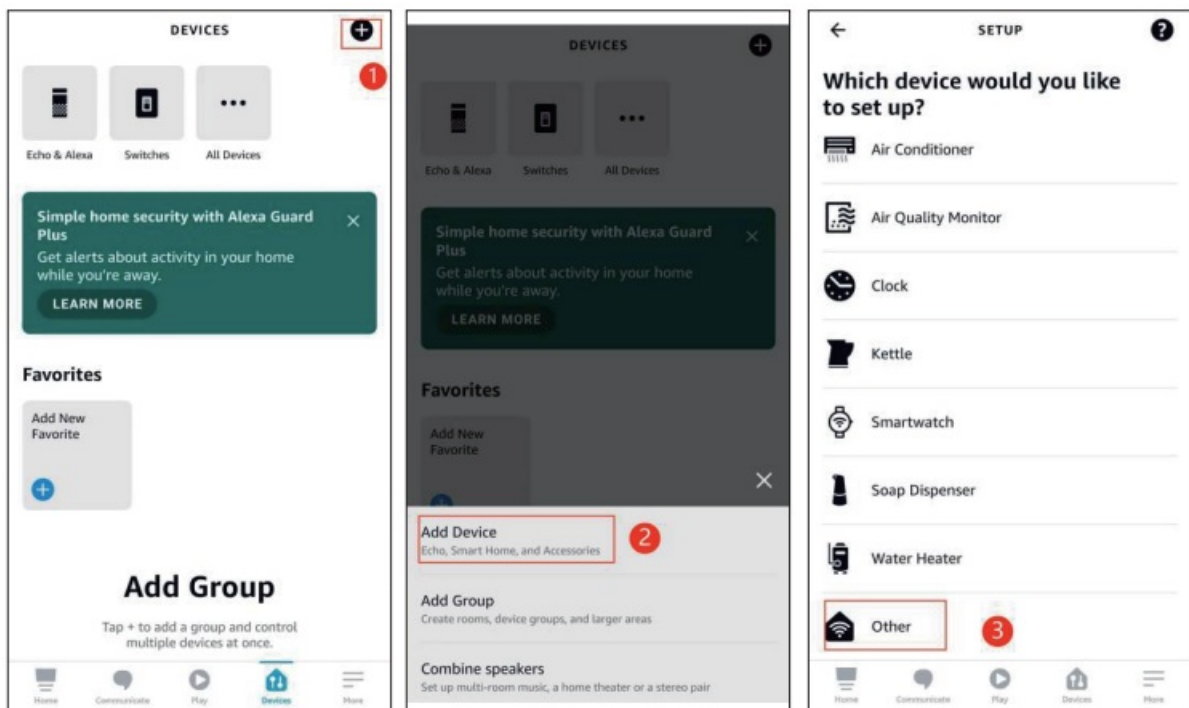

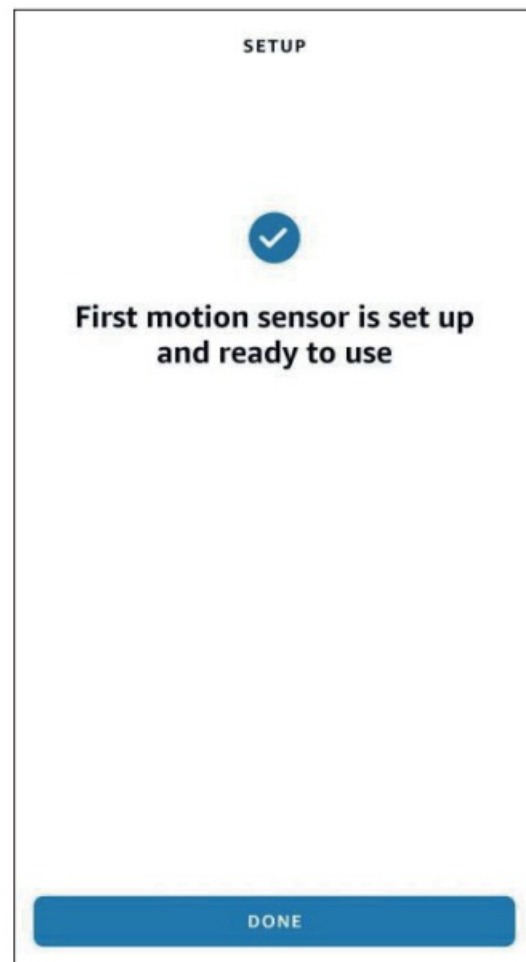
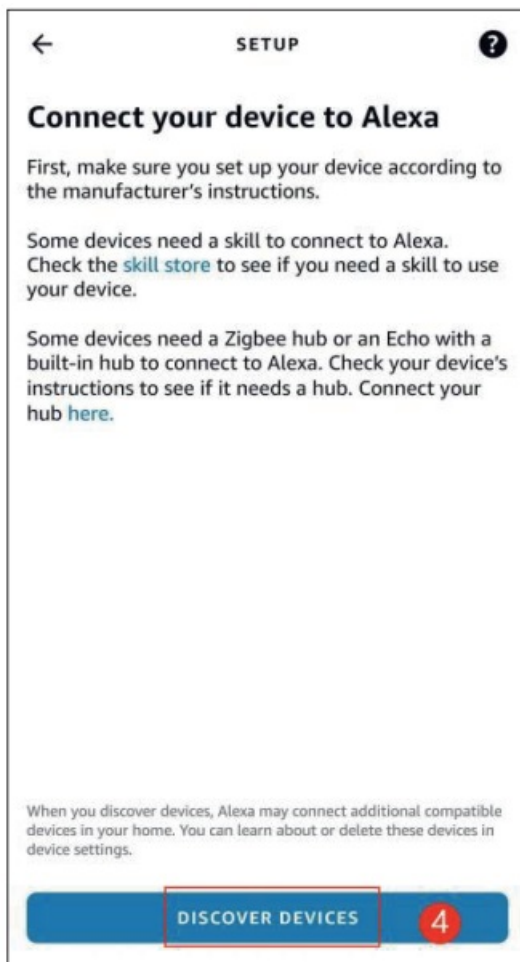

5. Tap “First Motion Sensor” in all devices list to open the Smart Button device page, you can create routines with it to control other devices.

* Please be aware of that since Alexa sees Smart Button as a motion sensor which has a cool down time of 30 sec-onds, in this case Smart Button can be triggered only once within 30 seconds.

* Please make sure you create 2 same routines for both “motion detected” and “motion not detected”, in order to avoid routine conflict.

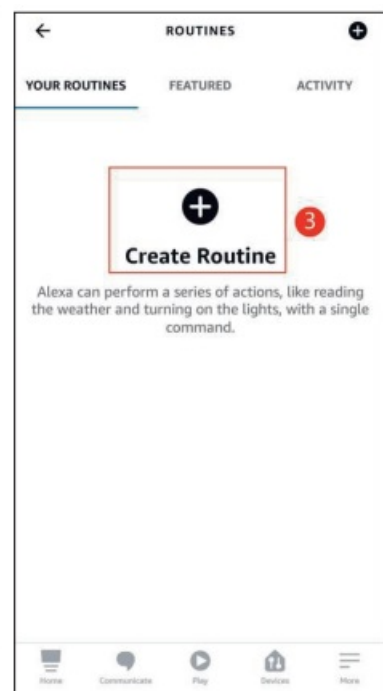
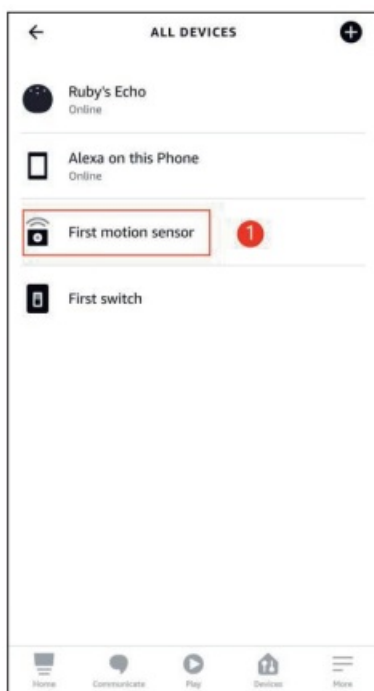

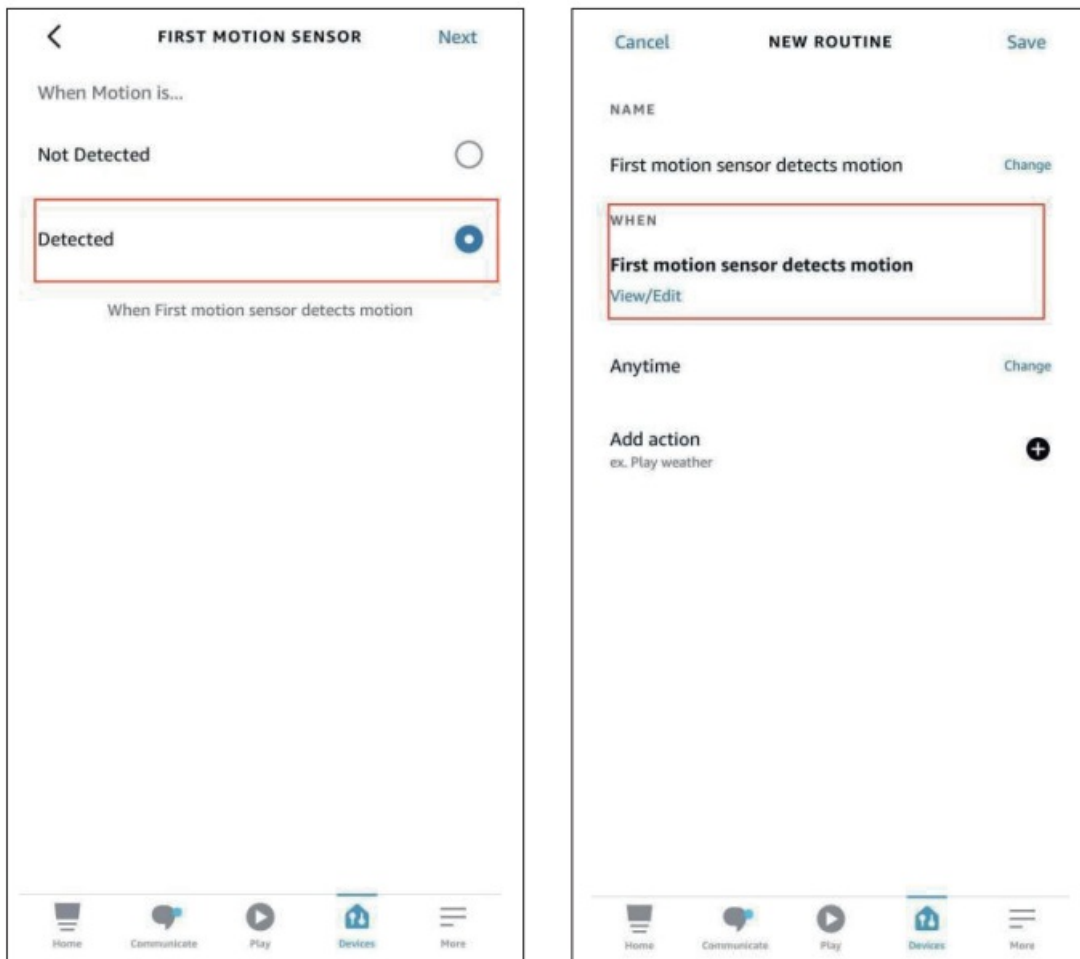

FAQ

1. How to factory reset the Smart Button?

Remove the back cover of the Smart Button, press and hold the reset button on the back for 3 seconds, the LED indicator will flash quickly, now it has been factory reset and is in pairing mode.

2. How to change between 2 ZigBee pairing modes?

To switch mode between standard ZigBee mode and Echo ZigBee mode by pressing the reset button for 5 times within 5 seconds. When the LED indicator blinks quickly in blue and red, it is in ZigBee pairing mode for Echo devices. When the LED indicator blinks quickly in blue, it is in ZigBee pairing mode for other ZigBee hubs like SmartThings Hub etc..

FCC regulatory conformance

This device complies with part 15 of the FCC rules. Operation is subject to the following two conditions: (1) this device may not cause harmful interference, and (2) this device must accept any interference received, including interference that may cause undesired operation.

Changes or modifications not expressly approved by the party responsible for compliance could void the user's authority to operate the equipment.

NOTE: This equipment has been tested and found to comply with the limits for a Class B digital device, pursuant to part 15 of the FCC Rules. These limits are designed to provide reasonable protection against harmful interference in a residential installation. This equipment generates and can radiate radio frequency energy and, if not installed and used in accordance with the instructions, may cause harmful interference to radio communications. However, there is no guarantee that interference will not occur in a particular installation. If this equipment does cause harmful interference to radio or television reception, which can be determined by turning

the equipment off and on, the user is encouraged to try to correct the interference by one or more of the following measures:

- Reorient or relocate the receiving antenna.
- Increase the separation between the equipment and receiver.
- Connect the equipment into an outlet on a circuit different from that to which the receiver is connected.
- Consult the dealer or an experienced radio/TV technician for help important announcement.

NOTE: The manufacturer is not responsible for any radio or TV interference caused by unauthorized modifications to this equipment. Such modifications could void the user's authority to operate the equipment.

RF Exposure

This equipment complies with FCC radiation exposure limits set forth for an uncontrolled environment. This transmitter must not be co-located or operating in conjunction with any other antenna or transmitter.

Limited Warranty

For limited warranty, please visit www.3reality.com/device-support
For customer support, please contact us at info@3reality.com or visit www.3reality.com
For help and troubleshooting related to Amazon Alexa, visit the Alexa app.

Documents / Resources

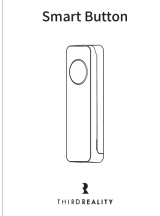
	<p>THIRDREALITY B09ZQGSYB Smart Button [pdf] Installation Guide 09ZQGSYBY, B0BTGXWXPR, B0BJDWR3BC, B09ZQGZX3G, B0BTYSWPC3, B0BJDVKRZL, B09ZQQX3HC, B0BJDY53RD, B09ZQGSYB, Smart Button, Button</p>
---	--

References

- [🌐 Quick Start Guide](#)
- [🌐 Smart Hardware | IOT platform | Third Reality, inc | China](#)
- [User Manual](#)