

THIRD REALITY
THIRD REALITY
Multi Function
Night Light



THIRD REALITY Multi Function Night Light User Guide

[Home](#) » [THIRD REALITY](#) » THIRD REALITY Multi Function Night Light User Guide 

Contents

- [1 THIRD REALITY Multi Function Night Light](#)
- [2 Product Overview](#)
- [3 What's In The Box](#)
- [4 Product Details](#)
- [5 Specification](#)
- [6 LED Status Table](#)
- [7 Setup](#)
- [8 Pairing with Third Reality](#)
- [9 Pairing With Amazon Echo](#)
- [10 Pairing With Hubitat](#)
- [11 Pairing With Home Assistant](#)
- [12 Pairing With SmartThings](#)
- [13 FCC regulatory conformance](#)
- [14 Limited Warranty](#)
- [15 Documents / Resources](#)
 - [15.1 References](#)

THIRD REALITY

THIRD REALITY Multi Function Night Light



Product Overview

Third Reality Zigbee Multi-Function Night Light – a compact and intelligent solution combines a motion sensor, a light sensor and color night light. With remote control via Zigbee commands, it offers versatile automation options for security, lighting, and ambiance. Experience convenience and innovation in one device.

Note: The level of illuminance value is defined with reference to the lux value, not exactly the same.

What's In The Box

- Multi-Function Night Light × 1
- Power Adapter × 1
- Quick Start Guide × 1

Product Details

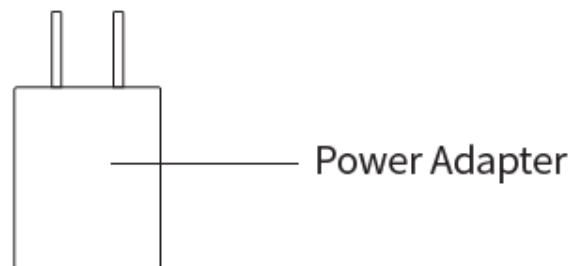
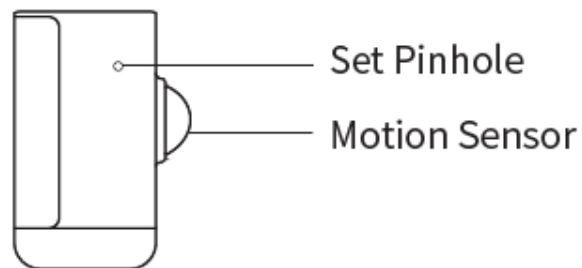
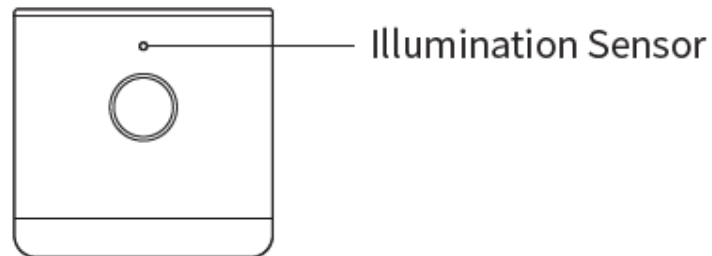
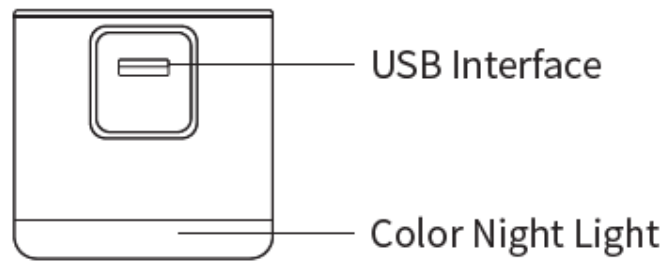

Specification

Dimension	2.6 x 1.6 x 2.5 inches
Color	White
Input	DC 5V 0.5A
Material	Plastic

LED Status Table

A: BOOTUP LED Status

LED	Color Scheme	Comments
First Blink	Green is Local Routine Enabled Red is Local Routine Disabled	Short press the pin hole will change the Local Routine Setup Status
Second Blink	Yellow is not paired Warm White is paired	Long press the pin hole will reset the pairing status
Status Check	Not Paired: On ≤ 5 s is illumination $> \text{min}$ On > 5 s is illumination $\leq \text{min}$	<p>Illumination $> \text{min}$ means environment is light need to turn off automatically</p> <p>Illumination $\leq \text{min}$ means environment is dark need to keep on and then</p>
	Paired: check report Status (First paired – Default blue on and dim 2 times)	If paired then go to RUNTIME status

B: Connect/Disconnect LED Status

LED	Color Scheme	Comments
Two Times	If LED is ON, dim two times (previous color) is indicate from disconnect to connect If LED is Off, No Indication	The device will automatically Try reconnect
Three Times	If LED is ON, dim three times (previous color) is indicate from connect to disconnect If LED is Off, No Indication	Long time has not been reconnected Try restarting your device or Hub

Setup

1. Plug the night light into a power outlet using a USB-A power adaptor, it initially lights up green and turns yellow, indicating it is in pairing mode.
 Note: It will exit pairing mode automatically if not successfully paired within 3 minutes, to put it into pairing mode again, press and hold the reset button through the pinhole for 5 seconds until it turns red, then release, the device will be reset and re-enter pairing mode.)
2. Install the Zigbee hub & app on your device and log in, make sure the firmwares are up to date, and follow the instructions to set up the device.
3. Once the pairing is successfully completed, the night light dims in blue twice then turns solid blue. You can change its brightness and color in the app.
4. The motion sensor, illumination sensor, and color light of the multi-function night light will report their status information as individual sub-devices, facilitating the configuration of various routines and home automation tasks. Once the pairing is successfully completed, the night light dims in blue twice then turn solid blue. You can

change its brightness and color in the app. Depending on the hub being used this may vary, check “pairing with different hubs” in detailed instructions.

Local Routine

The product supports local routines where the light will turn on when both the illumination sensor and motion sensor meet the specified conditions When the light is dim and detects human motion .

Short press the reset button through the pinhole to enable or disable the local routine function. Pressing the button once and seeing a green light indicates that the feature is currently enabled. Pressing the button again and seeing a red light indicates that the routine is disabled.

In both enabled and disabled states, motion sensor, illumination sensor, and color light will be reported synchronously.

Note that if you turn your Multi-Function Night Light on or off using your app or voice, Local Routine will be disabled for 12 hours.

Pairing with Different Hubs

Before pairing, use a pin to press into the pinhole and hold for 5 seconds until the LED turns red, then release to set the Multi-Function Night Light into pairing mode; Make sure the your hub’s firmware and phone apps are up to date.

Pairing with Third Reality

Hub: Third Reality Hub Gen2 Plus

App: Third Reality

Pairing steps

1. Tap “+” in Third Reality App, follow the on-screen instructions to add Smart Hub Gen2 Plus.

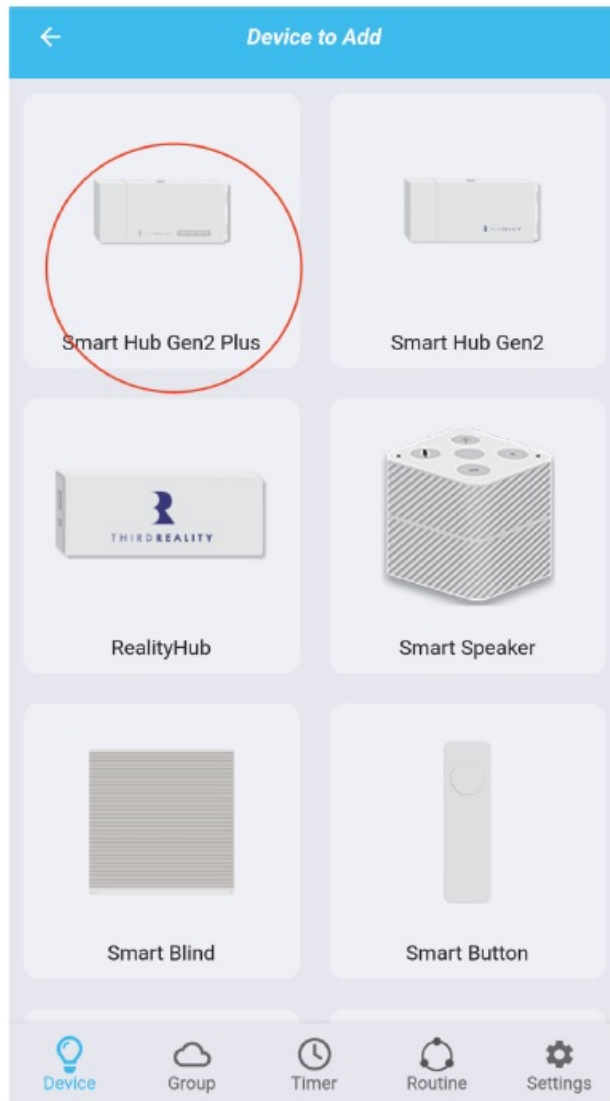

2. Tap "+" in the right of Smart Hub Gen2 Plus to add device, it will be added within seconds.

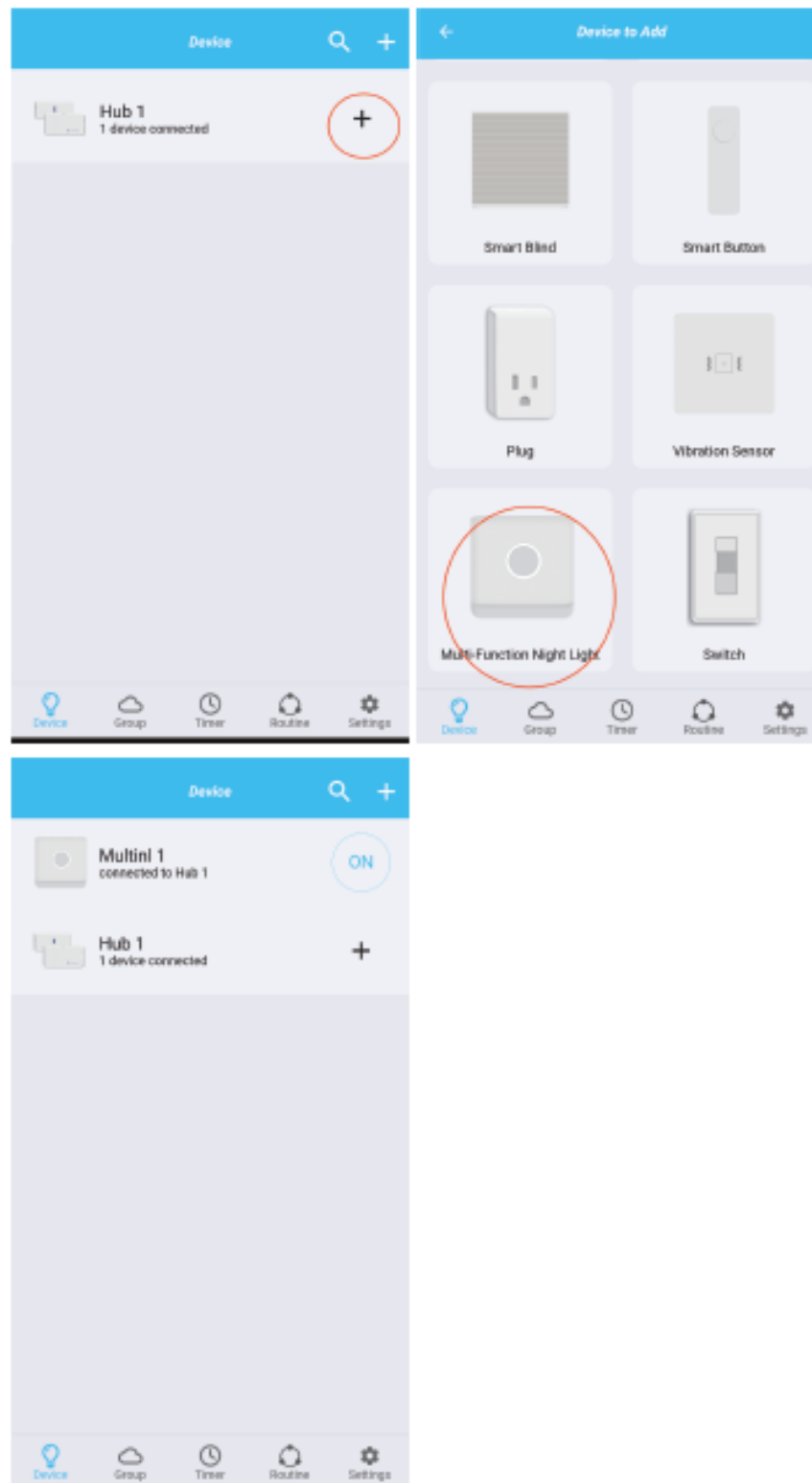

3. Create routines to use the motion sensor of the Multi-Function Night Light to control other connected devices.

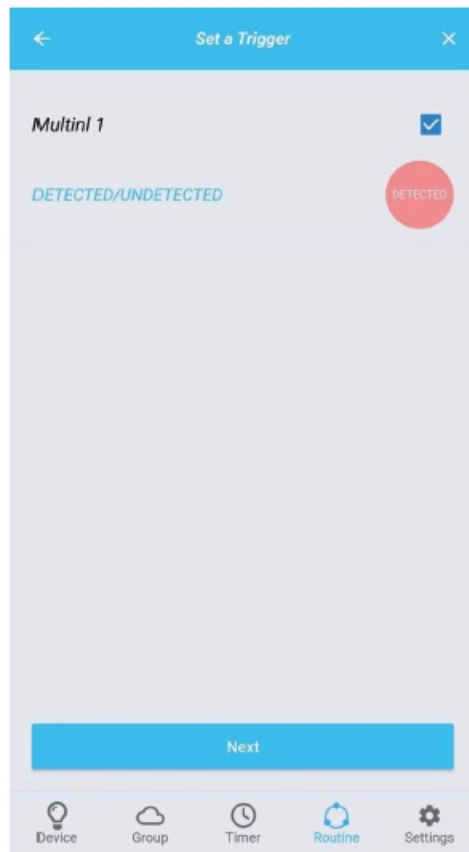

Pairing With Amazon Echo

Hub: Echo speakers with built-in Zigbee hub, Echo 4th Gen, Echo Plus 1st & 2nd Gen, Echo Studio

App: Amazon Alexa

Pairing steps

1. Tab “+” in the Alexa App, choose “Zigbee” and “others” to add device, the Multi-Function Night Light will be added as the “First Light”.
2. You can create routines with the “First Light”.

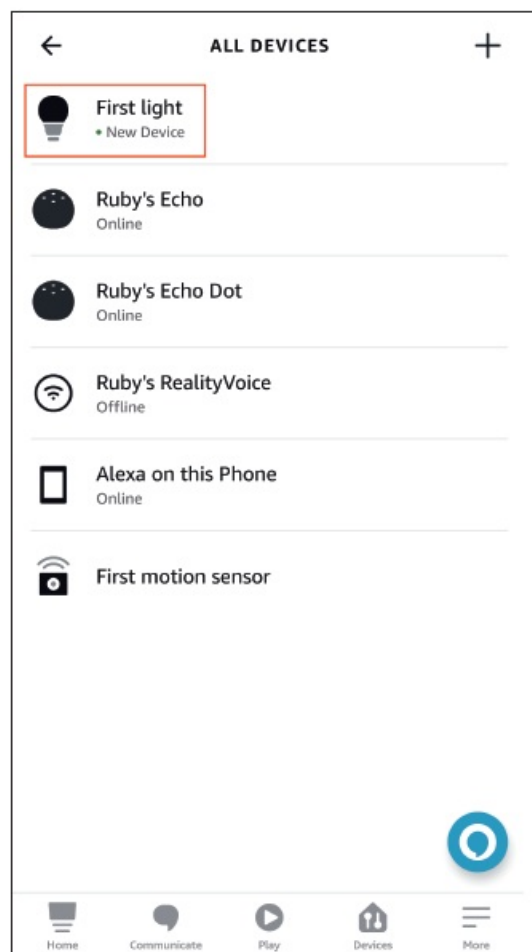
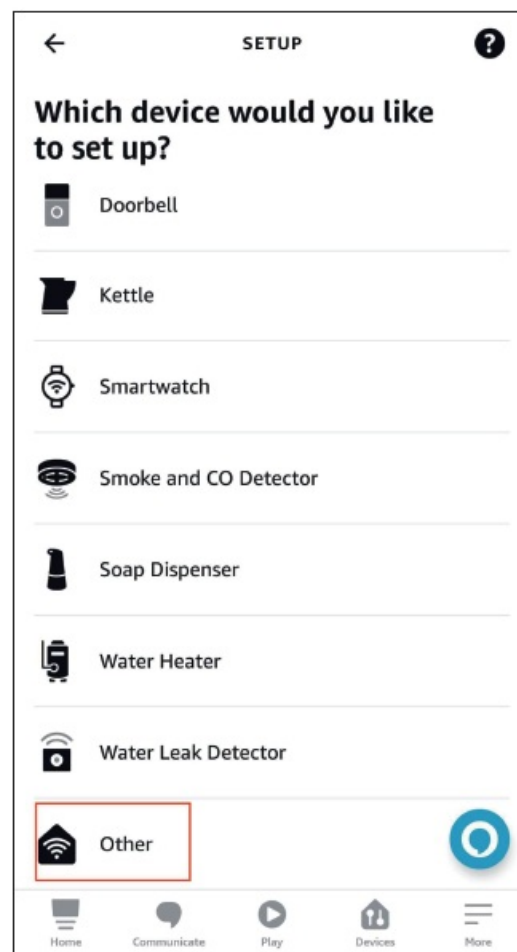
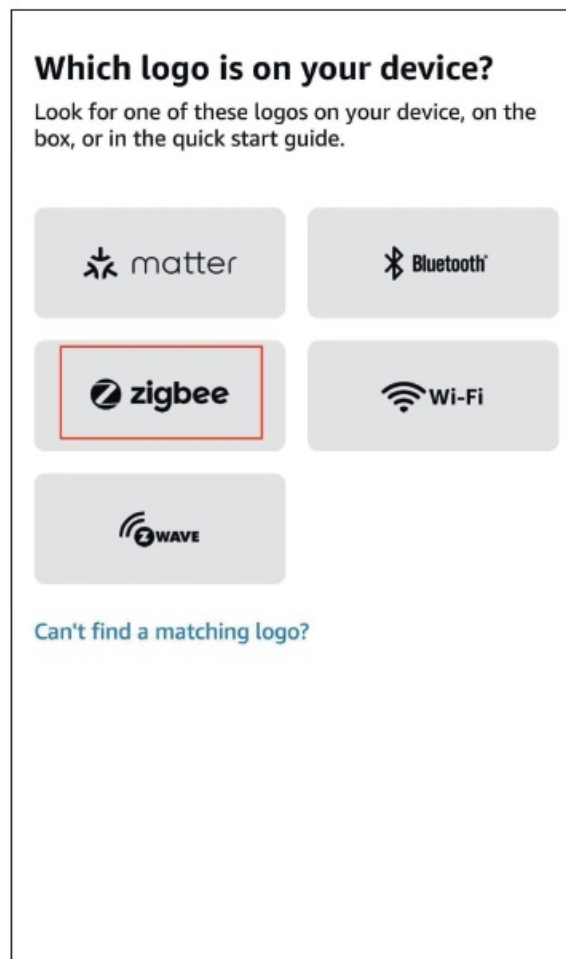
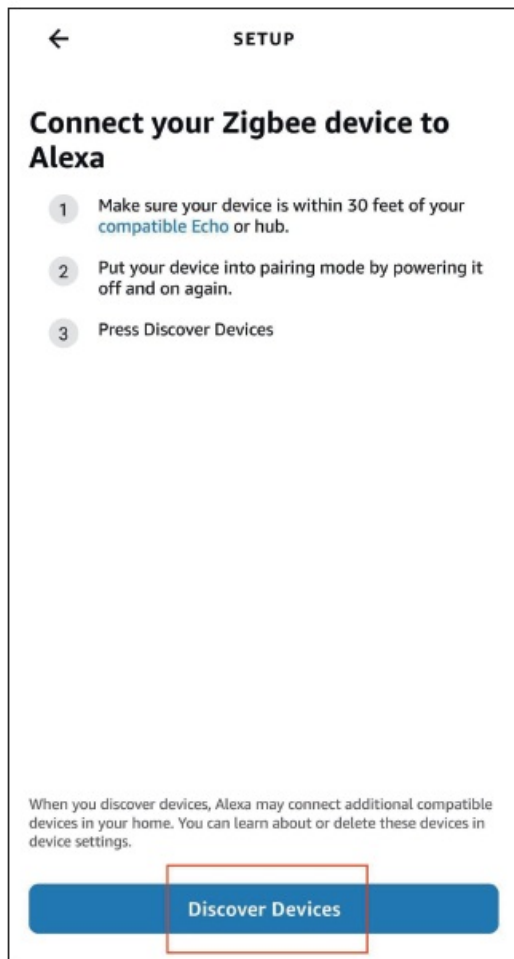

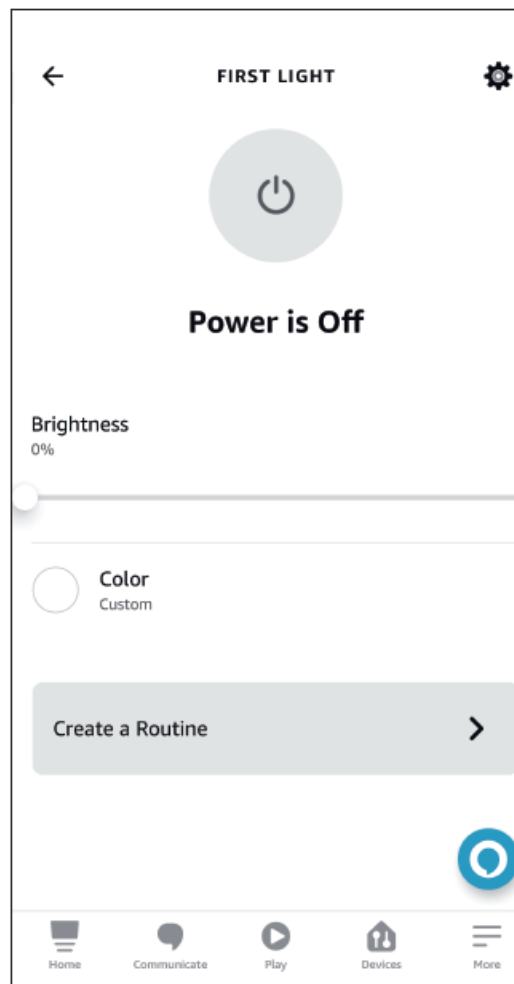

Pairing With Hubitat

Website: <http://find.hubitat.com/>

Pairing steps:

1. Tab “Add Device” in Hubitat Devices page.

Label (Name)	Room	Type	Source	Last Activity
123 (Device)	huan	Generic ZigBee RGB Light	System	6-26 4:25pm
3792 (Third Reality Smart Button)		Third Reality Smart Button	System	6-01 4:08pm
4cac (Generic Zigbee Switch)	JY	Generic Zigbee Switch	System	6-21 4:34pm
5370 LIGHT (Device)	JY	Generic ZigBee RGBW Light	System	6-26 3:49pm
5410LIGHT (Device)	JY	Advanced Zigbee RGBW Bulb	System	6-27 8:59am
706zigbee (Advanced Zigbee RGBW Bulb)	706	Advanced Zigbee RGBW Bulb	System	6-06 3:35pm

2. Choose “Zigbee”, then “Start Zigbee Pairing”.

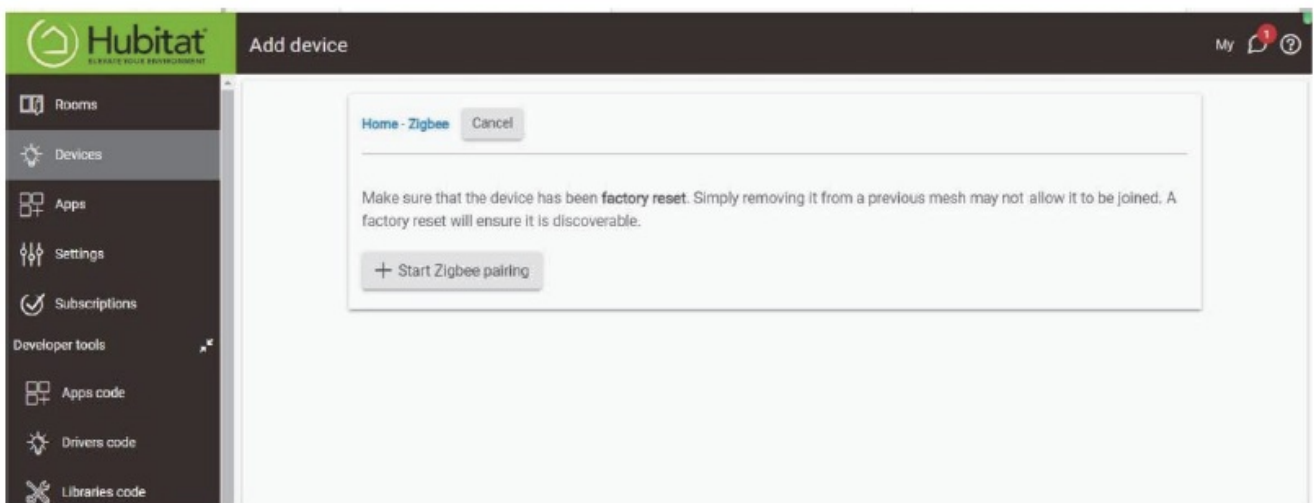
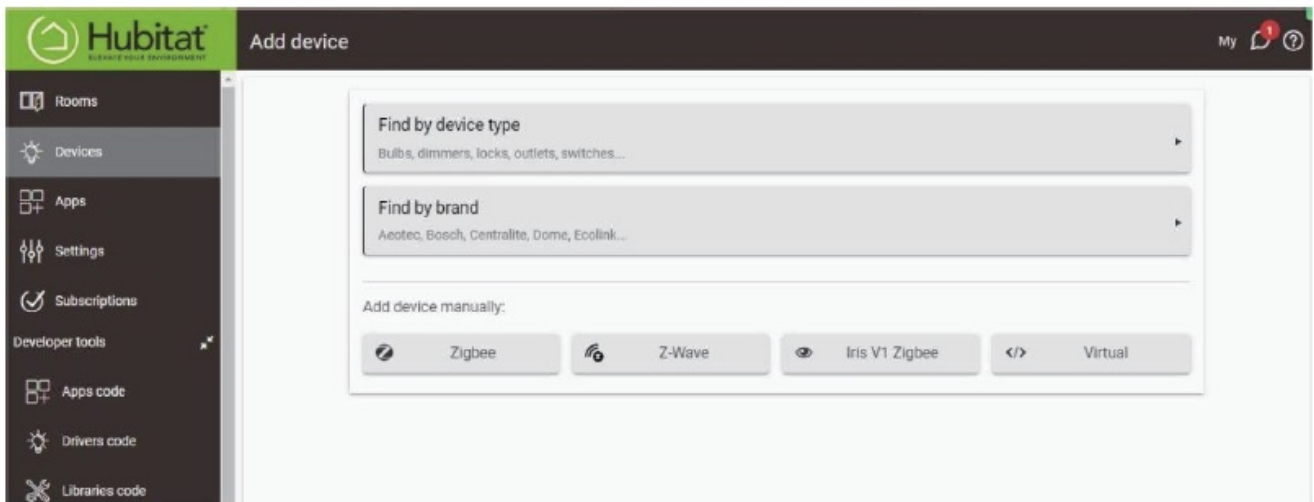

3. Type in a device and room name and click “Next” to complete pairing.

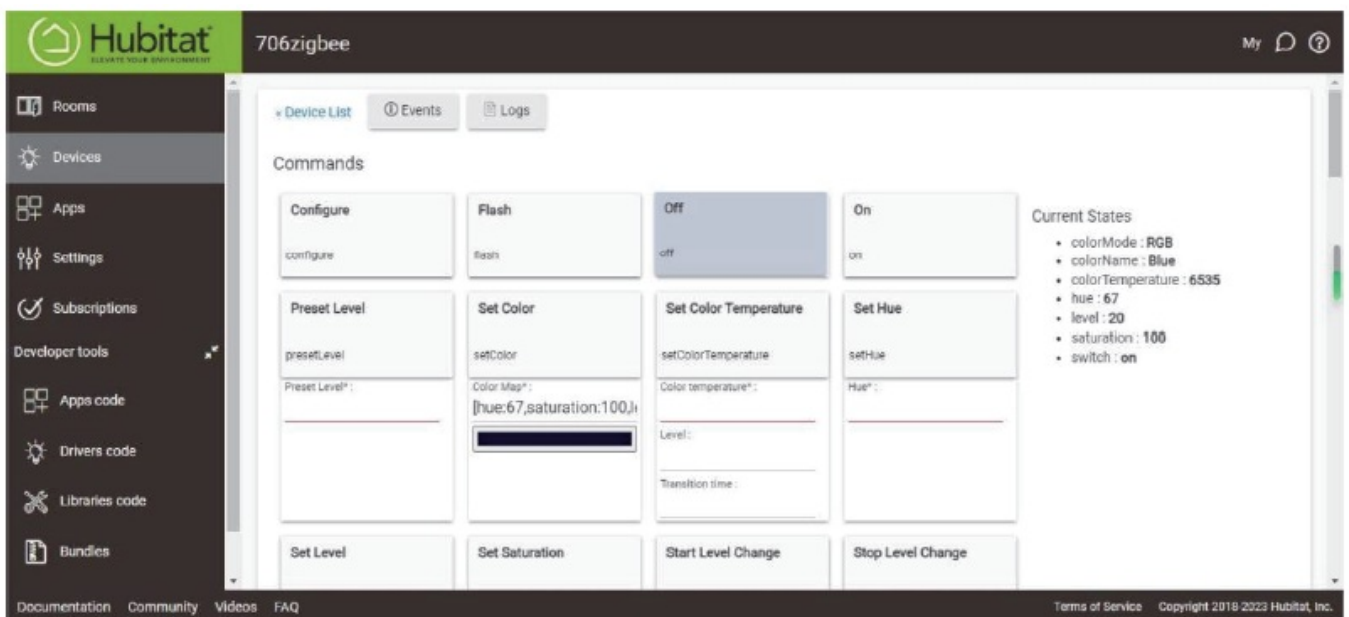

Pairing With Home Assistant

Pairing steps

Zigbee Home Automation(ZHA)

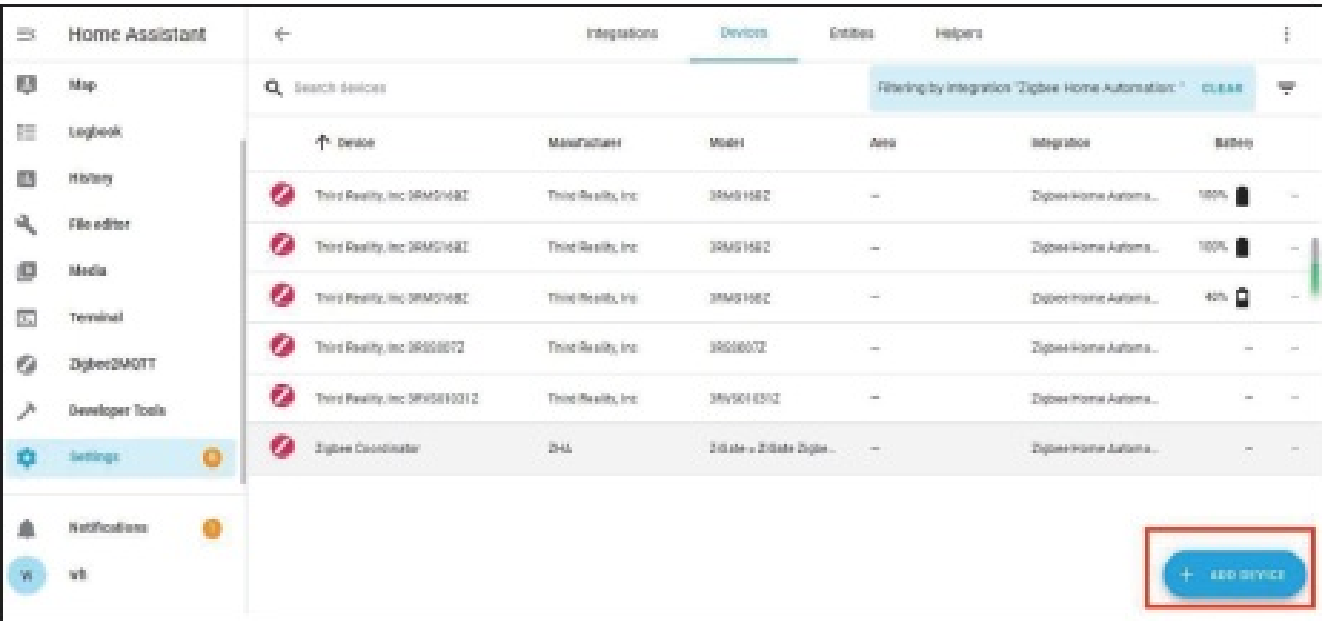
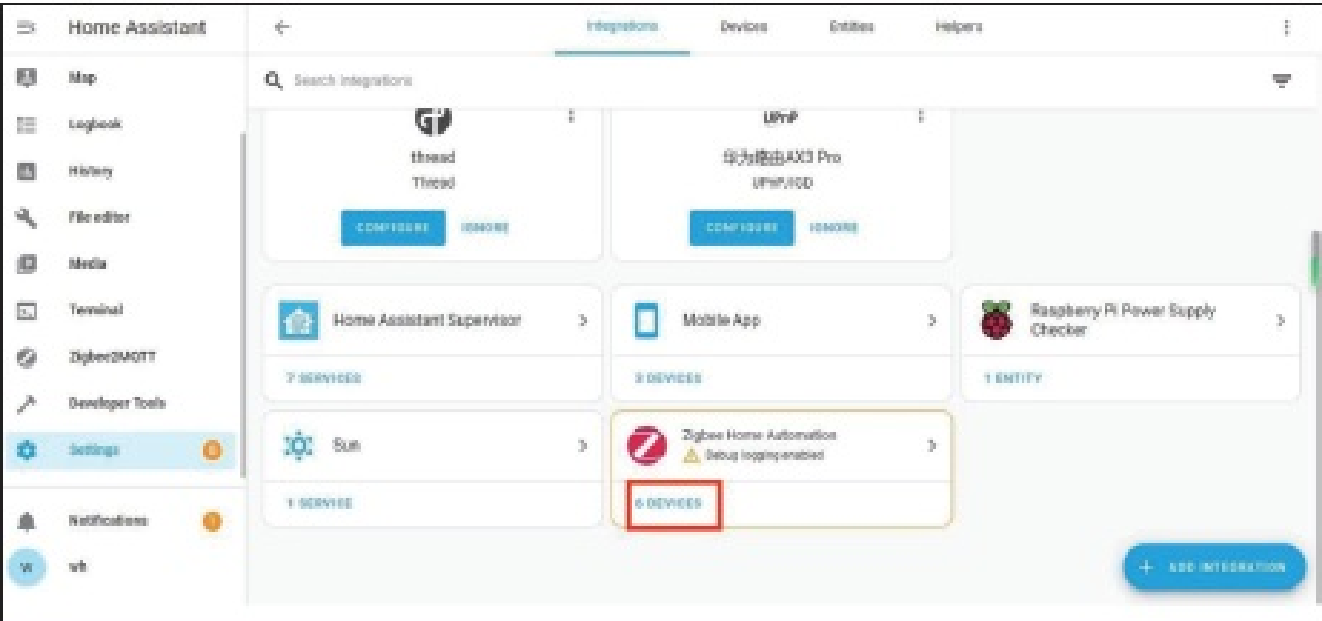
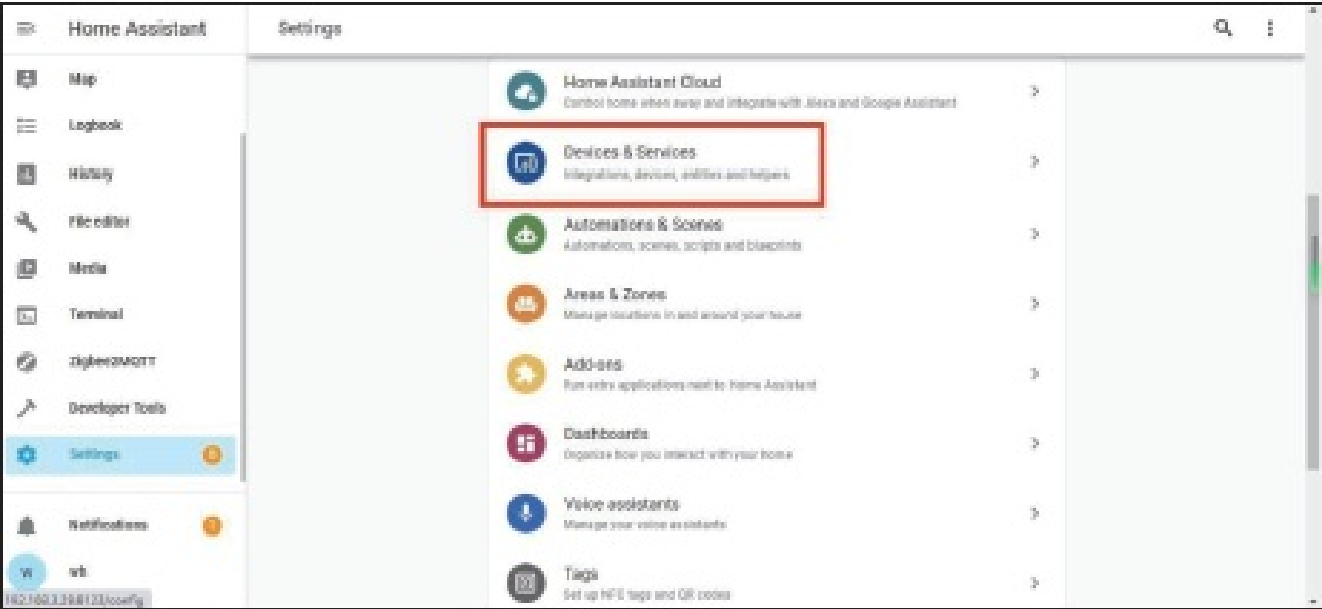

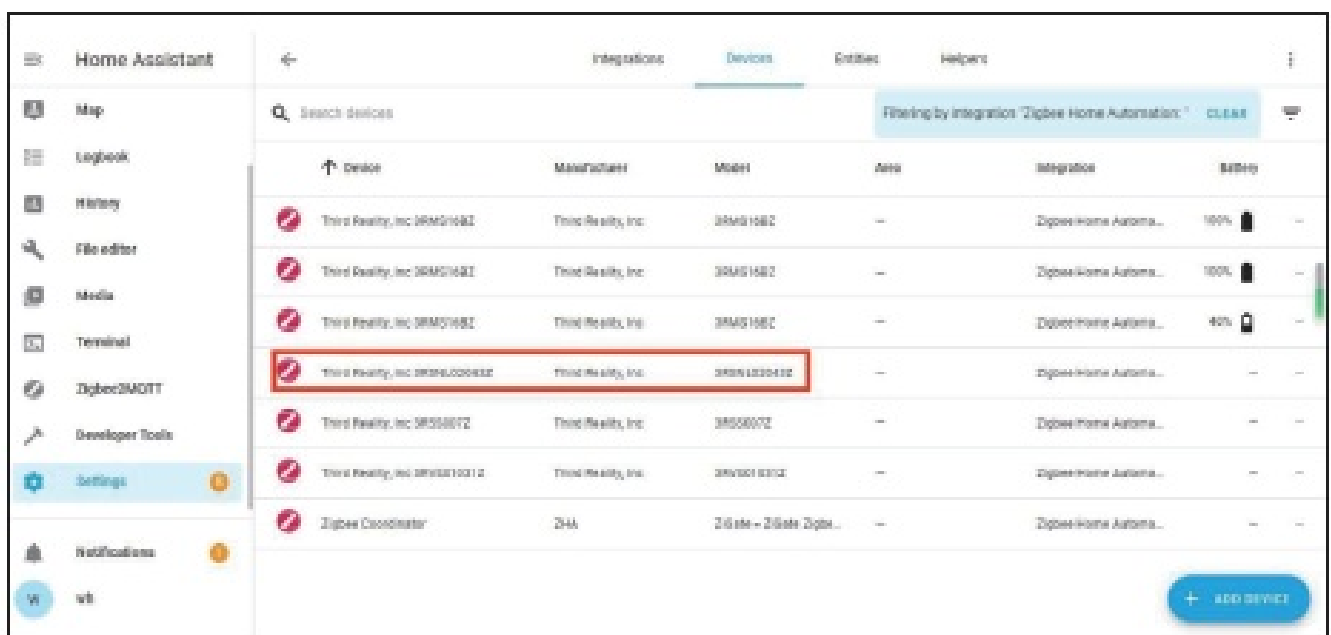
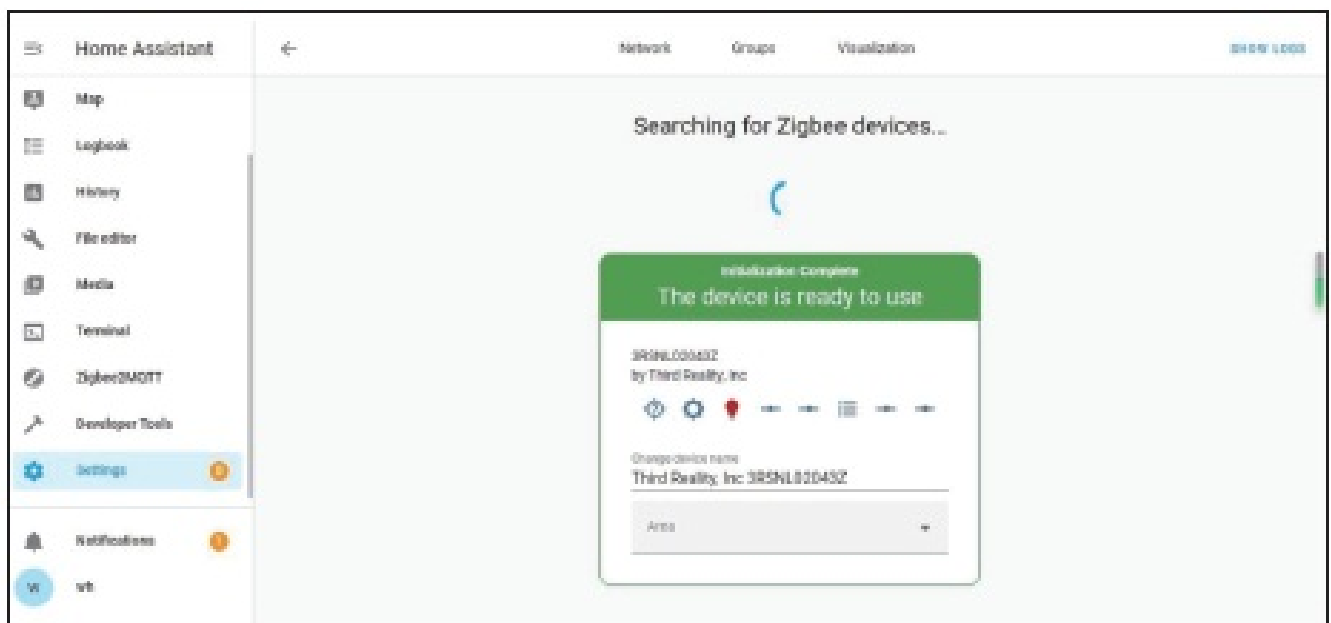
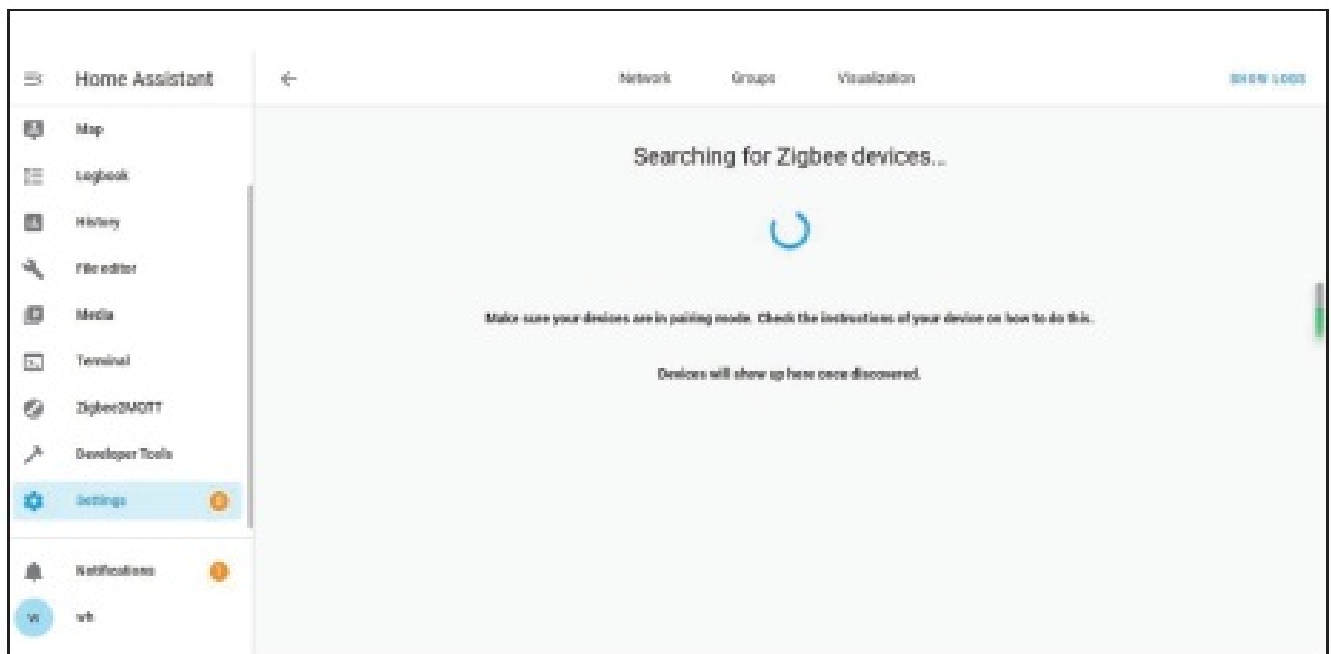

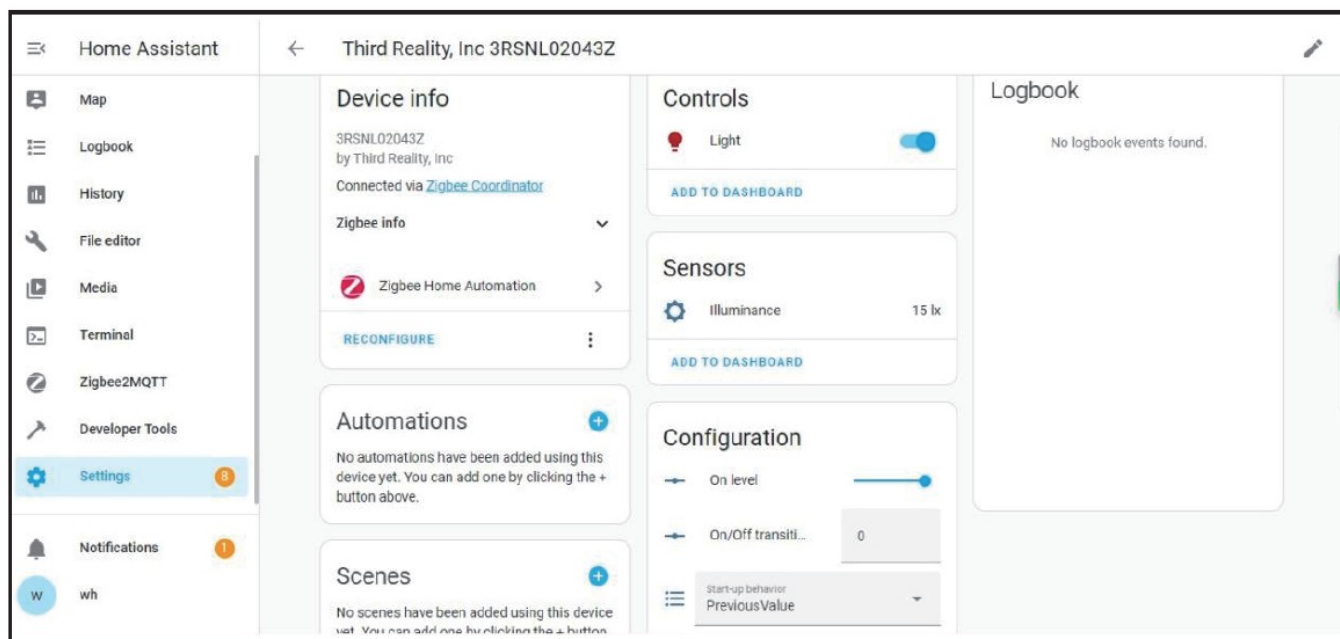

Zigbee2MQTT

Home Assistant

Overview

Energy

Map

Logbook

History

Media

Terminal

Zigbee2MQTT

Developer Tools

Notifications

2

22%

22v@192.168.3.87

Devices

Dashboard

Map

Settings

Groups

OTA

Touchlink

Logs

Extensions

+

Permit join (All)

⌵

⌵

⌵

Enter search criteria

✕

#	Pin	Friendly name	IEEE Address	Manufacturer	Model	LQI	Power	
1		0x282c02bffe01e45	0x282c02bffe01e45 (0x2845)	Third Reality	3RMS168Z	255	🟢	🔍 ⚙️ 🗑️
2		0x282c02bffe73f11	0x282c02bffe73f11 (0x7316)	Third Reality	3RMS168Z	255	🟢	🔍 ⚙️ 🗑️
3		0x282c02bffe0331e	0x282c02bffe0331e (0xA033)	Third Reality	3RMS168Z	255	🟢	🔍 ⚙️ 🗑️
4		0x282c02bffe1170	0x282c02bffe1170 (0xf29D)	Third Reality	3R380158Z	255	⚡	🔍 ⚙️ 🗑️

Home Assistant

Overview

Energy

Map

Logbook

History

Media

Terminal

Zigbee2MQTT

Developer Tools

Notifications

2

22%

22v@192.168.3.87

Devices

Dashboard

Map

Settings

Groups

OTA

Touchlink

Logs

Extensions

+

Disable join (All 8244)

⌵

⌵

⌵

Enter search criteria

✕

#	Pin	Friendly name	IEEE Address	Manufacturer	Model	LQI	Power	
1		0xb83dfb085c5f0000	0xb83dfb085c5f0000 (0x89E2)	Third Reality	3RGNL0240Z	255	⚡	🔍 ⚙️ 🗑️
2		0x282c02bffe01e45	0x282c02bffe01e45 (0x2845)	Third Reality	3RMS168Z	255	🟢	🔍 ⚙️ 🗑️
3		0x282c02bffe73f11	0x282c02bffe73f11 (0x7316)	Third Reality	3RMS168Z	255	🟢	🔍 ⚙️ 🗑️
4		0x282c02bffe0331e	0x282c02bffe0331e (0xA033)	Third Reality	3RMS168Z	255	🟢	🔍 ⚙️ 🗑️
5		0x282c02bffe1170	0x282c02bffe1170 (0xf29D)	Third Reality	3R380158Z	255	⚡	🔍 ⚙️ 🗑️

Home Assistant

Overview

Energy

Map

Logbook

History

Media

Terminal

Zigbee2MQTT

Developer Tools

Notifications

2

22%

22v@192.168.3.87

Devices

Dashboard

Map

Settings

Groups

OTA

Touchlink

Logs

Extensions

+

Disable join (All 0051)

⌵

⌵

⌵

0xb83dfb085c5f0000

About

Exposes

Bind

Reporting

Settings

Settings (specific)

State

Clusters

Scene

Dev console



Friendly name

0xb83dfb085c5f0000

Description

N/A

Last seen

Availability

Disabled

Device type

Router

Zigbee Model

3RGNL0240Z

Zigbee Manufacturer

Third Reality, Inc

Description

Zigbee multi-function night light

Support status

Supported

Pairing With SmartThings

Hub: SmartThings Hub 2015/SmartThings Hub 2018/ Aeotec Smart Home Hub
App: SmartThings APP

Pairing steps

1. Tab “Add device” in the up right in your SmartThings App.
2. Tab “Scan for Nearby devices” and choose the hub to pair the light to.
3. The light will be paired successfully, then you can create routines with it.

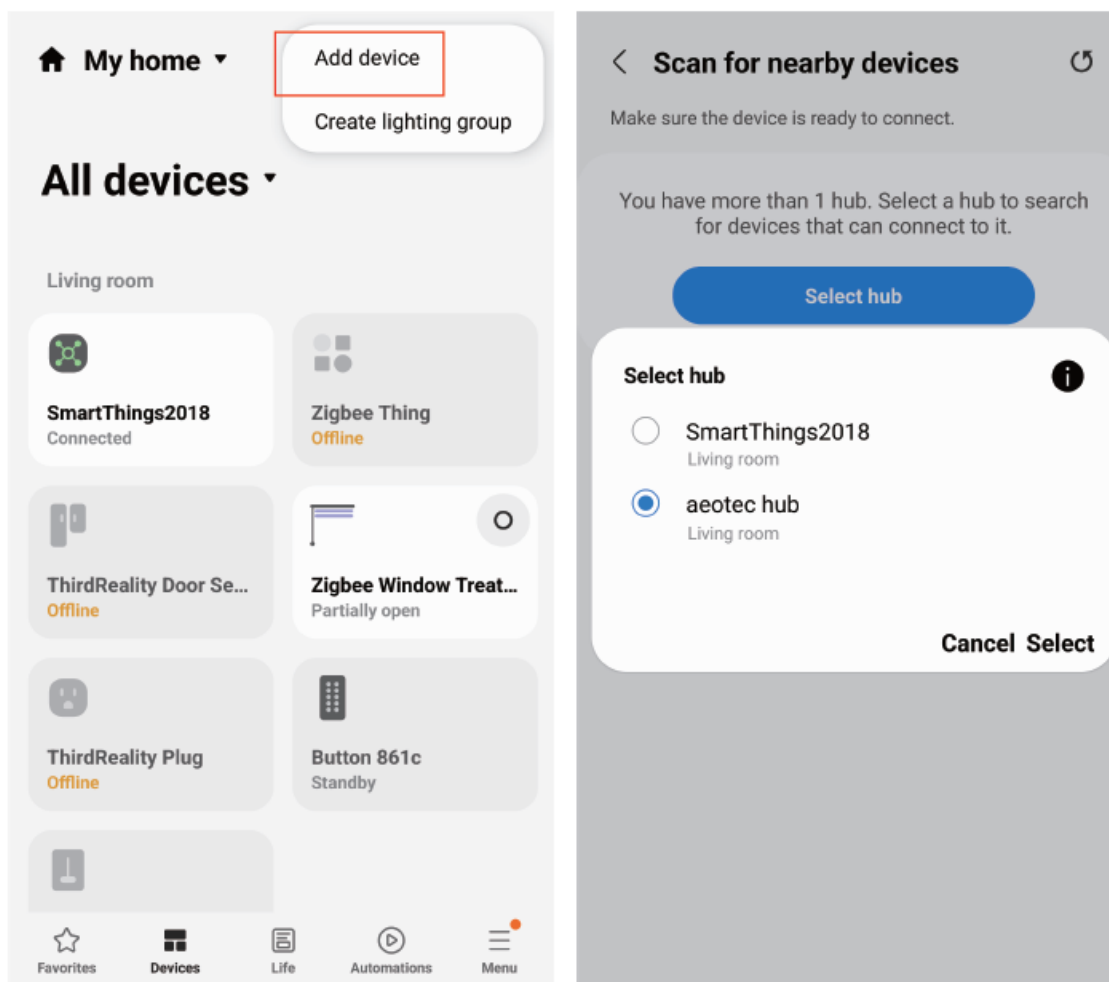

How to add SmartThings drivers for Third Reality Smart Blind

1. Open this link in your PC browser.
<https://bestow-regional.api.smartthings.com/invite/adM-Kr50EXzj9>
2. Log in your SmartThings Account.
3. Click “Enroll” —“Available Drivers” — “Install” to install the device driver as needed.



SmartThings

Channel Information

- Name
Third Reality
- Description
SmartThings driver for Third Reality devices
- [Terms of Service](#)

My Hubs

Aeotec Hub

My home

[Enroll](#)



SmartThings

Channel Information

- Name
Third Reality
- Description
SmartThings driver for Third Reality devices
- [Terms of Service](#)

My Hubs

Aeotec Hub

My home

[Unenroll](#) [Available Drivers](#)



SmartThings

Third Reality

Aeotec Hub

My home

- Name
Zigbee Switch
- Description
SmartThings driver for Zigbee switch devices
- Permissions
 - zigbee: Enable full access to Zigbee actions

[Install](#)

4. Reboot your SmartThings hub by powering it off and power it on again.
5. "Scan for Nearby Devices" in SmartThings App to pair the THIR-DRELAITY devices with your SmartThings hub.
6. You can change the driver of the Light in SmartThings App.

FCC regulatory conformance

This device complies with part 15 of the FCC rules. Operation is subject to the following two conditions: (1) this device may not cause harmful interference, and (2) this device must accept any interference received, including interference that may cause undesired operation.

Changes or modifications not expressly approved by the party responsible for compliance could void the user's authority to operate the equipment.

NOTE: This equipment has been tested and found to comply with the limits for a Class B digital device, pursuant to part 15 of the FCC Rules. These limits are designed to provide reasonable protection against harmful interference in a residential installation. This equipment generates uses and can radiate radio frequency energy and, if not installed and used in accordance with the instructions, may cause harmful interference to radio communications. However, there is no guarantee that interference will not occur in a particular installation. If this equipment does cause harmful interference to radio or television reception, which can be determined by turning the equipment off and on, the user is encouraged to try to correct the interference by one or more of the following measures:

- Reorient or relocate the receiving antenna.
- Increase the separation between the equipment and receiver.
- Connect the equipment into an outlet on a circuit different from that to which the receiver is connected.
- Consult the dealer or an experienced radio/TV technician for help important announcement.

NOTE: The manufacturer is not responsible for any radio or TV interference caused by unauthorized modifications to this equipment. Such modifications could void the user's authority to operate the equipment.

RF Exposure

This equipment complies with FCC radiation exposure limits set forth for an uncontrolled environment.

This transmitter must not be co-located or operating in conjunction with any other antenna or transmitter.

Limited Warranty

For limited warranty, please visit www.3reality.com/devicesup-port

For customer support, please contact us at info@3reality.com or visit www.3reality.com

For help and troubleshooting related to Amazon Alexa, visit the Alexa app.

Documents / Resources

Multi-Function Night Light

Quick Start Guide

THIRDREALITY

Product Overview

ThirdReality Zigbee Wall Function Night Light, ambient and smart light and also provides a motion sensor, a light sensor and color night light. With motion sensor, light sensor and color night light, the illumination options for security lighting, and ambience. Superior engineering and precision in its design.

What's In The Box

Multi-Function Night Light x 1
Power Adapter x 1
Quick Start Guide x 1

Product Details

USB Interface

Color Night Light

Illumination Sensor

Set Pinhole Motion Sensor

Power Adapter

Dimensions	2.8 x 1.8 x 2.5 inches
Color	White
Input	DC 5V 0.5A
Material	Plastic



Pairing With Hubitat



Pairing steps:



3. Type in a device and room name and click "Next" to complete pairing.



Pairing With Home Assistant



Pairing steps:

Zigbee Home Automation(ZHA)



References

- [!\[\]\(0f0f508d296bff693b2b34288b8d91ee_img.jpg\) Quick Start Guide](#)
- [!\[\]\(da9573afbd0f11bd65fa98c07c313243_img.jpg\) ThirdReality](#)
- [!\[\]\(108ddea3e4403f7ec336d9616208971a_img.jpg\) DeviceSupport – ThirdReality](#)
- [**User Manual**](#)

[Manuals+](#), [Privacy Policy](#)

This website is an independent publication and is neither affiliated with nor endorsed by any of the trademark owners. The "Bluetooth®" word mark and logos are registered trademarks owned by Bluetooth SIG, Inc. The "Wi-Fi®" word mark and logos are registered trademarks owned by the Wi-Fi Alliance. Any use of these marks on this website does not imply any affiliation with or endorsement.