

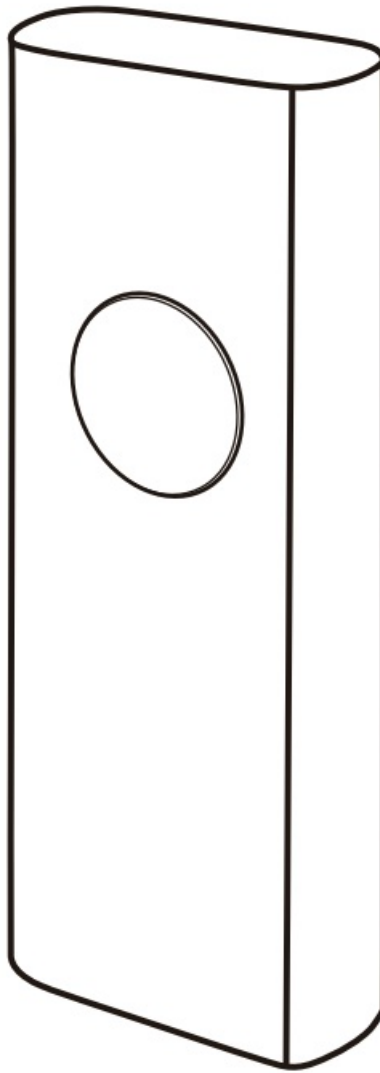

THIRD REALITY 3RSS009Z Smart Switch Gen3 Instruction Manual

[Home](#) » [THIRD REALITY](#) » THIRD REALITY 3RSS009Z Smart Switch Gen3 Instruction Manual 

THIRD REALITY 3RSS009Z Smart Switch Gen3



Contents

- [1 Mounting Kit](#)
- [2 Setting up your Smart Switch](#)
- [3 Using your Smart Switch](#)
- [4 LED Status](#)
- [5 Troubleshooting](#)
- [6 Limited Warranty](#)
- [7 FCC Regulatory Conformance:](#)
- [8 RF Exposure](#)
- [9 Documents / Resources](#)
- [10 Related Posts](#)

Mounting Kit

- Fastener x2

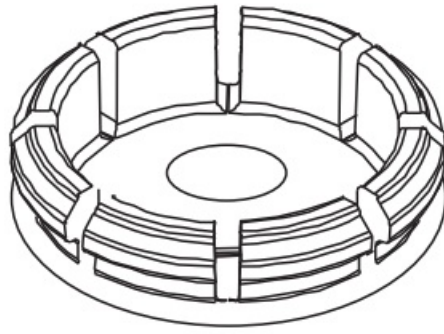
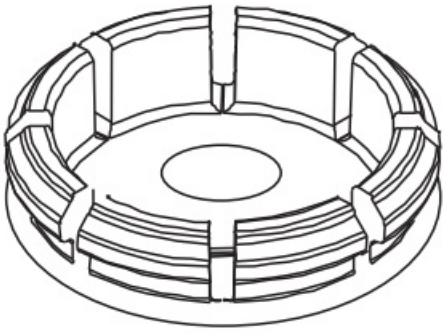

- Thin Spacer x2

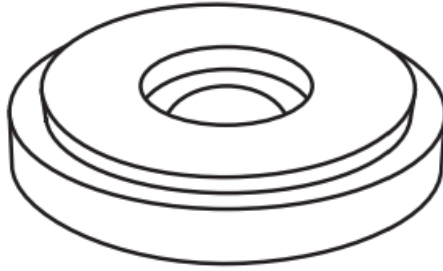
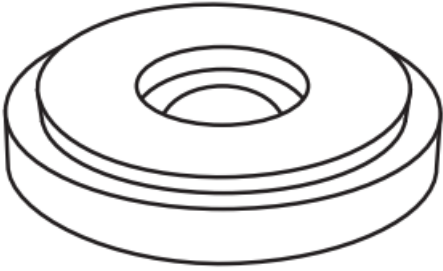

- Thick Spacer x2

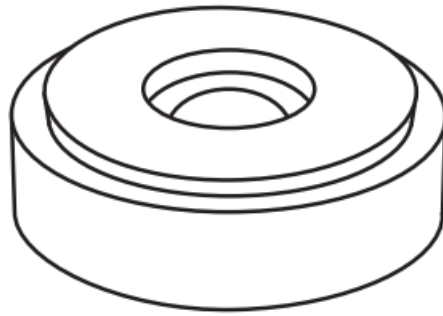
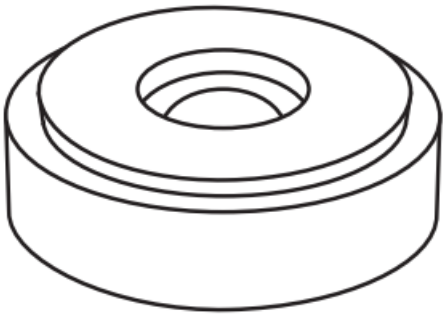

- Screw x2

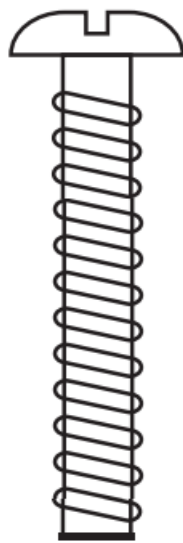
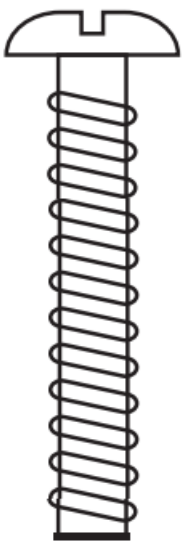

- Battery x2

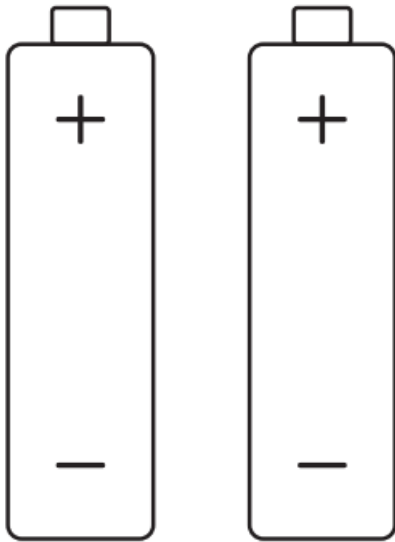

- Protective Film x2

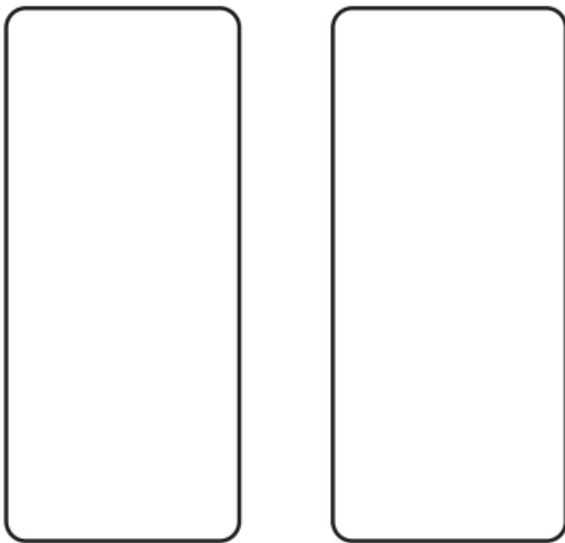

Setting up your Smart Switch

Works with both toggle and rocker style switches.

1. Remove screws from faceplate.

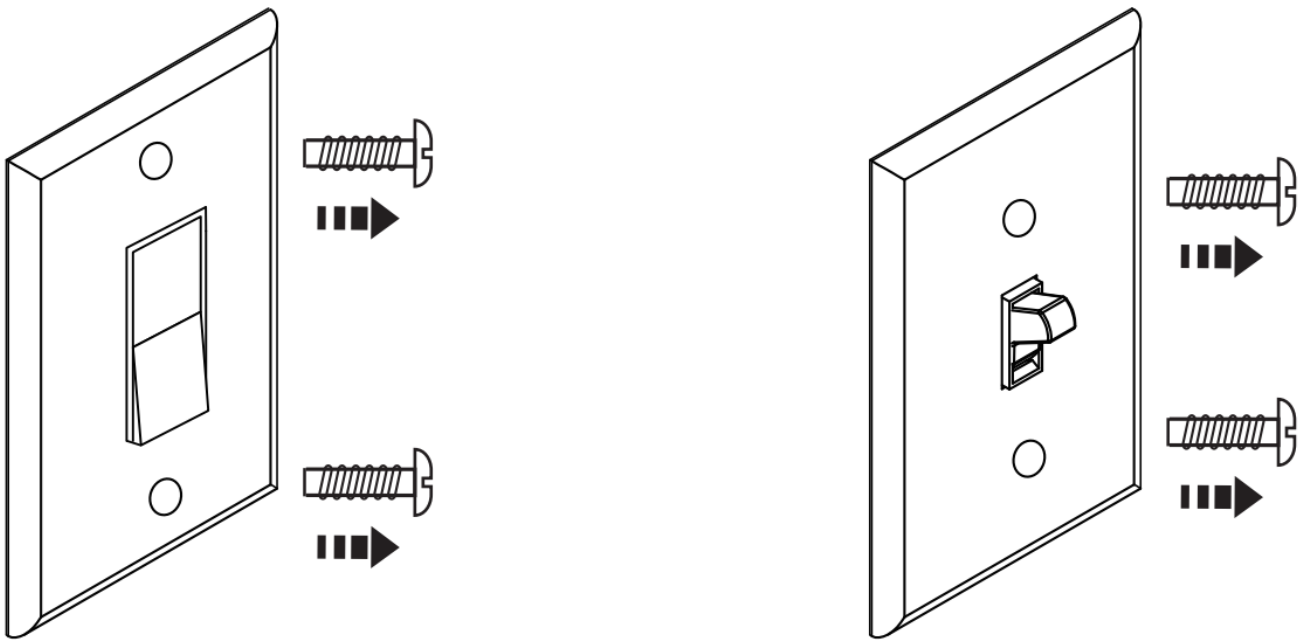

2. For rocker switch, please select the fasteners and spacers as shown below. Start with the appropriate spacers. When you get to Step 7, you may need to adjust the spacers accordingly.

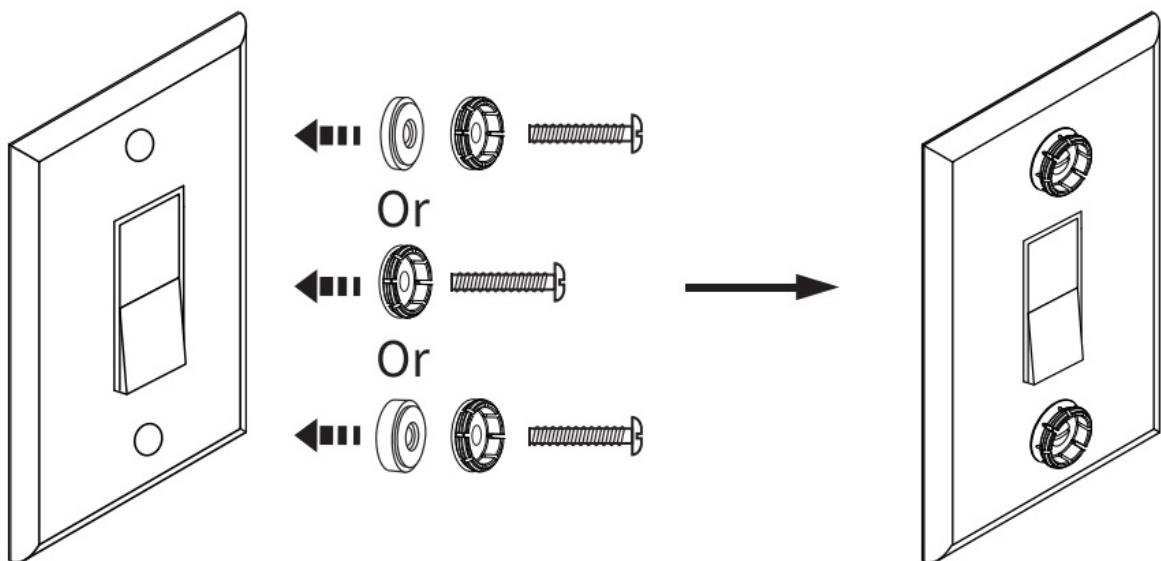
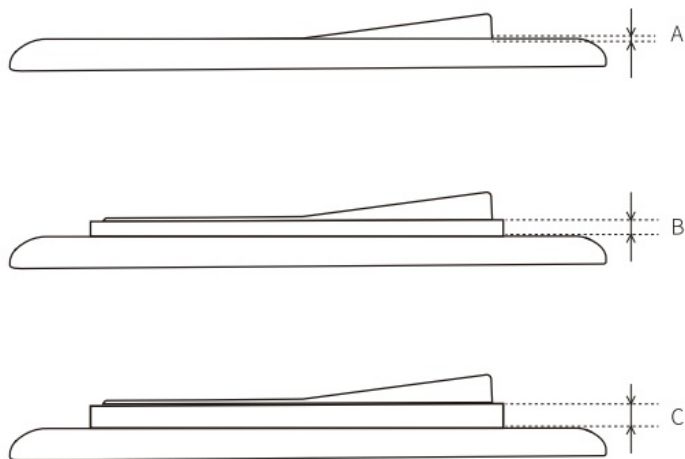

3. Insert two AAA batteries and replace cover.

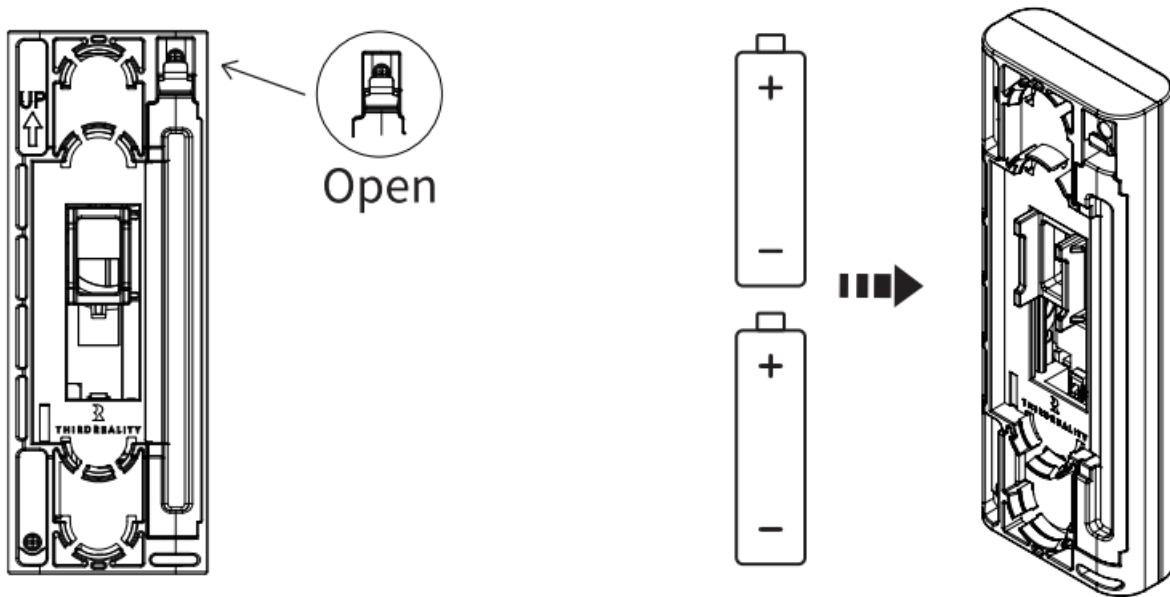

4. Pairing Instructions:

Note: Make sure your Echo device is up to date. You can say “Alexa, is my software up to date?” to trigger the update.

1. Bring the Smart Switch closer to your Echo device.
2. Put switch into pairing mode by holding button for at least 20 seconds, until light flashes rapidly.
3. Say “Alexa, discover my device.”

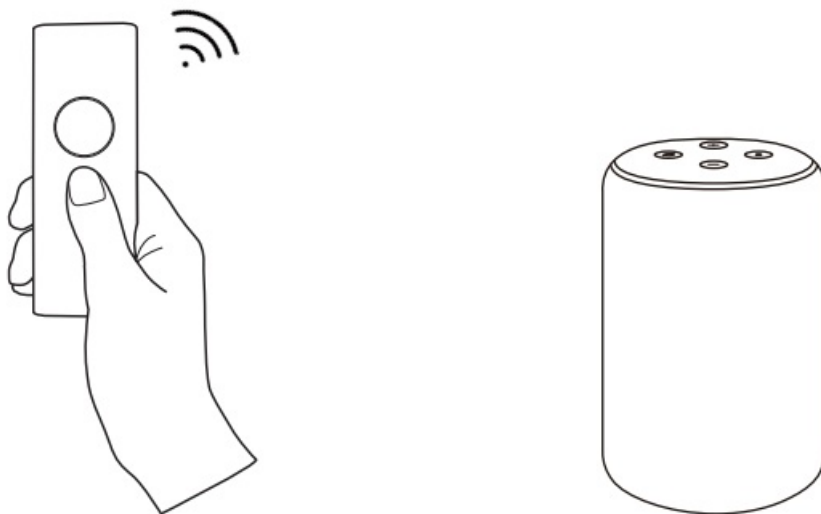

5. Make sure Smart Switch actuator is in the up position as shown by pressing the button.

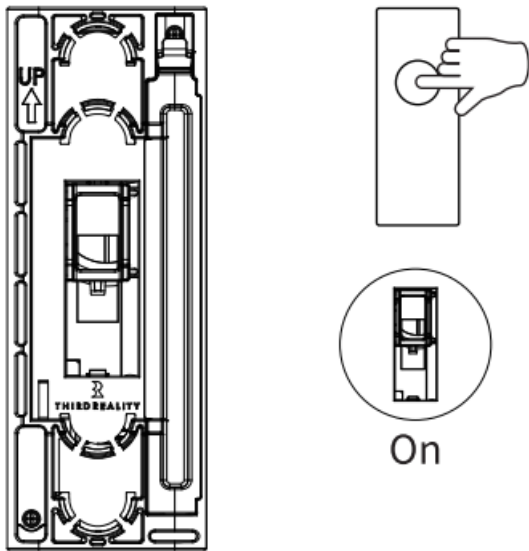

6. Turn your rocker or toggle switch to ON position, as shown.

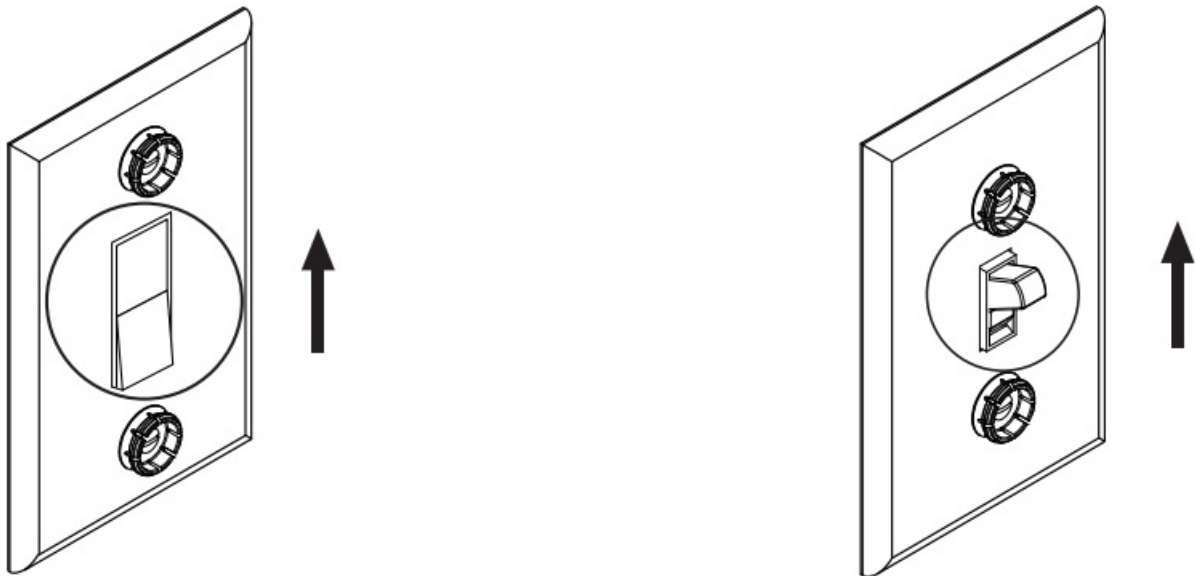

7. Place Smart Switch over existing switch. Test the switch by pressing the button to turn on and off. Adjust the spacers to ensure proper engagement between the Smart Switch and wall switch.

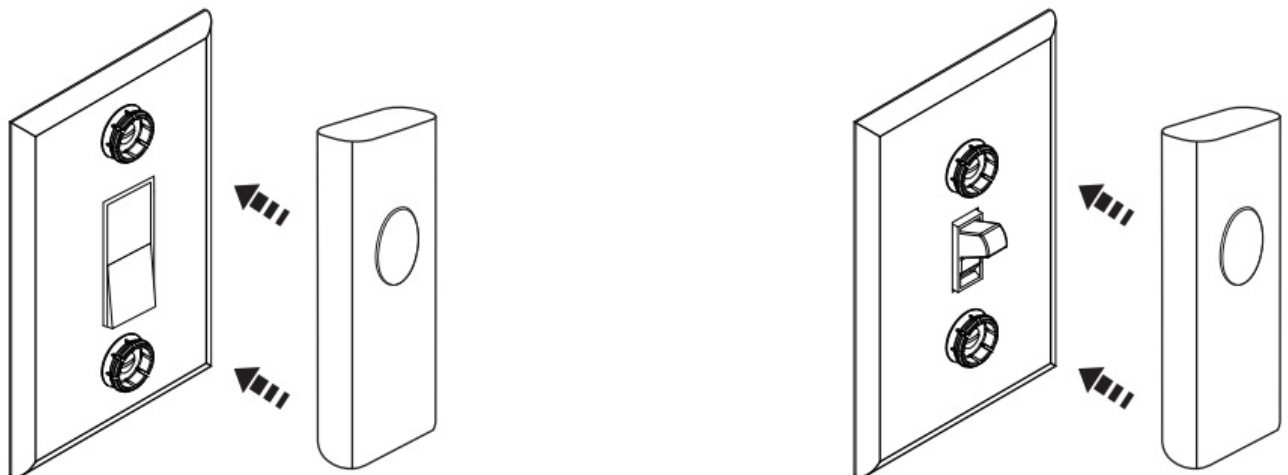

Optional – For rocker switch, place protective film over paddle, as shown.

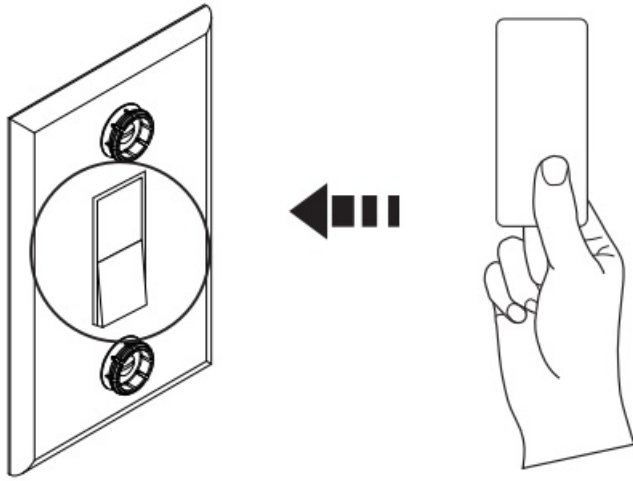

Using your Smart Switch

1. Follow instructions in the Amazon Alexa App to set up your Amazon Echo.
2. For optimal performance, switch should be no more than 100 feet from Echo device.
3. To control device using voice commands, say "Alexa, turn on/off First Switch"

LED Status

Pairing- LED fast blinking (two blinks every second)

Reconnect – LED slow blinking (blink once every three seconds)

Low Battery- LED double blinking (two short blinks every two seconds)

Troubleshooting

1. Inverted On/Off status

To reverse On/Off direction of the switch, long press the Smart Switch button more than 10 seconds until blue LED is displayed solid then release.

2. Factory Reset

To factory reset the Smart Switch, press and hold the Smart Switch button more than 20 seconds until the blue LED flashed rapidly, indicating that the Smart Switch is in pairing mode now.

3. Adjusting/Adding Spacers

- If the Smart Switch actuates but is not turning your wall switch on or off, the gap between Smart Switch and wall switch may be too wide. Try slightly tightening faceplate screws. You can also try using a different size spacer.
- If Smart Switch fails to actuate or comes off the wall when actuating, the Switch may be too close to the wall. Try changing the size of your spacer.

4. Switch won't pair.

Make sure your Echo speaker is compatible with Smart Switch, Compatible Echo speakers include Echo Plus Gen I & Gen 2, Echo Gen 4, Echo Studio.

- Make sure your Echo device is up to date. You can say "Alexa, is my software up to date?" to trigger the update.
- Reboot the Echo speaker by unplugging the power and plugging it back in, then try to pair the Smart Switch

with it again.

- Factory reset the Echo speaker (Press and hold the Action button for 25 seconds. The light ring will pulse orange, then turn off. Wait for the light ring to turn back on and turn blue.

The light ring then turns orange again and the device enters the set up mode), then try to pair the Smart Switch with it again.

5. Smart Switch is not responding

- Turn the Smart Switch on/off twice in the Alexa app to sync the switch.
- If your switch is not responding, reboot your Echo speaker, factory reset the switch and pair the switch again.
- If the switch is still not responding, try de-registering your Echo speaker using the Alexa app, set up the speaker again and pair the switch.

6. Moving Switches

If you want to change the Echo speaker that a switch is paired to, remove the switch using the Alexa app, wait 30 minutes for Alexa cloud to update and pair the switch to the new Echo speaker.

Scan this QR code to find more useful videos:



Limited Warranty

For limited warranty, please visit www.3reality.com/devicesupport

For customer support, please contact us at info@3reality or visit www.3reality.com

For help and troubleshooting related to Amazon Alexa, visit the Alexa app.

FCC Regulatory Conformance:

This device complies with Part 15 of the FCC Rules. Operation is subject to the following two conditions:

(1) This device may not cause harmful interference.

(2) This device must accept any interference received, including interference that may cause undesired operation.

NOTE: This equipment has been tested and found to comply with the limits for a Class B digital device, pursuant to part 15 of the FCC Rules. These limits are designed to provide reasonable protection against harmful interference in a residential installation.

This equipment generates uses and can radiate radio frequency energy and, if not installed and used in accordance with the instructions, may cause harmful interference to radio communications. However, there is no guarantee that interference will not occur in a particular installation. If this equipment does cause harmful interference to radio or television reception, which can be determined by turning the equipment off and on, the user is encouraged to try to correct the interference by one or more of the following measures:

- Reorient or relocate the receiving antenna.
- Increase the separation between the equipment and receiver.
- Connect the equipment into an outlet on a circuit different from that to which the receiver is connected.
- Consult the dealer or an experienced radio/TV technician for help.

NOTE: The manufacturer is not responsible for any radio or TV interference caused by unauthorized modifications to this equipment. Such modifications could void the user's authority to operate the equipment.

RF Exposure

This equipment complies with FCC radiation exposure limits set forth for an uncontrolled environment. This equipment should be installed and operated with minimum distance of 20 cm between the radiator and your body. This transmitter must not be co-located or operating in conjunction with any other antenna or transmitter.

This Guide is an independent publication of Third Reality, which is solely responsible for its content, and Amazon has not reviewed its claims for accuracy, Amazon, Alexa, Echo and all related logos are trademarks of Amazon.com, Inc. or its affiliates.



Documents / Resources

