



A11 CD Player



THINKYA A11 CD Player User Guide

[Home](#) » [THINKYA](#) » THINKYA A11 CD Player User Guide

Contents

- 1 [THINKYA A11 CD Player](#)
- 2 [WHAT'S IN THE BOX?](#)
- 3 [PRODUCT SPECIFICATIONS](#)
- 4 [BUTTON PANEL CONTROLS](#)
- 5 [REAR PANEL CONNECTIONS](#)
- 6 [LED DISPLAY](#)
- 7 [REMOTE CONTROLLER](#)
- 8 [POWER ON/STANDBY](#)
- 9 [BLUETOOTH MODE](#)
- 10 [US B-MP3](#)
- 11 [PLAYING CDS](#)
- 12 [FCC STATEMENT](#)
- 13 [Documents / Resources](#)
 - 13.1 [References](#)
- 14 [Related Posts](#)



THINKYA A11 CD Player



WHAT'S IN THE BOX?

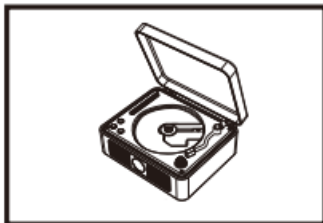

① CD Player

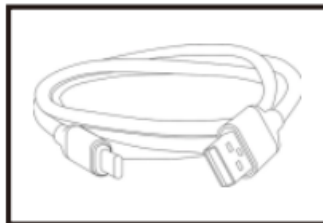

② Type-C charging cable

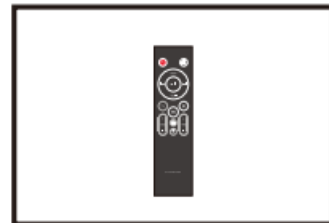

③ Remote control

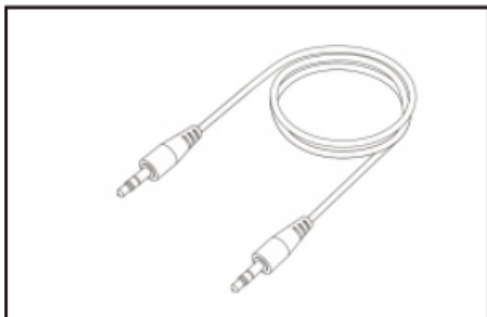

④ 3.5mm aux cable



⑤ Instruction manual



PRODUCT SPECIFICATIONS

Product name	CD Player
Input power	DC 5V/2A
Bluetooth version	5.0
BT protocol support	ADP/AVRCP
BT receiving distance	10M
Battery capacity	3.6V/2600mAh
Output Power	speaker(4Ω)2X2W;earphone(16Ω)2X20mW
USB playback format	MP3/WMA/WAV/APE/FLAC
CD playback format	CD-DA/MP3/CD-R
Audio In	3.5mm Audio In
Analog audio output	3.5mm stereo headphone output
Charging cable length	80CM
Product Size	210X170X77mm
Product weight	about 985g
Product accessories	(charging cable. audiocable. manual. remote)x1

BUTTON PANEL CONTROLS

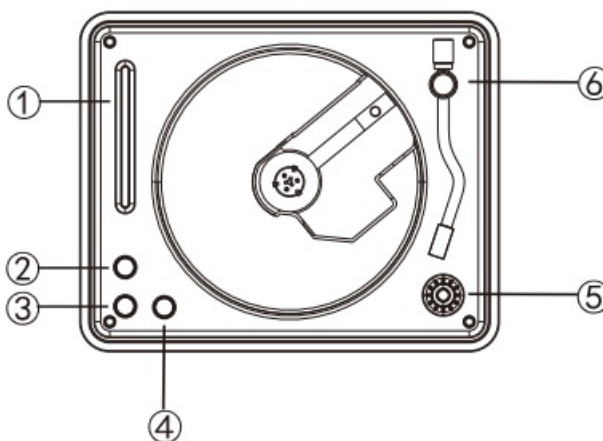

1. COLORED LANTERN
2. LONG PRESS: STANDBY
SHORT PRESS: ON/IN PUT SOURCE SELECTION(CD,USB,AUX,BT)
3. LONG PRESS: JUMPTOTHE PREVIOUS LIGHTING EFFECT
SHORT PRESS: PREVIOUS
4. LONG PRESS : JUMPTOTHE NEXT LIGHTING EFFECT
5. SHORT PRESS:NEXT
VOLUME BUTTON
6. TONEARM SWITCH(PLAY/PAUSE)

REAR PANEL CONNECTIONS

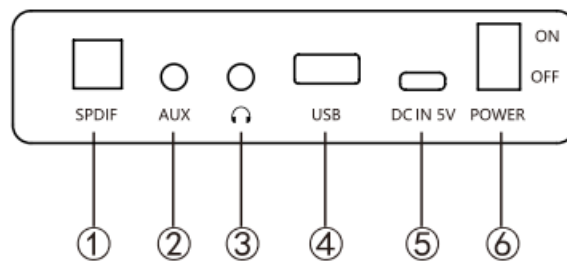

1. OPTICAL FIBER OUTPUT
2. AUX AUDIO INPUT TERMINAL
3. HEADPHONES OUTPUTTERMINAL
4. U SB INPUT TERMINAL
5. TYPE-C POWER TERMINAL
6. SWITCH

LED DISPLAY

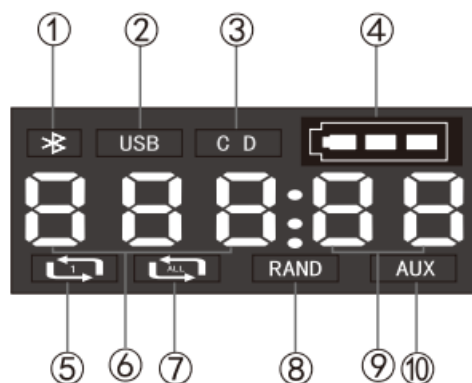

1. BLUETOOTH
2. USB
3. CD
4. POWER
5. SINGLE LOOP
6. TRACK NUMBER
7. ALL LOOP
8. RAND
9. PLAYTIME(SECONDS)
10. AUX

REMOTE CONTROLLER

1. STANDBY/ON
2. VOLUME+

3. PREVIOUS
4. VOLUME
5. REPEAT/SHUFFLE
6. BASS+/-
7. BT TRANSMITTING SIGNAL
8. MUTE
9. NEXT
10. PLAY /PLAUSE
11. STOP
12. INPUT SOURCE SELECTION (BT/AUX/CD/USB)
13. TREBLE+/-
14. EQ

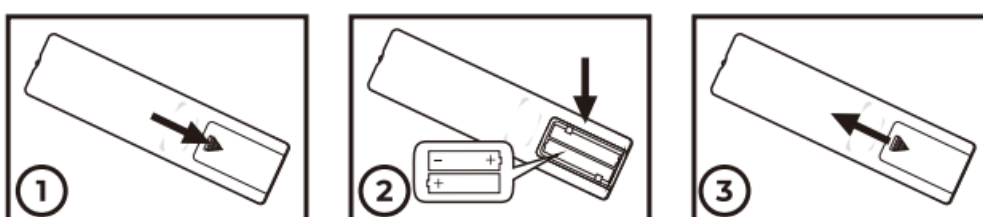

POWER ON/STANDBY

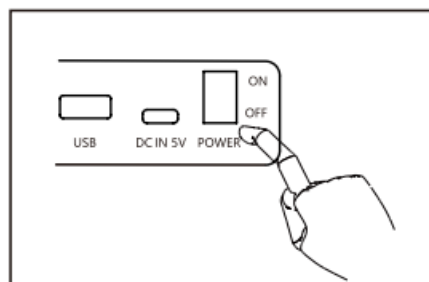

1. Turn the switch to ON state button 6 on the rear panel

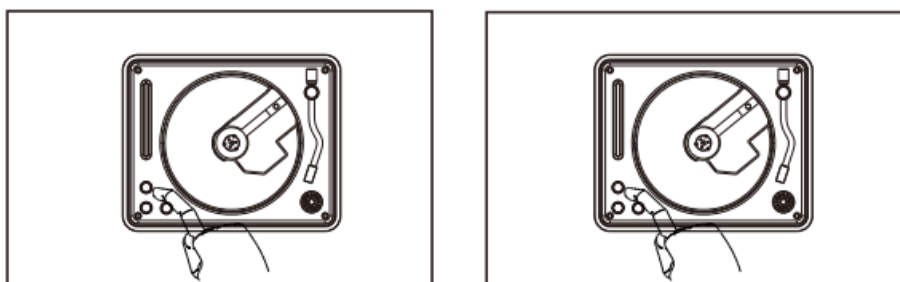

2. To turn on the unit, click the STANDBY button 2 on the button panel
3. To put the unit into standby mode, long-press the STANDBY button once again



BLUETOOTH MODE

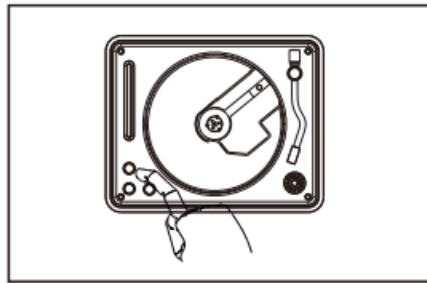

Select the Bluetooth mode. Click the SOURCE (button2) on the button panel until the BT option appears on the screen. The light will start flashing, which means the unit is ready to pair

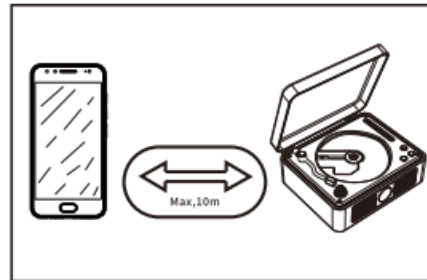
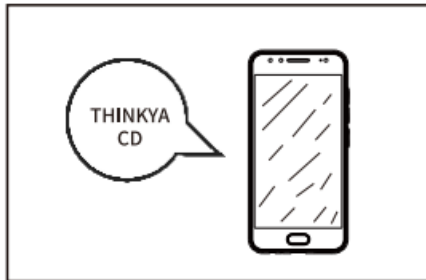

US B-MP3



Plug the desired USB in the USB input slot of the rear panel

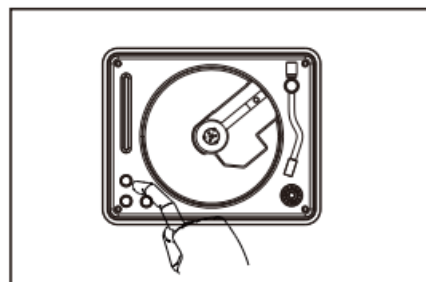
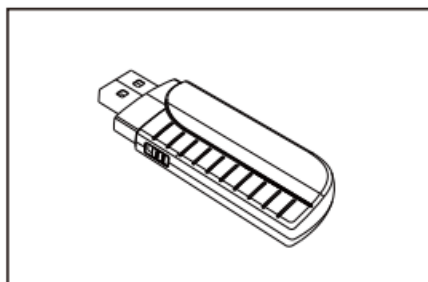

Devices compatible with USB 2.0 , Size 32Gb

Select the USB mode. using the button panel (SOURCE button 2)



PLAYING CDS

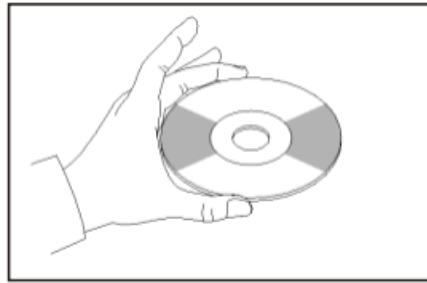
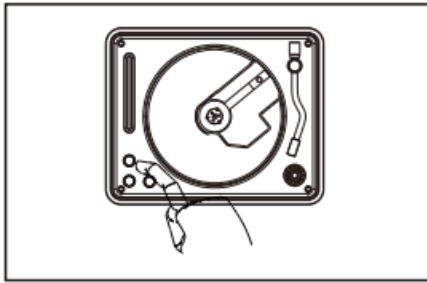

Select the CD mode. Using the button panel (SOURCE button 2)

Insert the CD into the tray

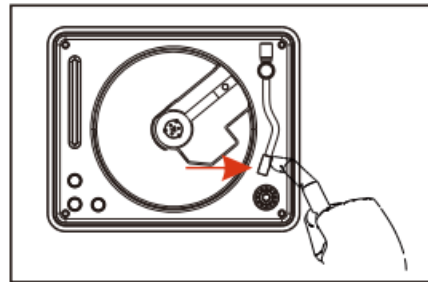
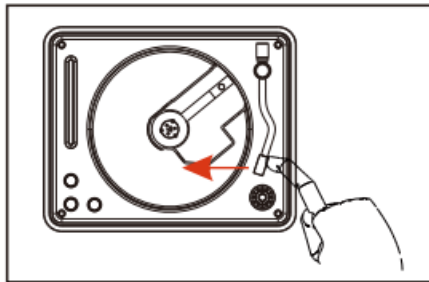

To search for a section on a CD track, press the NEXT (button 4 or PREVIOUS (button 3) during playback, then release it at the point you want to listen

FCC STATEMENT

Any Changes or modifications not expressly approved by the party responsible for compliance could void the user's authority to operate the equipment.

This device complies with part 15 of the FCC Rules. Operation is subject to the following two conditions: (1) This device may not cause harmful interference, and (2) this device must accept any interference received, including interference that may cause undesired operation.

Note: This equipment has been tested and found to comply with the limits for a Class B digital device, pursuant to part 15 of the FCC Rules. These limits are designed to provide reasonable protection against harmful interference in a residential installation. This equipment generates, uses and can radiate radio frequency energy and, if not installed and used in accordance with the instructions, may cause harmful interference to radio communications. However, there is no guarantee that interference will not occur in a particular installation. If this equipment does cause harmful interference to radio or television reception, which can be determined by turning the equipment off and on, the user is encouraged to try to correct the interference by one or more of the following measures:

- Reorient or relocate the receiving antenna.
- Increase the separation between the equipment and receiver.
- Connect the equipment into an outlet on a circuit different from that to which the receiver is connected.
- Consult the dealer or an experienced radio/TV technician for help.

RF Exposure Statement

The device has been evaluated to meet the general RF exposure requirements. The device can be used in portable exposure conditions without restriction.

Documents / Resources



[THINKYA A11 CD Player](#) [pdf] User Guide
A11, A11 CD Player, CD Player, Player

References

- [User Manual](#)

Manuals+. [Privacy Policy](#)

This website is an independent publication and is neither affiliated with nor endorsed by any of the trademark owners. The "Bluetooth®" word mark and logos are registered trademarks owned by Bluetooth SIG, Inc. The "Wi-Fi®" word mark and logos are registered trademarks owned by the Wi-Fi Alliance. Any use of these marks on this website does not imply any affiliation with or endorsement.