

THINKWARE Q200 Dash Cam Link



THINKWARE Q200 Dash Cam Link User Guide

[Home](#) » [THINKWARE](#) » THINKWARE Q200 Dash Cam Link User Guide 

Contents

- [1 THINKWARE Q200 Dash Cam Link](#)
- [2 Power the Dash Cam](#)
- [3 Download the App](#)
- [4 Install the Front Camera](#)
- [5 FAQ & Help Desk](#)
- [6 Documents / Resources](#)
 - [6.1 References](#)
- [7 Related Posts](#)

THINKWARE

THINKWARE Q200 Dash Cam Link



Power the Dash Cam

Use one of the following options

The included cable options vary depending on the dashcam model purchased.



12V Power Cable

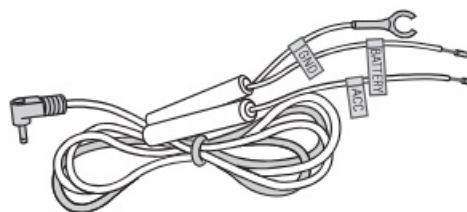

Hardwiring Cable*



OBD-II Cable*

To enable Parking Surveillance mode, the dash cam needs to be powered by either the OBD-II Cable or Hardwiring Cable (professional installation recommended).

Download the App

Download the THINKWARE DASHCAM LINK App

On your smartphone, open the Google Play Store or Apple App Store and download and install the THINKWARE

DASH CAM LINK.



THINKWARE DASH CAM LINK



Apple Store (iOS)



Google Play Store (Android)

Connect to the App

Follow the on-screen instructions

1. Press the  Wi-Fi button on the Dash Cam for at least 3 seconds.

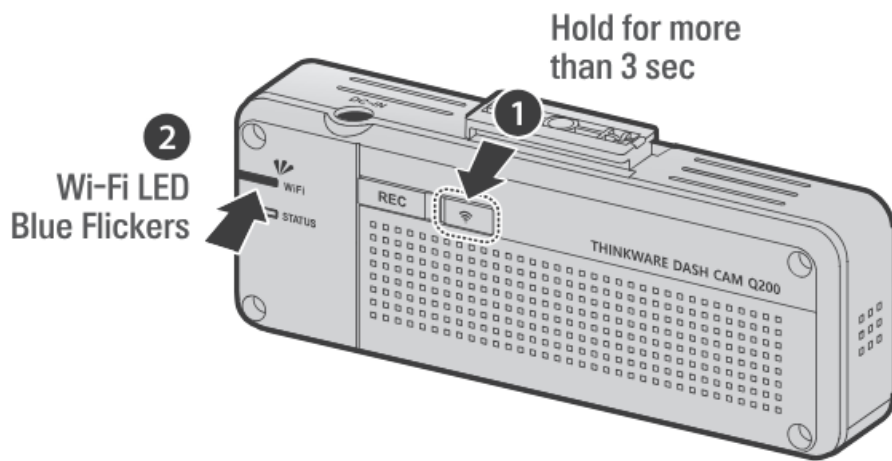

Won't Connect to the App?

Install the Front Camera

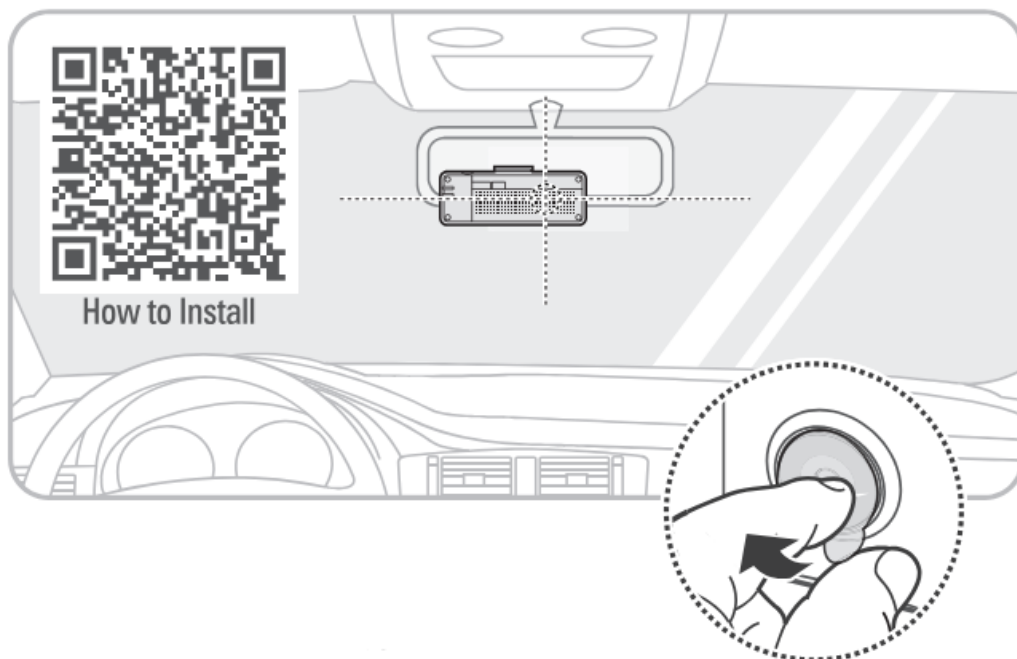

Open Live View in the app

- The blue line with the centre
- Green line with the front edge of the hood

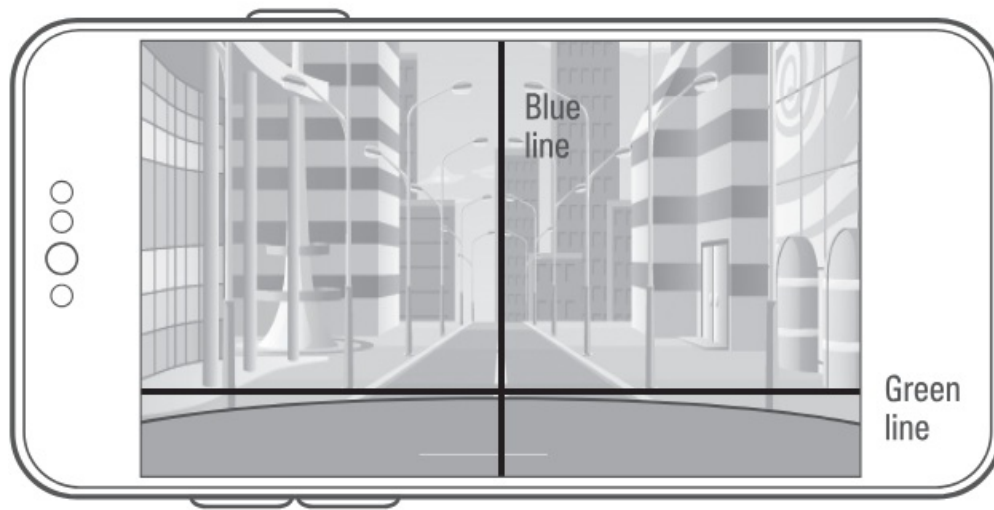

Install the Rear View Camera

- Open Live View Rear Camera in the App

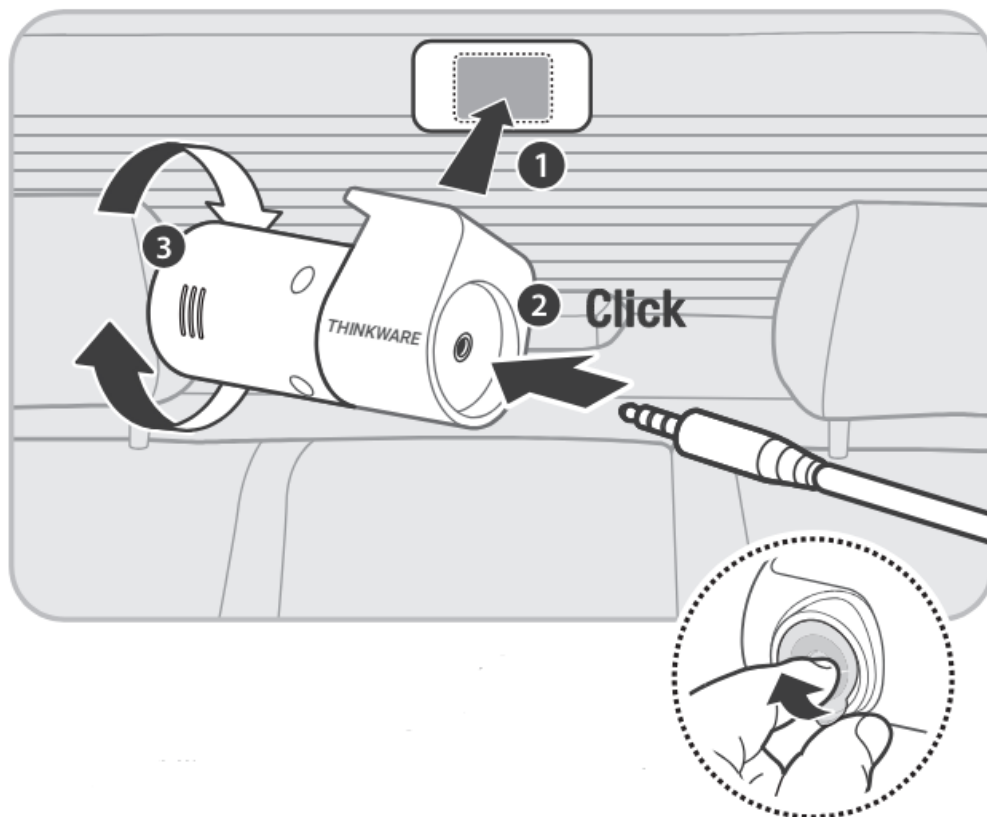

- Red line with the trunk centre
- Yellow line with the centre of the horizon
- Green line with the trunk line

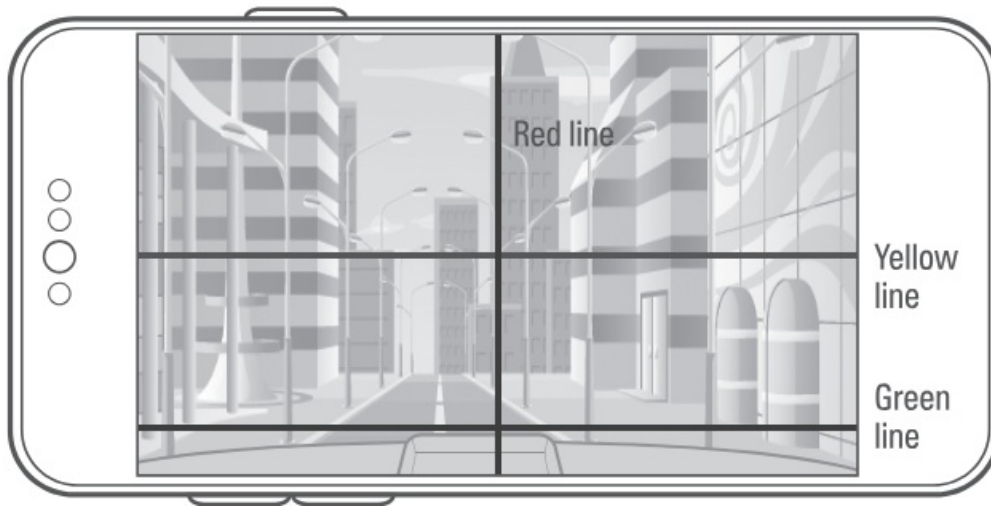

Dash Cam Settings in the App

- Default settings out of the box
- The default settings are as follows, and you have the option to adjust them according to your preference.

| Options | Description |
|--------------------|--------------|
| Voice Recording | Enabled |
| System Volume | 0 1 2 3 |
| Parking Mode | Disabled |
| Super Night Vision | Parking Mode |
| ADAS | Disabled |
| Speed Stamp | Disabled |
| Safety Camera | Enabled |

FAQ & Help Desk

Still, have questions or issues?

For further assistance or to report any issues, please contact our support team.

North America

1 [844-865-9273](tel:844-865-9273)

support@thinkware.com



FAQs & Help Desk

United Kingdom

44 (0) 333-121-0008

support.eu@thinkware.com

European Union

(+49) 69-943-22200

support@thinkware.com

FAQs & Help Desk

Please refer to CS Information QR in the box for other countries.

Documents / Resources

| | |
|--|--|
| <p>THINKWARE DASH CAM™ Quick Start Guide</p> <p>Q200</p> | <p>THINKWARE Q200 Dash Cam Link [pdf] User Guide Q200 Dash Cam Link, Q200, Dash Cam Link, Cam Link, Link</p> |
|--|--|

References

- [User Manual](#)

[Manuals+](#), [Privacy Policy](#)

This website is an independent publication and is neither affiliated with nor endorsed by any of the trademark owners. The "Bluetooth®" word mark and logos are registered trademarks owned by Bluetooth SIG, Inc. The "Wi-Fi®" word mark and logos are registered trademarks owned by the Wi-Fi Alliance. Any use of these marks on this website does not imply any affiliation with or endorsement.