



THINKWARE Q1000 Wi-Fi Dash Cam User Guide

[Home](#) » [THINKWARE](#) » THINKWARE Q1000 Wi-Fi Dash Cam User Guide 

THINKWARE Q1000 Wi-Fi Dash Cam User Guide



Contents

- [1 Power the Dash Cam](#)
- [2 Download the App](#)
- [3 Connect to the App](#)
- [4 Install the Front Camera](#)
- [5 Install the Rear View Camera](#)
- [6 Dash Cam Settings in the App](#)
- [7 FAQ & Help Desk](#)
- [8 Still have questions or issues?](#)
 - [8.1 Documents / Resources](#)
 - [8.1.1 References](#)

Power the Dash Cam

Use one of the following options

The included cable options vary depending on the dash cam model purchased

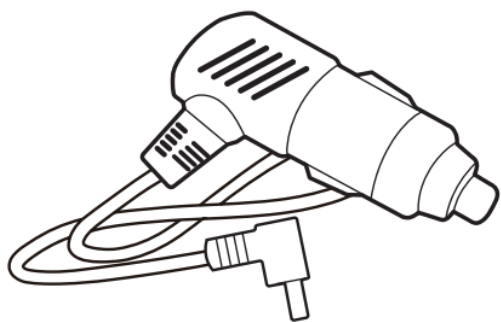

12 V Power Cable

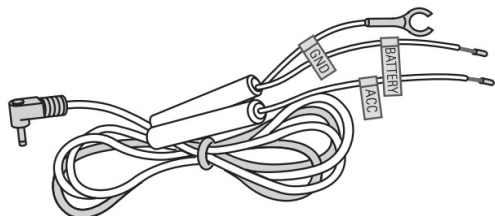

Hard wiring Cable*

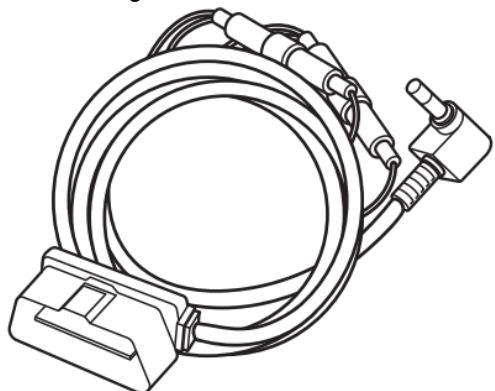

OB D -II Cable*



To enable Parking Surveillance mode, the dash cam needs to be powered by either the OBD-II Cable or Hardwiring Cable (professional installation recommended).

Download the App

Download the THINKWARE DASHCAM LINK App

On your smartphone, open the Google Play Store or Apple App Store and download and install **THINKWARE DASH CAM LINK**.



THINKWARE DASH CAM LINK

Apple Store (iOS)



Google Play Store (Android)



Connect to the App

Follow the on-screen instructions

1. Press the Wi-Fi button on the Dash Cam.

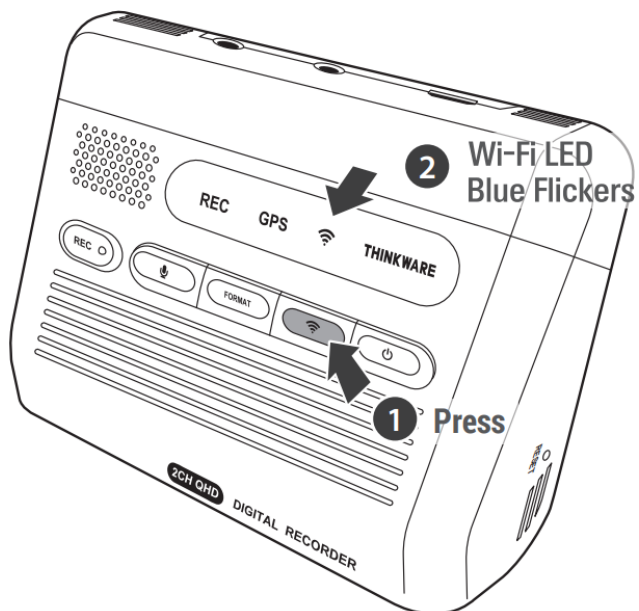

Won't connect to the App?

Install the Front Camera



How to Install

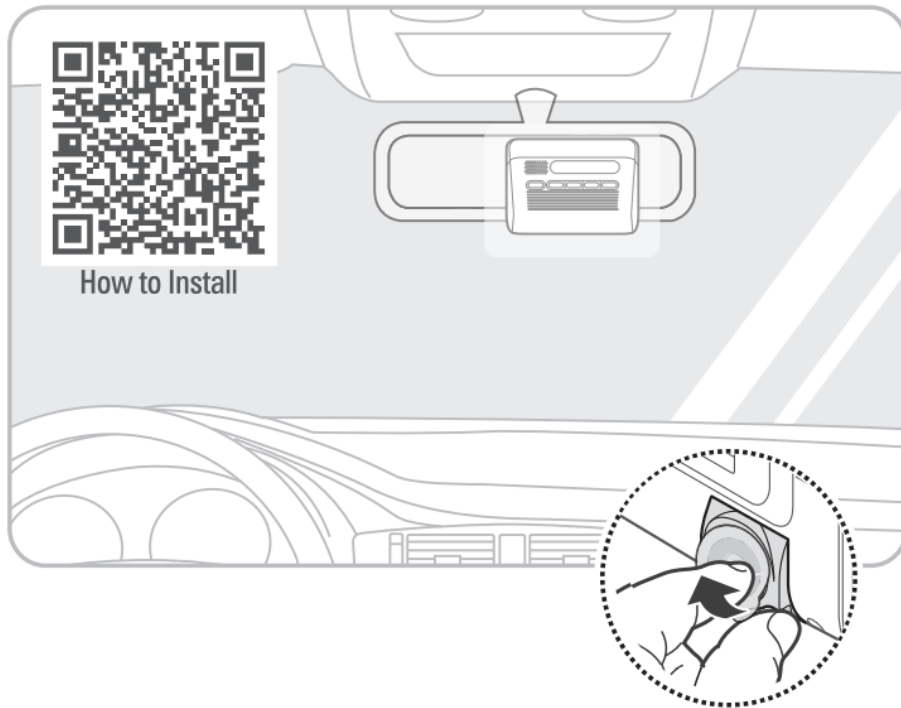

Open Live View in the app

- Blue line with the center
- Green line with the front edge of the hood

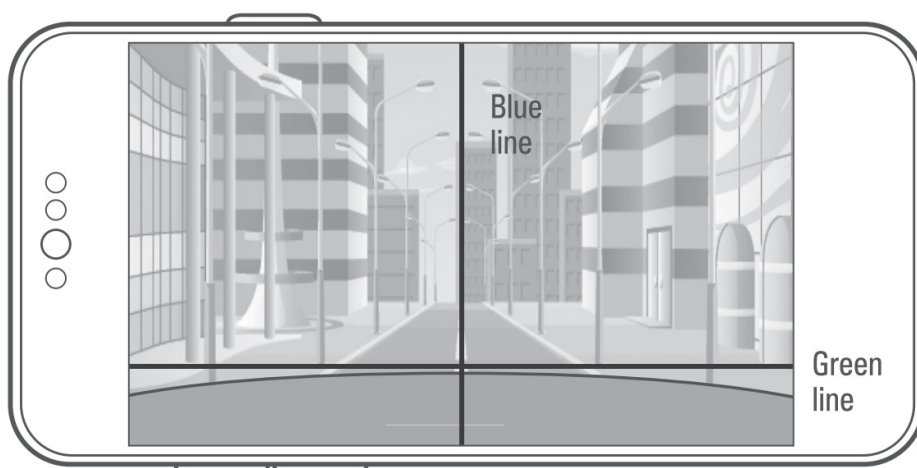

Install the Rear View Camera

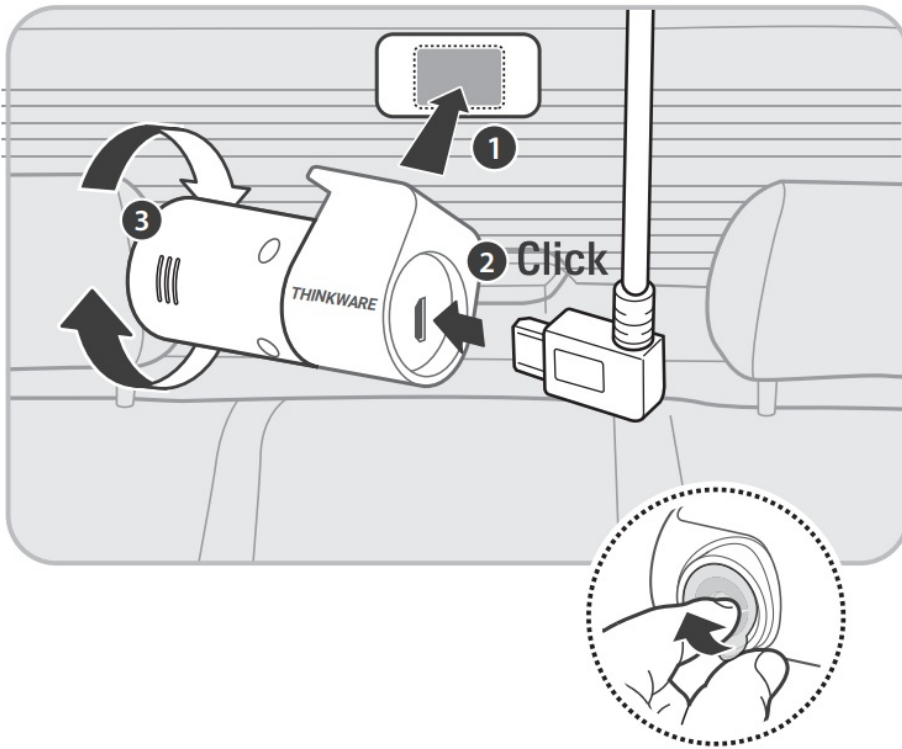

Open Live View Rear Camera in App

- Red line with the trunk center
- Yellow line with the center of the horizon
- Green line with the trunk line



Dash Cam Settings in the App

Default settings out of the box

The default settings are as follows, and you have the option to adjust them according to your preference.

| Options | Description |
|--------------------|--------------|
| Voice Recording | Enabled |
| System Volume | 0123 |
| Parking Mode | Disabled |
| Super Night Vision | Parking Mode |
| ADAS | Disabled |
| Speed Stamp | Enabled |
| Safety Camera | Enabled |

FAQ & Help Desk

—

Still have questions or issues?

For further assistance or to report any issues, please contact our support team.

- **North America**
1 [844-865-9273](tel:844-865-9273)
support@thinkware.com
- **United Kingdom**
44 (0) 333-121-0008
support.eu@thinkware.com
- **European Union**
(+49) 69-943-22200
support@thinkware.com



FAQs & Help Desk

Please refer to CS Information **QR** in the box for other countries.

Documents / Resources

| | |
|---|--|
| <div>THINKWARE DASH CAM™ Quick Start Guide</div> <div>Q1000</div> | <div>THINKWARE Q1000 Wi-Fi Dash Cam [pdf] User Guide</div> <div>Q1000 Wi-Fi Dash Cam, Q1000, Wi-Fi Dash Cam, Dash Cam, Cam</div> |
|---|--|

References

- [User Manual](#)

Manuals+. [Privacy Policy](#)

This website is an independent publication and is neither affiliated with nor endorsed by any of the trademark owners. The "Bluetooth®" word mark and logos are registered trademarks owned by Bluetooth SIG, Inc. The "Wi-Fi®" word mark and logos are registered trademarks owned by the Wi-Fi Alliance. Any use of these marks on this website does not imply any affiliation with or endorsement.