



Thinklabs TL1001 Digital Stethoscopes with Ambient Noise Rejection User Guide

[Home](#) » [Thinklabs](#) » Thinklabs TL1001 Digital Stethoscopes with Ambient Noise Rejection User Guide 



Quick Reference Guide

Contents

- [1 TL1001 Digital Stethoscopes with Ambient Noise Rejection](#)
- [2 Tips for Optimal Use](#)
- [3 Charger Connection](#)
- [4 Headphone and Audio Connection](#)
- [5 Controls & Display](#)
- [6 Package Contents](#)
- [7 Documents / Resources](#)
- [8 Related Posts](#)

TL1001 Digital Stethoscopes with Ambient Noise Rejection

Congratulations. You now own a state-of-the-art auscultation instrument made with advanced technology and fine materials. Thinklabs One is designed for the most discerning users who seek the highest quality.

This Quick Reference is your initial guide to using your Thinklabs One. The best-designed products are easy to use, with more advanced features hidden below the surface, available to those who require them. Use this Guide to familiarize yourself with the basic functions and then go to our website to explore One in more depth, according to your needs.

Go to <http://thinklabsone.com/manual> for a detailed User's Manual
<http://thinklabsone.com/support> for Customer Support

Tips for Optimal Use

Instructions – There's a lot more to learn – see <http://thinklabsone.com/manual>

Sound Levels – Do not set your stethoscope volume louder than necessary. Adjust the volume so that heart and lung sounds are clear and comfortable to hear. Protect your hearing!

Diaphragm Pressure and Skin Contact – Making skin contact will provide you with the best sound quality. If you do listen through clothing, avoid listening through thick garments.

Headphone Fit – Make sure your headphones are as sealed as possible against outside noise to enhance your listening. Use Thinklabs headphones or other high-quality headphones.

Cleaning – Use alcohol or other cleaning agents, but do not allow liquids inside One.

Charger Connection

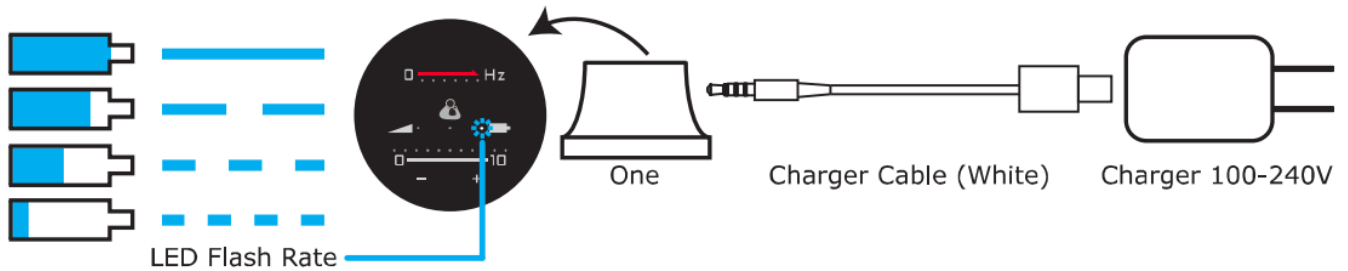

 Charge only at ambient temperature 5-35C (41-95F)

Headphone and Audio Connection

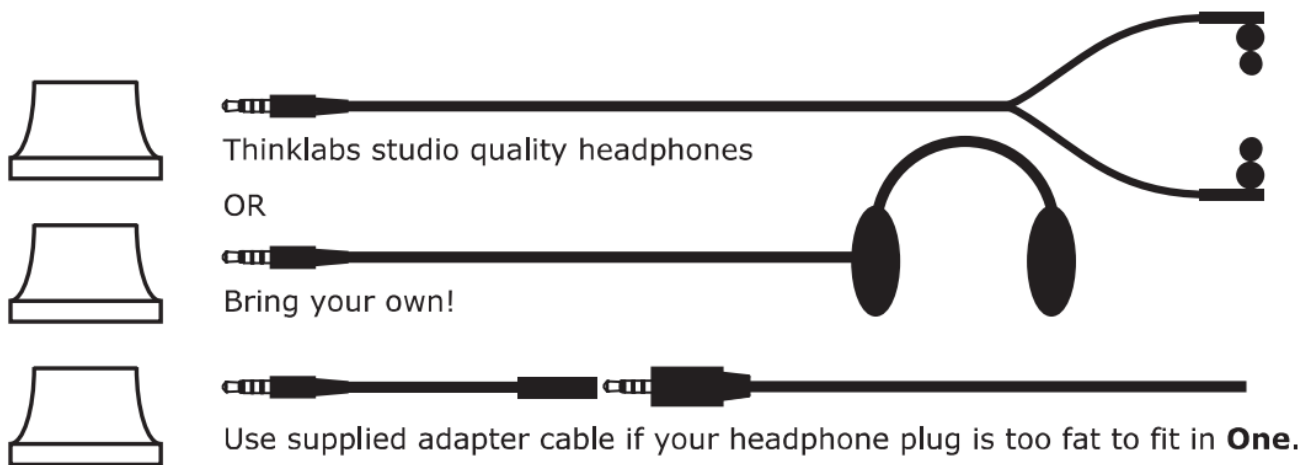

-  For best sound quality, use headphones with strong bass and good fit.
- Ensure that plug is pushed all the way in!
- OK to use cell phone headphones with built-in microphones.
- Thinking – For Connections to smartphones/tablets/computers, see <http://thinklabsone.com/thinklink>
- Hearing Aid Connections – see <http://thinklabsone.com/hearing>

Controls & Display

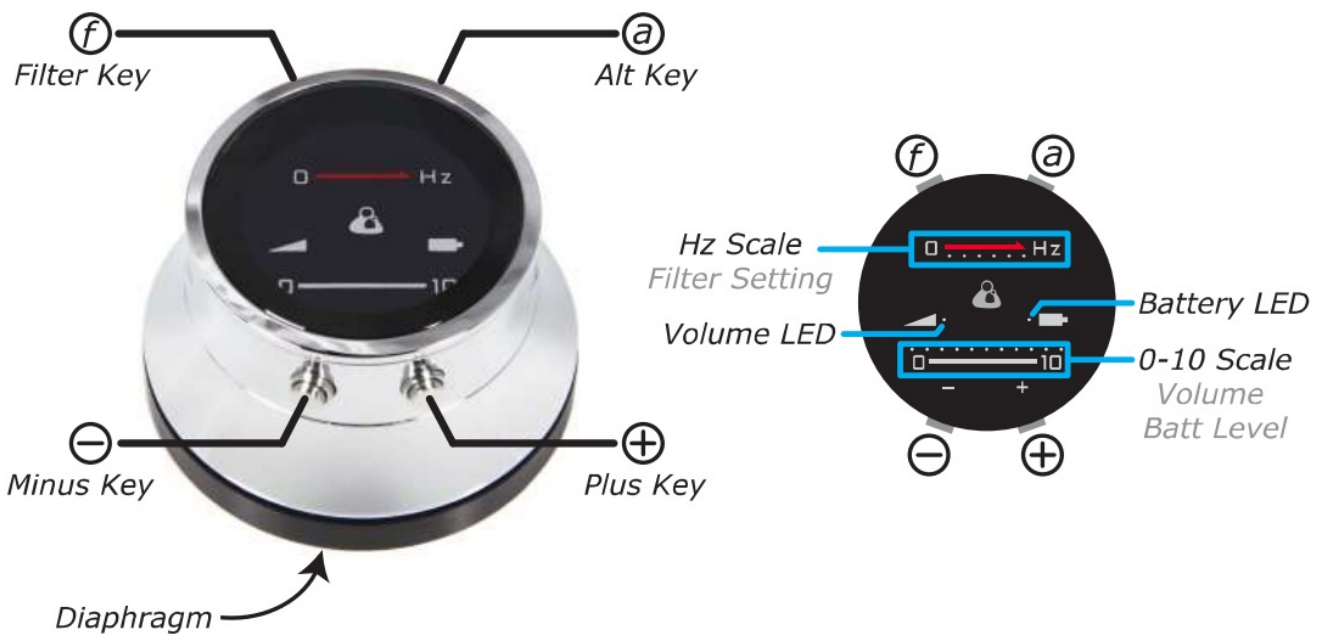

1. Power On / Off

Power On – Hold ANY Key until the power turns on.

Power Off – Push & Hold **a** and **-** simultaneously for 2 seconds, then release.

Auto Shutoff – Your One will shut off automatically after the preset auto shutoff time.



2. Volume Control & Display

Click **-** or **+** adjust Volume Level. Hold keys to step quickly up or down.



To reduce the risk of tinnitus or hearing loss, Aja listens at moderate volume levels.

3. Filter Selection & Display



Filters selectively amplify low, medium, or high-pitched sounds, to select for low-pitched heart sounds, mid-range murmurs, or high-pitched lung sounds. One has multiple filters for greater control over the sound than stethoscopes limited to the choice between Bell or Diaphragm.

- Pitch (i.e. frequency) is measured in Hertz (Hz) and displayed graphically on a low-to-high Hz Scale, which shows relative frequency range – filters that amplify low-pitched sounds show LEDs towards the left, filters for higher-pitched sounds show LEDs towards the right.
- See <http://thinklabsone.com/filters> for further explanations and details. Select Filter – a. Hold f Key for 2 seconds. b. Release Key when LEDs change. c. Repeat to cycle through filters.

Select Filter

- a. Hold f Key for 2 seconds.
- b. Release Key when LEDs change.
- c. Repeat to cycle through filters.

Set two “Favorite Filters”

- select 1st filter, select 2nd filter, then alternate easily between the two selections:

1.

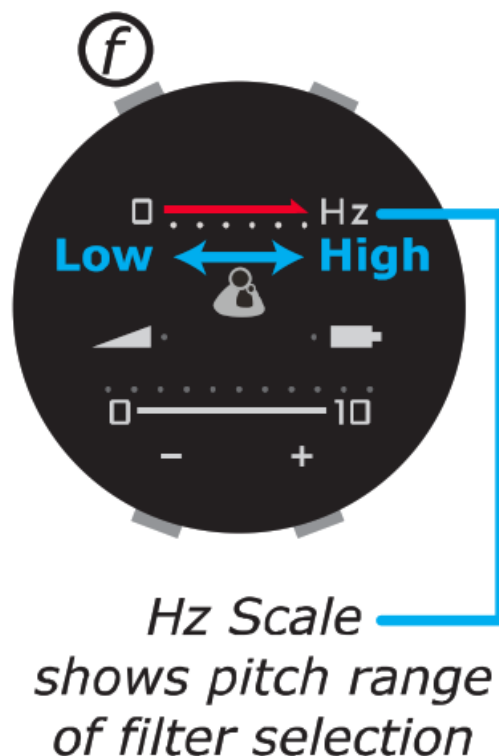

Select 1st Favorite – Steps a through c above.

2. Click (do not hold) f Key.
3. Select 2nd Favorite – Steps a through c again.
4. Click (do not hold) f Key to alternate between Favorites.
5. To use any other filter, simply do Steps a through c anytime and the Favorite you're currently using will be changed.

4. Battery Level Check To Check Battery Level:

1. Push any key to Power On.
2. Push & Hold **a** and **-** simultaneously for 2 seconds.
3. Battery Level flashes across 0-10 Scale when One powers off.



i Typical battery life in use " 240 minutes active listening. Standby/Power Off time > 4 weeks.

5. Setting Auto Shutoff Time

Start with One in the Power Off condition.

1. Turn Power On.
2. Click **a** Key once for each minute of the desired auto shutoff time. For example, click **a** Key 3 times for a 3 minute shutoff time.
3. Push and HOLD **a** Key until One shuts off ("10 seconds).

- **i** Factory Default = 2-minute auto shutoff time.
- The allowable range is one to ten minutes (1 – 10 clicks).
- To DISABLE Auto Shutoff (unit stays on), do 12 Clicks in step 2 above.

For Detailed User's Manual, Support Complete Manual Support

<http://thinklabsone.com/manual>

<http://thinklabsone.com/support>

+1.800.918.1088

+1.303.525.3458

Warranty

2 Years Limited Warranty <http://thinklabsone.com/warranty>

Warranty Thinklabs Medical LLC <http://thinklabs.com>

1.800.918.1088

1.303.525.3458

Package Contents

Thinklabs One Digital Stethoscope Thinklabs In Ear studio quality headphones Spare Eartips (Small, Medium, Large pairs provided) USB Style Battery Charger (100-240V worldwide use), US-style plug Carrying Case Charger Cable (white) Headphone (10cm) male-female adapter Think link:
Thinking switching system for recording and monitoring

Male-Male long cable (1m, black)	– Connects One to Thinklink switch.
Male-Male right angle connector	– Connects Thinklink to mobile device.
Male-Male – short cable (10cm)	– Alternative to right angle connector.

Quick Reference (this document) Regulatory and Warning Information (accompanying document)
 © 2014 Thinklabs Medical LLC. All Rights Reserved. Thinklabs is a Registered Trademark and Thinklabs One is a Trademark of Thinklabs Medical LLC. Quick Reference V1.0 Visit <http://thinklabs.com> for more information.
 Thinklabs products are protected by US and foreign patents.

Documents / Resources

	<p>Thinklabs TL1001 Digital Stethoscopes with Ambient Noise Rejection [pdf] User Guide TL1001 Digital Stethoscopes with Ambient Noise Rejection, TL1001, Digital Stethoscopes with Ambient Noise Rejection, Ambient Noise Rejection, Noise Rejection, Rejection</p>
---	--