

# THETFORD SANICON Turbo 700 Owner's Manual

[Home](#) » [THETFORD](#) » THETFORD SANICON Turbo 700 Owner's Manual



Congratulations and thank you for purchasing a Thetford product.

## Owner's Manual

### Contents [ [hide](#) ]

- [1 Overview](#)
- [2 Tank assembly](#)
- [3 Operation](#)
- [4 Troubleshooting](#)
- [5 Documents / Resources](#)
- [6 Related Posts](#)

## Overview

Congratulations on your purchase of the Sani-Con Turbo system – the cleanest, most sanitary, and convenient way to empty your RV holding tank!



Read and understand the warnings listed in this document before you operate or service this system. If you do not obey these warnings there is a risk of property loss, injury, or electrocution. Do not make any changes to this unit as this could result in property damage, injury, or electrocution.

Thetford Corporation accepts no responsibility or liability for damage to equipment, injury, or death that may result from the system's improper installation, service, or operation.

Thetford Corporation recommends that plumbing and electrical work be performed by a licensed tradesperson. Local permit and code compliance is required.

## Cautions and Warnings

Read and understand the warnings and cautions listed in this document before you operate, or service this unit.



Wear appropriate personal protective equipment when using the Sani-Con system.



Do not make any changes to this unit, as this could result in property damage or injury.

- **Flush only organic human waste and toilet tissue.** Do not flush non-dissolving articles such as feminine hygiene products, paper towels, or moist towelettes, as this will damage the macerator and will **void your warranty**.
- To avoid pump failure, if you are using an accessory garden hose on the end of the nozzle, make sure that the inner diameter of the hose is 3/4 in. (1.9 cm) or greater.



Do not let the pump run dry, as this could damage the macerator.

## Questions?

If you have any questions or need assistance, please contact Customer Service at 1-800-543-1219, available Monday through Friday 8 a.m. to 6 p.m., Eastern Standard Time.

## Tank assembly

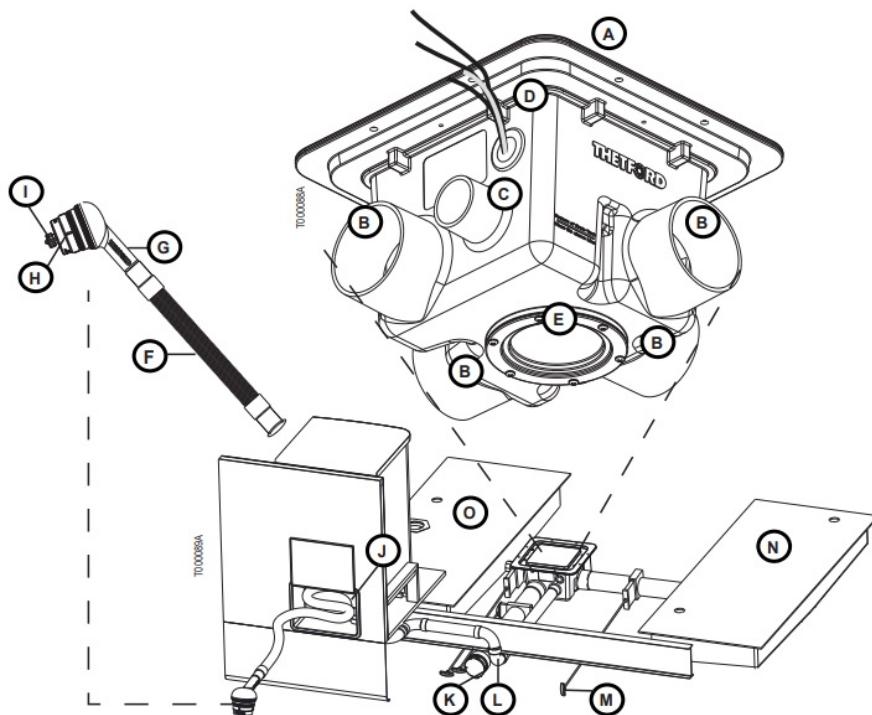

Fig. 1

## NOTICE

Actual installations may vary.

- A. Sanson TurboTank Assembly.
- B. 3" Inlet Ports (4x).
- C. 5" Discharge Port.
- D. Wire Lead Exit.
- E. Pump Impeller Access Cover.
- F. 5" Discharge Hose.
- G. Universal Nozzle.
- H. Large Nozzle Cap.
- I. Small Nozzle Cap.
- J. Hose Storage Compartment.
- K. Bayonet RV Drain (manual override).
- L. Hard plumbing to discharge hose.
- M. Gate Valve (black, gray, manual over-ride); the number of valves varies according to the coaching setup.
- N. Gray Tank.
- O. Black Tank.

## Operation

### ATTACH TO PUMP STATION

## NOTICE

Refer to the **Fig. 1**.

1. Open hose storage compartment (**J**); pull out the hose (**F**) and nozzle (**G**) with caps; do not disconnect from the coach.

## NOTICE

Remove cap (**H**) for full hose extension.

1. Unscrew large nozzle cap (**H**).
2. Attach universal nozzle (**G**) to dump station.

### BLACKWATER TANK

## NOTICE

Refer to the **Fig. 1**

1. ENSURE universal nozzle (**G**) is securely attached to the dump station! Refer to the "Attach to Dump Station" procedure.

## NOTICE

TIP For Cleaner Storage: Emptying the black water tank first, allows gray water to cleanse the system.

1. Open black water tank gate valve (**M**).

2. Turn pump on.
3. Do not leave unit unattended; a full 40-gallon tank takes approximately one minute to empty.

**NOTICE**

TIP: The hose expands as fluid moves to the dump station and contracts when the tank is empty.

1. Turn pump off.
2. Close black water tank gate valve (**M**).

**EMPTY GRAY WATER TANK(S)****NOTICE**

Refer to the **Fig. 1**

1. ENSURE universal nozzle (**G**) is securely attached to the dump station! Refer to the "Attach to Dump Station" procedure.

**NOTICE**

TIP For Cleaner Storage: Emptying the black water tank first, allows gray water to cleanse the system.

2. Open gray water tank gate valve (**M**).
3. Turn pump on.
4. Do not leave the unit unattended; a full 40-gallon tank takes approximately one minute to empty.

**NOTICE**

TIP: The hose expands as fluid moves to dump station and contracts when the tank is empty.

5. Turn pump off.
6. Close gray water tank gate valve (**M**).
7. Repeat Steps 2-6 for secondary gray tanks.

**NOTICE**

Gray water bypass is possible if the discharge plumbing does not flow upward.

**PREPARE HOSE FOR STORAGE****NOTICE**

Refer to **Fig. 1**.

1. Ensure pump is off.
2. Drain hose (**F**) by holding at a sloped angle to direct excess water into the dump station.

**NOTICE**

TIP For Faster Draining: Leave gray gate valve (**M**) open allowing hose to vent and expediting the process.

3. Disconnect nozzle (**G**) from dump station.
4. Install cap(s) (**H, I**).

5. Return hose to coach hose compartment ( **J** ); leave the hose connected to coach.

### Helpful Hints

- Empty the black water first. Use gray water to rinse the hose after evacuating the black water.
- Additional hoses can be purchased from Thetford and used to extend the length of the evacuation hose. Connect the hoses using 1.5 in. (3.8 cm) barbed coupling with a clamp.
- If you wish to extend the evacuation hose, connect a 3/4 in (1.9 cm) inner diameter garden hose to the end of the nozzle. Do not extend the hose beyond 150 (45 m).

### NOTICE

A longer evacuation hose reduces the flow rate.

- Before storing the hose, make sure that all liquid has drained from the hose.

### NOTICE

Gray water bypass is possible if the discharge plumbing does not flow upward.

### Obstruction Removal

### NOTICE

Dismantling the system can potentially cause the need for a new O-ring. Be sure to have a #238 Buna N O-Ring (1x) on hand before following the steps below. Service kits are available for purchase directly from Customer Service.

1. Ensure all contents have been drained from the system. If manual over-ride ( **K** ) has been installed, remove bayonet cap, and open gate valve ( **M** ) to drain system Contents.

### NOTICE

Be sure to have a container available for capturing system fluid.

2. Locate Impeller Access Cap ( **E** ); remove screws (6x).
3. Remove obstruction from impeller housing (not shown – located above ( **E** ).

### CAUTION

Do NOT remove pump lower housing. Obstruction MUST be removed through an impeller inlet.

4. Replace the O-Ring, Access Cap, and Screws. Service Kit comes with all new parts needed to reassemble.

### CAUTION

Install screws in a star pattern. Do NOT exceed 20 in. lb. torque.

5. Ensure manual over-ride bypass gate valve ( **M** ) is closed; reattach bayonet cap.
6. Operate the system using gray water; check for leaks.

### Manual Over-ride (Optional)

### NOTICE

Optional installation. It May not be installed on your unit.

1. Locate manual over-ride connection ( **K** ); remove the bayonet cap.

2. Connect 3" sewer hose (not supplied): one end to (K), another end to dump station.
3. Open manual over-ride gate valve.
4. Open Black Water gate valve; allow contents to drain.
5. Close Black Water gate valve.
6. Open Gray Water gate valve; allow contents to drain.
7. Close Gray Water gate valve.
8. Close manual over-ride gate valve.
9. Disconnect and clean sewer hose.
10. Install Manual Over-ride Bayonet Cap (K).

### **Winterizing the Sani-Con Unit**

1. Ensure all tanks are empty.
2. Pour RV antifreeze into the empty black water tank (O).

#### **NOTICE**

Be sure to have a container available for capturing system fluid.

3. Turn on pump.
4. Run the pump until the antifreeze begins to discharge from the universal nozzle (G).
5. Turn pump switch to the Off position.
6. Drain hose (F) by holding at a sloped angle to remove excess water; return hose to the storage position.

### **Troubleshooting**

#### **Troubleshooting**

Problem	Solution
Waste discharge pressure stops or decreases dramatically.	<ul style="list-style-type: none"> <li>• Are the holding tanks empty?</li> <li>• With the pump on, look for a location where hose expansion differs; check for obstruction at that point.</li> <li>• Turn the pump switch to the Off position:</li> <li>• To CHECK FOR OBSTRUCTION IN HOSE ( <b>F</b>): Visually check for foreign matter lodged in the hose by running your hand along with the hose.</li> <li>• TO CHECK FOR OBSTRUCTION IN IMPELLER: Look through clear access cap ( <b>E</b>) on pump for obstruction. Note: Fluid contents in the system may prevent visual inspection.</li> <li>• Failure to clear a clog could cause damage to the pump, which will void the warranty.</li> </ul>
The pump operates, but no liquid is expelled.	<ul style="list-style-type: none"> <li>• Are the holding tanks empty?</li> <li>• Check that the RV gate valves are open.</li> <li>• The pump may be clogged.</li> </ul>
The motor will not run.	<p>Make sure:</p> <ul style="list-style-type: none"> <li>• The pump is turned on.RV battery is charged.</li> <li>• The circuit breaker/fuse is functioning.</li> <li>• The pump is receiving voltage.</li> <li>• A foreign object is not preventing impeller operation</li> </ul>
How do I disassemble the system to check for an object lodged in the pump?	Refer to “Obstruction Removal” on page 7

## Warranty

For defined warranty terms, review the one-page warranty statement – see [www.thetford.com](http://www.thetford.com).

### **NOTICE**

Please give Serial Number (located on the tank sticker) for calls to customer service and warranty issues.

## Service Kits

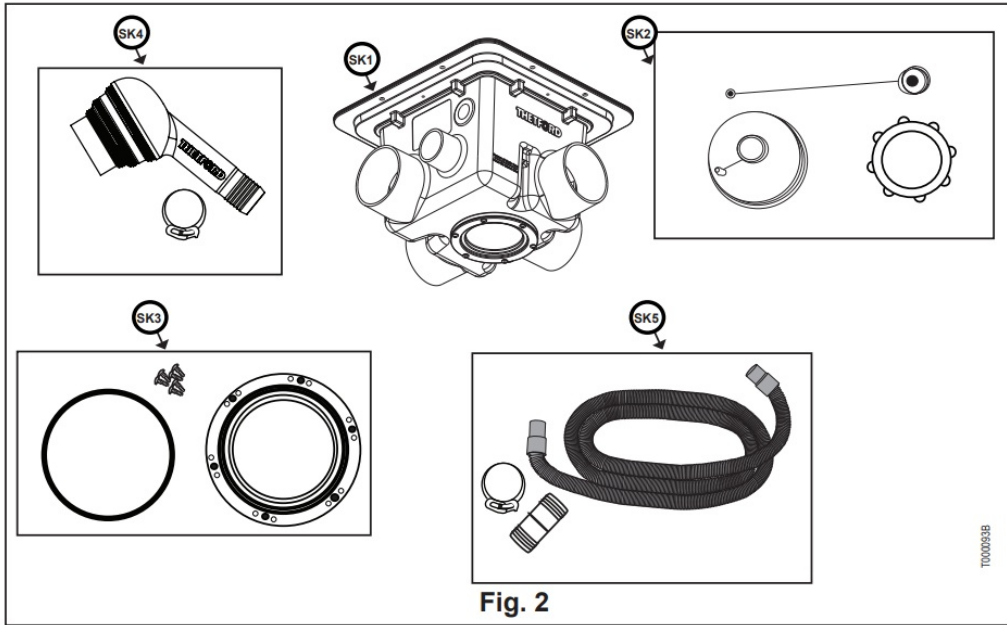

Ref	No. N° N.º	Description
SK1	97518	Tank Assembly
SK2	97514	Nozzle Cap, Garden Hose Cap, Nozzle Gasket
SK3	97517	Access Cover, O-Ring, Screws (6x)
SK4	97520	Nozzle, Clamp
SK5	97521	Hose, Clamp, and Coupler

### Questions?

See your dealer for more information about Thetford products.  
Or, write or call:



Place the serial number sticker in this box.

[www.thetford.com](http://www.thetford.com)

Printed in U.S.A.  
Sani-Con Turbo

## Documents / Resources

	<p><a href="#">THETFORD SANICON Turbo 700</a> [pdf] Owner's Manual THETFORD, SANICON, TURBO 700</p>
---	---

## Related Posts



### [Smart Soundbar 700 User Manual](#)

Smart Soundbar 700 User Manual - Optimized PDF Smart Soundbar 700 User Manual - Original PDF



### [2021 Encore Owner's Manual](#)

2021 Encore Owner's Manual - Optimized PDF 2021 Encore Owner's Manual - Original PDF



### [2021 Explorer Owner's Manual](#)

2021 Explorer Owner's Manual - Download [optimized] 2021 Explorer Owner's Manual - Download



### [Hughes HIRD-D45 Owner Manual](#)

Hughes HIRD-D45 Owner Manual - Original PDF Hughes HIRD-D45 Owner Manual - Optimized PDF