

# THESTREAMER PROONE8K Network Media Player User Manual

## THESTREAMER PROONE8K Network Media Player

### Contents

- [1 Interface](#)
- [2 Package content](#)
- [3 Installation](#)
- [4 Remote](#)
- [5 Using remote to control TV](#)
- [6 FCC Statement](#)
- [7 Documents / Resources](#)
  - [7.1 References](#)
- [8 Related Posts](#)

### Interface

1. LED indicator
2. Display
3. 2.5" SATA HD □ slot
4. 2 x Wi-Fi antennas
5. Optical S/PDIF output
6. Analog stereo audio output
7. HDMI 2 .1a output
8. Ethernet 10/100/1000
9. 12V DC input
10. Power ON/OFF switch
11. USB2.0 host
12. 2 x USB 3.0 host
13. USB 3.0 slave host

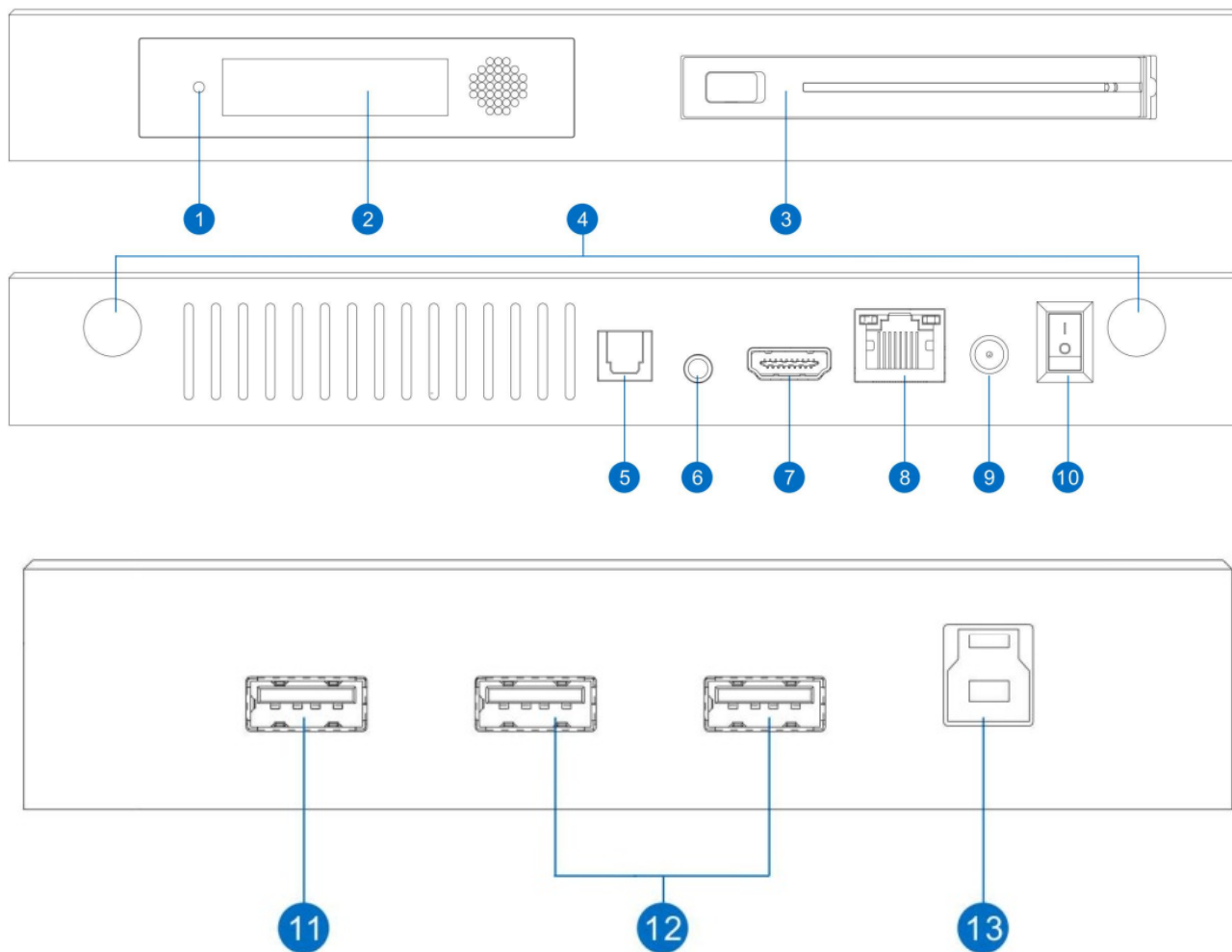

## Package content

1. Dune HD player
2. Power supply
3. HDMI cable
4. Remote control
5. 2 x AAA batteries
6. Quick start guide

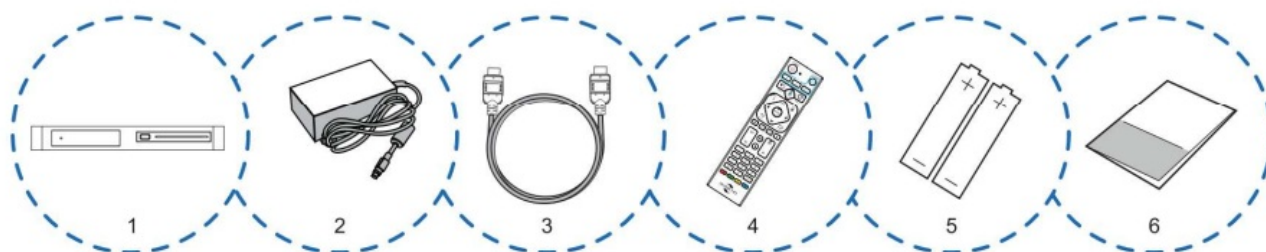

## Installation

1. Connect your Dune HD Player to TV by HOM I-cable
2. Connect the power adaptor

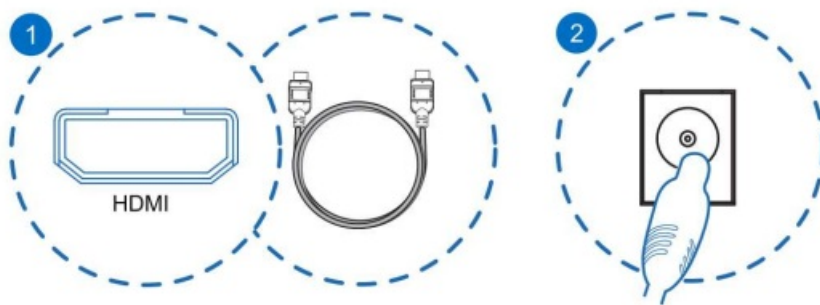

3. Use Ethernet-cable (not included) to connect Dune HD player to the Internet (or use Wi-Fi)
4. Turn on the Dune HD player and TV. Choose the proper input on the TV.

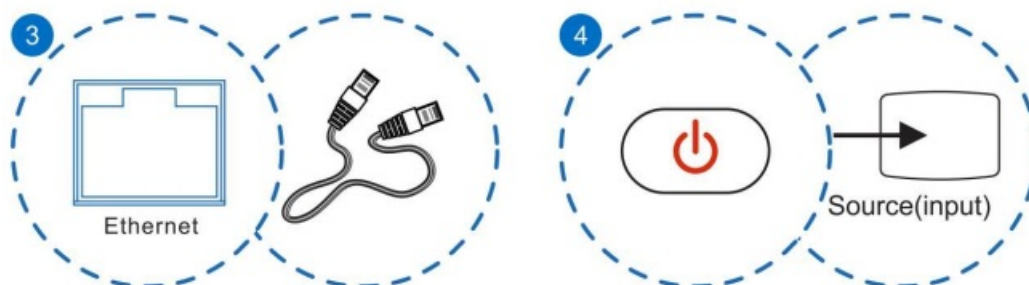

HDMI, HDMI High Definition Multimedia Interface, and the HDMI Logo are trademarks (s or registered trademarks) of HDMI licensing Administrator, Inc.

## Remote

Remote must be paired to the player via Bluetooth before use

1. Direct remote to the player and press any button on the remote, The remote and the player will pair automatically.
  2. If the remote was already paired before, or in case of any problems: press and hold the “ENTER” and “V+” buttons on the remote for 3 seconds to put the remote into pairing mode. Use “Setup “System” / “Remotes & accessories ” menu to unpair and pair the remote again.
- **POWER**- turn the player on/off.
  - TV section (TV DOWN, TV UP, TV INPUT, TV POWER) – learnable buttons to control TV or other equipment (see “Using Remote to Control TV” section).
  - FAV1 – “Recent” menu or user-defined function.
  - FAV2 – “Favorites” menu or user-defined function.
  - MIC – microphone/search.
  - Arrows ( ◀ ▶ ▲ ▼ ), ENTER, RETURN, TOP MENU, POP UP MENU, INFO – main buttons for controlling the player (navigate across the items on the screen, open/use the currently selected item, go back to the previous screen, go to the main menu, show/hide popup menu with actions for the currently selected item or the current player state, show/hide information about the currently selected item or the current player state, control some other player functions).
  - MUTE – turn the sound on/off.

- AUDIO (AUD), SUBTITLE (SUB)- toggle audio tracks and subtitle tracks.
- MOUSE – toggle mouse mode (air mouse).
- ► PLAY/ || PAUSE , STOP – control the playback and some other player functions.
- V+N- (volume up | volume down)- adjust the volume.
- P+/P- (page up | page down) – scroll up and down in various lists, switch to the next/previous TV channel, control some other player functions.
- 0-9 – enter numbers and text; control some other player functions.
- CLEAR – delete the last entered character, delete the currently selected item, control some other player functions.
- SELECT – switch text input mode, add the item to the selection list, control some other player functions.
- A (Red), B (Green), C (Yellow), D (Blue) – control various player functions.



**NOTE:** Button support and functions depend on particular applications.  
Not all apps support all buttons.

## Using remote to control TV

You can program 4 learnable buttons (located in “TV” section: “TV DOWN”, “TV UP”, “TV INPUT”, “TV POWER”) to control your TV or other equipment:

1. Press and hold the “TV UP” and “TV DOWN” buttons on the remote for 3 seconds.
2. Press one of 4 learnable buttons on the remote.
3. Place your remote and the other remote on a table so that the IR emitters of both remotes are directed towards each other and are at a distance of about 1 cm.

4. Press and hold a button on the other remote until the LEO indicator on your remote stops blinking. This means that the button learning is complete.
5. Learn other buttons the same way if needed (repeat steps 1-4).

Reset Remote to Factory Defaults: Press and hold "ENTER" and "TOP MENU" buttons on the remote for 3 seconds.

**More information on functions of the remote:** [Dune-HD.com/support/rcu](http://Dune-HD.com/support/rcu)

## FCC Statement

This equipment has been tested and found to comply with the limits for a Class B digital device, pursuant to part 15 of the FCC Rules. These limits are designed to provide reasonable protection against harmful interference in a residential installation. This equipment generates, uses and can radiate radio frequency energy and, if not installed and used in accordance with the instructions, may cause harmful interference to radio communications. However, there is no guarantee that interference will not occur in a particular installation. If this equipment does cause harmful interference to radio or television reception, which can be determined by turning the equipment off and on, the user is encouraged to try to correct the interference by one or more of the following Reorient or relocate the receiving antenna.

Increase the separation between the equipment and receiver.

Connect the equipment into an outlet on a circuit different from that to which the receiver is connected.

Consult the dealer or an experienced radio/TV technician for help.

Caution: Any changes or modifications to this device not explicitly approved by manufacturer could void your authority to operate this equipment.

This device complies with part 15 of the FCC Rules. Operation is subject to the following two conditions: **(1)** "this device may not cause harmful interference, and **(2)** this device must accept any interference received, including interference that may cause undesired operation.

## RF Exposure Information

This equipment complies with FCC radiation exposure limits set forth for an uncontrolled environment. This equipment should be installed and operated ,with minimum distance 20cm between the radiator and your body.



---

## Documents / Resources

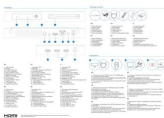
	<p><a href="#">THESTREAMER PROONE8K Network Media Player</a> [pdf] User Manual PROONE8K Network Media Player, PROONE8K, Network Media Player, Media Player, Player</p>
---	--

## References

- [User Manual](#)

[Manuals+](#), [Privacy Policy](#)