



Polytherm WT032 Programmable Thermostat Operation Manual

[Home](#) » [Thermostat](#) » Polytherm WT032 Programmable Thermostat Operation Manual 

Contents

- 1 [Operation Manual](#)
 - 1.1 [Polytherm WT032 Programmable Thermostat](#)
- 2 [Before installation](#)
- 3 [Installation location](#)
- 4 [Operation](#)
- 5 [Specification](#)
- 6 [Related Posts](#)

Operation Manual





Polytherm WT032 Programmable Thermostat

Before installation

Warning

Turn off the thermostat, electronic source and the electrical devices which will be connected before installation and maintenance.

⚠ CAUTION

The installation must be done by trained service personnel.

Installation location

The thermostat should be mounted on an inner wall, 1,5 m above the floor. Prevent direct exposure to sunlight, dripping or splashing area.

Do not place the unit at a location where air circulation is low, or where there are great temperature changes (e.g. near door). Do not place the thermostat near heat generating sources (radiators, hot air vents, TV or lights).

Opening the cover

Pull out the battery drawer and use a screwdriver to press on the spot shown below in order to detach the front Shell from its base as shown in the figure.

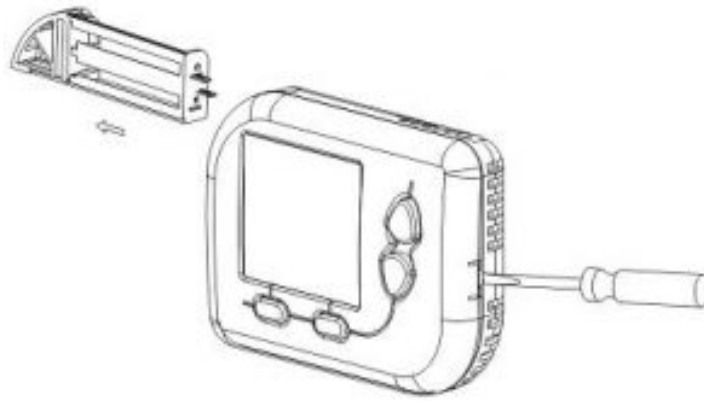

Wiring the terminal

There are 3 wiring terminals at the back of the thermostat which is labeled as “COM”, “NO” and “NC” as shown in the figure 2. The recommended wire ranges are AWG 14 – 22.

Symbols	Terminals
COM	24-230 Vac
NO	Normally open valve
NC	Normally closed valve

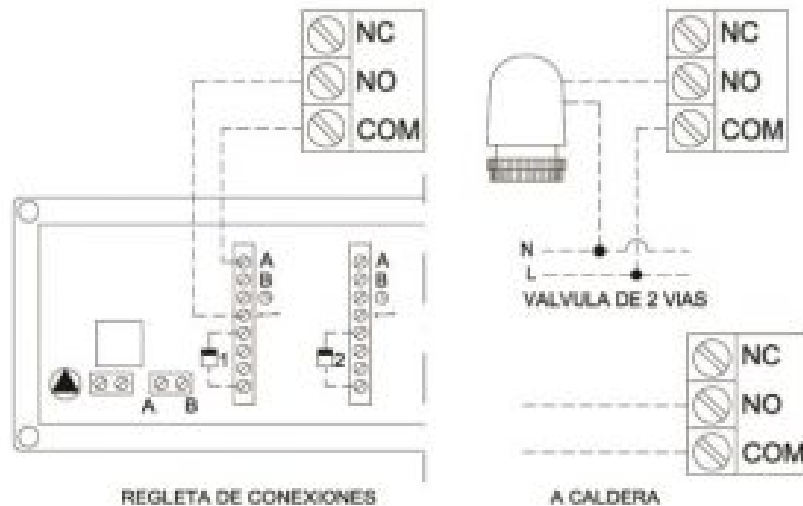

Mounting

Ensure the surface is leveled.

Place the cables at the hole near the terminal block.

Insert 2 pcs of wall anchors into the holes of the wall.

Fasten the thermostat with 2 pcs of long screws through the 2 mounting holes as shown in the figure 3.

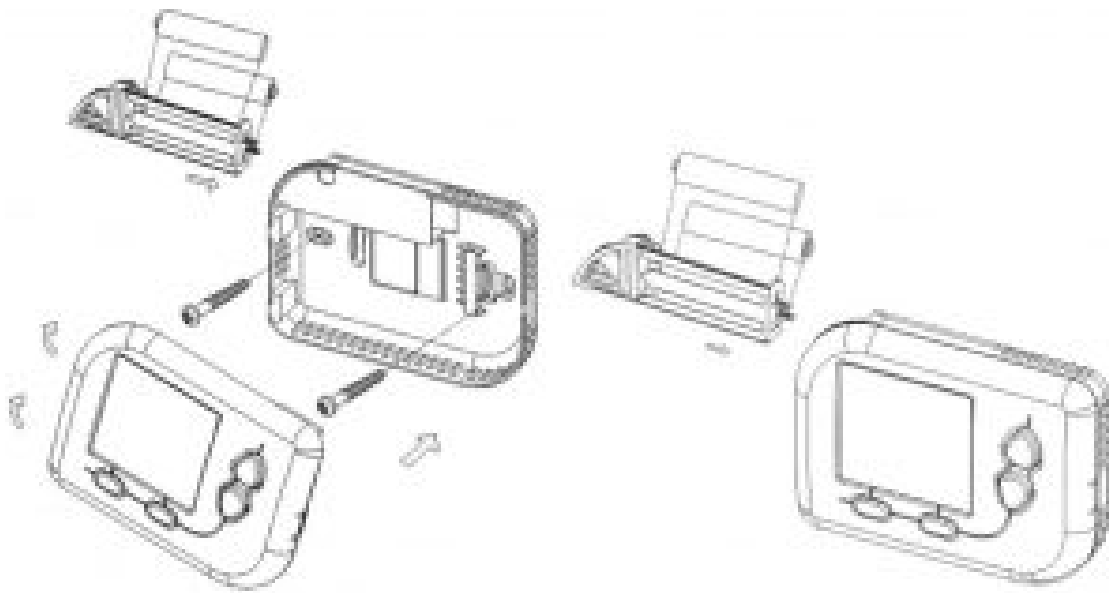

Batteries insertion

Pull out the battery drawer and insert two fresh AAA alkaline batteries into the drawer according to the polarity marked inside; then slide the drawer back into place as shown in the figure

Basic key and operation

When the unit is powered on, all the LCD segments are ON and go to normal display mode.

Key interface

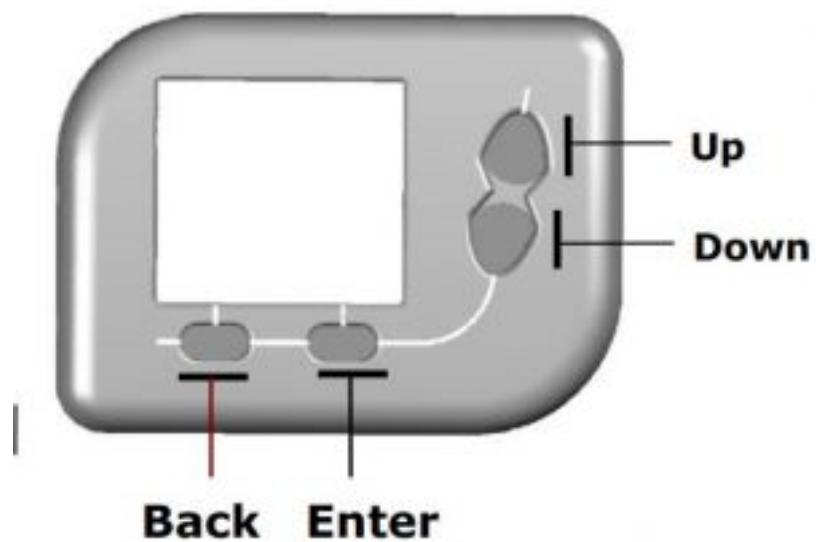

Keys	Function
Up	Setting value increase
Down	Setting value decrease
Back	Back key (Multifunction)
Enter	Enter key (Multifunction)

Normal display mode

Temperature measurement starts. Room & Current time will be displayed.

Program setting mode

Press the ENTER key in normal display mode to enter program setting mode. Select different item to set by pressing UP or DOWN button.

Setting cool/heat



When it is flashing on the display, press ENTER key.
Press UP or DOWN to select heat or cool mode.
Press BACK key to confirm the setting and go back.

Setting hour



When it is flashing the display, press ENTER key.

Press UP or DOWN to adjust day.
Press ENTER to select hour.
Press UP or DOWN to adjust hour.
Press ENTER to select minute.
Press UP to assign the comfort time slot.
Press DOWN to assign economic time slot.
Press ENTER to select another program to set.
Press BACK to confirm and go back.

Setting program



When it is flashing on the display, press ENTER Key.
Press UP or DOWN to change the program number
That the program will be edited (P8-P15)
Press ENTER to start setting the program
Press UP to assign the comfort time slot
Press DOWN to assign economic time slot
Press ENTER to select another program to set.
Press BACK to confirm and go back.

Assigning program to day



When it is flashing on the display, press ENTER key.

Press UP or DOWN to select the day that the program will be assigned.

Press ENTER

Press UP or DOWN to change the program number for the specified day. (P0-P7 default program or P8-P15 editable program)

Press ENTER to confirm and select another day for assigning program. Press BACK to confirm and go back

Predetermined program “HEAT” P8 and P9

	M	T	X	T	F	S	S
Comfort	6.00 – 10.00					08.00 – 10.00	
	12.00 – 23.00					13.00 – 23.00	
Economic	10.00 - 12.00					23.00 – 08.00	
	23.00 – 06.00					10.00 – 13.00	

Predetermined program “COOL” P10 and P11

	M	T	X	T	F	S	S
Comfort	5.00 – 09.00					05.00 – 09.00	
	11.00 – 23.00					11.00 – 24.00	
Economic	09.00 - 11.00					24.00 - 05.00	
	23.00 – 05.00					09.00 – 11.00	

Function setting mode

Hold the ENTER key for 2 seconds in normal display mode to go to function setting mode. Select different item to set by pressing UP or DOWN Button.

Display time unit 12/24 h

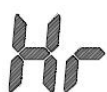

Press ENTER. The value “12” or “24” will be flashing. Press UP or DOWN to select 12/24 Hour display mode.

Delay mode



Press ENTER. The value "Ld" or "Sd" will be flashing. Press UP or DOWN to select Long Delay Mode or Short Delay mode. The minimum off delay will be 5 minutes for Long Delay and 10 seconds for short delay.

NOTE: This setting is applicable for heat mode only. For cool mode, the minimum off delay will remain 5 minutes.

Temperature calibration

Press ENTER. The value of the offset temperature ranging from -3 to 3 degrees will be flashing. Press UP or DOWN to adjust this value to calibrate the measured temperature.

NOTE: If the measured temperature is satisfied, it is not necessary to change this value and thus the value shall remain zero.

Operation

Running the normal display mode. The thermostat would control the temperature according to mode, program and setting.

Program mode

The thermostat controls the room temperature automatically according to setting program.

Each week/day has assigned program. Each program has its own time slot pattern. Either comfort or economic time slot has its own setting temperature.

 /  represent comfort/economic mode is running respectively.

Setting comfort and economic temperature

In normal display mode, simply press UP or DOWN.



If comfort mode is running. Comfort temperature and  will be flashing. Press UP or DOWN to adjust comfort temperature. During comfort temperature is flashing, press ENTER.

Economic mode temperature and  will be flashing. Press UP or DOWN to adjust economic temperature. Press BACK to confirm and return to normal display mode.

Temporary override mode

In normal display mode, press BACK key once.

The thermostat will enter temporary override mode. Either comfort

 or econ  mode icon with , appear in the LCD play. Set the override temperature by pressing UP or DOWN. The thermostat will maintain in temporary override mode until the next transition of comfort / econ state and by then the temporary override mode will be released.

Permanent override mode

In normal display mode, press BACK key twice to enter permanent override mode with  showing in the LCD without comfort or econ icon.

Set the override temperature by pressing UP or DOWN. The thermostat will maintain the permanent override mode. Press BACK key again to release this mode.

Specification

Temperature measurement:	de 0°C~40°C
Accuracy:	±0.5°C
Temperature controllable range:	
<u>Heat:</u>	
Comfort mode:	7°C~35°C
Economic mode:	5°C~33°C
Override mode:	5°C~35°C
<u>Cool:</u>	
Comfort mode:	5°C~33°C
Economic mode:	7°C~35°C
Override mode:	5°C~35°C
Resolution:	0.5°C
Power supply:	2 x AAA pilas alcalinas
Rating:	24 - 230Vac 5(1)A
Terminals:	2mm ² cable
Operating temperature:	0°C~50°C
Storage temperature:	-5°C~50°C
Sensor:	NTC thermistor

LCD



1. Cool
2. Heat
3. Comfort mode
4. Economic mode
5. Override
6. Defrost (<5°C)
7. Output on
8. Low battery
9. Time slot
Black – Comfort
Nothing – Econ
10. Temperature
11. Time
12. Day of the week
13. Program

Temperature display "HI" when temp >40°C and "LO" when temp < 0°C.

Read More About This Manual & Download PDF:

Polytherm WT032 Programmable Thermostat Operation Manual – [Download \[optimized\]](#)

Polytherm WT032 Programmable Thermostat Operation Manual – [Download](#)

Questions about your Manual? Post in the comments!