

THE SHADE STORE®
Wireless Link



THE SHADE STORE Wireless Link User Guide

[Home](#) » [THE SHADE STORE](#) » THE SHADE STORE Wireless Link User Guide 

Contents

- 1 [THE SHADE STORE Wireless Link](#)
- 2 [Product Usage Instructions:](#)
- 3 [The Shade Store Wireless Link – Apple HomeKit](#)
- 4 [The Shade Store Wireless Link – Apple HomeKit](#)
- 5 [How to Customize a Scene in Your Hub](#)
- 6 [How to Customize Your Home App](#)
- 7 [HomeKit Troubleshoot:](#)
- 8 [Finding the Apple Home App on iPhone, iPad, or iPod Devices.](#)
- 9 [Get Stuck on HomeKit — Cannot Delete The Shade Store Wireless Link from Your HomeKit App.](#)
- 10 [FAQS](#)
- 11 [Documents / Resources](#)
 - 11.1 [References](#)

THE SHADE STORE®

THE SHADE STORE Wireless Link



Specifications

- Product: The Shade Store Wireless Link
- Compatibility: Apple HomeKit
- Control: Voice control with Siri

Product Information:

The Shade Store Wireless Link integrates with Apple HomeKit to allow voice control of shades using Siri. It enables precise control of individual or groups of shades.

Product Usage Instructions:

Getting Started:

1. Open the Apple Home App.
2. Add The Shade Store Wireless Link as an accessory.
3. Pair Motorized shades through The Shade Store V2 App.

Controlling Your Shades Through Siri:

To control your shades using Siri, consider renaming shades in The Shade Store V2 App for easier voice commands. You can use voice commands like “Open Living Room Shade” or “Close Bedroom Shade.”

Group Control:

You can control groups of shades by creating rooms in the Home app. Simply ask Siri to open or close a specific room to operate multiple shades simultaneously.

Percentage Control:

You can set shades to any percentage of openness using Siri commands. For example, say “Siri, close the shade halfway” to adjust the shade position accordingly.

Tips:

- Avoid using conflicting words like “blind” or “shade” in The Shade Store V2 App descriptions.
- After changing shade names in the app, force close and reopen The Shade Store V2 App to ensure proper migration of names to Apple Home.

INTEGRATION SUPPORT

THE SHADE STORE WIRELESS LINK OVERVIEW

Take your Automate experience to the next level by integrating The Shade Store motorized shades into Apple HomeKit control systems. The Shade Store Wireless Link is a rich integration supports discreet shade control and features a two-way communication system offering real time shade position and battery level status. The Shade Store Wireless Link supports Ethernet Cable (CAT 5) and Wireless Communication 2.4GHz) for home automate integration using the RJ45 port conveniently located on the back of the hub. Each hub can support integration of up to 30 shades.

ABOUT THE SHADE STORE WIRELESS LINK AND APPLE HOMEKIT

Your Shade Store Wireless Link just got smarter. Apple HomeKit works with The Shade Store Wireless Link to take control of your shades with your voice and Siri. All you need is The Shade Store Wireless Link and a compatible Siri device. This allows you to control individual or groups of shades with precision.

GETTING STARTED:

Go to the Apple Home App and add The Shade Store Wireless Link as an accessory: Proceed to pair Motorized shades through The Shade Store V2 App.

CONTROLLING YOUR SHADES THROUGH SIRI:

To create a seamless experience for handsfree voice activation, consider the natural way you and your family would call a shade on any Siri-enabled device. You may want to consider changing the name from Shade 1 to Living Room Shade in your The Shade Store V2 App.

SIRI COMMANDS

Siri understands natural spoken language like “open the blind” or even “replace the blind with shade”; Siri knows what you meant to say. Siri even understands commands like “open the blind a little bit” and even if you don’t call it the exact name that’s listed in the App, Siri will know what you meant. For example, if the name of the blind is “Kitchen” and the user says, “open the kitchen window”, Siri will ignore the word “window”. Below are the expected commands and responses from Siri.

Voice Command	Expected Shade Movement or response
Close/open <blinds name>	Shade will open/close to top or bottom limit
Close/open <room name> blinds/shades	Room will open/close to top or bottom limit (rooms are setup in the Home App)
Set <blinds names> to <percentage>	Shade will move to the called percentage (100% is open, 0% is closed)
Open/close<blinds names> to <percentage>	Shade will move to the called percentage (100% is open, 0% is closed)
Close/open <blinds name> <a little bit >	Shade will open or close 10% of the total limit to the direction of the called limit
Close/open <blinds names> halfway	Shade will move to 50% from top or bottom limit
Open/close blinds	All blinds in The Shade Store V2 App will follow the open or close command
Open/close shades	All shades in The Shade Store V2 App will follow the open or close command
Raise/lower blinds/shades	All blinds/shades in The Shade Store V2 App will follow the open or close command
Are <blinds name> open?	Siri will respond yes or no your blind is open or closed
What is the position of the <blinds name>?	Siri will respond the percentage of the blind position is X%
What is the battery percentage of the <blinds name>?	Siri will respond either Critical or Normal, Normal is above 50%, Critical means recharge now

GROUP CONTROL:

Another method of operating window shades through HomeKit is through rooms. These rooms need to be setup in the Home app; rooms created in The Shade Store V2 App are not transferred over to Home app. Once a room has been created in the Home app, triggering it to operate, is it as simple as asking Siri to open or close that room.

PERCENTAGE CONTROL:

An individual window shade or group can be sent to any percentage of openness. The percentage will be based on the programmed limits on the motor. A shade that is completely raised to its upper limit is at 0%, while a shade that is completely lowered to its lower limit is at 100%. To move an individual shade only a little down, simply say "Siri close the shade a little bit."

TIPS:

Siri responds to names created in The Shade Store V2 App. Avoid using the words "blind" or "shade" in The Shade Store V2 App description. This will conflict when you say open all blinds. If you have changed the name of your shade in your The Shade Store V2 App, please ensure you force close The Shade Store V2 App, then re-open The Shade Store V2 App. Open the Apple Home app to check the names migrated to Apple Home.

The Shade Store Wireless Link – Apple HomeKit

Initial Setup:

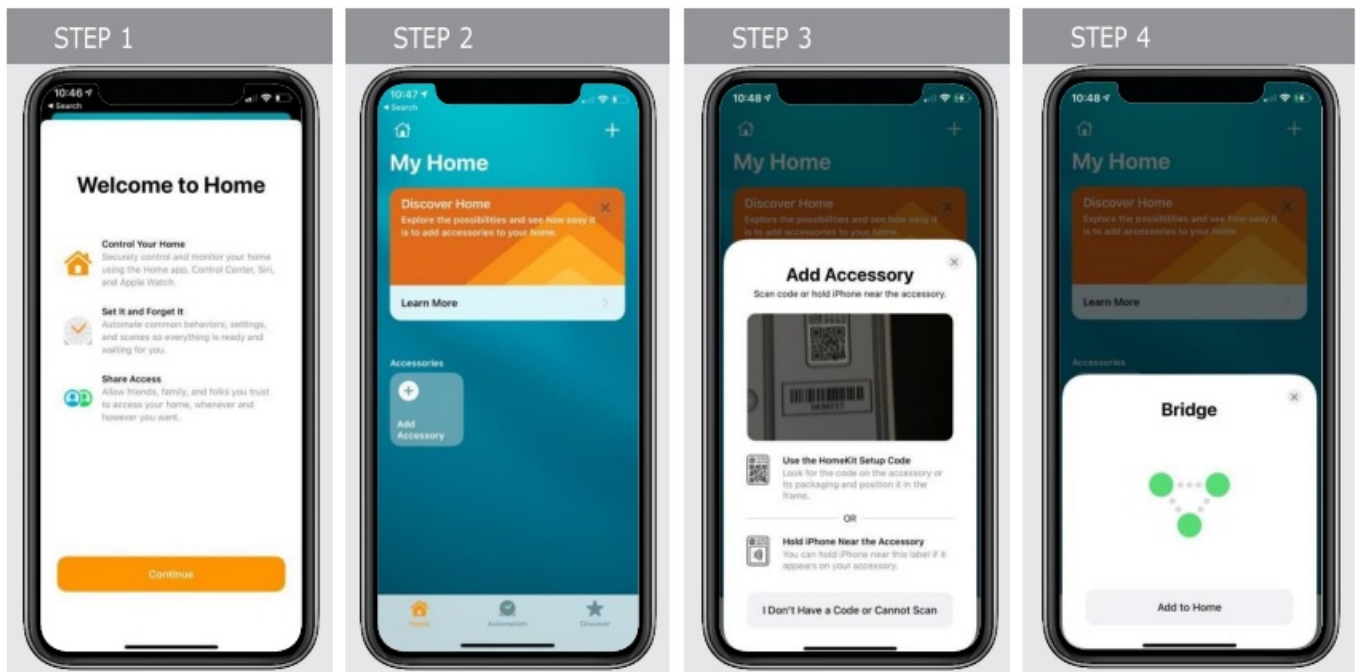

1. Open the “HomeKit” mobile App.
2. From “Add Accessory” at the icon of the page.
3. Scan the QR Code at the rear of the Hub, to synchronize with the HomeKit function of your Apple device.
4. Press the “Add to Home” button on the screen to proceed adding The Shade Store Wireless Link to the home app.

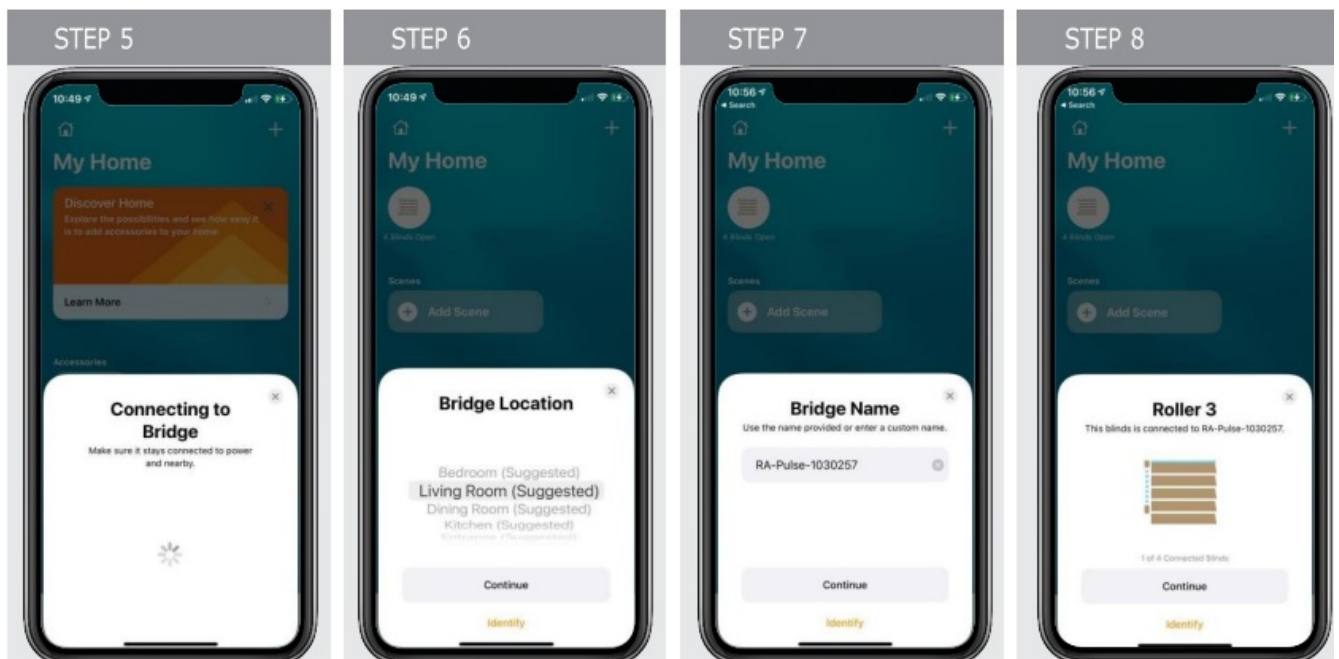

5. The Hub has been added to the HomeKit App.
6. Select a name for the Hub location and press the button to move forward with the configuration.
7. Confirm or edit the Hub name and press the “continue” button to move forward with the configuration.
8. Confirm the shade device and press the “continue” button to move forward with the configuration.

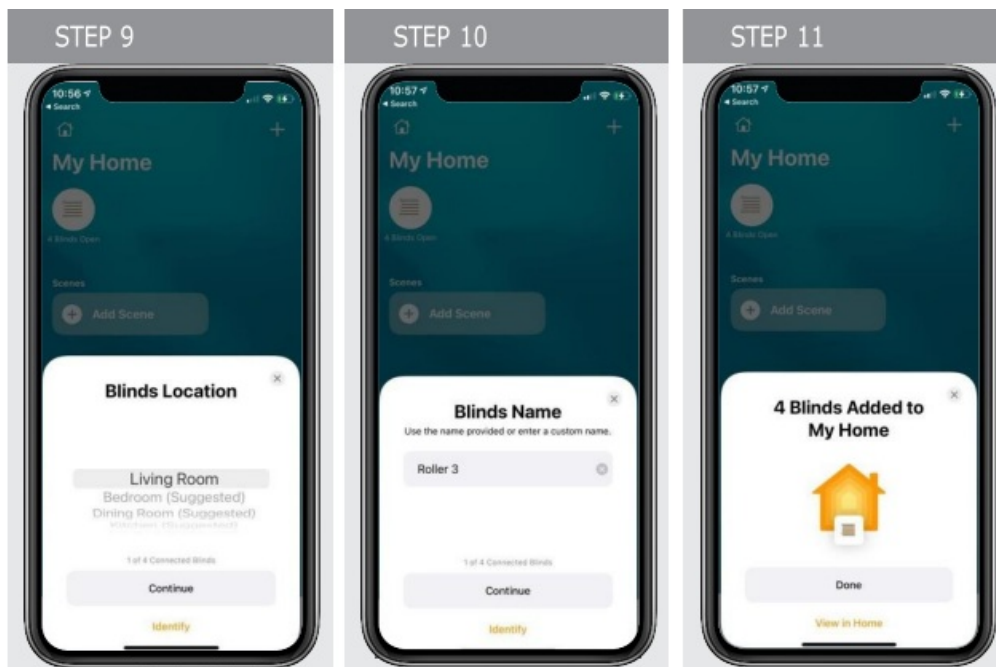

9. Select a name for the Shade location and press the “continue” button to move forward with the configuration.
10. Confirm or edit the shade name and press the “continue” button to move forward with the configuration.
11. The Hub is ready to be used. Press “Done” to start using the HomeKit app to control shades.

The Shade Store Wireless Link – Apple HomeKit

How to Operate the Shades from the Hub App

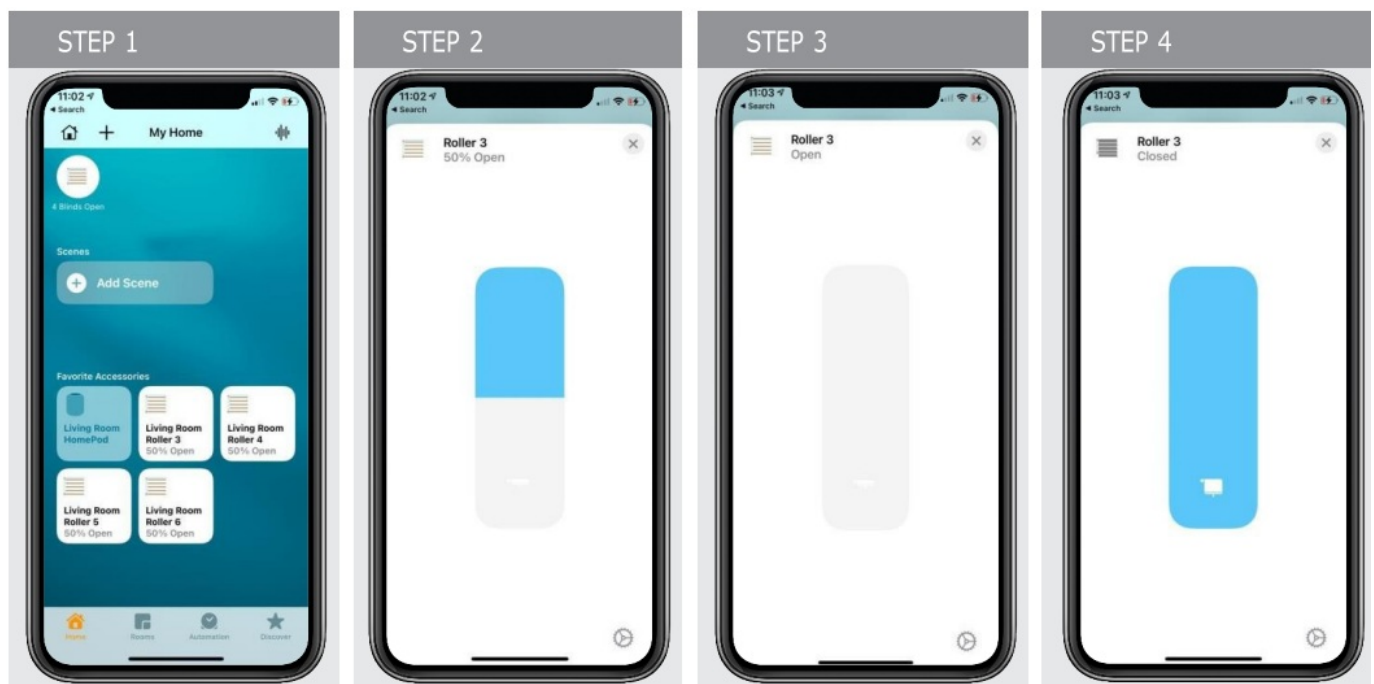

1. On the Home Screen, press and hold the “Shade Icon” to start controlling your shade.
2. Move the shade to any position desired by scrolling the (white) line to any position.
3. Open the shade by scrolling the (white) line to the top position.
4. Close the shade by scrolling the (white) line to the bottom.

How to Create a Scene in the Home App:

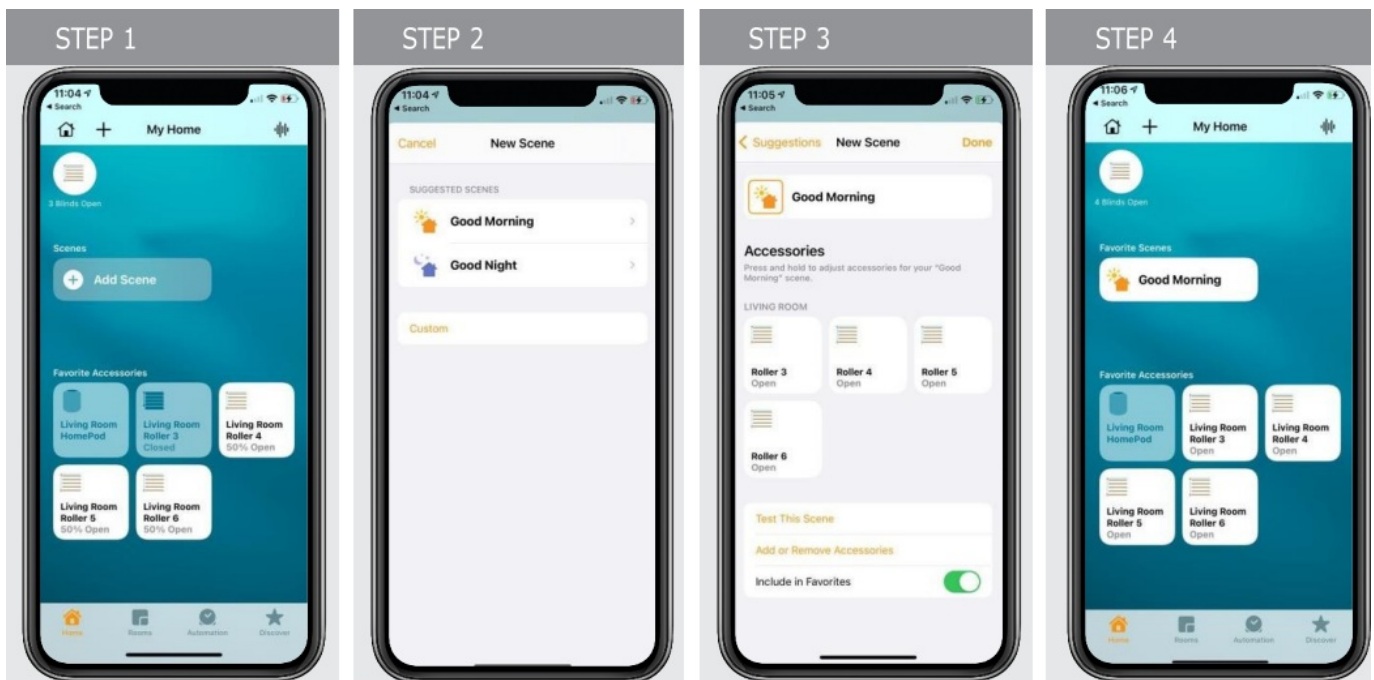

1. Click the “Add Scene” button to begin programming your desired scene.
2. Select the suggested scene “Good Morning” in the Home app to create the scene.
3. To finish creating your scene, move the shade to any position desired and click “Done”.
4. If you select the “Good Morning” Scene, you can open a shade or group of shades, as have been programmed.

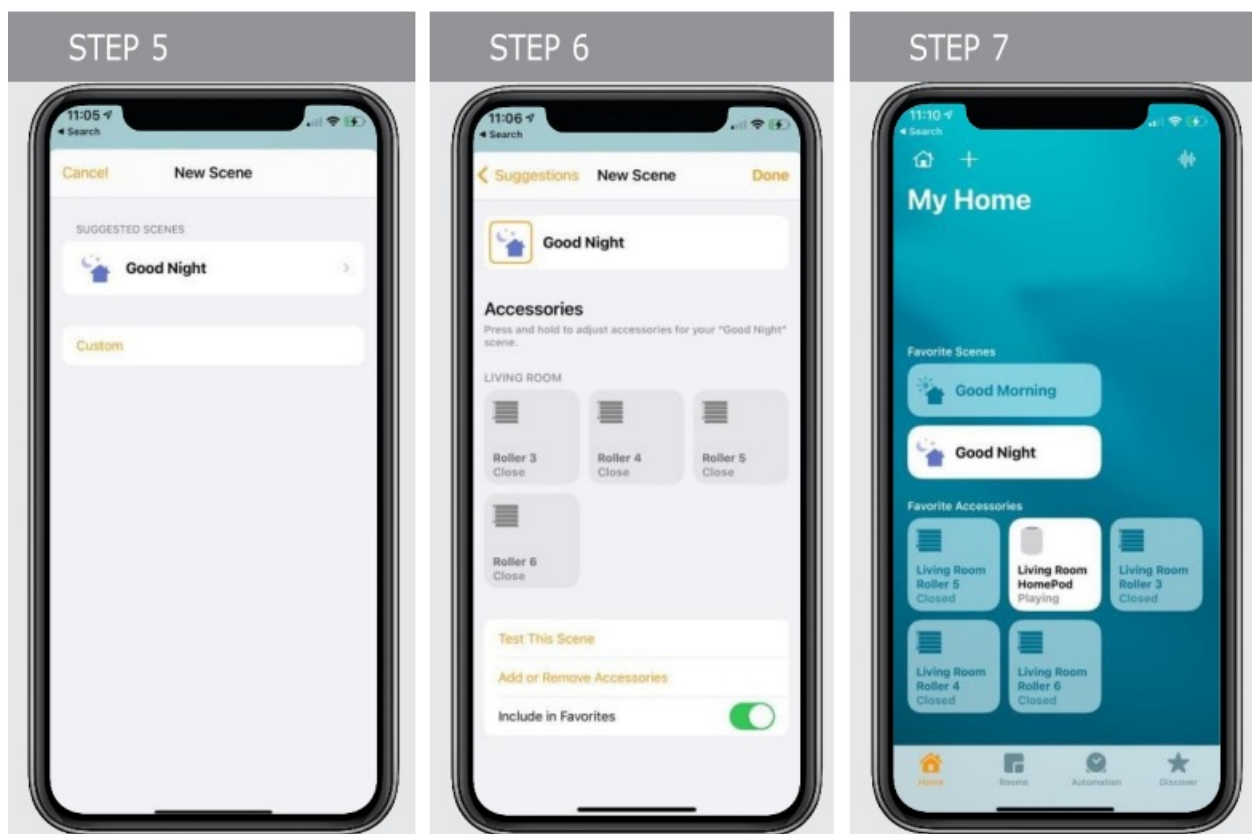

5. Select the suggested scene “Good Night” in the Home app to create the scene.
6. To finish creating your scene, move the shade to any position desired and click “Done”.
7. If you select the “Good Night” Scene, you can close a shade or group of shades, as have been programmed.

How to Customize a Scene in Your Hub

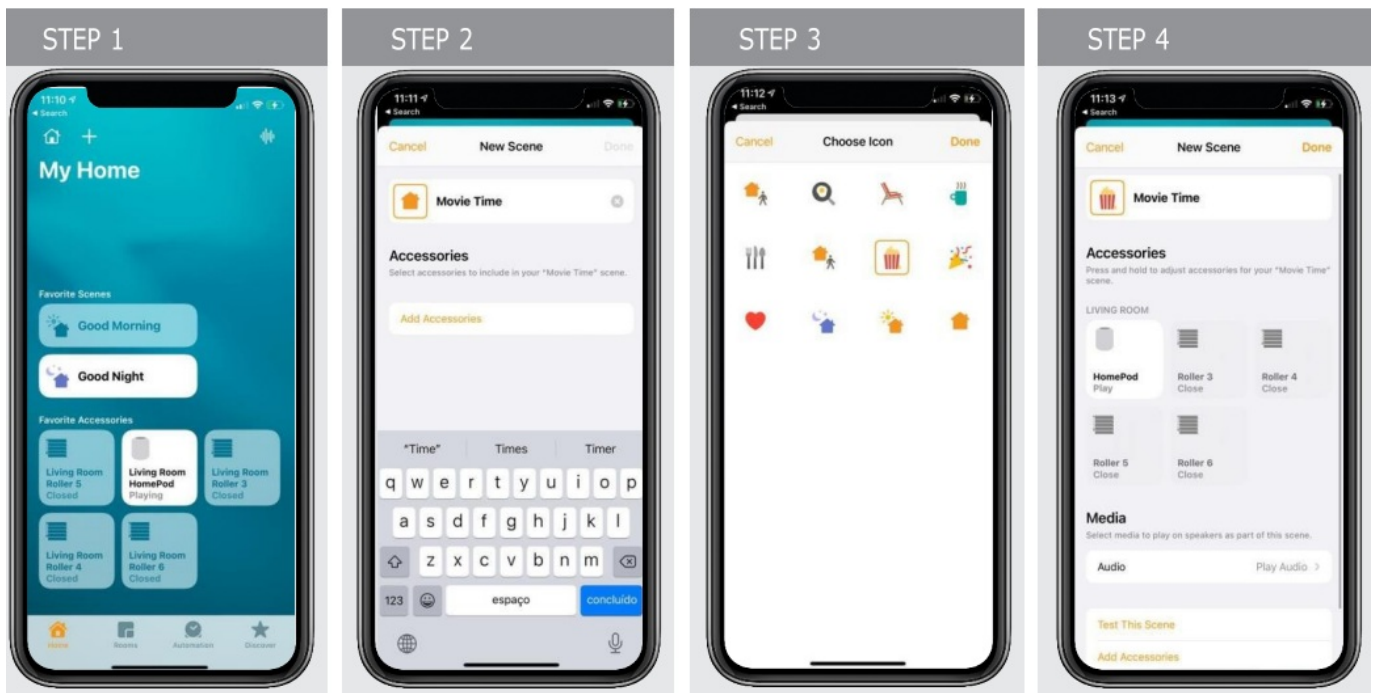

1. Click the “Add Scene” button to begin programming your customized scene.
2. If you select the “Custom” Scene, you can create a customized scene for shades, with the icon, name, and position of your choice.
3. Select the appropriate icon for the Scene.
4. Customize the name of your scene accordingly and set the desired position of your shade.

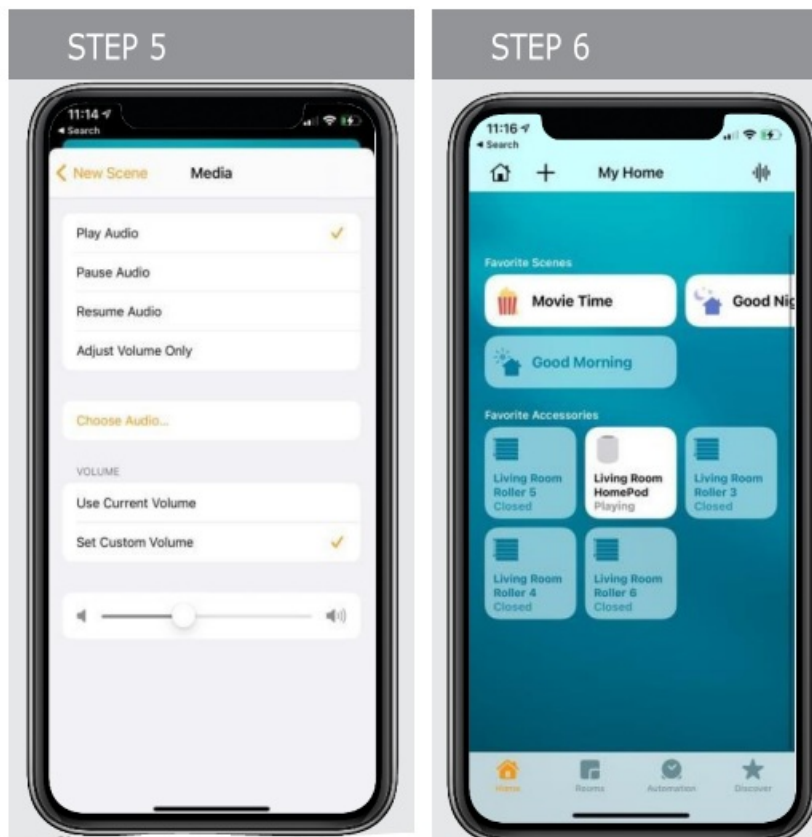

5. If you have any other HomeKit device available on Home App, you can also include it into the “Customized Scene” as the Homepod device.
6. If you select the “Movie Time” Scene, you can move a shade or group of shades that have been programmed. You can also activate the Homepod device.

How to Customize Your Home App

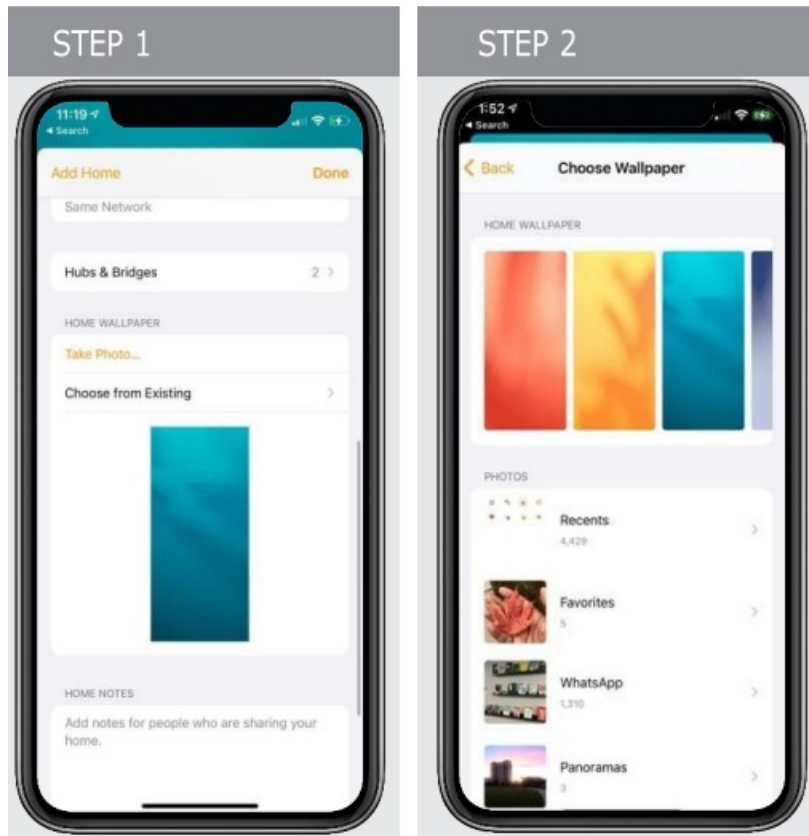

1. You can customize the room color and name according to your preference.
2. Select which color or image you want to use to customize your Home App.

Siri Expected Responses:

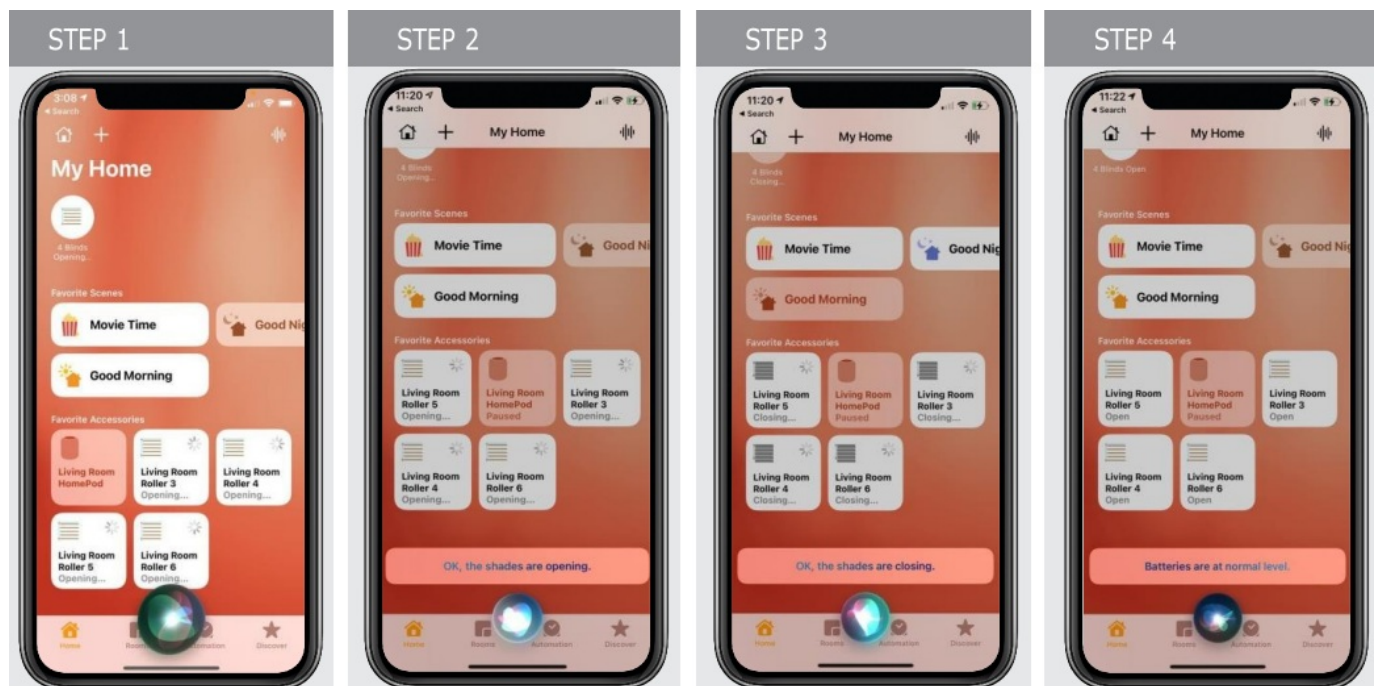

1. On your phone, say "Hey Siri" or press and hold the side button to activate Siri for controlling your shades.
2. Ask Siri to open the shades.
3. Ask Siri to close the shades.

4. Ask Siri to tell you the battery level for the shades.

HomeKit Troubleshoot:

If you have failed to pair your hub to The Shade Store V 2 App or HomeKit you may need to first remove The Shade Store Wireless Link from the Home app. Here are the steps to clear The Shade Store Wireless Link out of The Shade Store V

App and Apple Home.

Removing from The Shade Store V2 App

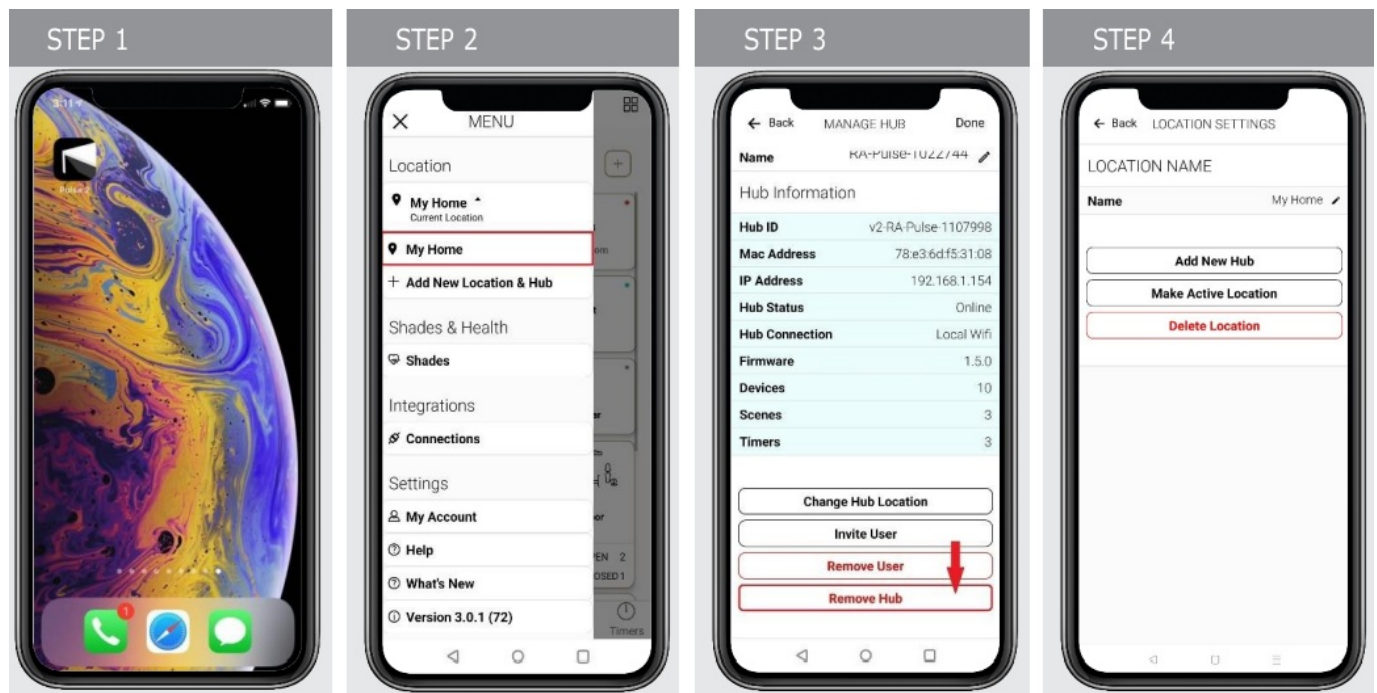

1. Open The Shade Store V2
2. Select location from the top left menu.
3. Select the location and "Remove Hub".
4. Confirm that the Hub has been deleted from The Shade Store V2 App and force quit the app.

Removing The Shade Store Wireless Link from Apple HomeKit:

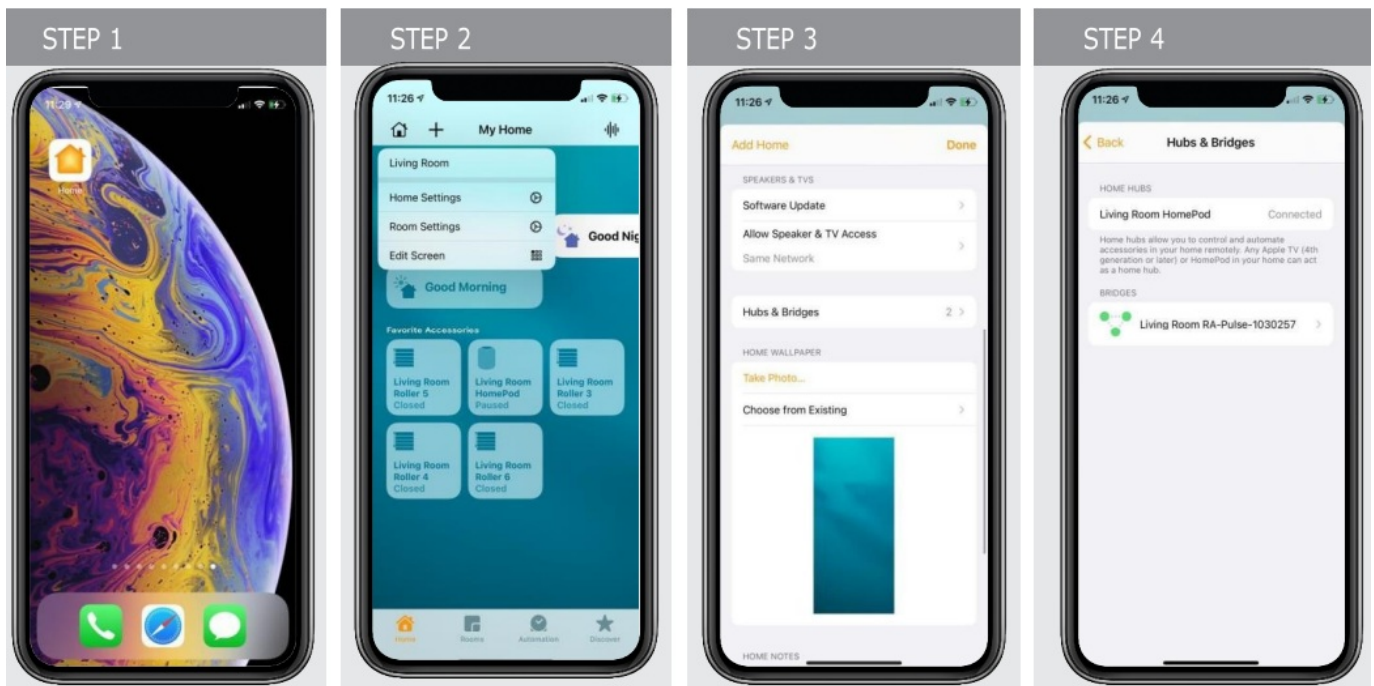

1. Select Home App on your phone.
2. Select “Home” icon in the top left and select “Home Settings”.
3. Select “Hubs & Bridges” on the list and select the RA-Pulse- XXXX device to be deleted.
4. Delete only the RA-Pulse- XXXX device from the Living Room location.

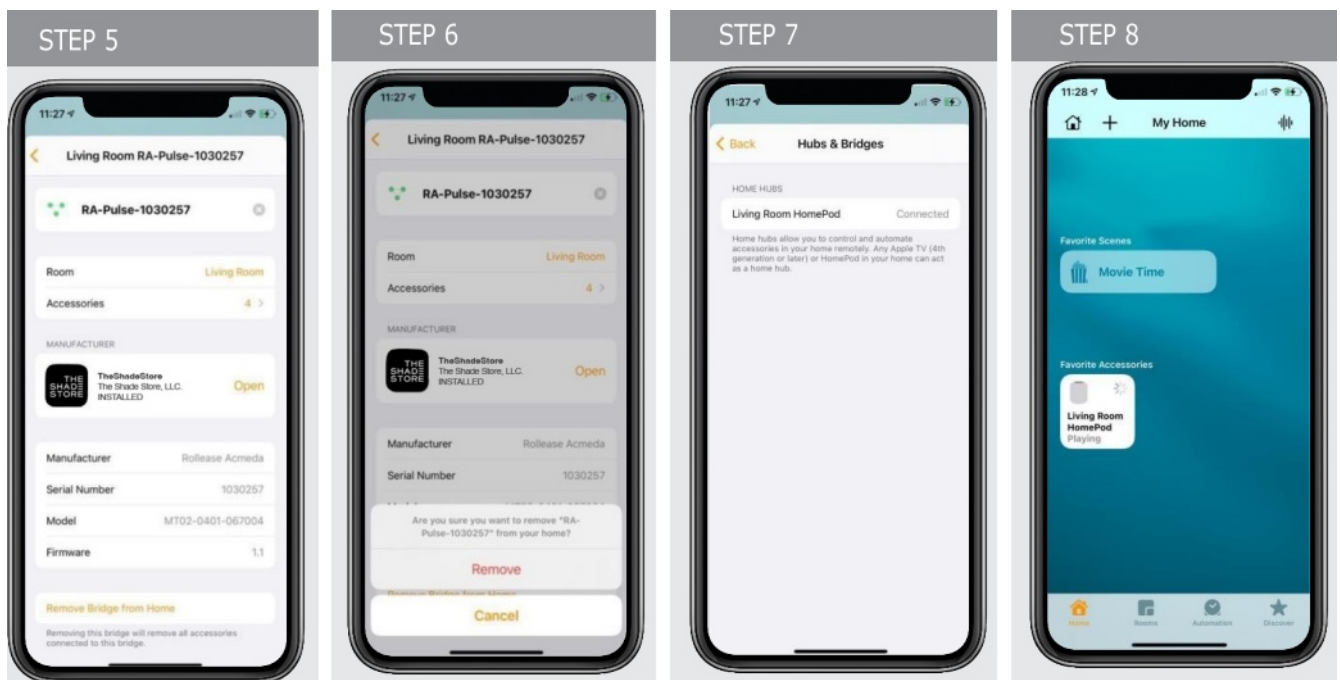

5. Select “Remove Bridge from Home” to proceed to delete only the Wireless Link from home app.
6. Press “Remove” button on the screen to delete the Wireless Link.
7. Confirm if that the other devices still on the same Home App location as before and Wireless Link has been completed removed.
8. All the other devices should still work from the same location in the home app.

Finding the Apple Home App on iPhone, iPad, or iPod Devices.

In some cases, the Apple HomeKit may not be installed on your phone. Please follow below steps install the Home App.



1. Select "Settings" and verify that it is installed. If not, go to the AppStore and type
2. Download the Home App.
3. Download the Home App. The Home App is now ready. Refer to the Initial setup on page 3.

Enable the HomeKit Privacy on Your Phone

In some cases, the user does not allow the Apple HomeKit on your phone, and it does not allow you pair your Hub with The Shade Store V 2 App. If you are facing this kind of issue, please follow the steps below:

If Hub does not come up into The Shade Store V 2 App:

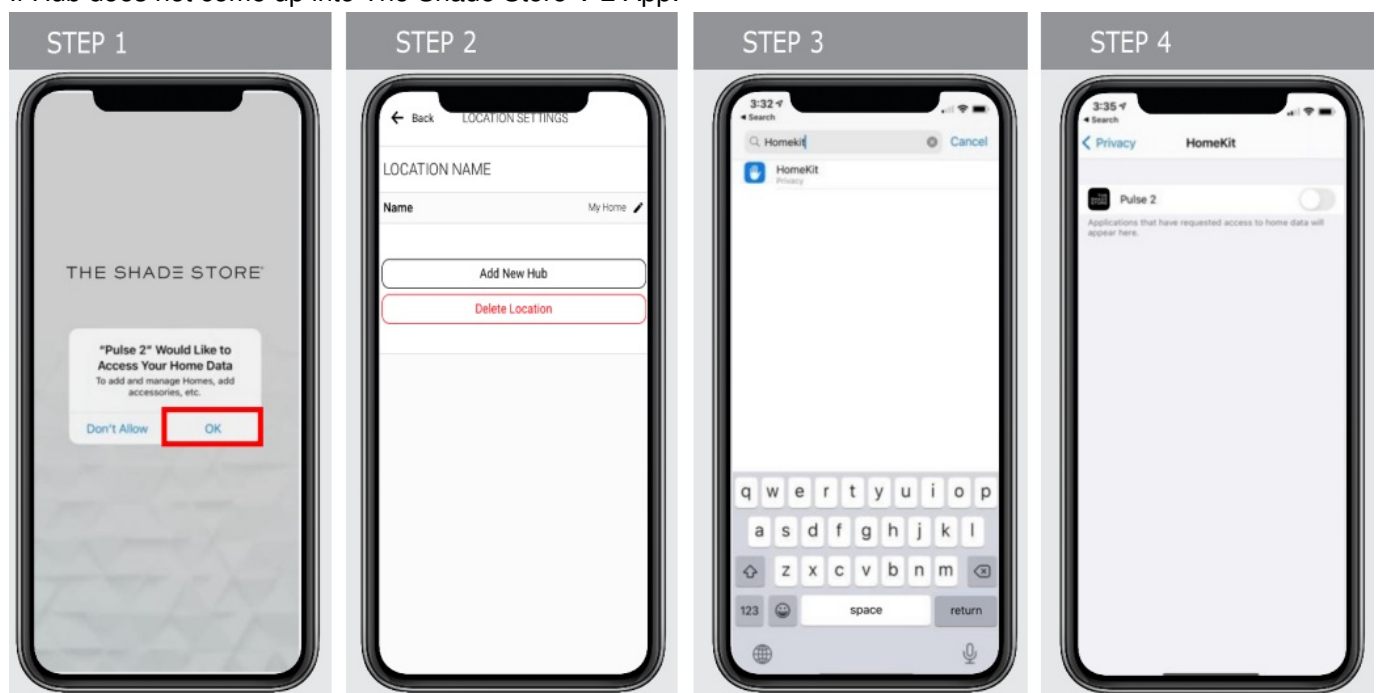

1. When you open The Shade Store V2 App and it asks about Home Data access, click “OK” otherwise the pairing process will fail.
2. If it is not allowed, the Hub will not come up, forbidding you to proceed with the pairing process.
3. If that happens, you can enable it manually but selecting “Settings” and typing “HomeKit”.
4. Press the HomeKit Privacy icon and check if The Shade Store V2 App is toggled on or off.

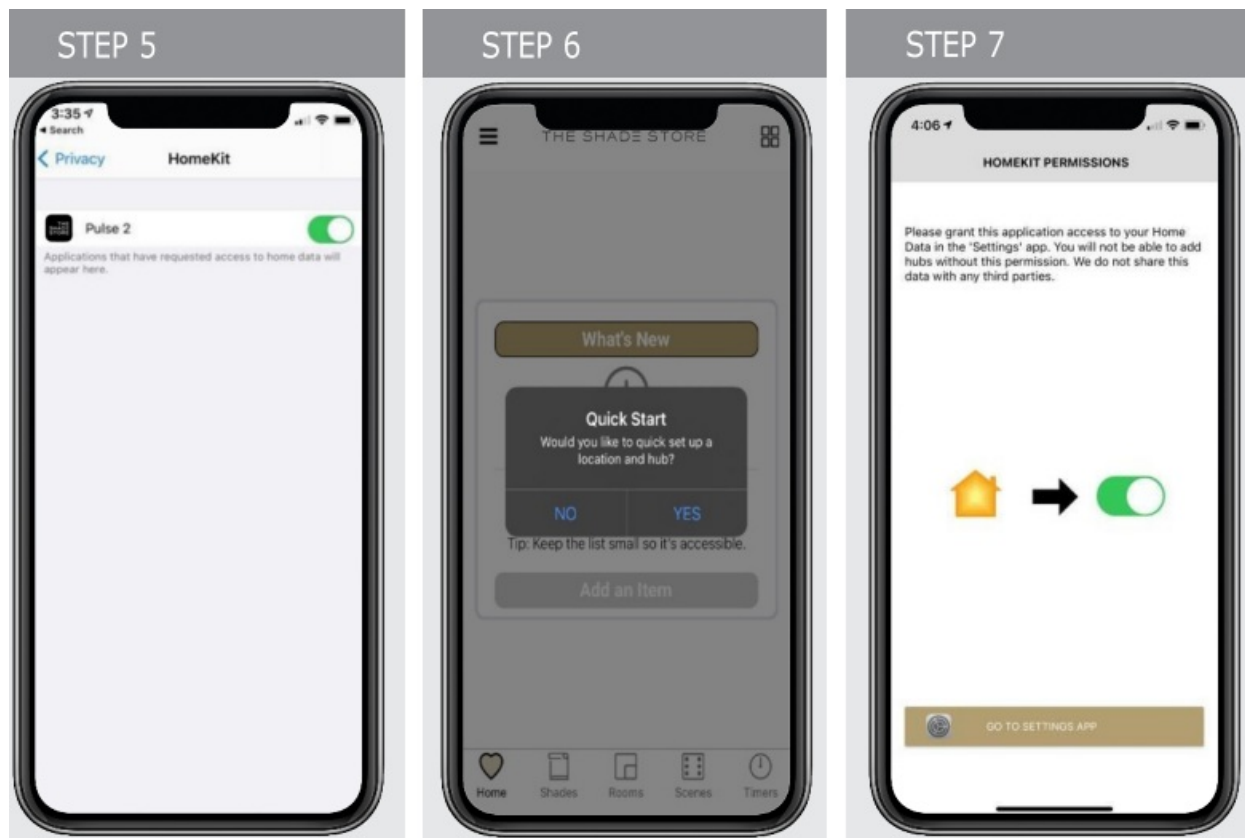

5. Press the button to enable The Shade Store V2 App to work with HomeKit.
6. If you are pairing the Hub for the first time, you can use the “Quick Start” as a step to guide you to enable The Shade Store V2 App to work with HomeKit.
7. The Shade Store V2 App guides you to enable the HomeKit permissions automatically.

Get Stuck on HomeKit — Cannot Delete The Shade Store Wireless Link from Your HomeKit App.

In some cases, the Apple HomeKit does not allow you delete the home from the Home App. In order to delete the home from your

HomeKit App, you need to reset your device completely and try again.

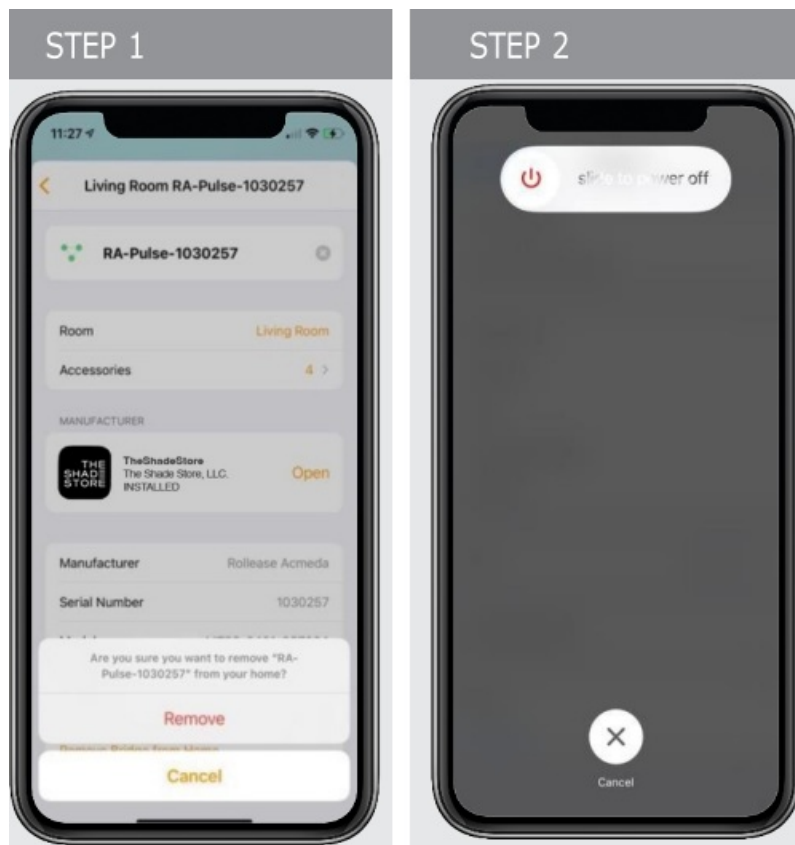

1. If you cannot delete The Shade Store Wireless Link from your Home App, reset your device completely.
2. Press and hold the Power Button for a few seconds and slide the power off button. After that, turn on your device and repeat the steps to remove the Hub.

Cannot Use or Scan the QR Code Using My HomeKit App

- To use the HomeKit App in your devices, you need make sure that the Two-Factor Authentication is ON.
- Follow the steps below in order to confirm or become your Two-Factor Authentication is "ON" in your device.

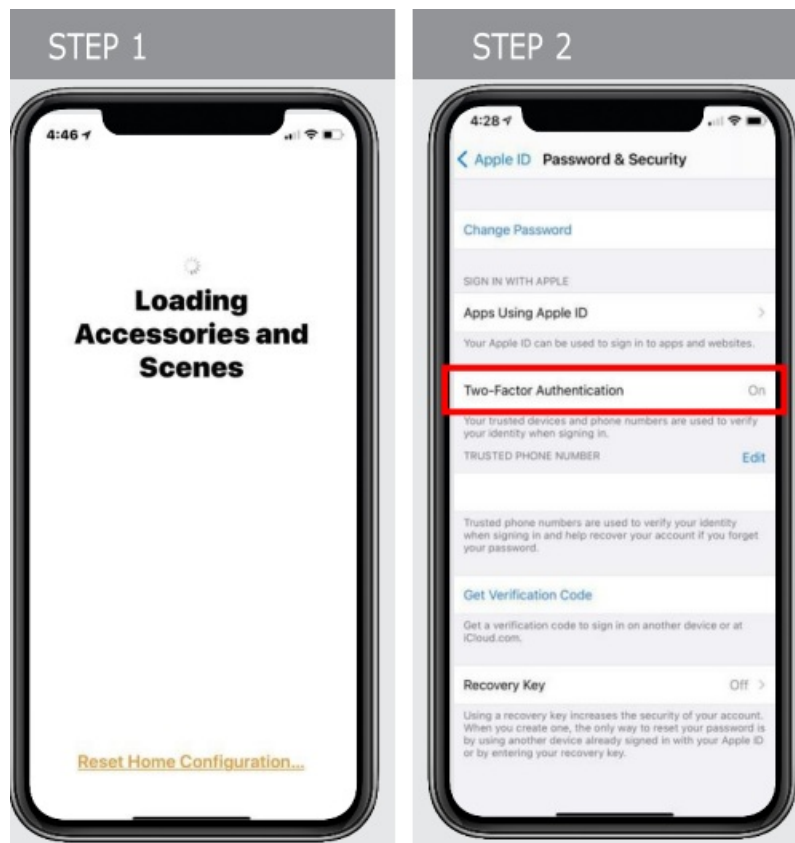

1. If you are not able to scan the QR code using the HomeKit App, check if your Apple ID account has the Two-Factor Authentication On.
2. Select "Settings", go to "Password and Security", check if the Two-Factor Authentication is ON. If not, you need enable this option to use with HomeKit.

Can I Pair The Shade Store Wireless Link with the Home App?

It is possible to use the Home App as an alternative option to be provisioning the Hub on the Wi-Fi and then complete the configuration on The Shade Store V 2 App.

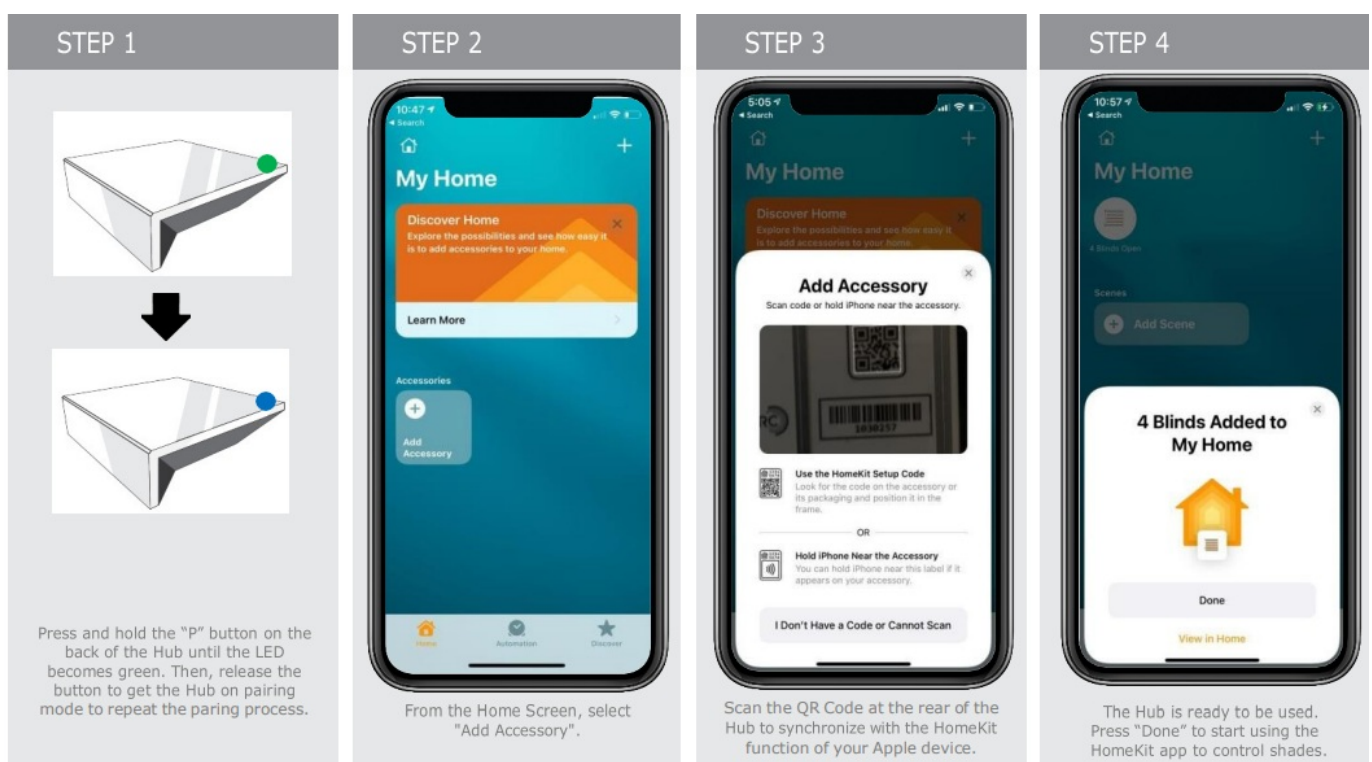

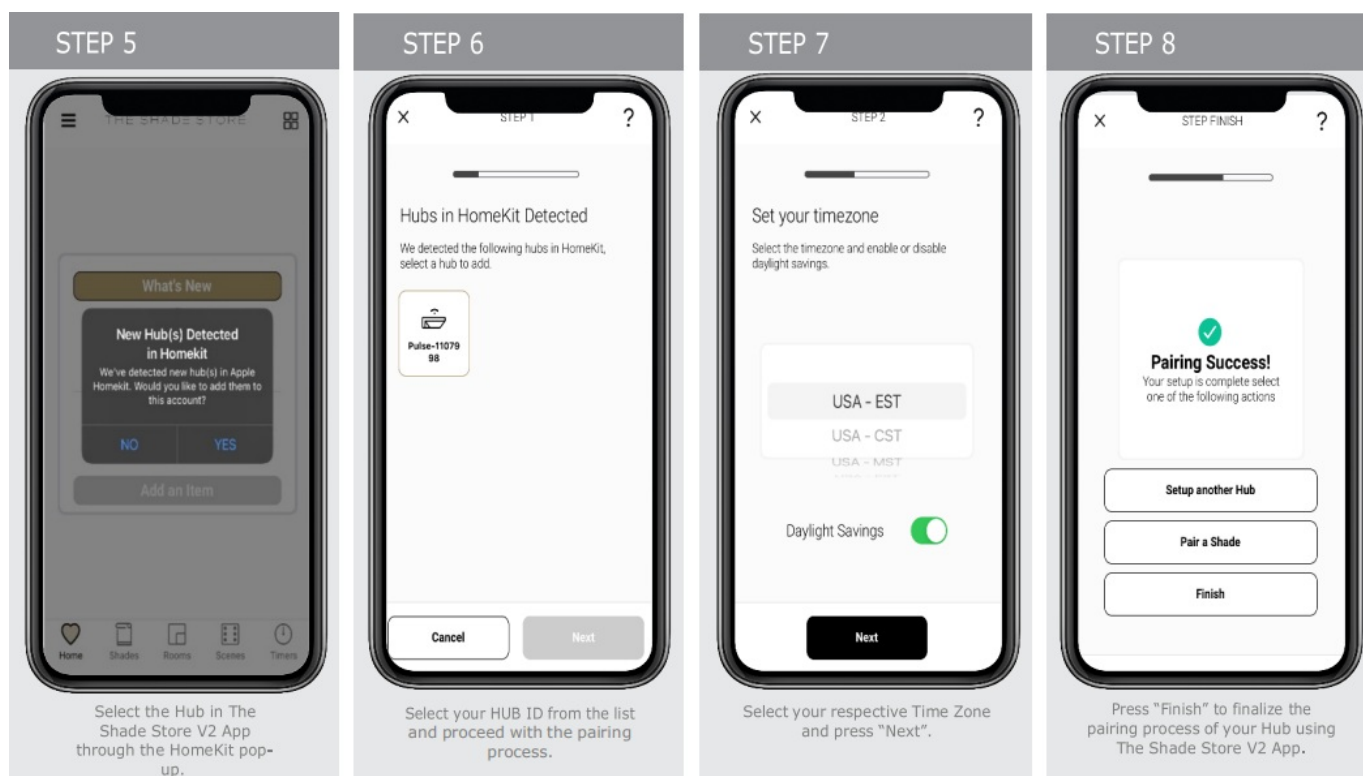

Removing The Shade Store Wireless Link Hub from HomeKit

Please ensure your hub is removed from the Home App and try again. Go to the Home App on your iOS device, select the house icon in the upper left corner of the home screen > Home Settings > Hub Location > Remove Home. Then Go back to The Shade Store V2 App and start from the beginning.

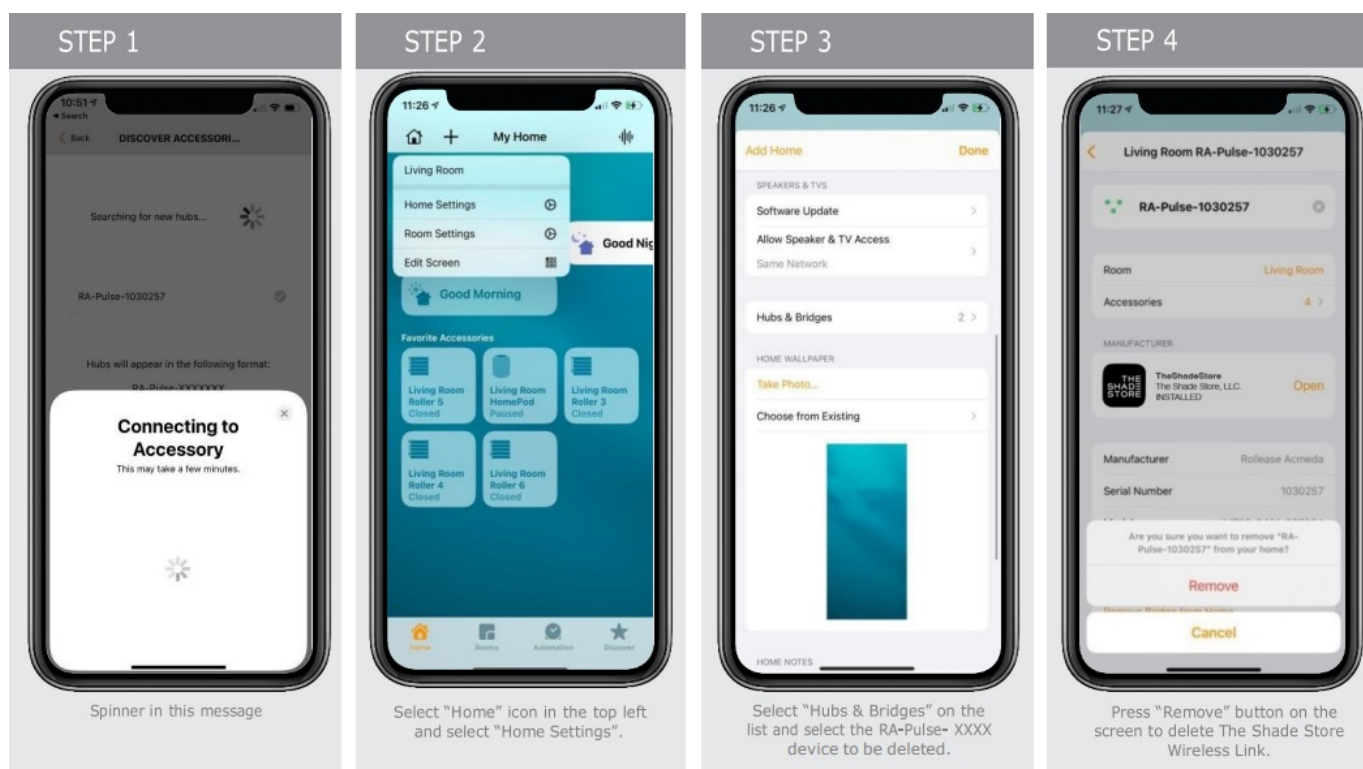

If you want to start from the beginning, please ensure that you are pressing the "P" button on the back of the Hub to re-pair it either from The Shade Store V2 App or from Home App.

STEP 5



After you remove The Shade Store Wireless Link from Home App, press and hold the "P" button on the back of the Hub until the LED becomes green. Then, release the button. To get the Hub on pairing mode to repeat the pairing process.

Where is the HomeKit QR Code Located on The Shade Store Wireless Link?

The HomeKit QR code is located on the bottom of the hub. *The house icon in the top left of the QR code represents the Home app for HomeKit.

STEP 1



After removing The Shade Store Wireless Link from Home App, press and hold the "P" button on the back of the Hub until the LED becomes green. Then, release the button. To get the Hub on pairing mode to repeat the pairing process.

The HomeKit QR code is on the bottom of The Shade Store Wireless Link.

STEP 2



Scan the QR Code at the rear of the Hub to synchronize with the HomeKit function of your Apple device.

STEP 3

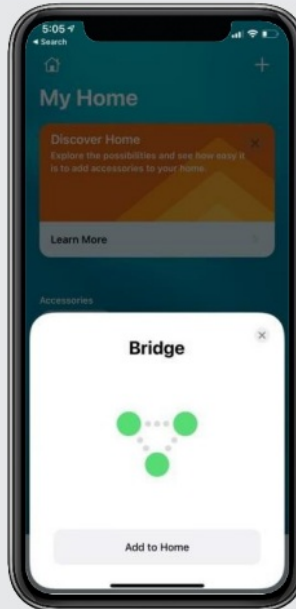

Press the "Add to Home" button on the screen to proceed adding The Shade Store Wireless Link to the Home App.

STEP 4

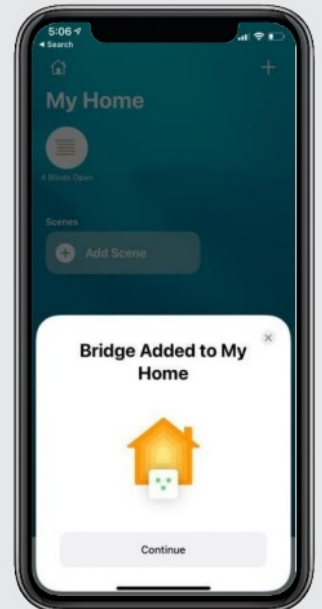

The Hub is ready to be used. Press "continue" to start using the HomeKit app to control shades.

If the QR scan fails, you will be prompted to enter the setup up code. This code is the eight-digit number located in the top right of the QR code.

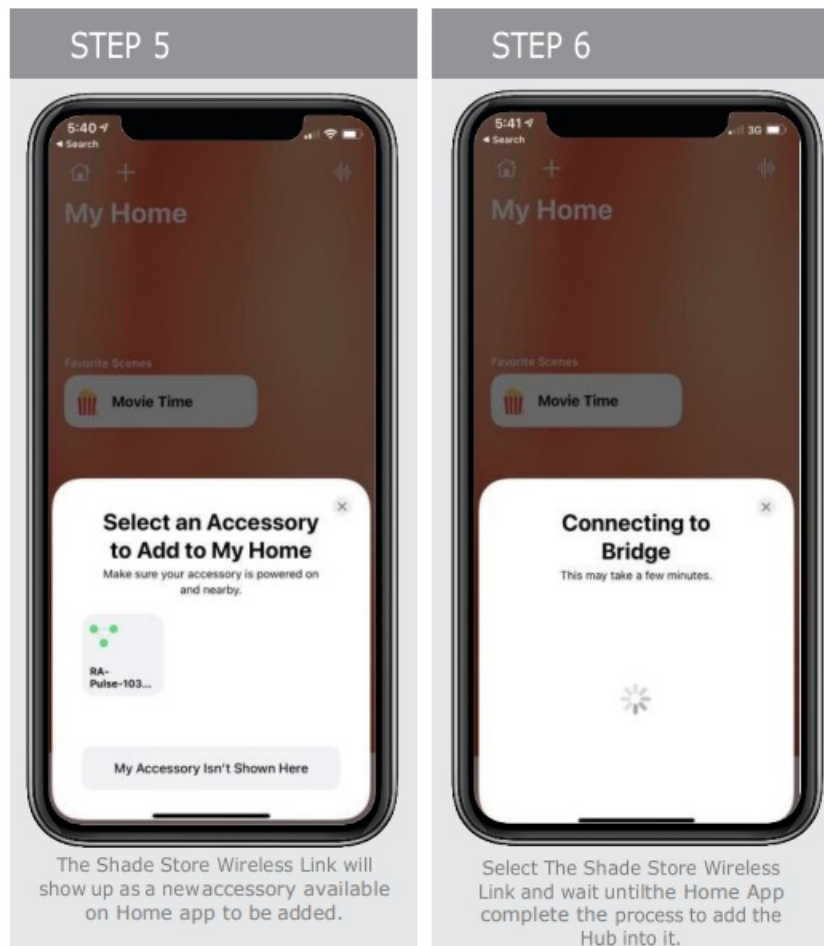
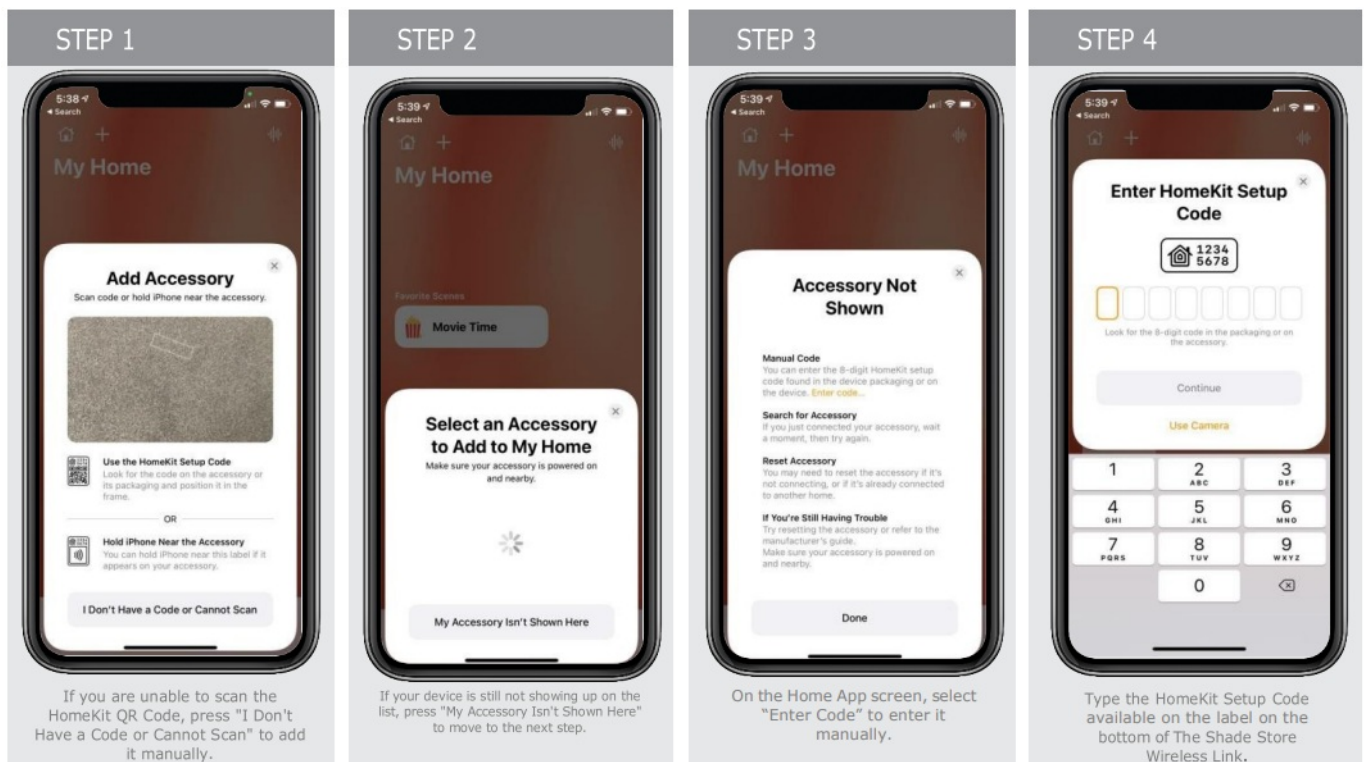

How do I know if my phone or device is connected to a 2.4Ghz or 5Ghz?

When you use the HomeKit QR code to pair The Shade Store Wireless Link, the app shows you if you are connected to the proper network.

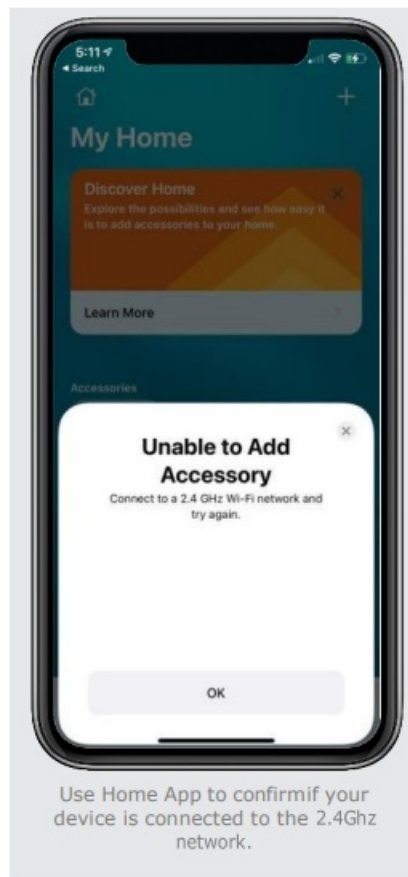

theshadestore.com/customer-service/app © 2024 The Shade Store, LLC

FAQS

What Does “HomeKit” mean for The Shade Store Wireless Link?

The Shade Store Shades can be operated by talking to Siri in your home if you have The Shade Store Wireless Link connected to your Router via Lan or Wi- Fi and the free The Shade Store V2 App installed on an iOS device using iOS11.3 or higher with Apple® HomeKit. Also, you can send the commands to your shade operating any HomeKit-enabled products outside the home. Talking to Siri requires 4th Generation Apple TV or Homepod. For more information on HomeKit, click: (<https://support.apple.com/en-us/HT204893>)

Can I control my shades via Siri from anywhere?

Siri will only operate the shades if you are connected via local Wi-Fi. Alternatively, you can set up a Home Pod, Apple TV or iPad as a home hub to grant you access to remotely control your HomeKit devices.

What Apple hardware/software is required for HomeKit?

An iPhone®, iPad®, or iPod® touch with iOS 11.3 or later is required for HomeKit. You can check your iOS version in Settings > General > About > Version.

- For remote access, you'll need to have a third generation or later Apple TV with software version 7.0 or later in your home or a Homepod Device. Follow the steps here to make sure you have a supported Apple TV or Homepod: <https://support.apple.com/en-us/HT200008> or <https://www.apple.com/homepod/>
- Remote access through Apple TV may require you to log out of iCloud® and log back in on your Apple TV.
- **Tip:** Siri® will be more responsive if you set the “Sleep After” setting to “Never” in Settings.
- If you have any other issues setting up Apple TV, please contact Apple Customer Support.

What Shade Store hardware/software is required for HomeKit?

- The Shade Store Wireless Link (MT02-0401-067001) is required, as well as the latest version of iOS The Shade Store V2 App.
- **Note:** The Shade Store V1 Hub (MTRF-WIFIBRIDGE-KIT) does not support HomeKit. Except for HomeKit support, all other features remain identical for generation 1 and generation 2.

Does The Shade Store Wireless Link with HomeKit features work with non-Apple smartphones and tablets (e.g. Android™)?

The Shade Store V2 App for The Shade Store Wireless Link is available for Android. However, Android devices do not have Siri and do not support third- party HomeKit apps. All The Shade Store Wireless Link (generation 1 and 2) have identical performance on Android.

Can everyone in the home use Siri from their own iOS device?

Using the HomeKit App, you can share control with family and friends and get notifications about the activity in your home so you never miss a thing. For more information on HomeKit click: <https://support.apple.com/en-us/HT204893>





Finding the Apple Home app on iPhone OS 12.4.3 or below.

If The Shade Store V2 App fails or displays an error message, there is an issue with connecting your Hub with HomeKit.

Documents / Resources

	<p>THE SHADE STORE Wireless Link [pdf] User Guide Wireless Link, Wireless, Link</p>
--	---

References

-  [Customer Support For Motorized Window Treatments Remote / APP / Smart Home](#)
-  [HomePod - Apple](#)
-  [Identify your Apple TV model - Apple Support](#)
-  [Add a smart home accessory to the Home app - Apple Support](#)
-  [HomePod - Apple](#)
- [User Manual](#)

Manuals+. Privacy Policy

This website is an independent publication and is neither affiliated with nor endorsed by any of the trademark owners. The "Bluetooth®" word mark and logos are registered trademarks owned by Bluetooth SIG, Inc. The "Wi-Fi®" word mark and logos are registered trademarks owned by the Wi-Fi Alliance. Any use of these marks on this website does not imply any affiliation with or endorsement.