



THE CAN CONVERTER R-1 Recessed Can Light Conversion Kit Instruction Manual

[Home](#) » [The Can Converter](#) » THE CAN CONVERTER R-1 Recessed Can Light Conversion Kit Instruction Manual 

THE CAN CONVERTER R-1 Recessed Can Light Conversion Kit Instruction Manual



WARNING

RISK OF ELECTRICAL SHOCK.

Disconnect the power to the existing luminaire at the breaker box. Do not make or alter any open holes in an enclosure of wiring or electrical components during kit installation. Check for damage to the enclosed wiring and components. Do not alter, relocate or remove wiring, lamp holders, ballasts or any other electrical components. Install this kit only in luminaires that have the construction features and dimensions shown in the photographs and /or drawings. To prevent wire damage, do not expose wiring to the sheet metal of the can or other sharp objects. The Can Converter is not intended for installation on recessed incandescent luminaires installed on an inclined ceiling. This product is not intended for luminaires greater than 5 lbs. The reflector kit requires knowledge of lighting luminaire's electrical systems. If not qualified, do not attempt installation. Contact a qualified electrician. The R-1 is designed to work with 4" 5" and 6" can lights that utilize incandescent bulbs.

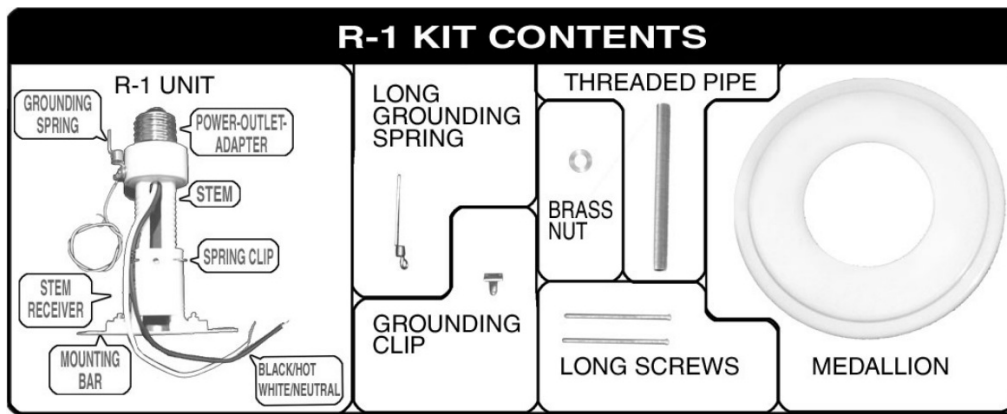

1. Remove the light bulb from the can light you will be replacing.

IMPORTANT: if the inside of the can light or lamp holder bracket is painted, or good grounding can not be obtained by using the grounding spring, by-pass step 2 and continue to step 7.



2. Note: recessed can lights that provide a lamp holder bracket to support the light socket will use the short grounding spring, already attached to the R-1 Unit.

Screw the R-1 Unit into the can light socket. It is very important that the ground spring on the R-1 Unit makes direct contact with an unpainted metal portion of the cans lamp holder bracket. If the grounding spring makes contact, remove the R-1 Unit and continue to step 9, if not continue to next step 3.

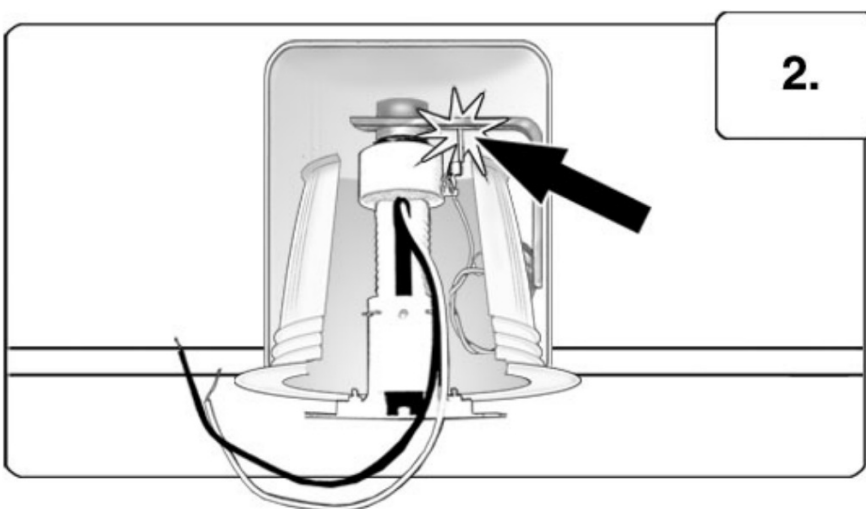

3. If your can light does not allow the ground spring to make contact with an unpainted metal portion of the can, or the light socket is mounted directly to the top of the can light housing, you will need to remove the R-1 Unit from the can light socket and replace the short grounding spring with the long ground-ing spring.

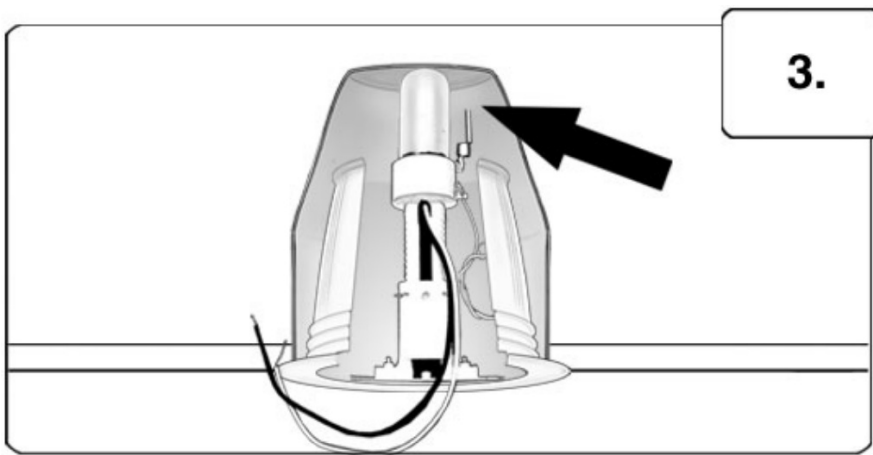

4. fig. A Unscrew the short ground spring and the ground wire from the R-1 Unit.

fig. B Replace the short ground spring with the long grounding spring. Be sure to attach the grounding spring vertically next to the R-1 Unit, then add the ground wire and screw the two securely to the R-1 Unit using the self-tapping screw.

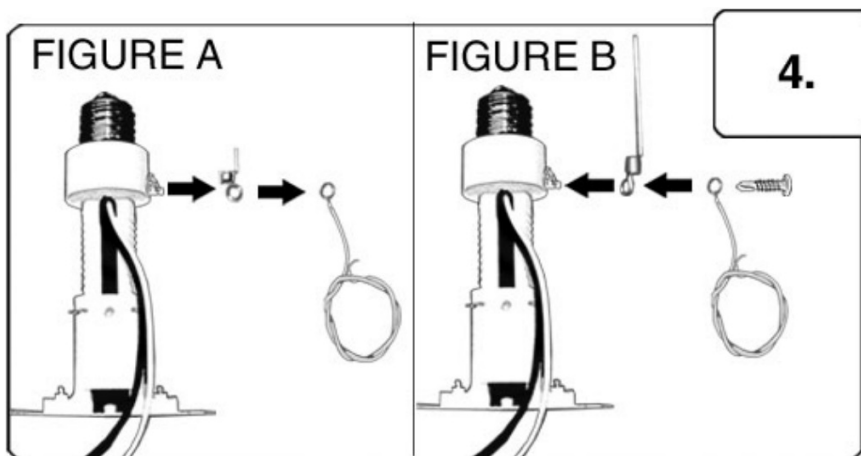

5. Reinstall the R-1 Unit and make sure the long grounding spring makes contact with an unpainted metal part of the can. If the ground-ing spring makes good contact, remove the R-1 Unit and continue to step 9, if not continue to next step 6.

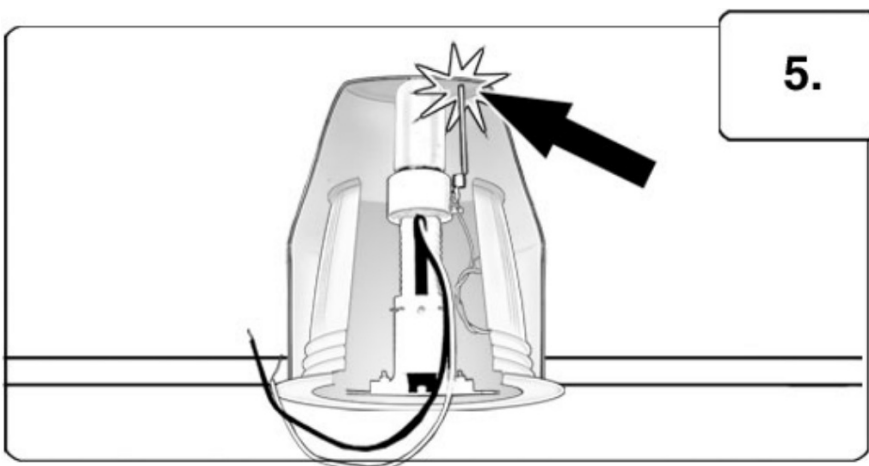

6. If the long grounding spring fails to touch an unpainted metal portion of the can, or the grounding spring is hung up on the light socket wiring, you will need to use the grounding clip in next step 7.

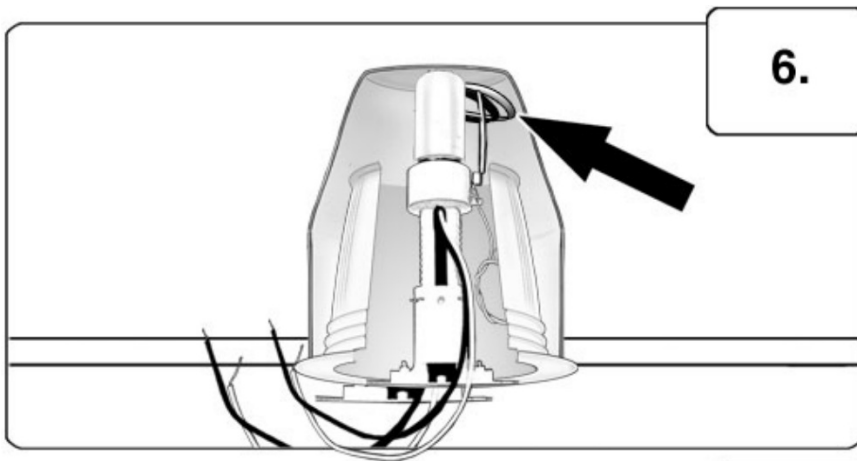

7. fig. A Remove the R-1 Unit from the can socket. Unscrew the ground wire and grounding spring from the R-1 Unit.

fig. B Screw the self-tapping screw back into the R-1 Unit. Then, using the small brass screw, attach the ground wire to the grounding clip. Tighten the brass screw against the clip with the hex nut.

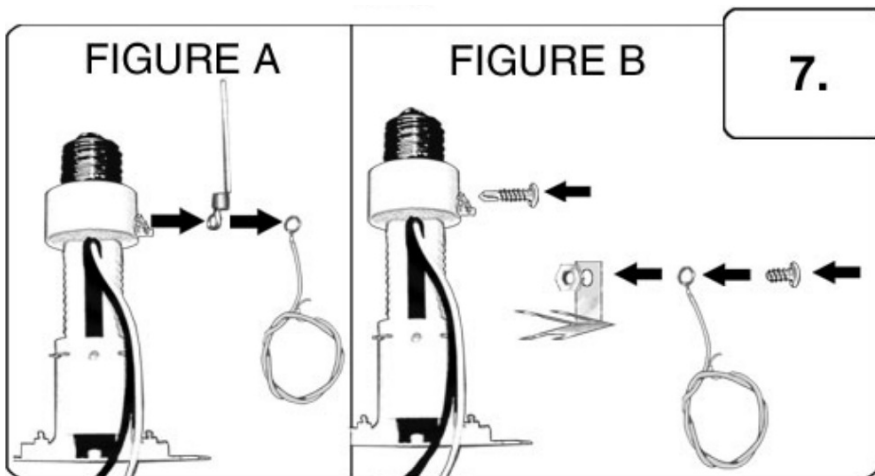

8. fig. A Remove the can trim from the can housing. fig. B Install the grounding clip onto an unpainted metal portion of the can housing. This will be used to ground the light fixture. DO NOT replace can trim.

IMPORTANT: if paint is present, you will need to remove/scrape off the paint to ensure good grounding contact.

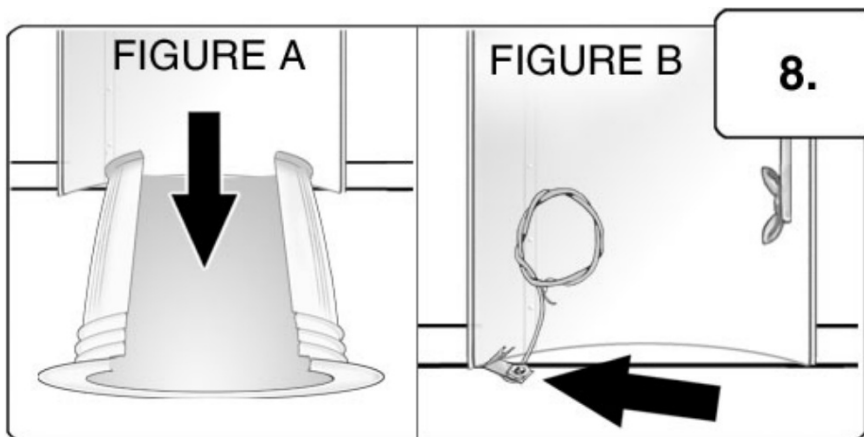

9. Remove the spring clip from the R-1 Unit and fully extend the stem. Replace the spring clip in the slot in the stem receiver.

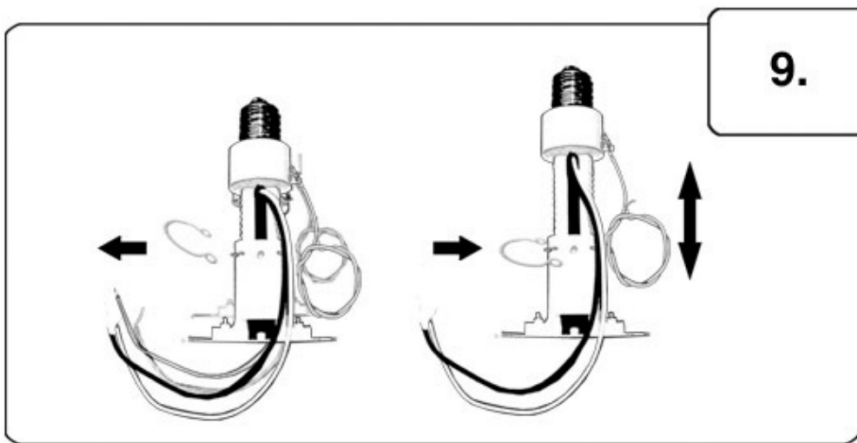

9.

10. fig. A Screw the R-1 Unit back in the can.

fig. B Push the stem receiver upward in the can. The mounting bar should be flush with the base of the can. The spring clip will hold the stem at the length you choose.

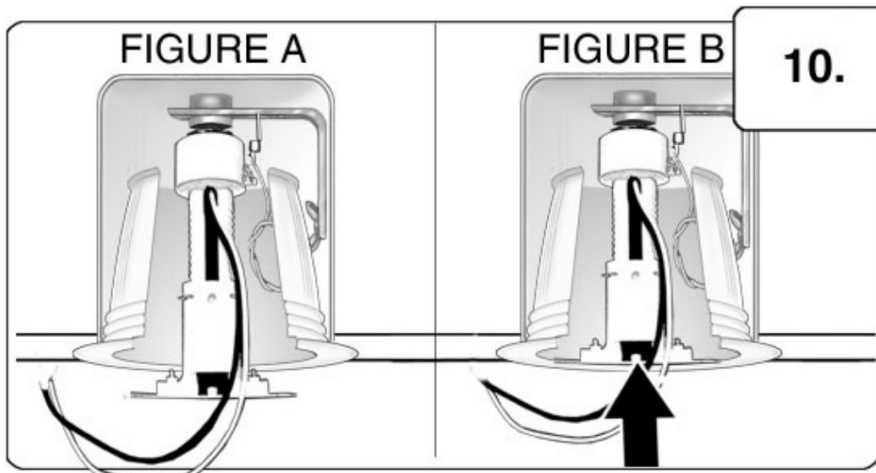

10.

11. fig. A Screw the threaded pipe into the mounting bar on the R-1 Unit.

fig. B Hold the medallion along with the fixture's light canopy against the ceiling. Adjust the length of the threaded pipe so that it is flush with the edge of the canopy.

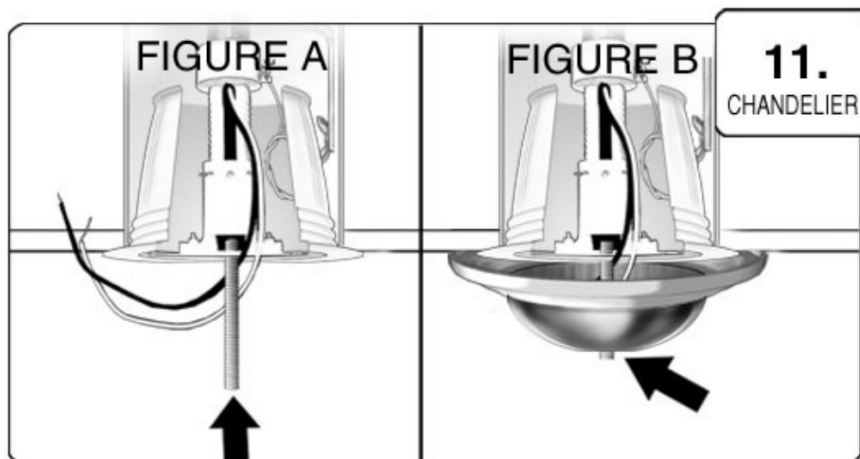

11.

CHANDELIER

12. Lower the canopy and medallion. Screw the brass nut onto the threaded pipe all the way up to the mounting bar. Tighten the nut to the mounting bar. Screw the fixture's light hook onto the threaded pipe.

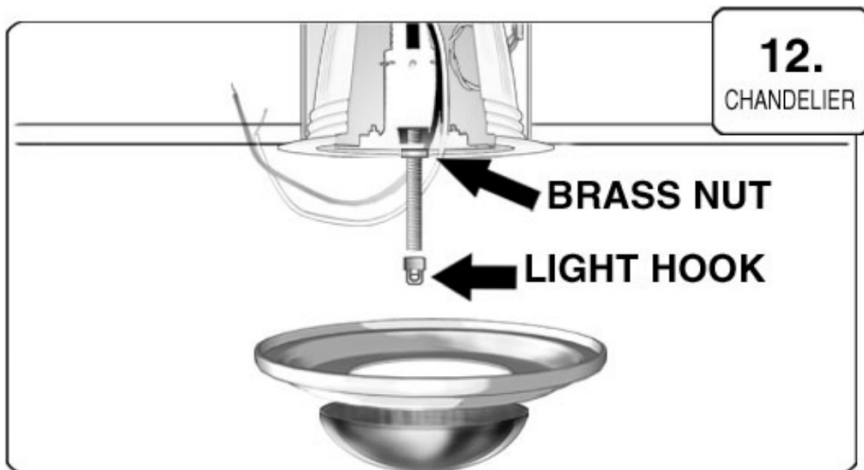

13. Run the chandelier nut, the chandelier canopy and the R1 medallion down the chandelier wiring.



14. Unscrew the R-1 Unit from the can socket along with the threaded pipe, light hook and brass nut.

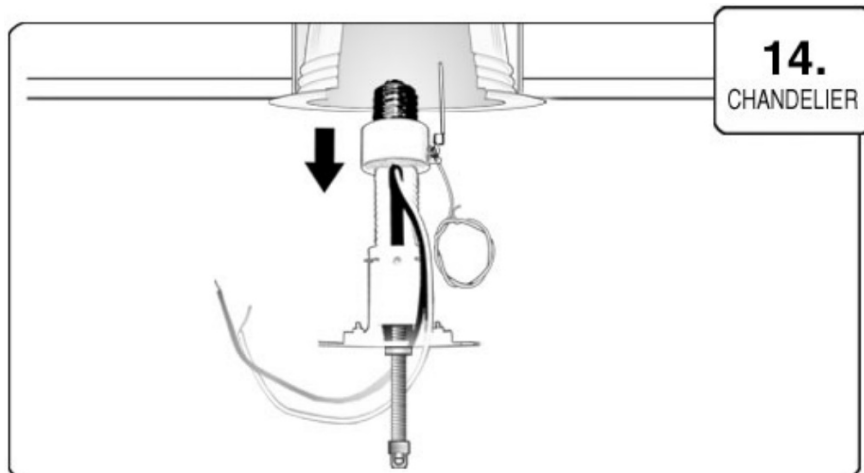

15. Run the chandelier's wires up into the threaded pipe and out the slot in the R-1 Unit stem. Attach the chandelier chain to the light hook.

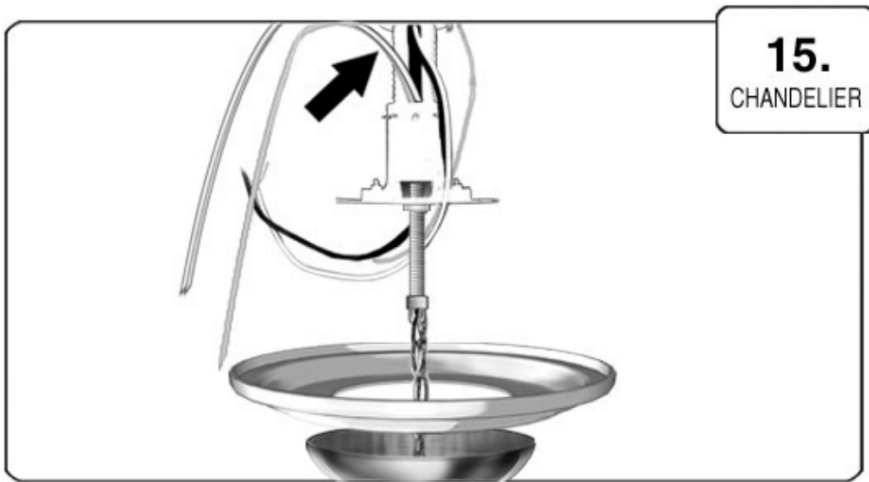

15.
CHANDELIER

16. Screw the R-1 Unit along with the entire chandelier assembly into the can socket.

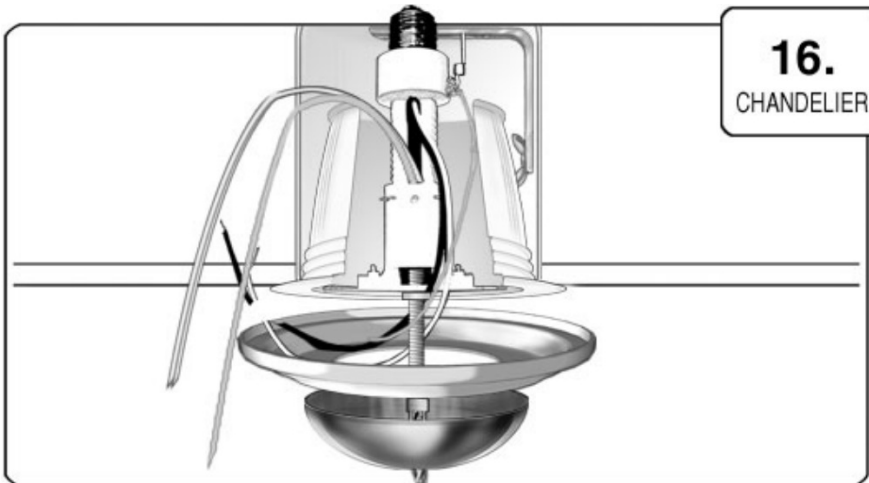

16.
CHANDELIER

17. fig. A Trim the excess wiring so it will fit within the canopy.

fig. B Using wire nuts, attach the fixture's hot wire to the power-outlet-adapter's hot wire, the fixture's neutral wire to the power-outlet-adapter's neutral wire and the fixture's ground wire to the R-1 Unit's ground wire.

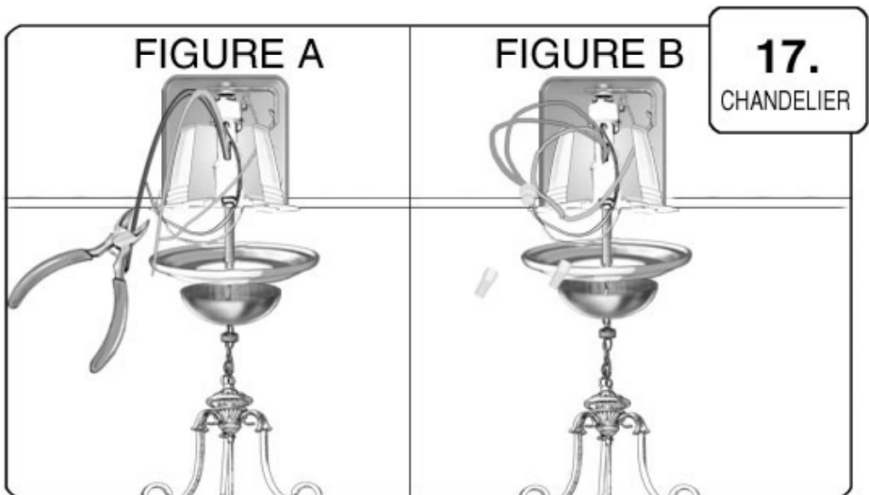

18. Run the medallion and canopy up to the ceiling and capture the wiring inside the can housing and the canopy. Complete the installation by tightening the chandelier nut on the light hook to secure the canopy and medallion in place.

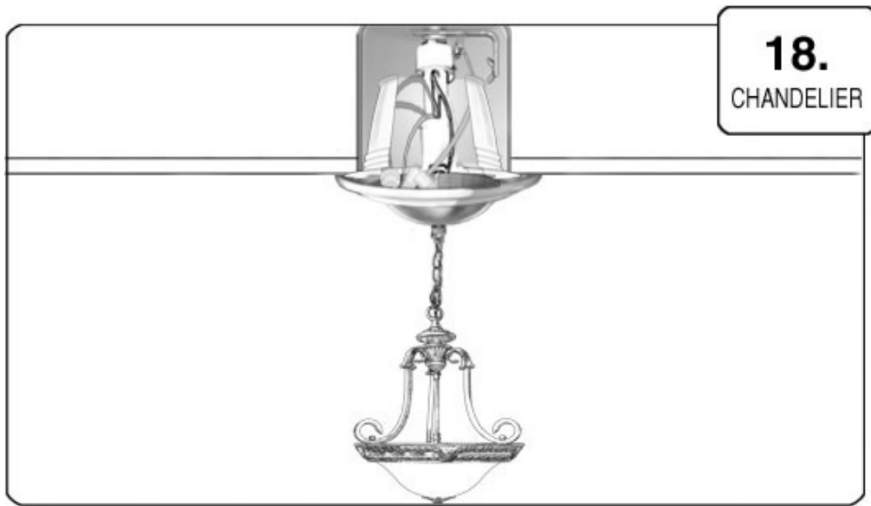

Contents

[1 PRNDANT/FLUSH MOUNT INSTALLATION](#)

[2 Documents / Resources](#)

[3 Related Posts](#)

PRNDANT/FLUSH MOUNT INSTALLATION

- fig. A Remove the R-1 Unit from the can socket. Match the holes on your fixture's canopy with the corresponding holes in the R-1 Unit mounting bar. Run the long screws through the holes so that the screw heads will be on the inside of the can.
fig. B If your fixture does not have decorative attachment nuts, or you are installing a flush mount fixture, the long screws will run up through the fixture's canopy to the R-1 Unit mounting bar. The screw heads will be on the outside of the fixture.

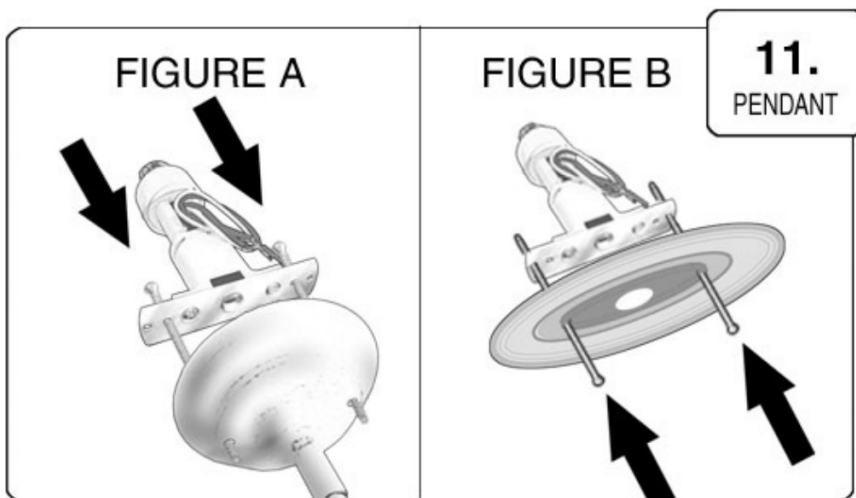

- Screw the R-1 Unit back into the can socket and run the wiring to the outside of the can.

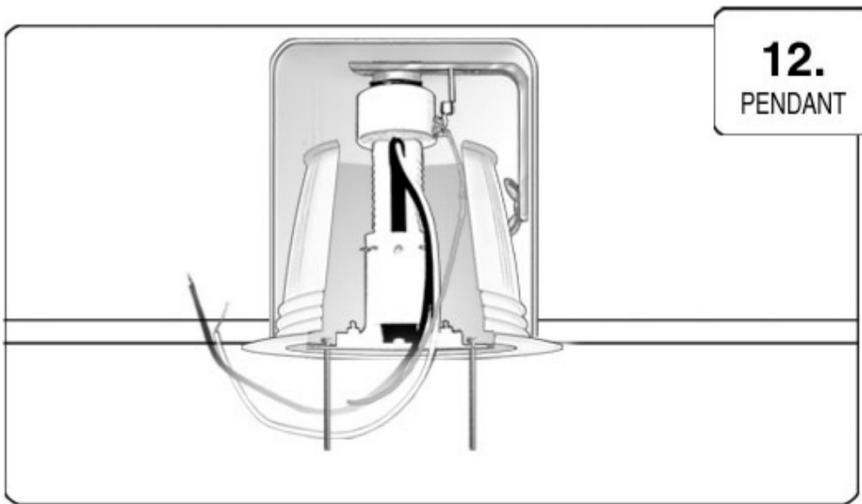

3. **Note:** Flush mount light fixtures that have a light canopy size of 7" or larger, the R-1 medallion is not needed. Light fixtures that have a light canopy size less than 7", the R-1 medallion is needed. Raise the medallion and/or light fixture canopy near the ceiling. At this point, it is helpful! if someone will hold the light while proceeding to the next step.

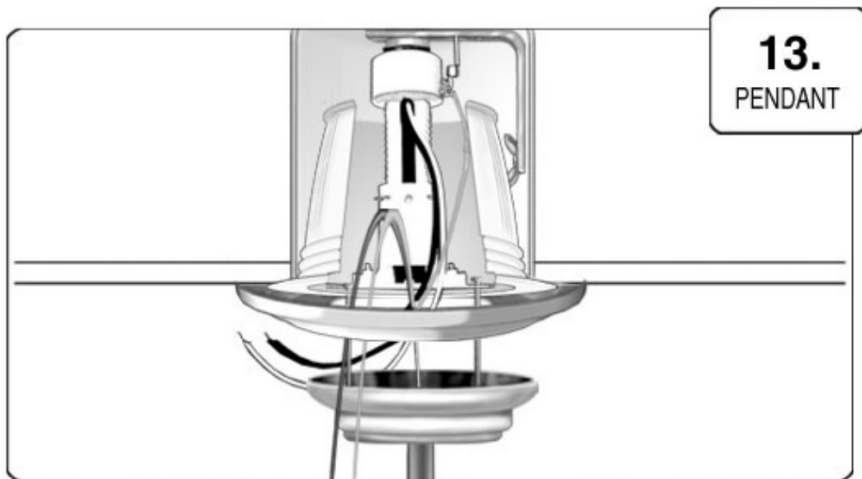

4. fig. A Cut the excess wiring so it will fit within the canopy. Using wire nuts, attach the fixture's hot wire to the power-outlet-adapter's hot wire, the fixture's neutral wire to the power-outlet-adapter's neutral wire and the fixture's ground wire to the R-1 Unit's ground wire. fig. B Raise the medallion and/or light canopy to the ceiling and capture the wiring inside the can housing and light canopy.

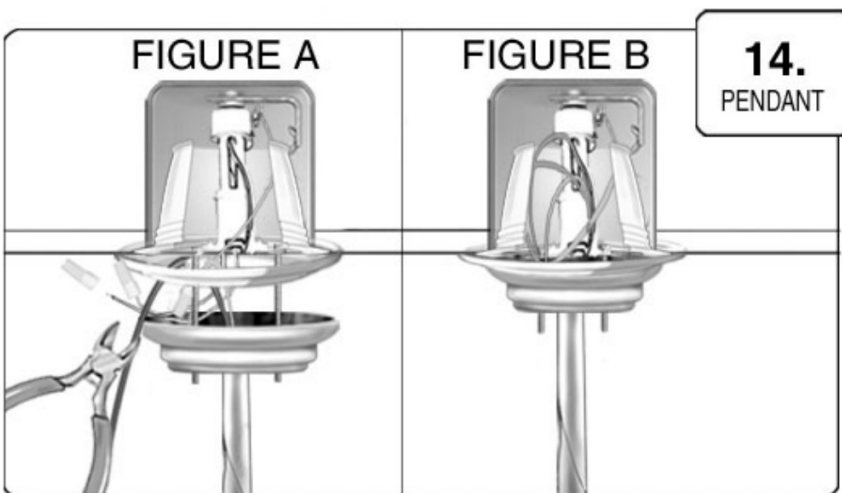

5. fig. A **PENDANT LIGHT:** Secure the pendant light canopy and medallion in place by tightening the decorative attachment nuts to the long screws. Alternately drive the nuts to the fully tightened position. The screws will back-drive, then stop when they are tightly in place.

fig. B FLUSH MOUNT: Secure the flush mount light canopy in place by tighten-ing the long screws directly into the R-1 Unit mounting bar through the flush mount fixture's canopy. Attach any fin-ishing diffuser.
(Turn your power back on at the breaker box. Your installation is now complete)

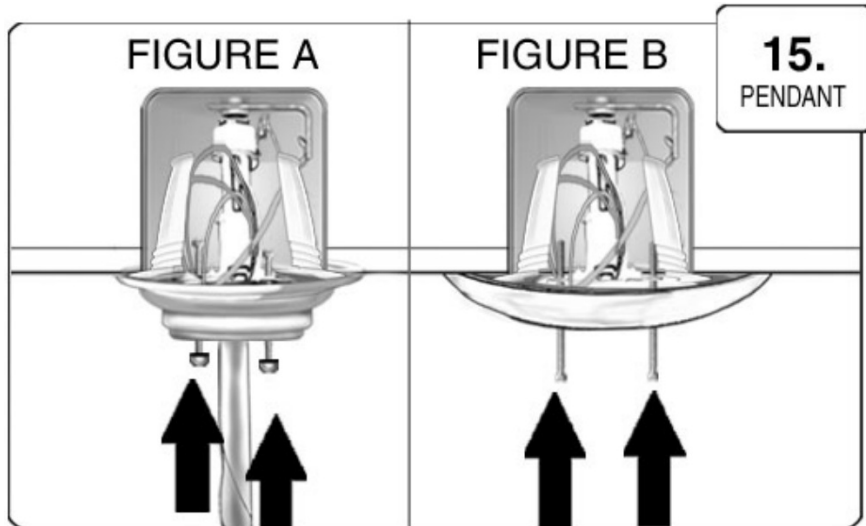

Documents / Resources

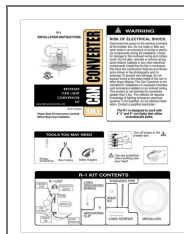

[THE CAN CONVERTER R-1 Recessed Can Light Conversion Kit](#) [pdf] Instruction Manual
R-1, Recessed Can Light Conversion Kit, Light Conversion Kit, Recessed Can Light, Can Light
Conversion Kit, Conversion Kit