



The Box Pro USB2CAND Can Bus Converter User Guide

[Home](#) » [The Box Pro](#) » The Box Pro USB2CAND Can Bus Converter User Guide 

Contents

- [1 USB2CAND Can Bus Converter](#)
- [2 Safety instructions](#)
 - [2.1 Intended use](#)
 - [2.2 Danger for children](#)
 - [2.3 Where to use the product](#)
 - [2.4 General handling](#)
 - [2.5 Keep foreign substances from the unit!](#)
 - [2.6 Controls and connections](#)
 - [2.7 Operating](#)
 - [2.8 Technical specifications](#)
- [3 Documents / Resources](#)
 - [3.1 References](#)
- [4 Related Posts](#)



USB2CAND Can Bus Converter

Quick Start Guide

This quick start guide contains important information on the safe operation of the product. Read and follow the safety advice and instructions given. Retain the quick start guide for future reference. If you pass the product on to others please include this quick start guide.

Safety instructions

Intended use

This device is used to convert signals between USB interfaces and the CAN bus system. Any other use or use under other operating conditions is considered to be improper and may result in personal injury or property damage. No liability will be assumed for damages resulting from improper use.

Danger for children



Ensure that plastic bags, packaging, etc. are disposed of properly and are not within reach of babies and young children. Choking hazard! Ensure that children do not detach any small parts from the product. They could swallow the pieces and choke! Never let children unattended use electrical devices.

Where to use the product

Never use the product

- in direct sunlight
- in conditions of extreme temperature or humidity
- in extremely dusty or dirty areas
- at locations where the unit can become wet
- near magnetic fields

General handling

To prevent damage, never use force when handling the product.

Never immerse the product in water. Just wipe it with a clean dry cloth. Do not use liquid cleaners such as benzene, thinners or flammable cleaning agents.

Keep foreign substances from the unit!

Keep the device away from containers with liquids. Should any liquid get into the unit, this could lead to its destruction, fire or electric shock. Be sure not to let any metal objects into the unit.

Controls and connections

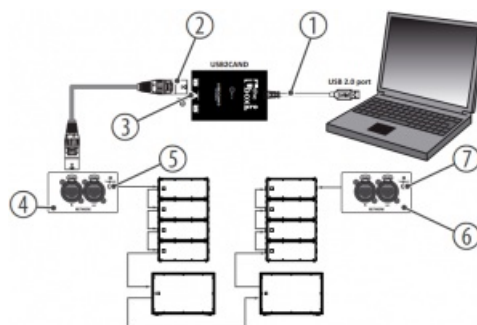

- 1 USB port of the USB2CAND
- 2 Network port [1]
- 3 [TERMINATE] pushbutton of the USB2CAND must be pressed
- 4 First to the bus connected device
- 5 [TERMINATE] pushbutton of the first device must not be pressed
- 6 Last to the bus connected device
- 7 [TERMINATE] pushbutton of the last device must be pressed

Operating

Connect the USB2CAND to your computer and install the corresponding software.

You can download the software from our website:

https://www.thomann.de/de/the_box_pro_a_10_la_line_array.htm

Change to the “DOWNLOADS” area and select “ProNet-Software”.

Connect the first device to your system via the network port [1] of the USB2CAND. All to the bus connected devices are connected via RJ45 network cable in a linear way.

Beginning and end of the bus must be terminated. The beginning is terminated by the USB2CAND. At the end, the [TERMINATE] pushbutton must be pressed on the rear panel of the last device to enable the built-in terminating resistor for termination. The [TERMINATE] pushbutton on all devices between the USB2CAND and the last device must not be pressed.

Note that the [TERMINATE] pushbutton only affects on the network port [1].

Technical specifications

Dimensions (W × H × D): 150 mm × 110 mm × 60 mm

Weight: 0.2 kg

Ambient conditions: Temperature range: 0 °C...40 °C

Relative humidity: 20%...80% (non condensing)



For the transport and protective packaging, environmentally friendly materials have been chosen that can be supplied to normal recycling. Ensure that plastic bags, packaging, etc. are properly disposed of. Do not just dispose of these materials with your normal household waste, but make sure that they are collected for recycling. Please follow the notes and markings on the packaging.



This product is subject to the European Waste Electrical and Electronic Equipment Directive (WEEE) in its currently valid version. Do not dispose of your old device with your normal household waste. Dispose of this product through an approved waste disposal firm or through your local waste facility. Comply with the rules and regulations that apply in your country. If in doubt, consult your local waste disposal facility.

Thomann GmbH • Hans-Thomann-Straße 1 • 96138 Burgebrach • www.thomann.de • info@thomann.de

DocID: 440591_07.07.2021

Documents / Resources

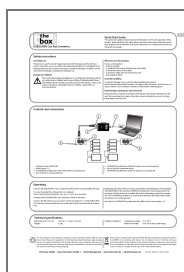

[The Box Pro USB2CAND Can Bus Converter](#) [pdf] User Guide
USB2CAND, Can Bus Converter

References

- [🔗 Welcome – Thomann United States](#)
- [🔗 the box pro A 10 LA Line Array Module – Musikhaus Thomann Warenkorb Warenkorb Warenkorb](#)

Manuals+.