



TFIRETEK HM103-A Projector User Manual

[Home](#) » [TFIRETEK](#) » TFIRETEK HM103-A Projector User Manual 

TFIRETEK USER MANUAL

For more details, please consult online customer service.



Notice

Floos 10 s usor manul oty bors o

Contents

- 1 Safety Tips
- 2 Specifications
- 3 Package Contents
- 4 Projector Introduction
- 5 Using the device
- 6 Q&A
- 7 Maintenance Suggestion
- 8 Warranty Card
- 9 Documents / Resources
- 9.1 References

Safety Tips

For the best viewing effect, please use the projector in dark room.

1. Do not install this projector in the area which directly blown by the air conditioner, to prevent projector failure caused by water vapor condensation or excessive temperature.
2. Ensure that the environment is ventilated to prevent overheating caused by heat build-up.
3. Prevent foreign objects from falling into the machine. Never insert any metal objects into the machine. If foreign objects fall into the machine accidentally,
4. Do not please power on professional to place any liquid on the machine to avoid leakage.
5. Avoid violent vibrations when transporting. Please protect the lens from wear,
6. Do not touch the vents when using the projector to avoid burns due to excessive temperature.
7. Do not look directly at the lens while the projector is running to prevent eye injury.
8. Please clean the filter regularly to prevent malfunction caused by clogging.

Notice

Do not open the case of projector to prevent electric shock. Please seek professional assistance for maintenance matters.

Warn

Do not touch! The inside of the projector contains uninsulated voltage:

Warn

Do not install the projector around flammable objects to prevent fire.

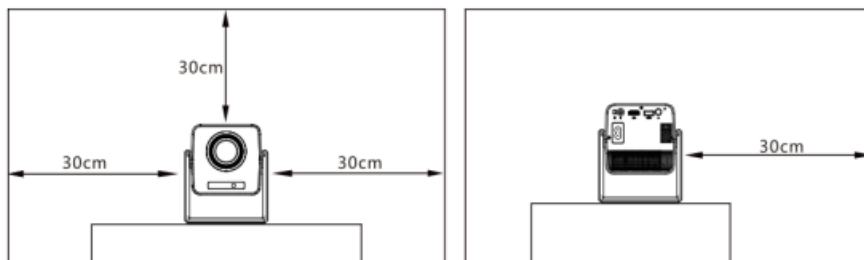

To ensure the performance and stability of the projector, please place it horizontally and leave a space of about 30cm between the projector and the wall.

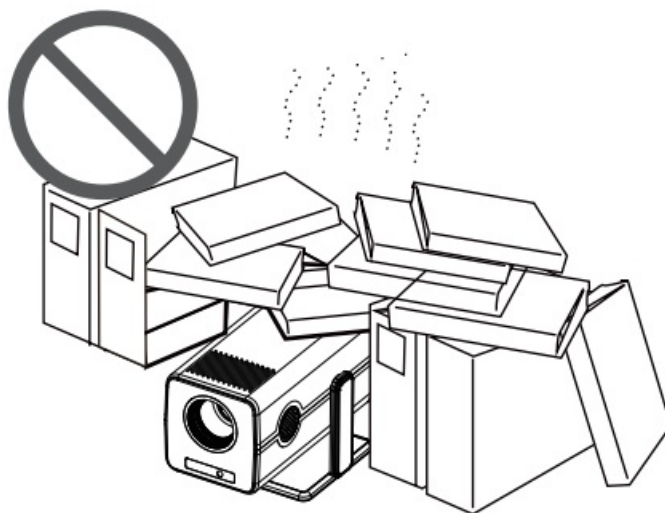

Do not install in places with poor ventilation.

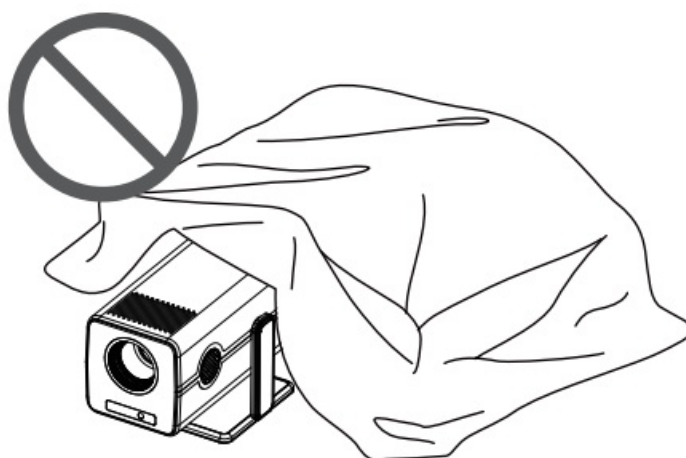

Do not block the vents.

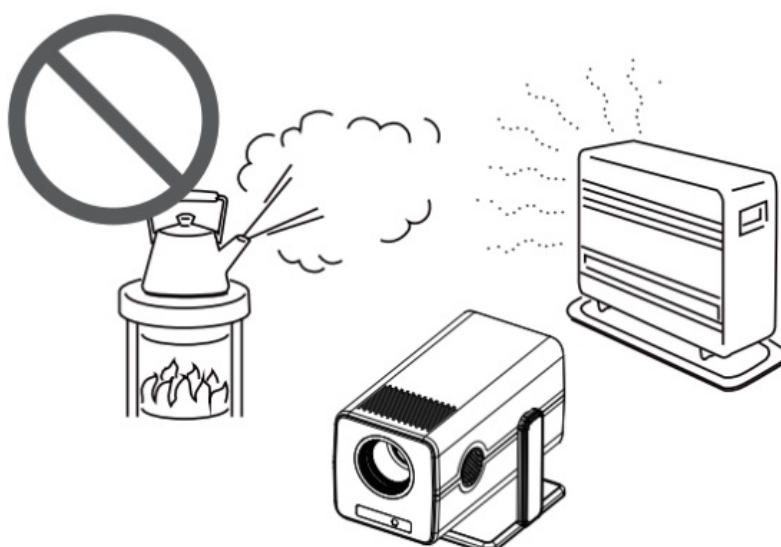

Do not install in high temperature or humid places.

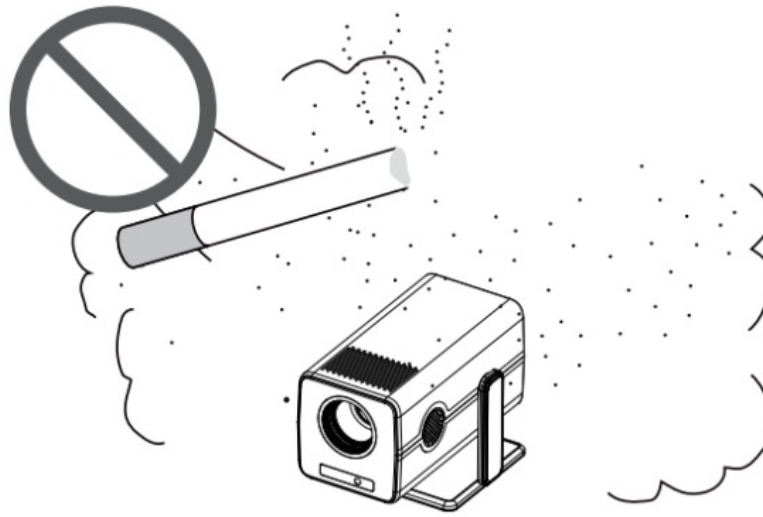

Do not install i dust or smoky places.

Specifications

Item		Specification
Product		HM103-A
Native Resolution		1920X1080
Projection Technology		LCD Display
Lamp Type		LED Lamp
Interface	HD	HD IN*1
	USB	USB 2.0*1
	Earphone	3.5mm audio port
Environment		
Power Input		AC 110-240V 50-60HZ
Operating Temperature		0 – 30°C
Storage Temperature		-20 – 65°C
Operating Humidity		0 – 90% Non-condensing

Package Contents



Projector



Power cord



Remote control



HD cable



User manual

Projector Infroduction

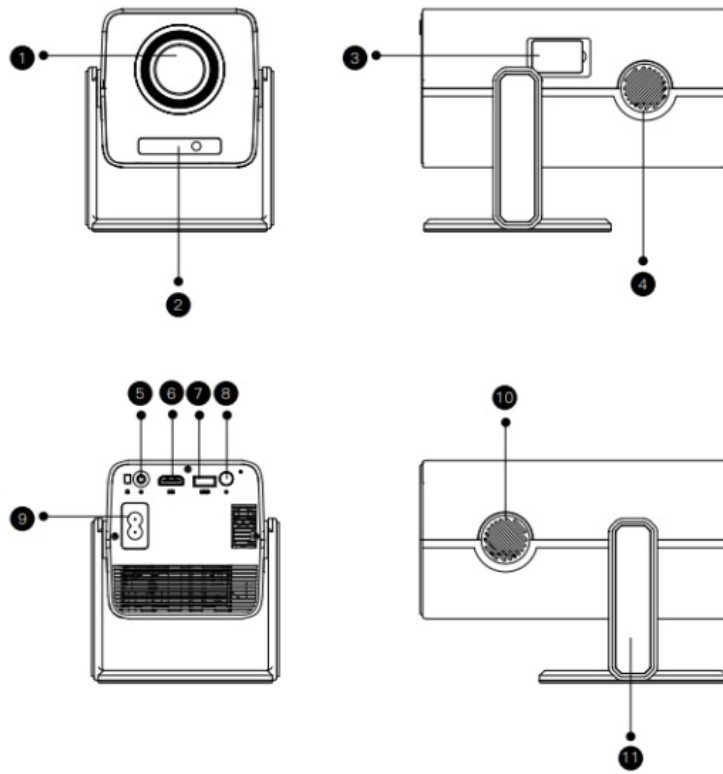

1. Projection Lens
2. IR Remote Sensor
3. Dust Removal Hole
4. Vent
5. 3.5mm Audio Port
6. HD Port
7. USB Port
8. Power On
9. AC Port
10. Vent
11. Bracket

Using the device

1. Network & Internet

This projector can connect to the Internet through Wi-Fi.

- * On the home page, select “ Setting ” to go to the “Network & Internet”, make sure that Wi-Fi is turned on.
- * Select your Wi-Fi network name when it appears in the list.
- * Complete the connection process by following on-screen prompts.

2. Bluetooth

How do connect a speaker to my projector?

- * Turn on the Bluetooth feature on your projector and the speaker.
- * On the home page, select “Setting” to go to the “Bluetooth”, make sure that Bluetooth is turned on.
- * Search for available devices on your projector’s setting menu and select your audio system when it appears in the list.
- * Complete the pairing process by following on-screen prompts.

Q&A

Unable to Boot Up

* Check if the power cord is connected properly, and if the power light is on. Try to unplug and plug the power if the projector still can not boot up.

Remote Controller is Insensitive or Unresponsive

* Do not cover IR receiver. * In the infrared mode, make sure remote points at IR receiver directly. * There is an obstacle between the remote control and the projector. * The batteries are out of power or the battery is not installed correctly * Pair the Bluetooth remote control and make sure is working within 5 meters.

Why is there no display when | connect HD port?

* Check if the interface is securely connected. * The devices may be incompatible.

Blurry Display

* The lens is not clean. * The projection lens is not correctly focused. * The environment is too bright.

Screen Freeze

* Please reboot the projector to test again. If the screen still freeze, please turn off for 10 minutes and turn on again. If you have any questions or suggestions, please contact our online customer service.

Maintenance Suggestion

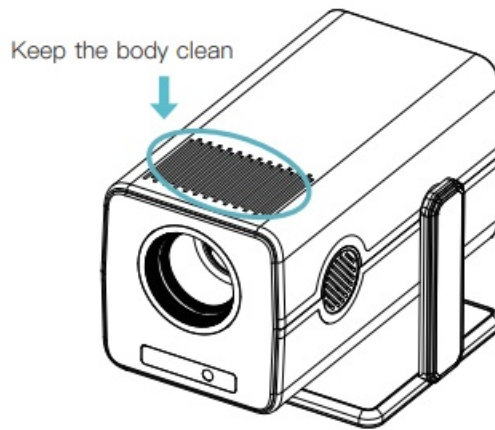

Notice

To make this projector work longer, we recommend you to follow the suggestions.

1. Before cleaning the projector, turn off the projector, then turn off the main power and unplug it from the outlet.
2. Clean the filter regularly every month to prevent clogging.
3. Make sure to close the projector off once you finished using it.
4. Make sure not to use it continuously for more than 6 hours.

Warranty Card

Client Name: — Client ID:

Client Phone Number: —

Purchase shop: —

Return Address: —

Fault description:

(For quick repair, please describe the problem in details.)



This device complies with part 15 of the FCC Rules. Operation is subject to the following two conditions: (1) This device may not cause harmful interference, and (2) this device must accept any interference received, including interference that may cause undesired operation.

Any Changes or modifications not expressly approved by the party responsible for compliance could void the user's authority to operate the equipment.

Note: This equipment has been tested and found to comply with the limits for a Class B digital device, pursuant to part 15 of the FCC Rules. These limits are designed to provide reasonable protection against harmful interference in a residential installation.

This equipment generates uses and can radiate radio frequency energy and, if not installed and used in accordance with the instructions, may cause harmful interference to radio communications. However, there is no guarantee that interference will not occur in a particular installation. If this equipment does cause harmful interference to radio or television reception, which can be determined by turning the equipment off and on, the user is encouraged to try to correct the interference by one or more of the following measures:

- Reorient or relocate the receiving antenna.
- Increase the separation between the equipment and receiver.
- Connect the equipment into an outlet on a circuit different from that to which the receiver is connected.
- Consult the dealer or an experienced radio/TV technician for help.

This equipment complies with FCC radiation exposure limits set forth for an uncontrolled environment. This equipment should be installed and operated with minimum distance 20cm between the radiator & your body.

TFIRETEK

Documents / Resources



[TFIRETEK HM103-A Projector](#) [pdf] User Manual
2A54Y-HM103A, 2A54YHM103A, hm103a, HM103-A Projector, HM103-A, Projector

References

- [User Manual](#)

[Manuals+](#), [Privacy Policy](#)

This website is an independent publication and is neither affiliated with nor endorsed by any of the trademark owners. The "Bluetooth®" word mark and logos are registered trademarks owned by Bluetooth SIG, Inc. The "Wi-Fi®" word mark and logos are registered trademarks owned by the Wi-Fi Alliance. Any use of these marks on this website does not imply any affiliation with or endorsement.