

TESY SL Series Range Hood



TESY SL Series Range Hood Instruction Manual

[Home](#) » [TESY](#) » TESI SL Series Range Hood Instruction Manual 

Contents

- 1 TESI SL Series Range Hood
- 2 Product Usage Instructions
- 3 IMPORTANT SAFETY MEASURES AND INSTRUCTIONS
- 4 CONTENTS OF THE PACKING BOX
- 5 INSTALLATION INSTRUCTIONS
- 6 OPERATING THE RANGE HOOD WITH AND WITHOUT CARBON FILTER
- 7 LAMP REPLACEMENT
- 8 CLEANING AND MAINTENANCE
- 9 FAULTS DIAGNOSTICS
- 10 Technical Chart
- 11 FAQ
- 12 Documents / Resources
 - 12.1 References
- 13 Related Posts

TESY

TESY SL Series Range Hood



Product Specifications:

- **Model:** SL 402 RB
- **Input Voltage:** 220-240 V~ 50Hz
- **Dimensions:** 53mm x 50mm
- **Manufacturer:** TESI Ltd
- **Manufacturer Address:** 48 Blvd. Madara, Shumen, 9700
- **Contact: PHONE:** +359 54 859 129,
- **Email:** office@tesy.com

Product Usage Instructions

Control Panel:

The control panel consists of control switches as shown in Figure 8 and Figure 9 of the user manual.

Installation:

1. Ensure the input voltage is within the specified range (220-240 V~ 50Hz).
2. Mount the product securely on a suitable surface.
3. Connect the necessary electrical connections following the provided wiring diagram.

Operation:

1. Turn on the device using the control switches on the control panel.
2. Set the desired temperature or mode using the available settings.
3. Monitor the device for proper functioning.

IMPORTANT SAFETY MEASURES AND INSTRUCTIONS

PRECAUTIONS AND SAFETY MEASURES

WARNING!

- Please read this manual before operating the appliance and keep it at a safe place for future reference. In case the appliance is obtained by a new owner, it should be transferred together with its manual.

- **CAUTION:** Children under 3 years of age should be kept away from the appliance unless they are under constant supervision.
- Children from 3 to 8 years of age are allowed to operate the on/off button ONLY, provided that the appliance is installed and ready for operation and such children have been supervised and instructed in safe operation of the appliance and they understand all related risks.
- Children from 3 to 8 years of age **MUST NOT:** connect the plug to power sockets, make adjustments, clean it or carry out user maintenance operations.
- This appliance can be used by children older than 8 years of age and by people with reduced physical, sensor, and mental capabilities, as well as by people with insufficient experience and knowledge provided they are supervised or instructed in safe operation of the appliance and understand the related risks. Children should not be allowed to play with the appliance. Cleaning and user maintenance operations must not be carried out by children without supervision.
- **CAUTION:** Accessible parts may become hot when used with cooking appliances.
- **WARNING:** LED lights are very bright and may damage the eyes (risk group 1). You should not look directly at running LED lights for longer than 100 seconds.
- There shall be adequate ventilation of the room when the range hood is used at the same time as appliances burning gas or other fuels. (Not applicable to appliances that only discharge the air back into the room.)
- Do not use the appliance simultaneously with appliances that generate poisonous gases that are released through a flue, like for example stoves running on gas, coal, fuel oil, or wood, unless adequate ventilation has been provided. Such type of heating appliances use air for burning at the place of their installation and release the exhaust gases through the flue. The air gets sucked out from the kitchen or the adjacent room when the range hood operates. This generates a vacuum unless fresh air flow is provided.
- In this case the exhaust gases are sucked in back from the flue and back into the room. Therefore, proper ventilation of the room must be provided.

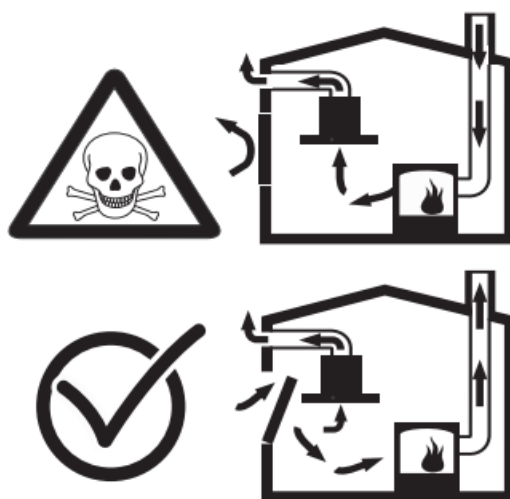

- Clean the appliance regularly. It is compulsory first to turn off the appliance through its power switch and to disconnect it from the power socket.
- There is a risk of fire if the cleaning is not done in accordance with the instructions.
- You shall not light any food on fire (flambe) under the range hood.
- The air must not be discharged into a flue that is used for exhausting fumes from appliances burning gas or other type of fuel. (Not applicable to appliances that only discharge air back into the room).
- When installing the range hood you must observe a minimum 65 cm distance between its lowest part and the surface of the hob on which cookware will be placed. When the range hood is installed over domestic appliance

which uses gas, then the distance shall be at least 65 cm. If the instruction manual of the gas hot plate itself indicates a bigger distance, then it should be taken into account.

- **WARNING:** Failure to install the screws or fix the device in accordance with these instructions may result in electrical hazards.
- Before connecting and switching on the appliance, please check whether the voltage indicated on the rating plate corresponds to the voltage supplied to your home. This appliance operates with the following voltage: 220-240V- 50Hz.
- This appliance shall be used only for the purpose it has been designed for. The appliance is not designed for commercial applications. Any other use shall be deemed incorrect and therefore dangerous.
- The manufacturer does not bear liability for damages resulting from incorrect and irrational use. Nonadherence to these instructions will render the appliance's warranty void!
- Do not leave your home while the appliance is operating. Please ensure it has been switched off.
- If the supply cord is damaged, it must be replaced by the manufacturer, its service agent or similarly qualified persons in order to avoid a hazard.
- The power supply cord of your appliance is equipped with a grounded plug. This cord shall be connected to a grounded power socket.
- Do not bend or crush the power cord during installation! Otherwise, the cord may get damaged.
- Do not break or bend the cord, do not pull it along sharp edges, and do not place it on hot surfaces or open flame!
- Place the power cord in such a way that it does not hamper the movement of people and it will not be stepped on! Use only approved extension cords that are suitable for the appliance, i.e. they should bear a conformity sign!
- Never move the appliance by pulling its cord and never use its cord for transporting objects!
- Only a qualified electrician shall make the electrical connections.
- Any installation done by unauthorized personnel may result in lower performance, damage to the appliance or accidents.
- Do not plug the appliance in the socket before the electrical connections have been completed.
- The socket shall be accessible at all times so that the plug can be taken out of it immediately if necessary!
- Never pull the power cord or the appliance itself while unplugging it from the mains.
- Should you decide to stop using an appliance of this kind, it is recommended to render it unusable by cutting off its cord after you have disconnected it from the mains. It is also recommended to secure all appliance-related risks, especially with regard to children who may use the appliance to play with it.
- Do not touch the lamps if they have been on for a long time – they may burn your hands because they are hot.
- Follow the relevant rules and guidelines for ducting out the exhaust air.
- Never touch the appliance with wet or damp hands
- this is dangerous for your life!
- Switch on the range hood only after You have placed a frying pan, cooking pot, or another cookware on the hot plate. Otherwise, the heat may cause deformities to some parts of the range hood.
- Do not leave cookware with hot oil on the hot plate. Cookware containing hot oil may cause self-ignition.
- Be careful with curtains and tablecloths while cooking, e.g. frying, because the oil may set them on fire.
- Ensure that filters are replaced in time. Filters that are not replaced/cleaned pose risk of fire due to the greasy deposits on them.
- Do not use materials that are not heat resistant instead of filters.

- Do not use the range hood without the aluminum filters. Do not remove the filters while the appliance is operating.
- In case of fire disconnect the power supply of the range hood and of the stove. (Unplug the appliance from the power socket or switch off the circuit breaker.)
- If the range hood and another appliance running on energy different from electricity operate simultaneously, the negative pressure in the room shall not exceed 4Pa.
- If in the same place where the range hood is located there is also an appliance on liquid or gaseous fuel, then this appliance shall be placed in an airtight container.
- Installation of the range hood over an appliance that runs on solid fuel (wood or coal) is allowed only in case the appliance is permanently enclosed. If the appliance has not been cleaned in accordance with the cleaning instructions it is possible to suck in sparkles or other small burning particles and thus cause fire.
- When discharging the air out of the room use pipes with diameter 120 mm or 150 mm. The pipe connection should be as short as possible and to have the minimum possible number of curves.
- In case of fire disconnect the power supply of the appliances, extinguish the fire; never use water!
- This range hood is only intended to be installed over a hob with no more than four hob elements.

UNPACKING THE APPLIANCE

- Upon unpacking the appliance please verify that it has not been damaged during transportation and it has been delivered in full! In case of any damage or incomplete delivery, please contact your authorized seller!
- Do not dispose of the original box! It may be used for storage and transportation to avoid any possible damages resulting from transportation!
- Disposing of the packaging material shall be done in the suitable manner!
- Children shall not play with the polyethylene bags!

CONTENTS OF THE PACKING BOX

The contents of the packaging may vary depending on the specific model:

SL 400 LX, SL 401 TB, SL 402 RB, SL 403 RW

- Range hood
- A set of aluminum filters
- Non-return flap Ø 150 mm
- Installation kit
- Installation template
- Instruction manual
- Warranty card
- Energy label
- Product fiche
- Adapter Ø 150 mm to Ø 120 mm

CHOOSING A LOCATION FOR INSTALLATION OF THE RANGE HOOD

When installing the range hood you must observe minimum 65 cm distance between its lowest part and the surface of the hob on which cookware will be placed.

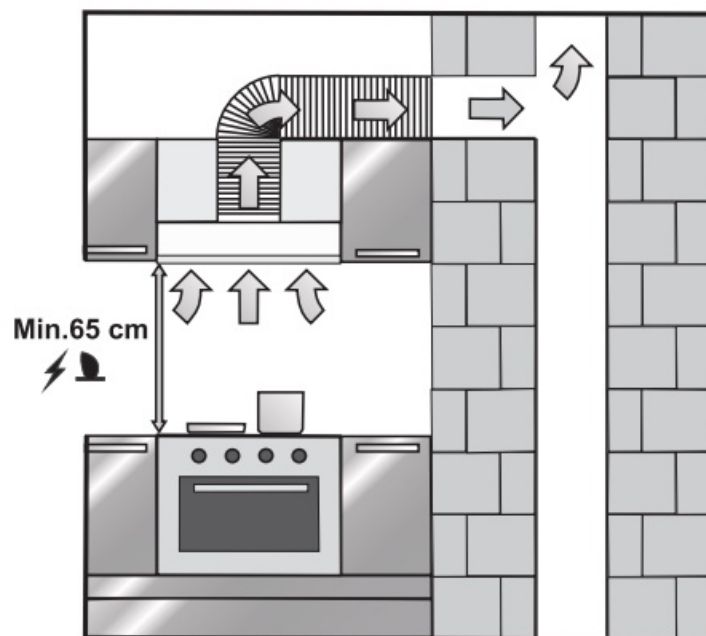

Figure 1 – Requirement for minimum distance from the working surface

INSTALLATION INSTRUCTIONS

- During installation always use protective gloves.
- All safety bolts and safety covers shall be installed in the way specified in the instructions, otherwise the appliance may fall.
- Do not place heavy objects on top of the appliance.

The SL-series range hoods are designed for hidden installation in a kitchen cabinet. Figure 3 below shows the distances between the installation openings for installation in a kitchen cabinet.

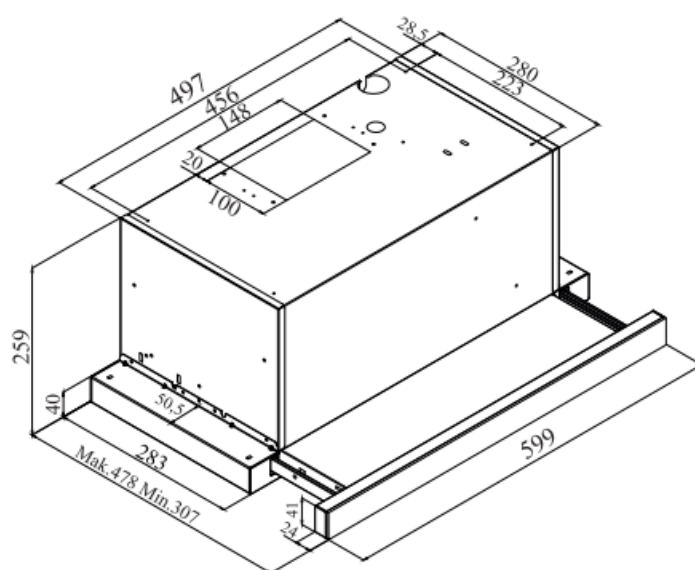

Figure 2 – Range hood dimensions

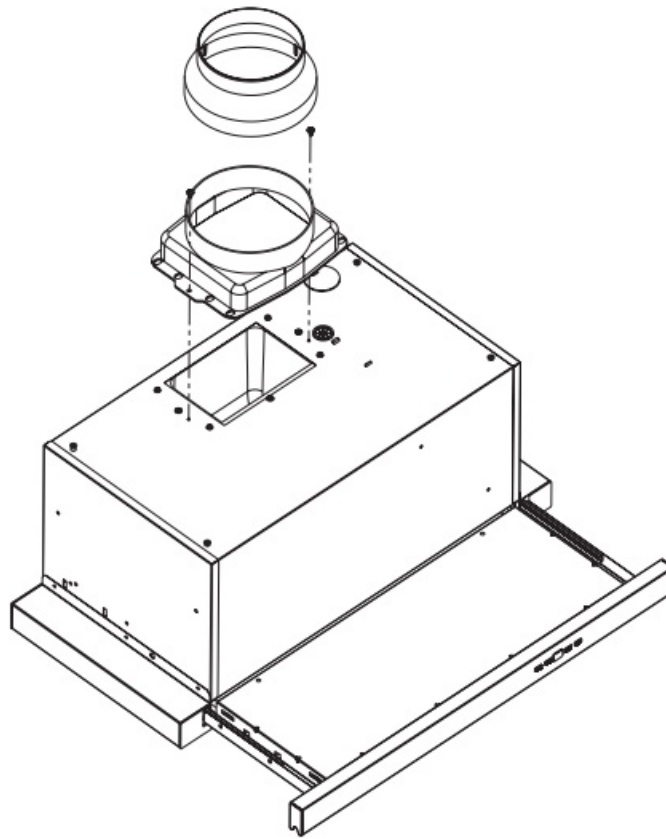

Figure 4 - Installation of non-return flap and adapter

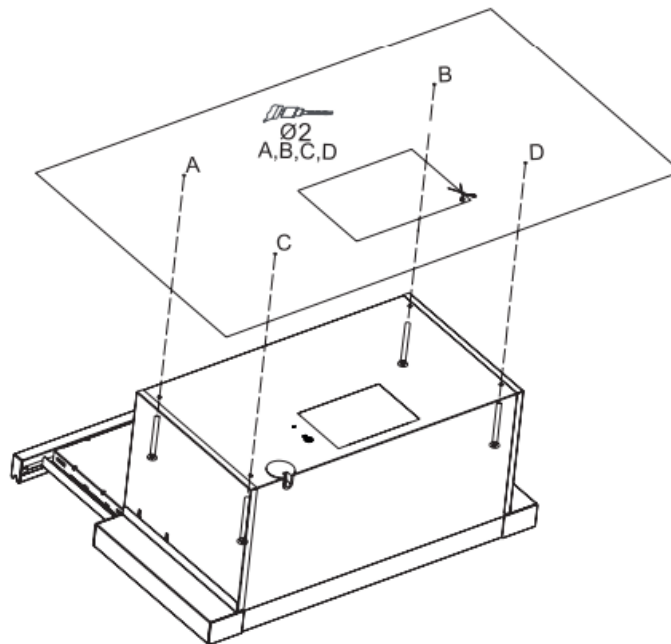

Figure 5 - Installation of the range hood to the bottom of the kitchen cabinet

- Mark on the bottom of the cabinet and drill 4 holes with diameter 02mm, taking into account the distance between the installation openings specified in Figure 3.
- Mark and cut the opening for the non-return flap with dimensions $262\pm5 \times 173\pm5$ mm.
- Install the non-return flap on the upper outlet of the range hood with two screws 03.5 x 12 mm.
- Install the range hood to the bottom of the cabinet with 4 screws 04x40 mm.
- Install the 0 1 SO mm to 0 120 mm adapter over the non-return flap.
- Connect the flexible aluminium pipe to the outlet of the range hood and to the flue, taking into account that the

bends and curves reduce the absorption power, so they should be reduced to the minimum.

- Ensure that the connection will not get loose when the appliance operates at maximum power

Thank You for choosing a TESI electric range hood. This appliance helps for better atmosphere in the kitchen while preparing food. If correctly operated and taken care of, as described in these instructions, the device will give You many years of useful operation.

The present instruction manual explains the installation, operation, maintenance and cleaning of the following models of TESI built-in household electric range hoods:

- SL400 LX
- SL401 TB
- SL402 RB
- SL403 RW

Operation of the range hood SL 400 LX





The range hood is operated by five buttons located on the front panel for comfortable and easy access. The display shows the ventilation speed.



SL 400 LX controls are activated when You pull the front panel forwards. Turning off the range hood is done by pushing the panel back.



Figure 6 - Control buttons of SL 400 LX

Description of the control buttons shown in Figure 5:

-  Button for switching on/off the fan
-  Button for reducing the ventilation speed
-  Button for increasing the ventilation speed
-  Timer for delayed switch off
-  Button for switching on/off the lightening





The range hood is switched on by the button . The display shows a number from 1 to 5 denoting the ventilation speed. Increasing the ventilation speed is done by pressing the button '+'; and for reducing the ventilation speed you should press the button '-'. The in-built lightening of the range hood is switched on/off by pressing the button . By pressing the button C9 you will activate the timer function for delayed switch off, and when 15 minutes have expired the range hood will automatically switch off.

Operation of the range hood SL 401 TB



Figure 7 - Control touch buttons of SL 401 TB

SL 401 TB range hood is operated by four touch buttons located on the front glass panel:

-  Button for switching on / off the lightening
-  Button for switching on / off 1st ventilation speed
-  Button for switching on / off 2nd ventilation speed
-  Button for switching on / off 3rd ventilation speed

The touch buttons are backlit. When the function is selected, the corresponding button lights up. In order to switch the ventilation on you must pull the front panel open. The ventilation speeds can be selected in random order. To switch the ventilation off press the button for the current operational speed or push the panel shut. When pulling the panel next time the appliance will start at the last selected speed. The lightening can be switched on and off both with front panel open and closed. To activate timer function, press and hold any of ventilation speed buttons for 3 seconds. When the timer function is activated the relevant button symbol will flash for 15 mins. Then, the 15-minute timer function will be activated and the product will turn off automatically after 15 minutes.

Operation of the range hood SL 402 RB & SL 403 RW

Range hoods SL 402 RB & SL 403 RW are operated by three switches which you can see after pulling the front panel. The switch located to the left hand side is for switching on/off the lightening, and the other two switches located to the right hand side are for control of the ventilation speed.

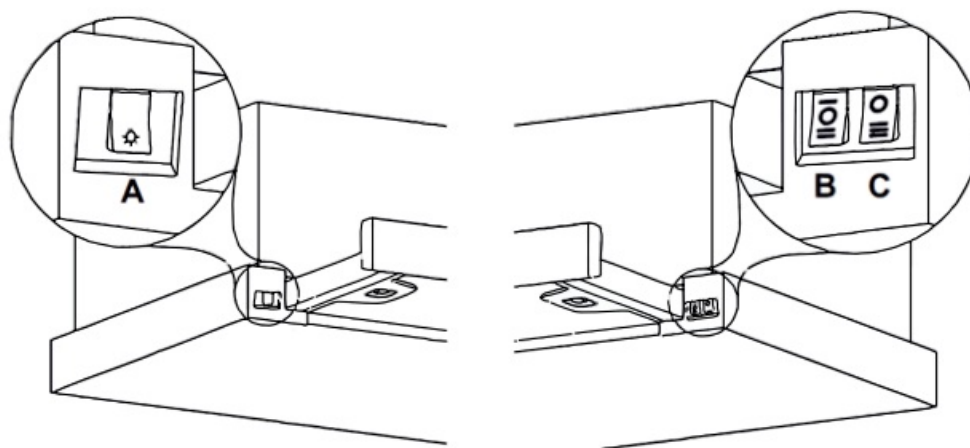

Figure 8 - Control panel

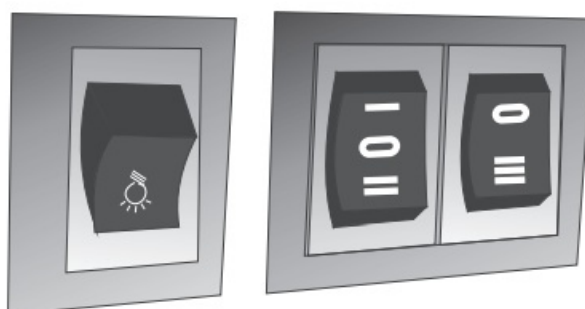

Figure 9 - Control switches

Description of the control switches shown in figure 4:

The lightening switch has two positions – off and on (💡)

The ventilation switch for 1st and 2nd speed has three positions

- I – 1st ventilation speed
- 0 – switched off
- II – 2nd ventilation speed

The ventilation switch for 3rd speed has two positions:

- 0 – switched off
- III – 3rd ventilation speed

In order for the range hood to operate at a particular ventilation speed you need to press the relevant button in the required position. In order for the range hood to operate at 3a speed it has to be selected by pressing its switch, regardless of the position of the switch for 1st and 2d speed. When you stop using the range hood, push the front panel fully backwards. This will activate a switch which will switch off the lightening and the fan. When you need to switch on the range hood, pull forward the front panel and the appliance will start operating with the settings which you have made during its last operation.

OPERATING THE RANGE HOOD WITH AND WITHOUT CARBON FILTER

- Do not use the appliance without filters!
- It is compulsory first to turn off the appliance through its power switch and to disconnect it from the power socket before replacing the carbon filter.
- Never wash the carbon filter. Keep it away from children.

TESY range hoods are intended for use with standard aluminium filters and also with carbon filters which may be purchased separately. There are two types of filters. To install the carbon filters align them with the center of the motor housing, push in and twist clockwise to lock. Removing them is done in reverse order.

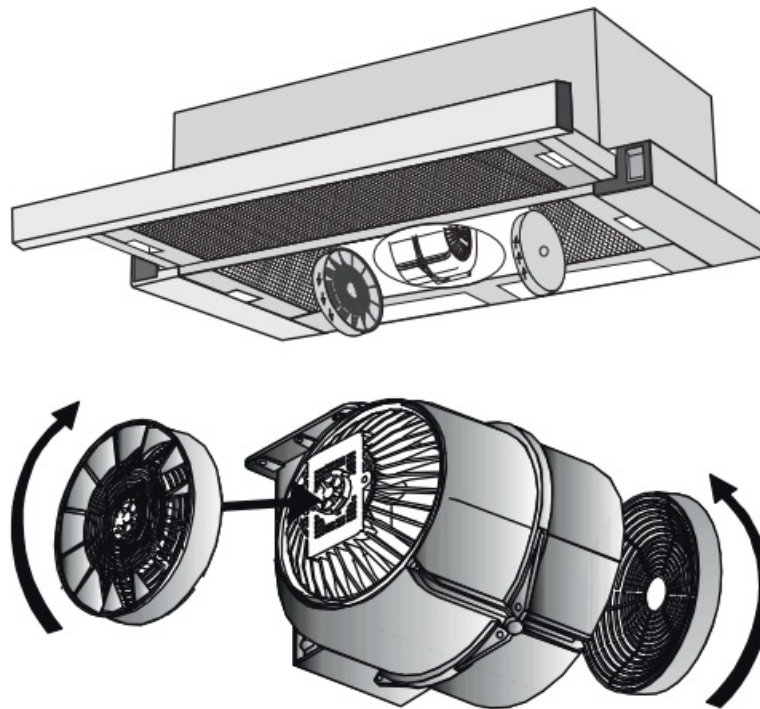

Figure 10 - Installation of charcoal filters

This filter is not included in the package, but you can purchase it from Your supplier or service centre. In this manner of operation the filter shall be replaced with a new one every 3 to 5 months depending on the frequency of use.

LAMP REPLACEMENT

- It is compulsory first to turn off the appliance through its power switch and to disconnect it from the power socket.
- Wait for the lamp cool down, otherwise You may burn yourself.

Bulb Power (W)	3
Lampholder / Socket	GZ 10
Bulb Voltage (V)	220 - 240 V~ 50Hz
Size (mm)	53x50mm
ILCOS Code	DR/F3-220-240- GZ10-50-53
Energy Class	F



Figure 11 - 3W 220 - 240 V~ 50Hz GZ10 LED lamp

SL 400 LX, SL 401 TB, SL 402 RB and SL 403 RW range hoods have two max 3W 220-240 V~ 50Hz GZ10 LED lamps.

In order to replace a faulty lamp, please follow the procedure below:

- Remove the aluminium filters.
- Press down the holder in order to lower the lamp.
- Turn the faulty lamp in a counter clockwise direction.
- Screw the new lamp in a clockwise direction.
- Release the holder.
- Reinstall the aluminium filters.

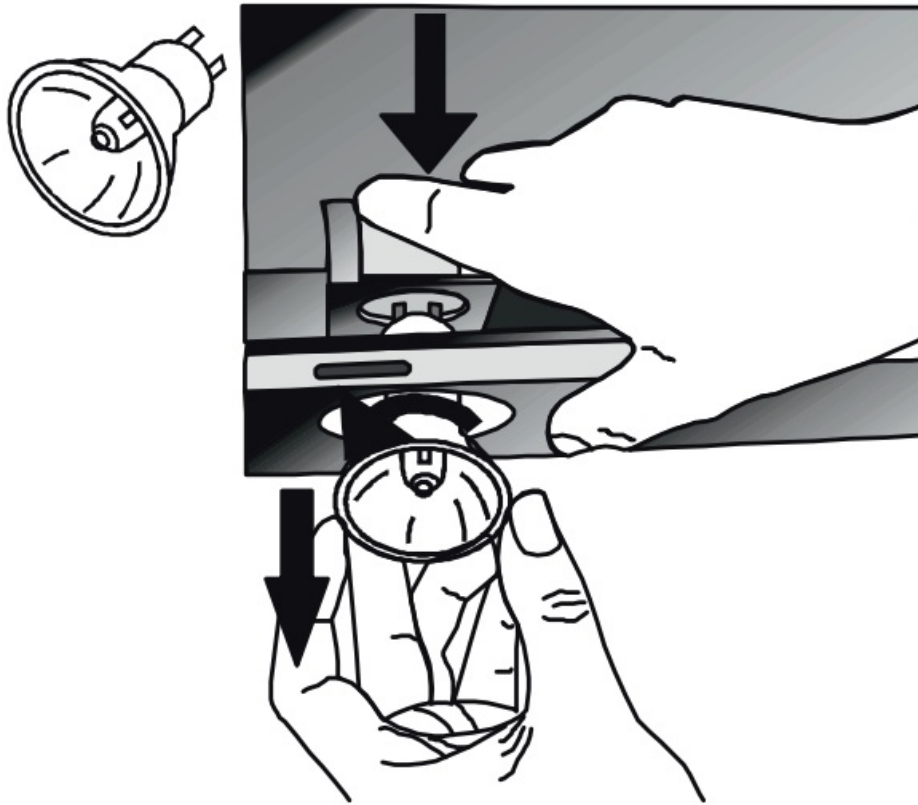

Figure 12 - Replacing a 3W GZ10 LED lamp of SL 400 LX, SL 401 TB, SL 402 RB and SL 403 RW

CLEANING AND MAINTENANCE

- It is compulsory first to turn off the appliance through its power switch and to disconnect it from the power socket.
- Wait until the appliance has cooled down before cleaning it.
- There is risk of damage caused by moisture penetrating into the electronic components. Never clean the control elements with damp cloth.
- The surface may get damaged if any sharp or abrasive cleaning objects or detergents are used. Never use such. You can obtain suitable cleaning and protective detergents from your dealer. The surface of the appliance and the control elements are sensitive to scratches.
- Clean the surface with a soft damp cloth, detergent for dishwashers or soft glass detergent. Do not use dry towels, abrasive sponges, substances which require rubbing, detergents which contain sand, soda, acid or chlorine or other strong chemicals.
- Clean the inox surfaces only in the direction of rubbing.
- Do not use detergents and wet towels on the control elements.
- Never immerse the appliance into water – there is danger for your life from electric shock!

Cleaning the aluminium filters

Wash the aluminium filter regularly. You may need your range hood to operate at higher speed because clogged filters restrict the air flow.

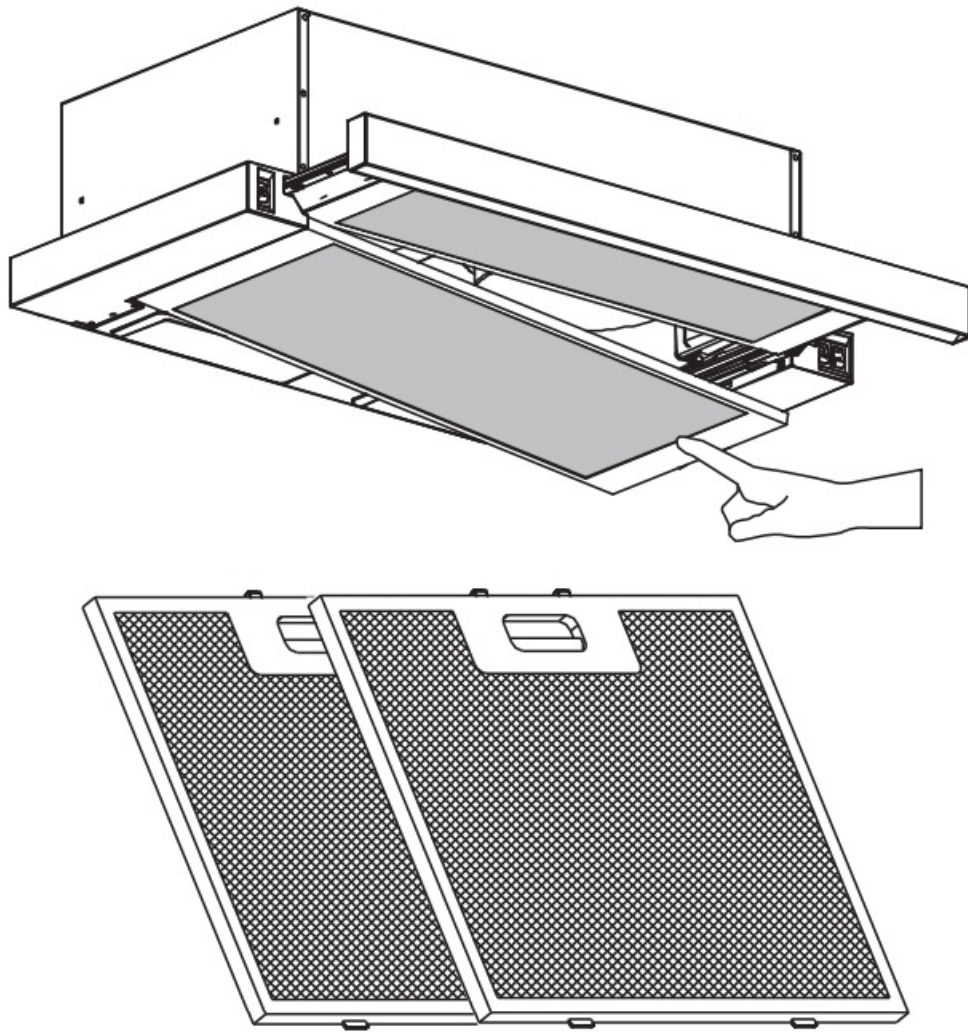

Figure 7 – Method for removing the aluminium filters

- The aluminium filters catch the greasy particles contained in the steam released during cooking. At normal frequency of operation (1-2 hours a day), the aluminium filters have to be cleaned once a month.
- Do not use too strong detergents which contain acid or chlorine.
- While cleaning the metal filter, you need to clean also the holding mechanisms of the metal filter on the appliance with damp cloth.
- You can wash the metal filter in a dishwasher or manually.

Washing the aluminium filters in a dishwasher

- In case of washing the aluminium filters in a dishwasher they may be slightly bleach. This will not affect the performance of the filters. Do not wash the severely clogged aluminium filters together with dishes.
- Place the aluminium filters in the dishwasher freely or positioned without any pressure on the dishes.

Periods of cleaning the aluminum filter of SL 400 LX

The filter must be cleaned when a “C” signal appears on the display or on every 2-3 weeks (according to the frequency of use). After cleaning and replacing the filters + button must be pressed for more than 3 seconds (when the appliance is off) to clear the “C” signal. An “E” signal will appear on the display and the appliance will start operating in the normal position. If you want to continue working without removing the “C” signal, active speed will appear for 1 second when press the button + , then the “C” signal will appear again and the motor will keep working.

Washing the aluminium filters manually

- You can use oil solvent for removing persistent stains. First soften the spots on the aluminium filter with hot water with dishwashing liquid.
- Use a brush to clean it and then rinse the filters with plenty of water.
- Leave the aluminium filters to dry fully before reinstalling them in the range hood.

Additional notes:

- In case of damage or unplanned repairs, unplug the appliance from the power socket or the fuse and call an authorized service technician!
- Repairs shall be always performed by authorized service centres or technicians.
- Use the various speeds of the range hood in the correct manner.
- Operating the range hood at high speed increases the consumption of electricity.

AUTHORIZED SERVICE INTERVENTIONS

If the lightening does not work

- Ensure the appliance is connected to the mains and the fuses are not damaged.
- Check the light bulbs. Ensure the appliance is disconnected from the mains while you are checking. Tighten the lamps if they have got loose. If they still do not work after this, replace them ..

Possible causes and actions you may take without calling service technicians.

The appliance does not operate at all:

- Check whether the appliance is connected to the power supply.
- Check the fuses of the appliance and the main fuses in your home.

If the appliance does not work at full power or it generates loud noises during operation:

- Is the diameter of the exhaust pipes sufficient? (minimum 120 mm)
- Are the metal filters clean? Please check.
- If you use the appliance without ducting the air out of the room, please ensure that the active carbon filters are not more than 6 months old.
- Ensure proper ventilation in the room and fresh air flow. If you are still dissatisfied with the performance of your range hood, please contact an authorized service centre.

FAULTS DIAGNOSTICS

Troubleshooting	Reason	Help
The product does not work.	Check electricity connection.	The mains voltage must be 220-240V and the product must be connected to an earth socket.
The lamp does not work.	Check electricity connection.	The mains voltage must be 220-240V and the product must be connected to an earth socket.
The lamp does not work.	Check electricity connection.	Lamp switch must be in the "on" position.
The lamp does not work.	Check lamps.	The product lamps must not be faulty.
The product air inlet is weak.	Check aluminum filter.	The aluminum cartridge filter must be washed at least once a month under normal conditions.
The product air inlet is weak.	Check air exhaust flue.	The air exhaust flue must be open.
The product air inlet is weak.	Check Carbon filter.	In products where carbon filters are used, the carbon filter must be replaced once every 3 months under normal conditions.
Does Not Discharge Air (Use without Flue).	Check aluminum filter.	Aluminum cartridge filter must be washed at least once a month under normal conditions.
Does Not Discharge Air (Use without Flue).	Check Carbon filter.	In products where carbon filters are used, the carbon filter must be replaced once every 3 months under normal conditions.

Technical Chart

Supply Voltage	220-240V~ 50Hz
Motor Insulation Class	F
Insulation Class	CLASS I

Environment protection instructions

Obsolete electric appliances contain valuable materials and consequently, they should not be treated as domestic waste! We ask for Your cooperation and Your active contribution to protect the resources and the environment. Please submit Your out-of-use appliances to the organized buy-back stations (if there are such).

TESY Ltd

- Shumen, 9700, 48 Blvd. Madara,
- **PHONE:** +359 54 859 129,
- office@tesy.com

FAQ

Q: What should I do if the product does not turn on?

A: Check the power supply and ensure it is within the required voltage range. Verify all connections are secure.

Q: How can I adjust the temperature settings?

A: Use the control switches on the control panel to adjust the temperature settings according to your preference.

Documents / Resources

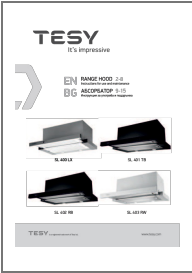
 The image shows a technical specification sheet for the TESI SL Series Range Hood. It features the TESI logo at the top left, followed by a large stylized '7' and the text 'EN 14183:2016' and 'BG 14183:2016'. Below this, there are four small images of the range hood models: SL 400 LX, SL 401 TB, SL 402 RB, and SL 403 RW. The TESI logo is repeated at the bottom left.	<p>TESY SL Series Range Hood [pdf] Instruction Manual</p> <p>SL 400 LX, SL 401 TB, SL 402 RB, SL 403 RW, SL Series Range Hood, SL Series, Range Hood, Hood</p>
--	--

References

- [User Manual](#)

Manuals+. Privacy Policy

This website is an independent publication and is neither affiliated with nor endorsed by any of the trademark owners. The "Bluetooth®" word mark and logos are registered trademarks owned by Bluetooth SIG, Inc. The "Wi-Fi®" word mark and logos are registered trademarks owned by the Wi-Fi Alliance. Any use of these marks on this website does not imply any affiliation with or endorsement.