



TESLA WL71291M Top-Loading Washing Machine User Manual

[Home](#) » [Tesla](#) » TESLA WL71291M Top-Loading Washing Machine User Manual 

TESLA

WL71291M Top-Loading Washing Machine User Manual

Contents

- [1 SAFETY INSTRUCTIONS](#)
- [2 INSTALLATION](#)
- [3 OPERATIONS](#)
 - [3.1 Washing](#)
- [4 Before Each Washing](#)
- [5 Detergent Dispenser](#)
- [6 Control Panel](#)
- [7 Option](#)
- [8 Other functions](#)
- [9 Programs](#)
- [10 Washing Programs Table](#)
- [11 MAINTENANCE](#)
- [12 TROUBLE SHOOTING](#)
- [13 Technical Specifications](#)
- [14 Product Fiches](#)
- [15 Additional information:](#)
- [16 Documents / Resources](#)
- [17 Related Posts](#)

SAFETY INSTRUCTIONS

For your safety, the information in this manual must be followed to minimize the risk of fire or explosion, electric shock, or to prevent property damage, personal injury, or loss of life.

Explanation of the symbols:



This combination of symbol and signal words indicates a potentially dangerous situation that may result in death or serious injuries unless it's avoided.



This combination of symbols and signal words indicates a potentially dangerous situation that may result in slight or minor injuries or damage to property and the environment.



This combination of symbols and signal words indicates a potentially dangerous situation that may result in slight or minor injuries.



The electric shock!

- If the supply cord is damaged, it must be replaced by the manufacturer, its service agent, or similarly qualified persons in order to avoid a hazard.
- The new hose-sets supplied with the appliance are to be used and that old hose-sets should not be reused.
- Before any maintenance of the device, unplug the appliance from the mains.
- Always unplug the machine and turn off the water supply after use. The max. inlet water pressure, in pascals.
The min. inlet water pressure, in pascals.
- To ensure your safety, a power plug must be inserted into an earthed three-pole socket. Check carefully and make sure that your socket is properly and reliably earthed.
- Make sure that the water and electrical devices must be connected by a qualified technician in accordance with the manufacturer's instructions and local safety regulations.

Risk to children!

- EN countries: the appliance can be used by children aged 8 years and above and persons with reduced physical, sensory or mental capabilities or lack of experience and knowledge if they have been given supervision or instruction concerning the use of the appliance in a safe way and understand the hazards involved. Children shall not play with the appliance. Cleaning and user maintenance shall not be made by children without supervision.
- Children of less than 3years should be supervised to ensure that they do not play with appliances.
- Animals and children may climb into the machine. Check the machine before every operation.
- Kids should be supervised that they do not play with the appliance.
- Remove all packages and transport bolts before using the appliance. Otherwise, serious damage may result.
- The plug must be accessible after installation.

Risk of explosion!

- Do not wash or dry articles that have been cleaned in, washed in, soaked in, or dabbed with combustible or explosive substances(such as wax, oil, paint, gasoline, degreasers, dry-cleaning solvents, kerosene, etc.)
This may result in fire or explosion.
- Beforehand thoroughly rinse items of washing by hand.

CAUTION!

Installing the product!

- This washing machine is for indoor use only.
- It isn't intended to be built-in using.
- The openings must not be obstructed by a carpet.
- A washing machine shall not be installed in a bathroom or very wet rooms as well as in rooms with explosive or caustic gases.
- The washing machine with a single inlet valve only can be connected to the cold water supply. The product with double inlet valves should be correctly connected to the hot water and cold water supply.
- The plug must be accessible after installation.
- Remove all packages and transport bolts before using the appliance. Otherwise, serious damage may result.

Risk of damaging appliance!

- Your product is only for home use and is only designed for textiles suitable for machine washing.
- Do not climb up and sit on the top cover of the machine.
- Do not lean against the machine door.
- Cautions during Handling Machine:
 1. Transport bolts shall be reinstalled to the machine by a specialized person.
 2. The accumulated water shall be drained out of the machine.
 3. Handle the machine carefully. Never hold each protruded part on the machine while lifting. Machine door can not be used as the handle during the conveyance.
 4. This appliance is heavy. Transport with care.
- Please do not close the door with excessive force. If it is found difficult to close the door, please check if the clothes are put in or distributed well.
- It is forbidden to wash carpets.

Operating the appliance!

- Flammable and explosive or toxic solvents are forbidden. Gasoline and alcohol etc. Shall not be used as detergents. Please only select the detergents suitable for machine washing, especially for drums.
- Make sure that all pockets are emptied. Sharp and rigid items such as coins, brooch, nail, screw or stone,s etc. may cause serious damage to this machine.
- Please check whether the water inside the drum has been drained before opening its door. Please do not open the door if there is any water visible.
- Be careful of burning when the product drains hot washing water.
- Never refill the water by hand during washing.
- After the program is completed, please wait for two minutes to open the door.

Packaging/Old appliance



This marking indicates that this product should not be disposed of with other household wastes throughout the EU. To prevent possible harm to the environment or human health from uncontrolled waste disposal, recycle it responsibly to promote the sustainable reuse of material resources. To return your used device, please use the collection systems or contact the retailer where the product was purchased. They return and can take this product for environmentally safe recycling.

INSTALLATION

Product Description

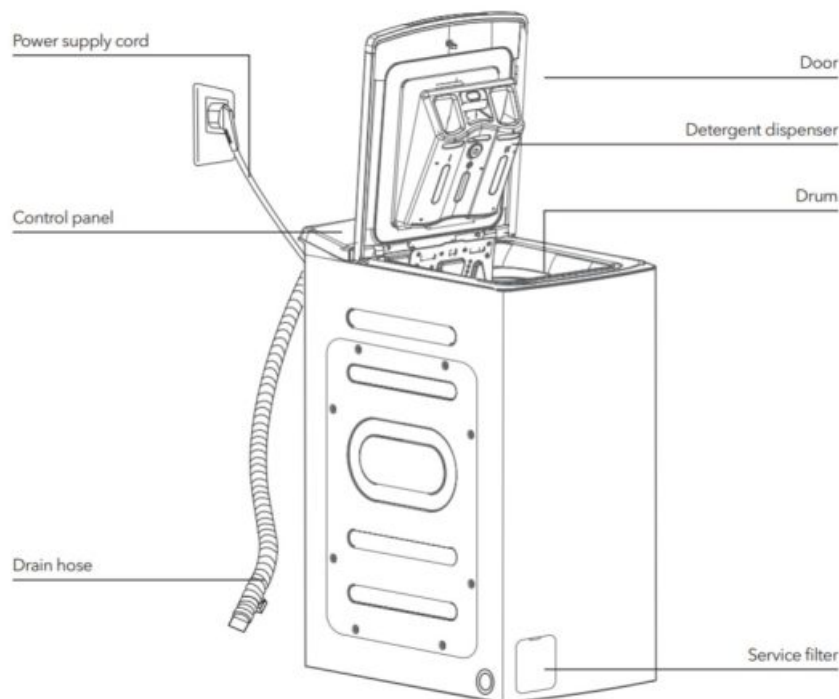

NOTE

- The product line chart is for reference only, please refer to the real product as standard.

Accessories



Transport hole plug



Supply hose
cold water



Drain hose support
(optional)

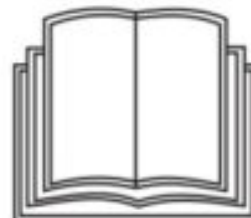

Owner's manual

Installation area



WARNING!

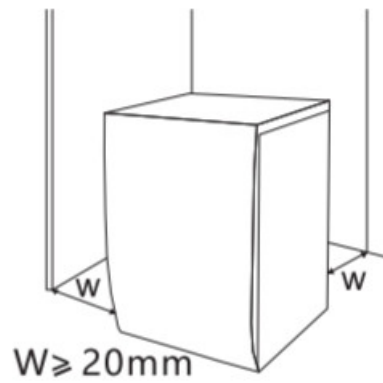

- Stability is important to prevent the product from wandering!
- Make sure that the product should not stand on the power cord.

Before installing the machine, the location characterized as follows shall be selected:

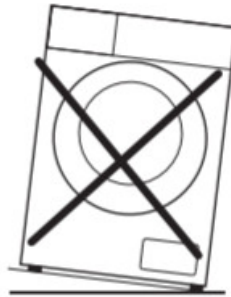

1. Rigid, dry, and level surface
2. Avoid direct sunlight
3. Sufficient ventilation
4. Room temperature is above 0 °C
5. Keep far away from the heat resources such as coal or gas.

Unpacking the washing machine

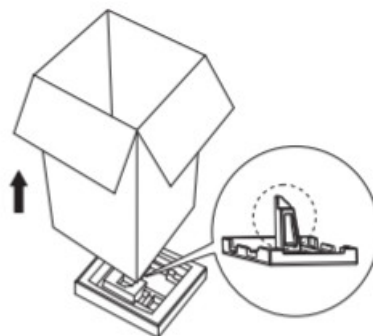

- Packaging material (e.g. Films, Styrofoam) can be dangerous for children.
- There is a risk of suffocation! Keep all packaging well away from children.

1. Remove the cardboard box and styrofoam packing.
2. Lift the washing machine and remove the base packing. Make sure the small triangle foam is removed with the bottom one together. If not, lay the unit down with the side surface, then remove the small foam from the unit bottom manually.
3. Remove the tape securing the power supply cord and drain hose.
4. Remove the inlet hose from the drum.

Remove transport bolts

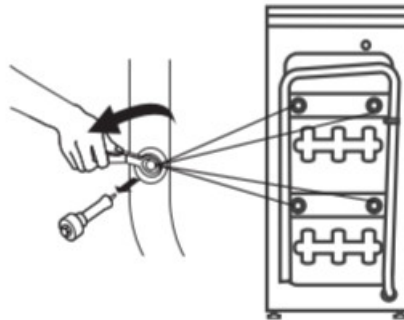

- You must remove the transport bolts from the backside before using the product.
- You'll need the transport bolts again if you move the product, so make sure you keep them in a safe place.

Please take the following steps to remove the bolts:

1. Loosen 4 bolts with a spanner and then remove them.
2. Stop the holes with transport hole plugs.
3. Keep the transport bolts properly for future use.

Leveling the washing machine



- The lock nuts on all four feet must be screwed tightly against the housing.
1. Check if the legs are closely attached to the cabinet. If not, please turn them to their original positions tighten the nuts.
 2. Loosen the lock nut turn the feet until it is closely in contact with the floor.
 3. Adjust the legs and lock them with a spanner, making sure the machine is steady.

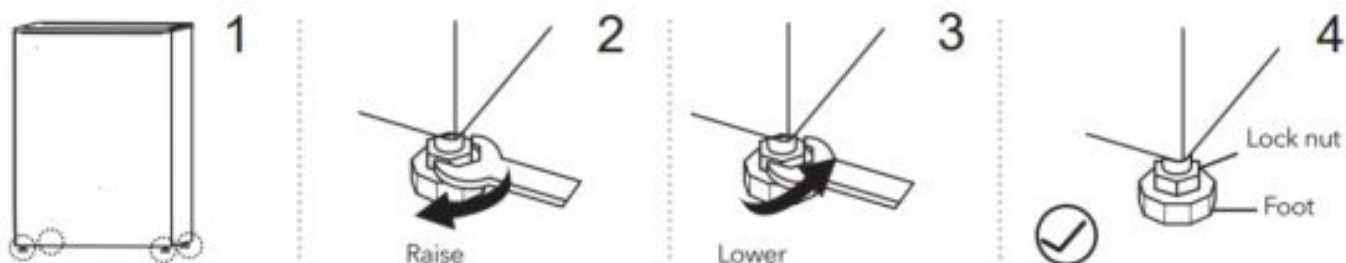

Connect Water Supply Hose



- To prevent leakage or water damage, follow the instructions in this chapter!
- Do not kink, crush, modify or sever water inlet hose.
- For the model equips hot valve, connect it to a hot water tap with a hot water supply hose. Energy consumption will decrease automatically for some programs.

Connect the inlet pipe as indicated, There are two ways to connect the inlet pipe.

1. The connection between ordinary tap and inlet hose.

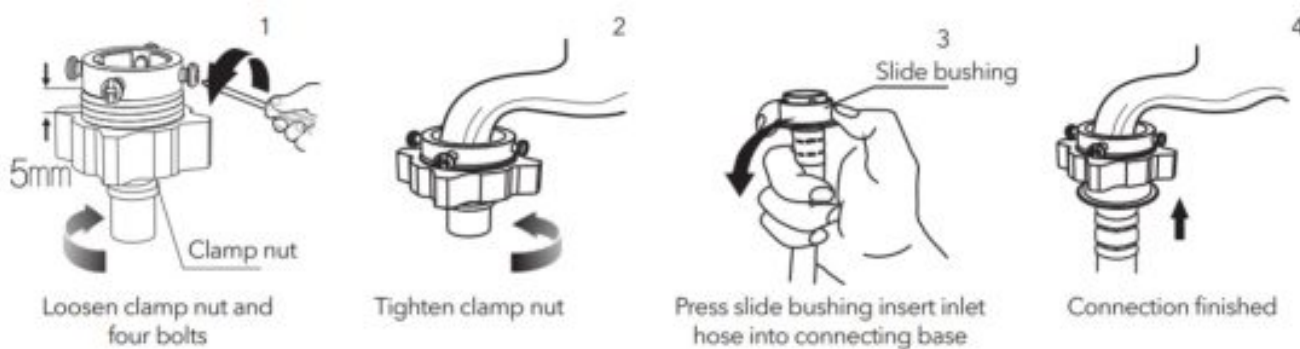

2. The connection between screw tap and inlet hose.



Connect the other end of the inlet pipe to the inlet valve at the backside of the product and fasten the pipe tightly clockwise.

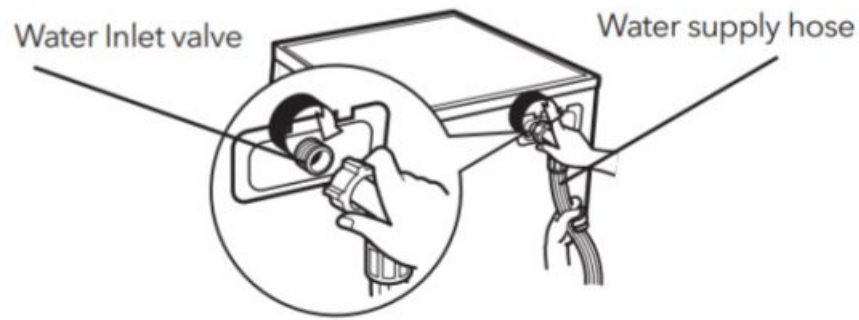

Drain Hose



- Do not kink or protract the drain hose.
- Position drain hose properly, otherwise damage might result of water leakage.

There are two ways to place the end of the drain hose:

1. Put the hose into the water drain

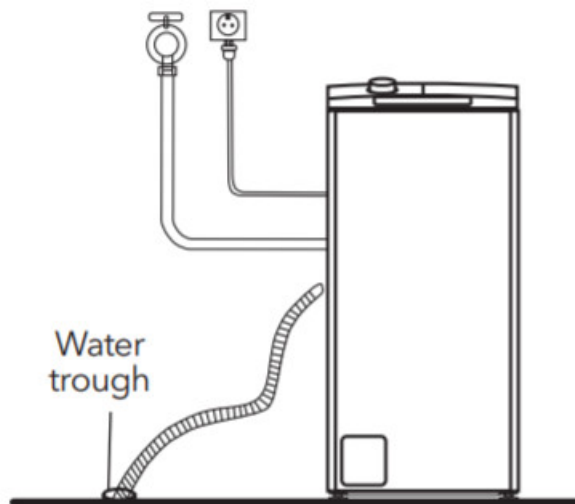

2. Connect it to the branch drain pipe of the trough.

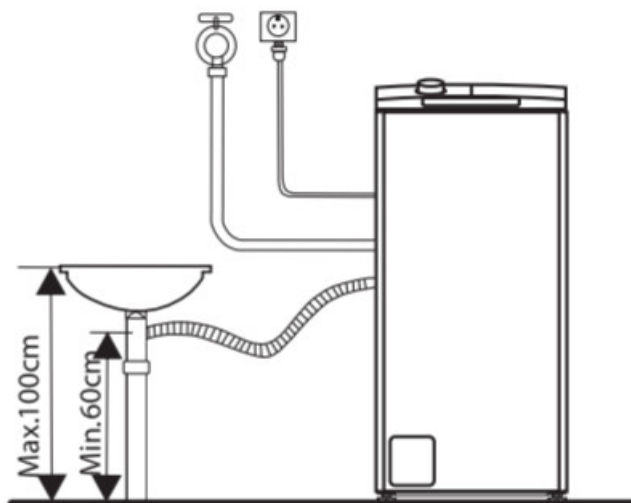

NOTE: If the machine has drain hose support, please install it like the following.

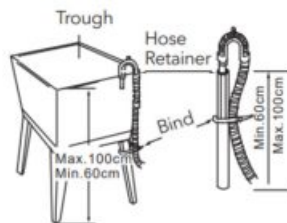
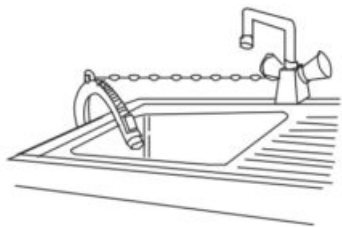

WARNING!

- Before washing, please make sure it's installed properly.
- When installing a drain hose, fix it properly with a rope.
- If the drain hose is too long, do not force it into the washing machine as it will cause abnormal noises.

OPERATIONS

Quick Start

CAUTION!

- Before washing, please make sure it's installed properly.

Before Washing

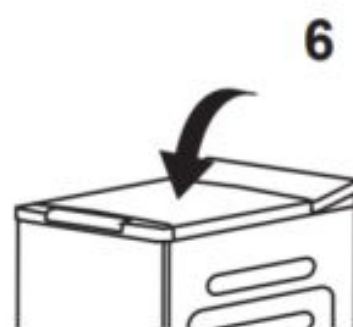
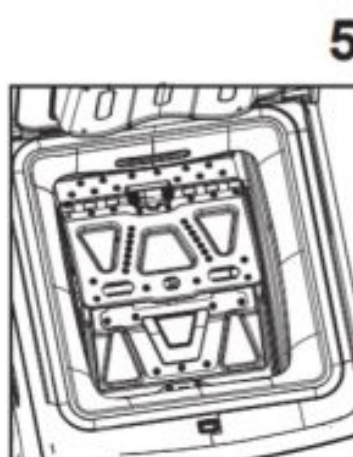
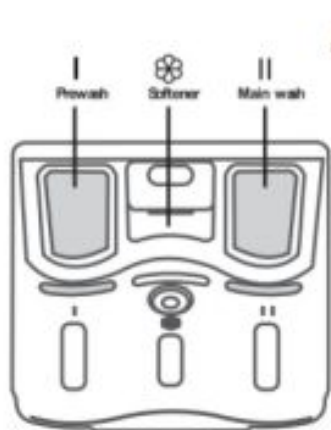
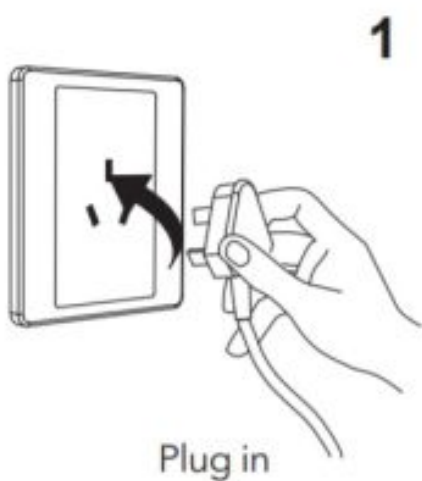

NOTE

- Detergent needs to be added in “case I “after selecting pre-washing for machines with this function.
- Make sure that the drum flaps are properly locked.

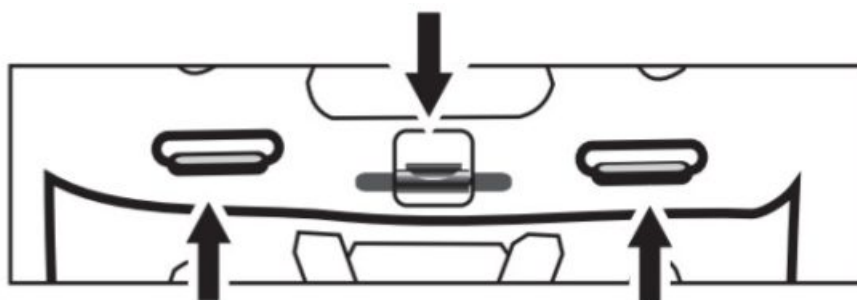

- All metal hooks must be properly hooked inside the rear door flap.

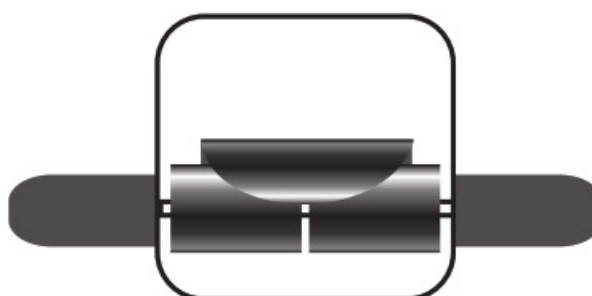

- Check the roller before each laundry, it must roll smoothly.

Washing

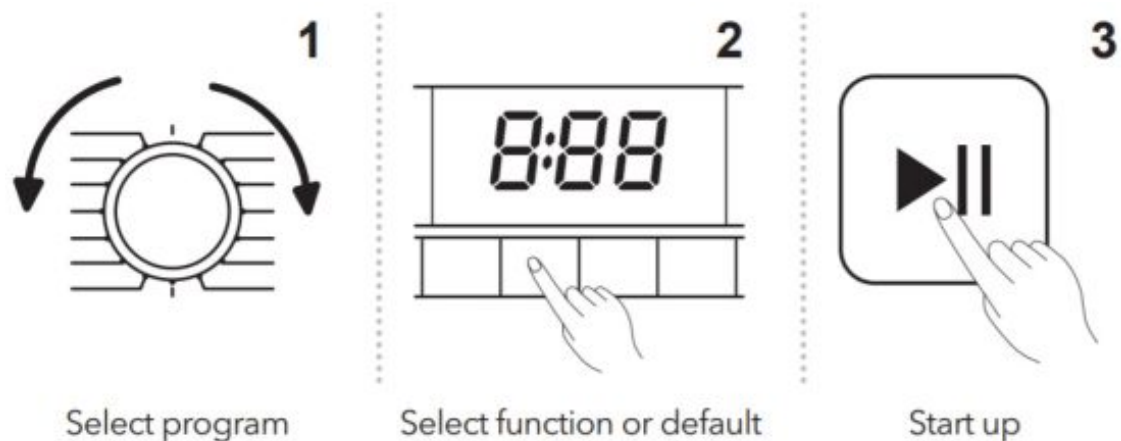

NOTE: If the default is selected, step 2 can be skipped.

After Washing

Buzzer beep or “End” on display.

Before Each Washing

- The working condition of the washer should be (0-40) °C. If used under 0 °C, the inlet valve and draining system may be damaged. If the machine is placed under the condition of 0 °C or less, then it should be transferred to normal ambient temperature to ensure the water supply hose and drain hose are not frozen before use.
- Please check the labels and the explanation of using detergent before washing. Use non-foaming or less-foaming detergent suitable for machine washing properly.



Check the label



Take out the items out of the pockets



Knot the long strips, zip or button



Put small clothes into the pillow slip



Turn easy-pilling and long-pile fabric inside out

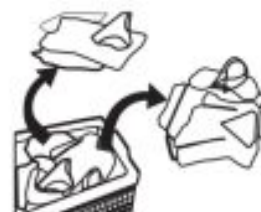

Separate clothes with different textures

WARNING!

- When washing single clothes, it may easily cause great eccentricity and give alarm due to great unbalance. Therefore it is suggested to add one or two more clothes to be washed together so that draining can be done

smoothly.

- Don't wash clothes that have been in touch with kerosene, gasoline, alcohol, and other flammable materials.

Detergent Dispenser

I Prewash detergent

II Main wash detergent



Softener

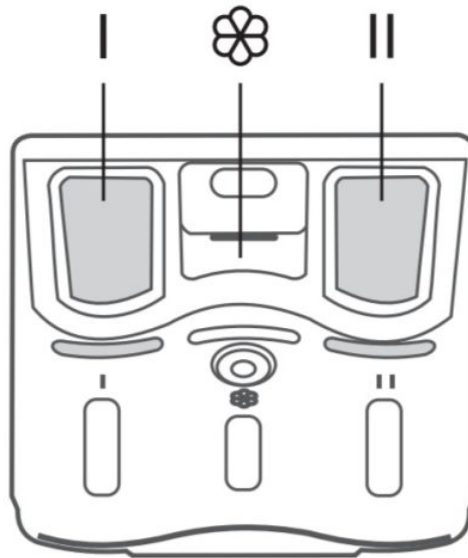



Pull out the dispenser



CAUTION!

- Detergent only needs to be added in “case I “after selecting pre-washing for machines with this function.
- Do not exceed the “MAX” level mark when filling in detergent, additives, or softener.

Program	I	II	
Cotton	<input type="radio"/>	<input checked="" type="radio"/>	<input type="radio"/>
Synthetic	<input type="radio"/>	<input checked="" type="radio"/>	<input type="radio"/>
Mix	<input type="radio"/>	<input checked="" type="radio"/>	<input type="radio"/>
Jeans	<input type="radio"/>	<input checked="" type="radio"/>	<input type="radio"/>
Sportswear	<input type="radio"/>	<input checked="" type="radio"/>	<input type="radio"/>
Drum Clean			
20°C		<input checked="" type="radio"/>	
Intensive		<input checked="" type="radio"/>	

Program	I	II	
Spin Only			<input type="radio"/>
Rinse & Spin		<input checked="" type="radio"/>	<input type="radio"/>
Wool		<input checked="" type="radio"/>	<input type="radio"/>
Daily Wash 45'	<input type="radio"/>	<input checked="" type="radio"/>	<input type="radio"/>
Quick 15'		<input checked="" type="radio"/>	<input type="radio"/>
ECO 40-60		<input checked="" type="radio"/>	<input type="radio"/>
Rapid 45'	<input type="radio"/>	<input checked="" type="radio"/>	<input type="radio"/>



Means must



Means optional



NOTE

- As for the agglomerated or ropy detergent or additive, before they are poured into the detergent box, it is suggested to use some water for dilution to prevent the inlet of the detergent box from being blocked and overflowing while filling water.
- Please choose the suitable type of detergent for the various washing temperature to get the best washing performance with less water and energy consumption.

Control Panel

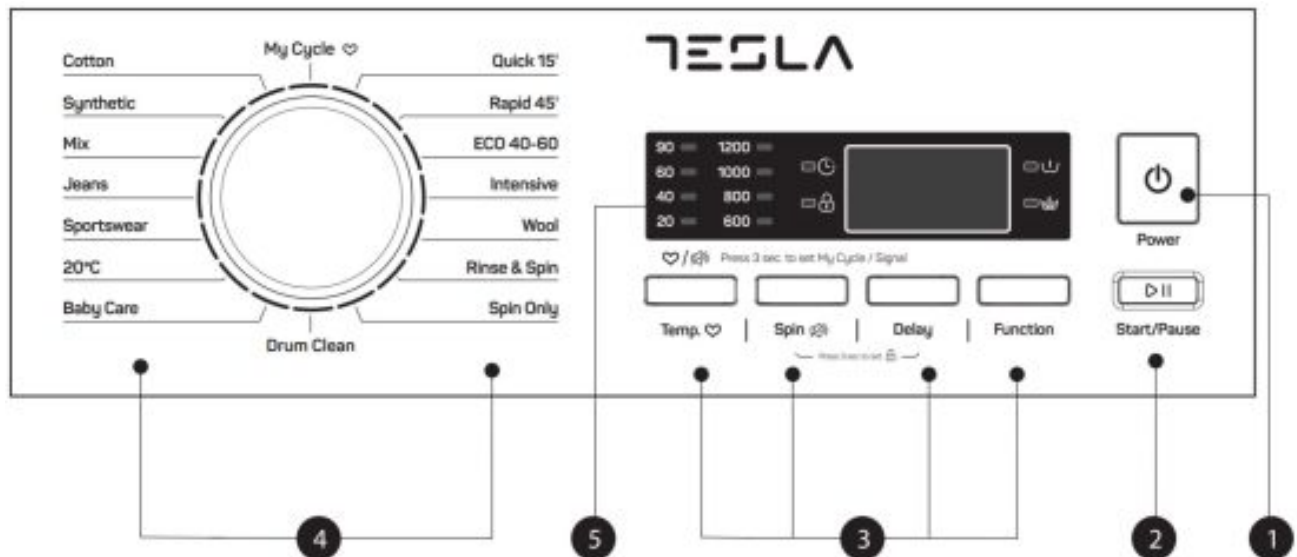

NOTE

- The chart is for reference only, please refer to the real product as standard.

1. On/Off

The product is switched on or off.

2. Start/Pause

Press the button to start or pause the washing cycle.

3. Option

This allows you to select an additional function and will light when selected.

4. Program

Available according to the laundry type.

5. Display

The display shows the settings, estimated time remaining, options, and status messages for your washer. The display will remain on through the cycle.

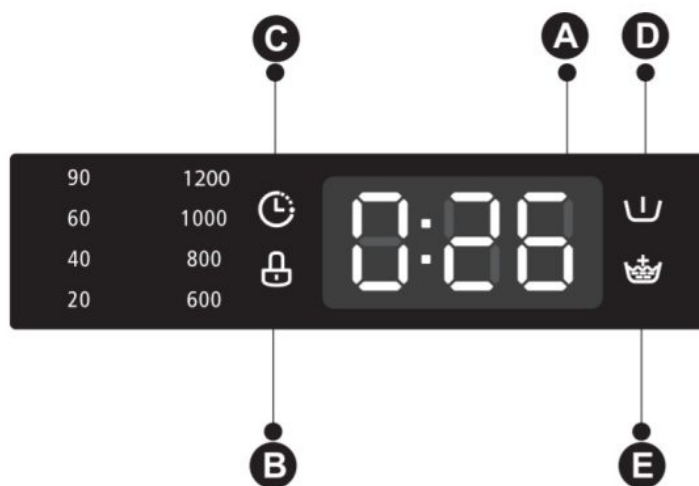

A Display
Wash Time

1.25

End

End

Delay Time

2h

Error

E30

B Door Lock
C Delay
D Pre Wash
E Extra Rinse

Option



Pre Wash

The Prewash function can get an extra wash before main wash, it is suitable for washing the dust rises to the surface of the clothes; You need to put detergent into the Case (I) when selecting it.



Extra Rinse

The laundry will undergo an extra rinse once after you select it.



Delay

Set the Delay function:

1. Select a program;
2. Press the Delay button to choose the time (the delaying time is 0-24 H/3H-6H-9H);
3. Press [Start/Pause] to commence the delayed operation



Cancel the Delay function:

Press the [Delay] button until the display is 0H. It should be pressed before starting the program.

If the program already started should switch off the program to reset a new one.



CAUTION!

If there is any break in the power supply while the machine is operating, a special memory stores the selected program and when the power is restarted, the program will continue.

Program	Option		
	Delay	Extra rinse	Pre-wash
Cotton	<input type="radio"/>	<input type="radio"/>	
Quick 15'	<input type="radio"/>		
Rapid 45'	<input type="radio"/>	<input type="radio"/>	
ECO 40-60	<input type="radio"/>		
Intensive	<input type="radio"/>		
20°C	<input type="radio"/>	<input type="radio"/>	
Rinse & Spin	<input type="radio"/>	<input type="radio"/>	
Spin Only	<input type="radio"/>		

Program	Option		
	Delay	Extra rinse	Pre-wash
Drum Clean	<input type="radio"/>		
Baby Care	<input type="radio"/>	<input type="radio"/>	<input type="radio"/>
Sportswear	<input type="radio"/>	<input type="radio"/>	<input type="radio"/>
Jeans	<input type="radio"/>	<input type="radio"/>	<input type="radio"/>
Wool	<input type="radio"/>	<input type="radio"/>	
Synthetic	<input type="radio"/>	<input type="radio"/>	<input type="radio"/>
Mix	<input type="radio"/>	<input type="radio"/>	<input type="radio"/>



Means optional (Some models have an intelligent weighing function, please refer to the actual product)

Other functions



Temp.

Press the button to regulate the temperature (Cold, 20°C, 40°C, 60°C, 90°C)



Spin

Press the button to change the speed: 0-600-800-1000-1200

Program	Default Speed (rpm)
Cotton	1200
Quick 15'	800
Rapid 45'	800
ECO 40-60	1200
Intensive	800
20°C	1000
Rinse & Spin	800
Spin Only	800

Program	Default Speed (rpm)
Drum Clean	—
Baby Care	800
Sportswear	800
Jeans	800
Wool	600
Synthetic	1200
Mix	800



Child Lock

To avoid misoperation by children.



Choose the Programme

Start

Press [Spin] and [Delay] 3 sec. till buzzer beep.



CAUTION!

- During the “Child Lock” function is activating, the buzzer will beep “Di-Di-Di”, When the buttons are pressed.
- Press the two-button 3sec. also to be released the function.
- The “Child Lock” will lock all buttons except the Power button.
- Cut off the power supply, the kid’s protection is to be released.



Mute the buzzer



Choose the Programme

Press the [Spin]button for 3sec., the buzzer is mute.

To act the buzzer function, press the button again for 3 seconds. The setting will be kept until the next reset. After Muting the buzzer function, the sounds will not be activated any more.



CAUTION!



My Cycle

To memory the frequently used programme.

After choosing the programme and setting the options, press [Temp.] 3 sec. before start to wash.

The default setting course is Cotton.

Programs

Programs are available according to the laundry type

Programs	
Cotton	Hard-wearing textiles, heat-resistant textiles made of cotton or linen.
Synthetic	Wash synthetic articles, for example: shirts, coats, blending. While washing the knitting textiles, detergent quantity shall be reduced due to its loose string construction and easily forming bubbles.
Baby Care	Washing the baby's clothes, it can make the baby's wear cleaner and make the rinse performance better to protect the baby skin.
Rapid 45'	Washing few and not very dirty clothes quickly.
Mix	Mixed load consisting of textiles made of cotton and synthetics.
Sportswear	Washing the activewear.
Jeans	Specially for jeans.
Quick 15'	Extra short programme approx, suitable for lightly soiled washing as a small amounts of laundry.
Delicate	For delicate, washable textiles, e.g. made of silk, satin, synthetic fibres or blended fabrics.
Wool	Hand or machine-washable wool or richwool textiles. Especially gentle wash programme to prevent shrinkage, longer programme pauses (textiles rest in wash liquor).
Spin Only	Extra spin with selectable spin speed.
Rinse & Spin	Extra rinse with spin.
Cotton ECO	To increase the washing effects, washing time is increased.
Drum Clean	Specially set in this machine to clean the drum and tube. It applies 90 °C high temperature sterilization to make the clothes washing more green. When this programme is performed, the clothes or other washing cannot be added. When proper amount of chlorine bleaching agent is put in, the barrel cleaning effect will be better. The customer can use this programme regularly according to the need.
ECO 40-60	Default 40°C, not selectable, suitable for laundry washing at about 40°C-60°C.
Intensive	To increase the washing effects, washing time is increased.
20°C	Washing brightly colored clothes, it can protect the colors better.

Washing Programs Table

Program	Load (kg)	Temp. (°C) (Default)	Display Time
Cotton	7.5	40	03:39
Synthetic	3.75	40	03:17
Mix	7.5	40	01:37
Jeans	7.5	60	01:45
Sportswear	3.75	40	01:31
20°C	3.75	20	01:01
Baby Care	7.5	60	01:42
Drum Clean	–	90	01:18
Spin Only	7.5	–	00:12
Rinse & Spin	7.5	–	00:20
Wool	2	40	01:07
Intensive	7.5	40	03:48
ECO 40_60	7.5	–	03:31
Rapid 45'	2	40	00:45
Quick 15'	2	Cold	00:15

- Concerning to EN 60456:2016 With (EU)No.1061/2010,
The EU energy efficiency class is: A+++
Energy test program: Intensive 60/40°C; Speed:The highest speed;
Other as the default.
Half load for 7.5Kg machine:3.75Kg.
- Concerning to EN 60456:2016/prA2019 With (EU)2019/2014, (EU)2019/2023,
The EU energy efficiency class is: C
Energy test program: ECO 40-60. Other as the default.
Half load for 7.5Kg machine: 3.75Kg.
Quarter load for 7.5Kg machine: 2.0Kg.

NOTE

The parameters in this table are only for user's reference. The actual parameters maybe different with the parameters in above mentioned table.

MAINTENANCE

Cleaning And Care



WARNING!

Before your maintenance starts, please unplug the machine and close the tap..

Cleaning The Cabinet

Proper maintenance on the washing machine can extend its working life. The surface can be cleaned with diluted

non-abrasive neutral detergents when necessary. If there is any water overflow, use the wet cloth to wipe it off immediately. No sharp items are allowed.



NOTE

- Formic acid and its diluted solvents or equivalent are forbidden, such as alcohol, solvents or chemical products, etc.

Cleaning The Drum

- The rusts left inside the drum by the metal articles shall be removed immediately with chlorine-free detergents.
- Never use steel wool.

NOTE

Don't put laundry in the washing machine during the drum cleaning.

Cleaning The Inlet Filter

NOTE

Inlet filter must be cleaned if there is less water.

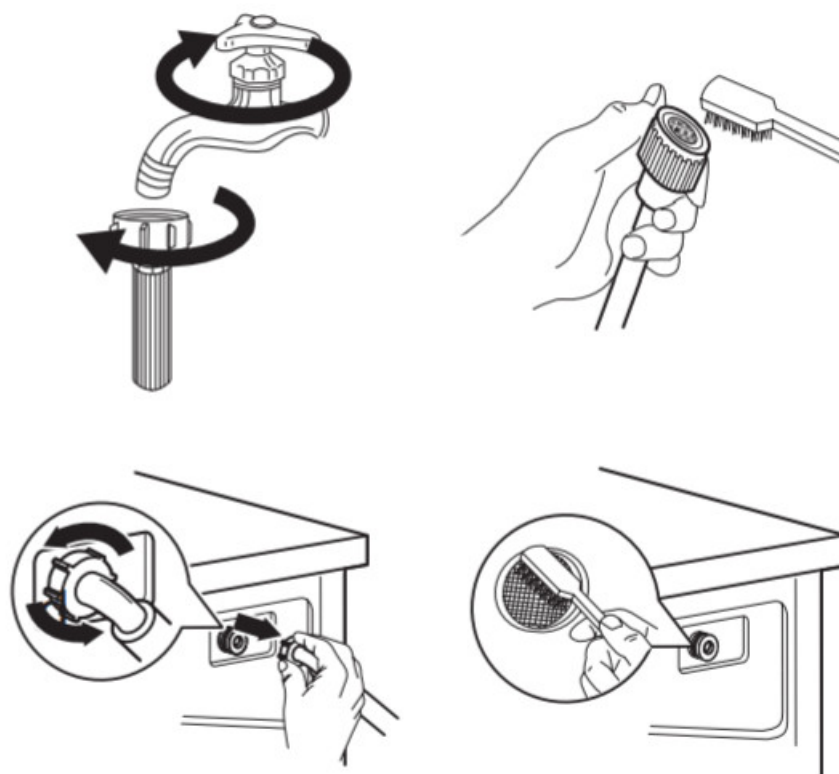

Washing the filter in the tap

1. Close the tap.
2. Remove the water supply hose from the tap.
3. Clean the filter.
4. Reconnect the water supply hose.

Washing the filter in washing machine:

1. Screw off the inlet pipe from the backside of the machine.
2. Pull out the filter with long nose pliers and reinstall it back after being washed.
3. Use the brush to clean the filter.
4. Reconnect the inlet pipe.

NOTE

- If the brush is not clean, you can pull out the filter washed separately;
- Reconnect, turn on the tap.

Clean The Detergent Dispenser

1. Press down the arrow location on softener cover inside the dispenser drawer.
2. Lift the clip up and take out softener cover and wash all grooves with water.
3. Restore the softener cover and push the drawer onto position.

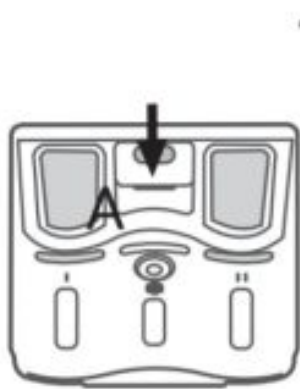

Pull out the dispenser drawer with press the A



Clean the dispenser drawer under water

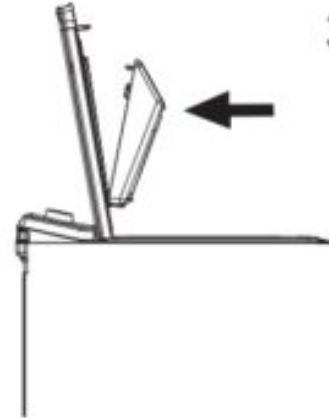

Insert the dispenser drawer



NOTE

Do not use alcohol, solvents or chemical products to clean the machine.

Cleaning The Drain Pump Filter



WARNING!

- Be careful of the hot water!
- Allow detergent solution to cool down.
- Unplug the machine to avoid electrical shock before washing.
- Drain pump filter can filter the yarns and small foreign matters from the washing.
- Clean the filter periodically to ensure the normal operation of washing machine.

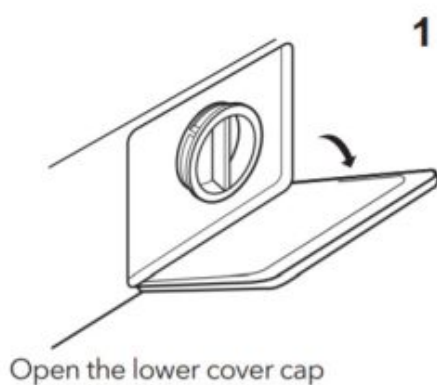

Open the lower cover cap



Open the filter by turning counter clockwise



Remove extraneous matter

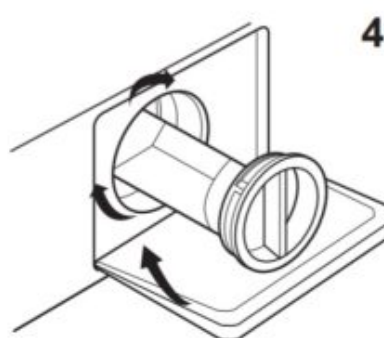

Close the lower cover cap



CAUTION!

- Make sure that valve cap and emergency drain hose are reinstalled properly, cap plates should be inserted aligning to hole plates otherwise water may leak.
- When the appliance is in use and depending on the programme selected there can be hot water in the pump. Never remove the pump cover during a wash cycle, always wait until the appliance has finished the cycle, and is empty. When replacing the cover, ensure it is securely re-tightened.

TROUBLE SHOOTING

The start of the appliance does not work or it stops during operation.

First try to find a solution to the problem, If not, contact the service centre.

Description	Reason	Solution
Washing machine cannot start up	Door is not closed properly	Restart after the door is closed Check if the clothes are stuck
Door can't be opened	Washer's safety protection design is working	Disconnect the power, restart the product
Water leakage	The connection between inlet pipe or outlet hose is not tighten	Check and fasten water pipes Clean up outlet hose
Detergent residues in the box	Detergent is dampened or agglomerated	Clean and wipe the detergent box
Indicator or display does not light	Disconnect the power PC board or harness has connection problem	Check if the power is shut down and the power plug is connected correctly
Abnormal noise		Check if the fixing (bolts) have been removed Check it's installed on a solid and level floor
Description	Reason	Solution
E30	Door is not closed properly	Restart after the door is closed Check if the clothes is stuck
E10	Water injecting problem while washing	Check if the water pressure is too low Straighten the water pipe Check if the inlet valve filter is blocked
E21	Overtime water draining	Check if the drain hose is blocked
E12	Water overflow	Restart the washer
EXX	Others	Please try again first, call up service line if there are still troubles



NOTE

After the check, activate the appliance. If the problem occurs or the display shows other alarm codes again, contact the service.

Technical Specifications

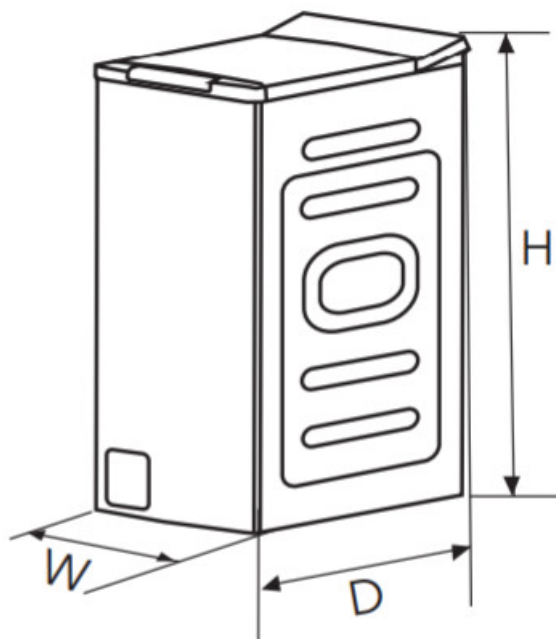

Power Supply	220-240V~,50Hz
MAX.Current	10A
Standard Water Pressure	0.1MPa~1MPa
Washing Capacity	7.5kg
Dimension (WxDxHmm)	400x610x875
Net Weight	56kg
Rated Power	2000W

Product Fiches

Product fiche concerning to EN 60456:2016 With (EU)No.1061/2010.

Trade mark

Model identifier WL71291M

Rated capacity in kg of cotton laundry 7.5

Energy efficiency class on a scale from A+++ (most efficient) to D (least efficient) A+++

Energy consumption 174kWh per year, based on 220 standard washing cycles for the standard cotton programmes at 60 °C and 40 °C at full and partialload, and the consumption of the low-power modes. Actual energy consumption will depend on how the appliance is used.

Energy consumption of the Intensive 60°C programme at full load 0.62kwh

Energy consumption of the standard 60°Ccotton programme at partial load 0.54kwh

Energy consumption of the standard 40°Ccotton programme at partial load 0.51kwh

Weighted power consumption of the off-mode 0.50W

Weighted power consumption of the left-on mode 1.00W

Water consumption 9900 litres per year, based on 220 standard washing cycles for the standard cotton programmes at 60 °C and 40 °C at full and partial load. Actual water consumption will depend on how the appliance is used.

Spin-drying efficiency class B on a scale from G (least efficient) to A (most efficient)

Maximum spin speed 1200

Remaining moisture content 53%

'Intensive 60°C programme' and the 'Intensive 40°C programme' are the standard washing programmes to which the information in the label and the fiche relates, that these programmes are suitable to clean normally soiled cotton laundry and that they are the most efficient programmes in terms of combined energy and water consumption.

Programme time of the standard 60°C cotton programme at full load 280min

Programme time of the standard 60°C cotton programme at half load 260min

Programme time of the standard 40°C cotton programme at half load 255min

Duration time of left-on mode –

Airborne acoustical noise emissions during washing phase 64dB

Airborne acoustical noise emissions during spinning phase 80dB

'Built-in' washing machine No

Energy test program: Intensive 40/60. Speed: the highest speed; Other as the default.

Supplier's name or trade mark:

Supplier's address (b):

Model identifier: WL71291M

General product parameters:

Parameter	Value		Parameter	Value		
Rated capacity (a) (kg)	7.5		Dimensions in cm	Height	88	
				Width	40	
				Depth	61	
EEl w(a)	69.0		Energy efficiency class (a)	C		
Washing efficiency index (a)	1.031		Rinsing effectiveness (g/kg) el	5.0		
Energy consumption in kWh per cycle, based on the eco 40-60 pro-programme. Actual energy consumption will depend on how the appliance is used.	0.611		Water consumption in litre per cycle, based on the eco 40-60 programme. Actual water consumption will depend on how the appliance is used and on the hardness of the water.			
Maximum temperature inside the treated textile(a) (°C)	Rated capacity	41	Remaining moisture content (a) (%)	Rated capacity	54.	
	Half	29		Half	54.	
	Quarter	23		Quarter	54.	
Spin speed (a) (pm)	Rated capacity	1200	Spin-drying efficiency class (a)			
	Half	1200				
	Quarter	1200				
Programme duration (a) (h: min)	Rated capacity	03:31	Type	free-standing	C	
	Half If	02:45				
	Quarter	02:45				
Airborne acoustical noise emissions in the spinning phase (a) (dB(A) re 1 pW)	80		Airborne acoustical noise emission class (a) (spinning phase)			
Off-mode (W)	0.50		Standby mode (W)	1.0		
Delay start (W) (if applicable)	4.00		Networked standby (W) (if applicable) N/A			
Minimum duration of the guarantee offered by the supplier (b):						
This product has been designed to release silver ions during the washing cycle			NO			

Additional information:

Weblink to the supplier's website, where the information in point 9 of Annex II to Commission Regulation (EU) 2019/2023 (1) (b) is found:

(a) for the eco 40-60 programme.

(b) changes to these items shall not be considered relevant for the purposes of paragraph 4 of Article 4 of

Regulation (EU) 201 7/1 369.

(c) if the product database automatically generates the definitive content of this cell the supplier shall not enter these data.



NOTE

- Programme setting for testing in accordance with applicable standard En60456.
- When using the test programmes, wash the specified load using the maximum spin speed.
- The actual parameters will depend on how the appliance is used, and maybe different with the parameters in above mentioned table.
- The household washing machine is equipped with power management system. The duration of the lefton mode time is less than 10 minute.
- The noise emissions during washing/spinning for the standard washing cycle at full load.

Documents / Resources

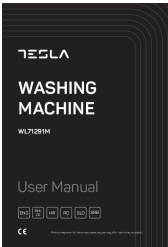
	TESLA WL71291M Top-Loading Washing Machine [pdf] User Manual WL71291M, Top-Loading Washing Machine
--	---