

[Skip to content](#)

Manuals+

User Manuals Simplified.



TESLA TSL-SWI-WIFI1 Smart Switch Dual Battery User Guide

[Home](#) » [Tesla](#) » TESLA TSL-SWI-WIFI1 Smart Switch
Dual Battery User Guide

Contents [hide](#)

[1 TESLA TSL-SWI-WIFI1 Smart Switch Dual Battery](#)

[2 QUICK START GUIDE](#)

[3 Product Indtoruction](#)

[4 Specification](#)

[5 Product outline](#)

[6 Contents Supplied](#)

[7 Tools You'll Need](#)

[8 Installation](#)

[9 APP Operation](#)

[10 Troubleshooting](#)

[11 INFORMATION ABOUT DISPOSAL AND RECYCLING](#)

[12 Documents / Resources](#)

[12.1 References](#)

[13 Related Posts](#)



TESLA TSL-SWI-WIFI1 Smart Switch Dual Battery

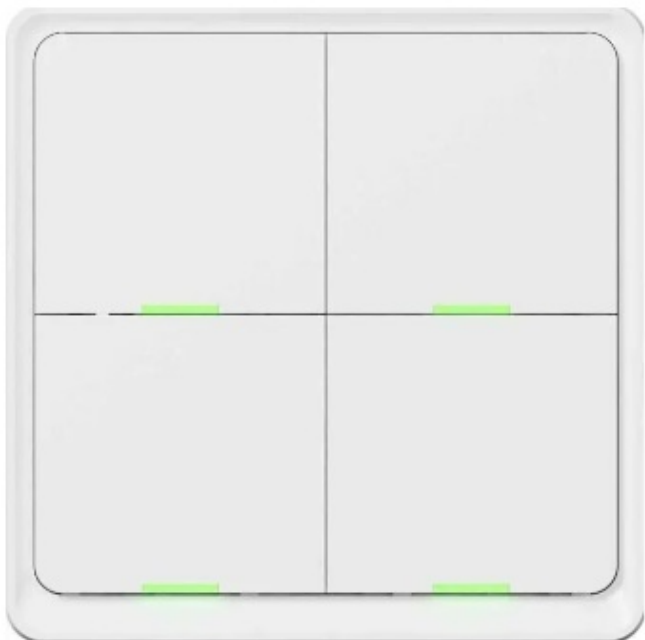

QUICK START GUIDE

- Voice/APP Control
- Smart Home Automation with Multi devices
- Silent switch with LED Indication

Product Indtoruction

Smart switch products are suitable for electrical equipment such as light-nings, fans, curtains, etc., through the network, voice and APP remote control functions, with various sensors to easily achieve home automation.

Specification

Input Power:	200~240V AC 50/60Hz
Resistive load:	INC 3•300W, LED 5•300W
Communication:	WiFi 2.4G
Standby Power:	≤0.5W
Working Temperature:	-10°C ~ 45°C
Working Humidity:	<90%
Life Cycle:	50k times
Dimension:	86x86x37.5mm

Product outline

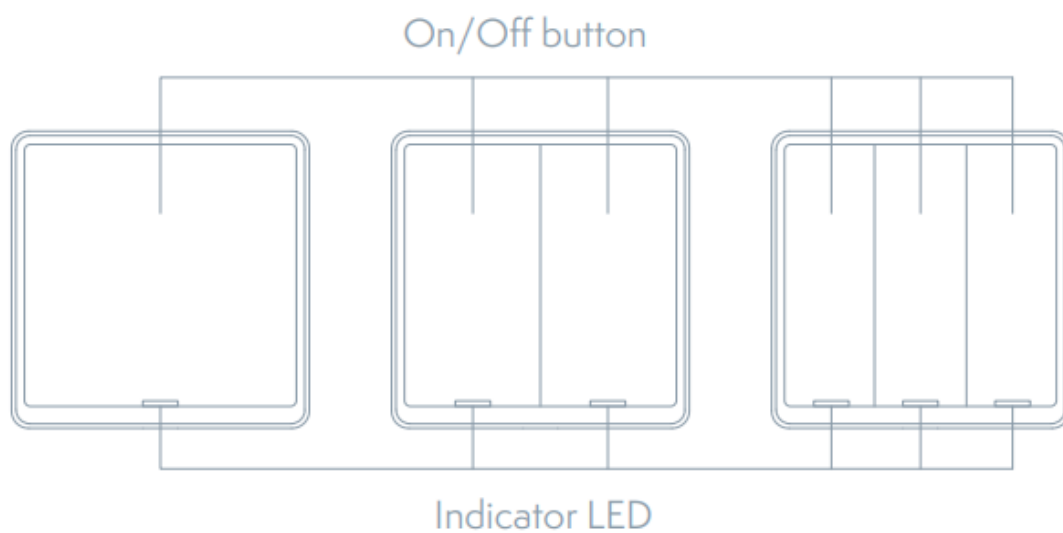

Indicator Light Status

Light Color	Light Status	Switch Status:
Green	OFF	The switch turn off
	ON	The switch turn on
	Flicker	The switch is in quick configure mode
White	ON	The switch turn on
	OFF	The switch turn off
Green	ON	The switch turn off
	OFF	The switch turn on

Contents Supplied



Screws

Tools You'll Need



Screwdriver



Flat-head Screwdriver



Voltage tester

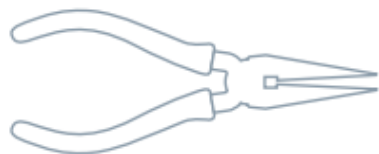

Pliers



Approximately
30 minutes of your time
to install and setup
the Switch

Installation

WARNING: RISK OF ELECTRIC SHOCK

This product installation requires handling 100-240 volt wiring. Follow each step carefully. If any concerns handling



wiring, hire a qualified electrician. Ensure all work meets applicable local and national codes.

1. **Turn Off The Breaker**

Turn off the circuit break and use the electrical tester to test the power.

2. **Connection Diagram**

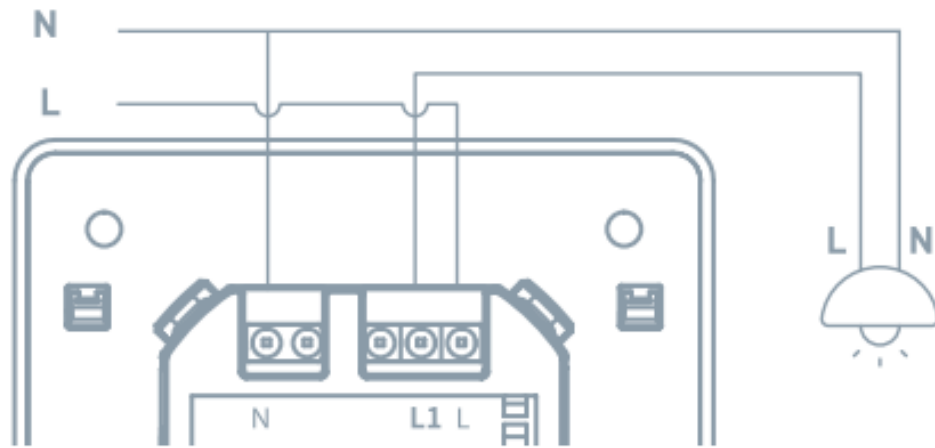

1 GANG

2 GANG

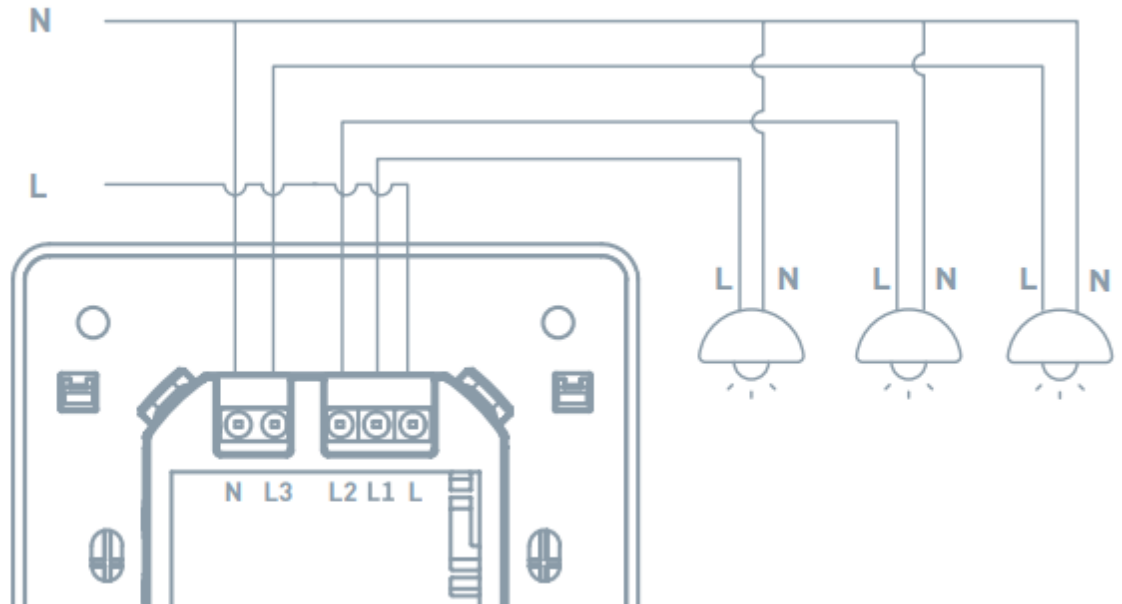
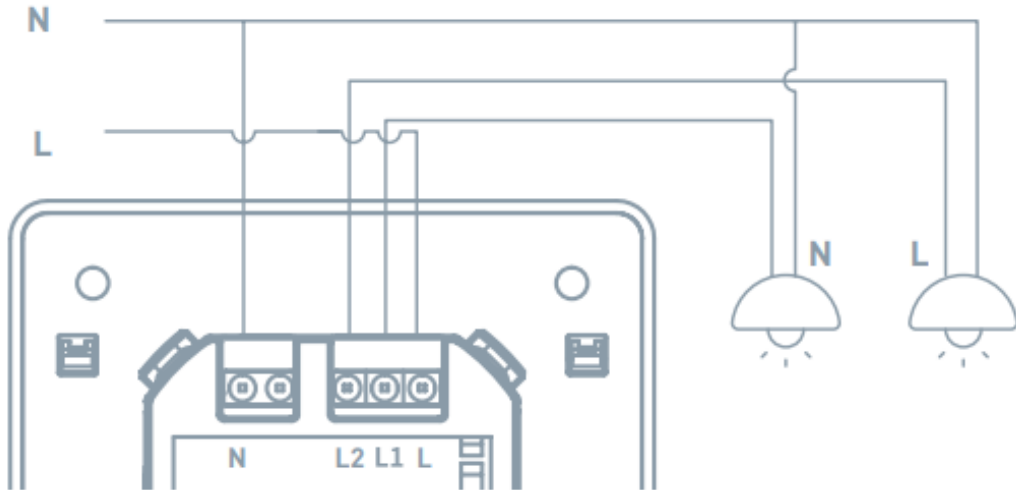

3 GANG

3. Remove The Panel

Remove the switch panel cover of the switch.

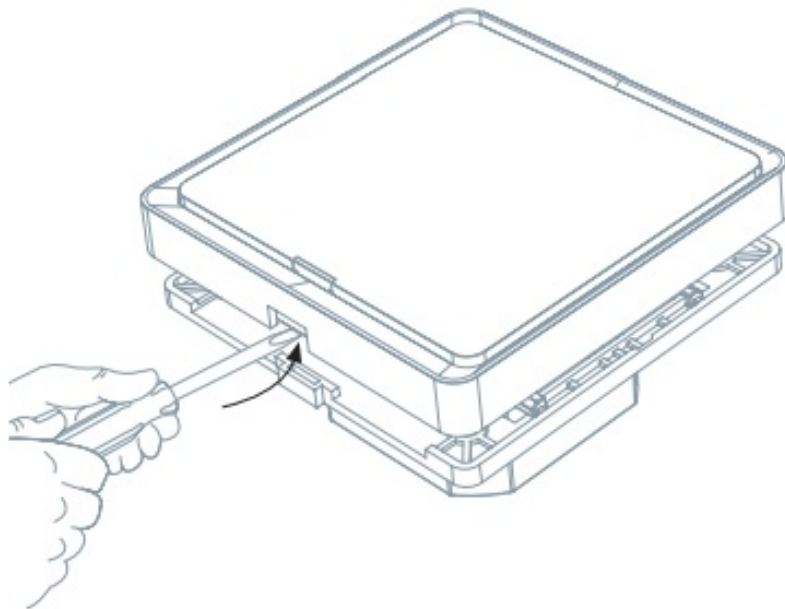

4. Mount The Switch

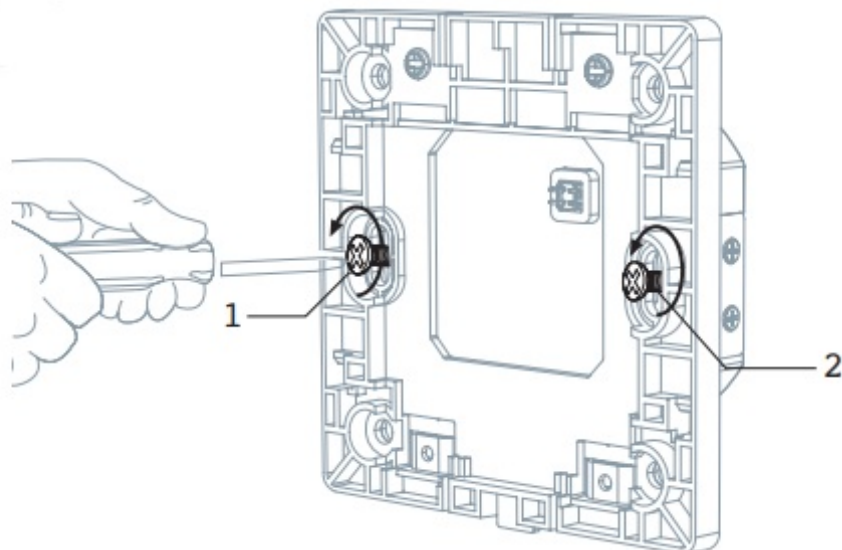

Use the screws provided.

5. Attach The Wallplate

Attach the adapter to the switch using the screws provided and snap on the wallplate.

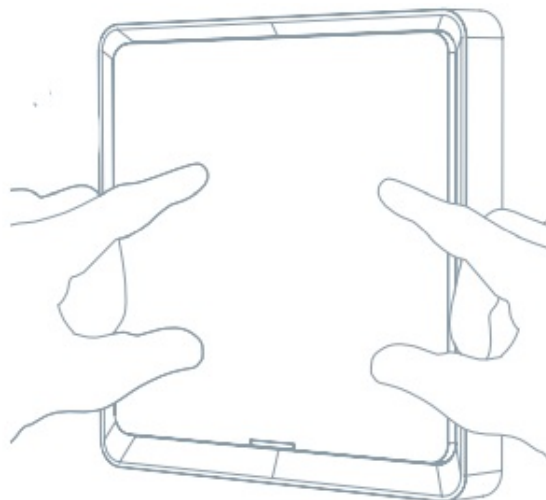

6. Turn On The power

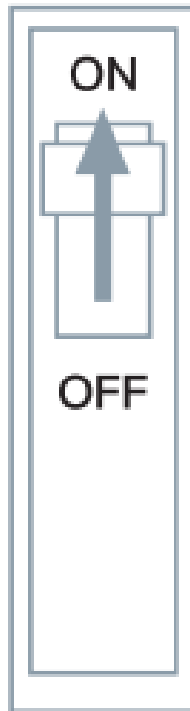

Turn the power back on at the circuit breaker

APP Operation

1. Preparation for use

- Tesla Smart is available for both iOS and Android OS. Search the name 'Tesla Smart' in App Store or Android Market, or scan the QR-Code to download the App and register or login your account.



- Make sure that the smartphone is connected to the 2.4Ghz network.

2. Connect the device

- Open Tesla Smart app and click "+" sign to Add new device
- Select Switches – Tesla Smart Switch
- Please follow the instructions to add the Tesla Smart Switch step by step

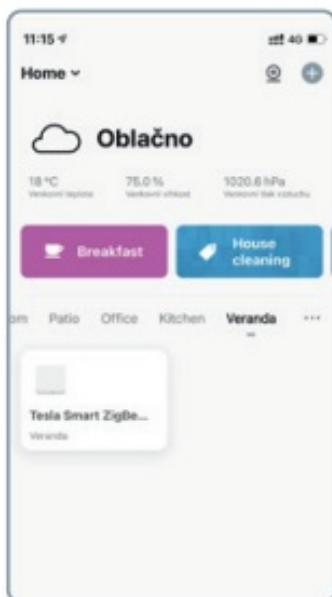

3. Control Switch

- Control switch with APP

Troubleshooting

1. Switch has not power on? The smart switch products need to be powered by the neutral line. If there is no neutral line in the inch-Manor location, the smart switch can not work
2. Can not connect to APP? Make sure the mobile phone and devices (gateways) in a same Wi-Fi network, and the device power an get into pair mode, make sure the device has good signal to support communication.
3. How far can be controlled? Please make sure that the distance between the product and the Wi-Fi router or gateway does no- exceed 25 meters, If the partition wall is used but the material and thickness of the wall will have a greater impact communication, based on the actual situation, users can consider adjusting the location of the Wi-Fi router or gateway or increasing Wi-Fi routers or gateways to ensure normal product communication.
4. Can the Switch still work if the network is disconnected? In the event of a network disconnection, the status indicator will flash. At this time, all APP control, smart linkage and other network functions will be invalid but the local control will not be affected.

Reset

Press and hold switch button for 5s until LED flash to reset the switch and get into quick configure mode.

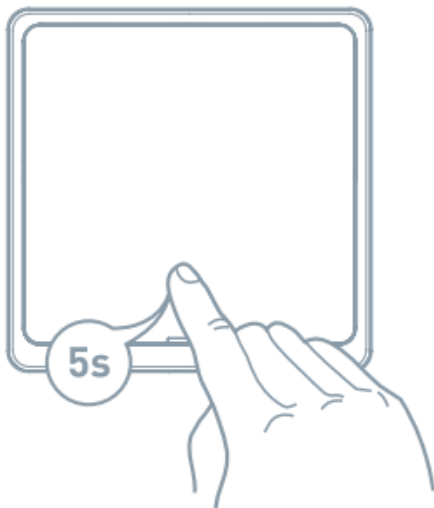

Remark:

1. Smart phone and device must connect to same Wi-Fi during setup mode
2. The device must be added to the account before it can be controlled remotely
3. After the device is successfully accessed, other users can obtain control of the product through the sharing function.

INFORMATION ABOUT DISPOSAL AND RECYCLING

This product is marked with the symbol for separate collection. The product must be disposed of in accordance with the regulations for disposal of electrical and electronic equipment (Directive 2012/19/EU on waste electrical and electronic equipment). Disposal together with regular municipal waste is prohibited. Dispose of all electrical and electronic products in accordance with all local and European regulations at the designated collection points which hold the appropriate authorisation and certification in line with the local and legislative regulations. Correct disposal and recycling help to minimise impacts on the environment and human health. Further information regarding disposal can be obtained from the vendor, authorised service centre or local authorities.

EU DECLARATION OF CONFORMITY

Hereby, Tesla Global Limited declares that the radio equipment type ESW-1WAA-EU, ESW-2WAA-EU is in compliance with EU directives. The full text of the EU declaration of conformity is available at the following internet address: tsl.sh/doc

Connectivity: Wi-Fi 2,4 GHz IEEE 802.11b/g/n

Frequency band: 2.412 – 2.4835 MHz



Max. radio-frequency power (EIRP): < 20 dBm

Manufacturer

Tesla Global Limited

Far East Consortium Building, 121 Des Voeux Road Central Hong Kong

www.teslasmart.com

Documents / Resources

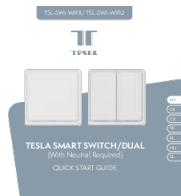

[TESLA TSL-SWI-WIFI1 Smart Switch Dual Battery](#) [pdf] User Guide

TSL-SWI-WIFI1 Smart Switch Dual Battery, TSL-SWI-WIFI1, Smart Switch Dual Battery, Switch Dual Battery, Dual Battery

References

- [Sign in to your account](#)
- [TESLA | Smart home in your hands](#)

Manuals+

- [home](#)
- [privacy](#)