



TESLA TSL-SWI-WBREAK2 Smart Switch Module Dual User Guide

[Home](#) » [Tesla](#) » TESLA TSL-SWI-WBREAK2 Smart Switch Module Dual User Guide 

Contents

- [1 TESLA TSL-SWI-WBREAK2 Smart Switch Module Dual](#)
- [2 Dimension](#)
- [3 Specification](#)
- [4 Turn power off at circuit breaker!](#)
- [5 Intelligent Traditional switches](#)
- [6 Intelligent traditional socket](#)
- [7 Hidden in a box](#)
- [8 Connection diagram 1](#)
- [9 Connection diagram 2](#)
- [10 Connection diagram 3](#)
- [11 Connection diagram 4](#)
- [12 Download the app](#)
- [13 Connect the device](#)
- [14 Reset Option 1](#)
- [15 Reset Option 2](#)
- [16 INFORMATION ABOUT DISPOSAL AND RECYCLING](#)
- [17 Documents / Resources](#)
 - [17.1 References](#)
- [18 Related Posts](#)

TESLA

TESLA TSL-SWI-WBREAK2 Smart Switch Module Dual



Dimension

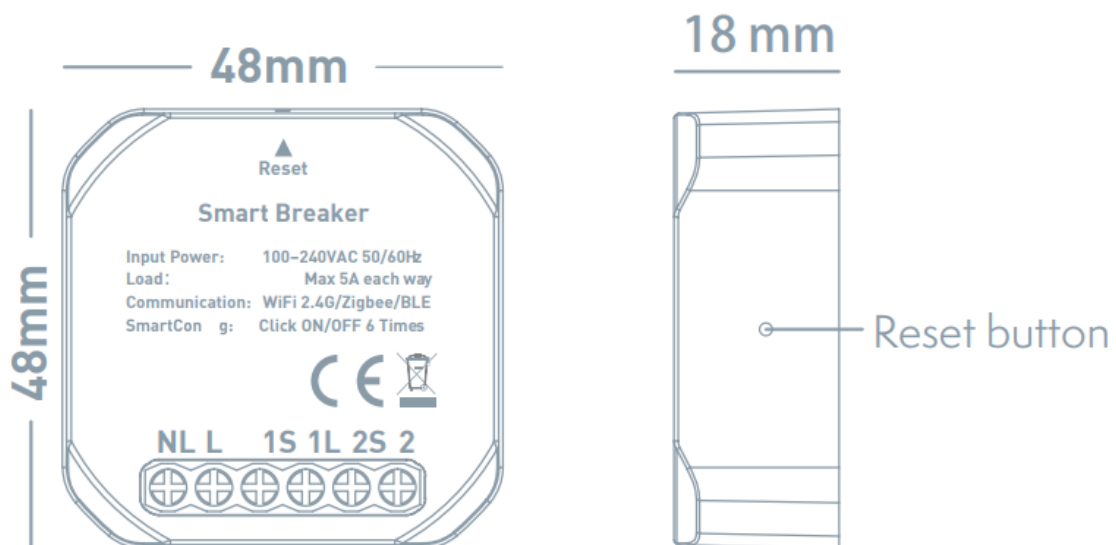

Specification

- Input Power: 100-240VAC 50/60Hz
- Load: Max 5A each way
- Communication: WiFi 2.4G

Turn power off at circuit breaker!

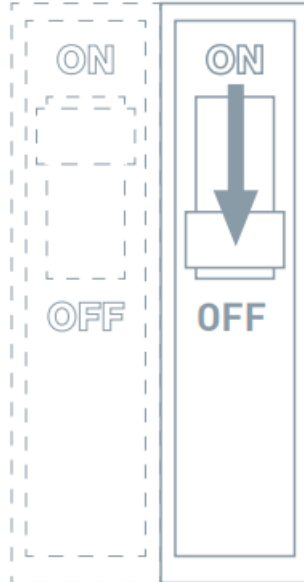

WARNING: SHOCK HAZARD.

May result in serious injury or death. Turn off power at circuit breaker or fuse before installing.

Intelligent Traditional switches



Intelligent traditional socket

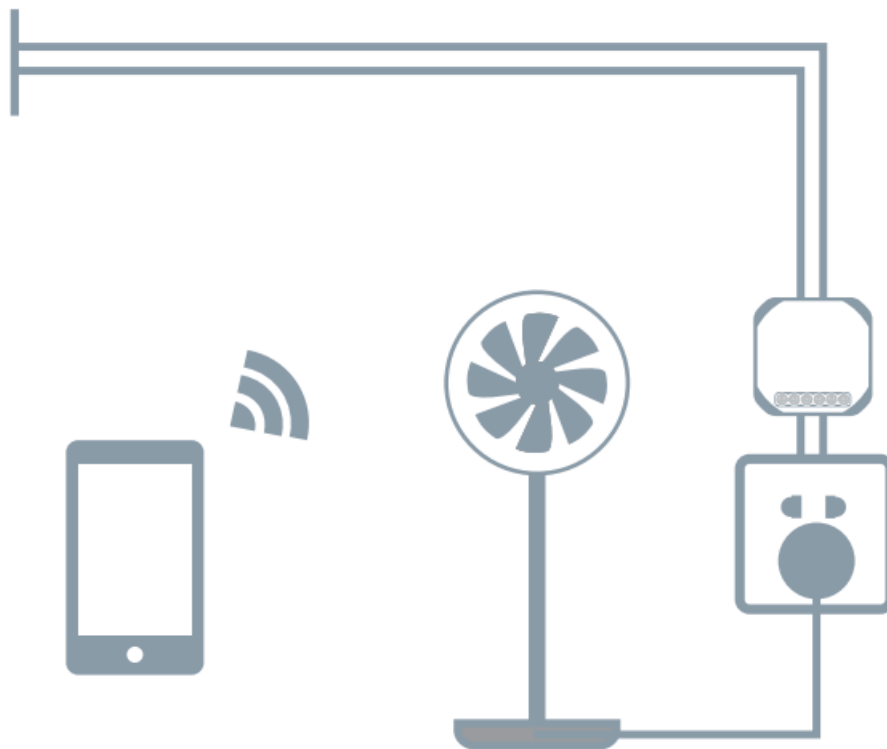

Install behind the traditional socket

Hidden in a box

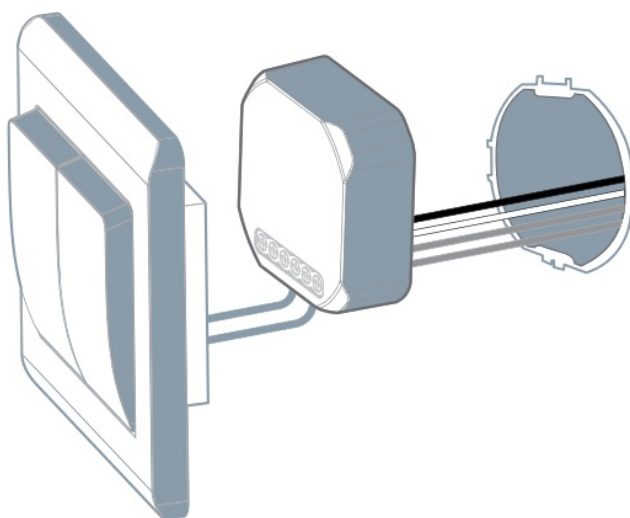

Install in original wall box

Connection diagram 1

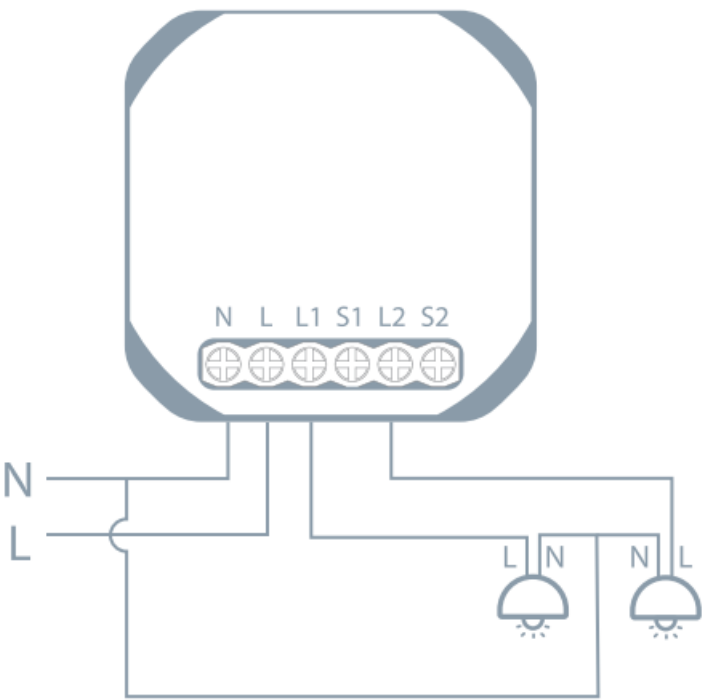

Without switch

Connection diagram 2

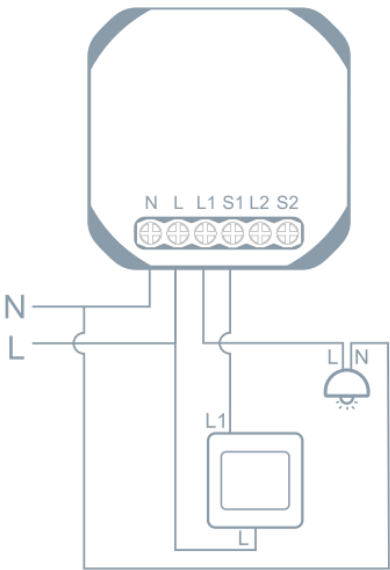

With 1 GANG Switch

Connection diagram 3

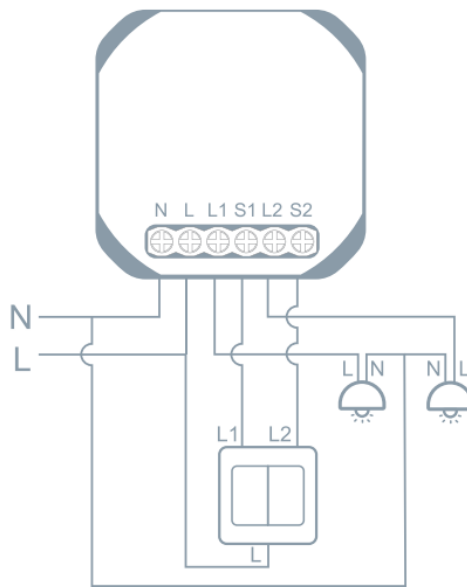

With 2 GANG Switch

Connection diagram 4

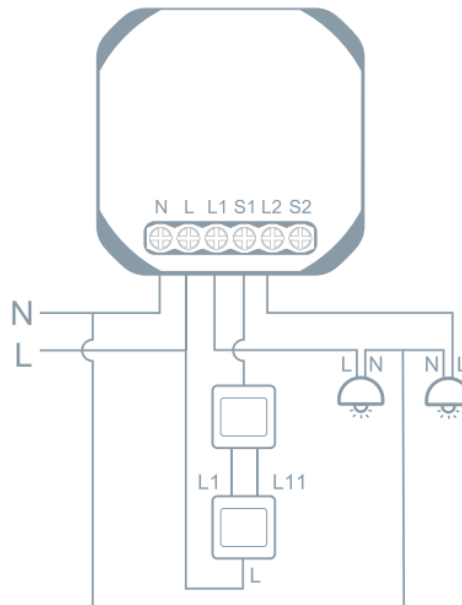

With Multi-Control Switches

Download the app

- Tesla Smart is available for both iOS and Android OS. Search the name 'Tesla Smart' in App Store or Android Market, or scan the QR-Code to download the App and register or login your account.
- Make sure that the smartphone is connected to the 2.4Ghz network.

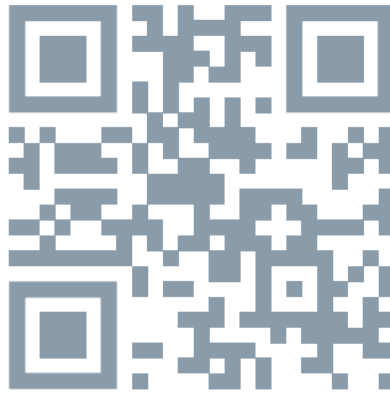

Connect the device

- Open Tesla Smart app and click “+” sign to Add new device
- Select Switches – Tesla Smart Switch Module Dual
- Follow the instructions to add the Tesla Smart Switch Module Dual step by step
- Control device with APP

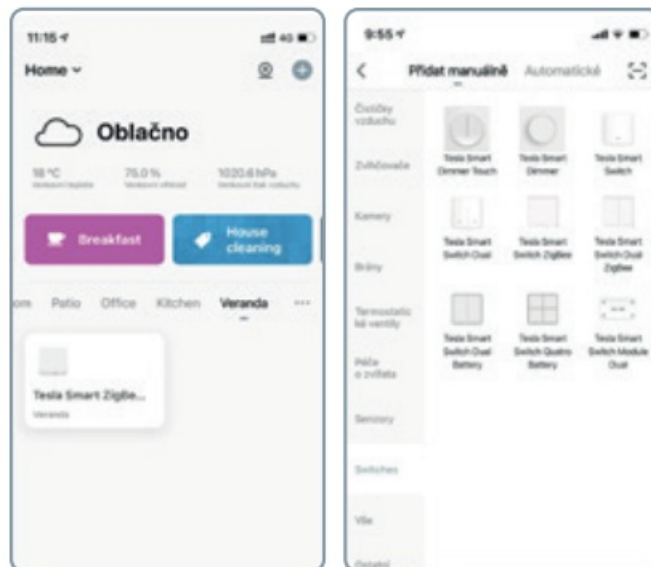

Reset Option 1

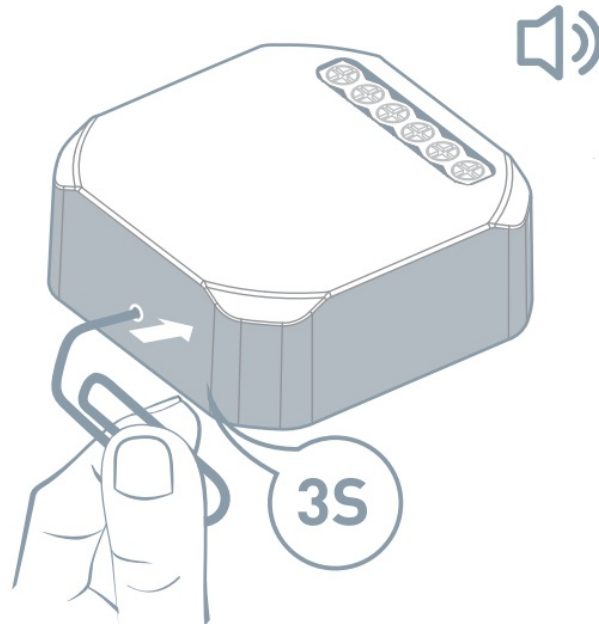

Reset Option 2

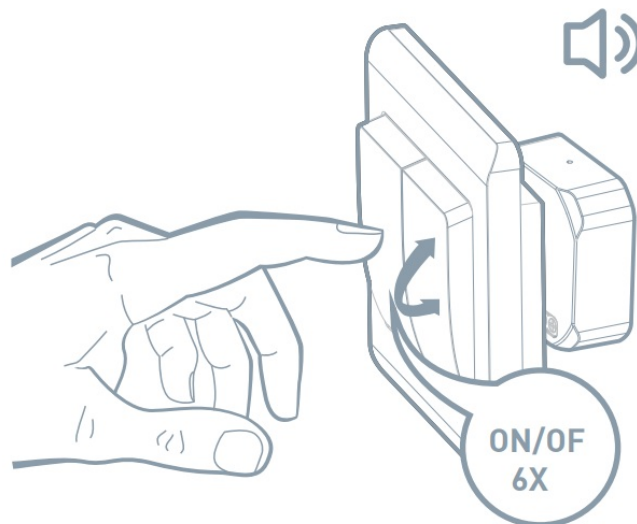

INFORMATION ABOUT DISPOSAL AND RECYCLING

This product is marked with the symbol for separate collection. The product must be disposed of in accordance with the regulations for disposal of electrical and electronic equipment (Directive 2012/19/EU on waste electrical and electronic equipment). Disposal together with regular municipal waste is prohibited. Dispose of all electrical and electronic products in accordance with all local and European regulations at the designated collection points which hold the appropriate authorisation and certification in line with the local and legislative regulations. Correct disposal and recycling help to minimise impacts on the environment and human health. Further information regarding disposal can be obtained from the vendor, authorised service centre or local authorities.

- Connectivity: Wi-Fi 2,4 GHz IEEE 802.11b/g/n
- Frequency band: 2.412 – 2.4835 MHz
- Max. radio-frequency power (EIRP): < 20 dBm

EU DECLARATION OF CONFORMITY

Hereby, Witty, s.r.o declares that the radio equipment type ESW-1WAB-EU is in compliance with EU directives. The full text of the EU declaration of conformity is available at the following internet address:

teslasmart.com/declaration

Manufacturer
Tesla Global Limited
Gee Chang Industrial Building, 121 Des Voeux Road Central 852 00 Hong Kong
www.teslasmart.com

Documents / Resources

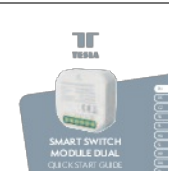
	<p>TESLA TSL-SWI-WBREAK2 Smart Switch Module Dual [pdf] User Guide TSL-SWI-WBREAK2, Smart Switch Module Dual</p>
	<p>TESLA TSL-SWI-WBREAK2 Smart Switch Module Dual [pdf] User Guide TSL-SWI-WBREAK2, Smart Switch Module Dual, TSL-SWI-WBREAK2 Smart Switch Module D ual, Switch Module Dual, Module Dual</p>

References

-  [TESLA | Smart home in your hands](#)