



TESLA TSL-SWI-DIMMER Smart Dimmer/Touch User Guide

[Home](#) » [Tesla](#) » TESLA TSL-SWI-DIMMER Smart Dimmer/Touch User Guide 



TSL-SWI-DIMMER/
TSL-SWI-DIMMERT



TESLA SMART

DIMMER/TOUCH QUICK START GUIDE

Contents

- 1 Product Outline
- 2 Indicator Light Status
- 3 Specification
- 4 Contents Supplied
- 5 Tools You'll Need
- 6 Installation
- 7 APP Operation
- 8 Troubleshooting
- 9 R4eset
- 10 Documents / Resources
 - 10.1 References
- 11 Related Posts

Product Outline

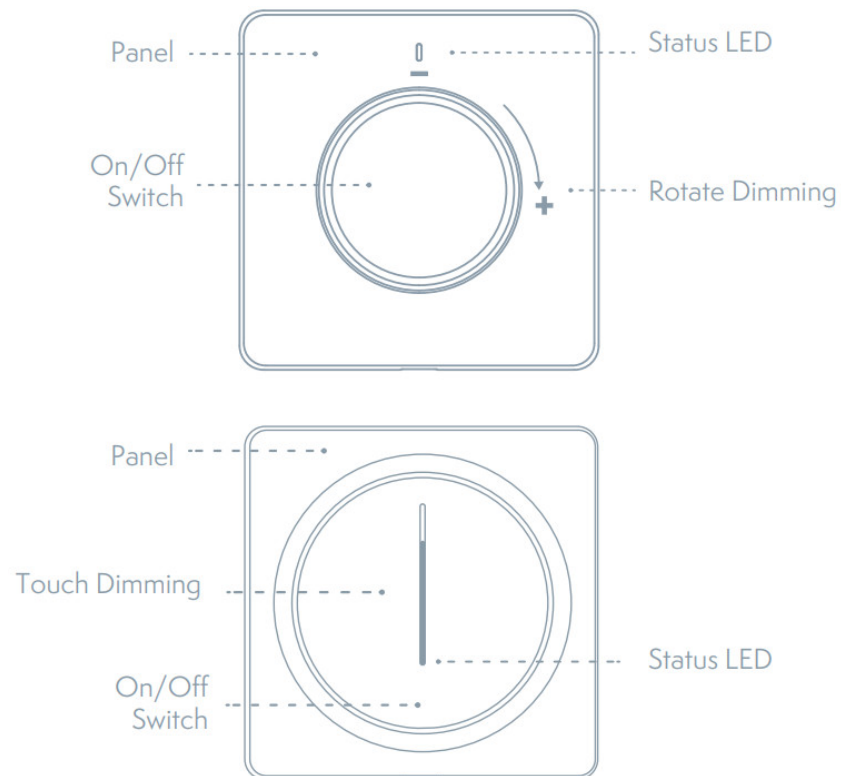

Indicator Light Status

Light Color	Light Status	Switch Status
white	LED bar with brightness level	: Light turns on
	Brightness indicator blinks slowly (Breathing)	Light turn off
	Bottom LED blinks fast	Network disconnected
	Bottom LED blink	Quick configure mode
	The bottom LED blink slowly	AP configure mode

Specification

Input Power:	100~240V AC 50/60Hz
Dimming Control:	Trailing-Edge Cut
Inductive load (LED/CFL):	<220W
Resistive load (Incandescent):	<300W
Communication:	WiFi 802.11 b/g/n 2.4GHz
Control Channel:	1 CH
Standby Power:	≤0.5W
Working Temperature:	-10°C ~ 45°C <90%
Working Humidity:	500k times
Button life:	86x86x53.5mm [TSL-SWI-DIMMER]
Dimension:	86x86x43mm [TSL-SWI-DIMMERT]

Contents Supplied

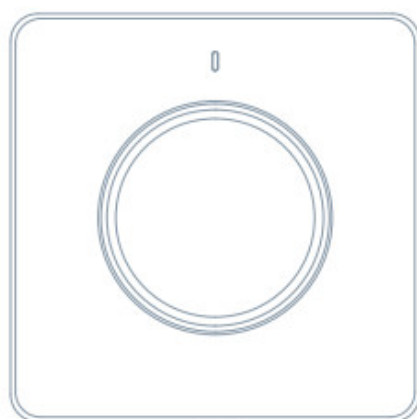

Dimmer



Screws

Tools You'll Need



Screwdriver



Flat-head Screwdriver



Voltage tester

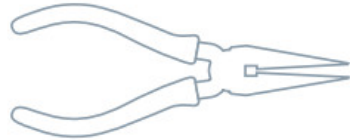

Pliers



Approximately 30
minutes of your time
to install and setup the
Dimmer.

Installation



WARNING: RISK OF ELECTRIC SHOCK

This product installation requires handling 100-240 volt wiring. Follow each step carefully. If any concerns handling wiring, hire a qualified electrician. Ensure all work meets applicable local and national codes.

1. Turn Off The Breaker

Turn off the circuit breaker and use the electrical tester to test the power.



2 Connection Diagram

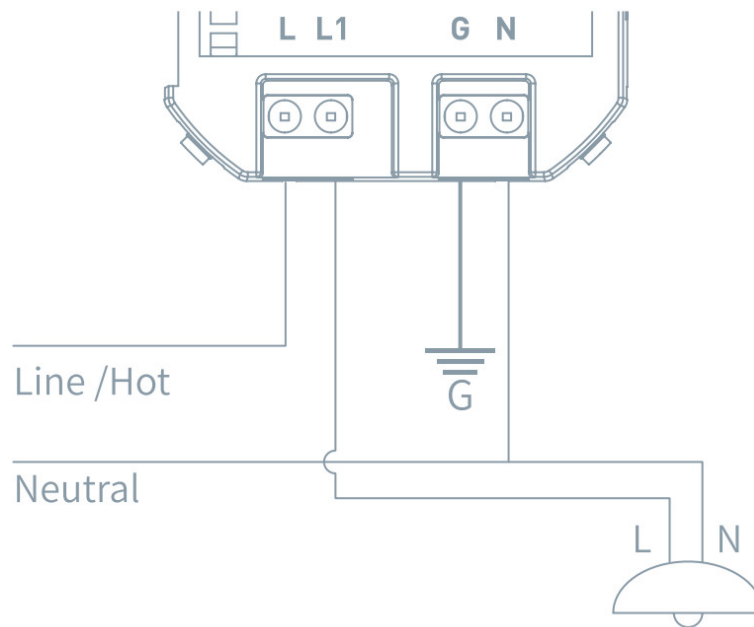

3. Pull Out the Knob

(Only for TSL-SWI-DIMMER) Pull the knob upwards.

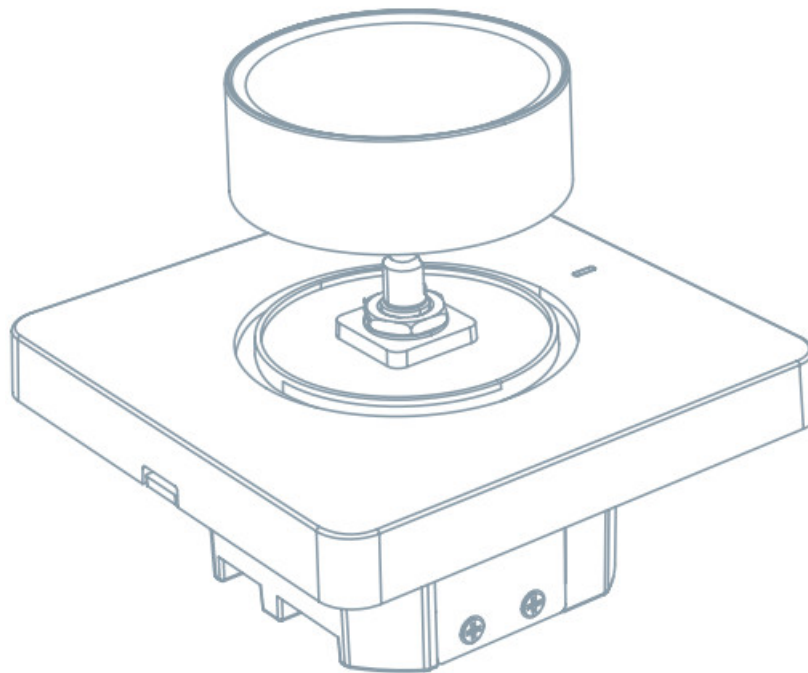

4. Remove Nuts and Gaskets

(Only for TSL-SWI-DIMMER) Remove the dimmer nuts and gaskets.

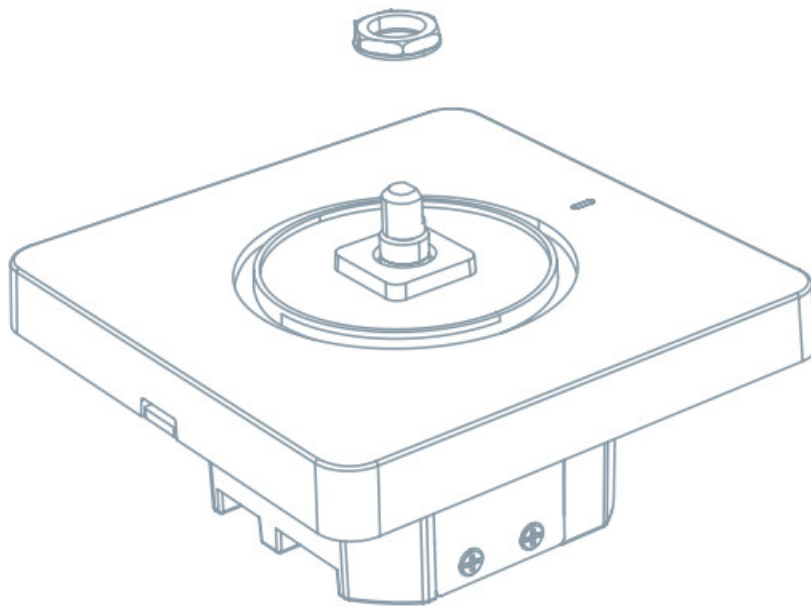

5. Remove the Panel

Remove the touch panel cover of the dimmer.

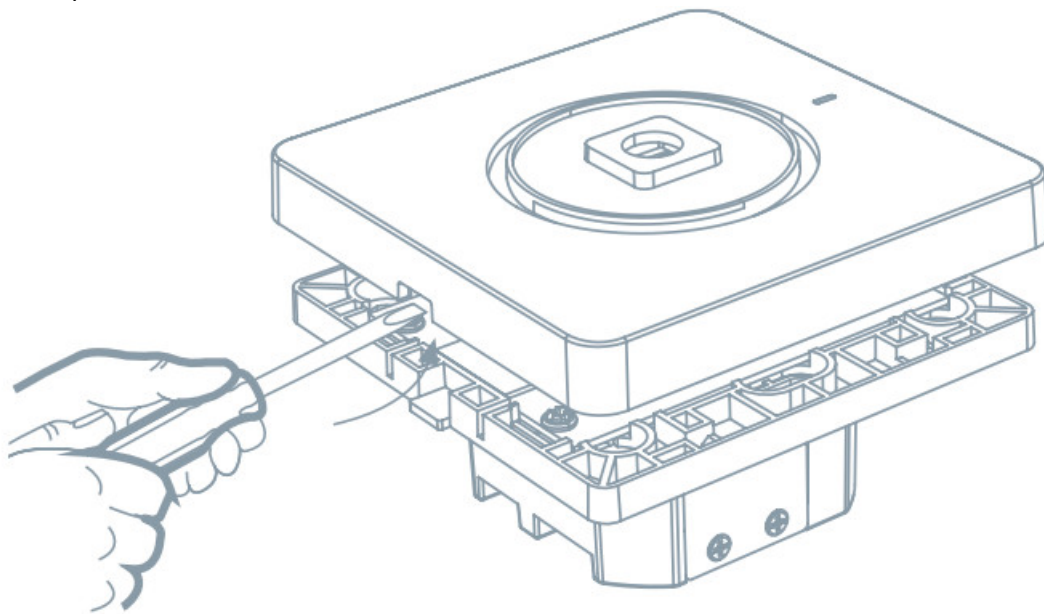

6. Mount the Switch

Use the screws provided.

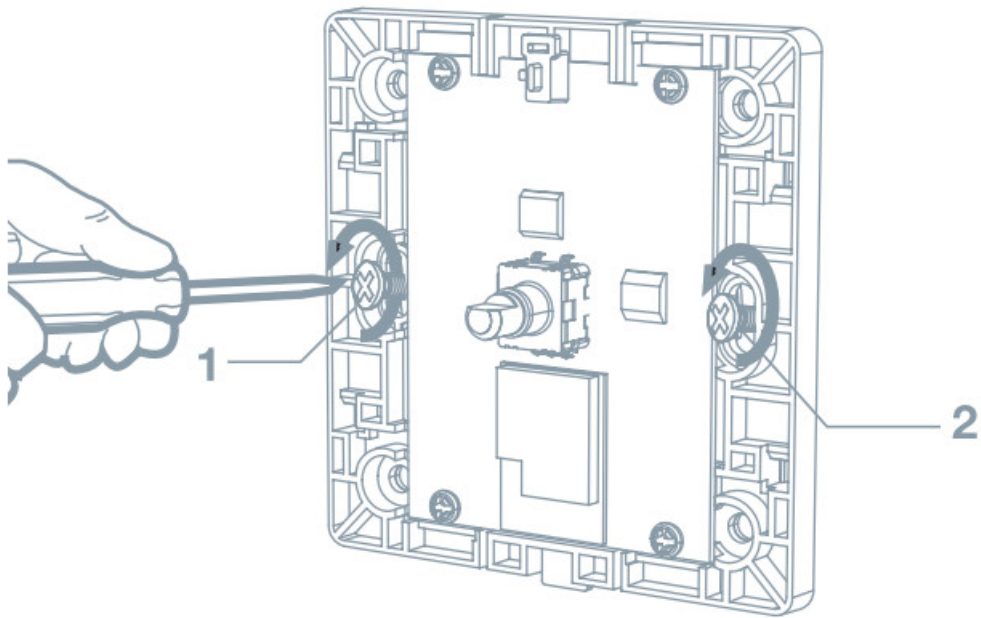

7. Attach the Wallplate

Attach the adapter to the dimmer using the screws provided and snap on the wallplate.

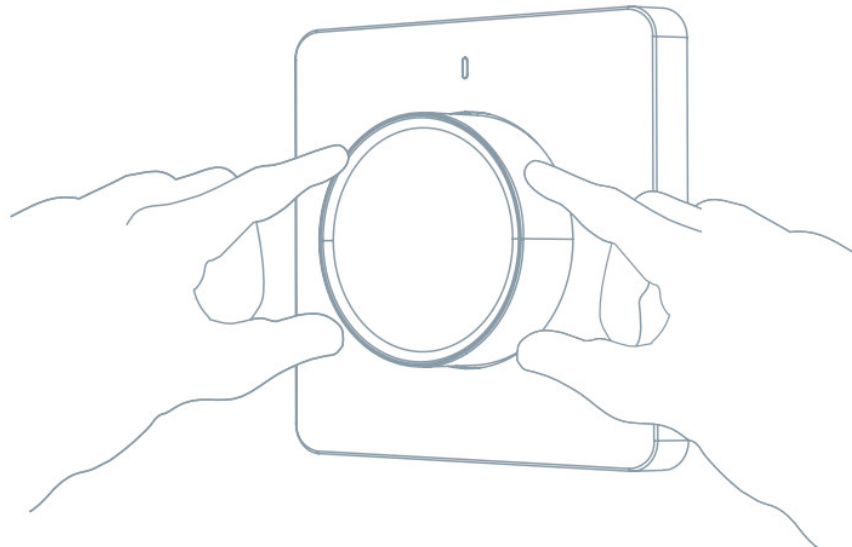

8. Turn on the Power

Turn the power back on at the circuit breaker.



APP Operation

1 Preparation for use

- Tesla Smart is available for both iOS and Android OS. Search the name 'Tesla Smart' in App Store or Android Market, or scan the QR-Code to download the App and register or log in to your account.

- Make sure that the smartphone is connected to the 2.4Ghz network.

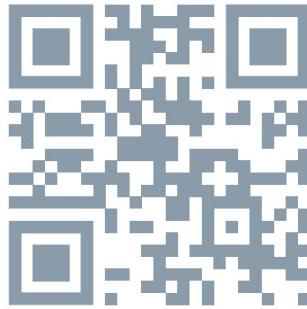

<http://tsl.sh/app>

2 Connect the device

- Open the Tesla Smart app and click “+” sign to add a new device
- Select Switches – Tesla Smart Dimmer
- Please follow the instructions to add the Tesla Smart Dimmer step by step

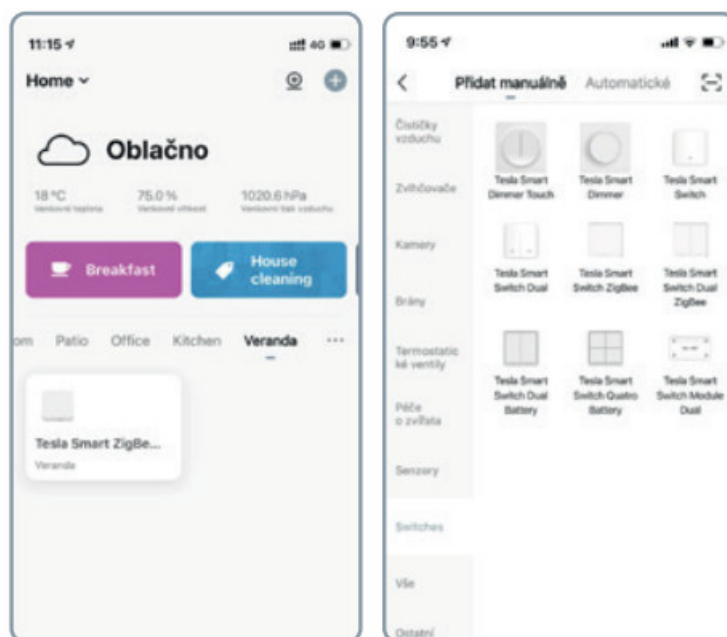

3 Control Dimmer

- Control dimmer with APP
- Add scene mode and timing mode in the APP

Troubleshooting

1. The light is Flashing or not dimming? The Smart Dimmer switch supports a Dimmable light source only, the non-Dimmerable light source may cause the light flashing or not working
2. Does Dimmer have no powered on? The smart dimmer products need to be powered by the neutral line. If there is no neutral line in the inch-Manor location, the smart dimmer can not work
3. Can not connect to APP? Make sure the mobile phone and devices (gateways) are in the same Wi-Fi network,

and the device power and get into pair mode, make sure the device has a good signal to support communication.

4. How far can be controlled? Please make sure that the distance between the product and the Wi-Fi router or gateway does not exceed 25 meters, If the partition wall is used but the material and thickness of the wall will have a greater impact on communication, based on the actual situation, users can consider adjusting the location of the Wi-Fi router or gateway or increasing Wi-Fi routers or gateways to ensure normal product communication.
5. Can the Dimmer still work if the network is disconnected? In the event of network disconnection, the status indicator will flash. At this time, all APP control, smart linkage, and other network functions will be invalid but the local control will not be affected.

Reset

Press and hold the switch button for 5s to reset the Dimmer and get into Quick Configure Mode.

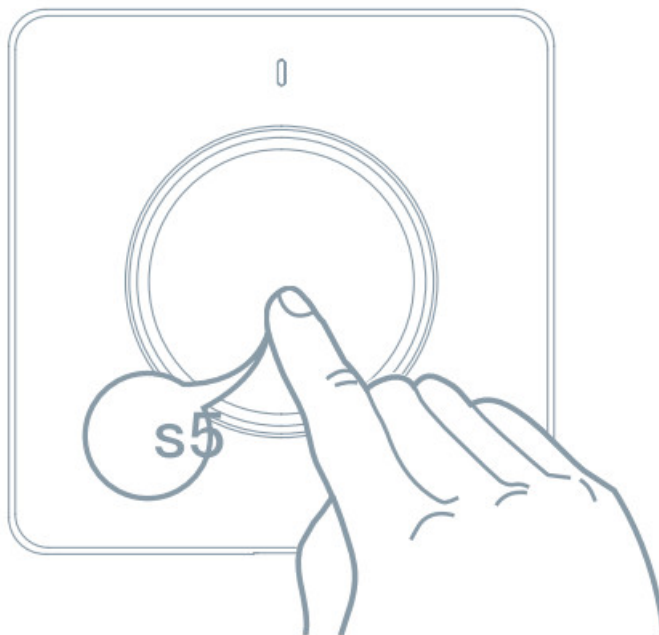

1 Tesla Smart Skills (Alexa)

- Log in your Alexa account on a smartphone or a computer, then tap Home>Skills & Games
- Search “Tesla Smart” and select the right one according to the blue logo (same with App)
- Login to the account you registered on the App in Part 2, then click “Link Now”
- The Account is linked successfully, and then tap Authorize to Complete.

Congratulations! Alexa Devices (Echo) can Control the Switch ON/OFF.

To add or delete switches, please delete or add them in the Tesla Smart App (See Part 2) and then the Alexa will synchronize automatically. If you cannot see the name of switches in the Devices List in Alexa Page. You can click “Discover” on the Alexa page it will synchronize from the Tesla Smart App.

2 Tesla Smart Skills (Google)

- Find “Home Control” in the main menu on the Google Home app’s home page > Home Control > tap “+”.

- Find “Tesla Smart” in the list
- Input your Tesla Smart account and password you registered in Part 0, then tap “Link Now”.
- After you assign rooms for the Switch, your Switch will be listed in the Home Control page.

Control your smart dimmer through Google Home. Now you can control your smart dimmer through Google Home.

If you set the name as “bedroom light”, the supported voice commands are as below: Ok Google, turn on the bedroom light. Ok Google, set bedroom light to 50%.

INFORMATION ABOUT DISPOSAL AND RECYCLING

This product is marked with the symbol for a separate collection. The product must be disposed of in accordance with the regulations for disposal of electrical and electronic equipment (Directive 2012/19/EU on waste electrical and electronic equipment). Disposal together with regular municipal waste is prohibited. Dispose of all electrical and electronic products in accordance with all local and European regulations at the designated collection points which hold the appropriate authorization and certification in line with the local and legislative regulations. Correct disposal and recycling help to minimize impacts on the environment and human health. Further information regarding disposal can be obtained from the vendor, authorized service center, or local authorities.

EU DECLARATION OF CONFORMITY

Hereby, Witty, s.r.o declares that the radio equipment type EDM-1WBA-EU, EDM-1WBB-EU is in compliance with EU directives. The full text of the EU declaration of conformity is available at the following internet address:

teslasmart.com/declaration

Connectivity: Wi-Fi 2,4 GHz IEEE 802.11b/g/n

Frequency band: 2.400 – 2.4835 MHz

Max. radio-frequency power (EIRP): < 20 dBm

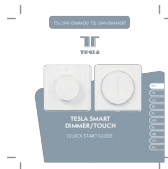

Documents / Resources

	<p>TESLA TSL-SWI-DIMMER Smart Dimmer/Touch [pdf] User Guide TSL-SWI-DIMMER, TSL-SWI-DIMMERT, Smart Dimmer, Smart Touch</p>
---	---

References

-  [TESLA | Smart home in your hands](#)

