



## TESERY 9 Inch Model 3 / Y Display LCD Instrument Dashboard Screen User Guide

[Home](#) » [TESERY](#) » TESERY 9 Inch Model 3 / Y Display LCD Instrument Dashboard Screen User Guide 

### TESERY 9 Inch Model 3 / Y Display LCD Instrument Dashboard Screen User Guide



This product specially designed for Tesla Model-3 & Model-Y with original style and original UI, convenient the driver head up to view the vehicle driving information while driving, avoid potential safety hazards caused by viewing large screens with a slanted head. Perfect connect iOS & Android smartphones with CarPlay and Android Auto, use these smartphone apps.

The easy and simple system setting can help you easy get through all functions of the device, the firmware upgrade service will upgrade device with latest firmware will get better experience, and you can choose different UI for fun drive.

#### Content

Navigation Bar—————  
Instrument Panel Info Display—————  
Smartphone Connection—————  
System Settings—————

#### Navigation Bar

Slide left from the right edge of the screen to pop up the navigation bar. Click the function icon to jump to the corresponding interface

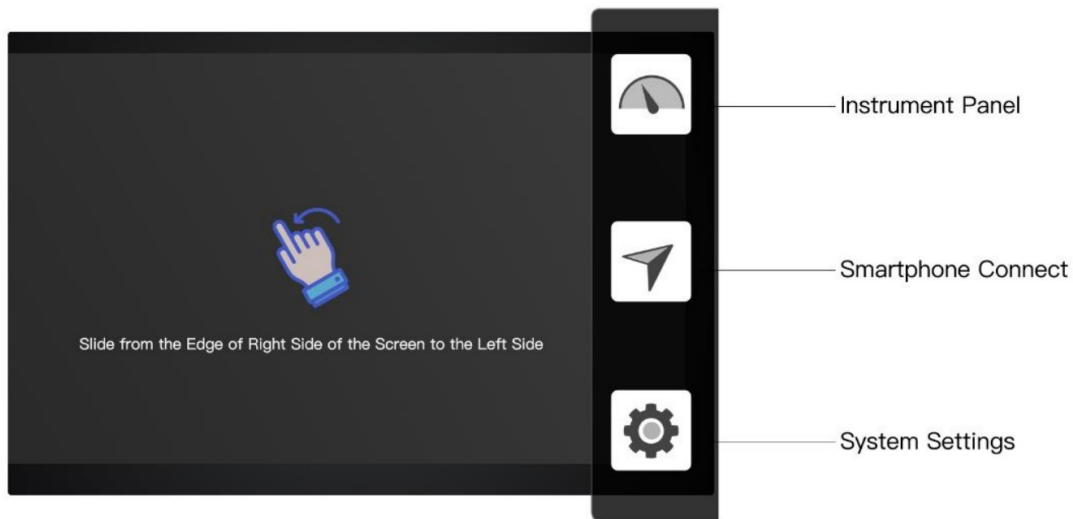

Rolling the right wheel of the car's steering wheel can also trigger the switching effect.

**Note:** If there is no operation within 5 Seconds, the navigation bar will automatically hidden.

### Instrument Panel Info Display

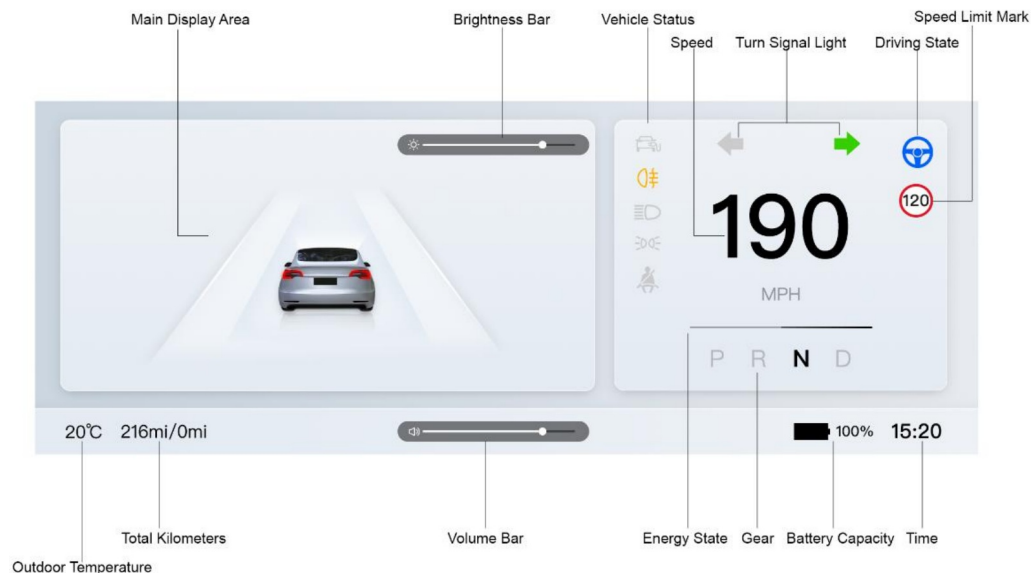

In the main display area, you can switch the display content by sliding left or right: parking status (front trunk & rear trunk & doors, when the above status is abnormal, the parking status will be actively popped up), tire pressure info, and driving status.

Day Mood (Instrument Panel will switch to day mood with the Central Display automatically)



Night Mood (Instrument Panel will switch to night mood with the Central Display automatically)

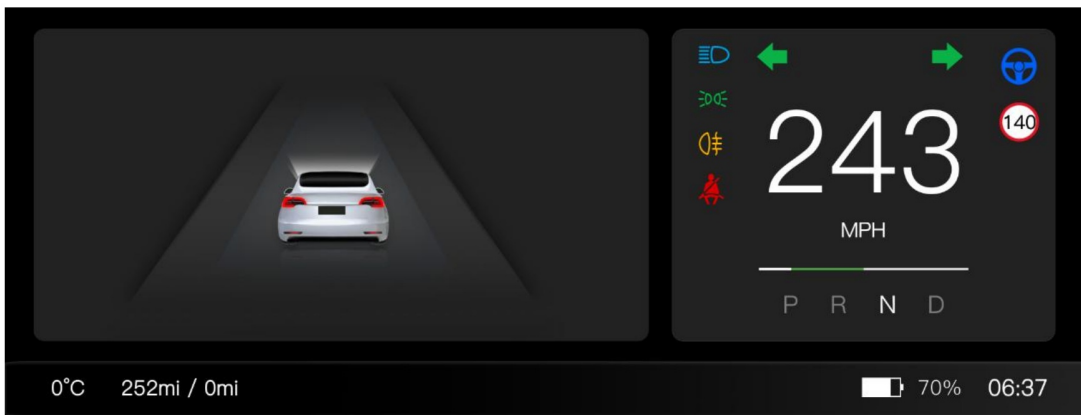

Slide up and down on the left side of the instrument panel to manually adjust the instrument panel speaker volume.

Slide up and down on the right side of the instrument panel to manually adjust the instrument panel LCD brightness.

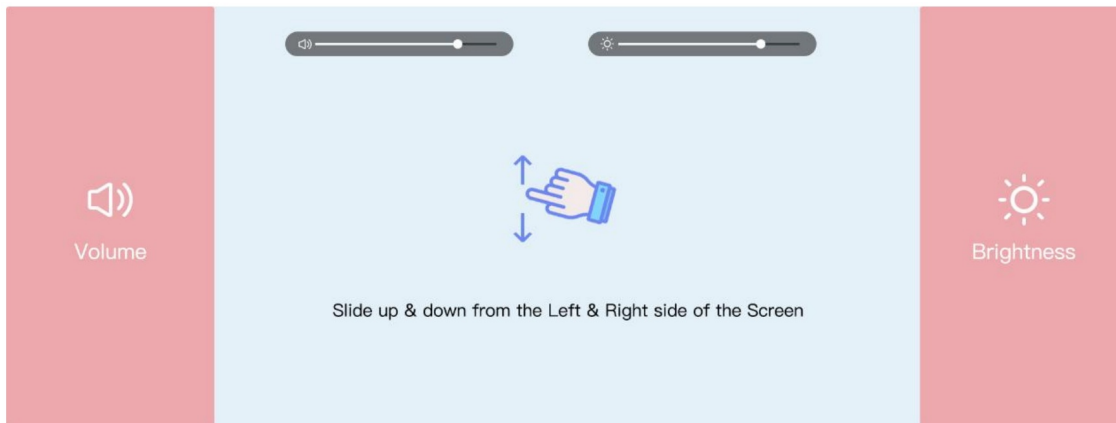

### Smartphone Connection Settings

The Smartphone Connection Settings

The Smartphone Connection function support full screen display and split screen display. The default setting is split screen with left side display smartphone screen, and right side display part of the instrument information.

Click the Smartphone Connect Icon on the navigation bar

The Instrument Panel will display the information: please open your smartphone Bluetooth connect the BT ID: BT-PLINK-XXXX.

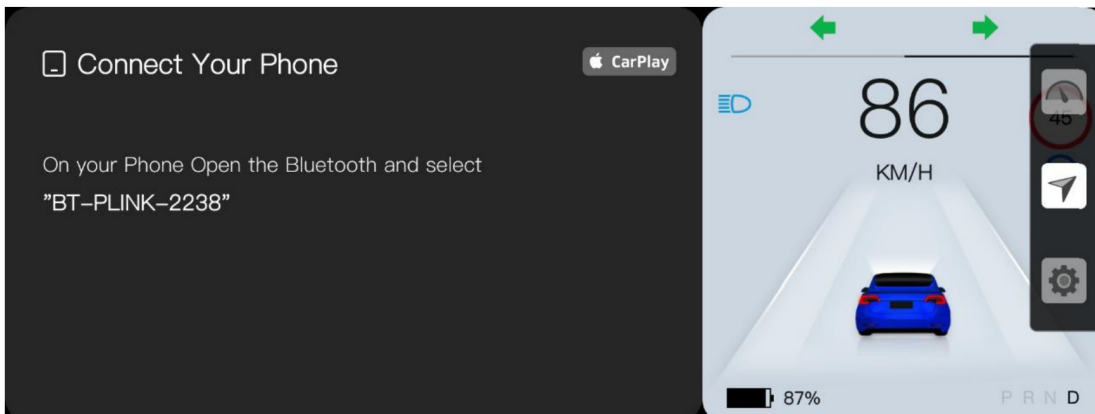

### CarPlay Connection

Open the System Setting Menu, find the Smartphone connection, choose the connection mode with Car Play

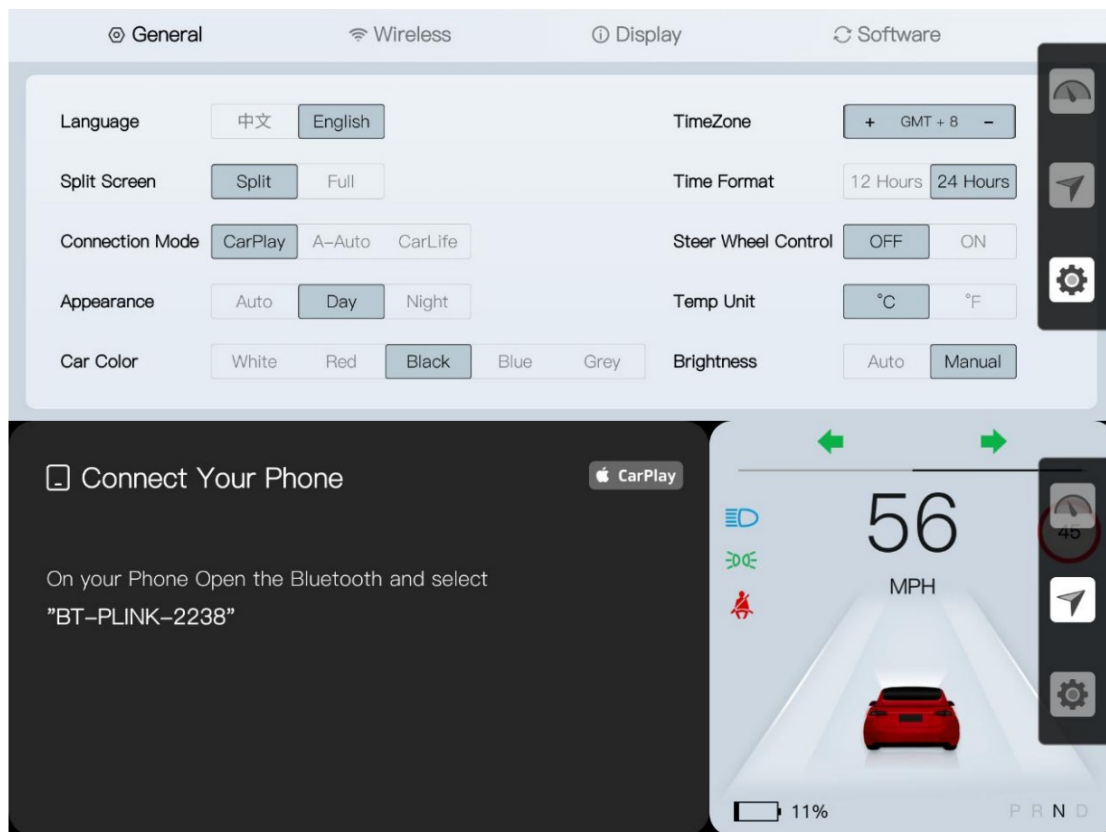

Then use the iOS Smartphone use BT pairing search the BT ID: BT-PLINK-XXXX, and pairing the device. Confirm the pairing code on smartphone and allow contacts, click allow to use CarPlay. After seconds the CarPlay Interface will automatically display on the instrument panel.

Bluetooth



This iPhone is discoverable as “恒哥^\_^iPhone” while Bluetooth Settings is open.

MY DEVICES

BT-868	Not Connected	
BT-868	Not Connected	
dostyle SD802	Not Connected	
HAVAL	Not Connected	
MD158	Not Connected	
QiaoQiao-K	Not Connected	
ZORDAI	Not Connected	

OTHER DEVICES

BT-PLINK-2238

To pair an Apple Watch with your iPhone, go to the [Apple Watch app](#).

Bluetooth



This iPhone is discoverable as “恒哥^\_^iPhone” while Bluetooth Settings is open.

MY DEVICES

BT-868	Not Connected	
BT-868	Not Connected	
dostyle SD802	Not Connected	
HAVAL	Not Connected	
MD158	Not Connected	
QiaoQiao-K	Not Connected	
ZORDAI	Not Connected	

OTHER DEVICES

BT-PLINK-2238

To pair an Apple Watch with your iPhone, go to the [Apple Watch app](#).

Bluetooth



This iPhone is discoverable as “恒哥^\_^iPhone” while Bluetooth Settings is open.

MY DEVICES

BT-868	Not Connected	(i)
BT-S...		(i)
dos		(i)
HAV		(i)
MD		(i)
Qia		(i)
ZORAN	Not Connected	(i)

Bluetooth Pairing Request

“BT-PLINK-2238” would like to pair with your iPhone. Confirm that this code is shown on “BT-PLINK-2238”. Do not enter this code on any accessory.

565997

Cancel

Pair

OTHER DEVICES ✱

BT-PLINK-2238	✱
OGA191119642	

To pair an Apple Watch with your iPhone, go to the [Apple Watch app](#).

Bluetooth



This iPhone is discoverable as “恒哥^\_^iPhone” while Bluetooth Settings is open.

MY DEVICES

BT-868	Not Connected	(i)
BT-868	Not Connected	(i)
dos		(i)
HAV		(i)
MD		(i)
Qia		(i)
ZORDAI	Not Connected	(i)

**Allow Contacts and Favorites Sync?**

Your car may request your contacts, phone favorites, and recent phone calls over Bluetooth. Do you wish to allow this? CarPlay will work without syncing.

Don't Allow

Allow

OTHER DEVICES ✱

BT-PLINK-2238	✱
OGA191119642	

To pair an Apple Watch with your iPhone, go to the [Apple Watch app](#).



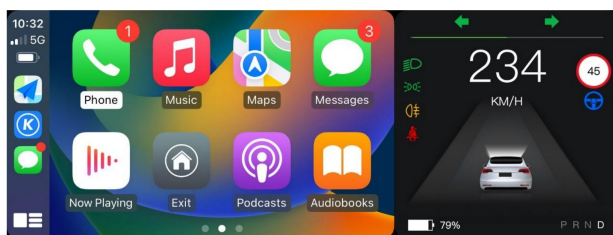
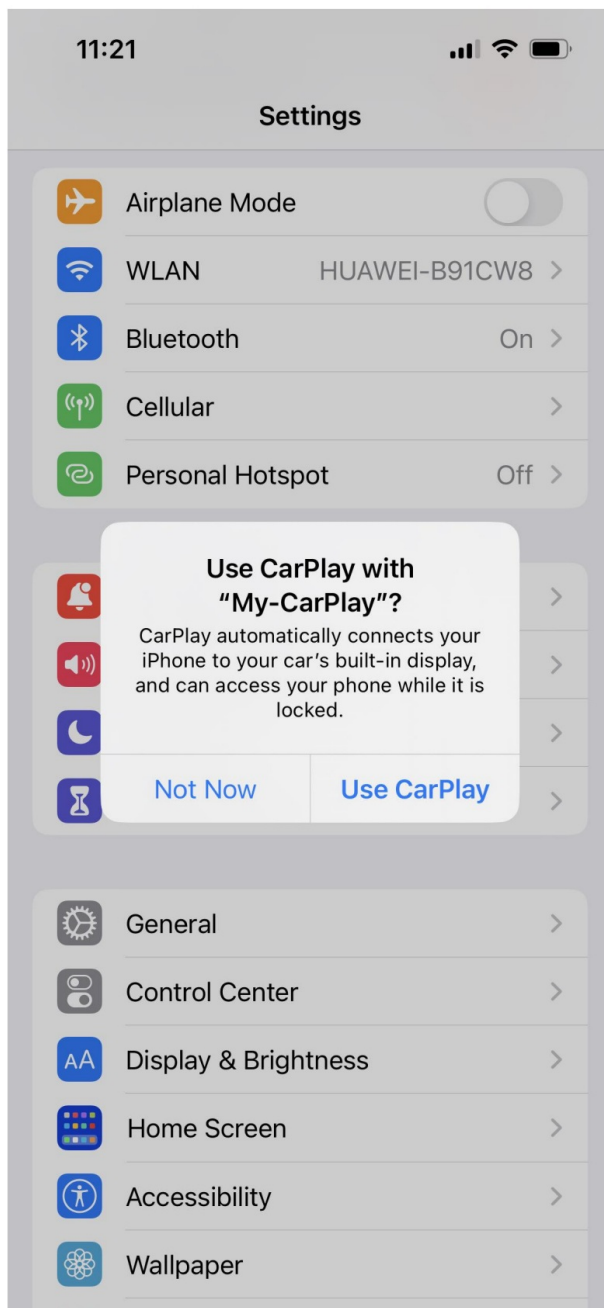

### Android Auto Connection

Open the System Setting Menu, find the Smartphone connection, choose the connection mood with A-Auto.

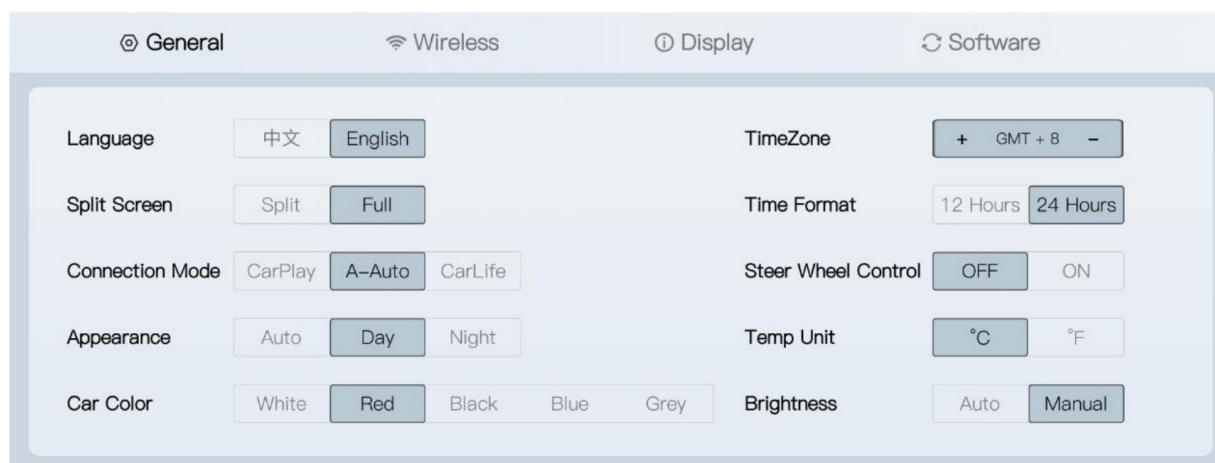

Open the Wi-Fi Setting, and share the Smartphone's hotspot with the Instrument Panel. For better experience please choose the Smartphone hotspot with 5G transmit band.



Open the Android Phone BT pairing function, search BT ID: BT-PLINK-XXXX, and pairing the device. After around 10 seconds, the Android Auto interface will display on Instrument Panel.

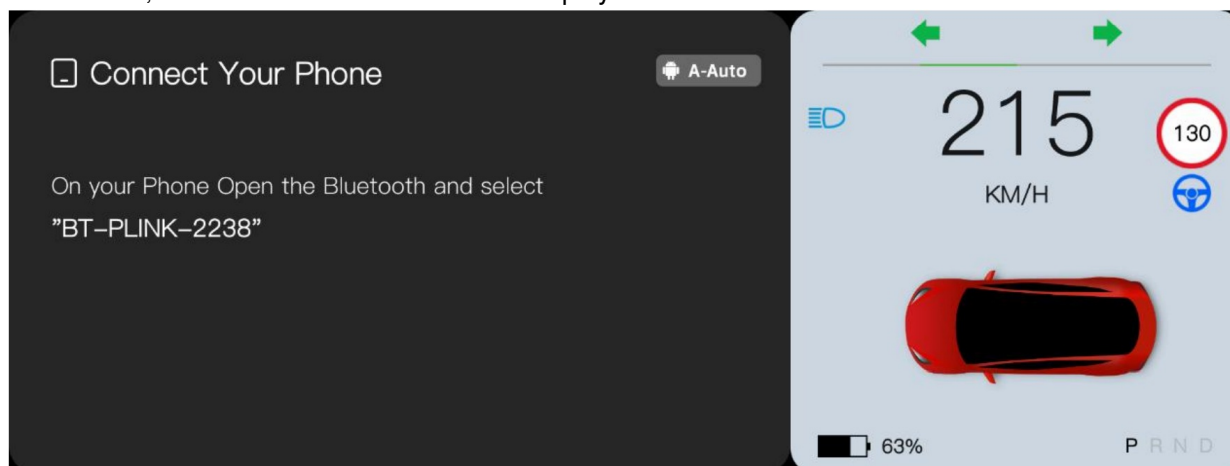

And you can also use the Type-C Cable connect the Android Smartphone into the Type-C port on the Instrument Panel with wired Android Auto function.

#### Note

Before using the smartphone connection, please check the System Settings, if the Connection mood is CarPlay or Android Auto, if choose wrong mood, the smartphone will be unable to connect with the instrument panel. The default setting is CarPlay Mood. After switching the right mood, the Instrument Panel will automatically restart, make the settings work.

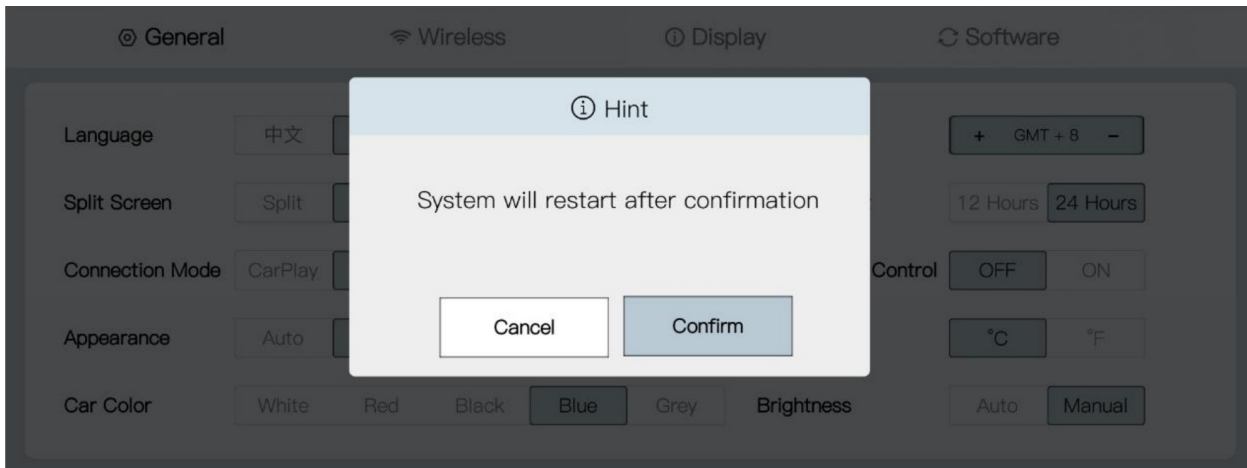

**Note:**

CarPlay and Android Auto support Full Screen and Split Screen mood.

**System Settings Interface**

Choose the System Settings Icon on the Navigation bar, will enter the systemsettinginformation. You can choose System Language, Smartphone connect mood, displaymood, car color, time, steer wheel control, temperature unit, brightness adjust mood, Wi-Fi function, system information, software update, UI Style switch.



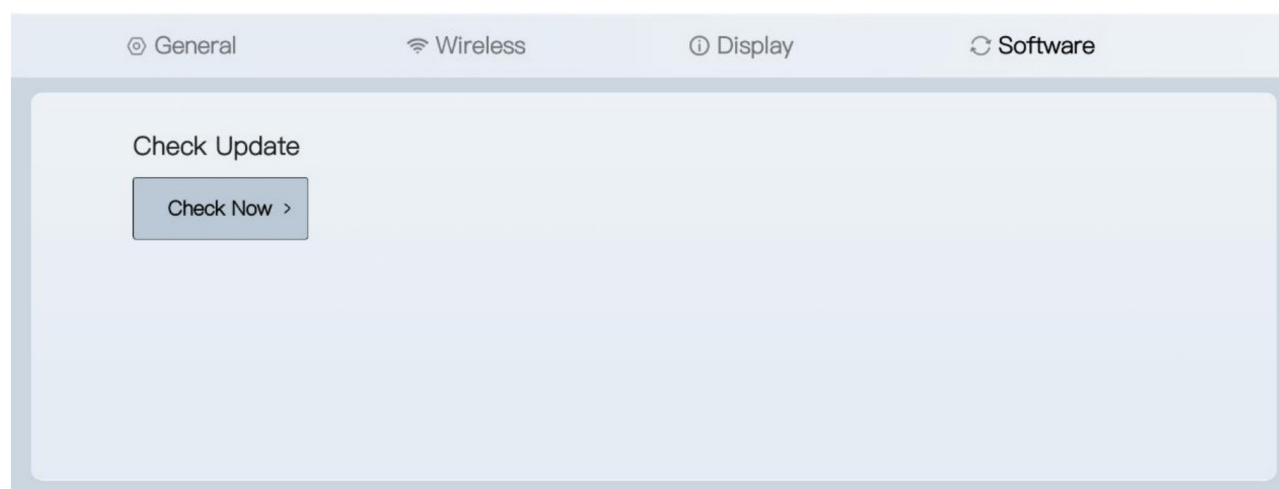

## About System Update

We will bring better user experience with our firmware up to date service. The device connect to Wi-Fi, choose check update, if there is new firmware the system will update automatically, and system will reboot. Please do not power off.

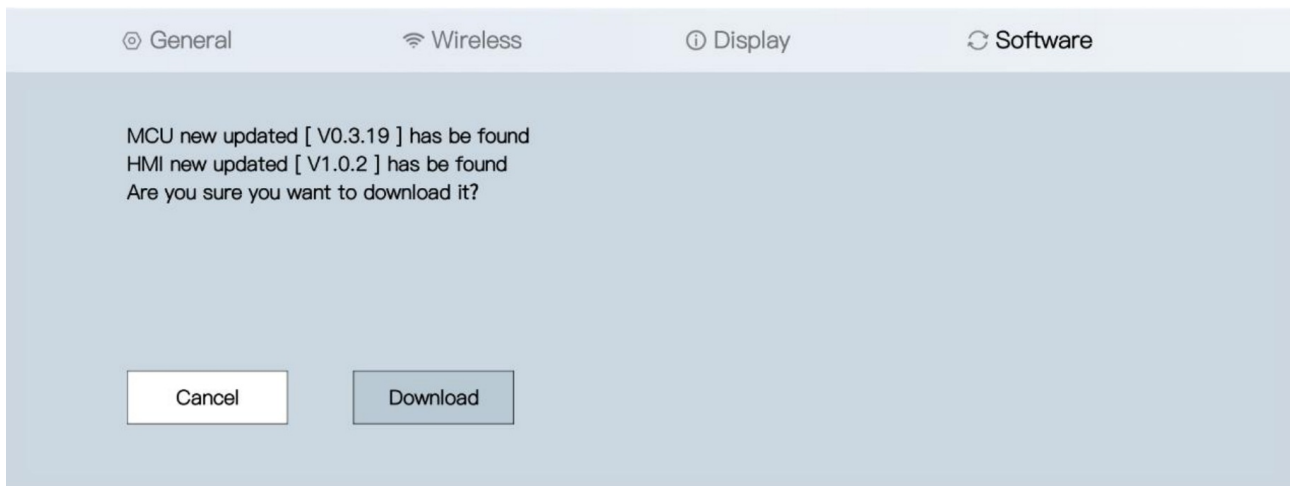

#### About the UI Switch

In system upgrade menu, there is a theme upgrade sub menu. You can freely switch different UI which you like. After switching the device will automatically reboot.





## Steer Wheel Control functions



Steer Wheel Control functions	
1	Left Push: Play Pervious Song/Hang off Phone Ca
<b>Assistant</b>	<b>connection interface</b>
2	2. Short Press: Play/Pause Music Long Press: Active Smartphone Voice
3	Right Push: Play Next Song/Pick up phone Call
4	Left short push: Back to pervious menu Left long push: back to Instrument Panel
5	Up/down rolling: switch between Instrument panel and smartphone
6	Right short push: Enter Smartphone Connection interface (Car Play/Android Auto) Right lo ng push: Enter Smartphone Steer Wheel control, short push is confirm function.

**Note:** Smartphone Steer wheel control function just work in Non automatic drivingmode.

Documents / Resources

	<p><a href="#">TESERY 9 Inch Model 3 / Y Display LCD Instrument Dashboard Screen</a> [pdf] User Guide 9 Inch Model 3 Y Display LCD Instrument Dashboard Screen, 9 Inch, Model 3 Y Display LCD Instrument Dashboard Screen, Instrument Dashboard Screen, Dashboard Screen, Screen</p>
---	--