

Tenda

**TEG1005D Series
Ethernet Switch**



Tenda TEG1005D Series Ethernet Switch Installation Guide

[Home](#) » [Tenda](#) » Tenda TEG1005D Series Ethernet Switch Installation Guide 

Contents

- [1 Tenda TEG1005D Series Ethernet Switch](#)
- [2 Product Information](#)
- [3 Product Usage Instructions](#)
- [4 Package contents](#)
- [5 Install the device](#)
- [6 Typical network topologies](#)
- [7 Indicators](#)
- [8 Get support and services](#)
- [9 FAQ](#)
- [10 Safety precautions](#)
- [11 FCC statement](#)
- [12 Technical support](#)
- [13 Documents / Resources](#)
 - [13.1 References](#)

Tenda

Tenda TEG1005D Series Ethernet Switch



Product Information

Specifications:

- Model: TEG1016M/TEG1116M
- Supports auto MDI/MDIX
- Standard mode with VLAN off
- Multiple language support
- Power: Power socket

Product Usage Instructions

Installation:

Preparations:

- Desktop mounting: ESD bracelet or gloves
- Wall mounting: ESD bracelet or gloves, screwdriver, spirit level, marker, hammer drill, rubber hammer, ladder, 2 plastic anchors (height: 6.6 mm, inner diameter: 2.4 mm, length: 26.4 mm), and 2 screws (thread diameter: 3 mm, length: 14 mm, head diameter: 5.2 mm)

Desktop Mounting:

Horizontally place the switch right-side up on a clean, stable, and flat desktop.

Wall Mounting:

Note: Install on non-flammable walls like concrete. Do not face air vents downward.

1. Mark wall for wall-mounting slots on the switch.
2. Drill two holes (diameter: 6 mm) horizontally at an appropriate distance based on the model.
3. Hammer plastic anchors into the holes.
4. Insert screws into anchors leaving a gap.
5. Place the switch on screws and slide down to lock into place.

Network Topologies:

The switch supports auto MDI/MDIX. Use straight-through or crossover cables to connect to Ethernet devices.

Standard Mode (Default):

Connect devices as per standard mode configuration with VLANoff.

Safety Precautions:

Operation is subject to specific conditions to avoid interference and ensure proper functioning.

Quick Installation Guide

5/8/16-Port Gigabit Ethernet Switch

- TEG1005D/TEG1005M/TEG1008M/TEG1016M/TEG1116M

9-Port 10/100M Ethernet Desktop Switch

- TEF1109D

5-Port Fast Ethernet Switch

- TEF1005D

Package contents

TEG1005D/TEF1005D/TEG1005M/TEG1008M/TEF1109D

- Switch × 1
- Power adapter × 1
- Quick installation guide

TEG1016M/TEG1116M

- Switch × 1
- Power adapter × 1
- Screw (thread diameter: 3 mm, length: 14 mm, head diameter: 5.2 mm) × 2
- Plastic anchor (height: 6.6 mm, inner diameter: 2.4 mm, length: 26.4mm) × 2
- Quick installation guide

TEF1109D is used for illustrations here unless otherwise specified. The actual product prevails.

Install the device

Preparations

- Desktop mounting: ESD bracelet or gloves
- Wall mounting: ESD bracelet or gloves, screwdriver, spirit level, marker, hammer drill, rubber hammer, ladder, 2 plastic anchors (self-prepared except TEG1016M/TEG1116M, height: 6.6 mm, inner diameter: 2.4 mm, length: 26.4 mm) and 2 screws (self-prepared except TEG1016M/TEG1116M, thread diameter: 3 mm, length: 14 mm, head diameter: 5.2 mm)

Installation

Desktop mounting

Horizontally place the switch right-side up on a big enough, clean, stable and flat desktop.

Wall mounting

Note

- This switch can only be installed on non-flammable walls, such as a concrete wall.
 - Do NOT install the switch with its air vents facing downward. Otherwise, there will be potential safety hazards.
1. Mark your wall for the wall-mounting slots on the bottom of the switch and drill two holes (diameter: 6 mm) horizontally. The distance between two holes varies with models (TEG1008M/TEF1109D: 116 mm, TEG1005D/TEF1005D/TEG1005M: 80 mm, TEG1016M/TEG1116M: 110 mm).
 2. Hammer plastic anchors into the holes.
 3. Insert screws into the plastic anchors, leaving a gap (at least 2.5 mm) between the screw heads and plastic anchors.
 4. Place the switch on the screws and slide it down until it locks into place.

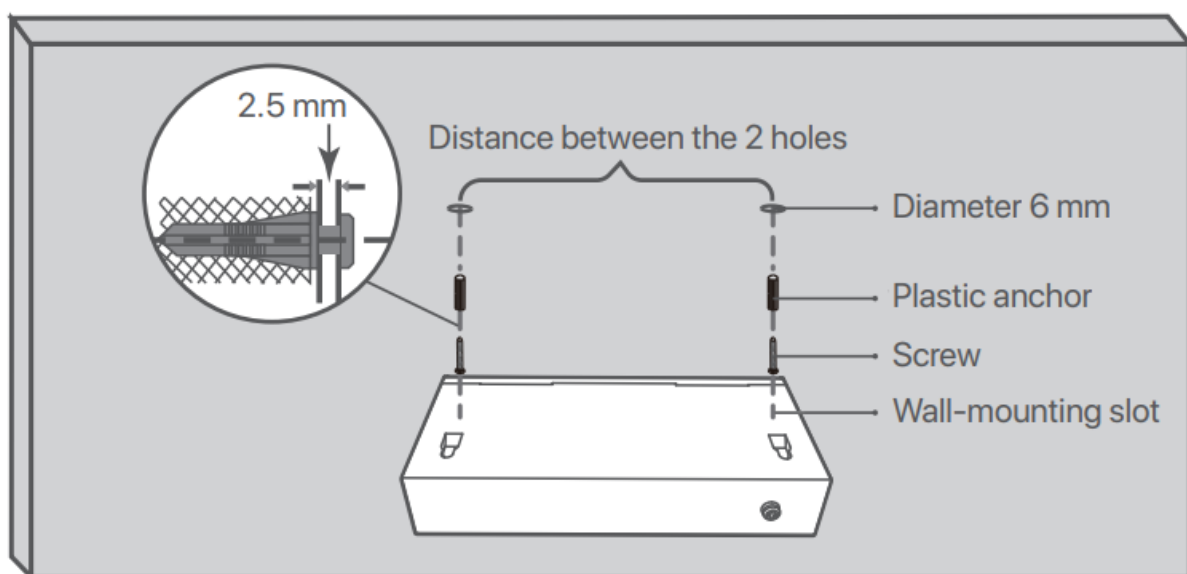

Example: TEF1109D

Typical network topologies

Tips

The switch supports auto MDI/MDIX. You can use either a straight-through cable or a crossover cable to connect the switch to Ethernet devices.

Standard mode (default)

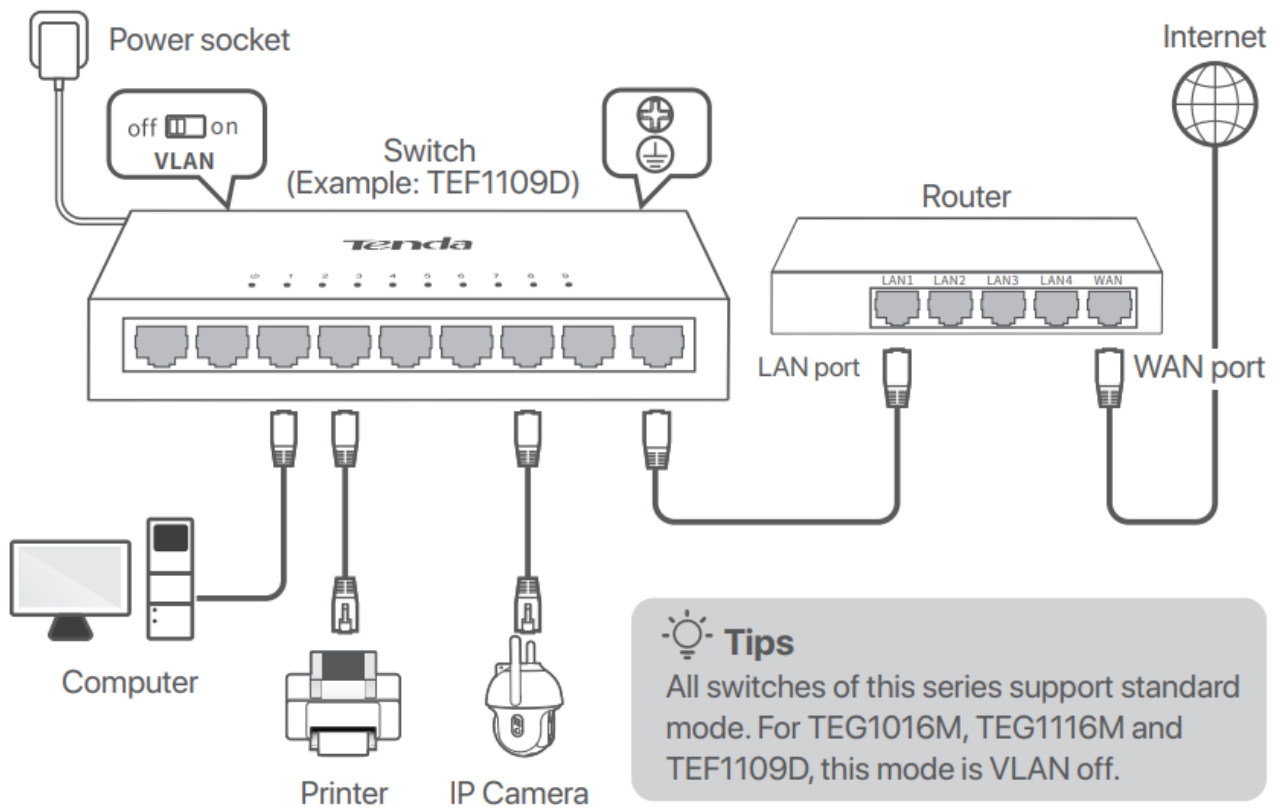

VLAN mode

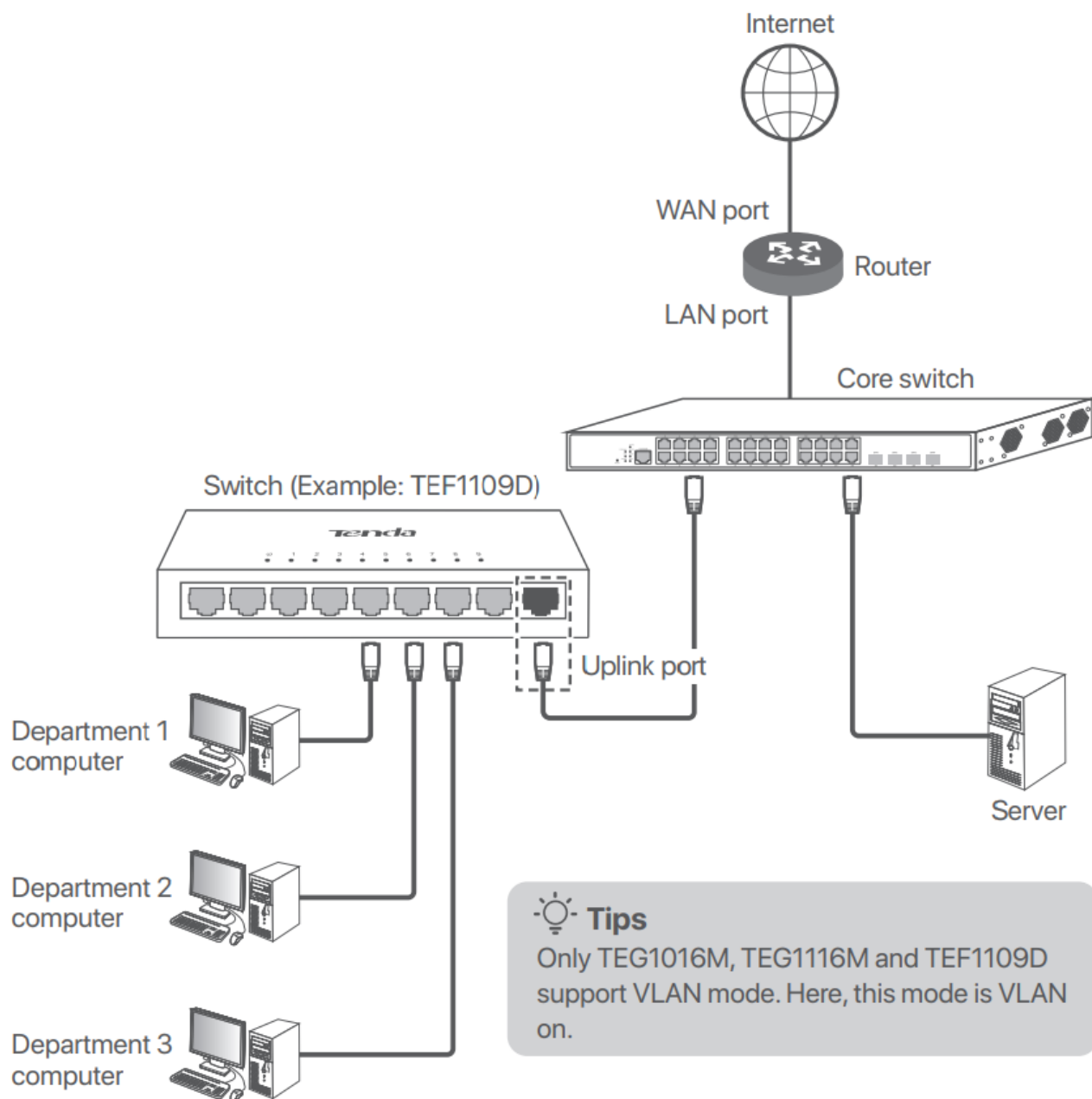

After connection, you can check whether the switch is connected properly or change its working mode based on the following tables.

Indicators

Indicator	Status	Description
PWR/Power/  TEG1016M/ TEG1116M: on the rear panel	Solid on	The switch is powered on.
	Off	The switch is powered off.
1-5/8/9/16	Solid on	The port is connected, but no data is being transmitted over the port.
	Blinking	Data is being transmitted over the port.
	Off	The port is not connected.

Working mode toggle

(TEF1109D/TEG1016M/TEG1116M)

Working mode	Description
VLAN off	Default mode. In this mode, all ports can communicate with each other.
VLAN on	<p>In this mode, the downlink ports are isolated from each other but can communicate with the uplink ports. This mode helps isolate DHCP broadcasts and reduce broadcast storm.</p> <p>Uplink ports:</p> <ul style="list-style-type: none">– TEG1016M/TEG1116M: Ports 15-16– TEF1109D: Port 9 <p>Downlink ports:</p> <ul style="list-style-type: none">– TEG1016M/TEG1116M: Ports 1-14– TEF1109D: Ports 1-8

Get support and services

For technical specifications, user guides and more information, please visit the product page or service page on www.tendacn.com. Multiple languages are available. You can see the product name and model on the product label.



- <https://www.tendacn.com/service/default.html>

FAQ

Q1: The power indicator ( PWR or Power) does not light up. What should I do?

- Ensure that the power adapter is connected to the switch and the power jack properly.
- Ensure that the switch is powered on.
- Ensure that the input voltage matches the value required by the switch.

Q2: The Link/Act indicator (1-5/8/9/16) of the switch is off. What should I do?

- Ensure that the Ethernet cable is not damaged.
- Ensure that the Ethernet cable between the switch and the attached device is connected properly, and the length of the Ethernet cable is within the standard length 100m.
- Ensure that the switch is powered on.
- Ensure the connected device is powered on and working properly.

Safety precautions

Before operating, read the operation instructions and precautions to be taken, and follow them to prevent accidents. The warning and danger items in other documents do not cover all the safety precautions that must be followed. They are only supplementary information, and the installation and maintenance personnel need to understand the basic safety precautions to be taken.

- For wall mounting, the device is only suitable for mounting at heights ≤ 2 m.
- Operating environment: Temperature: 0°C- 40°C (32°F – 104°F); Humidity: (10% – 90%) RH, non-condensing; Storage environment: Temperature: -20°C – 70°C (-4°F – 158°F); Humidity: (5% – 90%) RH, non-condensing.
- The mains plug is used as the disconnect device and shall remain readily operable.
- The power socket shall be installed near the device and easily accessible.
- Only use attachments/accessories specified by the manufacturer.
- Do not block any ventilation openings.
- Keep the device away from water, heat sources, high electric field, high magnetic field, and inflammable and explosive items.
- Keep the operating environment clean. Remove dust from the device regularly. Cut power before cleaning.
- Ensure proper grounding before device operation. Refer to the Lightning Protection Guide on the official website for guidance.
- Disassembling or modifying the device or its accessories without authorization voids the warranty and might cause safety hazards.
- If such phenomena as smoke, abnormal sound or smell appear when you use the device, immediately stop using it and disconnect its power supply, unplug all connected cables, and contact the after-sales service personnel.
- Disconnect the power source during servicing.
- Refer all servicing to qualified service personnel.
- The device's marking information can be found on its surface.

For the latest safety precautions, see Safety and Regulatory Information on www.tendacn.com.

FCC statement

This equipment has been tested and found to comply with the limits for a Class A digital device, pursuant to Part 15 of the FCC Rules. These limits are designed to provide reasonable protection against harmful interference when the equipment is operated in a commercial environment. This equipment generates, uses, and can radiate radio frequency energy and, if not installed and used in accordance with the instruction manual, may cause harmful interference to radio communications. Operation of this equipment in a residential area is likely to cause harmful interference in which case the user will be required to correct the interference at his own expense.

Operation is subject to the following two conditions:

1. this device may not cause harmful interference, and
2. this device must accept any interference received, including interference that may cause undesired operation.

Caution!

Any changes or modifications not expressly approved by the party responsible for compliance could void the user's authority to operate the equipment.

NOTE:

1. The manufacturer is not responsible for any radio or TV interference caused by unauthorized modifications to this equipment.
2. To avoid unnecessary radiation interference, it is recommended to use a shielded RJ45 cable.

CE mark warning

This is a Class A product.

Warning: Operation of this equipment in a residential environment could cause radio interference. In this case, the user may be required to take adequate measures.

NOTE:

1. The manufacturer is not responsible for any radio or TV interference caused by unauthorized modifications to this equipment.
2. To avoid unnecessary radiation interference, it is recommended to use a shielded RJ45 cable.

Declaration of Conformity

Hereby, SHENZHEN TENDA TECHNOLOGY CO., LTD. declares that the device (Switch) is in compliance with directives 2014/35/EU and 2014/30/EU. The full text of the EU Declaration of Conformity is available at the following internet address: <https://www.tendacn.com/download/list-9.html>

**RECYCLING**

This product bears the selective sorting symbol for Waste Electrical and Electronic Equipment (WEEE). This means that this product must be handled pursuant to European directive 2012/19/EU in order to be recycled or dismantled to minimize its impact on the environment. User has the choice to give his product to a competent recycling organization or to the retailer when he buys new electrical or electronic equipment

Technical support

- Shenzhen Tenda Technology Co., Ltd.
- Floor 6-8, Tower E3, No.1001, Zhongshanyuan Road, Nanshan District, Shenzhen, China. 518052

- Website: www.tendacn.com
- E-mail: support@tenda.com.cn
- support.uk@tenda.cn (United Kingdom)
- support.us@tenda.cn (North America)

Copyright© 2024 Shenzhen Tenda Technology Co., Ltd. All rights reserved. Tenda is a registered trademark legally held by Shenzhen Tenda Technology Co., Ltd. Other brand and product names mentioned herein are trademarks or registered trademarks of their respective holders. Specifications are subject to change without notice.

Documents / Resources

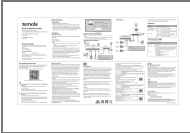
	Tenda TEG1005D Series Ethernet Switch [pdf] Installation Guide TEG1005D, TEF1005D, TEG1005M, TEG1008M, TEF1109D, TEG1016M, TEG1116M, TEG1005D Series Ethernet Switch, TEG1005D Series, Ethernet Switch, Switch
---	---

References

- [User Manual](#)

[Manuals+](#), [Privacy Policy](#)

This website is an independent publication and is neither affiliated with nor endorsed by any of the trademark owners. The "Bluetooth®" word mark and logos are registered trademarks owned by Bluetooth SIG, Inc. The "Wi-Fi®" word mark and logos are registered trademarks owned by the Wi-Fi Alliance. Any use of these marks on this website does not imply any affiliation with or endorsement.