



# Tenda AX3000 Wireless PCI Express Adapter User Guide

[Home](#) » [Tenda](#) » Tenda AX3000 Wireless PCI Express Adapter User Guide 

# *Tenda*

**Quick Installation Guide  
Wireless AX3000 PCI Express Adapter  
E30**

## Contents

- [1 Package contents](#)
- [2 Technical Support](#)
- [3 Hardware installation](#)
- [4 Install WiFi driver and connect to a WiFi network](#)
- [5 Connect to a WiFi network](#)
- [6 Install Bluetooth driver and use Bluetooth](#)
- [7 Connect Bluetooth](#)
- [8 Appendix](#)
- [9 FAQ](#)
- [10 Documents / Resources](#)
  - [10.1 References](#)
- [11 Related Posts](#)

## Package contents

- Wireless adapter (with a high profile bracket) x 1
- Antenna x 2
- Driver CD x 1
- Low profile bracket x 1
- Bluetooth cable x 1
- Quick installation guide x 1

The guide walks you through installation and how to perform first-time configurations. For product details, please visit [www.tendacn.com](http://www.tendacn.com).

## Technical Support

Shenzhen Tenda Technology Co., Ltd.

6-8 Floor, Tower E3, NO.1001, Zhongshanyuan Road, Nanshan District, Shenzhen, China.

518052

USA hotline: 1-800-570-5892

Toll-Free: 7 x 24 hours

Canada hotline: 1-888-998-8966

Toll Free: Mon – Fri 9 am – 6 pm PST

Hong Kong hotline: 00852-81931998

Global hotline: +86 755-2765 7180 (China Time Zone)

Website: [www.tendacn.com](http://www.tendacn.com)

E-mail: [support@tenda.com.cn](mailto:support@tenda.com.cn)

### Copyright

© 2020 Shenzhen Tenda Technology Co., Ltd. All rights reserved.

Tenda is a registered trademark legally held by Shenzhen Tenda Technology Co., Ltd. Other brand and product names mentioned herein are trademarks or registered trademarks of their respective holders. Specifications are subject to change without notice.

Operating Temperature: 0°C – 40°C

Operating Humidity: (10% – 90%) RH, non-condensing



### Tips

- This wireless adapter only supports Windows 10 64-bit operating system.
- If you have installed a wireless adapter before, please uninstall the existing wireless adapter. The specific steps can refer to in the appendix.
- If the high profile bracket is too long for your PC case, you can use the low profile bracket in the package to install the wireless adapter.

## Hardware installation

1. Turn off the computer and disconnect the power, then remove the side panel of the PC case.

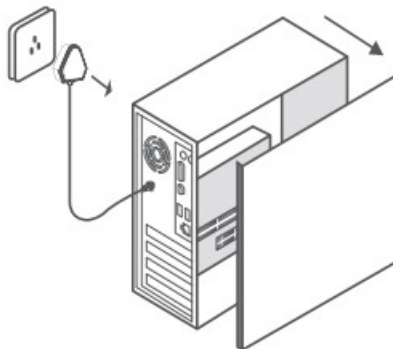

2. Select an available PCI-E X1 slot, and remove the bracket corresponding to the slot on the PC case. Then insert the wireless adapter into the selected slot, and make sure that the wireless adapter contacts with the slot properly.

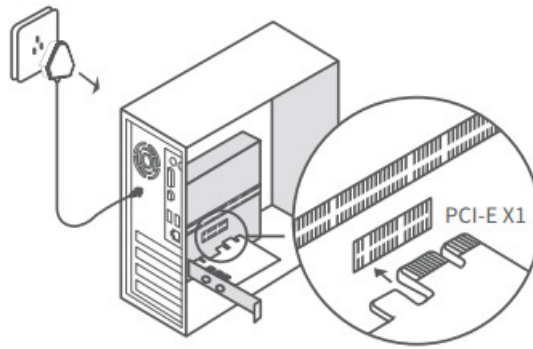

#### Note

Do not touch the metal pins on the connector of the wireless adapter with your hands to prevent the wireless adapter from being burnt out by static electricity.

3. Connect the 4-hole end of the Bluetooth cable to the Bluetooth connector of the wireless adapter and the other end to the 9-pin connector with USB printing on the mainboard.

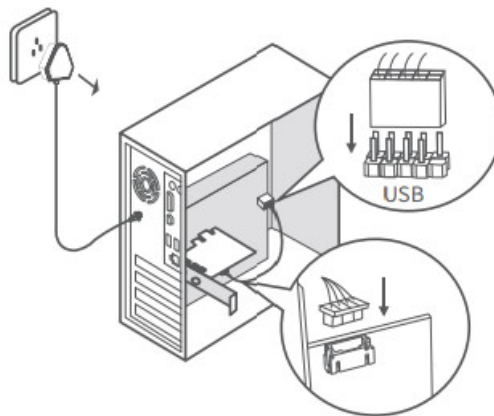

4. Install the antennas to the wireless adapter. Install the side panel of the PC case, then reconnect the computer to the power source and switch it on.

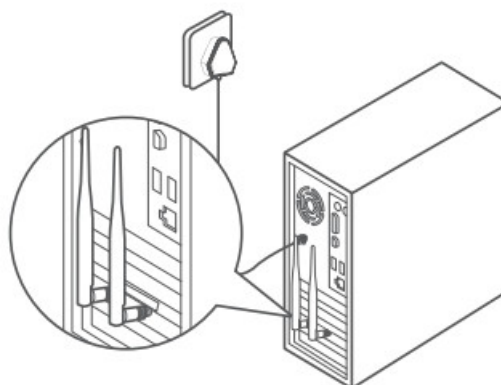

## Install WiFi driver and connect to a WiFi network

Install the WiFi driver

1. Put the CD in your computer's CD-ROM drive.

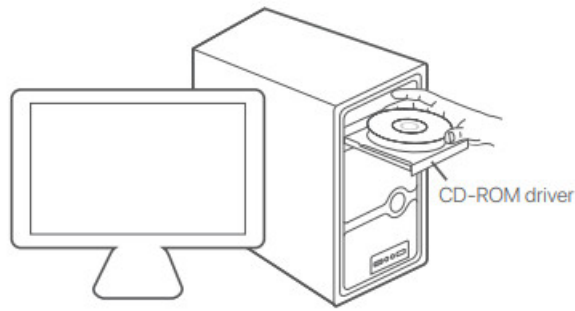

### Tips

If there is no CD driver in your computer, you can download the WiFi driver of this wireless adapter through the following methods.

Method 1: Visit <https://www.tendacn.com/en/download/detail-3734.html> to download the WiFi driver.

Method 2: Scan the QR code below to download the WiFi driver. If the WiFi driver cannot be downloaded through the WeChat QR code, it is recommended to try a browser.



<https://www.tendacn.com/en/download/detail-3734.html>

2. Access the contents of the CD. Double-click the driver wifi\_driver\_win10\_64.exe and follow the prompts.

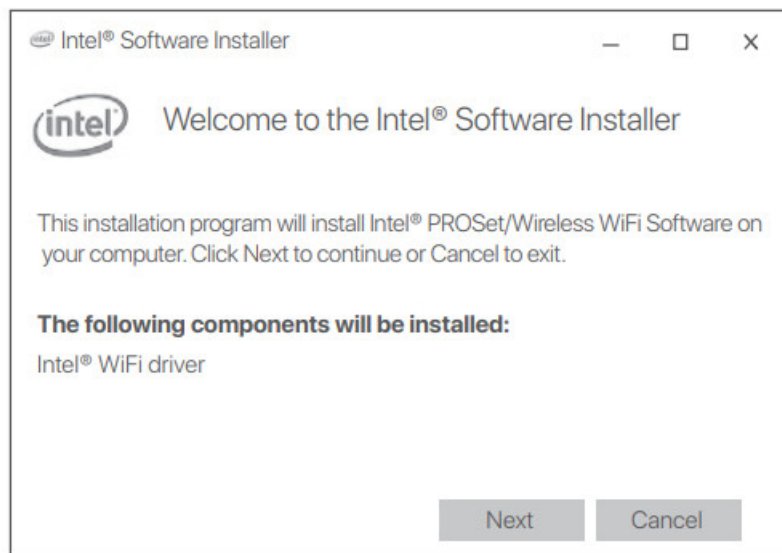

√ Installation completed.

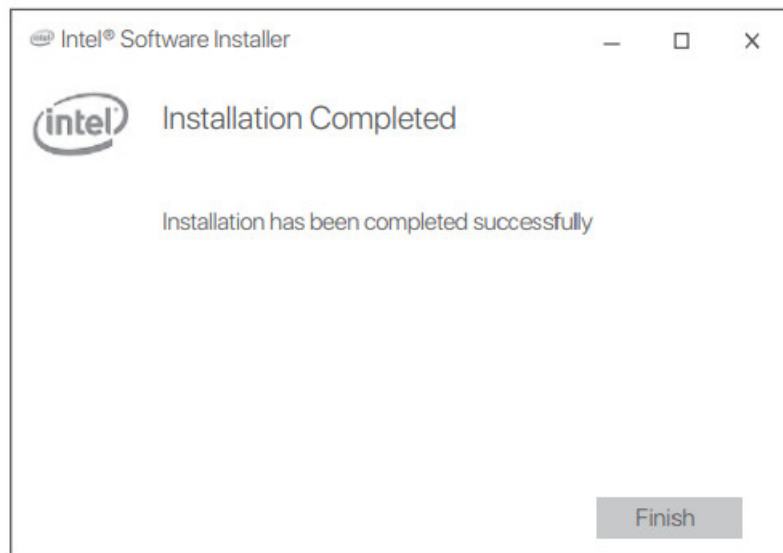

## Connect to a WiFi network

1. Click  in the lower right corner on the desktop.  
Choose the WiFi network you need to connect and click Connect.
2. If the wireless network is encrypted, enter its wireless password, click Next, and then follow the system prompts.  
Connected successfully.

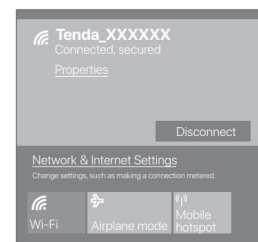
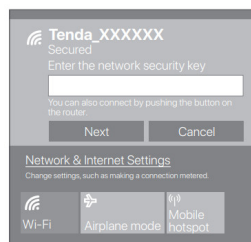
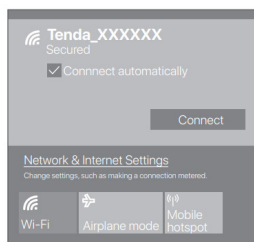

## Install Bluetooth driver and use Bluetooth

### Install the Bluetooth driver

1. Put the CD in your computer's CD-ROM drive.

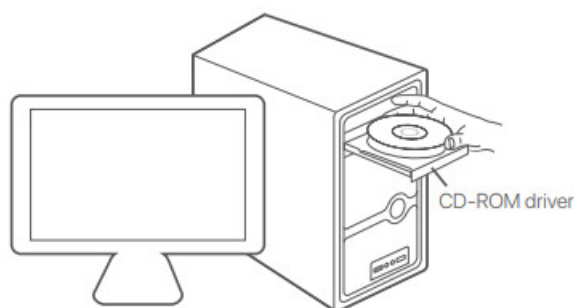

### Tips

If there is no CD driver in your computer, you can download the Bluetooth driver of this wireless adapter by the following methods.

Method 1: Visit <https://www.tendacn.com/en/download/detail-3734.html> to download the Bluetooth driver.

Method 2: Scan the QR code below to download the Bluetooth driver.



<https://www.tendacn.com/en/download/detail-3734.html>

2. Access the contents of the CD. Double-click the driver Bt\_win10\_64.exe and follow the prompts.

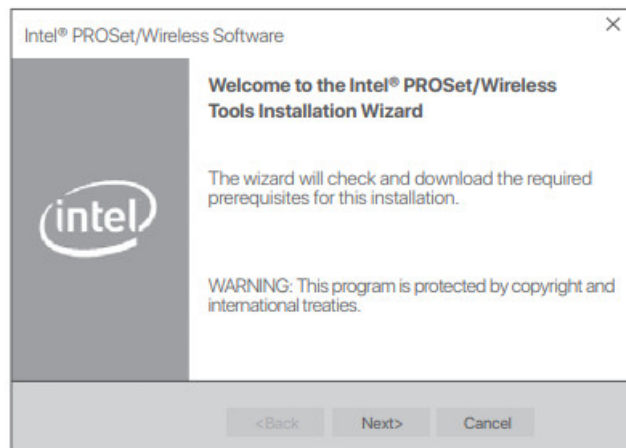

✓ Installation completed.

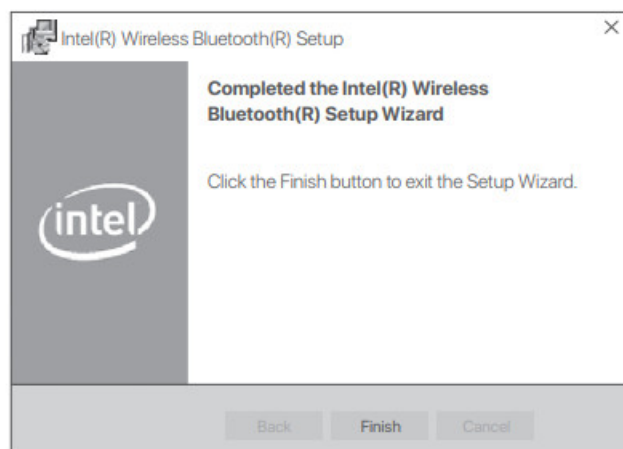

## Connect Bluetooth

1. Turn on Bluetooth for the device to be connected to, such as a wireless mouse, wireless stereo, and so on.
2. Turn on Bluetooth for the wireless adapter.

1. Click  in the lower right corner of your desktop, and click Add a Bluetooth Device.
2. Click Add Bluetooth or another device.

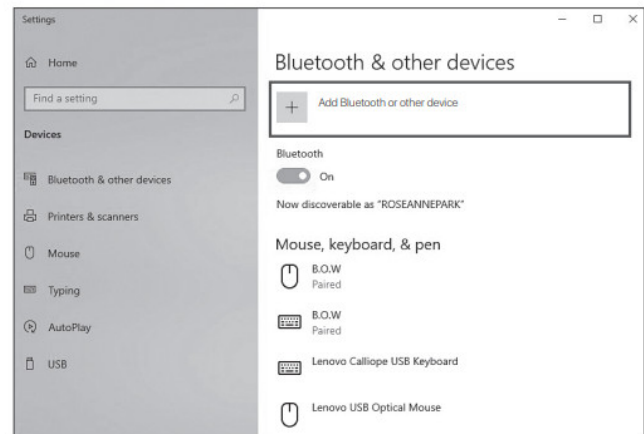
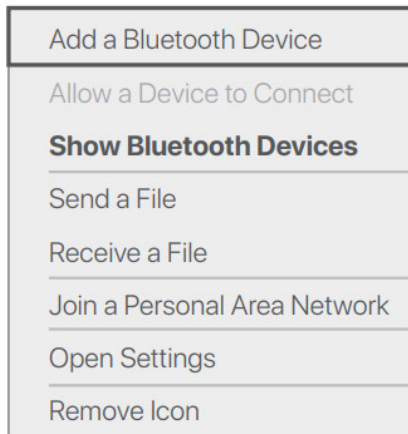

3. Click Bluetooth.
4. Click the Bluetooth device you want to connect to.

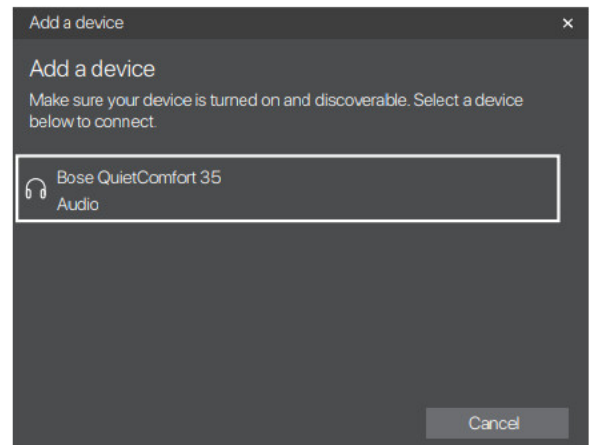
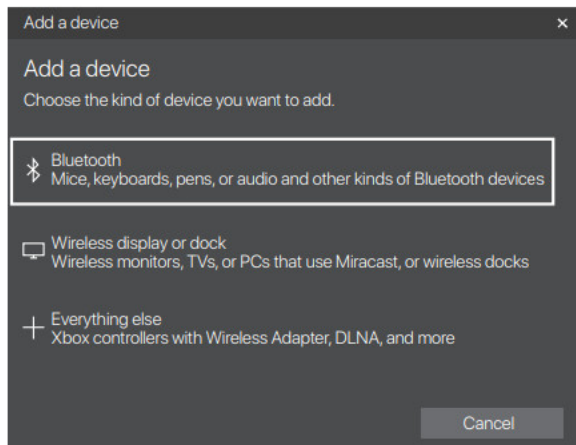

### Tips



If you can't find the Bluetooth device you want to connect to, try the following solutions.

- Place the device close to the wireless adapter.
- Restart Bluetooth for the device.

Wait a moment, the connection succeeds.

## Appendix

Uninstall the wireless adapter driver you already had on your computer.

1. Click  in the lower-left corner of the desktop. Click .



2. Click Apps.

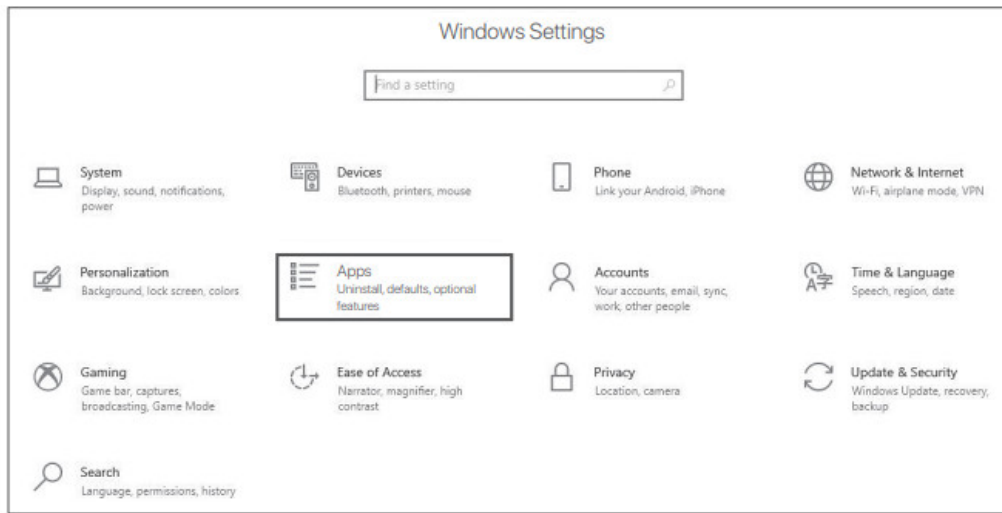

## FAQ

Q1: After the completion of hardware installation, the computer cannot identify the wireless adapter, what should I do?

A1: Please try the following solutions:

- Wipe the metal pins of the wireless adapter's PCI-E interface with an eraser.
- Use another PCI-E X1 slot.
- If the computer still cannot identify the network card, please contact the reseller.



### CE Mark Warning

This is a Class B product. In a domestic environment, this product may cause radio interference, in which case the user may be required to take adequate measures.

Operations in the 5.15-5.35GHz band are restricted to indoor use only.

### Declaration of Conformity

Hereby, SHENZHEN TENDA TECHNOLOGY CO., LTD. declares that the radio equipment type E30 is in compliance with Directive 2014/53/EU.

The full text of the EU declaration of conformity is available at the following internet address:

<http://www.tendacn.com/en/service/download-cata-101.html>

Operating Frequency:

BTL: EU/2402-2480MHz

2.4GHz: EU/2412-2472MHz

5GHz: 5150-5350MHz 5470-5725MHz 5725-5850MHz

EIRP Power (Max.): 2.4 GHz 20dBm

5 GHz 20dBm

Software Version: V21.90.3

### FCC Statement

This equipment has been tested and found to comply with the limits for a Class B digital device, pursuant to Part 15 of the FCC Rules. These limits are designed to provide reasonable protection against harmful interference in a residential installation. This equipment generates, uses and can radiate radio frequency energy and, if not installed and used in accordance with the instructions, may cause harmful interference to radio communications.

However, there is no guarantee that interference will not occur in a particular installation. If this equipment does cause harmful interference to radio or television reception, which can be determined by turning the equipment off and on, the user is encouraged to try to correct the interference by one or more of the following measures:

- Reorient or relocate the receiving antenna.



- Increase the separation between the equipment and receiver.
- Connect the equipment into an outlet on a circuit different from that to which the receiver is connected.
- Consult the dealer or an experienced radio/TV technician for help.

The device is for indoor usage only.

Operation is subject to the following two conditions: (1) this device may not cause harmful interference, and (2) this device must accept any interference received, including interference that may cause undesired operation.

#### Radiation Exposure Statement

This device complies with FCC radiation exposure limits set forth for an uncontrolled environment and it also complies with Part 15 of the FCC RF Rules.

This equipment should be installed and operated with a minimum distance 20cm between the device and your body.

#### Caution:

Any changes or modifications not expressly approved by the party responsible for compliance could void the user's authority to operate this equipment.

This transmitter must not be co-located or operating in conjunction with any other antenna or transmitter.

Operating frequency: BTL: 2402-2480MHz, 2.4GHz: 2412-2462MHz, 5GHz: 5150-5350MHz, 5470-5725MHz, 5725-5850MHz

**NOTE:** (1) The manufacturer is not responsible for any radio or TV interference caused by unauthorized modifications to this equipment. (2) To avoid unnecessary radiation interference, it is recommended to use a shielded RJ45 cable.

For EU/EFTA, this product can be used in the following countries:

	BE	BG	CZ	DK	DE	EE	IE	EL	ES	FR	HR	IT	CY	LV
	LT	LU	HU	MT	NL	AT	PL	PT	RO	SI	SK	FI	SE	UK

#### RECYCLING



This product bears the selective sorting symbol for waste electrical and electronic equipment (WEEE). This means that this product must be handled pursuant to European directive 2012/19/EU in order to be recycled or dismantled to minimize its impact on the environment.

The user has the choice to give his product to a competent recycling organization or to the retailer when he buys new electrical or electronic equipment.

#### Documents / Resources

	<a href="#">Tenda AX3000 Wireless PCI Express Adapter</a> [pdf] User Guide AX3000, Wireless PCI Express Adapter
---	--

#### References

- [Tenda US](#)
- [CE Center-Tenda-All For Better NetWorking](#)
- [Sorry. Page not found](#)
- [E30 Driver-Tenda-All For Better NetWorking](#)