

Telpo M1 Android POS Terminal User Manual

[Home](#) » [Telpo](#) » Telpo M1 Android POS Terminal User Manual 

Contents

- [1 Telpo M1 Android POS Terminal](#)
- [2 Read me first](#)
- [3 Device layout](#)
- [4 Technical Specification](#)
- [5 FCC Caution](#)
- [6 Package contents](#)
- [7 Installing the SIM card, PSAM and TF card](#)
- [8 SIM card & TF card Installation](#)
- [9 Charging the battery and transfer data](#)
- [10 Basics](#)
- [11 Connect & transfer](#)
- [12 Bluetooth](#)
- [13 Settings](#)
- [14 About Phone](#)
- [15 Documents / Resources](#)
- [16 Related Posts](#)



Telpo M1 Android POS Terminal

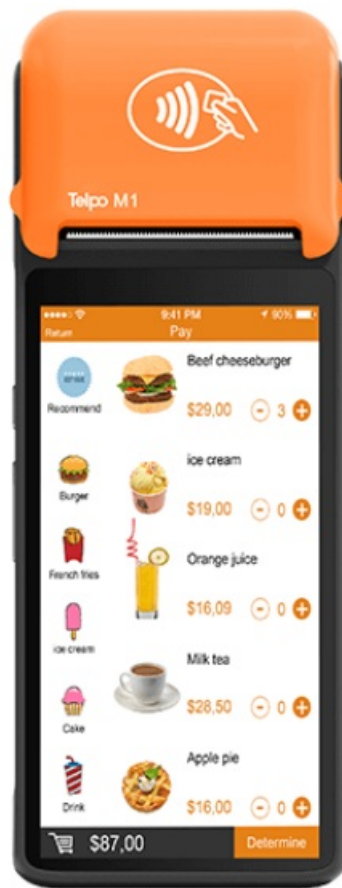

Read me first

This device provides mobile communication and media services using Telpo's latest standards and technological expertise. This user manual and the information available contain details about the device's functions and features.

- Please read this manual before using the device to ensure safe and proper use.
- Descriptions are based on the device's default settings.
- Some content may differ from your device depending on the region, service provider, or device's software.
- Telpo is not liable for performance issues caused by apps supplied by providers other than Telpo.
- Telpo is not liable for performance issues or incompatibilities caused by edited registry settings or modified operating system software. Attempting to customise the operating system may cause the device or apps to work improperly.
- Software, sound sources, wallpapers, images, and other media provided with this device are licensed for limited use. Extracting and using these materials for commercial or other purposes is an infringement of copyright laws. Users are entirely responsible for illegal use of media.
- You may incur additional charges for data services, such as messaging, uploading and downloading, auto-syncing, or using location services. To avoid additional charges, select an appropriate data tariff plan. For details, contact your service provider.
- Modifying the device's operating system or installing software from unofficial sources may result in device malfunctions and data corruption or loss. These actions are violations of your Telpo licence agreement and will void your warranty.
- Is in compliance with the essential requirements and other relevant provisions of Directive 2014/53/EU.
- For safe operating, the antenna of the product shall be least 0.22m away from the body of the user. The

maximum allowed antenna gain is 1.0 dBi.

- The Handheld Terminal supplied by Li Polymer battery, and charged from approved Travel Charger with USB cable connection.
- Caution:
- For Adapter: Shall be installed near the equipment and shall be easily accessible.
- For Battery: Risk of explosion battery is replaced by an incorrect type, dispose of used batteries according to the instructions.
- Only can use the adapter as below:
 - Manufacturer: SHENZHEN SOY TECHNOLOGY CO., LTD.
 - Model Name: SOY-131QC3.0EU
 - Rated Input & Output: Input:100-240VAC 50/60Hz Output: 3.6V-6.5V 3A; 6.5V-9V 2A;9V-12V 1.5A
 - The plug considered as disconnect device of adapter.

Device layout

The following illustration outlines your device's primary external features.



Buttons

Button	Function
Power	<ul style="list-style-type: none"> Press and hold to turn the device on or off. Press to lock or unlock the device. The device goes into lock mode when the touch screen turns off.
Volume	<ul style="list-style-type: none"> Press to adjust the device volume.
Overview	<ul style="list-style-type: none"> Tap Overview to see your recent apps, and tap an app to reopen it. To remove an app from the list, swipe it left, right. To scroll the list, swipe up or down.
Home	<ul style="list-style-type: none"> Tap to return to the Home screen.
Back	<ul style="list-style-type: none"> Tap to return to the previous screen.

Technical Specification

OS	Android 11
Processor	Quad-Core 2.0GHz
Memory	2GB DDR, 16GB eMMC, Ext. TF card slot
Display	6-inch, 720*1440
Keypad	1 power key, 2 volume keys
Thermal Printer	Paper width: 58mm, Φ40mm
Contactless Card Reader	ISO14443 Type A/B, Mifare
Camera	5M Pixel, auto focus (Barcode software decoding)
2D Barcode Reader(Optional)	Hard Decoding
SIM Slots	1 Nano SIMs 2 Nano SIM(Optional)
SAM Slots	2 SAMs

Communications	LTE/WCDMA/GPRS/WiFi/Bluetooth IEEE 802.11 a/b/g/n/ac 2.4GHz/5 GHz LTE:B3/B7/B20 WCDMA: B1/B8 2G 900/1800 BLE 5.0
GPS (Optional)	Built-in
Peripheral Ports	1 Type-C(OTG), 1 Audio Jack
Audio	Digital Audio Speaker
Power Supply	Fast charging supported
Battery	7.6V/2500mAh, Li-ion(Non-removable)
Environmental	Operating temperature: -5°C ~ 45°C Storage temperature: -25°C ~ 60 °C
Dimensions (mm)	220 (L)*85 (W)*17 (H)

IC Caution.

This device contains licence-exempt transmitter(s)/receiver(s) that comply with Innovation, Science and Economic Development Canada's licence-exempt RSS(s). Operation is subject to the following two conditions:

1. This device may not cause interference.
2. This device must accept any interference, including interference that may cause undesired operation of the device.

FCC Caution

This device complies with part 15 of the FCC Rules. Operation is subject to the following two conditions: (1) This device may not cause harmful interference, and (2) this device must accept any interference received, including interference that may cause undesired operation.

Any Changes or modifications not expressly approved by the party responsible for compliance could void the user's authority to operate the equipment.

Note: This equipment has been tested and found to comply with the limits for a Class B digital device, pursuant to part 15 of the FCC Rules. These limits are designed to provide reasonable protection against harmful interference in a residential installation. This equipment generates uses and can radiate radio frequency energy and, if not installed and used in accordance with the instructions, may cause harmful interference to radio communications. However, there is no guarantee that interference will not occur in a particular installation. If this equipment does cause harmful interference to radio or television reception, which can be determined by turning the equipment off and on, the user is encouraged to try to correct the interference by one or more of the following measures:

- Reorient or relocate the receiving antenna.
- Increase the separation between the equipment and receiver.
- Connect the equipment into an outlet on a circuit different from that to which the receiver is connected.

- Consult the dealer or an experienced radio/TV technician for help.

FCC/IC RF Radiation Exposure and SAR Statements

The device has been tested for body and head Specific Absorption Rate (SAR) compliance. The FCC/IC has established detailed SAR requirements and has established that these requirements. RF Exposure Information The radio module has been evaluated under FCC Bulletin C95.1 and IEEE 1528 and found to be compliant to RF Exposure from radio frequency devices. This model meets the applicable government requirements for exposure to radio frequency waves. The highest reported SAR level for usage near the Body SAR is 0.937 W/kg.

“XXXX declares that this Terminal is in compliance with the essential requirements and other relevant provisions of Directive 2014/53/EU.

Importers: XXXXXXXX

Address: XXXXXXXX

For the full RED DoC file, Please download it as follow web: <http://XXXX.XXXX>

Technology	Frequency band[MHz]	Maximum transmit power
GSM:850/1900	GSM850 869-894MHz	GSM850 32±3dB
	GSM1900 1930-1990MHz	GSM1900 30±3dB
WCDMA:B2/B5	B2 1930-1990MHz	B2 23±2dB
	B5 869-894MHz	B5 23±2dB
LTE Bands: B2/B4	B2 1930-1990MHz	B2 23±2dB
	B4 2110-2155MHz	B4 23±2dB
WLAN 802.11 a/b/g/n/ac	2.4G 2412-2472MHz	<22dB
	5G 5180-5825 MHz	
BLuetooth	2402~2480 MHz	<20dB
GPS	1575.42 MHz	
NFC	13.56MHz	12.75dBuA/m

Package contents

Check the product box for the following items:

- Main Device
- Power Adapter
- Battery
- User guide
- The items supplied with the device and any available accessories may vary depending on the region or service provider.
- The supplied items are designed only for this device and may not be compatible with other devices.
- Appearances and specifications are subject to change without prior notice.

- You can purchase additional accessories from your local retailer. Make sure they are compatible with the device before purchase.
- Availability of all accessories is subject to change depending entirely on manufacturing companies. For more information about available accessories, please contact us.

Power on your device

- To turn your device on, hold down the Power key until the device powers on. It will take a few seconds before the screen lights up.
- Unlock your device with a swipe, PIN, password or pattern before the Home screen can display if you've set a screen lock in Settings.
 - If you do not know your PIN code or if you have forgotten it, contact your network carrier.
 - Do not leave your PIN code with your device.
 - Store this information in a safe place when not in use.

Power off your device

To turn your device off, hold down the Power key until the Device options appear, then select Power off.

Installing the SIM card, PSAM and TF card

1. Take out the back cover. and the card sockets will be shown.
2. The left card slot is a SIM& TF card two-in-one card socket.

The upper deck can support the insertion of SIM card and TF card. The lower deck can support the insertion of a SIM card.

Notes: In the upper deck, the SIM card needs to be inserted horizontally into the card slot, and in the lower deck, the SIM card needs to be inserted into the card slot vertically.

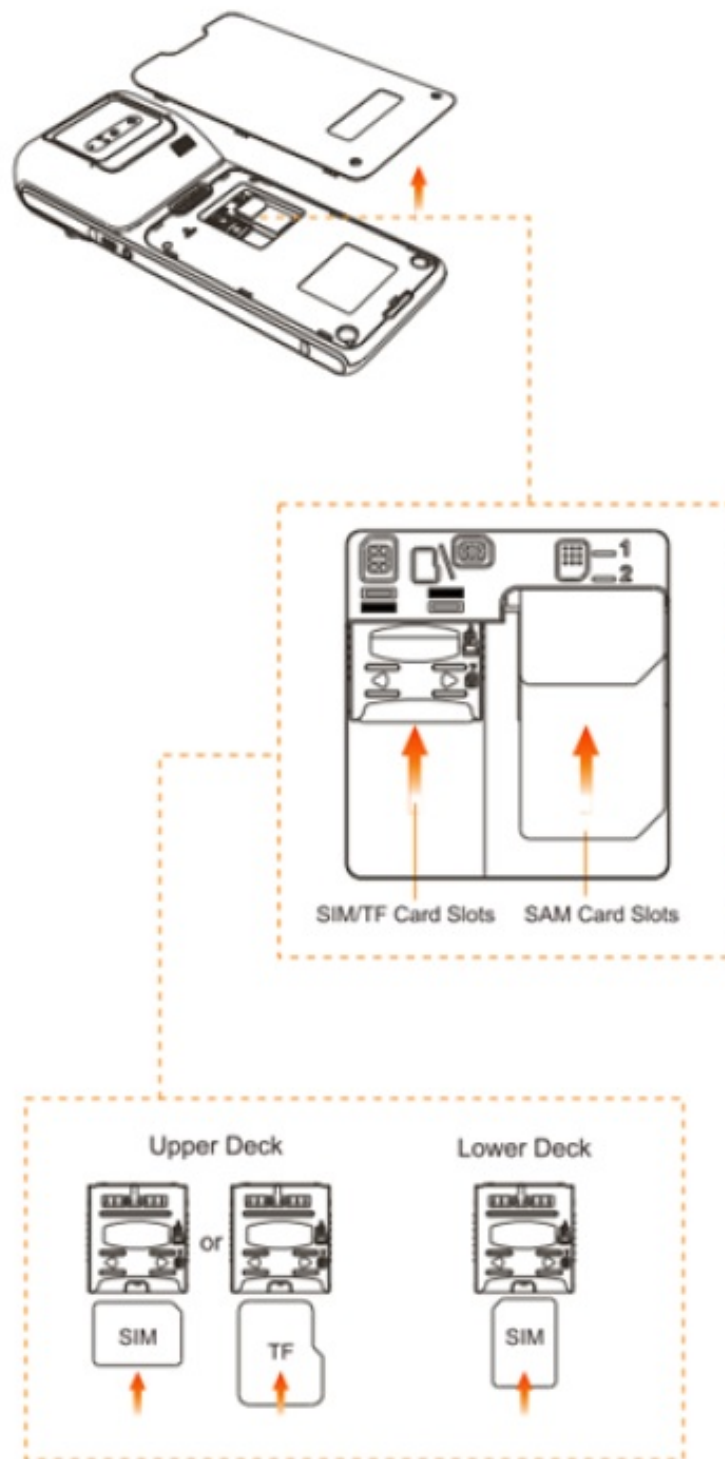

- Be careful not to damage your fingernails when you remove the back cover.
- Do not bend or twist the back cover excessively. Doing so may damage the cover.
- Push the SIM card into the socket correctly. Be sure the SIM card is in right position.
- Do not insert a memory card into the SIM card slot. If a memory card happens to be lodged in the SIM card slot, take the device to a Telpo Service Centre to remove the memory card.
- Use caution not to lose or let others use the SIM card. Telpo is not responsible for any damages or inconveniences caused by lost or stolen cards.

SIM card & TF card Installation

1. First, you need to remove the card from the upper deck.
2. Withdraw the metal tray from the middle of the two deck.
3. Push the metal tray into the middle of the two deck again.
4. Finally, remove the SIM card in the lower deck.

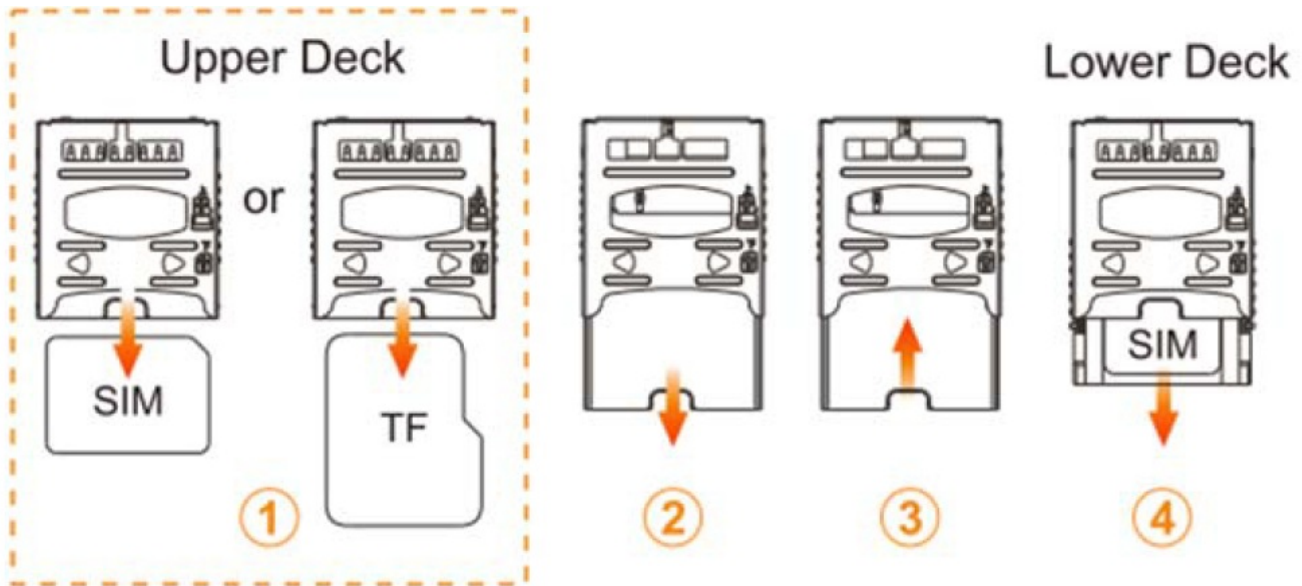

- Any attempt of alteration with wrong battery type has risk of explosion.
- Don't throw battery casually.

SAM card installation

1. Push the PSAM card into the socket correctly. Be sure the PSAM card is in right position.

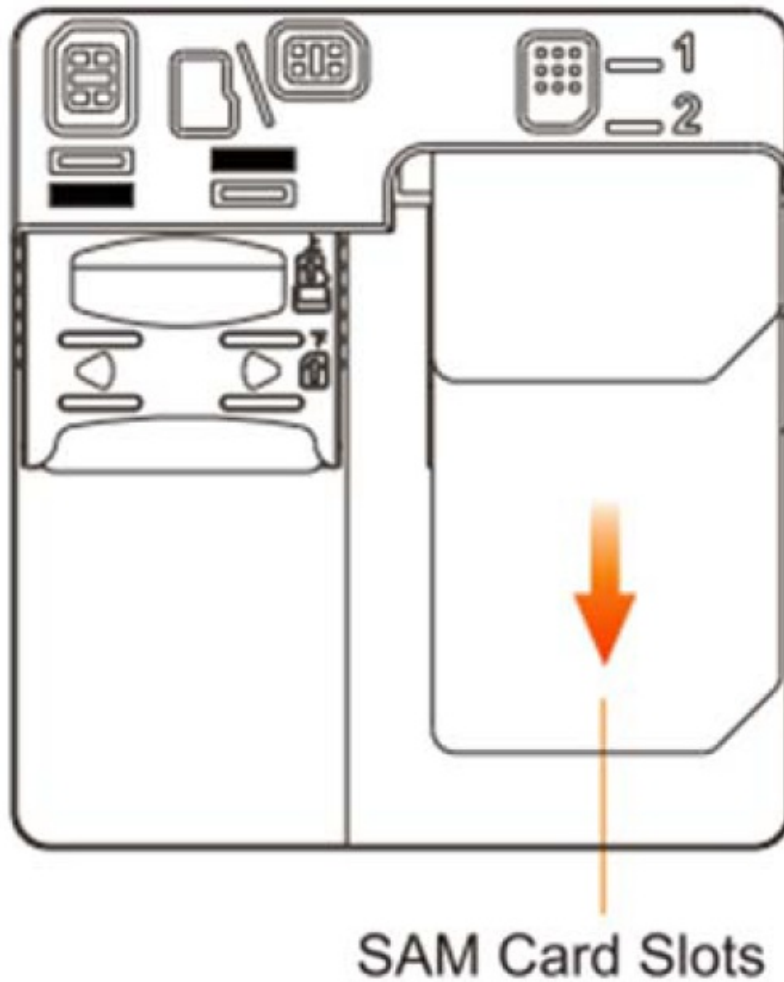

Charging the battery and transfer data

Use the charger to charge the battery before using it for the first time. A computer can be also used to charge the device by connecting them via the USB cable.

- Connect the USB cable to the USB power adaptor.
- Plug one end of the USB cable into the device's Charger Port and the other end into an electrical outlet. The charge time varies depending upon the battery level.

The peripheral can use USB cable to transfer data from device through TYPE C USB.

- Plug one end of the USB cable into TYPE C USB and the other end into peripheral.

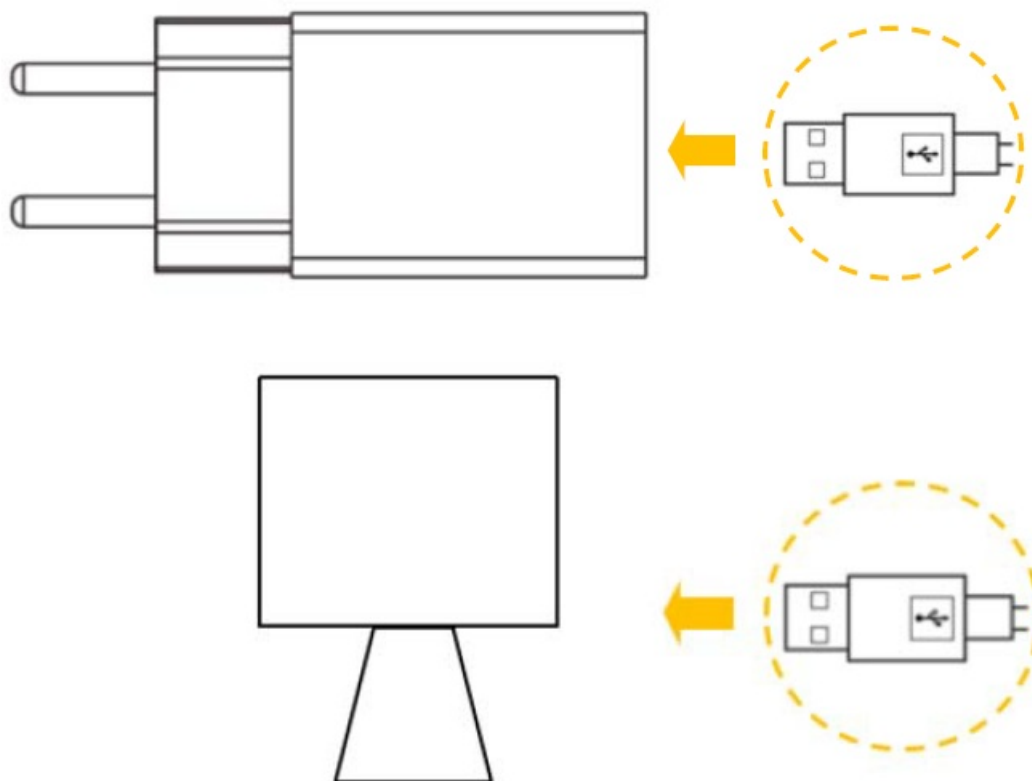

- Use only Telpo-approved chargers, batteries, and cables. Unapproved chargers or cables can cause the battery to explode or damage the device.
- Do not remove the battery before removing the charger. This may damage the device.
- When the battery power is low, the battery icon appears empty.
- If the battery is completely discharged, the device cannot be turned on immediately when the charger is connected. Allow a depleted battery to charge for a few minutes before turning on the device.
- If you use multiple apps at once, network apps, or apps that need a connection to another device, the battery will drain quickly. To avoid disconnecting from the network or losing power during a data transfer, always use these apps after fully charging the battery.
- To save energy, unplug the charger when not in use. The charger does not have a power switch, so you must unplug the charger from the electric socket when not in use to avoid wasting power. The charger should remain close to the electric socket and easily accessible while charging.

Card Reading

NFC tag, put the NFC tag over the printer case of the device.

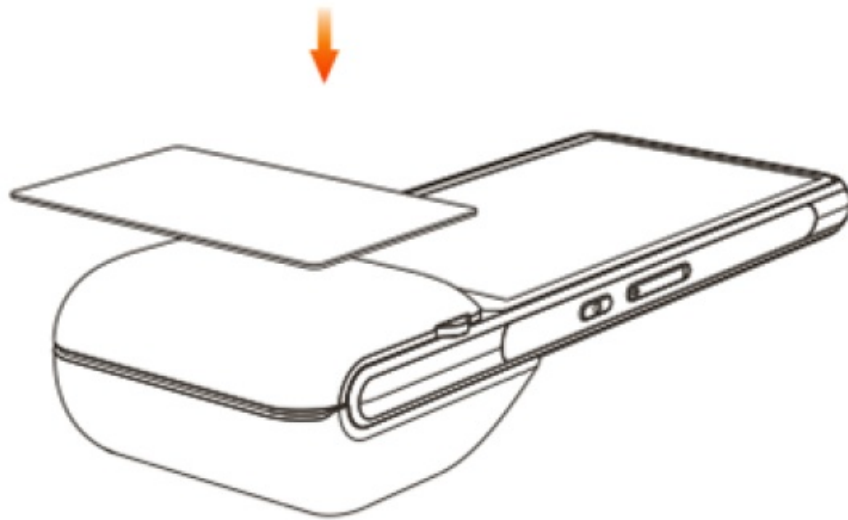

Printing Instruction

This device support 58mm thermal paper with specifications of $57\pm0.5\text{mm}'\leq 140\text{mm}$.

- Please open the paper container with the opening hands on both sides of the printer cover;
- Feed the paper correctly into the paper container in the direction as shown, and pull some paper outside the cutter.
- Close the cover of the paper container to finish printing paper feeding.

Note: If the printed paper is blank, please check whether the paper roll has been install in the correct direction.

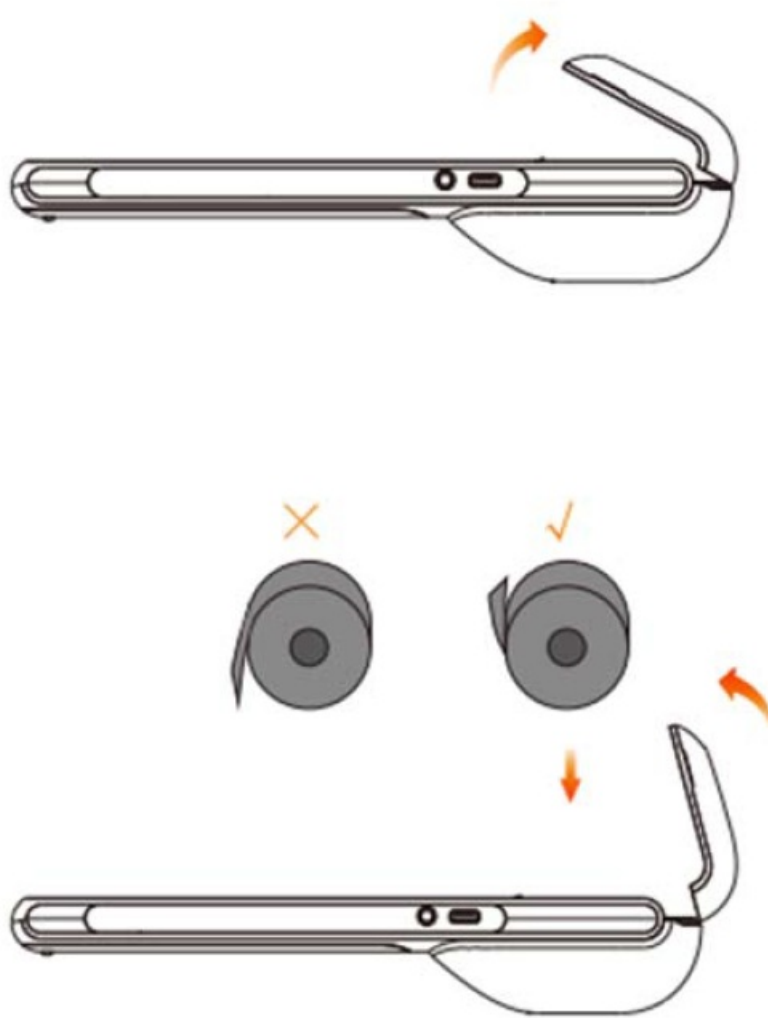

Basics

Home Screen Overview

The home screen is what you see when you first turn on your device. From here, you can explore apps and more.

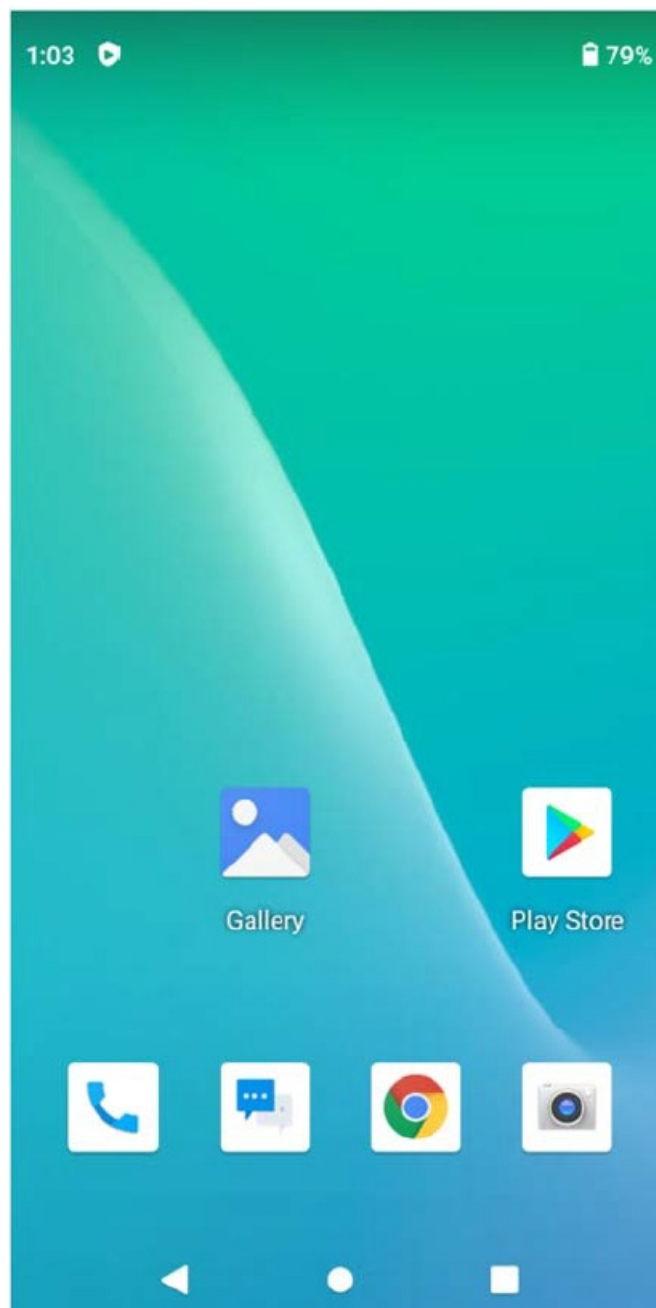

- Widgets: To put widgets like a clock, interactive calendar, and more on your home screen, touch and hold an empty spot on the home screen, then tap WIDGETS.
- Settings: To quickly open settings, swipe the status bar down with two fingers, to open more settings, tap .
- Apps: To remove an app from a home screen page, touch and hold the app, then drag it to Remove. The app isn't removed from your device, just the home screen.

To uninstall apps from your home screen, touch and hold an app, then drag it to Uninstall.





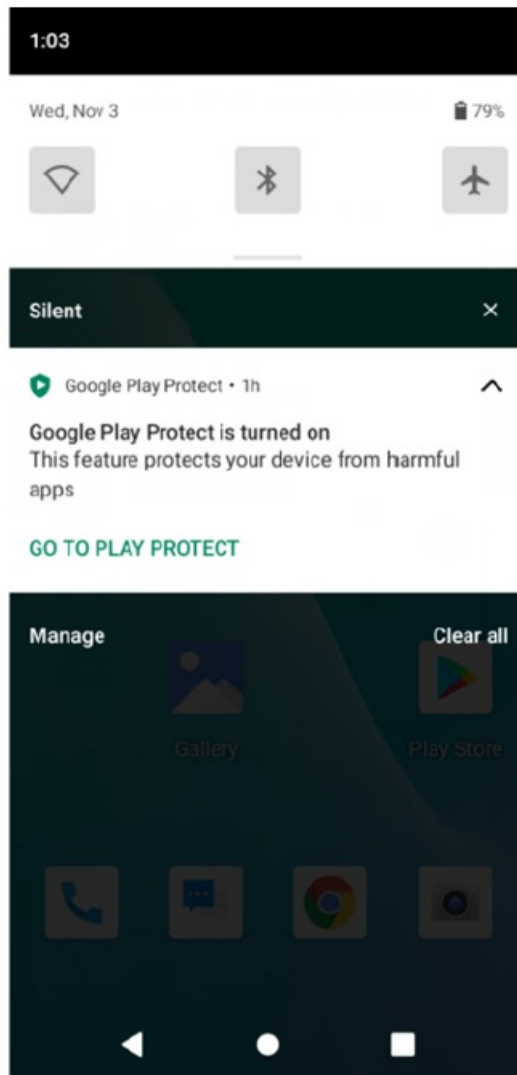



Status & notifications

At the top of the screen, icons on the left notify you about new messages or events. If you don't know what an icon means, swipe the status bar down for details.



The icons displayed on the status bar provide information about the status of the device. The icons listed in the table below are most common.

Note: The status bar may not appear at the top of the screen in some apps. To display the status bar, drag down from the top of the screen.

	Bluetooth feature activated
	GPS activated
	Wi-Fi connected
	Signal strength
	Flight mode activated
	Mute mode activated
	Vibration mode activated
	Error occurred or caution required

Quick settings

For quick access to Wi-Fi, Bluetooth, Brightness, Airplane mode, and other settings, swipe down the status bar or the lock screen with two fingers. For even more settings, tap .

Note: Your quick settings may look a little different.

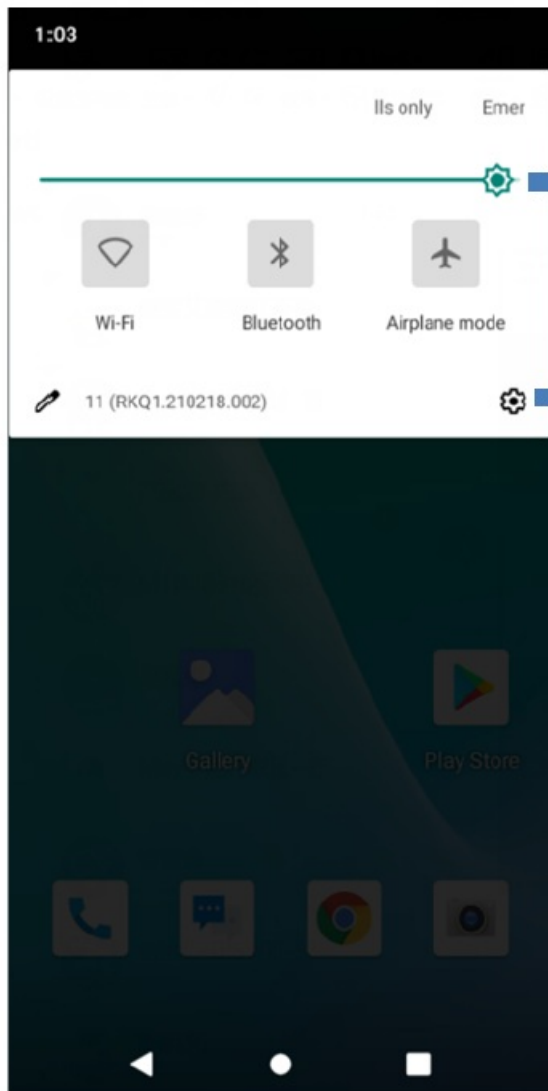

Set screen brightness

Set all of your settings

Profiles

You can share your device with others by adding a user. Users will have their own spaces on the device for custom home screens, accounts, apps, personalized settings, and more.

Add & switch users

Note: Only the device's owner can add a user.

Swipe down the status bar with two fingers and tap Profile .Follow the prompts to add a new user.

To switch users, swipe down the status bar with two fingers and tap Profile. Tap a user name.

Note: For a temporary user, use the Guest profile, which has limited access to your device's features and apps. Guests won't have access to your personal information.

Change or delete users

Tap Settings Users, then tap next to a user's name.

Connect & transfer

Wi-Fi networks

Wi-Fi provides wireless Internet access over distances of up to 300 feet. To use your device's Wi-Fi, you need

access to a wireless access point or “hotspot.”

The availability and range of the Wi-Fi signal depends on a number of factors, including infrastructure and other objects through which the signal passes.

Turn Wi-Fi power on/off

Find it: Settings > WLAN, then touch the Wi-Fi switch to turn it ON.

Note: To extend battery life, turn the Wi-Fi switch OFF when you're not using it.

Connect to networks

To find networks in your range:

1. Settings WLAN.

Note: To show your device's MAC address and Wi-Fi settings, tap Menu > Advanced.

2. Make sure the switch at the top is , then touch Menu > Refresh.
3. Tap a found network to connect it (if necessary, enter Network SSID, Security, and Wireless password, and tap Connect).

When your device connects, the Wi-Fi status indicator appears in the status bar.

Note: The next time your device connects to a previously accessed secured wireless network, you will not be prompted to enter the password again, unless you reset your device to its factory default settings or you instruct the device to forget the network.

Wi-Fi networks are self-discoverable, which means no additional steps are required for your device to connect to a Wi-Fi network. It may be necessary to provide a user name and password for certain closed wireless networks.

USB cables

To load music, pictures, videos, documents, or other files from your computer, connect your device to your computer with a USB cable. To change the type of USB connection (if necessary), tap Settings

Setting > Storage > Menu USB computer connection.

Bluetooth

Turn Bluetooth power on/off

Find it: Settings > Bluetooth, then touch the switch to turn it ON.

Note: Swipe down the status bar with two fingers to quickly turn Bluetooth on or off.

To extend battery life or stop connections, turn Bluetooth switch OFF when you're not using it.

Connect devices

The first time you connect a Bluetooth device, follow these steps:

1. Make sure the device you are pairing with is in discoverable mode.
2. Touch Settings > BLUETOOTH
3. Make sure the switch at the top is ON.
4. Tap a found device to connect it (if necessary, tap Pair or enter a passkey like 0000).

Manage devices

- To manually reconnect your device with a paired device, tap the device name in the list.
- To manually disconnect your device from a paired device, tap the device name in the devices list, then touch OK.
- To remove a paired device, touch next to the device name, then touch Unpair. 4
- To change the name your device shows to other devices, touch Settings Bluetooth, turn

Data use

You can track the amount of data your device uploads and downloads.

Find it: Settings > Data usage

Your device shows a data usage graph. Below the graph, apps appear from highest to least data usage. Apps that use a lot of data might also use a lot of battery power.



Restrict background data, show wi-fi networks, and more.

Note: Usage information is provided to help you manage your device. This may not match the amounts charged by your service provider, as they're not measured in the same way.

Near Field Communication (NFC) Technology

NFC (Near Field Communication) technology is a short-range, wireless technology that lets you quickly and wirelessly exchange information between your device and other NFC-enabled devices, smart accessories, and NFC-enabled access points. You can also use NFC technology to save, view, create, or change smart tags.

To use NFC technology on your device, your device must be within approximately 0.78 in. (2 cm) of the NFC-enabled device, smart accessory, NFC-enabled access point, or smart tag that you want to exchange information with. When information is transferred over an NFC connection, your device vibrates.

Turn NFC On and Off

When NFC is turned on, data can be exchanged when your device touches another device.

Touch the check box next to NFC to turn the feature On or Off.

Memory card

Your photos, videos, and other files are automatically stored in your device's internal memory. You can set certain apps, like the camera, to store files on a microSD card.

Note: Your device supports memory cards up to 32GB.

Mount or unmount memory card

To mount a memory card, simply put it into your device.

To unmount your memory card (so you can take it out of your device), tap Settings > Storage & USB > Unmount SD card.

Note: Do not remove a memory card while your device is using it or writing files to it.

Erase memory card content

To delete all the information (music, photos, and files) from your memory card, tap Settings > Storage & USB > Erase SD card.

Cellular networks

You should not need to change any network settings. Contact your service provider for help.

To see network settings options, tap Settings > More > Cellular networks.

Airplane mode

Use airplane mode to turn off all your wireless connections—useful when flying.

Swipe down the status bar with two fingers, then tap Airplane mode.

Or tap Settings > More > Airplane mode.

Note: When you select airplane mode, all wireless services are disabled. You can then turn Wi-Fi and/or Bluetooth Power back on, if permitted by your airline. Other wireless voice and data services (such as calls and text messages) remain off in airplane mode. Emergency calls to your region's emergency number can still be made.

Settings

Wi-Fi Settings

The Wi-Fi settings menu lets you turn Wi-Fi on or off, set up and connect to available Wi-Fi networks, and configure advanced Wi-Fi options.

Access the Wi-Fi Settings Menu

Touch Settings > WLAN.

Advanced Wi-Fi Settings

The advanced Wi-Fi settings menu lets you set up and manage wireless access points.

1. Touch Settings > WLAN.
2. Touch Menu > Advanced.
3. Configure your Wi-Fi settings, which may include:
 - Network notification
 - Keep Wi-Fi on during sleep
 - Scanning always available

- WLAN frequency band
- Install certificates
- WLAN Direct
- WPS Push Button
- WPS Pin Entry

Bluetooth Settings

Your device's Bluetooth capabilities let you use wireless headsets, send and receive pictures and files, and more.

Access the Bluetooth Settings Menu

Touch Settings > Bluetooth.

Data Usage Settings

The Data usage menu lets you view your device's mobile and Wi-Fi data usage, set data limits, restrict hotspot usage, and more.

- Touch Settings > Data usage.

More Settings

The More settings menu provides access to additional wireless and network options, such as cellular networks, VPN, Mobile plan, Emergency broadcasts, and more.

Cellular Networks Settings

The Mobile networks options let you enable your device's mobile data access, set your preferred network mode, configure Connections Optimizer, and select network operators for international use.

1. Touch Settings > More... > Cellular networks.
2. Options include:
 - Data roaming
 - Preferred network type
 - System select
 - Access Point Names
 - Network operators

NFC Settings

NFC (Near Field Communication) is a wireless technology that enables data transmission between two objects when they are brought within a few inches of each other. When you enable NFC on your device, it can exchange data with other NFC-enabled devices or read information from smart tags embedded in posters, stickers, and other products. From the NFC settings menu, you can manage direct sharing and pairing Bluetooth via NFC.

1. Touch Settings > More....
2. Touch the check box next to NFC to turn the feature On or Off.

Storage Settings

The Storage settings menu lets you manage internal storage on your device. You can view your device's internal storage capability and available space.

- Touch Settings > Storage & USB.
- View your device's memory storage total space and space used by specific features.
- Touch an itemized category for additional details.

Application Manager

You can download and install applications from the Google Play Store or create applications using the Android SDK and install them on your device. Use Application manager to manage applications on your device.

1. Touch Settings > Apps.
2. Touch Downloaded, Phone storage, Running or All to view the status of apps and services. Tap an app or service for more information, and for app options, such as stopping and uninstalling.

Location Settings

Your Location menu lets you select how your device determines its location (using the wireless network, GPS satellites, both, or neither).

1. Touch Settings > Location.
2. Touch the ON/OFF switch next to Location to turn the option On or Off.

Backup & reset

Your device's Back up and reset menu lets you back up your device's data and settings to Google servers before resetting your device to the original factory settings. The Factory data reset erases all data from the device's application storage, including:

- Your Google Account
- All other email and social networking accounts
- System and application data and settings
- Downloaded applications

Backup and Restore

To set your backup and restore options:

1. Touch Settings > Back up and reset.
2. Select your backup and restore options.
 - Back up my data: This option lets you back up your app data, Wi-Fi passwords, and other settings to Google servers.
 - Backup account: Select a Google Account for your device backup.
 - Automatic restore: This option lets you restore backed up settings and data when reinstalling an application after a factory data reset.

Factory Data Reset

1. Touch Settings > Back up and reset.
2. Touch Factory data reset.
3. Read the factory data reset information page and touch Reset device.
4. Touch Delete all. Your device will power down and reset itself, which may take up to 10 minutes.

Once the device has reset, it will run through the Hands Free Activation and update processes again. When finished, you will see the Welcome screen and Setup application.

Date & Time Settings

Use the Date & Time settings menu either to automatically use the network-provided date and time or manually set these values, as well as select time and date format options.

1. Touch Settings > Date and time.
2. Touch Automatic date & time to disable the feature.
 - If enabled, you cannot alter the date, time zone or time values.
3. Touch Set date. Adjust the date, month, and year. Touch Done when finished.
4. Touch Set time. Adjust the hour and minute. Touch Done when finished.
5. Touch Automatic time zone to disable the feature.
 - If enabled, you cannot alter the time zone values.
6. Touch Select time zone, and then select a time zone from the onscreen list. Scroll down the list to view additional time zones.
7. Touch Use 24-hour format to toggle between using a 12-hour or a 24-hour format.

About Phone

Find it: Settings > About Phone

This contains information about things ranging from Status, Legal information, Model number, Android version, Android security patch level, Baseband version, Kernel version, Build number to those listed below:

- Status: This contains the status of the Battery status, Battery level, My device number, Network, Signal strength, etc.
- Legal information: Touch to view legal information.
- Model number: View your device's model number.
- Android version: View the firmware version of your device.
- Baseband version: View the baseband version of your device.
- Kernel version: View the kernel version of your device.
- Build number: View the build number of your device.

Documents / Resources

	<p>Telpo M1 Android POS Terminal [pdf] User Manual M1, 2AJ2B-M1, 2AJ2BM1, M1 Android POS Terminal, Android POS Terminal, POS Terminal, Terminal</p>
---	---